

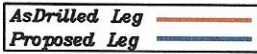

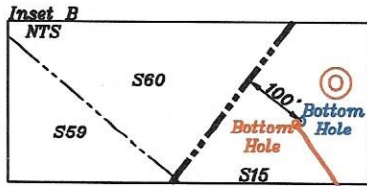

form - wv6



RECEIVED  
Office of Oil and Gas

MAR 14 2024

WV Department of  
Environmental Protection

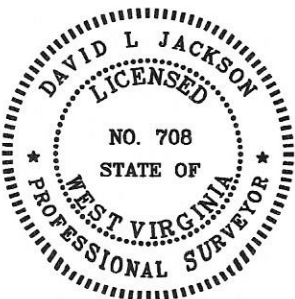
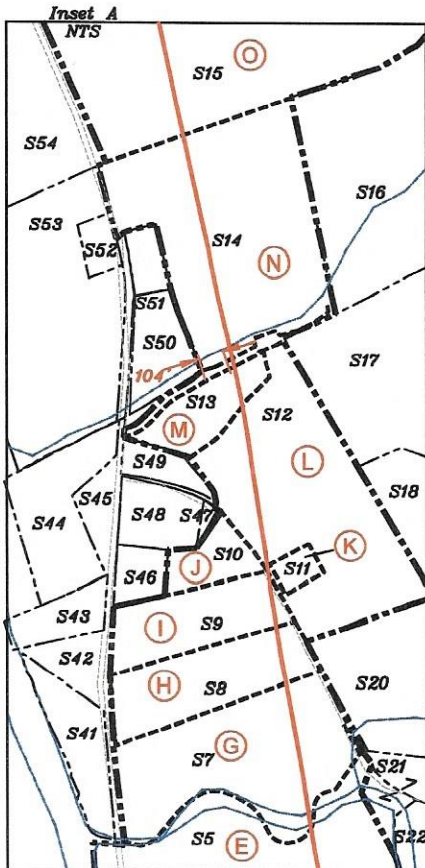

P.S.  
708

*David L Jackson*

Parcels within Unit Boundary				
Tags	Number	Tax Map -Parcel	Surface Owner	Acres
A	S1	p/o 05-10-12	JOSEPH BOYD	21.25
B	S2	05-10-11	LONNIE C & DEBBIE K FREY	85
C	S3	05-10-10	KENNETH R & JENNIFER L MASON	55
D	S4	05-10-13.1	KENNETH R & JENNIFER L MASON	80
E	S5	05-10-13	KENNETH R & JENNIFER L MASON	78.053
F	S6	05-10-13.3	ANTHONY S WRIGHT	2.797
G	S7	05-10-2.16	DANIEL M & SHANNON SMITH	7.966
H	S8	05-10-2.9	INDIAN CREEK SOUTHERN BAPTIST CHURCH	3.895
I	S9	05-10-2.10	INDIAN CREEK SOUTHERN BAPTIST CHURCH	3.265
J	S10	05-10-2.17	AARON S & CHERYL A YEATER	1.341
K	S11	05-10-2.15	LAURA L GARGASZ	0.441
L	S12	05-10-2.6	LAURA L GARGASZ	9.78
M	S13	05-10-5	DAVID J BOARD, TERRY M BOARD & KEVIN G BOARD LIVING TRUST	3
N	S14	05-10-55	DAVID & MELISSA WEST	11.36
O	S15	05-5-4	KENNETH & JENNIFER L MASON	52.78

Adjoining Parcels Ownership Table				
	Number	Tax Map -Parcel	Surface Owner	Acres
	S16	05-5-5	EARNLEY OWENS ET AL	75
	S17	05-10-2	LAURA L GARGASZ	20.997
	S18	05-10-2.7	CHRISTOPHER & KELLJ ANN POTOCZNY	11.14
	S19	05-10-2.8	C TODD & CANDY WARNER	6.875
	S20	05-10-2.1	MICHAEL J & CHRISTINE FARHATT	5.56
	S21	05-10-2.12	WILLIAM L ZILLS	30
	S22	05-10-8	WILLIAM A KILE	29.62
	S23	05-10-9.1	KENNETH R & JENNIFER L MASON	4.142
	S24	05-10-3	JASON M & AIMEE L STEVENS	27.25
	S25	05-10-48	ROBERT C MCMAHON	0.36
	S26	05-10-47	JAMES WRIGHT	2
	S27	05-10-46	DONALD & IMOGENE WHITFIELD	1
	S28	05-10-45	KATHLEEN RICHMOND, WALTER D & IMOGENE WHITFIELD	0.25
	S29	05-10-44	JEFFREY LEE & KATHLEEN ANN RICHMOND	0.25
	S30	05-10-43	ARTHUR T & LOIS J BLOOM	0.23
	S31	05-10-42	ARTHUR T & LOIS J BLOOM	0.23
	S32	05-10-41	MARK ALAN	0.7
	S33	05-10-40	EDWARD W JR & MARY FRANCES JOSEPH	0.35
	S34	05-10-4	DONALD J & JUDITH A LISBY	80
	S35	p/o 05-10-12	JOSEPH BOYD	10.25
	S36	p/o 05-10-12	JOSEPH BOYD	35
	S37	05-10-12.1	JOSEPH BOYD	28.25
	S38	05-10-20	KENNETH & JENNIFER L MASON	208
	S39	05-10-16.3	KENNETH & JENNIFER L MASON	267.68
	S40	01-05-4	KENNETH & JENNIFER L MASON	90
	S41	05-10-2.3	STATE OF WV	2.55
	S42	05-10-2.2	JEFFREY A DAVIS	1.061
	S43	05-10-7.1	JEFFREY A DAVIS	0.125
	S44	05-10-7	KEITH A RIEGELSBERGER	3.625
	S45	05-10-1	DONALD K JR & MAGGIE G MONGOLD	0.75
	S46	05-10-2.19	AARON S & CHERYL A YEATER	0.821
	S47	05-10-2.18	AARON S & CHERYL A YEATER	0.113
	S48	05-10-2.4	DAVIS, LLC	1.541
	S49	05-10-5.1	DAVID J BOARD, TERRY M BOARD & KEVIN G BOARD LIVING TRUST	0.33
	S50	05-10-6	STEVEN C & MELINDA WEIGLE	1.5
	S51	05-10-53	BOBBY & RITA DOLL	0.645
	S52	05-10-52	BRANDON & RACHEL DOLL	0.6
	S53	05-10-51	KATHY ANN SEAGO ET AL	11.4
	S54	05-10-50	STEVEN C WEIGLE	6.59
	S55	05-05-4.2	URSAL KAREN BAKER	0.67
	S56	05-05-4.1	KATHY ANN SEAGO ET AL	1.062
	S57	05-05-3	JASON S & MELISSA R THOMPSON	7.52
	S58	05-05-2	JAMES S TAYLOR	6
	S59	05-05-1	MELVIN E & SANDRA K FERGUSON	6.25
	S60	02-28-28	LINDA HOOVER ET AL	136.22
	S61	05-10-9	KENNETH R & JENNIFER L MASON	13.86

08/16/2024



Jay Bee  
Oil & Gas  
DRILLING  
into the future

API #: 47-095-02846  
WELL #: Maddie Mae 5  
DISTRICT: McELROY  
COUNTY: TYLER  
STATE: WV

WELL PLAT  
PAGE 2 OF 3  
DATE: 12/28/2023



form wv6

Tracts	District Tax Map/Parcel	JB Tract #	Lessor, Grantor, etc.	Deed Book/Page	Acres
A	p/o 05-10-12	W668C	Donna A. Alexander, et al	391/638	21.250
B	05-10-11	w669, 705	Monica Graham Beadling, et al	423/188	85.000
C	05-10-10	w669, 705	Monica Graham Beadling, et al	423/188	55.000
D	05-10-13.1	T5002B	Cathleen Donahue, et al	407/780	80.000
E	05-10-13	T5002A	Kenneth R. & Jennifer L. Mason, et al	403/511	78.053
F	05-10-13.3	T5002A	Kenneth R. & Jennifer L. Mason, et al	403/511	2.797
G	05-10-2.16	EXCO144H	Ella Saulene Goldston, et al	228/531	7.966
H	05-10-2.9	EXCO144F	Ella Saulene Goldston, et al	228/531	3.895
I	05-10-2.10	EXCO144F	Ella Saulene Goldston, et al	228/531	3.265
J	05-10-2.17	EXCO144I	Ella Saulene Goldston, et al	228/531	1.341
K	05-10-2.15	EXCO144A	Ella Saulene Goldston, et al	228/531	0.441
L	05-10-2.6	EXCO144A	Ella Saulene Goldston, et al	228/531	9.780
M	05-10-05	T6340	David J. Board, et al	sent to recorder	3.000
N	05-10-55	T5005B	David and Melissa West	448/158	11.360
O	05-05-04	T5005A	Mary F. Mutschelknaus	446/535	52.780

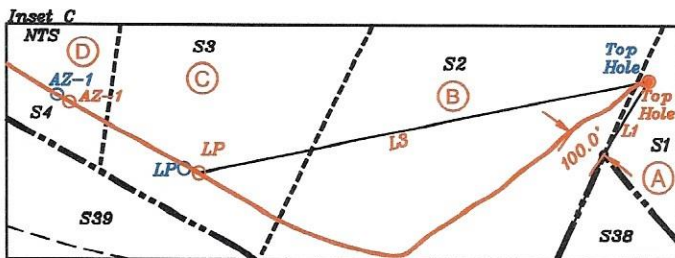

As Drilled Leg ———  
Proposed Leg ———

**Top Hole**  
Geo NAD 83- 39.437927 N, 80.806081 W  
UTM NAD 83(Meters)-4365382.48 N, 516687.81 E  
UTM NAD 83(Feet)-14322092.34 N, 1695186.59 E

**Landing Point**  
Geo NAD 83- 39.437114 N, 80.810554 W  
UTM NAD 83(Meters)-4365302.54 N, 516303.02 E  
UTM NAD 83(Feet)-14321630.05 N, 1693904.15 E

**Bottom Hole**  
Geo NAD 83- 39.454179 N, 80.830213 W  
UTM NAD 83(Meters)-4367193.04 N, 516407.66 E  
UTM NAD 83(Feet)-14328032.49 N, 1688341.98 E

**Azimuth Point 1 (AZ-1)**  
Geo NAD 83- 39.437649 N, 80.811791 W  
UTM NAD 83(Meters)-4365361.71 N, 516196.47 E  
UTM NAD 83(Feet)-14322024.20 N, 1693554.58 E

**Azimuth Point 2 (AZ-2)**  
Geo NAD 83- 39.439525 N, 80.814687 W  
UTM NAD 83(Meters)-4365589.41 N, 516946.85 E  
UTM NAD 83(Feet)-14322705.64 N, 1692795.63 E

RECEIVED  
Office of Oil and Gas

MAR 14 2024

WV Department of  
Environmental Protection

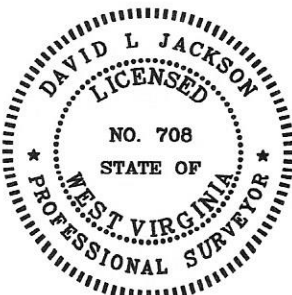

P.S.  
708

David L Jackson

08/16/2024



Jay Bee  
Oil & Gas  
DRILLING  
into the future

API #: 47-095-02846  
WELL #: Maddie Mae 5  
DISTRICT: McELROY  
COUNTY: TYLER  
STATE: WV

WELL PLAT  
PAGE 3 OF 3  
DATE: 12/28/2023