

**Antero Resources Corporation**

Appalachian Basin

Roma Lou Pad

Tyler County

RECEIVED  
Office of Oil and Gas

FEB 6 2023

Quadrangle: Middlebourne

Watershed: Outlet Middle Island Creek

District: Union

Date: 11-22-2019

WV Department of  
Environmental Protection

03/17/2023



**Antero Resources  
Well No. Loki 1H**

PAGE 1 of 2

Antero Resources Corporation

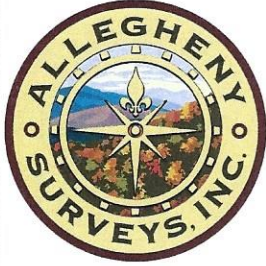

Well Location References (NTS)

Proposed Well No. Loki 1H

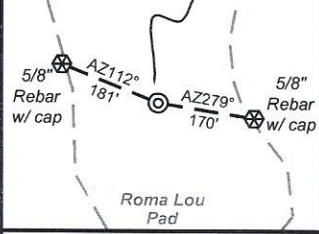

5,965' to Bottom Hole  
4,473' to Top Hole  
TOP HOLE LATITUDE 39 - 30 - 00  
BTM HOLE LATITUDE 39 - 32 - 30

**Notes**  
West Virginia Coordinate System of 1927, North Zone based upon Differential GPS Measurements. Well No. Loki Unit 1H Top Hole coordinates are N: 362,141.43' Latitude: 39°29'05.71\"/>

**Notes:**  
Well No. Loki Unit 1H UTM Zone 17, NAD 1927  
Top Hole Coordinates N: 14,338,495.22' E: 1,647,701.57'  
Point of Entry Coordinates N: 14,338,847.32' E: 1,648,724.77'  
Bottom Hole Coordinates N: 14,346,438.07' E: 1,646,206.66'

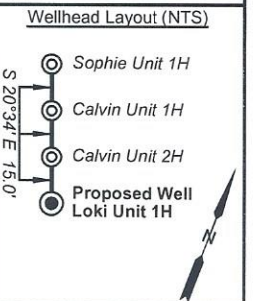

I, the undersigned, hereby certify that this plat is correct to the best of my knowledge and belief and shows all the information required by law and the rules issued and prescribed by the Department of Environmental Protection.

*Bradley D. Miller*  
Bradley D. Miller, P.S. 2167

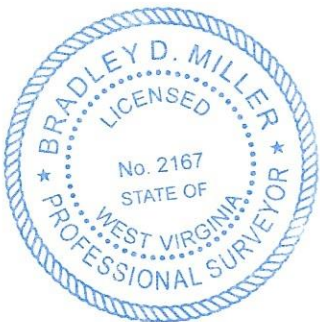

SEAL

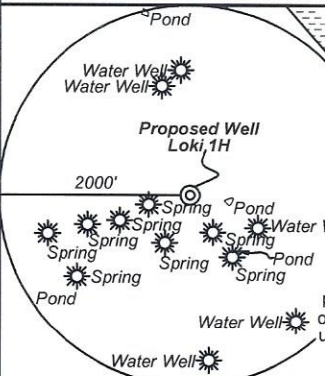

Note: 5 water wells 8 springs and 4 ponds were found within 2000' of proposed well. No occupied dwellings or buildings 2,500 square feet or larger used to house or shelter dairy cattle or poultry husbandry are located within 625' of the center of the well pad.

|    | Bearing    | Dist.    |
|----|------------|----------|
| L1 | S 74°16' W | 1,729.3' |
| L2 | N 81°50' W | 1,396.5' |
| L3 | N 08°53' W | 1,556.9' |
| L4 | N 72°46' E | 2,152.3' |
| L5 | N 71°58' E | 1,082.5' |

- Legend**
- Proposed gas well
  - Monument, as noted
  - Existing Well, as noted
  - Digitized Well, as noted
  - Creek or Drain
  - Road
  - Surface boundary (approx.)
  - Interior surface tracts (approx.)
  - District Line

FILE NO: 259-54-U-22  
DRAWING NO: Loki Unit 1H  
SCALE: 1" = 1500'  
MINIMUM DEGREE OF ACCURACY: Submeter  
PROVEN SOURCE OF ELEVATION: WVDOT, Harrisville, WV

**STATE OF WEST VIRGINIA**  
DEPARTMENT OF ENVIRONMENTAL PROTECTION  
**OIL AND GAS DIVISION**

DATE: January 23 2023  
OPERATOR'S WELL NO. Loki 1H  
API WELL NO  
47 - 095 - 02049  
STATE COUNTY PERMIT

WELL TYPE:  OIL  GAS  LIQUID INJECTION  WASTE DISPOSAL  
(IF GAS) PRODUCTION:  STORAGE  DEEP  SHALLOW

LOCATION: ELEVATION: As-Built 883' WATERSHED: Outlet Middle Island Creek QUADRANGLE: BH: Paden City  
DISTRICT: Union COUNTY: Tyler 03/17/2023  
SURFACE OWNER: Antero Resources Corp. ACREAGE: 60.38  
ROYALTY OWNER: Berna J. Hammel; WVDNR; Steven D. Zechman & Linda M. Jensen; Jay Edward Smith; LEASE NO: ACREAGE: 60.83; 250.5; 57.23; 72.88; 339.71; 65.462  
PROPOSED WORK:  DRILL  CONVERT  DRILL DEEPER  FRACTURE OR STIMULATE  PLUG OFF OLD FORMATION  
 PERFORATE NEW FORMATION  OTHER PHYSICAL CHANGE IN WELL (SPECIFY)  
 PLUG AND ABANDON  CLEAN OUT AND REPLUG TARGET FORMATION: Marcellus Shale ESTIMATED DEPTH: 6,500' TVD 16,500' MD

WELL OPERATOR: Antero Resources Corporation DESIGNATED AGENT: Kevin Ellis  
ADDRESS: 1615 Wynkoop Street ADDRESS: 535 White Oaks Blvd.  
Denver, CO 80202 Bridgeport, WV 26330



Antero Resources Corporation

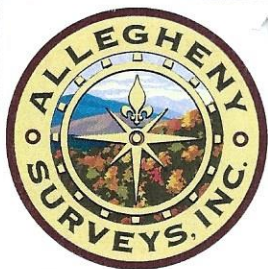

| ID | TM-Par | Owner                               | Bk/Pg    | Acres  |
|----|--------|-------------------------------------|----------|--------|
| 1  | 10-4.1 | Antero Resources Corporation        | OR12/739 | 60.38  |
| 2  | 9-9.1  | Jennifer K. & Diane M. Thomas       | AR46/754 | 40.00  |
| 3  | 10-4   | Kevin L. & Tammy J. Thomas          | OR7/290  | 32.22  |
| 4  | 10-5.3 | Richard Daniel Bowen                | 344/814  | 25.92  |
| 5  | 10-5.5 | Bowen Family Irrevocable Trust      | 372/303  | 22.89  |
| 6  | 10-5   | Timothy Brian Bowen, et al          | 652/440  | 48.36  |
| 7  | 9-4    | Steven D. Zechman & Linda M. Jensen | 348/422  | 250.00 |
| 8  | 6-3    | Eldon J. & Ruth A. Helman           | 383/761  | 72.80  |
| 9  | 6-1    | Eldon J. & Ruth A. Helman           | 383/761  | 169.00 |
| 10 | 5-16   | Charity Gas Inc.                    | 358/516  | 393.00 |
| 11 | 6-4    | Darren E. Thacker                   | 616/762  | 67.00  |
| 12 | 6-5.2  | Julia Fetty Carolus                 | 323/585  | 5.50   |
| 13 | 5-26   | Paul R. Fetty                       | 288/126  | 82.22  |

| Leases |                                     |
|--------|-------------------------------------|
| A      | Berna J. Hammel                     |
| B      | Mary Faye Grove                     |
| C      | Sally & Mitchell Dunn               |
| D      | J&N Management Enterprises, LLC     |
| E      | WVDNR                               |
| F      | Steven D. Zechman & Linda M. Jensen |
| G      | Jay Edward Smith                    |
| H      | Norma R. Spencer                    |
| I      | Haight Family Trust                 |
| J      | Greenbrier Royalty Fund III, LLC    |

FILE NO: 259-54-U-22  
DRAWING NO: Loki Unit 1H  
SCALE: 1" = 1500'  
MINIMUM DEGREE OF ACCURACY:  
Submeter  
PROVEN SOURCE OF ELEVATION:  
WVDOT, Harrisville, WV

**STATE OF WEST VIRGINIA**  
DEPARTMENT OF ENVIRONMENTAL PROTECTION  
**OIL AND GAS DIVISION**

DATE: January 23 2023  
OPERATOR'S WELL NO. Loki 1H  
API WELL NO  
47 - 095 - 02849  
STATE COUNTY PERMIT

WELL TYPE:  OIL  GAS  LIQUID INJECTION  WASTE DISPOSAL  
(IF GAS) PRODUCTION:  STORAGE  DEEP  SHALLOW

LOCATION: ELEVATION: As-Built 883' WATERSHED: Outlet Middle Island Creek QUADRANGLE: BH: Paden City TH: Middlebourne  
DISTRICT: Union COUNTY: Tyler

SURFACE OWNER: Antero Resources Corp. ACREAGE: 60.38  
ROYALTY OWNER: Berna J. Hammel; WVDNR; Steven D. Zechman & Linda M. Jensen; Jay Edward Smith; LEASE NO: ACREAGE: 60.83; 250.5; 57.23; 72.88; 339.71; 65.462

PROPOSED WORK:  DRILL  CONVERT  DRILL DEEPER  FRACTURE OR STIMULATE  PLUG OFF OLD FORMATION  
 PERFORATE NEW FORMATION  OTHER PHYSICAL CHANGE IN WELL (SPECIFY)  
 PLUG AND ABANDON  CLEAN OUT AND REPLUG TARGET FORMATION: Marcellus Shale ESTIMATED DEPTH: 16,500' MD

WELL OPERATOR: Antero Resources Corporation DESIGNATED AGENT: Kevin Ellis  
ADDRESS: 1615 Wynkoop Street ADDRESS: 535 White Oaks Blvd.  
Denver, CO 80202 Bridgeport, WV 26330

03/17/2023