

Antero Resources  
Well No. Burch 1H  
As-Drilled  
Antero Resources Corporation

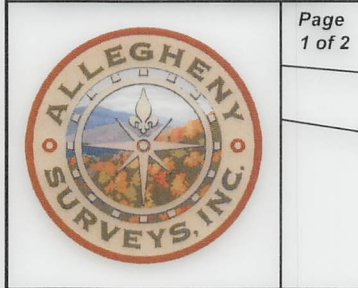

Page  
1 of 2

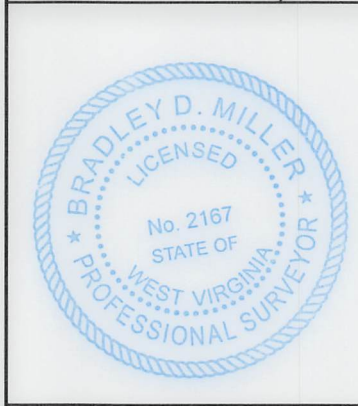

I, the undersigned, hereby certify that this plat is correct to the best of my knowledge and belief and shows all the information required by law and the rules issued and prescribed by the Department of Environmental Protection.

*Bradley D. Miller*  
Bradley D. Miller, P.S. 2167

Top Hole Coordinates, As-drilled data, and information was provided by Antero Resources Corporation. AllegHENY Surveys Inc. (ASI) is not certifying the data and information provided. ASI is not responsible for any errors or inaccuracies with the data and information that has been provided.

Note: 8 water wells were found within 2000' of proposed well. No occupied dwellings or buildings 2,500 square feet or larger used to house or shelter dairy cattle or poultry husbandry are located within 625' of the center of the well pad.

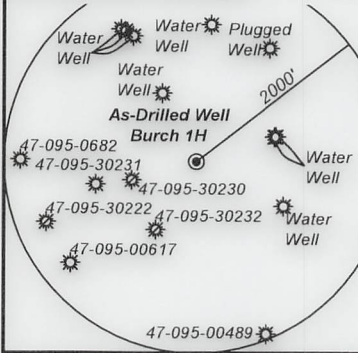

	Bearing	Dist.
L1	N 74°10' E	3,049.9'
L2	S 78°13' E	2,153.7'
L3	S 20°07' W	1,002.3'
L4	N 51°19' W	2,927.8'

Legend

- Proposed gas well
- Monument, as noted
- Existing Well, as noted
- Digitized Well, as noted
- Road
- Surface boundary (approx.)
- Interior surface tracts (approx.)
- District Line

BTM Hole  
7.5' Spot

5/8" Rebar

47-94-00673

47-095-30223

47-095-30222

Capped Rebar

47-095-00677

47-95-00682

47-95-00682

47-95-00682

47-95-00682

47-95-00682

47-95-00682

47-95-00682

47-95-00682

47-95-00682

47-95-00682

47-95-00682

47-95-00682

47-95-00682

47-95-00682

47-95-00682

47-95-00682

47-95-00682

47-95-00682

47-95-00682

47-95-00682

STATE OF WEST VIRGINIA  
DEPARTMENT OF ENVIRONMENTAL PROTECTION  
OIL AND GAS DIVISION

DATE: April 16 20 25

OPERATOR'S WELL NO. Burch Unit 1H

API WELL NO

47 - 095 - 02893  
STATE COUNTY PERMIT

WELL TYPE: ☐ OIL ☒ GAS ☐ LIQUID INJECTION ☐ WASTE DISPOSAL  
(IF GAS) PRODUCTION: ☐ STORAGE ☐ DEEP ☒ SHALLOW

LOCATION: ELEVATION: As-Built 937' WATERSHED: Outlet Middle Island Creek QUADRANGLE: Bens Run

DISTRICT: THL: Meade, BHL: Union COUNTY: THL: Meade, BHL: Bens Run

SURFACE OWNER: Shirley J. Wells & Suise Cunningham ACREAGE: 53.85

ROYALTY OWNER: Antero Minerals, LLC LEASE NO: ACREAGE: 365.445

PROPOSED WORK: ☐ DRILL ☐ CONVERT ☐ DRILL DEEPER ☐ FRACTURE OR STIMULATE ☐ PLUG OFF OLD FORMATION  
☐ PERFORATE NEW FORMATION ☒ OTHER PHYSICAL CHANGE IN WELL (SPECIFY) As-Drilled

☐ PLUG AND ABANDON ☐ CLEAN OUT AND REPLUG TARGET FORMATION: Marcellus Shale ESTIMATED DEPTH: 5,987' TVD 20,076' MD

WELL OPERATOR: Antero Resources Corporation

DESIGNATED AGENT: Conrad Baston

ADDRESS: 1615 Wynkoop Street  
Denver, CO 80202

ADDRESS: 535 White Oaks Blvd.  
Bridgeport, WV 26330

2,321' to Top Hole

TOP HOLE LATITUDE 39 - 27 - 30  
BTM HOLE LATITUDE 39 - 30 - 00

Notes

West Virginia Coordinate System of 1927, North Zone based upon Differential GPS Measurements. Well No. Burch Unit 1H Top Hole coordinates are N: 339,136.40' Latitude: 39°25'16.72" E: 1,573,939.74' Longitude: 81°00'29.58" Bottom Hole coordinates are N: 351,839.27' Latitude: 39°27'21.26" E: 1,567,963.52' Longitude: 81°01'48.48" UTM Zone 17, NAD 1983 Top Hole Coordinates Bottom Hole Coordinates N: 4,363,540.097m N: 4,367,379.643m E: 499,307.217m E: 497,421.933m Plat orientation and corner and well references are based upon the grid north meridian. Well location references are based upon the magnetic meridian.

Notes:

Well No. Burch Unit 1H As-Drilled POE Coordinates WV Coordinate System of 1927, North Zone N: 338,979.71' E: 1,572,397.35' Latitude: 39°25'14.91" Longitude: 81°00'49.20" UTM Zone 17, NAD 1983 N: 4,363,484.508m E: 498,838.125m

Wellhead Layout (NTS)

Oxbow Unit 1H (API# 47-095-02894)  
As-Drilled Well Burch Unit 1H (API# 47-095-02893)  
Rata Unit 1H (API# 47-095-02895)



LONGITUDE 81 - 00 - 00

13,485' to Top Hole

16,061' to Bottom Hole



Antero Resources  
Well No. Burch 1H  
As-Drilled

Antero Resources Corporation



Page  
2 of 2

Leases	
A	Roy Emmett Huffman & Linda Gay Huffman
B	Michael Scott Bonner
C	Lisa Kmyaich
D	Terry & Daphne Heinzman
E	Antero Minerals, LLC
F	Clifford Benjamin & Rebecca Louise Boone
G	Bobbin E. Pardine
H	Estate of Mary Jane Stewart
I	Greenbrier Royalty Fund II, LLC
J	WVDNR
K	A.P. Allen, et ux
L	Wells Cattle Farms, Inc.
M	Greenbrier Royalty Fund II, LLC
N	Vicki Bonner
O	Bradley William Poch
P	Janelle Sue Perkins
Q	Antero Minerals, LLC
R	Inex B. Fletcher, et vir
S	Mary C. Robinson Living Trust

ID	TM/Par	Owner	Bk/Pg	Acres
1	3-9	Roy Emmett & Linda Gay Huffman	126/341	55.00
2	3-23A	David L. Bonner	WB33/171	104.00
3	3-26	Glen E. Bonner	WB33/171	13.35
4	13-36	Lisa Krynaich	566/759	165.50
5	7-14	Terry & Daphne Heinzman	262/527	61.77
6	12-12	Lisa Krynaich	566/759	20.00
7	7-23B	Frederick M. Bonner	286/474	27.33
8	7-14.1	Terry & Daphne Heinzman	262/527	30.00
9	7-15	Rebecca Louise & Clifford Benjamin Boone	348/311	9.17
10	7-13.1	Rebecca Louise & Clifford Benjamin Boone	348/317	77.25
11	7-15.1	Bobbin E. Pardine	268/516	63.60
12	7-13.2	Terry & Daphne Heinzman	342/105	42.70
13	15-16	James E. & Anita Carr	349/742	58.12
14		Middle Island Creek		
15		Middle Island Creek		
16	7-22	Forty-Four Acres, Inc.	208/134	44.50
17	4-8	Wells Cattle Farms, Inc.	331/164	155.00
18	4-19	Wells Cattle Farms, Inc.	318/190	206.13
19	4-20	Cecil E. Sr. & Linda Jordan; James & Connie Hicks	318/190	206.13
20	4-32	Wells Cattle Farms, Inc.	318/190	206.13
21	7-1	Daniel Preston Bonner	416/11	142.72
22	7-1.1	Daniel Preston Bonner	416/11	20.19
23	7-7	Janelle S. Perkins	184/378	74.08
24	12-17	Cecil E. & Betty J. Hamilton	269/58	32.38
25	7-8	John Wells	428/412	52.39
26	7-2	Shirley J. Wells & Susie Cunningham	WB41/317	53.85

FILE NO: 173-54-U-23

DRAWING NO: Burch Unit 1H As-Drilled

SCALE: 1" = 2000'

MINIMUM DEGREE OF ACCURACY:  
Submeter

PROVEN SOURCE OF ELEVATION:  
WVDOT, Harrisville, WV

STATE OF WEST VIRGINIA  
DEPARTMENT OF ENVIRONMENTAL PROTECTION  
OIL AND GAS DIVISION



DATE: April 16 20 25

OPERATOR'S WELL NO. Burch Unit 1H

API WELL NO

47 — 095 — 02893  
STATE COUNTY PERMIT

WELL TYPE: ☐ OIL ☒ GAS ☐ LIQUID INJECTION ☐ WASTE DISPOSAL  
(IF GAS) PRODUCTION: ☐ STORAGE ☐ DEEP ☒ SHALLOW

LOCATION: ELEVATION: As-Built 937' WATERSHED: Outlet Middle Island Creek QUADRANGLE: Bens Run

DISTRICT: THL: Meade, BHL: Union COUNTY: Tyler, GHL: Pleasants

SURFACE OWNER: Shirley J. Wells & Suise Cunningham ACREAGE: 53.85

ROYALTY OWNER: Antero Minerals, LLC LEASE NO: ACREAGE: 365.445

PROPOSED WORK: ☐ DRILL ☐ CONVERT ☐ DRILL DEEPER ☐ FRACTURE OR STIMULATE ☐ PLUG OFF OLD FORMATION  
☐ PERFORATE NEW FORMATION ☒ OTHER PHYSICAL CHANGE IN WELL (SPECIFY) As-Drilled 5,987' TVD

☐ PLUG AND ABANDON ☐ CLEAN OUT AND REPLUG TARGET FORMATION: Marcellus Shale ESTIMATED DEPTH: 20,076' MD

WELL OPERATOR: Antero Resources Corporation DESIGNATED AGENT: Conrad Baston

ADDRESS: 1615 Wynkoop Street ADDRESS: 535 White Oaks Blvd.  
Denver, CO 80202 Bridgeport, WV 26330