

Antero Resources
Well No. Acadia 1H
BHL MOD
Antero Resources Corporation

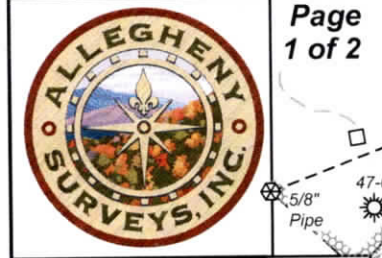

Page
1 of 2

4,071' to Bottom Hole
 8,704' to Top Hole
 TOP HOLE LATITUDE 39 - 35 - 00
 BTM HOLE LATITUDE 39 - 32 - 30

Notes
 West Virginia Coordinate System of 1927, North Zone based upon Differential GPS Measurements.
 Well No. Acadia Unit 1H Top Hole coordinates are
 N: 387,356.07' Latitude: 39°33'16.17"
 E: 1,591,860.55' Longitude: 80°56'51.14"
 Bottom Hole coordinates are
 N: 373,510.27' Latitude: 39°31'00.03"
 E: 1,596,276.90' Longitude: 80°55'51.95"
 UTM Zone 17, NAD 1983
 Top Hole Coordinates Bottom Hole Coordinates
 N: 4,378,321.753m N: 4,374,126.037m
 E: 504,521.694m E: 505,937.468m
 Plat orientation and corner and well references are based upon the grid north meridian.
 Well location references are based upon the magnetic meridian.

Notes:
 Well No. Acadia Unit 1H UTM Zone 17, NAD 1927
 Top Hole Coordinates
 N: 14,363,830.01'
 E: 1,655,203.58'
 Point of Entry Coordinates
 N: 14,363,683.02'
 E: 1,655,194.00'
 Bottom Hole Coordinates
 N: 14,350,064.57'
 E: 1,659,848.88'

Well Location References
 Not To Scale
 Stake & Tack AZ97° 40' 40'
 Stake & Tack AZ309° 45' 45'
 Shinn Pad
 Proposed Well No. Acadia 1H
 I, the undersigned, hereby certify that this plat is correct to the best of my knowledge and belief and shows all the information required by law and the rules issued and prescribed by the Department of Environmental Protection.
 Bradley D. Miller, P.S. 2167

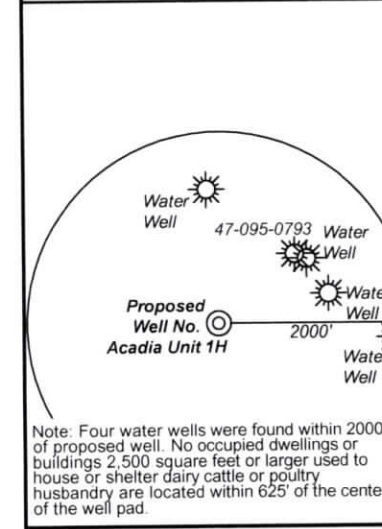
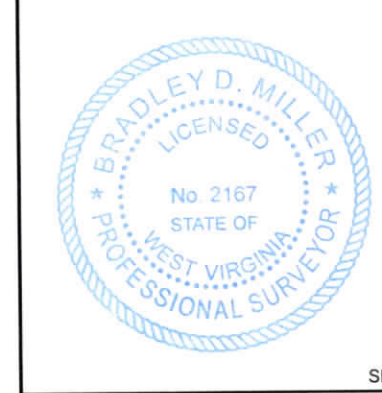

| | Bearing | Dist. |
|----|------------|----------|
| L1 | N 08°27' E | 830.9' |
| L2 | N 25°49' W | 3,315.5' |
| L3 | S 46°43' E | 1,472.9' |
| L4 | N 69°10' E | 3,466.7' |
| L5 | S 04°41' W | 147.4' |

FILE NO: 164-54-L-23
 DRAWING NO: Acadia Unit 1H BHL MOD
 SCALE: 1" = 2000'
 MINIMUM DEGREE OF ACCURACY: Submeter
 PROVEN SOURCE OF ELEVATION: WVDOT, Harrisville, WV

STATE OF WEST VIRGINIA
 DEPARTMENT OF ENVIRONMENTAL PROTECTION
OIL AND GAS DIVISION

DATE: November 6 2024
 OPERATOR'S WELL NO. Acadia Unit 1H
 API WELL NO
 47 - 095 - 02897
 STATE COUNTY PERMIT

WELL TYPE: OIL GAS LIQUID INJECTION WASTE DISPOSAL
 (IF GAS) PRODUCTION: STORAGE DEEP SHALLOW
 Proposed Grade 1,036'
 LOCATION: ELEVATION: Existing Grade 1,043' WATERSHED: Outlet Middle Island Creek QUADRANGLE: Paden City
 DISTRICT: Lincoln COUNTY: Tyler 12/20/2024
 SURFACE OWNER: Antero Resources Corporation ACREAGE: 52.51
 ROYALTY OWNER: Raymond B. Heintzman, et ux LEASE NO: ACREAGE: 100
 PROPOSED WORK: DRILL CONVERT DRILL DEEPER FRACTURE OR STIMULATE PLUG OFF OLD FORMATION
 PERFORATE NEW FORMATION OTHER PHYSICAL CHANGE IN WELL (SPECIFY) BHL MOD 6,700' TVD
 PLUG AND ABANDON CLEAN OUT AND REPLUG TARGET FORMATION: Marcellus Shale ESTIMATED DEPTH: 22,600' MD

WELL OPERATOR: Antero Resources Corporation DESIGNATED AGENT: Kevin Ellis
 ADDRESS: 1615 Wynkoop Street ADDRESS: 535 White Oaks Blvd.
 Denver, CO 80202 Bridgeport, WV 26330

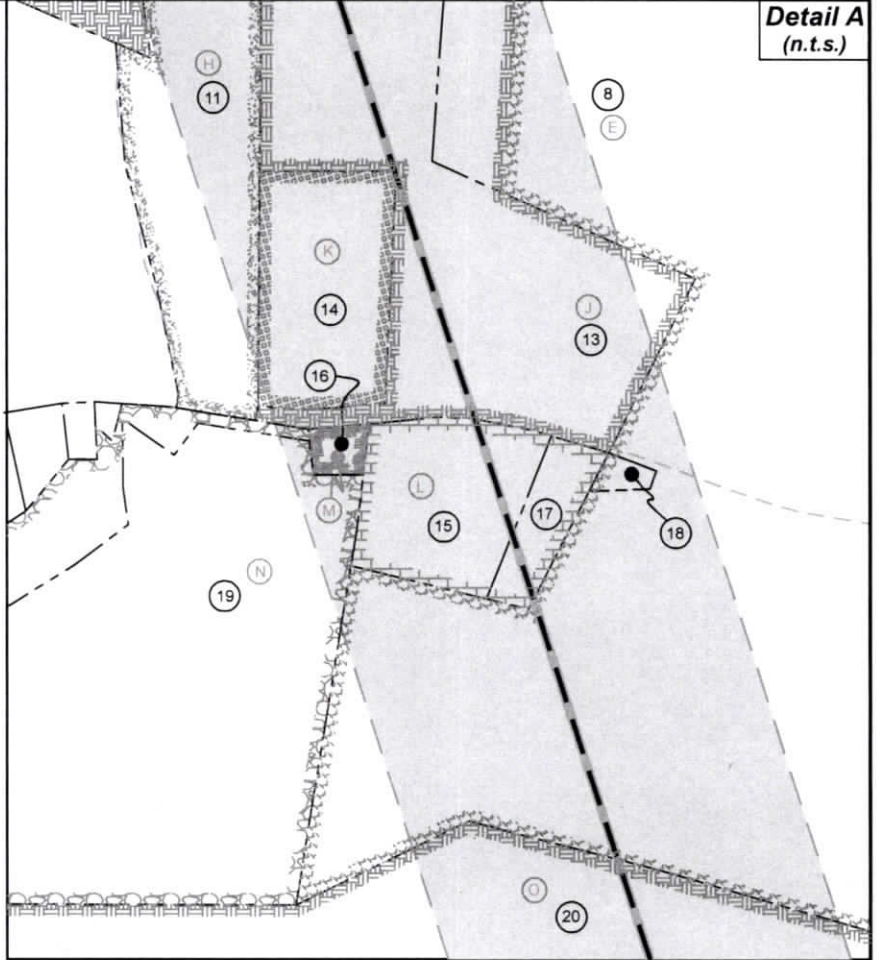

| ID | TM-Par | Owner | Bk/Pg | Acres |
|----|---------|-------------------------------------------|----------|--------|
| 1 | 8-21.2 | Antero Resources Corporation | 296/494 | 35.52 |
| 2 | 8-21 | Antero Resources Corporation | 296/490 | 52.51 |
| 3 | 8-19 | Olive Branch Animal Rescue | 333/804 | 173.48 |
| 4 | 8-39 | Virginia A. Nalley | 190/482 | 70.65 |
| 5 | 8-41 | David E. & Ila Grace Kyle | 272/189 | 118.10 |
| 6 | 8-40 | Cleatus T. Still | AR46/356 | 16.94 |
| 7 | 8-59 | Burl A. & Colleen Folger | 199/135 | 24.00 |
| 8 | 12-71 | Shaun M. & Carrie A. Meckley | 393/423 | 266.33 |
| 9 | 8-39.1 | Gary G. Jr. & Debbie Ann Phillips | 404/299 | 33.13 |
| 10 | 8-58 | Jerry R. Brightwell & Gwendolyn C. Davies | 343/841 | 20.16 |
| 11 | 12-19 | Joseph C. & Nancy E. Starkey | 217/203 | 17.00 |
| 12 | 8-57 | Douglas Ray Carson, Jr. | 595/111 | 33.84 |
| 13 | 12-20.2 | Shawn M. & Carrie A. Meckley | 601/789 | 30.21 |
| 14 | 12-20.4 | Joseph C. & Nancy E. Starkey | 579/666 | 4.85 |
| 15 | 12-20 | Gary G. Sr. & Mary E. Phillips | 308/508 | 3.82 |
| 16 | 12-42 | Ray T. & Amy S. Fluharty | 227/16 | 0.42 |
| 17 | 12-20.3 | Kathleen Cooley | 618/455 | 1.38 |
| 18 | 12-20.1 | Shaun M. & Carrie A. Meckley | 393/423 | 1.38 |
| 19 | 12-41 | Shaun M. & Carrie A. Meckley | 633/569 | 43.28 |
| 20 | 12-71.1 | James Perry & Melissa Flesher | 316/137 | 63.45 |
| 21 | 12-54.9 | Justin L. & Suzanne L. Nichols | 531/592 | 1.37 |
| 22 | 12-54.3 | Teresa Jean Starcher | 316/146 | 2.62 |
| 23 | 12-54.4 | Charles Matthew & Christina R. Duke | 564/350 | 1.11 |
| 24 | 12-54.5 | Charles R. Duke | 349/511 | 1.01 |
| 25 | 12-54.6 | Thomas & Nova Lee Fonner | 243/392 | 1.12 |
| 26 | 12-54 | David A. Starcher | 591/22 | 60.95 |
| 27 | 12-54.2 | Jane Ann Magruder | 322/333 | 15.84 |
| 28 | 12-68 | Denver R. II & Deborah L. Starcher | 475/380 | 51.41 |
| 29 | 13-15 | Cathy J. Meredith Trust | 634/684 | 200.86 |
| 30 | 12-69 | Denver R. II & Deborah L. Starcher | 475/380 | 10.00 |
| 31 | 12-70 | Starkey Farm 95, LLC | 387/530 | 76.01 |
| 32 | 13-20 | Jim Winland | 304/421 | 50.75 |
| 33 | 13-1 | James L. & Martha Jo Stewart | 330/931 | 194.04 |
| 34 | 14-1 | James A. & Carol Winland | WB31/209 | 47.48 |

| Leases | |
|--------|-----------------------------------------------------------------------|
| A | Raymond B. Heintzman, et ux |
| C | Bounty Minerals, LLC |
| D | John L. Hess |
| E | Lois M. & Billy J. Stern, JTWROS |
| F | Virginia A. Nalley |
| G | Jerry R. Brightwell, et ux |
| H | Julia Ann Ford |
| I | Bounty Minerals, LLC |
| J | Rose Ann Craig Lambert |
| K | Joseph Clair Starkey, et ux |
| L | Gary W. Phillips, et ux |
| M | Kenny W. Harter |
| N | Roy L. Craig |
| O | James P. & Melissa B. Flesher, JTWROS |
| Q | BRC Appalachian Minerals I, LLC |
| R | Cathy Jane Meredith, acting Trustee for the Cathy Jane Meredith Trust |
| S | Carolina Mineral Partners, LLC |
| T | James Andrew Winland |
| W | James Andrew Winland |
| Y | BRC Appalachian Minerals I, LLC |
| Z | Nevin Porter, et al |

FILE NO: 164-54-L-23
 DRAWING NO: Acadia Unit 1H BHL MOD
 SCALE: 1" = 2000'
 MINIMUM DEGREE OF ACCURACY:
 Submeter
 PROVEN SOURCE OF ELEVATION:
 WVDOT, Harrisville, WV

STATE OF WEST VIRGINIA
 DEPARTMENT OF ENVIRONMENTAL PROTECTION
OIL AND GAS DIVISION

DATE: November 6 2024
 OPERATOR'S WELL NO. Acadia Unit 1H
API WELL NO
 47 - 095 - 02897
 STATE COUNTY PERMIT

WELL TYPE: OIL GAS LIQUID INJECTION WASTE DISPOSAL
 (IF GAS) PRODUCTION: STORAGE DEEP SHALLOW
 LOCATION: ELEVATION: Proposed Grade 1,036' Existing Grade 1,043' WATERSHED: Outlet Middle Island Creek QUADRANGLE: Paden City
 DISTRICT: Lincoln COUNTY: Tyler **12/20/2024**
 SURFACE OWNER: Antero Resources Corporation ACREAGE: 52.51
 ROYALTY OWNER: Raymond B. Heintzman, et ux LEASE NO: ACREAGE: 100
 PROPOSED WORK: DRILL CONVERT DRILL DEEPER FRACTURE OR STIMULATE PLUG OFF OLD FORMATION
 PERFORATE NEW FORMATION OTHER PHYSICAL CHANGE IN WELL (SPECIFY) BHL MOD 6,700' TVD
 PLUG AND ABANDON CLEAN OUT AND REPLUG TARGET FORMATION: Marcellus Shale ESTIMATED DEPTH: 22,600' MD

WELL OPERATOR: Antero Resources Corporation DESIGNATED AGENT: Kevin Ellis
 ADDRESS: 1615 Wynkoop Street ADDRESS: 535 White Oaks Blvd.
 Denver, CO 80202 Bridgeport, WV 26330