

Antero Resources Corporation

Appalachian Basin

Starkey Pad

Tyler County

Quadrangle: Paden City

Watershed: Outlet Middle Island Creek

District: Lincoln

Date: 9-25-2023

05/30/2025

Antero Resources
Well No. Eleanor 2H

Antero Resources Corporation

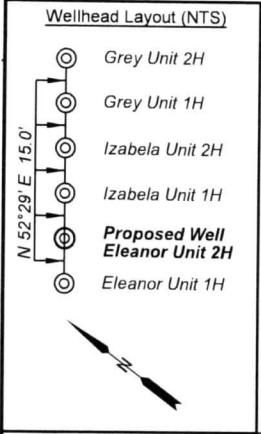

- Legend
- Proposed gas well
 - Monument, as noted
 - Surface boundary (approx.)
 - Adjoiner boundary

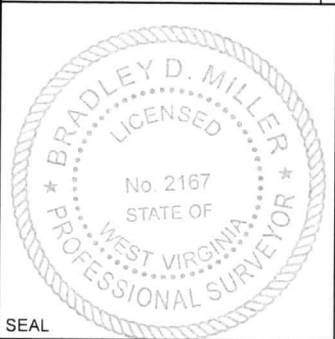

I, the undersigned, hereby certify that this plat is correct to the best of my knowledge and belief and shows all the information required by law and the rules issued and prescribed by the Department of Environmental Protection.

Bradley D. Miller, P.S. 2167

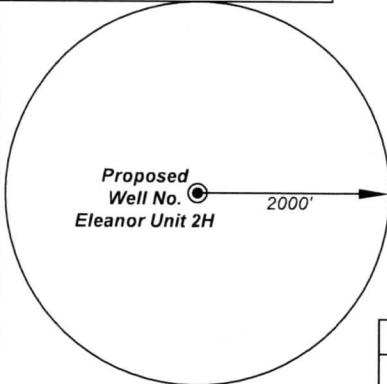

Note: No water wells were found within 2000' of proposed well. No occupied dwellings or buildings 2,500 square feet or larger used to house or shelter dairy cattle or poultry husbandry are located within 625' of the center of the well pad.

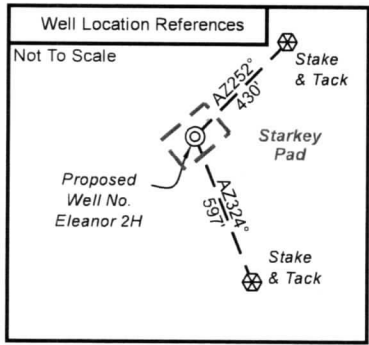

Tag	Bearing	Dist.	Monument
L1	S 34°46' W	1,132.4'	Stone
L2	S 05°00' E	1,282.6'	5/8" Rebar
L3	S 88°16' E	1,566.9'	5/8" Rebar
L4	N 63°29' E	1,207.6'	Capped Iron Rebar

No.	TM / Par	Owner	Bk / Pg	Ac.
1	5 / 11	Robert F. & Rita K. Scardina	320 / 646	25.00
2	5 / 9.4	Neil R. Stebbins	366 / 436	51.48
3	5 / 12	Robert F. & Rita K. Scardina	320 / 646	25.00
4	5 / 10	Robert F. & Rita K. Scardina	320 / 646	25.00

Notes:

West Virginia Coordinate System of 1927, North Zone based upon Differential GPS Measurements.

Well No. Eleanor 2H coordinates are

N: 392,075.10' Latitude: 39°34'03.61"

E: 1,596,930.22' Longitude: 80°55'47.38"

UTM Zone 17, NAD 1983

Top Hole Coordinates

N: 4,379,785.267m

E: 506,042.229m

UTM Zone 17, NAD 1927

Top Hole Coordinates

N: 14,368,631.38'

E: 1,660,192.05'

Plat orientation and corner and well references are based upon the grid north meridian.

Well location references are based upon the magnetic meridian.

FILE NO: 157-54-U-23

DRAWING NO: Eleanor Unit 2H Vertical

SCALE: 1" = 500'

MINIMUM DEGREE OF ACCURACY: Submeter

PROVEN SOURCE OF ELEVATION: WVDOT, Harrisville, WV

STATE OF WEST VIRGINIA

DEPARTMENT OF ENVIRONMENTAL PROTECTION

OIL AND GAS DIVISION

DATE: April 11 20 25

OPERATOR'S WELL NO: Eleanor Unit 2H

API WELL NO

47 - 095 - 02933

STATE COUNTY PERMIT

WELL TYPE: ☐ OIL ☒ GAS ☐ LIQUID INJECTION ☐ WASTE DISPOSAL

(IF GAS) PRODUCTION: ☐ STORAGE ☐ DEEP ☒ SHALLOW

LOCATION: ELEVATION: As-Built 1,092' WATERSHED: Outlet Middle Island Creek QUADRANGLE: Paden City

DISTRICT: Lincoln COUNTY: Tyler 05/30/2025

SURFACE OWNER: Robert F. Scardina & Rita K. Scardina ACREAGE: 25.00

ROYALTY OWNER: Robert F. Scardina & Rita K. Scardina LEASE NO: ACREAGE: 25.00

PROPOSED WORK: ☒ DRILL ☐ CONVERT ☐ DRILL DEEPER ☒ FRACTURE OR STIMULATE ☐ PLUG OFF OLD FORMATION

☒ PERFORATE NEW FORMATION ☐ OTHER PHYSICAL CHANGE IN WELL (SPECIFY) 6,700' TVD

☐ PLUG AND ABANDON ☐ CLEAN OUT AND REPLUG TARGET FORMATION: Marcellus Shale ESTIMATED DEPTH: 6,700' MD

WELL OPERATOR: Antero Resources Corporation DESIGNATED AGENT: Conrad Baston

ADDRESS: 1615 Wynkoop Street ADDRESS: 535 White Oaks Blvd.

Denver, CO 80202 Bridgeport, WV 26330

Antero Resources
Well No. Eleanor 2H

Antero Resources Corporation

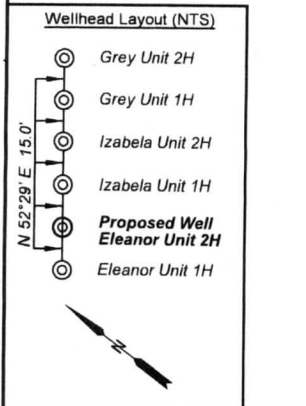

- Legend
- Proposed gas well
 - Monument, as noted
 - Surface boundary (approx.)
 - Adjoiner boundary

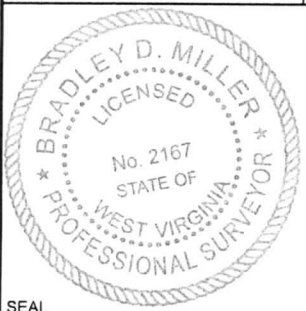

I, the undersigned, hereby certify that this plat is correct to the best of my knowledge and belief and shows all the information required by law and the rules issued and prescribed by the Department of Environmental Protection.

Bradley D. Miller, P.S. 2167

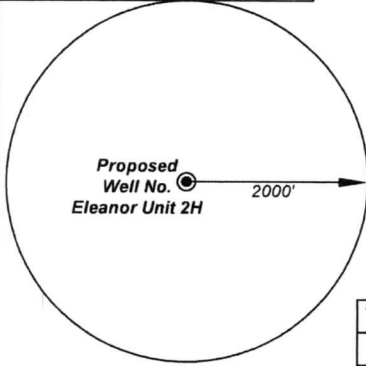

Note: No water wells were found within 2000' of proposed well. No occupied dwellings or buildings 2,500 square feet or larger used to house or shelter dairy cattle or poultry husbandry are located within 625' of the center of the well pad.

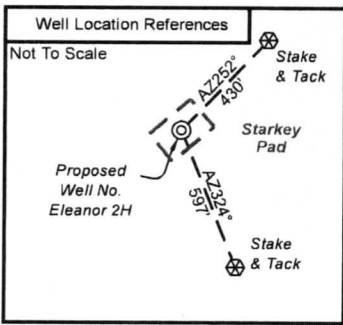

Tag	Bearing	Dist.	Monument
L1	S 34°46' W	1,132.4'	Stone
L2	S 05°00' E	1,282.6'	5/8" Rebar
L3	S 88°16' E	1,566.9'	5/8" Rebar
L4	N 63°29' E	1,207.6'	Capped Iron Rebar

No.	TM / Par	Owner	Bk / Pg	Ac.
1	5 / 11	Robert F. & Rita K. Scardina	320 / 646	25.00
2	5 / 9.4	Neil R. Stebbins	366 / 436	51.48
3	5 / 12	Robert F. & Rita K. Scardina	320 / 646	25.00
4	5 / 10	Robert F. & Rita K. Scardina	320 / 646	25.00

Notes:

West Virginia Coordinate System of 1927, North Zone based upon Differential GPS Measurements.

Well No. Eleanor 2H coordinates are

N: 392,075.10' Latitude: 39°34'03.61"

E: 1,596,930.22' Longitude: 80°55'47.38"

UTM Zone 17, NAD 1983

Top Hole Coordinates

N: 4,379,785.267m

E: 506,042.229m

UTM Zone 17, NAD 1927

Top Hole Coordinates

N: 14,368,631.38'

E: 1,660,192.05'

Plat orientation and corner and well references are based upon the grid north meridian.

Well location references are based upon the magnetic meridian.

FILE NO: 157-54-U-23

DRAWING NO: Eleanor Unit 2H Vertical

SCALE: 1" = 500'

MINIMUM DEGREE OF ACCURACY: Submeter

PROVEN SOURCE OF ELEVATION: WVDOT, Harrisville, WV

STATE OF WEST VIRGINIA
DEPARTMENT OF ENVIRONMENTAL PROTECTION
OIL AND GAS DIVISION

DATE: April 11 20 25

OPERATOR'S WELL NO: Eleanor Unit 2H

API WELL NO

47 - 095 - 02933

STATE COUNTY PERMIT

WELL TYPE: ☐ OIL ☒ GAS ☐ LIQUID INJECTION ☐ WASTE DISPOSAL

(IF GAS) PRODUCTION: ☐ STORAGE ☐ DEEP ☒ SHALLOW

LOCATION: ELEVATION: As-Built 1,092' WATERSHED: Outlet Middle Island Creek QUADRANGLE: Paden City

DISTRICT: Lincoln COUNTY: Tyler

SURFACE OWNER: Robert F. Scardina & Rita K. Scardina ACREAGE: 25.00

ROYALTY OWNER: Robert F. Scardina & Rita K. Scardina LEASE NO: ACREAGE: 25.00

PROPOSED WORK: ☒ DRILL ☐ CONVERT ☐ DRILL DEEPER ☒ FRACTURE OR STIMULATE ☐ PLUG OFF OLD FORMATION

☒ PERFORATE NEW FORMATION ☐ OTHER PHYSICAL CHANGE IN WELL (SPECIFY) 6,700' TVD

☐ PLUG AND ABANDON ☐ CLEAN OUT AND REPLUG TARGET FORMATION: Marcellus Shale ESTIMATED DEPTH: 6,700' MD

WELL OPERATOR: Antero Resources Corporation DESIGNATED AGENT: Conrad Baston

ADDRESS: 1615 Wynkoop Street ADDRESS: 535 White Oaks Blvd.

Denver, CO 80202 Bridgeport, WV 26330

4/15/25