

Company American Oil Development Co.

Address Sistersville, W.Va.

Farm Jesse White

Tract 1 Acres 245 Lease No. _____

Well (Farm) No. 7 Serial No. _____

Elevation (Spirit Level) 989.5'

Quadrangle Centerpoint n.w.

County Tyler District McElroy

Engineer J.S. Haught

Engineer's Registration No. _____ Co. Surveyor _____

File No. _____ Drawing No. _____

Date 10-7-37 Scale 1"-50 rds.

STATE OF WEST VIRGINIA
Department of Mines
OIL AND GAS DIVISION
CHARLESTON

WELL LOCATION MAP
File No. TYL-149A

† Denotes location of well on United States Topographic Maps, scale 1 to 62,500, latitude and longitude lines being represented by border lines as shown.

— Denotes one inch spaces on border line of original tracing.

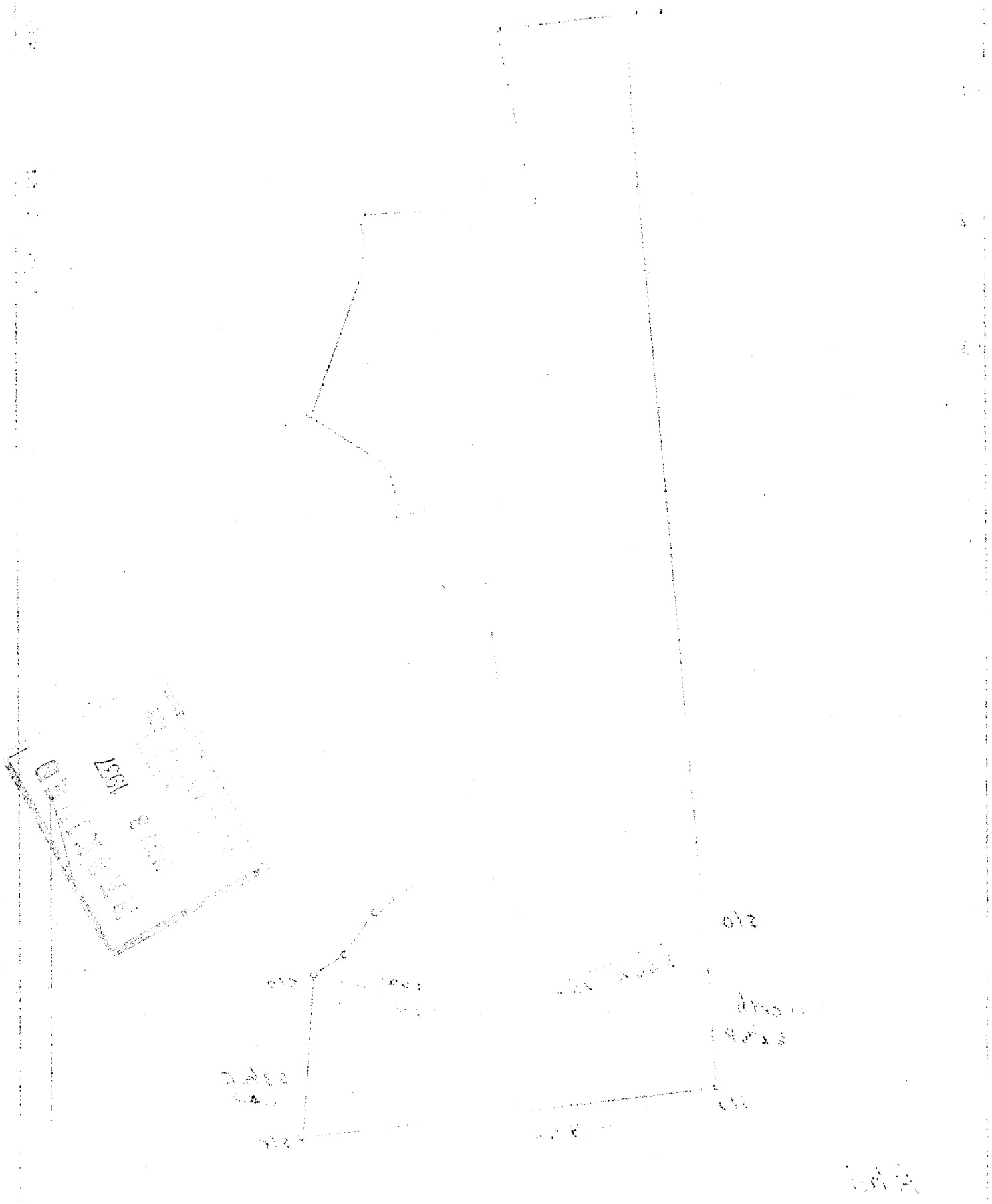

This drawing is a site plan showing the layout of a building and its surroundings. The building is represented by the smaller rectangle in the bottom-left corner of the main plot. The dimensions of the building are given as 1007 units by 8.100 units. The main plot is a larger rectangle with dimensions 210 units by 200 units. The drawing also shows various lines and arrows indicating the orientation and boundaries of the plot. The annotations '210', '200', and '100' likely refer to the dimensions of the main plot. The drawing is a technical drawing and should be used as a reference for the construction of the building.