

Company Underwood Oil Co.
 Address Shirley, W. Va.
 Farm S.M. and Pere F. Portt, Surface
 Tract _____ Acres 85 Lease No. _____
 Well (Farm) No. _____ Serial No. _____
 Elevation (Spirit Level) 1004
 Quadrangle West Union NE
 County Tyler District McElroy
 Engineer J. M. Martin
 Engineer's Registration No. 811
 File No. _____ Drawing No. _____
 Date Feb 23, 1940 Scale 70 Feet - 1"

STATE OF WEST VIRGINIA
 DEPARTMENT OF MINES
 OIL AND GAS DIVISION
 CHARLESTON

WELL LOCATION MAP
 FILE NO. TYL-242A

+ Denotes location of well on United States Topographic Maps, scale 1 to 62,500, latitude and longitude lines being represented by border lines as shown.

- Denotes one inch spaces on border line of original tracing.

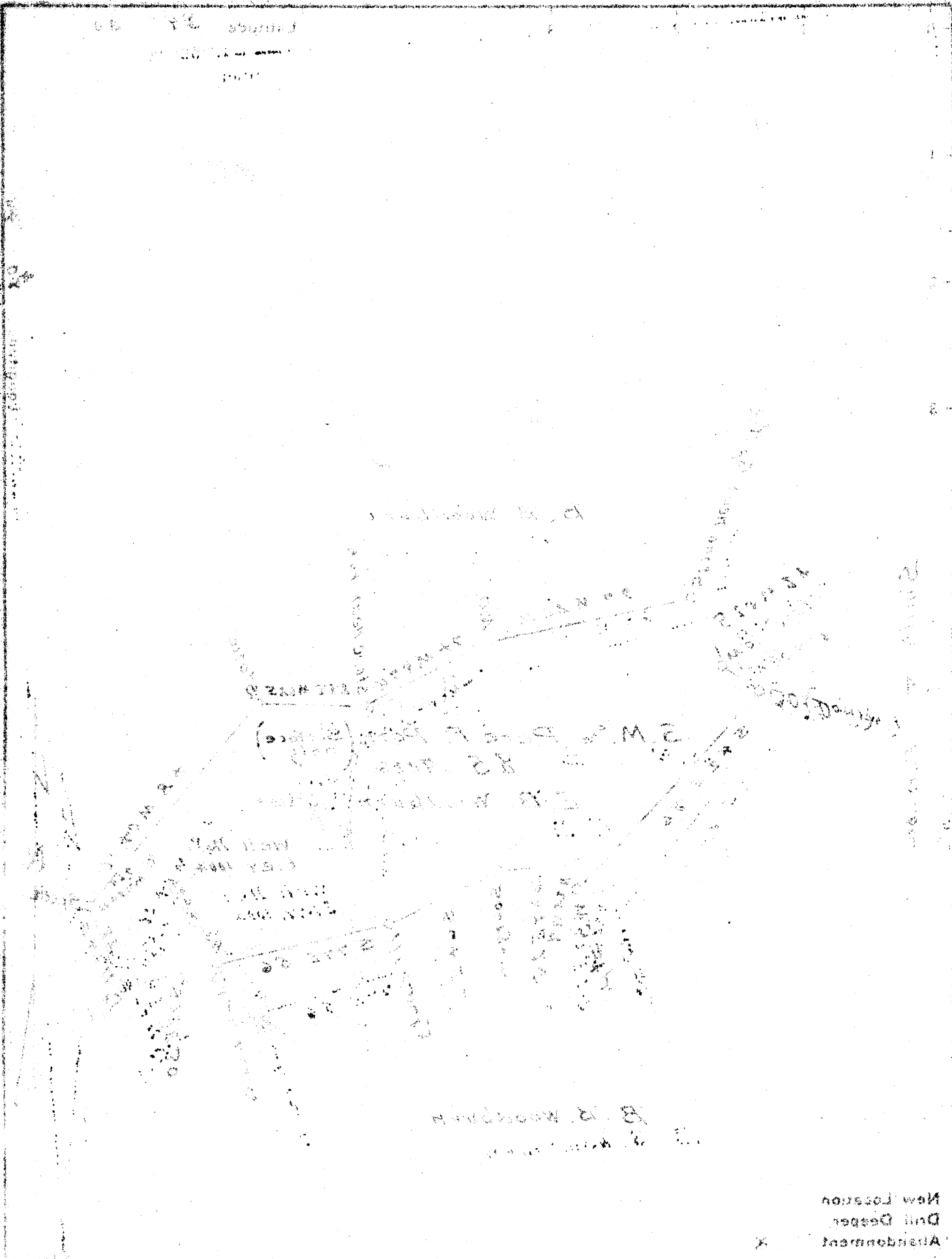

New Location
 Drill Design
 Abandonment X

STATE OF WEST VIRGINIA
 DEPARTMENT OF MINING
 OIL AND GAS DIVISION
 CHARLESTON

WELL LOCATION MAP
 FILE NO. TYL-252A

+ Denotes location of well on United States
 Topographic Map, scale 1 to 62,500, and
 true and longitude lines being represented
 by border lines as shown.

- Denotes one inch scales on layout and
 of original tracing.

Date: 1940
 Drawing No. 40
 Engineer's Registration No. 1004
 File No. 1004

Company: Underwood Oil Co.
 Address: 2110 W. 10th St., W.Va.
 Farm: 2110 W. 10th St., W.Va.
 Tract: 2110 W. 10th St., W.Va.
 Well (Farm) No. 1004
 Elevation Spirit Level: 1004
 Quadrangle: West Virginia
 County: Tyler
 Engineer: [Signature]