

4	0.61 S	3.37 W
3	0.67 S	3.74 W
6	0.69 S	3.40 W
12	0.68 S	3.11 W

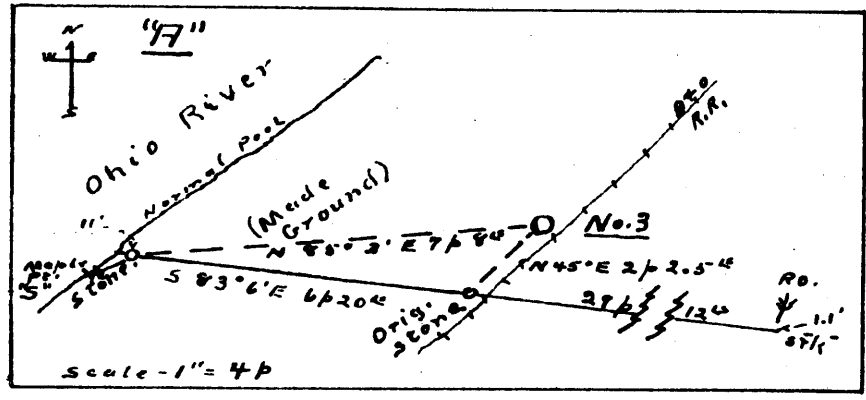

New Location...

Drill Deeper.....

Abandonment.....

Casing heads:-  
 No. 3 + 0.2' No. 6 + 1.5'  
 No. 4 + 1' No. 12 + 3'  
 (No. 3 Well has previously been located on 1924 Topo. Sheet.)

Company Roy W. Confer Co.

Address 515 Allen St. Titusville, Pa.

Farm E. P. Russell

Tract 1 Acres 60 Lease No. \_\_\_\_\_

Well (Farm) No. 3, 4, 6 & 12 Serial No. 3-529,021/6-1029,836

Elevation (Spirit Level) 4-1062,506/12-900.031

Quadrangle New Martinsville

County Tyler District Lincoln

Engineer Don L. Riggle SW

Engineer's Registration No. \_\_\_\_\_

File No. 0+G-S.P. 11 Drawing No. \_\_\_\_\_

Date Apr. 28, 48 Scale 1" = 60'

STATE OF WEST VIRGINIA  
 DEPARTMENT OF MINES  
 OIL AND GAS DIVISION  
 CHARLESTON

**WELL LOCATION MAP**

FILE NO. JYL-542-A-#4  
JYL-545-A-#12 JYL-543-A-#3  
JYL-544-A-#6

+ Denotes location of well on United States Topographic Maps, scale 1 to 62,500, latitude and longitude lines being represented by border lines as shown.

- Denotes one inch spaces on border line of original tracing.



STATE OF WEST VIRGINIA  
DEPARTMENT OF MINES  
OIL AND GAS DIVISION

506

WELL RECORD

Permit No. 5754

Oil or Gas Well Oil  
(KIND)

Company Roy W. Confer Co.  
Address 515 Allen Street, Titusville, Pa.  
Farm E. P. Russell Acres 60  
Location (waters) \_\_\_\_\_  
Well No. 12 Elev. 900.031  
District Lincoln County Tyler  
The surface of tract is owned in fee by E. P. Russell  
Address Sistersville, WVa  
Mineral rights are owned by South Penn Oil Co.  
Address Parkersburg, WVa

Casing and Tubing	Used in Drilling	Left in Well	Packers
Size			
16			Kind of Packer
13			
10	<u>150'</u>	<u>Pulled Out</u>	of
8 1/4	<u>900'</u>	<u>" "</u>	
6 5/8	<u>1335'</u>		Depth set
5 3/16			
3			Perf. top
2			Perf. bottom
Liners Used			Perf. top
			Perf. bottom

Drilling commenced \_\_\_\_\_  
Drilling completed \_\_\_\_\_  
Date Shot No Record From \_\_\_\_\_ To \_\_\_\_\_  
With \_\_\_\_\_  
Open Flow /10ths Water in \_\_\_\_\_ Inch  
/10ths Merc. in \_\_\_\_\_ Inch  
Volume \_\_\_\_\_ Cu. Ft.  
Rock Pressure \_\_\_\_\_ lbs. \_\_\_\_\_ hrs.  
Oil No Record bbls., 1st 24 hrs.  
Fresh water \_\_\_\_\_ feet \_\_\_\_\_ feet  
Salt water \_\_\_\_\_ feet \_\_\_\_\_ feet

CASING CEMENTED \_\_\_\_\_ SIZE \_\_\_\_\_ No. Ft. \_\_\_\_\_ Date \_\_\_\_\_  
COAL WAS ENCOUNTERED AT \_\_\_\_\_ FEET \_\_\_\_\_ INCHES  
\_\_\_\_\_ FEET \_\_\_\_\_ INCHES FEET \_\_\_\_\_ INCHES  
\_\_\_\_\_ FEET \_\_\_\_\_ INCHES FEET \_\_\_\_\_ INCHES

Formation	Color	Hard or Soft	Top	Bottom	Oil, Gas or Water	Depth Found	Remarks
<u>Big Injun</u>			<u>1640'</u>	<u>1731'</u>	<u>Oil</u>	<u>1640'</u>	

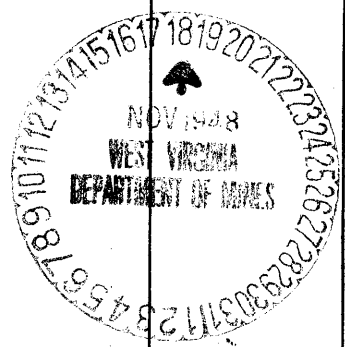

L.P.  
K. F. RUSSELL NO. 12 WELL.

Lincoln District, Tyler County, W. Va.  
By Roy W. Confer Co., 515 Allen St., Titusville, Pa.  
Abandoned under permit Tyl-.....-A?  
On 60 acres.

Elevation, 900.031' L.

Surface owned by K. F. Russell, Sistersville, W. Va., and minerals by  
South Penn Oil Co., Parkersburg, W. Va.

Date shot, no record.

10" casing, 150' (pulled); 8 1/2", 900' (pulled); 6", 1335'.

Oil well. Record to Dept. of Mines stamped Nov. 18, 1908.

Record to RCT from Mrs. Griffith July 10, 1909. Old File No. 506.

Big Injun Sand (oil, 1640')  
Total depth

Top.	Bottom.
1640	- 1731
	1731