

LATITUDE 39° 35'

LONGITUDE 80° 50'

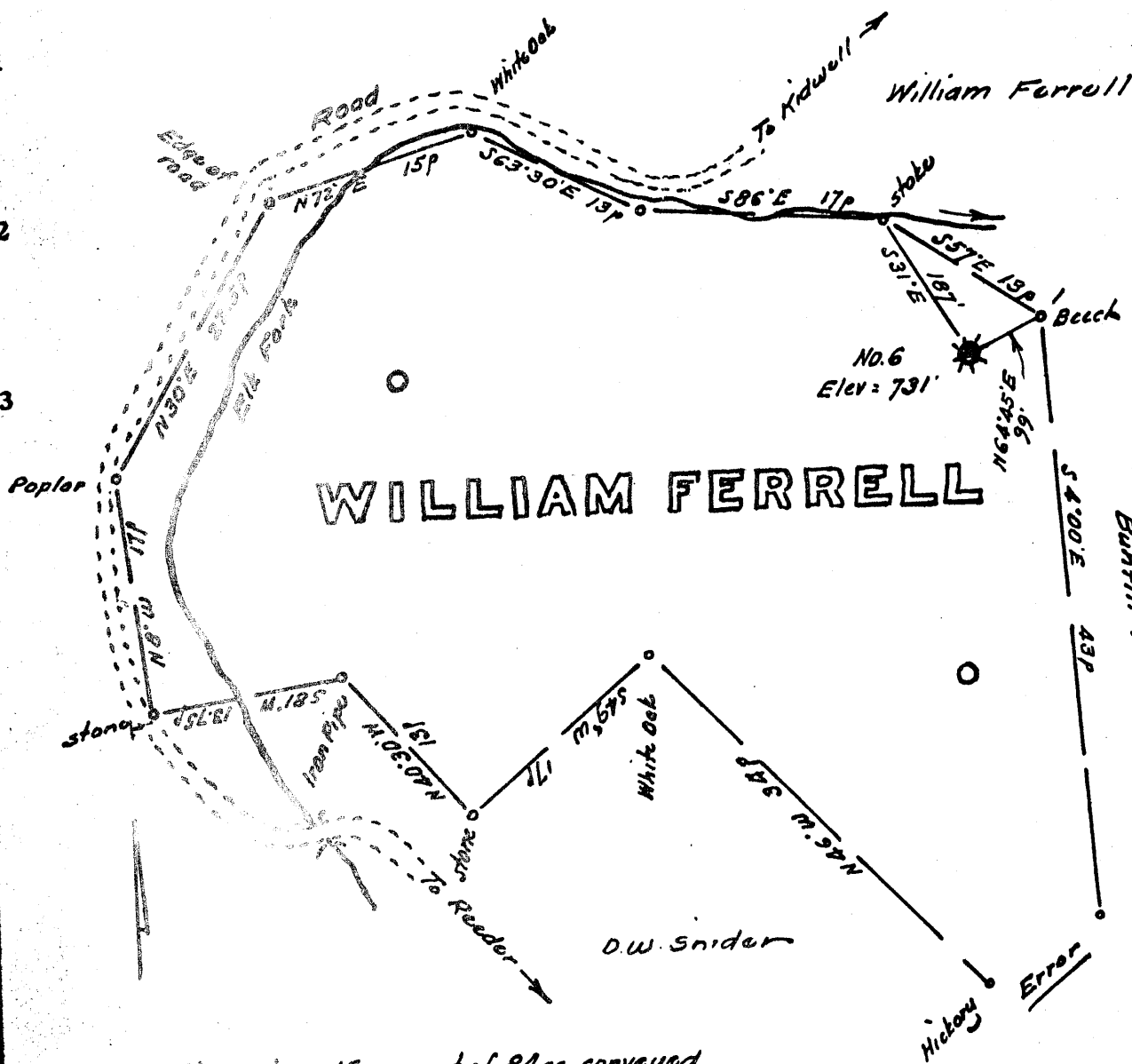

Note: Shown is a 15ac part of 84ac. conveyed to Frank Fizer.

Minimum Error of Closure 1 in 200'

Source of Elevation Elev at mouth of Big Run = 719'

I, the undersigned, hereby certify that this map is correct to the best of my knowledge and belief and shows all the information required by paragraph 6 of the rules and regulations of the oil and gas section of the mining laws of West Virginia.

- Fracture.....
- New Location.....
- Drill Deeper.....
- Abandonment.....

Signed: [Signature]
 Squares: N S E W

Map No.

Company C. B. FEIGK
 Address Route 2, Walker, West Va.
 Farm William Ferrell
 Tract _____ Acres 84 Lease No. _____
 Well (Farm) No. Six Serial No. _____
 Elevation (Spirit Level) 731'
 Quadrangle New Martinsville SC
 County Talbot District Ellsworth
 Engineer [Signature]
 Engineer's Registration No. 1227
 File No. _____ Drawing No. _____
 Dnto Oct 9, 1969 Scale 1" = 200'

STATE OF WEST VIRGINIA
 DEPARTMENT OF MINES
 OIL AND GAS DIVISION
 CHARLESTON

WELL LOCATION MAP

FILE NO. Ty1-950(A)

+ Denotes location of well on United States Topographic Maps, scale 1 to 62,500, latitude and longitude lines being represented by border lines as shown.

- Denotes one inch spaces on border line of original tracing.