

WW-7
8-30-06



West Virginia Department of Environmental Protection
Office of Oil and Gas
WELL LOCATION FORM: GPS

API: 47-097-00124 WELL NO.: WV 607846 (Allman #2-7846)

FARM NAME: Eva C. Allman, et al.

RESPONSIBLE PARTY NAME: EQT Production Company

COUNTY: Upshur DISTRICT: Buckhannon

QUADRANGLE: Berlin 7.5'

SURFACE OWNER: Charles R. & Jean S. Marks

ROYALTY OWNER: EQT Production Company, et al.

UTM GPS NORTHING: 4317926

UTM GPS EASTING: 562163 GPS ELEVATION: 452 m (1484 ft)

The Responsible Party named above has chosen to submit GPS coordinates in lieu of preparing a new well location plat for a plugging permit or assigned API number on the above well. The Office of Oil and Gas will not accept GPS coordinates that do not meet the following requirements:

1. Datum: NAD 1983, Zone: 17 South, Coordinate Units: meters, Altitude: height above mean sea level (MSL) – meters.
2. Accuracy to Datum – 3.05 meters
3. Data Collection Method:

Survey grade GPS : Post Processed Differential
Real-Time Differential

Mapping Grade GPS X: Post Processed Differential X
Real-Time Differential

RECEIVED
Office of Oil and Gas

4. Letter size copy of the topography map showing the well location

I the undersigned, hereby certify this data is correct to the best of my knowledge and belief and shows all the information required by law and the regulations issued and prescribed by the Office of Oil and Gas.

Signature

PS#2180
Title

11/19/15
Date

Topo Quad: Berlin 7.5'

Scale: 1" = 2000'

County: Upshur

Date: November 2, 2015

District: Buckhannon

Project No: 39-09-00-09

47-097-00124 WV 607846 (Allman #2-7846)

Topo

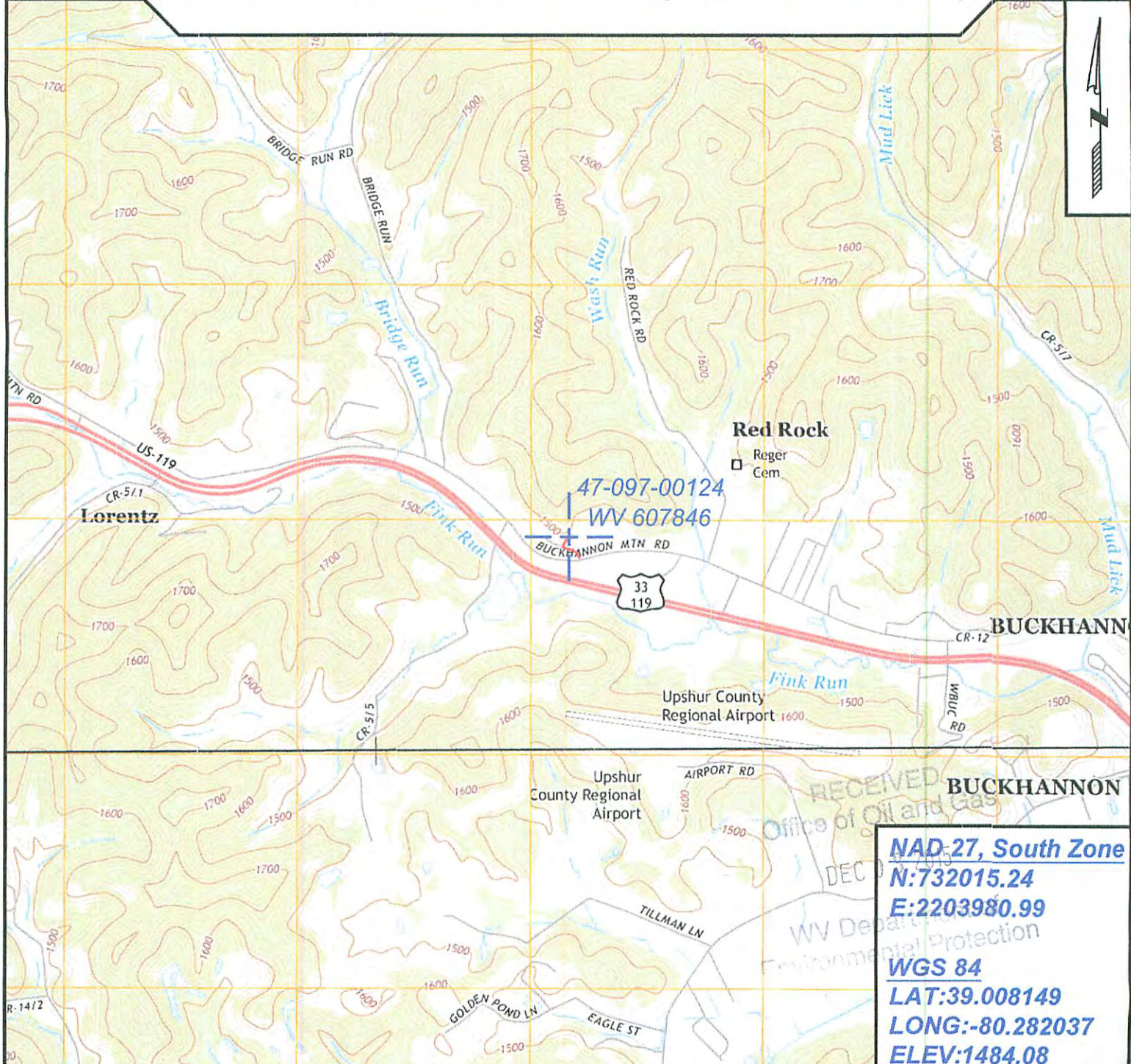

RECEIVED
Office of Oil and Gas
DEC 15 2015
WV Department of Environmental Protection

NAD-27, South Zone
N:732015.24
E:2203980.99
WGS 84
LAT:39.008149
LONG:-80.282037
ELEV:1484.08



SURVEYING AND MAPPING SERVICES PERFORMED BY:
ALLEGHENY SURVEYS, INC.
 1-800-482-8606
 237 Birch River Road
 Birch River, WV 26610
 PH: (304) 649-8606
 FAX: (304) 649-8608

PREPARED FOR:
EQT Production Company
 P.O. Box 280
 Bridgeport, WV 26330
01/08/2016