

LATITUDE 38°25'

LONGITUDE 82°30'



7'5 OGIS topo location

7.5' loc 242
0.34

15' loc 242
(calc.) 0.34

Company _____

Farm _____

Quad Cstletsburg / Cerda

County Wayne El

District Watmore land

WELL LOCATION MAP

File No. Way-74

Plat showing proposed location of
GAS WELL
 on Spring Valley Country Club 115 Ac Tr.
 The Hamilton Co. (Cincinnati, Ohio) A Corporation, Owners.
 Huntington, West Va.

Scale: 1" = 500' 23rd March, 1934 Engineering Service Co.

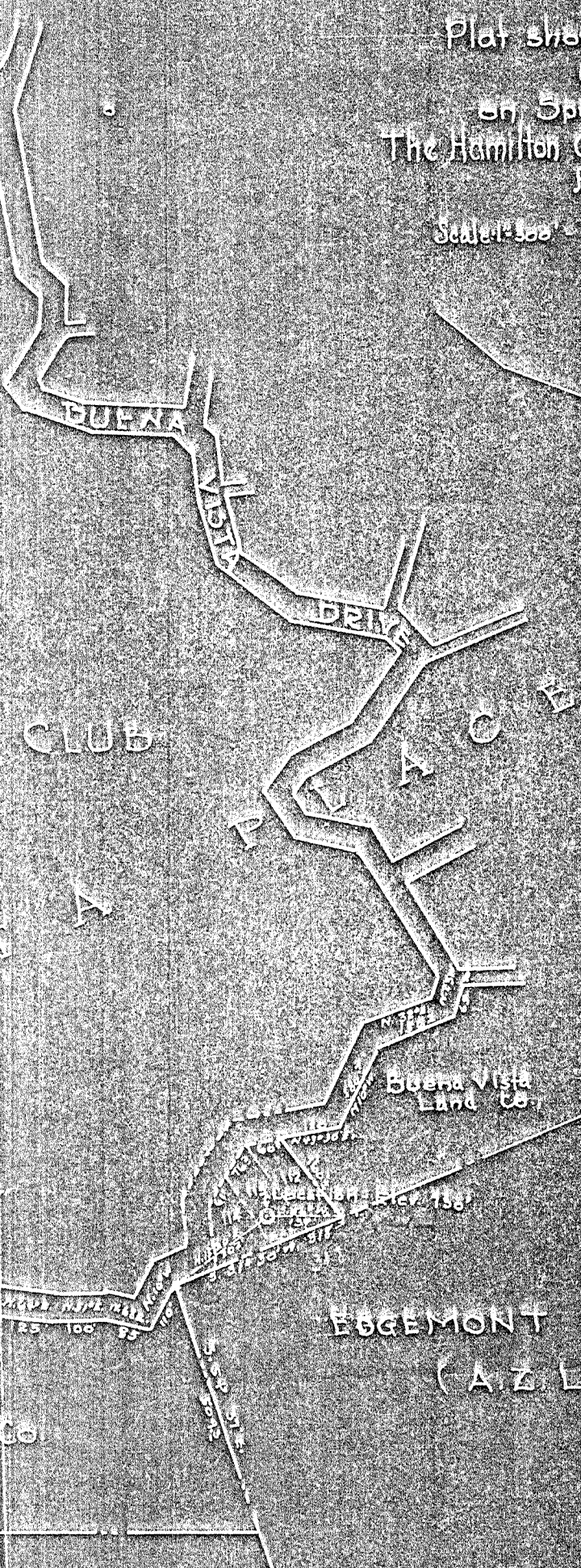

ENGINEER'S CERTIFICATE

I, the undersigned hereby certify that this map is correct and shows all the information to the best of my knowledge and belief, required by the Oil and Gas Section of the Mining Laws of West Virginia.

[Handwritten Signature]

STATE OF WEST VIRGINIA

COUNTY OF MASON

TO WIT

Acknowledged before me a Notary Public, in and for the State and County aforesaid this the 30th day of March, 1934.

My Commission Expires

January 25th 1942

Rose Lyttle
 Notary Public

EDGE MONT ADDITION

(A. Z. LITZ)

WAY-74

PIEDMONT HEIGHTS SUB-DIVISION

SPRING VALLEY COUNTRY

GOLF COURSE

110 Ac.

BUENA VISTA

BUENA VISTA DRIVE

Buena Vista Land

Map 74

WEST VIRGINIA DEPARTMENT OF MINES

OIL AND GAS DIVISION

PRELIMINARY DATA SHEET NO. 1

WAY - 74

File No. _____ Well No. 1

J. F. Wilson Company of Huntington W. Va

on the Hamilton Land Co. Farm

containing 120 acres. Location Spring Valley Country Club

Ceredo District, in Wayne County, West Virginia

The surface of the above tract is owned in fee by The Hamilton Land Co.

of Cincinnati Ohio address, and the mineral rights are owned by The Hamilton Land Co. of Cincinnati Ohio

The oil and gas privileges are held under lease by the above named company, and this well is drilled under permit No. _____ issued by the West Virginia Department of Mines, Oil and Gas Division

_____ 193 _____

Elevation of surface at top of well, _____ Spirit Barometric.

The number of feet of the different sized casings used in the well.

_____ 35 feet _____ 10 da size. Wood conductor.

470 feet _____ 8 1/4 in size, csg. _____ 1485 feet _____ 6 5/8 in sized csg.

_____ feet _____ size, csg. _____ feet _____ sized csg.

_____ feet _____ size, csg. _____ feet _____ sized csg.

_____ None packer of _____ size, set at _____

_____ packer of _____ size, set at _____

_____ in casing perforated at _____ feet to _____ feet.

_____ in casing perforated at _____ feet to _____ feet.

Coal was encountered at _____ None feet, thickness _____ inches, and at _____

feet; thickness _____ inches; and at _____ feet; thickness _____ inches.

Liners were used as follows: (Give details) _____ None

July 9 - 1934 Date.

Approved J. F. Wilson, Owner.

By _____ (TITLE)

WAG-74

Spring Valley Well No.1 Drilled on
Hamilton Company Land on
Crouts Creek, Wayne County, W. Va.

| | <u>Top</u> | <u>Bottom</u> |
|----------------|------------|---------------|
| Slate | 20 | 75 |
| Sand | 75 | 100 |
| Slate | 100 | 125 |
| Sand | 125 | 140 |
| Slate | 140 | 220 |
| Sand | 220 | 250 |
| Slate | 250 | 275 |
| Sand | 275 | 345 |
| Slate | 345 | 425 |
| Shells & Slate | 425 | 450 |
| Sand | 450 | 470 |
| Slate | 470 | 490 |
| Salt Sand | 490 | 660 |
| Slate | 660 | 670 |
| Coal | 670 | 675 |
| Slate | 675 | 690 |
| Sand | 690 | 740 |
| Slate | 740 | 790 |
| Sand | 790 | 820 |
| Slate & Shells | 820 | 885 |
| Sand | 885 | 925 |
| Slate | 925 | 995 |
| Sand | 995 | 1095 |
| Slate | 1095 | 1120 |
| Lime | 1120 | 1140 |
| Maxton Sand | 1140 | 1240 |
| Big Lime | 1240 | 1312 |
| Injun Sand | 1312 | 1355 |
| Black Lime | 1355 | 1385 |
| Slate | 1385 | 1395 |
| Sand Wier | 1395 | 1440 |
| Slate & Shells | 1440 | 1700 |
| Slate | 1700 | 1830 |
| Lime Shells | 1830 | 1860 |
| Brown Shale | 1860 | 1905 |
| Berea Grit | 1905 | 1918 |
| White Slate | 1918 | 1931 |
| Hard Shells | 1931 | 1943 |

1905
205
1885

W.M.J. - 74

| | <u>Top</u> | <u>Bottom</u> | |
|-------------|------------|---------------|-----------------------|
| White Slate | 1943 | 1992 | |
| Brown Shale | 1992 | 2100 | Gas in Shale at 2002' |
| White Slate | 2100 | 2270 | |
| Brown Shale | 2270 | 2510 | Gas increase at 2380' |
| White Slate | 2510 | 2530 | " " " 2545' |
| Brown Shale | 2530 | 2550 | " " " 2588' |
| White Slate | 2550 | 2560 | |
| Brown Shale | 2560 | 2600 | |
| White Slate | 2600 | 2610 | |
| Brown Shale | 2610 | 2695 | |
| White Slate | 2695 | 2755 | |
| Brown Shale | 2755 | 2765 | |
| White Slate | 2765 | 2860 | |
| Brown Shale | 2860 | 2894 | |
| Corniferous | 2894 | | |
| Total Depth | 2894 | | |

461

Casing Record:

| | |
|-------------------|---------|
| 10" 24# Casing | 35 feet |
| 8-1/4" " | 470 " |
| 6-5/8" 17# Casing | 1483 " |