

38° 12' 30"

2 3

LATITUDE 38° 15'

LONGITUDE 82° 20'

82 22' 30"

75.64 S
1.94 W

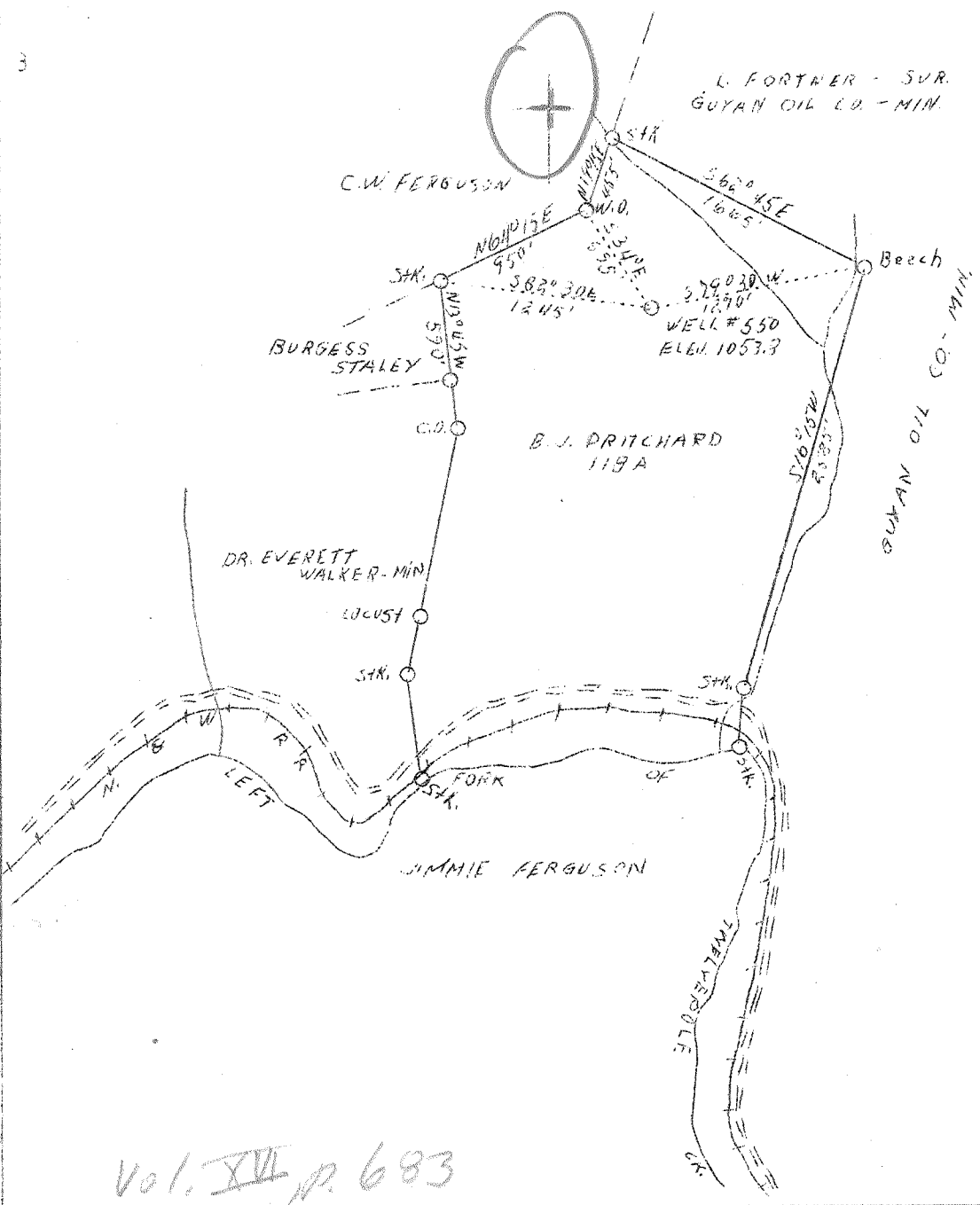

3.4 S
4.3 W

Vol. IV, p. 683

Company	Owens Libbey-Owens Gas Dept
Address	Box 1375 Charleston, W. Va.
Farm	B. J. Pritchard
Tract	Acres 118 Lease No. 1455
Well (Farm) No.	1 Serial No. 550
Quadrangle	Wayne <i>NC</i>
County	Wayne
District	Stonewall
Engineer	T. S. Flournoy
Engineer's Registration No.	269
File No.	Drawing No.
Date	May 12, 1933 Scale 1" = 1000'

STATE OF WEST VIRGINIA
 DEPARTMENT OF MINES
 OIL and GAS DIVISION
 CHARLESTON
 WELL LOCATION MAP

FILE NO. WAY-137

* Senotes location of well on United States Topographic Maps, scale 1 to 62,500, latitude and longitude lines being represented by border line as shown.

- Denotes one inch spaces on border line of original tracing.

Sample (MZ 180) (1647-3428) Deep Well

B. J. PRICHARD NO. 1 (550) WELL.

Stonewall District, Wayne County, W. Va.

By The Owens, Libbey-Owens Gas Dept., Box 1375, Charleston, W. Va.

Located 4.3 mi. W. of 82° 20' and 3.44 mi. S. of 38° 15' - NC - Wayne Quadrangle;
2.5 mi. S. E. of Wayne.

Elevation, 1054' L.

Starts about 130 feet below Pittsburgh Coal horizon.

Permit Way-137.

Drilling commenced June 2, 1938; completed, July 15, 1938.

Shot July 13, 1938, at 2605-3435'.

Gas well. Volume, 366,000 cu.ft.

Rock pressure, Injun, 320 lbs. per sq. in.; Shale, 542 lbs. per sq. in. in 24 hrs.

Fresh water at 126 and 629'; salt water at 1080'.

Coal was encountered at 653-657'.

13" casing, 11'; 8 1/4", 678'; 6 3/8", 1482'; 2" tubing, 3441'; 5 1/2" liner, 926'.

Spang Comb. wall-anchor packer, set at 1735'.

The thickness of the Greenbrier is probably more than ^{the} 153 feet given in the driller's record. The only sample of this formation is from the bottom.

The thickness of the other formations given below are probably correct.

Martens' record from samples.

Top. Bottom. Thickness.

			GREENBRIER LIMESTONE, 153 FEET
1494 - 1545	51	Big Lime, yellow, hard	
1545 - 1642	97	Big Lime, white, hard (gas, 1589', 84,000 cu. ft.; blew out in 24 hrs; oil show, 1625')	
1642 - 1647	6	Anhydrite, white, fine, 50%; brown dolomite or strongly dolomitic limestone, 50%	
			MACCRADY FORMATION, 20 FEET
1647 - 1667	20	Siltstone, dark-red	
			POCONO FORMATION, 592 FEET
1667 - 1693	26	Sandstone, gray, very fine	
1693 - 1695	2	Shale, dark-gray	
1695 - 1731	36	Sandstone, light-gray, fine (gas, 1709', 80,000 cu. ft.; gas, 1723', 166,000 cu. ft.)	
1731 - 1735	4	No sample (reported as soft gray sand)	
1735 - 1743	8	Siltstone, gray, shaly	
1743 - 2132	389	No samples (reported as gray slate and shells)	
2132 - 2147	15	No samples (reported as soft gray slate)	
2147 - 2176	29	No samples (reported as hard sand shells)	
2176 - 2234	58	No samples (reported as dark slate and shales)	
2234 - 2245	11	Shale, black (Sunbury Shale)	
2245 - 2248	3	Sandstone, nearly white, fine; very pyritic at top (Berea Sandstone, 2245-2259')	
2248 - 2253	5	Shale, light-gray, micaceous, 70%; light-gray, very fine sandstone, 30%	
2253 - 2259	6	Sandstone, light-gray, very fine, 60%; gray micaceous shale, 40%	
			DEVONIAN SHALES, 1176 FEET
2259 - 2268	9	Shale, gray, 60%; light-gray siltstone and very fine sandstone, 40%	
2268 - 2295	27	No samples (reported as soft gray slate)	
2295 - 2301	6	Sandstone, light-brown and gray, very fine; almost a siltstone	
2301 - 2334	33	No samples (reported as light hard shell)	
2334 - 2344	10	No samples (reported as soft brown slate)	
2344 - 2439	95	Shale, very dark brownish gray to black; mostly silty and micaceous	
2439 - 2485	46	No samples (reported as soft light slate)	

(OVER)

B. J. PRICHARD NO. 1 (550) WELL (Continued).

Top.	Bottom.	Thickness.	
2485	- 2672	187	No samples (reported as gray slate and shells)
2672	- 2680	8	No samples (reported as soft gray slate)
2680	- 2698	18	Shale, about half dark- and half medium-gray
2698	- 2769	71	Shale, dark brownish gray to black
2769	- 2809	40	Shale, medium- to dark-gray
2809	- 2825	16	Shale, very dark gray
2825	- 2841	16	Shale, medium- to dark-gray
2841	- 2927	86	Shale, dark-gray to very dark gray, somewhat brownish (gas, 2903', 6,000 cu. ft.)
2927	- 2964	37	Shale, medium-gray, 50 to 70%; very dark gray to black, 50 to 30% (gas, 2935-2964', 22,000 cu. ft.)
2964	- 3058	94	Shale, very dark gray to black, mostly somewhat brownish (gas, 3010', 5,000 cu. ft.)
3058	- 3158	100	Shale, black; small brown spores in some samples in this interval (gas, 3150', 10,000 cu. ft.)
3158	- 3238	80	Shale, gray
3238	- 3251	13	Shale, very dark gray
3251	- 3261	10	No samples (reported as soft white slate)
3261	- 3270	9	Shale, gray
3270	- 3300	30	No samples (reported as soft white slate)
3300	- 3310	10	Shale, gray
3310	- 3367	57	Shale, grayish-green
3367	- 3380	13	Shale, gray
3380	- 3435	55	Shale, very dark gray to black; numerous spores at base of shale (gas, 3388', 6,000 cu. ft.)
			HELDERBERG LIMESTONE (?), 3 FEET
3435	- 3438	3	Limestone, gray to brown, cherty, somewhat dolomitic
	3438		Total depth

WEST VIRGINIA DEPARTMENT OF MINES

OIL & GAS DIVISION

WELL RECORD

Permit No. Way-137

Gas Well

Wayne Quad.

CASING & TUBING

Company	The Owens, Libbey-Owens Gas Dept.,	13"	11'	11'
Address	P. O. Box 1375, Charleston, W. Va.	8-1/4	678	678
Farm	B. J. Pritchard Acres 118	6-5/8	1482	1482
Location	Twelve Pole Creek	2	3441	3441
Well No.	550 Elev. 1054'	5 1/2	Liner 926	926
District	Stonewall County Wayne	Perforated		
Surface & Mineral	B. J. Pritchard, Wayne, W. Va.	PACKER:		
Drilling commenced	June 2, 1938	Kind - Spang Comb. Well		
Drilling completed	July 15, 1938	Anchor		
Date shot	July 13, 1938 - Depth 2605-3435'	Size - 6-5/8"x2"		
Open Flow	10/10ths Water in 2" Injun Sand	Depth set - 1735		
	31/10ths Water in 2" Shale	Perf. top - 3404		
Volume	366,000 c. f.	" bottom - 3409		
Rock Pressure	Injun 320#, Shale 542# 48 hrs.	" top - 3432		
Fresh Water	126 - 629'	" bottom - 3437		
Salt Water	1080'			

COAL ENCOUNTERED:
653 ft. 48 inches

Formation	Color	HT	Top	Base	Result	Formation	Color	HT	Top	Base	Result
Surface	red	s	0	10		Slate & Shells	gr.	s	2421	2437	
Sand	red	s	10	13		Slate	light	s	2437	2485	
Clay	blue	s	13	50		Slate & Shells	gr.	s	2485	2516	
Sand	yel.	s	50	75		Slate & Shells	"	h	2516	2541	
Clay	gray	s	75	117		Slate & Shells	"	s	2541	2672	
Clay	yel.	s	117	132		Slate	gray	s	2672	2680	
Slate	gray	s	132	152		Shale	brown	s	2680	2809	
Clay	red	s	152	195		Shale broken	brown	s	2809	2857	
Slate	white	s	195	235		Shale	brown	s	2857	3167	
Clay	light	s	235	275		Slate	white	s	3167	3381	
Slate	dark	s	275	411		Shale	brown	s	3381	3435	
Clay	dark	s	411	425		Corniferous Lime Dr.	h		3435	3438	
Sand	white	s	425	559		Total Depth				3438	
Slate	dark	s	559	653							
Coal	black	s	653	657		Water-Fresh	126'	Little			
Slate	black	s	657	678		Fresh Water	629	3 bails. per hr.			
Sand	white	s	678	793		Salt Water	1080'	Hole full			
Slate	dark	s	793	861							
Sand	gray	s	861	884		Gas	1051'	show			
Slate	dark	s	884	910		"	1589	84,000	blew out in 24 hrs.		
Sand	white	s	910	950		"	1709	84,000			
Slate	dark	s	950	1028		"	1723	166,000			
Salt Sand	gray	s	1028	1073		"	2903	6,000			
Salt sand	white	s	1073	1362		"	2935-64	22,000			
Slate	light	s	1362	1398		"	3010	5,000			
Red Rock	red	s	1398	1408		"	3150	10,000			
Slate	light	s	1408	1420		"	3388	6,000			
Little Lime	dark	h	1420	1451							
Big Lime	white	h	1451	1494		Oil	1625'	show			
Big Lime	yel.	h	1494	1545							
Big Lime	white	h	1545	1647							
Injun Sand	red	s	1647	1667							
Injun Sand	gray	h	1667	1693							
Slate	gray	s	1693	1695							
Sand	gray	s	1695	1741							
Slate & Shells	"	s	1741	2132							
Slate	gray	s	2132	2147							
Sand & Shells	dark	h	2147	2176							
Slate & "	dark	s	2176	2234							
Brown Shale		s	2234	2245							
Berea Sand	gray	h	2245	2259							
Slate	dark	s	2259	2268							
Slate & Shells	lt.	h	2268	2295							
Shell	light	h	2295	2334							
Slate	brown	s	2334	2344							
Shale	brown	s	2344	2421							