

SM

LATITUDE 38° 15'

LONGITUDE 82° 20'

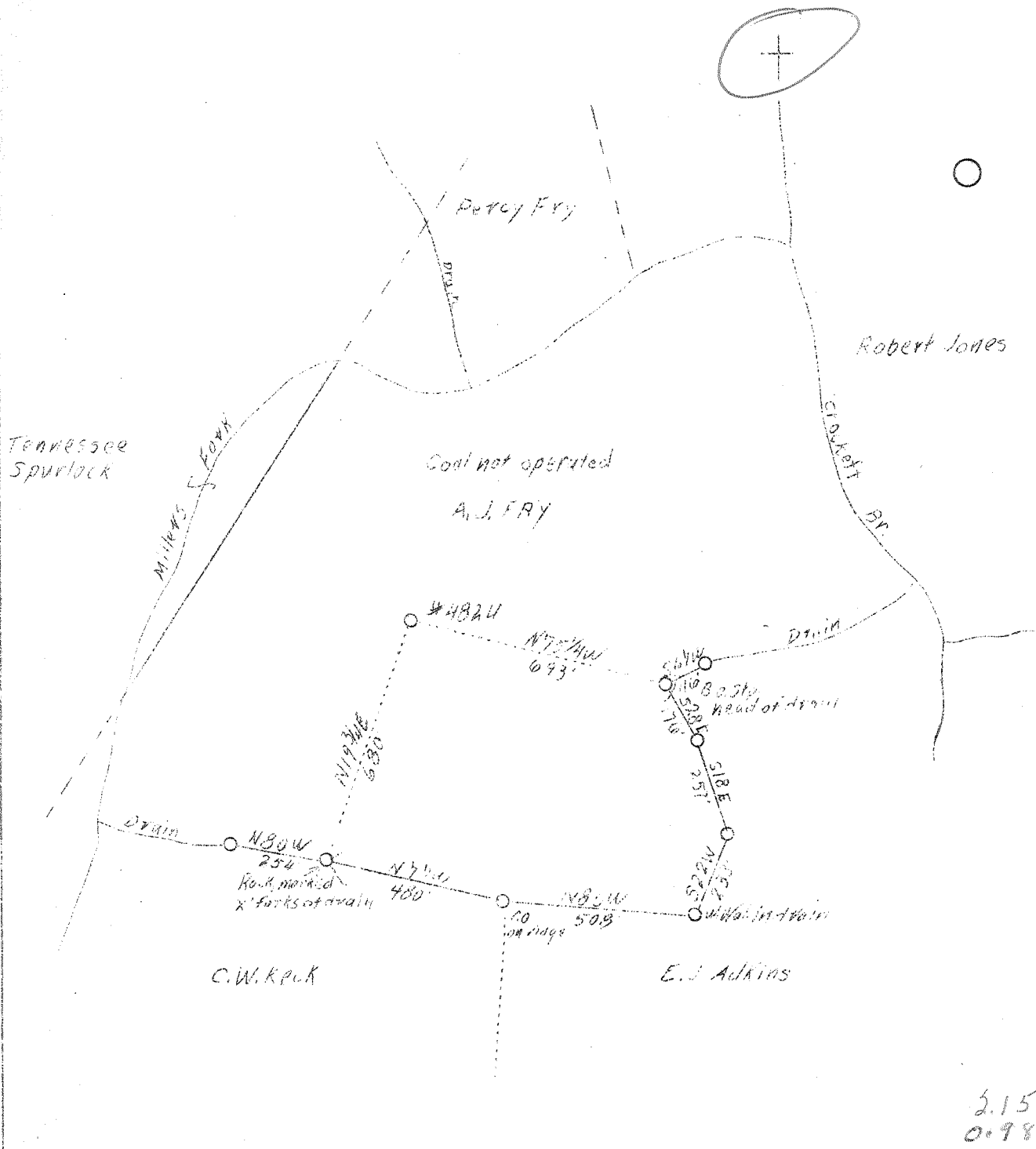

2.15 W  
0.98 S

New location

Company	United Fuel Gas Co.
Address	Charleston, W. Va.
Farm	A. J. Fry
Acres	55.5
Lease No.	39491
Well (Farm) No.	One
Serial No.	4824
Elevation (SP)	-
Quadrangle	Wayne <i>n.e. Wc</i>
County	Wayne
District	Union
Engineer	G. A. Cunningham
Eng. Reg. No.	659
File No.	20 - 51
Date	Nov. 18, 1938
Scale	1" - 400'

STATE OF WEST VIRGINIA  
 Department of Mines  
 OIL & GAS DIVISION  
 Charleston

WELL LOCATION MAP

File No. Way-149

x Denotes location of well on U. S. Topographic Maps, scale 1 to 62,500; latitude and longitude lines being represented by border lines as shown.

- Denotes one inch spaces on border line of original tracing.

Deepwell

WEST VIRGINIA DEPARTMENT OF MINES

OIL & GAS DIVISION

WELL RECORD

Gas Well

Permit No. Way-149

CASING & TUBING

Wayne Quad.

Company United Fuel Gas Co.  
 Address Charleston, W. Va.  
 Farm A. J. Fry ACRES 55.5  
 Location Millers Fork  
 Well No. 4824 ELEV. 820  
 District Union - Wayne County  
 Surface & Mineral A. U. Fry, Wayne, W. Va.  
 Drilling commenced Dec. 17, 1938  
 Drilling completed Feb. 4, 1939  
 Date shot 2/7/39 - Depth 2581  
 Open Flow 12/10ths Water in 2 inch  
 Volume 146,000 c.f.  
 Rock Pressure 415 lbs. 48 hrs.  
 Water -

8-1/4 528 528  
 6-5/8 1317 1317

COAL ENCOUNTERED:  
 487' 96"

Formation Color Hor Top Base Result Formation Color Hor Top Base Result

Formation	Color	Hor	Top	Base	Result	Formation	Color	Hor	Top	Base	Result
Surface			0	12							
Sand			12	40							
Slate			40	140							
Sand			140	160							
Slate			160	265							
Sand			265	320							
Sand			320	425							
Slate			425	450							
Sand			450	487							
Coal			487	495							
Sand			495	560							
Slate			560	600							
Sand			600	680							
Slate			680	730							
Broken Sand			730	900							
Slate			900	910							
Salt Sand			910	1025							
Slate			1025	1070							
Sand			1070	1150							
Slate			1150	1180							
Mixon Sand			1180	1205							
Slate&Shells			1205	1252							
Little Lime			1252	1280							
Pencil Crave			1280	1285							
Big Lime			1285	1450							
Slate&Shells			1450	1490							
Injun Sand			1490	1550							
Slate&Shells			1550	1710							
Shell			1710	1740							
Break			1740	1750							
Shell			1750	1790							
Slate&Shells			1790	2055							
Brown Shale			2055	2065							
Berea Sand			2065	2075							
Slate			2075	2078							
Shell			2078	2120							
Slate			2120	2165							
Brown Shell			2165	2240							
Slate			2240	2570							
Brown Shale			2570	2625							
Slate			2625	2670							
Light Brown Shale			2670	2715							
Brown Shale			2715	3015	Gas 2770'						
White Slate			3015	3237	Gas 2780'						
Brown Shale			3237	3321							
Corniferous Lims			3321								
Total Depth				3321							

3321  
 820  
 -----  
 2501

910

2770  
 2780