

LATITUDE 38° 15'

LONGITUDE 82° 20'

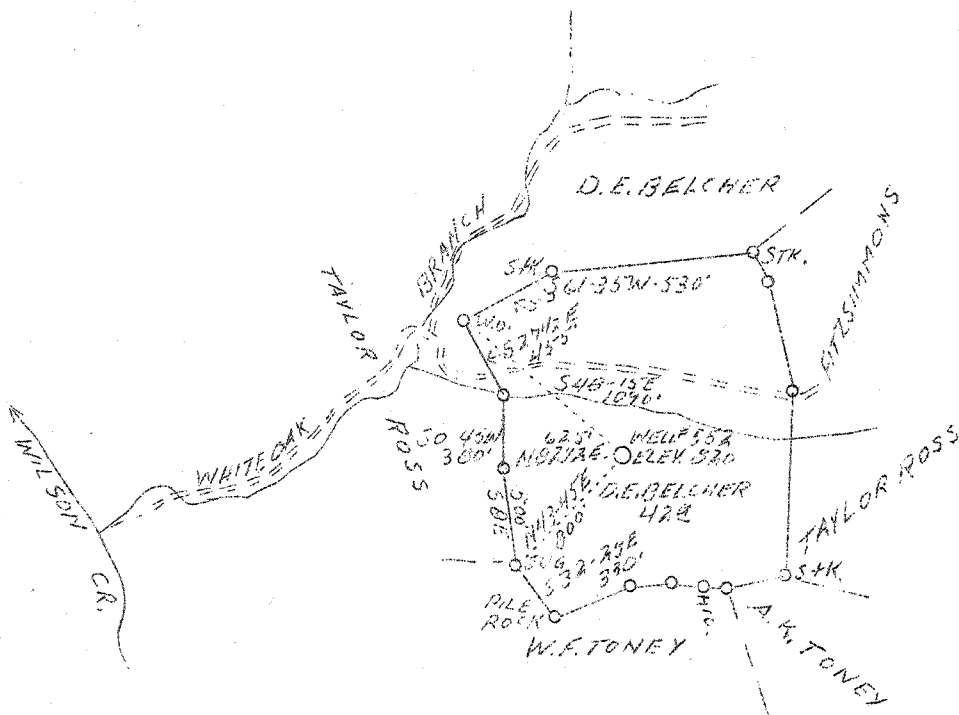

4.13 W
2.15 S

ABD
11/46

Vol. IV, p. 689

Company	The Owens, Libbey-Owens Gas Dept.	STATE OF WEST VIRGINIA Department of Mines OIL AND GAS DIVISION Charleston WELL LOCATION MAP FILE NO. <u>Way-157</u> x Denotes location of well on U.S. Topographic Maps, scale 1 to 62,500, latitude and longitude lines being represented by border lines as shown. - Denotes one inch spaces on border line of original tracing.
Address	Box 1375 Charleston, W.Va.	
Farm	Virgin Belcher et al	
Acres	42	
Lease No.	1504	
Serial No.	552	
Well (Farm) No.	1	
El. (S.L.)	820	
Quadrangle	Wayne <i>N.C. N.C.</i>	
District	Union	
County	Wayne	
Eng.	T.S. Flourney	
Eng. Reg. No.	269	
Date	5/8/39	
Scale	1" = 1000'	

Sample (No. 278) (2440-3513) Deep Well

WEST VIRGINIA DEPARTMENT OF MINES

OIL & GAS DIVISION

WELL RECORD

Permit No. Way-157

Wayne Quad.

Gas Well

CASING & TUBING

Company	The Owens, Libbey-Owens Gas Dept.,	8-1/4	454	454
Address	Box 1375, Charleston, W. Va.	6-5/8	1293	1293
Farm	Virgin Belcher, et al ACRES 42	3	2968	2968
Location	Wilson Creek			
Well No.	552 ELEV. 820			
District	Union - Wayne County			Packer - Hooper HookWall
Surface & Mineral	Virgin Belcher et al			Size - 3 x 6-5/8
Address	Fort Gay, W. Va.			Depth set - 2118 to 2123
Commenced	May 18, 1939			Perf. top - 2240
Completed	July 17, 1939			" bot. - 2968
Shot	7/3/39 - Depth 2424-3212			
Open Flow	4/10ths Water in 1" - Injun & Berea			COAL AT:
	3/10ths Water in 2" - Dev. Shale			68' 36"
				408' 48"
Volume	94,000 c.f.			
Rock Pressure	Berea & Injun 439 lbs. 24 hrs.			
	Shale - lbs. - 24 hrs.			Salt Water 845 & 895

Formation Color		H	TOP	Base	Result	Formation Color	H	TOP	Base	Result	
Surface	yel	s	0	10		Shell	gr	s	2708	2715	
Slate	wh	s	10	58		Shale	brn	s	2715	2936	G 2777
Sand	wh	s	52	68							6,000 cf
Coal	blk	s	68	71		Slate	lgt	s	2936	3180	G 2927
Slate	wh	s	71	123							3,000 cf
Sand	wh	s	123	145		Shale	brn	s	3180	3212	G 3038
Slate	drk	s	145	200							6,000 cf
Sand	wh	s	200	264		Corniferous	Lime drk h	3212	3216		
Slate	wh	s	264	268		Total Depth			3216		
Sand	wh	s	268	408		Filled up			3212		
Coal	blk	s	408	412							
Slate	wh	s	412	463							
Sand	wh	s	463	503							
Slate	drk	s	503	525							
Slate&Shells	drk	s	525	638							
Sand	wh	s	638	680							
Slate	drk	s	680	687							
Sand	drk	s	687	722							
Slate&Shells	drk	s	722	775							
Salt Sand	wh	s	775	919	SW 845						
					Gas 850	show					
					SW 895	hole full					
Salt Sand	wh	h	919	1156							
Red Rock	red	s	1156	1159							
Slate	drk	s	1159	1196							
Little Lime	blk	h	1196	1235							
Big Lime	wh	h	1235	1293							
Big Lime	wh	h	1293	1300							
Big Lime	yel	h	1300	1382							
Big Lime	drk	h	1382	1404							
Injun Sand	pink	s	1404	1456	Gas 1441	8,000 c.f.					
Slate&Shells	drk	s	1456	1920							
Shell	drk	h	1920	1940							
Slate	drk	s	1940	1951							
Slate&Shells	drk	s	1951	2001							
Brown Shale	brn	s	2001	2012							
Berea Sand	gr	h	2012	2033	Gas 2018-2023	42,000 c.f.					
Shells	blk	h	2033	2060							
Shells	drk	h	2060	2085							
Slate	wh	h	2109	2120							
Shale	brn	s	2120	2187							
Slate&Shells	drk	s	2187	2326							
Slate&Shells	lgt	s	2326	2364							
Slate&Shells	drk	s	2364	2440							
Shells	drk	h	2440	2445							
Shale	brn	s	2445	2565							
Slate&Shells	lgt	s	2565	2572							
Shale	brn	s	2572	2708							

3212
820
2392

1156
775
381

775

2018
2023
42,000

2708
2572
2440