



STATE OF WEST VIRGINIA
DEPARTMENT OF MINES
OIL AND GAS DIVISION

NOTICE OF PROPOSED LOCATION OF OIL AND GAS WELL

To THE DEPARTMENT OF MINES,
Charleston, W. Va.

Ed Workman, et al.
COAL OPERATOR OR COAL OWNER

Wayne, W. Va.
ADDRESS

COAL OPERATOR OR COAL OWNER

ADDRESS

OWNER OF MINERAL RIGHTS

ADDRESS

Owens, Libbey-Owens Gas Department
NAME OF WELL OPERATOR

Box 4158, Charleston 4, W. Va.
COMPLETE ADDRESS

March 8, 19 55
PROPOSED LOCATION

Butler District

Wayne County

Well No. 2 (920) 38° 15' 82° 25'

G. W. Workman Farm

GENTLEMEN:

The undersigned well operator is entitled to drill upon the above named farm or tract of land for oil and gas, having fee title thereto, (or as the case may be) under grant or lease dated April 15, 1929

, made by Ed Workman, et al, to

Owens Bottle Co. & Libbey-Owens Sheet Glass Co. and recorded on the 4th day of June, 1929 (Now Owens-Illinois Glass Company & Libbey-Owens-Ford Glass Co.)

, in the office of the County Clerk for said County in Book 13, page 362.

The enclosed plat was prepared by a competent engineer and shows the proposed location of a well to be drilled for oil and gas by the undersigned well operator on the farm and in the Magisterial District and County above named, determined by survey and courses and distances from two permanent points, or land marks.

The undersigned well operator is informed and believes there are no coal operators operating beds of coal beneath said farm or tract of land on which said well is located, or within 500 feet of the boundaries of the same, who have mapped their workings and filed their maps as required by law, excepting the coal operators or coal owners (if any) above named as addressees.

The above named coal operators or coal owners (if any) are notified that any objections they may desire to make to such proposed location, or which they are required to make by Section 3 of said Code, if the drilling of a well at said proposed location will cause a dangerous condition in or about their respective coal mines, must be received by, or filed with the Department of Mines within ten* days from the receipt of a copy of this notice and accompanying plat by said Department. Said coal operators are further notified that forms for use in making such objections will be furnished to them by the Department of Mines promptly on request and that all such objections must set forth as definitely as is reasonably possible the ground or grounds on which such objections are based and indicate the direction and distance the proposed location should be moved to overcome same.

(The next paragraph is to be completed only in Department's copy.)

Copies of this notice and the enclosed plat were mailed by registered mail, or delivered to the above named coal operators or coal owners at their above shown respective address ~~day~~ before, ~~or~~ on the same day with the mailing or delivery of this copy to the Department of Mines at Charleston, West Virginia.

Very truly yours,

OWENS, LIBBEY-OWENS GAS DEPARTMENT
WELL OPERATOR
Box 4158
STREET
Charleston 4,
CITY OR TOWN
West Virginia
STATE

02/09/2024

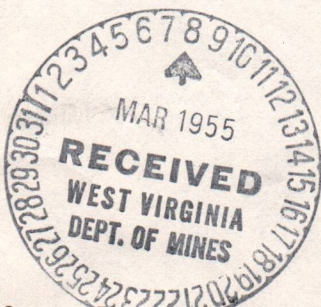

Address of Well Operator }

*Section 3 If no such objections be filed or be found by the department of mines, within said period of ten days from the receipt of said notice and plat by the department of mines, to said proposed location, the department shall forthwith issue to the well operator a drilling permit reciting the filing of such plat, that no objections have been made by the coal operators to the location, or found thereto by the department, and that the same is approved and the well operator authorized to proceed to drill at said location.

Formation	Color	Hard or Soft	Top 10	Bottom	Oil, Gas or Water	Depth Found	Remarks
Slate	Dark	Soft	1924	1950			
Sl. & Shells	Dark	Soft	1950	2050			
Shells	Dark	Soft	2050	2065			
Slate	Dark	Soft	2065	2084			
Sl. & Shells	Dark	Soft	2084	2107			
Slate	Dark	Soft	2107	2125			
Shells	Dark	Soft	2125	2140			
Sl. & Shells	Dark	Hard	2140	2168			
Shells	Dark	Hard	2168	2187			
Slate	White	Soft	2187	2198			
Shale	Brown	Soft	2198	2218			
							Ran 7" casing at 2218 on shoe.
							Casing cemented in by Halliburton Co.
							Used floating shoe, 10 sacks aquagel,
							25 sacks cement.
							Pipe did not go back to bottom after
							running cement. Stopped 27" up hole.
Br. Shale	Brown	Soft	2218	2233			
Berea	Grey	Hard	2233	2244			
Black Lime	Black	Hard	2244	2246	Gas 2237		19.3 M
					Gas 2241		100M
							S.D. Waiting on fracture treatment
							R.P. 605# in 24 hours
							5-18-55 Hydrafrac treated by Hallibur-
							ton Co. used 90 bbl. crude oil.
							20 bbl. Breaker Fluid (crude oil with
							breaking agent & treating acid)
							1600 gal. Kerosene with Gel. agent.
							3000# sand. Crude oil to flush approx.
							20 bbl.
							5-25-55 Swabbed to bottom
							Well open 8 hrs., gas tested 193 MCF.
							Shut well in.
							5-26-55 R.P. 604# in 22 hrs.
							Blew well 1 hour. Gas tested 239 MCF.
							5-27-55 R.P. 598# in 17 hrs.
							Drilled pocket 2246 - 2239.
							Well open 7½ hrs. Gas tested 237 MCF.
							Shut well in.
							5-31-55 Well opened. Cleaned out.
							Ran 3½" tubing with one perforated
							joint on bottom. No packer. Tubing
							suspended on 7" casinghead. Well open
							10 hours - final open flow 251 MCF.
Berea Sand	White	Hard	2246	2259			
							Total Depth
							2259

02/09/2024

Date June 9, 1955

APPROVED OWENS, LIBBEY-OWENS GAS DEPARTMENT, Owner

By G. H. Smith (Title) Geologist



DEPARTMENT OF MINES
OIL AND GAS DIVISION

WELL RECORD

Quadrangle Wayne

Permit No. May-958

02/09/2024

Company OWENS, LIBBEY-OWENS GAS DEPARTMENT

Address P. O. Box 4158, Charleston 4, W. Va.

Farm G. W. Workman

Acres 600

Location (waters) Well No. 2 (Serial #920)

Elev. 1027.11

District Butler

County Wayne

The surface of tract is owned in fee by Ed Workman, Executor

Address Wayne, W. Va.

Mineral rights are owned by Ed Workman, Executor

Address Wayne, W. Va.

Drilling commenced 3-16-55

Drilling completed 5-27-55

Date Shot 5-18-55

From 88 MCF To 251 MCF

Liners Used

2

Perf. top

Perf. bottom 1 ft.

Kind of Packer No packer

Size of 10

Size of 8 5/8

Size of 7

Depth set 2215'6"

Depth set 2255'8"

Perf. top

Perf. bottom

Perf. top

Perf. bottom

With Hydrated

Open Flow /10ths Water in Inch

Volume Cu. Ft.

Rock Pressure 595 lbs.

Oil 24 hrs.

Fresh water 518, 600

Salt water 1115

Formation Red Clay

Red Clay

White

Dark

Soft

Hard

Hard or Soft

Top

Bottom

Oil, Gas or Water

Depth

Remarks

Gas 1715 - 1730 show.

Gas 2237

Gas 2211

Gas 2225

Gas 2225

Gas 2225

Gas 2225

Gas 2225

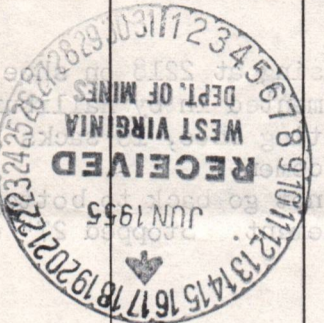

Gas 2237

Gas 2211

Gas 2225

Gas 2225

Gas 2225

Gas 2225

Gas 2225

Gas 2225

STATE OF WEST VIRGINIA
DEPARTMENT OF MINES
OIL AND GAS DIVISION

INSPECTOR'S WELL REPORT

Permit No. Hay-958-

Oil or Gas Well 2-51-920
(KIND)

Company Owens Libby Owens
 Address P.O. Box 4158 Charleston, W. Va.
 Farm G. H. Workman
 Well No. 2-51-920
 District Butler County Wayne
 Drilling commenced _____
 Drilling completed _____ Total depth _____
 Date shot _____ Depth of shot _____
 Initial open flow _____ /10ths Water in _____ Inch
 Open flow after tubing _____ /10ths Merc. in _____ Inch
 Volume _____ Cu. Ft.
 Rock pressure _____ lbs. _____ hrs.
 Oil _____ bbls., 1st 24 hrs.
 Fresh water _____ feet _____ feet
 Salt water _____ feet _____ feet

CASING AND TUBING	USED IN DRILLING	LEFT IN WELL	PACKERS
Size			
16			Kind of Packer _____
13			
10			Size of _____
8 1/4			
6 5/8			Depth set _____
5 3/16			
3			Perf. top _____
2			Perf. bottom _____
Liners Used			Perf. top _____
			Perf. bottom _____

CASING CEMENTED _____ SIZE _____ No. FT. _____ Date _____
 COAL WAS ENCOUNTERED AT _____ FEET _____ INCHES
 _____ FEET _____ INCHES FEET _____ INCHES
 _____ FEET _____ INCHES FEET _____ INCHES

Drillers' Names _____

Remarks: Clifford Mills Contractor

Drilling at 500 feet.

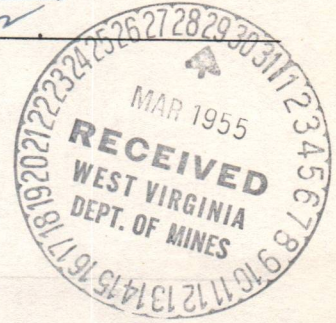

3-18-55
DATE

O. G. Allen
DISTRICT WELL INSPECTOR

STATE OF WEST VIRGINIA
 DEPARTMENT OF MINES
 OIL AND GAS DIVISION
INSPECTOR'S PLUGGING REPORT

Permit No. _____

Well No. _____

COMPANY _____ ADDRESS _____

FARM _____ DISTRICT _____ COUNTY _____

Filling Material Used _____

Liner		Location	Amount	Packer	Location		
PLUGS USED AND DEPTH PLACED			BRIDGES		CASING AND TUBING		
CEMENT-THICKNESS	WOOD-SIZE	LEAD	CONSTRUCTION-LOCATION		RECOVERED	SIZE	LOST

Drillers' Names _____

Remarks: _____

_____ I hereby certify I visited the above well on this date.
DATE

 DISTRICT WELL INSPECTOR

02/09/2024

1.0 API well number: (If not available, leave blank. 14 digits.)	<u>47-099-0958</u>			
2.0 Type of determination being sought: (Use the codes found on the front of this form.)	<u>108</u> Section of NGPA	<u>NA</u> Category Code		
3.0 Depth of the deepest completion location: (Only needed if sections 103 or 107 in 2.0 above.)	<u>NA</u> feet			
4.0 Name, address and code number of applicant: (35 letters per line maximum. If code number not available, leave blank.)	<u>Industrial Gas Corporation</u> Name		<u>009283</u> Seller Code	
	<u>P. O. Box 1473</u>			
	<u>Charleston</u> City	<u>WV</u> State	<u>25325</u> Zip Code	
5.0 Location of this well: [Complete (a) or (b).] (a) For onshore wells (35 letters maximum for field name.)	<u>NA</u> Field Name		<u>WV</u> State	
	<u>Wayne</u> County			
(b) For OCS wells:	<u>NA</u> Area Name		<u>NA</u> Block Number	
	Date of Lease: Mo. Day Yr.		<u>NA</u> OCS Lease Number	
(c) Name and identification number of this well: (35 letters and digits maximum.)	<u>G. W. Workman 2-920</u>			
(d) If code 4 or 5 in 2.0 above, name of the reservoir: (35 letters maximum.)	<u>NA</u>			
6.0 (a) Name and code number of the purchaser: (35 letters and digits maximum. If code number not available, leave blank.)	<u>See Addendum "A"</u> <u>Houdaille Industries, Inc.</u> Name		<u>N/Available</u> Buyer Code	
(b) Date of the contract:	<u>1 2 2 6 7 3</u> Mo. Day Yr.			
(c) Estimated annual production:	<u>2.1</u> MMcf.			
	(a) Base Price (\$/MMBTU)	(b) Tax	(c) All Other Prices [Indicate (+) or (-).]	(d) Total of (a), (b) and (c)
7.0 Contract price: See Addendum "A" (As of filing date. Complete to 3 decimal places.)	<u>1.283</u>	<u>0.051</u>	<u>0.003</u>	<u>1.336</u>
8.0 Maximum lawful rate: (As of filing date. Complete to 3 decimal places.)	<u>2.243</u>	<u>0.302</u>	<u>0.0</u>	<u>2.545</u>
9.0 Person responsible for this application:	<u>William C. Charlton</u> <u>Division Counsel</u> Name Title			
Agency Use Only	<u>William C. Charlton</u> Signature			
Date Received by Juris. Agency <u>Feb 28 1979</u>	<u>02/28/79</u> Date Application is Completed		<u>(304) 342-8166</u> Phone Number	
Date Received by FERC				

WELL DETERMINATION REPORT

PARTICIPANTS:

DATE: OCT 10 1979

BUYER-SELLER CODE

WELL OPERATOR: Industrial Gas Corporation

009283

FIRST PURCHASER: Houdaille Industries, Inc.

OTHER: _____

W. Va. Department of Mines, Oil & Gas Division
 WELL DETERMINATION FILE NUMBER
790228-108-099-0958
 Use Above File Number on all Communications
 Relating to Determination of this Well

*Qualifies as Section 108. stripper well
Robert Lee*

CHECK EACH ITEM AS COMPLETE OR NOTE WHAT IS MISSING

ITEM NO.

- 1 FERC-121 Items not completed - Line No. _____
- 2 IV-1 - Agent William C. Charlton
- 3 IV-2 - Well Permit
- 4 IV-6 - Well Plat
- 5 IV-35- Well Record Drilling Deepening _____
- 6 IV-36- Gas-Oil Test: Gas Only Was Oil Produced? No Ratio _____
- 7 IV-39- Annual Production 2 years
- 8 IV-40- 90 day Production 87 Days off Line: _____
- 9 IV-48- Application for Certification. Complete?
- 10 - 17 IV Form #51 - 52 - 53 - 54 - 55 - 56 - 57 - 58. Complete Affidavit Signed
- 18 - 28 Other: Survey _____ Logs _____ Geological Charts _____ Structure Map _____
 1:4000 Map _____ Well Tabulations _____ Gas Analyses _____
- (5) Date Commenced: 3-16-55
Completed: 5-18-55 Deepened _____
date frac:
- (5) Production Depth: 1715-1730, 2237-41, 2246-2259
- (5) Production Formation: Broken sand, Black Lime, Berea
- (5) ~~Initial Potential:~~ F.O.F.: 251 Mcf
- (5) Static R.P. after frac: 595# - 24 hrs.
- (6) Other Gas Test: _____
- (7) Avg. Daily Gas from Annual Production: 6.3 Mcf $(\frac{2291}{366})$
- (8) Avg. Daily Gas from 90-day ending w/1-120 days 7.1 Mcf $(\frac{618}{87})$
- (8) Line Pressure: 36 PSIG from Daily Report
- (5) Oil Production: _____ From Completion Report _____
- (10-17) Does lease inventory indicate enhanced recovery being done: No
- (10-17) Is affidavit signed? Serialized?

02/09/2024

Does official well record with the Department conform with the submitted information? Yes

Additional Information _____ Does computer program confirm? _____

Was Determination Objected to? _____ By Whom? _____

DM

STATE OF WEST VIRGINIA
DEPARTMENT OF MINES, OIL AND GAS DIVISION

Date 02/28, 19 79

Operator's Well No. 2-920

API Well No. 47 - 099 - 0958
State County Permit

WELL CLASSIFICATION FORM

STRIPPER GAS WELL

NGPA Section 108

DESIGNATED AGENT William C. Charlton

ADDRESS P. O. Box 1473
Charleston, WV 25325

WELL OPERATOR Industrial Gas Corporation LOCATION: Elevation 1,027.11'

ADDRESS P. O. Box 1473 Watershed Not Available
Charleston, WV 25325 Dist. Butler County Wayne Quad. Wayne

GAS PURCHASER * _____ Gas Purchase Contract No. * _____

ADDRESS _____ Meter Chart Code R0361

Date of Contract * _____

*See FERC-121 - Addendum "A"

* * * * *

Provide a complete inventory of the lease and production equipment used for the well for the previous 24 months or, if less than 24 months, the period the well has been in production. Include a complete list of equipment or processes used in connection with recognized enhanced recovery techniques during completion or production. (Attach separate sheets, if necessary.)

(See Attachment)

List all records reasonably available to you which contain information relevant to a determination of eligibility (including production records, B&O Tax Records and royalty payment records) and indicate the location of such records:

All records required to determine production by meter stations are maintained in Charleston, West Virginia.

B&O Tax Records are located in Charleston, West Virginia, our Boston, Massachusetts office and the Houston, Texas office.

Royalty payment instructions are located in Charleston, West Virginia office and Houston, Texas office.

Describe the search made of any records listed above:

I have made a diligent search of the production records located in Charleston, West Virginia. They were the records utilized in making the determination herein.

Are you aware of any other information which would tend to be inconsistent with the information specified above? Yes No . If yes, indicate the type and source of the information.

AFFIDAVIT

I, Lawrence B. Mentzer, having been first sworn according to law, state that I have caused to be made a diligent search of those records hereinbefore indicated in the manner herein described, that the information contained in this document is true and accurate and that on the basis of the records and examinations hereinbefore described, and to the best of my information, knowledge and belief, the well for which this certification is sought qualifies as a stripper well.



STATE OF WEST VIRGINIA,
COUNTY OF Kanawha TO WIT:

I, Charlotte I. Mathews, a Notary Public in and for the state and county aforesaid, do certify that Lawrence B. Mentzer whose name is signed to the writing above, bearing date the 28 day of February, 19 79, has acknowledged the same before me, in my county aforesaid.

Given under my hand and official seal this 28 day of February, 19 79.

My term of office expires on the 5th day of December, 19 85.

02/09/2024

Charlotte I. Mathews
Notary Public

STATE OF WEST VIRGINIA
DEPARTMENT OF MINES, OIL AND GAS DIVISION

Date February 28, 1979

Operator's Well No. 2-920

API Well No. 47 - 099 - 0958
State County Permit

Previous File No. NA
(If Applicable)

STATE APPLICATION FOR WELL CLASSIFICATION

WELL OPERATOR Industrial Gas Corporation

DESIGNATED AGENT William C. Charlton

ADDRESS P. O. Box 1473
Charleston, W. Va. 25325

ADDRESS P. O. Box 1473
Charleston, W. Va. 25325

Gas Purchase Contract No. * _____ and Date _____
(Month, day and year)

Meter Chart Code R0361

Name of First Purchaser *

(Street or P. O. Box)

(City) (State) (Zip Code)

FERC Seller Code 009283 FERC Buyer Code _____

TYPE OF DETERMINATION BEING SOUGHT:

- (1) Initial determination (See FERC Form 121.) 108 Section of NGPA NA Category Code
- (2) Determination that increased production is the result of enhanced recovery technology.
- (3) Determination of a seasonally affected well.

(*See FERC-121 Addendum "A")

William C. Charlton Division Counsel
Name (Print) Title

William C. Charlton
Signature

P. O. Box 1473
Street or P. O. Box
Charleston, W. Va. 25325
City State (Zip Code)

(304) 342-8166
Area Code Phone Number

(Certificate of Proof of Service to Purchaser)

See Separate Certificate Attached

(All of the above to be completed by the Operator/Applicant)

(To be completed by Jurisdictional Agency. Executed copy to be returned to Operator/Applicant and purchaser, if known).

The Department of Mines has received a request, for certification of the above described well as meeting the requirements of Section _____ under the Natural Gas Policy Act of 1978, (NGPA); or for determination that increased production is the result of enhanced recovery technology under Section 108 of (NGPA); or for determination of a seasonally affected well under Section 108 of (NGPA)

All interested parties are hereby notified that on the _____ day of _____, 19____, at the office of the Oil and Gas Division in Charleston, West Virginia, or as soon thereafter as it may be heard, there will be a public hearing, if requested, or if objection is filed.

This Application is assigned File No. _____

Initial review of information submitted indicates the well is. is not entitled to certification as claimed under the Natural Gas Policy Act (NGPA). A review of this evidence and any additional evidence will be made at the time appointed for a public hearing or as soon thereafter as the matter may be heard.

Unless objections are timely filed or a request for a hearing is made within fifteen (15) days, a hearing will not be held except on ex parte motion of the department and the matter will go to determination.

WEST VIRGINIA DEPARTMENT OF MINES

Director

By _____
Title _____

02/09/2024

FEB 28 1979

Date received by
Jurisdictional Agency

IV-39-WC

STATE OF WEST VIRGINIA
DEPARTMENT - MINES
DIVISION - OIL AND GAS

ANNUAL REPORT OF MONTHLY PRODUCTION-1977
GAS VOLUMES IN MFC @ 14.73
OIL IN DARRELLS @ 60 DEGREES
OPERATOR - Industrial Gas Corporation

REPORT NO. CCA101P1 PG 00002
CURRENT DATE - 2/28/79
REPORT DATE - 2/28/79

API	FARM	Workman	2-920	COUNTY	Wayne	AVG. FLOW PRESSURE	NA	SHUT-IN PRESSURE	NA	TOTALS				
47-099-00958														
GAS MFC	163	197	137	151	169	130	99	185	134	109	146	146	0AS	1766
OIL BBL	J-	F-	M-	A-	M-	J-	A-	A-	S-	0-	H-	D-	OIL	355
DAYS ONLINE	30	34	27	31	32	28	18	37	29	28	32	29		

1977

API	FARM	Workman	2-920	COUNTY	Wayne	AVG. FLOW PRESSURE	36	SHUT-IN PRESSURE	NA	TOTALS				
47-099-00958														
GAS MFC	224	188	184	175	212	191	152	153	194	200	195	223	0AS	2291
OIL BBL	J-	F-	M-	A-	M-	J-	A-	A-	S-	0-	H-	D-	OIL	366
DAYS ONLINE	36	27	28	30	32	30	30	31	35	27	30	30		

1978

SUMMARIZATION SCHEDULE
Section 271. 804 (b)

In accordance with Section 271.804(b) please list all other wells which are to be used in determining this well classification under Part 271 Subpart H.

02/09/2024

API NUMBERS

47-099-0958; 47-099-0980; 47-099-1015; 47-099-1019; 47-099-1205; 47-099-1202

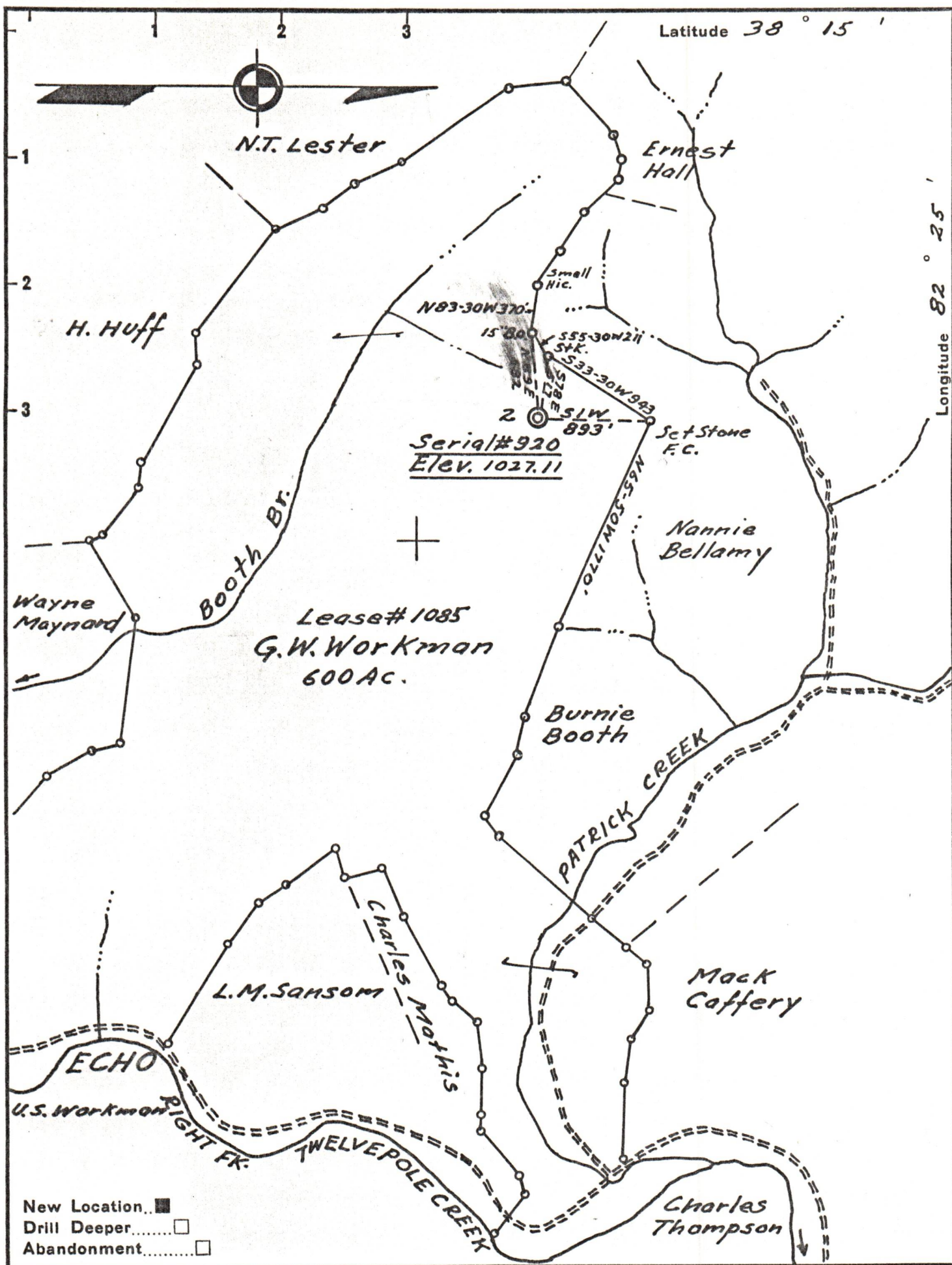

Company Owens, Libbey-Owens Gas Dept.
 Address Box 4158 Charleston 4 W. Va.
 Farm G. W. Workman
 Tract _____ Acres 600 Lease No. 1085
 Well (Farm) No. 2 Serial No. 920
 Elevation (Spirit Level) 1027.11
 Quadrangle Wayne 354.12" W 4.25"
 County Wayne District Butler
 Engineer T. S. Flournoy
 Engineer's Registration No. 269
 File No. _____ Drawing No. _____
 Date Feb. 29, 1955 Scale 1" = 1000'

STATE OF WEST VIRGINIA
 DEPARTMENT OF MINES
 OIL AND GAS DIVISION
 CHARLESTON

WELL LOCATION MAP

FILE NO. WAY-958 02/09/2024

+ Denotes location of well on United States Topographic Maps, scale 1 to 62,500, latitude and longitude lines being represented by border lines as shown.
 - Denotes one inch spaces on border line of original tracing.