



STATE OF WEST VIRGINIA  
DEPARTMENT OF MINES  
OIL AND GAS DIVISION

NOTICE OF PROPOSED LOCATION OF OIL AND GAS WELL

To THE DEPARTMENT OF MINES,  
Charleston, W. Va.

Inez Coffman, Agent  
COAL OPERATOR OR COAL OWNER

137 Walnut St., Huntington, W. Va.  
ADDRESS

COAL OPERATOR OR COAL OWNER

ADDRESS

OWNER OF MINERAL RIGHTS

ADDRESS

OWENS, LIBBEY-OWENS GAS DEPARTMENT  
NAME OF WELL OPERATOR

P. O. BOX 4158, CHARLESTON, W. VA.  
COMPLETE ADDRESS

April 12, \_\_\_\_\_, 1955

**PROPOSED LOCATION**

Union \_\_\_\_\_ District

Wayne \_\_\_\_\_ County

Well No. 906-1 38° 20'  
72° 20'

Inez Coffman et als \_\_\_\_\_ Farm

GENTLEMEN:

The undersigned well operator is entitled to drill upon the above named farm or tract of land for oil and gas, ~~having fee title thereto, (or as the case may be)~~ under grant or lease dated August 22, 1952, made by Inez Coffman et als, to Owens-Illinois Glass Co., Libbey-Owens-Ford Glass Co., and recorded on the 2nd day of May, 1953, in the office of the County Clerk for said County in Book 43, page 171.

The enclosed plat was prepared by a competent engineer and shows the proposed location of a well to be drilled for oil and gas by the undersigned well operator on the farm and in the Magisterial District and County above named, determined by survey and courses and distances from two permanent points, or land marks.

The undersigned well operator is informed and believes there are no coal operators operating beds of coal beneath said farm or tract of land on which said well is located, or within 500 feet of the boundaries of the same, who have mapped their workings and filed their maps as required by law, excepting the coal operators or coal owners (if any) above named as addressees.

The above named coal operators or coal owners (if any) are notified that any objections they may desire to make to such proposed location, or which they are required to make by Section 3 of said Code, if the drilling of a well at said proposed location will cause a dangerous condition in or about their respective coal mines, must be received by, or filed with the Department of Mines within ten\* days from the receipt of a copy of this notice and accompanying plat by said Department. Said coal operators are further notified that forms for use in making such objections will be furnished to them by the Department of Mines promptly on request and that all such objections must set forth as definitely as is reasonably possible the ground or grounds on which such objections are based and indicate the direction and distance the proposed location should be moved to overcome same.

(The next paragraph is to be completed only in Department's copy.)

Copies of this notice and the enclosed plat were mailed by registered mail, or delivered to the above named coal operators or coal owners at their above shown respective address \_\_\_\_\_ day before, or on the same day with the mailing or delivery of this copy to the Department of Mines at Charleston, West Virginia.

Very truly yours,

OWENS, LIBBEY-OWENS GAS DEPARTMENT  
WELL OPERATOR

P. O. BOX 4158  
STREET

CHARLESTON 4,  
CITY OR TOWN

WEST VIRGINIA  
STATE

Address of Well Operator }

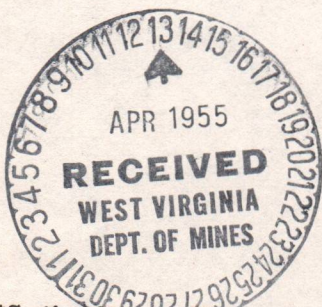

02/09/2024

\*Section 3-... If no such objections be filed or be found by the department of mines, within said period of ten days from the receipt of said notice and plat by the department of mines, to said proposed location, the department shall forthwith issue to the well operator a drilling permit reciting the filing of such plat, that no objections have been made by the coal operators to the location, or found thereto by the department, and that the same is approved and the well operator authorized to proceed to drill at said location.



STATE OF WEST VIRGINIA  
DEPARTMENT OF MINES  
OIL AND GAS DIVISION

NOTICE OF PROPOSED LOCATION OF OIL AND GAS WELL

To The Department of Mines  
Charleston, W. Va.

NAME OF WELL OPERATOR	NAME OF COAL OWNER
OWENS, LIBBY-OWENS GAS DEPARTMENT	Inez Colliery, Agent
COMPLETE ADDRESS	ADDRESS
P. O. BOX 1158, CHARLESTON, W. VA.	137 Walnut St., Huntington, W. Va.
PROPOSED LOCATION	GOAL OPERATOR OR COAL OWNER
Union	
County	ADDRESS
Wayne	
Well No. 200-1	OWNER OF MINERAL RIGHTS
Inez Colliery et als	ADDRESS
Permit Number	

The undersigned well operator is entitled to drill upon the above named farm or tract of land for oil and gas, ~~under grant or lease dated~~ August 22, 1922 made by Inez Colliery et als to Owens-Libby-Owens Ford Glass Co. and recorded on the 2nd day of May, 1923 in the office of the County Clerk for said County in Book 113 page 171

The enclosed plat was prepared by a competent engineer and shows the proposed location of a well to be drilled for oil and gas by the undersigned well operator on the farm and in the Mineral District of said County above named, determined by survey and courses and distances from two permanent points or land marks.

The undersigned well operator is informed and believes there are no coal operators operating here or coal beneath said farm or tract of land on which said well is located or within 500 feet of the bounding lines of the same who have mapped their workings and filed their maps as required by law, excepting the coal operators or coal owners (if any) above named as addressees.

The above named coal operators or coal owners (if any) are notified that any objections they may desire to make to such proposed location, or which they are entitled to make by Section 3 of said Code, if the drilling of a well at said proposed location will cause a dangerous condition in or about their respective coal mines, must be received by or filed with the Department of Mines within ten days from the receipt of a copy of this notice and accompanying plat by said Department. Said coal operators are further notified that forms for use in making such objections will be furnished to them by the Department of Mines promptly on request and that all such objections must set forth as definitely as is reasonably possible the ground or grounds on which such objections are based and indicate the situation and distance the proposed location should be moved to overcome same.

(The next paragraph is to be completed only in Department's copy.)  
Copies of this notice and the enclosed plat were mailed by registered mail, or delivered to the above named coal operators or coal owners at their above shown respective address May 1923 on the same day with the mailing or delivery of this copy to the Department of Mines at Charleston, West Virginia.

Very truly yours,

OWENS, LIBBY-OWENS GAS DEPARTMENT  
WELL OPERATOR  
P. O. BOX 1158  
CHARLESTON, W. VA.  
WEST VIRGINIA

Address of Well Operator

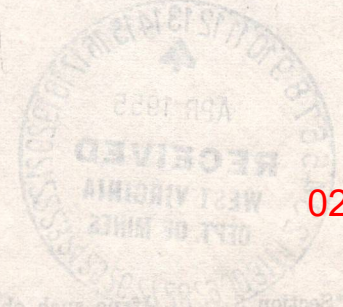

02/09/2024

Section 3 of said Code provides that no such objections be filed or be found by the department of mines within said period of ten days from the receipt of said notice and that by the department of mines to said proposed location, the department of mines shall forthwith issue to the well operator a drilling permit locating the line of such plat, that no objections have been made by the coal operators to the location or land thereon by the department, and that the same is approved and the well operator authorized to proceed to drill at said location.

A-10

BILL OF SALE OF WELL SALVAGE

STATE OF WEST VIRGINIA )  
 ) KNOW ALL MEN BY THESE PRESENTS:  
COUNTY OF WAYNE )

THAT, INDUSTRIAL GAS CORPORATION, a Delaware corporation, authorized to do business in the State of West Virginia, hereinafter called Grantor, for and in consideration of the sum of Two Thousand Two Hundred Dollars (\$2,200.00) to it in hand paid by CHARLES L. SKEENS, Individually and d/b/a SKEENS DRILLING COMPANY of Branchland, West Virginia, the receipt and sufficiency of which is hereby acknowledged, does by these presents GRANT, BARGAIN, SELL, ASSIGN, TRANSFER, and SET OVER unto CHARLES L. SKEENS, Individually and d/b/a SKEENS DRILLING COMPANY, Grantee, insofar as it has the right so to do, all of the casing and salvage materials, fixtures, valves and appliances now present in an old Industrial gas well designated the "Inez Coffon #1", Serial No. 906, located in Wayne County, West Virginia, in Union District, for the purpose of removing said well salvage, being more particularly itemized on separate vouchers designated Schedule "A", attached hereto and made a part hereof for all purposes.

Grantor undertakes no obligation to furnish the easements of ingress and egress to and from said well and Grantee assumes full responsibility and sole risk and cost for obtaining its own passageway to the well location for removal of the salvage material.

In consideration of the premises aforesaid, Grantee hereby covenants and agrees with Grantor, at its own separate cost and expense, to remove, within a period of six (6) months from the date hereof, or at an earlier date if so required by said respective lease or lease owners, the aforesaid salvage and equipment, and Grantee hereby releases and discharges the Grantor, its successors and assigns, from any and all liability or claim for damages now or hereafter arising from the removal of said equipment and salvage, and further covenants and agrees to plug and abandon such well in the manner and form required by the respective lease obligations, and in full conformity with all applicable rules and regulations of the State of West Virginia with reference to the plugging and abandonment of such well.

Grantor makes no warranty, either express or implied, as to the physical condition of the pipe or materials to be salvaged from said well, Grantee

02/09/2024

Formation	Color	Hard or Soft	Top /7	Bottom	Oil, Gas or Water	Depth Found	Remarks
Salt Sand	White	Hard	1290	1349			
Slate	Blue	Soft	1349	1354			
Salt Sand	White	Hard	1354	1461			
Slate	Blue	Soft	1461	1503			
Little Lime	Blue	Hard	1503	1525			
Slate	Blue	Soft	1525	1530			
Little Lime	White	Hard	1530	1545			
Pencil Cave	Blue	Soft	1545	1550			
Big Lime	White	Hard	1550	1700	SIM 1553 =	Sand LM 1548	
Injun Sand	Blue	Hard	1700	1762			
Slate	Blue	Soft	1762	1766			
Injun Sand	Blue	Hard	1766	1828	Gas, 1656',	show.	
Slate	Blue	Soft	1828	1835			
Casing Shell	Dark	Hard	1835	1841	Ran 7" casing on shoe	at 1841 ft.	
Black Shell	Black	Hard	1841	1848			
Shell	Dark	Hard	1848	1885			
Shell	Black	Hard	1885	1926			
Slate	Dark	Soft	1926	1979			
Slate	Blue	Soft	1979	2022			
Slate	Dark	Soft	2022	2097			
Slate	White	Soft	2097	2131			
Shell	Dark	Hard	2131	2167			
Slate	Blue	Soft	2167	2188			
Slate	White	Soft	2188	2223			
Shell	Dark	Hard	2223	2267			
Slate	White	Soft	2267	2301			
Slate	Dark	Soft	2301	2318			
Brown Shale	Brown	Soft	2318	2338	SIM 2338 = Sand LM 2328.		
Berea Sand	White	Hard	2338	2356	Oil stain found after 25 hr. test at 2356 ft.		
Slate	White	Soft	2356	2387			
Shell	Grey	Hard	2387	2409			
Slate	White	Soft	2409	2432			
Shell	Blue	Hard	2432	2494			
Brown Shale	Brown	Soft	2494	2516			
Slate	White	Soft	2516	2556			
Slate	Dark	Soft	2556	2609			
Slate	White	Soft	2609	2732			
Slate	Dark	Soft	2732	2817			
Brown Shale	Brown	Soft	2817	3288	No gas at 3288 ft.		
Slate	White	Soft	3288	3312			
		Total Depth		3312			
		Total Depth after Second Shot		2943			
					Shooter's measurement	3312	
					Depthometer	3303	
					Before shot - no gas		
					7-20-55 Shot Shells & Shale from 2400 to 3312 with 8,800 lbs. Detonite		
					After shot:		
					1/4 Hr.	809 M	
					1 "	250 M	
					2 "	147 M	
					21 "	51 M	
					Shut-in in 7" casing 21 Hrs. A.S.		
					1 Min.	0#	
					2 "	1#	
					5 "	2#	
					30 Hrs.	285#	
					7-25-55 Well open 44 hrs.		
					Gas tested 53 MCF.		
					Shot second time with 6,800# Detonite from 2353 to 3059.		
					1/4 Hr.	546 M	02/09/2024
					1 "	188 M	
					10 "	55.4 M	
					21 "	48 M	

Date August 15, 1955

APPROVED OWENS, LIBBEY-OWENS GAS DEPARTMENT, Owner

By G. H. Owens  
(Title) Geologist



STATE OF WEST VIRGINIA  
DEPARTMENT OF MINES  
OIL AND GAS DIVISION 17

Quadrangle Guyandotte

Permit No. Way-963

2021/06/20

Company Owens, Libbey-Owens Gas Department

Address P. O. Box 4158, Charleston 4, W. Va.

Farm Inez Coffman

Location (waters) Well No. 1 (Serial No. 906)

District Union County Wayne

The surface of tract is owned in fee by

Address 137 Walnut St. Inez Coffman, Agt.

137 Walnut St. Huntington, W. Va.

Drilling commenced 5-28-55

Drilling completed 7-17-55

Date Shot 7-25-55

From 2353 To 3059

With 6,800# Detonite (second time) see remarks

Open Flow /10ths Water in Inch

Volume Br. Shale 21 Hrs. A.S. 48M Cu. Ft.

Rock Pressure lbs. 7 days

Oil bbls., 1st 24 hrs.

Fresh water 585, 800

Salt water

feet

feet

Oil or Gas Well Gas

WELL RECORD

Left in Well	Used in Drilling	Casing and Tubing	Size	Kind of Packer	Size of	Depth set	Perf. top	Perf. bottom	Perf. top	Perf. bottom
		8% 5/8"	380'6"	380'6"	18 1/2'	18 1/2' 10"				
		5 3/16"								
		3"								
		2"								
		Liners Used								

CASING CEMENTED SIZE No. Ft. Date

COAL WAS ENCOUNTERED AT FEET INCHES

FEET INCHES FEET INCHES

Bottom Top Hard or Soft

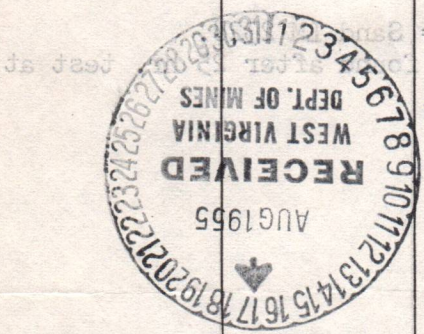

Ran 8-5/8" casing on shoe at 380 ft.

Water 585', 1 B.P.H.

Water 800', 2 B.P.H.

Water Sand 1166', hole filling.

Formation	Color	Hard or Soft	Top	Bottom	Oil, Gas or Water	Depth Found	Remarks
Surface	Red	Soft	0	15			
Slate	Blue	Soft	15	63			
Sand	Grey	Hard	63	73			
Slate	Blue	Soft	73	105			
Red Rock	Red	Soft	105	140			
Slate	Blue	Soft	140	160			
Red Rock	Red	Soft	160	204			
Slate	Blue	Soft	204	209			
Red	Red	Soft	209	237			
Slate	White	Soft	237	271			
Red Rock	Red	Soft	271	297			
Slate	White	Soft	297	359			
Sand	White	Soft	359	375			
Slate	White	Soft	375	380			
Slate	Black	Soft	380	386			
Slate	White	Soft	386	430			
Broken Sand	White	Soft	430	438			
Slate	White	Soft	438	484			
Slate	Black	Soft	484	495			
Sand	White	Soft	495	516			
Slate	Black	Soft	516	553			
Slate	White	Soft	553	580			
Sand	White	Hard	580	595			
Slate	White	Soft	595	620			
Sand	White	Soft	620	670			
Sand	White	Hard	670	691			
Slate	Dark	Soft	691	757			
Slate	White	Soft	757	777			
Slate	Blue	Soft	777	787			
Sand	White	Soft	787	832			
Slate	Blue	Soft	832	839			
Sand	White	Soft	839	949			
Sand	White	Hard	949	984			
Slate	White	Soft	984	992			
Sand	White	Hard	992	1025			
Slate	Blue	Soft	1025	1093			
Sand	White	Hard	1093	1171			
Salt Sand	White	Hard	1171	1279			
Slate	Blue	Soft	1279				

(Over)

Well No. 1 Tract Town Center

Serial No. 906

Acres 50 District Union

County, WAYNE State, WVA.

Elevation 820.16

Work done by: E. J. Ekins, Contractor

Driller's Name:

Commenced Drilling Up --  
Well Completed 7-25-55

Commenced Drilling 5-26-55  
Commenced Producing

Completed Drilling 7-17-55  
Abandoned

CONDUCTOR, CASING AND TUBING

PACKERS. Kind

CLOSED IN PERFORATIONS

SIZE	WEIGHT	NO. OF JOINTS	USED IN DRILLING	LEFT IN WELL
8-5/8	24	15	330'6"	330'6"
7	20	63	1842'10"	1842'10"

Size

Set

Kind

Size

Set

Perforations

Size

1 Min.

2 Min.

3 Min.

4 Min.

5 Min.

10 Min.

24 Hours

126 Hours

tamped with (7-Days - 365\*)

Shot 7-20 1955, from 2400 to 3312 with 8,800# Detonite

Open flow before: No gas MCF: 15 Min. after: 809 MCF: 21 hours after: 51 MCF

Shot 7-25- 1955, from 2353 to 3059 with 6,800# Detonite

Open flow before: 53 MCF: 15 Min. after: 546 MCF: 21 hours after: 48 MCF

Acid or other treatment:

WELL	Initial test:	barrels per	flowing.	barrels per	pumping.
CAS WELL	Open flow:		Brown Shale	21 Hrs. AS Total	48 MCF

DRILLERS' RECORD

FORMATION	COLOR	HARDNESS	TOP	BOTTOM	THICKNESS	REMARKS
Surface	Red	Soft	0	15	15	
Slate	Blue	Soft	15	63	48	
Sand	Grey	Hard	63	73	10	
Slate	Blue	Soft	73	105	32	
Red Rock	Red	Soft	105	140	35	
Slate	Blue	Soft	140	160	20	
Red Rock	Red	Soft	160	204	44	
Slate	Blue	Soft	204	209	5	
Red Rock	Red	Soft	209	237	28	
Slate	White	Soft	237	271	34	
Red Rock	Red	Soft	271	297	26	
Slate	White	Soft	297	359	62	
Sand	White	Soft	359	375	16	
Slate	White	Soft	375	380	5	Ran 8-5/8" casing on shoe at 380 ft.
Slate	Black	Soft	380	386	6	SLM 380 = sand LM 379
Slate	White	Soft	386	430	44	
Broken Sand	White	Soft	430	438	8	
Slate	White	Soft	438	484	46	
Slate	Black	Soft	484	495	11	
Sand	White	Soft	495	516	21	
Slate	Black	Soft	516	553	37	SLM 553 = Sand LM 551
Slate	White	Soft	553	580	27	
Sand	White	Hard	580	595	15	Water 585', 1 B.P.H.
Slate	White	Soft	595	620	25	
Sand	White	Soft	620	670	50	
Sand	White	Hard	670	691	21	
Slate	Dark	Soft	691	757	66	
Slate	White	Soft	757	777	20	
Slate	Blue	Soft	777	787	10	
Sand	White	Soft	787	832	45	Water 800', 2 B.P.H.
Slate	Blue	Soft	832	839	7	
Slate	White	Soft	839	949	110	
Sand	White	Hard	949	984	35	
Slate	White	Soft	984	992	8	
Sand	White	Hard	992	1025	33	
Slate	Blue	Soft	1025	1093	68	
Sand	White	Hard	1093	1171	78	Water sand 1166', hole filling.
Sand	White	Hard	1171	1279	108	SLM 1260 = Sand LM 1212.
Sand	Blue	Soft	1279	1280	1	Water level, 351' at 1280'.
Sand	White	Hard	1280	1347	67	Water level, 345' at 1315'.

02/09/2024

DRILLERS' RECORD

FORMATION	COLOR	HARDNESS	TOP	BOTTOM	THICKNESS	REMARKS
late	Blue	Soft	1349	1354	5	
alt Sand	White	Hard	1354	1461	107	
late	Blue	Soft	1461	1503	42	
ittle Lime	Blue	Hard	1503	1525	22	
late	Blue	Soft	1525	1530	5	
ittle Lime	White	Hard	1530	1545	15	
encil Cave	Blue	Soft	1545	1550	5	
ig Lime	White	Hard	1550	1700	150	SLM 1553 = Sand LM 1548.
njun Sand	Blue	Hard	1700	1762	62	SLM 1613 = Sand LM 1611.
late	Blue	Soft	1762	1766	4	Water level, 305' at 1613'.
njun Sand	Blue	Hard	1766	1823	62	Gas, 1656, show.
late	Blue	Soft	1823	1835	7	Water level 310' at 1828'.
asing Shell	Dark	Hard	1835	1841	6	Ran 7" casing on shoe at 1841.
ack Shell	Black	Hard	1841	1848	7	SLM 1848 = Sand LM 1848.
hell	Dark	Hard	1848	1885	37	
hell	Black	Hard	1885	1926	41	
late	Dark	Soft	1926	1979	53	
late	Blue	Soft	1979	2022	43	
late	Dark	Soft	2022	2097	75	
late	White	Soft	2097	2131	34	
hell	Dark	Hard	2131	2167	36	
late	Blue	Soft	2167	2188	21	
late	White	Soft	2188	2223	35	
hell	Dark	Hard	2223	2267	44	
late	White	Soft	2267	2301	34	
late	Dark	Soft	2301	2318	17	
rown Shale	Brown	Soft	2318	2338	20	SLM 2338 = Sand LM 2328.
erea Sand	White	Hard	2338	2356	18	Oil Stain found after 25 hr. test at 2356'
late	White	Soft	2356	2387	31	SLM 2385 = Sand LM 2380.
hell	Grey	Hard	2387	2409	22	
late	White	Soft	2409	2432	23	
hell	Blue	Hard	2432	2494	62	
rown Shale	Brown	Soft	2494	2516	22	
late	White	Soft	2516	2556	40	
late	Dark	Soft	2556	2609	53	
late	White	Soft	2609	2732	123	SLM 2702 = Sand LM 2700.
late	Dark	Soft	2732	2817	85	
rown Shale	Brown	Soft	2817	3288	471	Tested for gas at 3030 - no gas. No gas at 3288.
late	White	Soft	3288	3312	24	
Total Depth			3312			Shooter's measurement 3312'
Total Depth after 2nd shot			2943			Depthometer 3303'.

7-20-55

Shot Shells & Shale from 2400 to 3312 with 8,800 lbs. Detonite.

Before shot - no gas.

After shot:

1/4 Hr.	809 M
1 "	250 M
2 "	147 M
10 "	59 M
21 "	51 M

Shut-in in 7" casing 21 Hrs. after shot.

1 Min.	0#
2 "	1#
3 "	1#
4 "	2#
5 "	2#
10 "	4#
30 Hrs.	285#

02/09/2024

7-25-55 Shot second time.

Well open 44 hours.

Gas tested 53 MCF.

Shot second time with 6,800# Detonite 2353 to 3059.

1/4 Hr.	546 M
1 "	188 M
2 "	110 M
10 "	55.4 M
21 "	48 M

Shut-in well in 7" casing 21 Hrs.

April 23, 1955

Owens, Libbey-Owens Gas Department  
P. O. Box 4158  
Charleston, West Virginia

Gentlemen:

Enclosed are permits for the drilling of the following permits:

<u>Permit No.</u>	<u>Well No.</u>	<u>Farm</u>	<u>District</u>
Way-963	1-906	Inez Coffman et al	Union
Way-964	5-907	Etta R. Fritchard et al	Union
Way-965	1-935	Lenora M. Newman	Union

Very truly yours,

Administrative Assistant  
OIL AND GAS DIVISION

CNH:K  
Encl-3

CC: Inspector O. C. Allen

02/09/2024



STATE OF WEST VIRGINIA  
 DEPARTMENT OF MINES  
 OIL AND GAS WELLS DIVISION

RECEIVED

MAY 22 1975

OIL & GAS DIVISION  
 DEPT. OF MINES

INSPECTOR'S PLUGGING REPORT

Permit No. Way 963 P Well No. 1

COMPANY Charlie S Neems ADDRESS Branchland, wva.

FARM Thos Coffman DISTRICT Union COUNTY Wayne

Filling Material Used Clay Stone

Liner Location Amount Packer Location

PLUGS USED AND DEPTH PLACED			BRIDGES	CASING AND TUBING		
CEMENT-THICKNESS	WOOD-SIZE	LEAD	CONSTRUCTION-LOCATION	RECOVERED	SIZE	LOST
2200-2223		Claystone		2223-2943		

Drillers' Names Charlie S Neems  
Co. Tools

Remarks:

5-20-75

I hereby certify I visited the above well on this date.

DATE

K.E. Butcher

DISTRICT WELL INSPECTOR

02/09/2024

STATE OF WEST VIRGINIA  
DEPARTMENT OF MINES  
OIL AND GAS WELLS DIVISION

INSPECTOR'S WELL REPORT

Permit No. \_\_\_\_\_

Oil or Gas Well \_\_\_\_\_  
(KIND)

Company _____	CASING AND TUBING	USED IN DRILLING	LEFT IN WELL	PACKERS
Address _____	Size			
Farm _____	16			Kind of Packer _____
Well No. _____	13			
District _____ County _____	10			Size of _____
Drilling commenced _____	8 1/4			
Drilling completed _____ Total depth _____	6 5/8			Depth set _____
Date shot _____ Depth of shot _____	5 3/16			Perf. top _____
Initial open flow _____ /10ths Water in _____ Inch	3			Perf. bottom _____
Open flow after tubing _____ /10ths Merc. in _____ Inch	2			Perf. top _____
Volume _____ Cu. Ft.	Liners Used			Perf. bottom _____
Rock pressure _____ lbs. _____ hrs.	CASING CEMENTED _____ SIZE _____ No. FT. _____ Date _____			
Oil _____ bbls., 1st 24 hrs.	NAME OF SERVICE COMPANY _____			
Fresh water _____ feet _____ feet	COAL WAS ENCOUNTERED AT _____ FEET _____ INCHES			
Salt water _____ feet _____ feet	_____ FEET _____ INCHES _____ FEET _____ INCHES			

Drillers' Names \_\_\_\_\_

Remarks: \_\_\_\_\_

STATE OF WEST VIRGINIA  
DEPARTMENT OF MINES  
OIL AND GAS WELLS DIVISION

RECEIVED

MAY 23 1975

OIL & GAS DIVISION  
DEPT. OF MINES

INSPECTOR'S PLUGGING REPORT

Permit No. Way-963P Well No. 1

COMPANY Charlie J. Speens ADDRESS Branchland, WVA,

FARM Jess Coffman DISTRICT Union COUNTY Wayne

Filling Material Used Clay Stone Cement

Liner Location Amount Packer Location

PLUGS USED AND DEPTH PLACED			BRIDGES	CASING AND TUBING		
CEMENT-THICKNESS	WOOD-SIZE	LEAD	CONSTRUCTION-LOCATION	RECOVERED	SIZE	LOST
18 20 - 18 1/2	Claystone		18 1/2 - 2200			
15 80 - 1600	Will recover all 7"		18 1/2 7"			
	Claystone		1600 - 1820			

Drillers' Names Oliver Pugh  
Co. Goals

Remarks: Plugging as 7" pipe is pulled

5-21-75 I hereby certify I visited the above well on this date.

DATE

K.E. Butcher

DISTRICT WELL INSPECTOR 02/09/2024

STATE OF WEST VIRGINIA  
DEPARTMENT OF MINES  
OIL AND GAS WELLS DIVISION

## INSPECTOR'S WELL REPORT

Permit No. \_\_\_\_\_

Oil or Gas Well \_\_\_\_\_  
(KIND)

	CASING AND TUBING	USED IN DRILLING	LEFT IN WELL	PACKERS
Company _____	Size			Kind of Packer _____
Address _____				
Farm _____	16 _____			
Well No. _____	13 _____			
District _____ County _____	10 _____			Size of _____
Drilling commenced _____	8 1/4 _____			
Drilling completed _____ Total depth _____	6 5/8 _____			Depth set _____
Date shot _____ Depth of shot _____	5 3/16 _____			
Initial open flow _____ /10ths Water in _____ Inch	3 _____			Perf. top _____
Open flow after tubing _____ /10ths Merc. in _____ Inch	2 _____			Perf. bottom _____
Volume _____ Cu. Ft.	Liners Used _____			Perf. top _____
Rock pressure _____ lbs. _____ hrs.				Perf. bottom _____
Oil _____ bbls., 1st 24 hrs.	CASING CEMENTED _____ SIZE _____ No. FT. _____ Date _____			
Fresh water _____ feet _____ feet	NAME OF SERVICE COMPANY _____			
Salt water _____ feet _____ feet	COAL WAS ENCOUNTERED AT _____ FEET _____ INCHES			
	_____ FEET _____ INCHES _____ FEET _____ INCHES			
	_____ FEET _____ INCHES _____ FEET _____ INCHES			

Drillers' Names \_\_\_\_\_

Remarks:

RECEIVED

MAY 28 1975

STATE OF WEST VIRGINIA  
DEPARTMENT OF MINES  
OIL AND GAS WELLS DIVISION

OIL & GAS DIVISION  
DEPT. OF MINES

INSPECTOR'S PLUGGING REPORT

Permit No. Way-963 P Well No. 1

COMPANY Charlie L. Sheens ADDRESS Branchland town

FARM Fred Coffman DISTRICT Union COUNTY Wayne

Filling Material Used Clay stone cement

PLUGS USED AND DEPTH PLACED			BRIDGES	CASING AND TUBING		
CEMENT-THICKNESS	WOOD-SIZE	LEAD	CONSTRUCTION-LOCATION	RECOVERED	SIZE	LOST
1150'-1170'			will recover	360'	8"	20'
785'-810'	Stone	Clay	1170'-1580'			
	" f "	"	810'-1160'			
	" f "	"	380'-785'			

Drillers' Names Orville Paugh  
Co. Tools

Remarks: Part of this work performed on 5-22-75

5-23-75 I hereby certify I visited the above well on this date.

DATE

H. E. Butcher  
DISTRICT WELL INSPECTOR

02/09/2024

STATE OF WEST VIRGINIA  
DEPARTMENT OF MINES  
OIL AND GAS WELLS DIVISION

INSPECTOR'S WELL REPORT

Permit No. \_\_\_\_\_

Oil or Gas Well \_\_\_\_\_  
(KIND)

Company _____	CASING AND TUBING	USED IN DRILLING	LEFT IN WELL	PACKERS
Address _____	Size			
Farm _____	16			Kind of Packer _____
Well No. _____	13			
District _____ County _____	10			Size of _____
Drilling commenced _____	8 1/4			Depth set _____
Drilling completed _____ Total depth _____	6 5/8			
Date shot _____ Depth of shot _____	5 3/16			Perf. top _____
Initial open flow _____ /10ths Water in _____ Inch	3			Perf. bottom _____
Open flow after tubing _____ /10ths Merc. in _____ Inch	2			Perf. top _____
Volume _____ Cu. Ft.	Liners Used _____			Perf. bottom _____
Rock pressure _____ lbs. _____ hrs.	CASING CEMENTED _____ SIZE _____ No. FT. _____ Date _____			
Oil _____ bbls., 1st 24 hrs.	NAME OF SERVICE COMPANY _____			
Fresh water _____ feet _____ feet	COAL WAS ENCOUNTERED AT _____ FEET _____ INCHES			
Salt water _____ feet _____ feet	_____ FEET _____ INCHES FEET _____ INCHES			
	_____ FEET _____ INCHES FEET _____ INCHES			

Drillers' Names \_\_\_\_\_

Remarks:

RECEIVED

MAY 29 1975

STATE OF WEST VIRGINIA  
DEPARTMENT OF MINES  
OIL AND GAS WELLS DIVISION

OIL & GAS DIVISION  
DEPT. OF MINES

INSPECTOR'S PLUGGING REPORT

Permit No. Way-963P Well No. 1

COMPANY Charles J. Sheens ADDRESS Branchland, wva,

FARM Jay Coffman DISTRICT Union COUNTY Wayne

Filling Material Used Clay Stone Cement

Liner Location Amount Packer Location

PLUGS USED AND DEPTH PLACED			BRIDGES	CASING AND TUBING		
CEMENT-THICKNESS	WOOD-SIZE	LEAD	CONSTRUCTION-LOCATION	RECOVERED	SIZE	LOST
360-380	Claystone		20-360	360	8"	20'6"
0-20						

Drillers' Names Orville Paugh  
Co. Tool

Remarks: This hole was finished on 5-27-75.

5-27-75  
DATE I hereby certify I visited the above well on this date.

K.E. Bulcher  
DISTRICT WELL SUPERVISOR

02/09/2024

STATE OF WEST VIRGINIA  
DEPARTMENT OF MINES  
OIL AND GAS WELLS DIVISION

INSPECTOR'S WELL REPORT

Permit No. \_\_\_\_\_

Oil or Gas Well \_\_\_\_\_  
(KIND)

	CASING AND TUBING	USED IN DRILLING	LEFT IN WELL	PACKERS
Company _____	Size			
Address _____	16			Kind of Packer _____
Farm _____	13			
Well No. _____	10			Size of _____
District _____ County _____	8 1/4			
Drilling commenced _____	6 5/8			Depth set _____
Drilling completed _____ Total depth _____	5 3/16			
Date shot _____ Depth of shot _____	3			Perf. top _____
Initial open flow _____ /10ths Water in _____ Inch	2			Perf. bottom _____
Open flow after tubing _____ /10ths Merc. in _____ Inch	Liners Used _____			Perf. top _____
Volume _____ Cu. Ft.				Perf. bottom _____
Rock pressure _____ lbs. _____ hrs.	CASING CEMENTED _____ SIZE _____ No. FT. _____ Date _____			
Oil _____ bbls., 1st 24 hrs.	NAME OF SERVICE COMPANY _____			
Fresh water _____ feet _____ feet	COAL WAS ENCOUNTERED AT _____ FEET _____ INCHES			
Salt water _____ feet _____ feet	_____ FEET	_____ INCHES	_____ FEET	_____ INCHES
	_____ FEET	_____ INCHES	_____ FEET	_____ INCHES

Drillers' Names \_\_\_\_\_

Remarks:





State of West Virginia

Department of Mines  
Oil and Gas Division

Charleston 25305

May 25, 1976

JOHN ASHCRAFT  
Director

ROBERT L. DODD  
Deputy Director

Kenneth Butcher  
RFD # 1  
Barboursville, W.Va.

PERMIT WAY-963-P  
COMPANY Charles L. Skeens  
FARM Inez Coffman, etals.  
WELL NO 1-S-906  
DISTRICT Union  
COUNTY Wayne

Dear Sir:

Please make a final inspection of the well described above.

Very truly yours,

A handwritten signature in cursive script that reads "Robert L. Dodd".

Robert L. Dodd

RLD/ ch

02/09/2024

PROPOSED MANNER OF PLUGGING AND FILLING WELL

(REQUIRED BY RULES AND REGULATIONS)

WEST VIRGINIA DEPARTMENT OF MINES

OIL AND GAS DIVISION

WORK ORDER

Well to be plugged and filled as follows:

4D- 2943  
 fill hole with mud and stone - to 2223  
 Cement - 2223 - 2200 -  
 Stone 2200 - 1980  
 Clay and Stone - 1980 - 1842  
 Pull up 7' casing - Set @ 1842  
 Cement - 1842 - 1820 -  
 Clay - 1820 - 1600  
 Cement 1600 - 1580  
 Stone - 1580 - 1570 -  
 Stone and Clay 1170  
 Cement - 1170 - 1160 -  
 Stone and Clay 1160 - 810  
 Cement - 810 - 795 -  
 Stone and Clay 795 - 380 -  
 Pull up 85' casing.  
 Cement 380 - 360 -  
 Clay - 360 - 20  
 Cement 20 - surface with monument

To the Department of Mines  
 Coal Owner or Operator,  
 Lease or Property Owner.

**IF PARTIAL PLUGGING  
 PLEASE SUBMIT REVISED WELL RECORD  
 WHEN WORK IS COMPLETED.**

Gentlemen:

This "work order" is submitted for your approval and concurrence and unless notified of your disapproval or non-concurrence, the undersigned will proceed with the plugging and filling of said well in the above described manner on the date inspector is notified after permit is issued.

Very truly yours,

\_\_\_\_\_

Well Operator

No objections have been filed by the coal owner or coal operator, or any available adjacent lease or property owners or interposed by the Department of Mines to the manner herein described for the plugging and filling of the well above mentioned. Therefore, the same is hereby approved this

19th. day of May, 1975.

DEPARTMENT OF MINES  
 Oil and Gas Division

By: Robert H. Dodd

02/09/2024

NOTE: This "work order" shall be filed in triplicate, one copy for the files of the Department of Mines; one to be approved or corrected and returned to the well operator as his authority for plugging said well; and one for the well inspector.



STATE OF WEST VIRGINIA  
DEPARTMENT OF MINES  
OIL AND GAS WELLS DIVISION

RECEIVED  
MAY 19 1975  
OIL & GAS DIVISION  
DEPT. OF MINES

NOTICE OF INTENTION TO PLUG AND ABANDON WELL

(REQUIRED BY SECTION 9, ARTICLE 4, CHAPTER 22 OF THE CODE)

TO THE DEPARTMENT OF MINES,  
Charleston, W. Va.

None	Charles L. Skeens
Coal Operator	Name of Well Operator
	Box 97
	Branchland, W.Va. 25506
Address	Complete Address
	May 19, 1975
Coal Owner	Date
	WELL TO BE ABANDONED
Address	Union _____ District
	Wayne _____ County
Lease or Property Owner	Well No. 1-S-906
Address	Inez Coffman, etals. Farm
Rue Schoolcraft, Inspector-at-Large-Pineville, W Va. 24874	732-7245
Inspector Kenneth Butcher, RFD # 1, Barboursville, W.Va. 25504	736-4885
	Telephone _____

TO BE NOTIFIED 24 HOURS IN ADVANCE OF PLUGGING OPERATIONS

Gentlemen:—

The undersigned well operator is about to abandon the above described well and will commence

the work of plugging and abandoning said well on the date inspector is notified (which date shall not be less than five days after the day on which this notice so mailed is received, or in due course should be received by the Department of Mines).

This notice is given you in order that your respective representatives may be present at the plugging and filling of said well. You are further notified that whether you are represented or not represented the undersigned will proceed on that date, or shortly thereafter, to plug and fill said well in the manner required by Section 10, Article 4, Chapter 22 of the Code and given in detail on the reverse side of this notice, in "Work Order."

This notice is being mailed by registered mail to each of you at the above addresses on the above date.

Very truly yours,

*Charles L. Skeens*  
Well Operator  
T.H.

NOTE: Upon the abandonment of any well drilled prior to June 1, 1929, a plat prepared by a registered engineer, shall be filed with THREE COPIES OF APPLICATION, (OG-9) AND "WORK ORDER" AND TWO COPIES OF THE WELL RECORD, (OG-10). The map must show the district and county in which the tract of land is located, the name and acreage of same, the name or names of the owners and names of adjacent tracts and the location of the well to be abandoned, determined by survey with the courses and distances of such well from two permanent points or landmarks on said tract, in compliance with Rule 5 of the Rules and Regulations.

02/09/2024

NOTE: In case plugging is not commenced within four months from the date of permit, same shall expire and be of no further force or effect.

NOTE: PERMIT IS NON TRANSFERABLE.

**BOND PLUG**

WAY-963-P

47-099

Permit Number

AFFIDAVIT, FORM OG-8, MANNER WELL PLUGGED MUST BE SUBMITTED TO OBTAIN RELEASE OF WELL UNDER BOND.

RECEIVED

MAY 25 1976

FORM OG-8

STATE OF WEST VIRGINIA  
DEPARTMENT OF MINES  
OIL AND GAS WELLS DIVISION

OIL & GAS DIVISION  
DEPT. OF MINES

AFFIDAVIT OF PLUGGING AND FILLING WELL

AFFIDAVIT SHOULD BE MADE IN TRIPLICATE, ONE COPY MAILED TO THE DEPARTMENT, ONE COPY TO BE RETAINED BY THE WELL OPERATOR AND THE THIRD COPY (AND EXTRA COPIES IF REQUIRED) SHOULD BE MAILED TO EACH COAL OPERATOR AT THEIR RESPECTIVE ADDRESSES.

None  
 \_\_\_\_\_  
COAL OPERATOR OR OWNER

\_\_\_\_\_  
ADDRESS

\_\_\_\_\_  
COAL OPERATOR OR OWNER

\_\_\_\_\_  
ADDRESS

\_\_\_\_\_  
LEASE OR PROPERTY OWNER

\_\_\_\_\_  
ADDRESS

Charles L. Skeens  
 \_\_\_\_\_  
NAME OF WELL OPERATOR

Branchland, W. Va. 25506  
 \_\_\_\_\_  
COMPLETE ADDRESS

May 19, 1975  
 \_\_\_\_\_  
WELL AND LOCATION

Union  
 \_\_\_\_\_  
District

Wayne  
 \_\_\_\_\_  
County

Well No. 1-s-906  
 \_\_\_\_\_  
 Inez Coffman, etals.  
 \_\_\_\_\_  
Farm

STATE INSPECTOR SUPERVISING PLUGGING. Kenneth Butcher, RFD #1, Barboursville, W.Va.  
Rue Schoolcraft, Inspector-at-large, Pineville, W. Va. 24874

AFFIDAVIT

STATE OF WEST VIRGINIA,  
County of Wayne } ss:  
Oliver Paugh

and Charles Skeens  
being first duly sworn according to law depose and say that they are experienced in the work of plugging and filling oil and gas wells and were employed by Charles Skeens well operator, and participated in the work of plugging and filling the above well, that said work was commenced on the 20th day of May, 1975, and that the well was plugged and filled in the following manner:

SAND OR ZONE RECORD FORMATION	FILLING MATERIAL	PLUGS USED SIZE & KIND	CASING	
			CSG PULLED	CSG LEFT IN
2913 - 2223	Mud and Stone			
2223 - 2200	Cement			
2200 - 1980	Stone			
1980 - 1842	Clay and Stone			
1842 - 1600	Cement and Clay			
1600 - 1570	Cement and Stone			
1570 - 1170	Stone and Clay			
1170 - 1160	Cement			
1160 - 810	Stone and Clay			
810 - 795	Cement			
795 - 380	Stone & Clay			
380 - 360	Cement			
360 - 20	Clay			
20 - 0	Cement			
	Erected Monument			
COAL SEAMS				
(NAME)		DESCRIPTION OF MONUMENT		
(NAME)				
(NAME)				
(NAME)				

and that the work of plugging and filling said well was completed on the 20th day of August, 1975.

And further deponents saith not.

Sworn to and subscribed before me this 20th day of August, 1975.

My commission expires: 4/15/79 9/11/79

Gary Paugh  
 Oliver J Paugh  
 John Frankling  
 Notary Public.

02/09/2024

Permit No. WAY-963=P

Faint, illegible text, possibly bleed-through from the reverse side of the page. Some faint words like "MILITARY" and "OFFICE" are visible.

Faint, illegible text, possibly bleed-through from the reverse side of the page. Some faint words like "MILITARY" and "OFFICE" are visible.

Faint, illegible text, possibly bleed-through from the reverse side of the page. Some faint words like "MILITARY" and "OFFICE" are visible.

02/09/2024

STATE OF WEST VIRGINIA  
DEPARTMENT OF MINES  
OIL AND GAS WELLS DIVISION

RECEIVED

JUL 6 - 1976

OIL & GAS DIVISION  
DEPT. OF MINES

INSPECTOR'S WELL REPORT

Permit No. Way-963P

Oil or Gas Well \_\_\_\_\_  
(KIND)

Company <u>Charlie J. Skeens</u>	CASING AND TUBING	USED IN DRILLING	LEFT IN WELL	PACKERS
Address <u>Branchland, W. Va.</u>	Size			
Farm <u>near Coffman et al</u>	16			
Well No. <u>1-S-906</u>	13			
District <u>Union</u> County <u>Wayne</u>	10			
Drilling commenced _____	8 1/4			
Drilling completed _____ Total depth _____	6 5/8			
Date shot _____ Depth of shot _____	5 3/16			
Initial open flow _____ /10ths Water in _____ Inch	3			
Open flow after tubing _____ /10ths Merc. in _____ Inch	2			
Volume _____ Cu. Ft.	Liners			
Rock pressure _____ lbs. _____ hrs.	CASIN			
Oil _____ bbls., 1st 24 hrs.	NAME			
Fresh water _____ feet _____ feet	COAL			
Salt water _____ feet _____ feet				

PS Form 3811, Jan. 1975

● SENDER: Complete items 1, 2, and 3. Add your address in the "RETURN TO" space on reverse.

1. The following service is requested (check one).  
 Show to whom and date delivered..... 15¢  
 Show to whom, date, & address of delivery.. 35¢  
 RESTRICTED DELIVERY. Show to whom and date delivered..... 65¢  
 RESTRICTED DELIVERY. Show to whom, date, and address of delivery 85¢

2. ARTICLE ADDRESSED TO:  
 Charles L. Skeens  
 Box 97  
 Branchland, W.Va. 25506

3. ARTICLE DESCRIPTION:  
 REGISTERED NO. \_\_\_\_\_ CERTIFIED NO. 81087 INSURED NO. \_\_\_\_\_  
 (Always obtain signature of addressee or agent)

I have received the article described above.  
 SIGNATURE  Addressee  Authorized agent  
Emma Skeens

4. DATE OF DELIVERY 7-19-76

5. ADDRESS (Complete only if requested)

6. UNABLE TO DELIVER BECAUSE:

CLERK'S INITIALS [Signature]

POSTMARK  
 JUL 19 1976  
 SPO W.V.

RETURN RECEIPT, REGISTERED, INSURED AND CERTIFIED MAIL

☆ GPO: 1975-O-568-047

Drillers' Names \_\_\_\_\_

Remarks:

*Final inspection made on this well.*

7-1-76  
DATE

K.E. Butcher  
DISTRICT WELL INSPECTOR

02/09/2024

STATE OF WEST VIRGINIA  
 DEPARTMENT OF MINES  
 OIL AND GAS WELLS DIVISION  
**INSPECTOR'S PLUGGING REPORT**

Permit No. \_\_\_\_\_ Well No. \_\_\_\_\_

COMPANY \_\_\_\_\_ ADDRESS \_\_\_\_\_

FARM \_\_\_\_\_ DISTRICT \_\_\_\_\_ COUNTY \_\_\_\_\_

Filling Material Used \_\_\_\_\_

Liner			Location			Amount			Packer			Location		
PLUGS USED AND DEPTH PLACED			BRIDGES			CASING AND TUBING								
CEMENT-THICKNESS	WOOD-SIZE	LEAD	CONSTRUCTION-LOCATION			RECOVERED	SIZE	LOST						

Drillers' Names \_\_\_\_\_

Remarks:

\_\_\_\_\_ I hereby certify I visited the above well on this date.  
DATE

\_\_\_\_\_  
DISTRICT WELL INSPECTOR  
02/09/2024



State of West Virginia

Department of Mines  
Oil and Gas Division

Charleston 25305

July 7, 1976

CharlestL. Skeens  
Box 97  
Branchland, W.Va. 25506

In Re: Permit No. WAY-963-P  
Farm Inez Coffman, etals.  
Well No. 1-S-906  
District Union  
County Wayne

Gentlemen:

The final inspection report for the well which is described above has been received in this office. Only the column checked below applies.

         The bond covering the well designated by the above permit number has been released under your Blanket Bond.

XXXX Please return the enclosed cancelled bond which covered the well designated by the above permit number to the Surety Company who executed said bond in your behalf, in order that they may give you credit on their records.

Very truly yours,

Deputy Director  
Oil and Gas Division

RLD/ch

Enclosure: Single Bond dated 5-19-75 (U.S.F. & G Ins. Co.)

02/09/2024



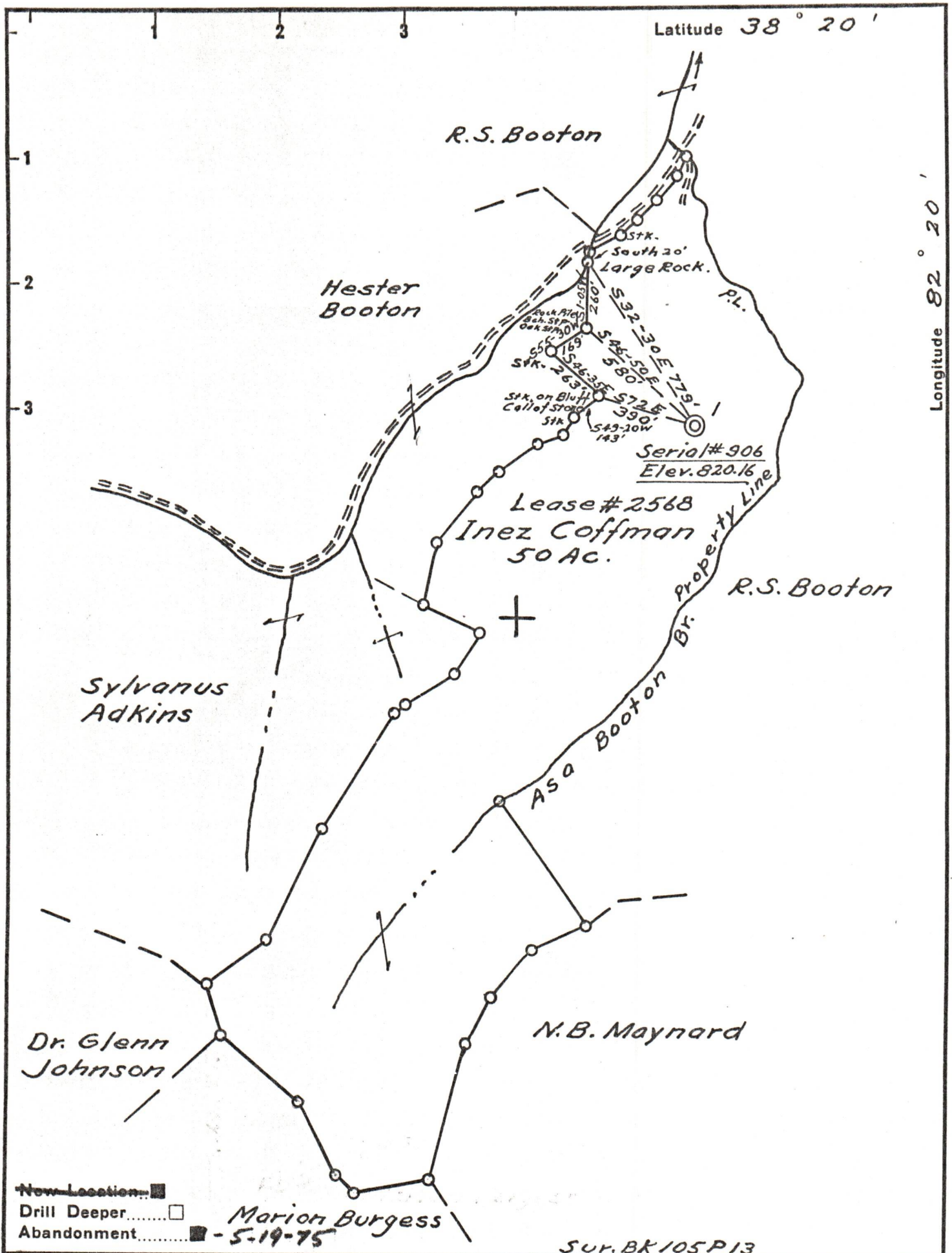

New Location:    
 Drill Deeper:    
 Abandonment:  - 5-19-75

CHARLES L. SKEENS - BRANCLAND, W.VA. 25506   
 Company ~~Owens, Libbey Owens Gas Dept.~~   
 Address: ~~Box 4158 Charleston 4 W.Va.~~   
 Farm Inez Coffman   
 Tract \_\_\_\_\_ Acres 50 Lease No. 2568   
 Well (Farm) No. 1 Serial No. 906   
 Elevation (Spirit Level) 820.16   
 Quadrangle Guyandot 85 4.83" W 3.45"   
 County Wayne District Union   
 Engineer T.S. Flournoy   
 Engineer's Registration No. 269   
 File No. \_\_\_\_\_ Drawing No. \_\_\_\_\_   
 Date April 7, 1955 Scale 1" = 500'

SUR. BK 105 P 13

STATE OF WEST VIRGINIA   
 DEPARTMENT OF MINES   
 OIL AND GAS DIVISION   
 CHARLESTON

WELL LOCATION MAP

FILE NO. WAY-963-P 02/08/2024

+ Denotes location of well on United States Topographic Maps, scale 1 to 62,500, latitude and longitude lines being represented by border lines as shown.

- Denotes one inch spaces on border line of original tracing.

47-099