



STATE OF WEST VIRGINIA  
DEPARTMENT OF MINES  
OIL AND GAS DIVISION

NOTICE OF PROPOSED LOCATION OF OIL AND GAS WELL

To THE DEPARTMENT OF MINES,  
Charleston, W. Va.

Truman Crockett & Martha Blankenship

COAL OPERATOR OR COAL OWNER

R.F.D. #2, Wayne, West Virginia

ADDRESS

COAL OPERATOR OR COAL OWNER

ADDRESS

OWNER OF MINERAL RIGHTS

ADDRESS

Owens, Libbey-Owens Gas Department

NAME OF WELL OPERATOR

P. O. Box 4158, Charleston 4, W. Va.

COMPLETE ADDRESS

July 7, 19 55

PROPOSED LOCATION

Union District

Wayne County

Well No. 943-1 38° 20'  
82° 20'

Truman Crockett Farm

GENTLEMEN:

The undersigned well operator is entitled to drill upon the above named farm or tract of land for oil and gas, ~~having fee title thereto, (or as the case may be)~~ under grant or lease dated January 28, 1954, made by Truman Crockett & Martha Blankenship, to Owens-Illinois Glass Co. & Libbey-Owens-Ford Glass Co., and recorded on the 19th day of May, 1954, in the office of the County Clerk for said County in Book 44, page 466.

The enclosed plat was prepared by a competent engineer and shows the proposed location of a well to be drilled for oil and gas by the undersigned well operator on the farm and in the Magisterial District and County above named, determined by survey and courses and distances from two permanent points, or land marks.

The undersigned well operator is informed and believes there are no coal operators operating beds of coal beneath said farm or tract of land on which said well is located, or within 500 feet of the boundaries of the same, who have mapped their workings and filed their maps as required by law, excepting the coal operators or coal owners (if any) above named as addressees.

The above named coal operators or coal owners (if any) are notified that any objections they may desire to make to such proposed location, or which they are required to make by Section 3 of said Code, if the drilling of a well at said proposed location will cause a dangerous condition in or about their respective coal mines, must be received by, or filed with the Department of Mines within ten\* days from the receipt of a copy of this notice and accompanying plat by said Department. Said coal operators are further notified that forms for use in making such objections will be furnished to them by the Department of Mines promptly on request and that all such objections must set forth as definitely as is reasonably possible the ground or grounds on which such objections are based and indicate the direction and distance the proposed location should be moved to overcome same.

(The next paragraph is to be completed only in Department's copy.)

Copies of this notice and the enclosed plat were mailed by registered mail, or delivered to the above named coal operators or coal owners at their above shown respective address \_\_\_\_\_ day \_\_\_\_\_ before, or on the same day with the mailing or delivery of this copy to the Department of Mines at Charleston, West Virginia.

Very truly yours,

OWENS, LIBBEY-OWENS GAS DEPARTMENT

WELL OPERATOR

P. O. Box 4158

STREET

Charleston 4,

CITY OR TOWN

West Virginia

STATE

02/02/2024

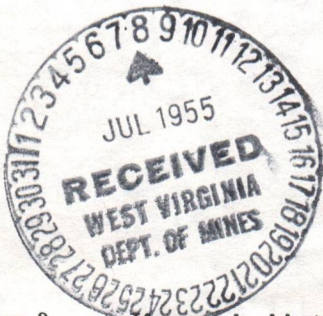

Address of Well Operator }

\*Section 3 . . . . If no such objections be filed or be found by the department of mines, within said period of ten days from the receipt of said notice and plat by the department of mines, to said proposed location, the department shall forthwith issue to the well operator a drilling permit reciting the filing of such plat, that no objections have been made by the coal operators to the location, or found thereto by the department, and that the same is approved and the well operator authorized to proceed to drill at said location.





STATE OF WEST VIRGINIA  
DEPARTMENT OF MINES  
OIL AND GAS DIVISION

NOTICE OF PROPOSED LOCATION OF OIL AND GAS WELL

To THE DEPARTMENT OF MINES,  
Charleston, W. Va.

NAME OF WELL OPERATOR Owens, Libbey-Owens Gas Department	COAL OPERATOR OR COAL OWNER T Truman Crockett & Martha Blankenship
COMPLETE ADDRESS P. O. Box 1258, Charleston 11, W. Va.	ADDRESS R. F. D. #2, Wayne, West Virginia
PROPOSED LOCATION Union District Wayne County	COAL OPERATOR OF COAL OWNER ADDRESS
Well No. 013-1	OWNER OF MINERAL RIGHTS ADDRESS
System T Truman Crockett	

The undersigned well operator is entitled to drill upon the above named farm or tract of land for oil and gas ~~under grant or lease dated~~ January 28, 1951 made by Truman Crockett & Martha Blankenship Owens-Illinois Glass Co. & Libbey-Owens-Ford Glass Co. and recorded on the 19th day of May, 1951 in the office of the County Clerk for said County in Book 44 page 186

The enclosed plat was prepared by a competent engineer and shows the proposed location of a well to be drilled for oil and gas by the undersigned well operator on the farm and in the Magisterial District and County above named determined by survey and courses and distances from two permanent points or land marks.

The undersigned well operator is informed and believes there are no coal operators operating beds of coal beneath said farm or tract of land on which said well is located, or within 500 feet of the boundary of the same, who have mapped their workings and filed their map as required by law, excepting the coal owners or coal owners (if any) above named as witnesses.

The above named coal operators or coal owners (if any) are notified that any objections they may desire to make to such proposed location, or which they are required to make by Section 3 of said Code, if the drilling of a well at said proposed location will cause a dangerous condition in or about their respective coal mines, must be received by or filed with the Department of Mines within ten days from the receipt of a copy of this notice and accompanying plat by said Department. Said coal operators are further notified that forms for use in making such objections will be furnished to them by the Department of Mines promptly on request and that all such objections must set forth as definitely as is reasonably possible the ground or grounds on which such objections are based and indicate the direction and distance the proposed location should be moved to overcome same.

(The next paragraph is to be completed only in Department's copy.)  
Copies of this notice and the enclosed plat were mailed by registered mail, or delivered to the above named coal operators or coal owners at their above shown respective addresses day before, or on the same day with the mailing or delivery of this copy to the Department of Mines at Charleston, West Virginia.

Very truly yours,

OWENS, LIBBEY-OWENS GAS DEPARTMENT

WELL OPERATOR  
P. O. Box 1258  
Charleston 11, West Virginia

Address of Well Operator

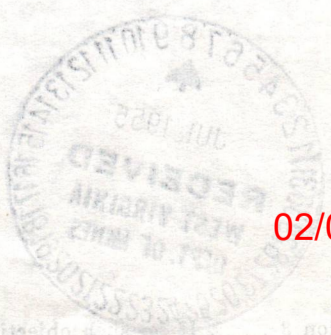

02/02/2024

If an objection be filed or be found by the department of mines within said period of ten days from the receipt of said notice and plat by the department of mines, to said proposed location, the department shall forthwith issue to the well operator a drilling permit requiring the filing of such plat and objections have been made by the coal operators to the location, or found therein by the department, and that the same be approved and the well operator authorized to proceed to drill at said location.

Permit Number WAY-975



A-10

# OWENS, LIBBEY-OWENS GAS DEPARTMENT

5793 MACCORKLE AVENUE

P. O. BOX 4158

CHARLESTON 4, WEST VIRGINIA

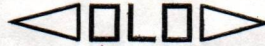

July 7, 1955

State of West Virginia  
Department of Mines  
Oil and Gas Division  
Charleston, West Virginia

Gentlemen:

We are submitting an application for a permit to drill Well No. 943-1 on our Truman Crockett and Martha Blankenship lease, situated in Union District, Wayne County, West Virginia.

Attached to the application is a plat showing the proposed location of said well.

Yours very truly,

OWENS, LIBBEY-OWENS GAS DEPARTMENT

By

  
T. S. Flournoy, Chief Engineer

TSR/ed  
Enclosures  
cc: Mr. Truman Crockett

02/02/2024





STATE OF WEST VIRGINIA  
DEPARTMENT OF MINES

CHARLESTON

July 18, 1955

JULIUS C. OLZER  
CHIEF



Owens, Libbey-Owens Gas Department  
P. O. Box 4158  
Charleston, West Virginia

Gentlemen:

Enclosed are permits for the drilling of the following wells:

<u>Permit No.</u>	<u>Well No.</u>	<u>Farm</u>	<u>District</u>
Lin-1172	1-939	W. O. Morris	Washington
✓ Way-975	1-943	Truman Crockett	Union

COPY

Very truly yours,

Administrative Assistant  
OIL AND GAS DIVISION

CNH:K  
Encl-2

CC: Inspectors Dana E. Lawson  
O. C. Allen





STATE OF WEST VIRGINIA  
DEPARTMENT OF MINES

CHARLESTON

July 18, 1925

JULIUS C. OLKER  
CHIEF

Owens, Libbey-Owens Gas Department  
P. O. Box 1158  
Charleston, West Virginia

Gentlemen:

Enclosed are permits for the drilling of the following

wells:

Permit No.	Well No.	Permittee	District
14-1172	1-939	O. Morris	Washington
Way-925	1-943	Thomas Crockett	Union

Very truly yours,

Administrative Assistant  
OIL AND GAS DIVISION

CHIEF  
Encl-2

CC: Inspector Dana F. Lawson  
O. C. Allen



Formation	Color	Hard or Soft	Top 14	Bottom	Oil, Gas or Water	Depth Found	Remarks
Slate	Black	Soft	1322	1338			
Little Lime	"	Hard	1338	1378			
Pencil Cave	Brown	Soft	1378	1383			
Big Lime	White	Hard	1383	1557			
Injun Sand	Blue	Hard	1557	1715			
Slate	Grey	Soft	1715	1731			
Shell	Blue	Hard	1731	1739			
		correction		1741			Water level 205' at 1739'
Unrecorded	-	-	1741	1748			
Shell	Dark	Hard	1748	1790			
Slate	White	Soft	1790	1831			
Slate	Dark	Soft	1831	1954			
Slate	White	Soft	1954	2095			
Shell	Dark	Hard	2095	2115			
Slate	White	Soft	2115	2178			
Br. Shale	Brown	Soft	2178	2196			
Berea Sand	White	Hard	2196	2213			
Slate	White	Soft	2213	2215			Oil, 2200', show Shut down at 2215' to test Berea Sand for oil and water One quart oil found after 24 hours.
Shell	Grey	Hard	2215	2242			
Slate	White	Soft	2242	2283			
Slate	Dark	Soft	2283	2319			
Br. Shale	Brown	Soft	2319	2369			
Shell	Brown	Hard	2369	2379			
Slate	White	Soft	2379	2430			
Shell	Grey	Hard	2430	2450			Gas 2430', show
Slate	White	Soft	2450	2620			
Slate	Brown	Soft	2620	2642			
Brown Shale	Brown	Soft	2642	2752			
Slate	White	Soft	2752	2778			
Br. Shale	Brown	Soft	2778	2872			Gas 2869, 10/10 W 3/8 = 3.4 M
Slate	White	Soft	2872	2892			Test 2916, 6/10 W 1/8 = 3.0 M
Br. Shale	Brown	Soft	2892	3115			Gas 2936, 22/10 W 3/8 = 5.1 M Test 2949, 22/10 W 3/8 = 5.1 M Gas 2995, 31/10 W 3/8 = 6.1 M Test 3137, 29/10 W 3/8 = 5.9 M
Slate	White	Soft	3115	3137			
		Total Depth		3137			
		Total Depth After Shot		3091			10-5-55 Shot with 8000# Detonite from 2299' to 3137'
							Test B.S., 26/10 W 3/8 = 5.6 M Tests A.S.: 15 Min. 10/10 M 3 = 823 M 1 Hr. 20/10 W 2 1/2 = 219 M 2 Hrs. 20/10 W 2 = 140 M 4 " 31/10 W 1 1/2 = 98 M 8 " 18/10 W 1 1/2 = 75 M 12 " 54/10 W 1 = 57.6 M 18 " 49/10 W 1 = 54.8 M 21 " 46/10 W 1 = 53 M
							Well shut-in in 7" casing 21 hrs. A.S.

02/02/2024

Date October 27, 19 55

APPROVED OWENS, LIBBEY-OWENS GAS DEPARTMENT, Owner

By A. H. Smith (Title) Geologist







STATE OF WEST VIRGINIA  
DEPARTMENT OF MINES  
OIL AND GAS DIVISION

INSPECTOR'S WELL REPORT

Permit No. Way-975

Oil or Gas Well \_\_\_\_\_  
(KIND)

Company	CASING AND TUBING	USED IN DRILLING	LEFT IN WELL	PACKERS
<u>Owenist Libbey Owen Gas Co</u>	Size			Kind of Packer
Address <u>4158 Charleston, W.V.</u>	16			
Farm <u>Human Crockett</u>	13			
Well No. <u>1.</u>	10	<u>30'</u>		Size of
District <u>Union</u> County <u>Wayne</u>	8 1/4	<u>366'</u>		
Drilling commenced <u>Aug-15-55</u>	6 5/8	<u>1739'</u>		Depth set
Drilling completed _____ Total depth _____	5 3/16			
Date shot _____ Depth of shot _____	3			Perf. top
Initial open flow _____ /10ths Water in _____ Inch	2			Perf. bottom
Open flow after tubing _____ /10ths Merc. in _____ Inch	Liners Used			Perf. top
Volume _____ Cu. Ft.				Perf. bottom
Rock pressure _____ lbs. _____ hrs.	CASING CEMENTED _____ SIZE _____ No. FT. _____ Date _____			
Oil _____ bbls., 1st 24 hrs.	COAL WAS ENCOUNTERED AT _____ FEET _____ INCHES			
Fresh water <u>420-535-580</u> feet _____ feet	_____ FEET _____ INCHES FEET _____ INCHES			
Salt water _____ feet _____ feet	_____ FEET _____ INCHES FEET _____ INCHES			

Drillers' Names Howard Pack - E.E. Wilkinson

Remarks: E.J. Elkins cont.

9-26-55  
DATE

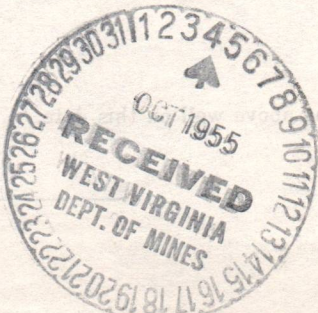

O.C. Allen  
DISTRICT WELL INSPECTOR  
02/02/2024











STATE OF WEST VIRGINIA  
DEPARTMENT OF MINES  
OIL AND GAS DIVISION

INSPECTOR'S WELL REPORT

Permit No. \_\_\_\_\_

Oil or Gas Well \_\_\_\_\_  
(KIND)

		CASING AND TUBING	USED IN DRILLING	LEFT IN WELL	PACKERS
Company _____		Size			Kind of Packer _____
Address _____					
Farm _____		16			
Well No. _____		13			
District _____ County _____		10			Size of _____
Drilling commenced _____		8 1/4			
Drilling completed _____ Total depth _____		6 5/8			Depth set _____
Date shot _____ Depth of shot _____		5 3/16			
Initial open flow _____ /10ths Water in _____ Inch		3			Perf. top _____
Open flow after tubing _____ /10ths Merc. in _____ Inch		2			Perf. bottom _____
Volume _____ Cu. Ft.		Liners Used			Perf. top _____
Rock pressure _____ lbs. _____ hrs.					Perf. bottom _____
Oil _____ bbls., 1st 24 hrs.		CASING CEMENTED _____ SIZE _____ No. FT. _____ Date _____			
Fresh water _____ feet _____ feet		COAL WAS ENCOUNTERED AT _____ FEET _____ INCHES			
Salt water _____ feet _____ feet		_____ FEET _____ INCHES _____ FEET _____ INCHES			

Drillers' Names \_\_\_\_\_

Remarks: \_\_\_\_\_

02/02/2024



STATE OF WEST VIRGINIA  
DEPARTMENT OF MINES  
OIL AND GAS DIVISION

## INSPECTOR'S PLUGGING REPORT

Permit No. WAY-975 Well No. 1-SR-943  
 COMPANY Owens Libb y Owens Gas Dept. ADDRESS P.O. Box 4158  
Charleston 4, W. Va.  
 FARM Truman Crockett DISTRICT Union COUNTY Wayne  
 Filling Material Used Stone, clay and cement

Liner	Location	Amount	Packer	Location
PLUGS USED AND DEPTH PLACED			BRIDGES	
CEMENT-THICKNESS			CONSTRUCTION-LOCATION	
WOOD-SIZE	LEAD	RECOVERED	SIZE	LOST
		1741'6"	7"	0

Drillers' Names K. E. Butcher  
C. V. Hill

Remarks: Bridged hole @ 1260'; Rock 1260'-1220'; clay 1220'-1080'; rock 1080'-1070'; cement 1070'-1060'; Bridged hole @ 610'; rock to 565'; clay 565'-525'; rock 525'-515'; cement 515'-505'; pulling 8-5/8" casing.

4/5/60 I hereby certify I visited the above well on this date.  
DATE

RECEIVED  
 WEST VIRGINIA  
 DEPT. OF MINES  
 DISTRICT WELL INSPECTOR  
 02/02/2024



STATE OF WEST VIRGINIA  
DEPARTMENT OF MINES  
OIL AND GAS DIVISION

INSPECTOR'S WELL REPORT

Permit No. \_\_\_\_\_ Oil or Gas Well \_\_\_\_\_  
(KIND)

		CASING AND TUBING	USED IN DRILLING	LEFT IN WELL	PACKERS
Company _____		Size			Kind of Packer _____
Address _____					
Farm _____		16			
Well No. _____		13			
District _____ County _____		10			Size of _____
Drilling commenced _____		8 1/4			Depth set _____
Drilling completed _____ Total depth _____		6 5/8			
Date shot _____ Depth of shot _____		5 3/16			Perf. top _____
Initial open flow _____ /10ths Water in _____ Inch		3			
Open flow after tubing _____ /10ths Merc. in _____ Inch		2			Perf. bottom _____
Volume _____ Cu. Ft.		Liners Used			Perf. top _____
Rock pressure _____ lbs. _____ hrs.					Perf. bottom _____
Oil _____ bbls., 1st 24 hrs.		CASING CEMENTED _____ SIZE _____ No. FT. _____ Date _____			
Fresh water _____ feet _____ feet		COAL WAS ENCOUNTERED AT _____ FEET _____ INCHES			
Salt water _____ feet _____ feet		_____ FEET _____ INCHES _____ FEET _____ INCHES			

Drillers' Names \_\_\_\_\_

Remarks: \_\_\_\_\_

DATE

DISTRICT WELL INSPECTOR

02/02/2024





STATE OF WEST VIRGINIA  
DEPARTMENT OF MINES  
OIL AND GAS DIVISION

NOTICE OF INTENTION TO PLUG AND ABANDON WELL

(REQUIRED BY SECTION 9, ARTICLE 4, CHAPTER 22 OF THE CODE)

To THE DEPARTMENT OF MINES,  
Charleston, W. Va.

	OWENS, LIBBEY-OWENS GAS DEPARTMENT
COAL OPERATOR OR COAL OWNER	NAME OF WELL OPERATOR
	P. O. Box 4168, Charleston 4, W. Va.
ADDRESS	COMPLETE ADDRESS
	March 23, 19 60
COAL OPERATOR OR COAL OWNER	WELL TO BE ABANDONED
	Union District
ADDRESS	Wayne County
Truman Crockett	Well No. 1 (Serial No. 943)
LEASE OR PROPERTY OWNER	Truman Crockett Farm
R.F.D. #2, Wayne, W. Va.	
ADDRESS	

INSPECTOR - JAMES W. PACK, HAMLIN, W. VA.

Gentlemen:--

The undersigned well operator is about to abandon the above described well and will commence

**24 HOURS IN ADVANCE OF PLUGGING**

the work of plugging and abandoning said well on the 28th day of March, 19 60,  
(which date shall not be less than five days after the day on which this notice so mailed is received,  
or in due course should be received by the Department of Mines.)

This notice is given you in order that your respective representatives may be present at the plugging and filling of said well. You are further notified that whether you are represented or not represented the undersigned will proceed on that date, or shortly thereafter, to plug and fill said well in the manner required by Section 10, Article 4, Chapter 22 of the Code and given in detail on the reverse side of this notice, in "Work Order."

This notice is being mailed by registered mail to each of you at the above addresses on the above date.

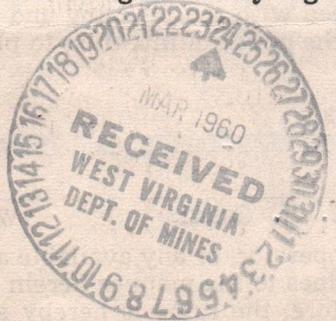

Very truly yours,  
OWENS, LIBBEY-OWENS GAS DEPARTMENT  
*A. H. Smith*  
A. H. Smith, Well Operator.  
Mgr. Land, Engrg. & Geology

02/02/2024

NOTE: Upon the abandonment of all wells drilled prior to June 1, 1929, a plat prepared by a competent engineer, showing the district and county in which the tract of land is located, the name and acreage of same, the names of the owners and adjacent tracts, and the location of the about to be abandoned well, determined by survey, and the courses and distances of such well from two permanent points or landmarks on said tract, shall be submitted with this notice.

(Over)



PROPOSED MANNER OF PLUGGING AND FILLING WELL

(REQUIRED BY RULES AND REGULATIONS)

WEST VIRGINIA DEPARTMENT OF MINES

OIL AND GAS DIVISION

WORK ORDER

Well to be plugged and filled as follows:

as completed 10-6-55 :

10-3/4" casing at 33'  
8-5/8" casing at 366'  
7" casing at 1,741'  
Total Depth 3,137'  
Shot hole 2,300 to 3,137'

Moved in 2/26/50 to clean out and repair.  
As of 3/23/60, could not get below 2,383 feet  
due to cavings.

Set solid bridge 2280 to 2230  
Clay 2230 to 2180  
Rock 2180 to 2175  
Cement 2175 to 2165 (2-1/2 bags)  
Open hole to 1820.

Rock bridge 100 to 50 feet  
(Make sure this is solid)  
Cement 50 to 40 feet (5-1/2 bags)

Pull 10-3/4" casing at 33 ft.

Rock bridge 1820 to 1770  
Cement 1770 to 1760 (2-1/2 bags)  
Pull 7" casing at 1,741 feet.  
Open hole to 1160.

Rock and Clay 40 ft. to surface.

Rock bridge 1160 to 1120  
Clay 1120 to 1080  
Rock 1080 to 1070  
Cement 1070 to 1060 (3-1/2 bags)  
Open hole to 610.

Rock bridge 610 to 565  
Clay 565 to 525  
Rock 525 to 515  
Cement 515 to 505 (3-1/2 bags)  
Open hole to 366 feet.  
Pull 8-5/8" casing at 366  
Open hole to 100 feet.

Erect concrete monument 2' x 2' x 3'

Mark monument "O.L.O. 943"

To the Department of Mines  
Coal Owner or Operator,  
Lease or Property Owner.

Gentlemen:

This "work order" is submitted for your approval and concurrence and unless notified of your disapproval or non-concurrence, the undersigned will proceed with the plugging and filling of said well in the above described manner on the date stated in the notice of intention to plug and abandon the said well on opposite side of this sheet.

Very truly yours,  
OWENS, LIBBEY-OWENS GAS DEPARTMENT

A. H. Smith Well Operator.

No objections have been filed by the coal owner or coal operator, or any available adjacent lease or property owners or interposed by the Department of Mines to the manner herein described for the plugging and filling of the well above mentioned. Therefore, the same is hereby approved. 03/02/2024

25TH day of MARCH, 19 60

DEPARTMENT OF MINES  
Oil and Gas Division

By: M. E. Giffith

NOTE: This "work order" shall be filed in triplicate, one copy for the files of the Department of Mines; one to be approved or corrected and returned to the well operator as his authority for plugging said well; and one for the well inspector.



STATE OF WEST VIRGINIA  
DEPARTMENT OF MINES  
OIL AND GAS DIVISION

AFFIDAVIT OF PLUGGING AND FILLING WELL

AFFIDAVIT SHOULD BE MADE IN TRIPLICATE, ONE COPY MAILED TO THE DEPARTMENT, ONE COPY TO BE RETAINED BY THE WELL OPERATOR AND THE THIRD COPY (AND EXTRA COPIES IF REQUIRED) SHOULD BE MAILED TO EACH COAL OPERATOR AT THEIR RESPECTIVE ADDRESSES.

Truman Crockett  
COAL OPERATOR OR OWNER

R. F. D. #2, Wayne, W. Va.  
ADDRESS

OWENS, LIBBEY-OWENS GAS DEPARTMENT  
NAME OF WELL OPERATOR

P. O. Box 4168, Charleston 4, W. Va.  
COMPLETE ADDRESS

April 18, 19 60  
WELL AND LOCATION

Union District

Wayne County

Well No. 1 (Serial No. 943)

Truman Crockett Farm

STATE INSPECTOR SUPERVISING PLUGGING

AFFIDAVIT

STATE OF WEST VIRGINIA,

County of Wayne

ss:

K. E. Butcher and C. V. Hill

being first duly sworn according to law depose and say that they are experienced in the work of plugging and filling oil and gas wells and were employed by \_\_\_\_\_, well operator, and participated in the work of plugging and filling the above well, that said work was commenced on the 29th day of March, 19 60, and that the well was plugged and filled in the following manner:

SAND OR ZONE RECORD	FILLING MATERIAL			PLUGS USED	CASING	
	FORMATION	CONTENT	FROM TO		SIZE & KIND	CSG PULLED
10-3/4" casing at	33'					
8-5/8" casing at	366					
7" casing at	1,741					
Total Depth	3,137'					
Shot hole	2,300' to 3,137'					
Moved in 2/26/60 to clean out and repair.						
As of 3/23/60, could not get below 2,383 feet due to cavings.						
Set solid bridge		2280	2230			
Clay		2230	2180			
Rock		2180	2175			
Cement	2-1/2 sacks	2175	2165			
Open hole			1820			
COAL SEAMS						
(NAME)				2' x 2' x 3' Concrete		
(NAME)				Marked "O.L.O. 943"		
(NAME)						
(NAME)						

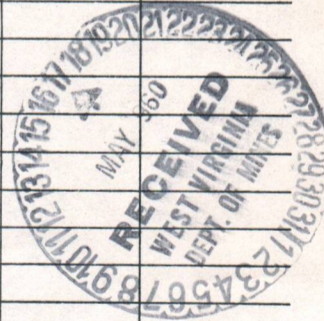

and that the work of plugging and filling said well was completed on the 5th day of April, 19 60.

And further deponents saith not.

Sworn to and subscribed before me this 16th day of May, 19 60.

*K. E. Butcher*  
*C. V. Hill*

02/02/2024

My commission expires:

2/7/67

*Katherine P. Hume*

Notary Public.

Permit No. Way-975-P



STATE OF WEST VIRGINIA  
DEPARTMENT OF MINES  
OIL AND GAS DIVISION

Rock bridge 1820 to 1770  
 Cement 2-1/2 sacks 1770 to 1760  
 Pulled 7" casing at 1,722 feet.  
 Open hole to 1160

Rock bridge 1160 to 1120  
 Clay 1120 to 1080  
 Rock 1080 to 1070  
 Cement 3-1/2 sacks 1070 to 1060  
 Open hole to 610

Rock bridge 610 to 565  
 Clay 565 to 525  
 Rock 525 to 515  
 Cement 3-1/2 sacks 515 to 505  
 Open hole to 366  
 Pulled 8-5/8" casing at 366 feet.  
 Open hole to 100

Rock bridge 100 to 50  
 Cement 5-1/2 sacks 50 to 40  
 Pulled 10-3/4" casing at 33 feet.

Rock and clay 40 to surface

C. V. HALL

K. E. Decker

DATE	DEPTH	DESCRIPTION	REMARKS
	33'	10-3/4" casing at	
	366	8-5/8" casing at	
	1,741	7" casing at	
	3,137	Total Depth	
	2,300' to 3,137'	Shot hole	
		Moved in 2,250' to clean out and retest.	
		As of 2,230', could not get below 2,383 feet due to casing.	
	2230	Get solid bridge	
	2180	Clay	
	2175	Rock	
	2175	Cement 2-1/2 sacks	
	1820	Open hole	

C. V. HALL

K. E. Decker

April 19 1900

02/02/2024



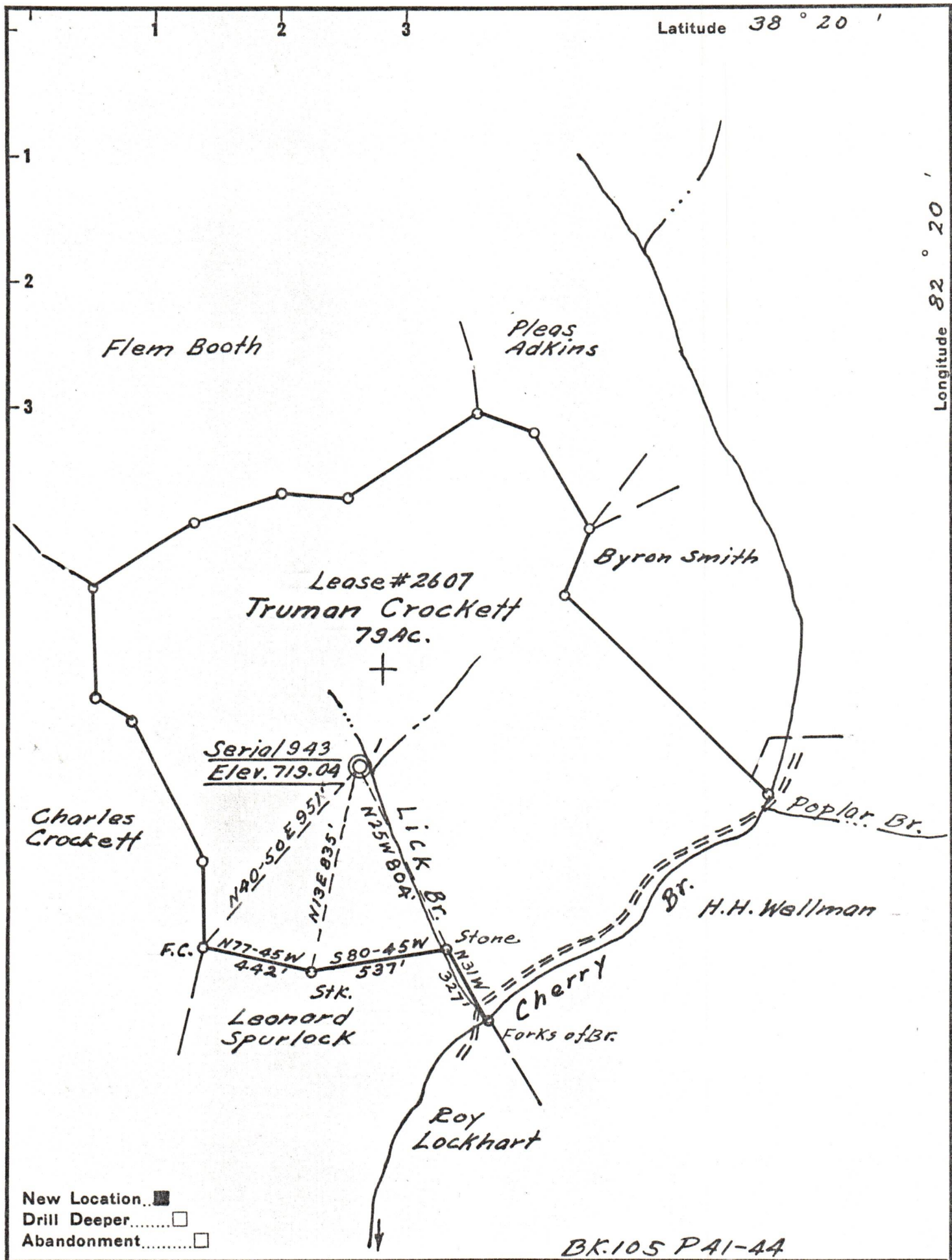

BK.105 PAI-44

Company Owens, Libbey-Owens Gas Dept.  
 Address Box 4158 Charleston 4 W. Va.  
 Farm Truman Crockett  
 Tract \_\_\_\_\_ Acres 79 Lease No. 2607  
 Well (Farm) No. 1 Serial No. 943  
 Elevation (Spirit Level) 719.04  
 Quadrangle Guyandotte 8 S 5.22" W 4.51"  
 County Wayne District Union  
 Engineer T.S. Flournoy  
 Engineer's Registration No. 269  
 File No. \_\_\_\_\_ Drawing No. \_\_\_\_\_  
 Date June 3, 1955 Scale 1" = 500'

STATE OF WEST VIRGINIA  
 DEPARTMENT OF MINES  
 OIL AND GAS DIVISION  
 CHARLESTON

WELL LOCATION MAP  
 FILE NO. WAY-978 02/02/2024

+ Denotes location of well on United States Topographic Maps, scale 1 to 62,500, latitude and longitude lines being represented by border lines as shown.  
 - Denotes one inch spaces on border line of original tracing.