



STATE OF WEST VIRGINIA
DEPARTMENT OF MINES
OIL AND GAS DIVISION

NOTICE OF PROPOSED LOCATION OF OIL AND GAS WELL

To THE DEPARTMENT OF MINES,
Charleston, W. Va.

COAL OPERATOR OR COAL OWNER

ADDRESS

COAL OPERATOR OR COAL OWNER

ADDRESS

United Fuel Gas Co.
OWNER OF MINERAL RIGHTS

Charleston, W. Va.
ADDRESS

United Fuel Gas Co.
NAME OF WELL OPERATOR

Charleston, W. Va.
COMPLETE ADDRESS

May 13, 1958

PROPOSED LOCATION

Lincoln District

Wayne County

Well No. 8661 *Lat. 38°00'*
Lon. 82°25' Elev. 909.44'

United Fuel Gas Co. Min. Tr. #1 Farm

GENTLEMEN:

The undersigned well operator is entitled to drill upon the above named farm or tract of land for oil and gas, having fee title thereto, (or as the case may be) under grant or lease dated December 26, 1946, made by Huntington Development & Gas Co., to United Fuel Gas Co., and recorded on the 27th day of December, 1946, in the office of the County Clerk for said County in Book 234, page 318.

The enclosed plat was prepared by a competent engineer and shows the proposed location of a well to be drilled for oil and gas by the undersigned well operator on the farm and in the Magisterial District and County above named, determined by survey and courses and distances from two permanent points, or land marks.

The undersigned well operator is informed and believes there are no coal operators operating beds of coal beneath said farm or tract of land on which said well is located, or within 500 feet of the boundaries of the same, who have mapped their workings and filed their maps as required by law, excepting the coal operators or coal owners (if any) above named as addressees.

The above named coal operators or coal owners (if any) are notified that any objections they may desire to make to such proposed location, or which they are required to make by Section 3 of said Code, if the drilling of a well at said proposed location will cause a dangerous condition in or about their respective coal mines, must be received by, or filed with the Department of Mines within ten* days from the receipt of a copy of this notice and accompanying plat by said Department. Said coal operators are further notified that forms for use in making such objections will be furnished to them by the Department of Mines promptly on request and that all such objections must set forth as definitely as is reasonably possible the ground or grounds on which such objections are based and indicate the direction and distance the proposed location should be moved to overcome same.

(The next paragraph is to be completed only in Department's copy.)

Copies of this notice and the enclosed plat were mailed by registered mail, or delivered to the above named coal operators or coal owners at their above shown respective address _____ day _____ before, or on the same day with the mailing or delivery of this copy to the Department of Mines at Charleston, West Virginia.

Very truly yours,

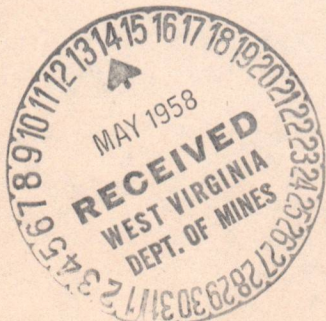

Address of Well Operator }

UNITED FUEL GAS COMPANY
WELL OPERATOR

P. O. Box 1273
STREET

Charleston 25
CITY OR TOWN

West Virginia
STATE

08/18/2023

*Section 3 If no such objections be filed or be found by the department of mines, within said period of ten days from the receipt of said notice and plat by the department of mines, to said proposed location, the department shall forthwith issue to the well operator a drilling permit reciting the filing of such plat, that no objections have been made by the coal operators to the location, or found thereto by the department, and that the same is approved and the well operator authorized to proceed to drill at said location.



STATE OF WEST VIRGINIA
 DEPARTMENT OF MINES
 CHARLESTON

May 24, 1958

C
O
P
Y

United Fuel Gas Company
 P. O. Box 1273
 Charleston 25, West Virginia

Att: Mr. Bernard Moon

Gentlemen:

Please find enclosed permits for drilling the following wells:

Permit No.	Well No.	Farm	District
NIN-578	8644	Mingo Oil & Gas Co. #4	Harvey
WAY-1092	8660	United Fuel Gas Co. Fee	Lincoln
WAY-1093	8661	U. F. G. Co. Min. Tr. #1	Lincoln
WAY-1094	8662	U. F. G. Co. Min. Tr. #1	Lincoln

Please post one copy of each permit at the well site.

Very truly yours,

Assistant Director
 OIL AND GAS DIVISION

RG/dm
 encl:
 cc Mr. Ivan T. Hensen, Inspector

Mr. G. H. Samples, Inspector
 at Large

08/18/2023



STATE OF WEST VIRGINIA
 DEPARTMENT OF MINES
 CHARLESTON

MAY 22, 1928

United Fuel Gas Company
 P. O. Box 1277
 Charleston 25, West Virginia

Attest: Mr. Bernard Hagan

Commissioner

Please find enclosed permits for drilling the following wells:

Permit No.	Well No.	Owner	Location
WV-1098	8002	U. F. C. Co. Min. Tr. Co.	Lincoln
WV-1097	8001	U. F. C. Co. Min. Tr. Co.	Lincoln
WV-1096	8000	United Fuel Gas Co.	Lincoln
KIN-375	8014	Kings Oil & Gas Co.	Harvey

Please post one copy of each permit at the well

also.

Very truly yours,

Assistant Director
 OIL AND GAS DIVISION

cc Mr. Ivan T. Henson, Inspector
 Mr. G. W. Samples, Inspector
 at large

COPY



STATE OF WEST VIRGINIA
DEPARTMENT OF MINES
OIL AND GAS DIVISION

Quadrangle Naugatuck

Permit No. WAY-1093

WELL RECORD

Oil or Gas Well Gas
(KIND)

Company United Fuel Gas Co.
 Address P.O. Box 1273; Charleston 25, W. Va.
 Farm United Fuel Gas Co. Min. Tr. #1 Acres 13,232.32
 Location (waters) Horse Creek
 Well No. 8661 Elev. 809.44'
 District Lincoln County Wayne
 The surface of tract is owned in fee by _____
 Address _____
 Mineral rights are owned by United Fuel Gas Co.
 Address Charleston, W. Va.
 Drilling commenced 2-11-59
 Drilling completed 4-9-59
 Date Shot 4-15-59 From 1937 To 2813
 With 8,600# DuPont Gelatin
 Open Flow 7 /10ths Water in 2 Inch
 _____ /10ths Merc. in _____ Inch
 Volume 112,000 - Berea Cu. Ft.
 Rock Pressure 355 lbs. 48 hrs.
 Oil _____ bbls., 1st 24 hrs.
 WELL ACIDIZED _____
 WELL FRACTURED _____

Casing and Tubing	Used in Drilling	Left in Well	Packers
Size			
16			Hookwall
13 3/8		12'	Kind of Packer
10 3/4		207	3 1/2" x 7" x 16"
8 1/4			Size of _____
7 5/8		1200	Depth set
5 3/16			1324'
3 1/2		2026	Perf. top _____
2			Perf. bottom _____
Liners Used			Perf. top _____
			Perf. bottom _____

CASING CEMENTED	SIZE	No. Ft.	Date
COAL WAS ENCOUNTERED AT <u>142</u> FEET <u>36</u> INCHES			
_____	FEET	INCHES	FEET INCHES
_____	FEET	INCHES	FEET INCHES

RESULT AFTER TREATMENT _____
 ROCK PRESSURE AFTER TREATMENT _____
 Fresh Water 145 Feet Salt Water _____ Feet

Formation	Color	Hard or Soft	Top	Bottom	Oil, Gas or Water	Depth	Remarks
Surface			0	8	Water 145'		
Slate			8	18			
Sand			18	130	Gas 462-467'		
Slate & Shells			130	142			
Coal			142	145	Gas 1937-1942'	6/10 W 1" 25 M	
Slate & Shells			145	475			
Sand			475	500	Test before shot 3/10 W 1" 18 M		
Slate			500	525	Shot 4-15-59 with 8,600# DuPont Gelatin		
Broken Sand			525	620	from 1937-2813'		
Salt Sand			620	810	Test 1 hour after shot 8 1/10 W 2" 379 M		
Slate			810	820	Test 19 hours after shot 7/10 W 2" 112 M		
Broken Sand			820	855			
Slate			855	905			
Sand			905	975			
Slate			975	1080			
Red Rock			1080	1086			
Slate & Shells			1086	1135			
Red Rock			1135	1140			Shut in 4-17-59 in 3 1/2" tubing.
Slate & Shells			1140	1163			
Little Lime			1163	1186			
Big Lime			1186	1370			
Injun Sand			1370	1535			
Slate & Shells			1535	1917			
Coffee Shale			1917	1937			
Berea Grit			1937	2035			
Slate			2035	2050			
Brown Shale			2050	2120			
Light Shale			2120	2300			
Brown Shale			2300	2404			
Light Shale			2404	2590			

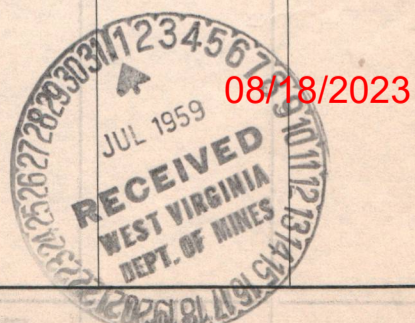

(over)

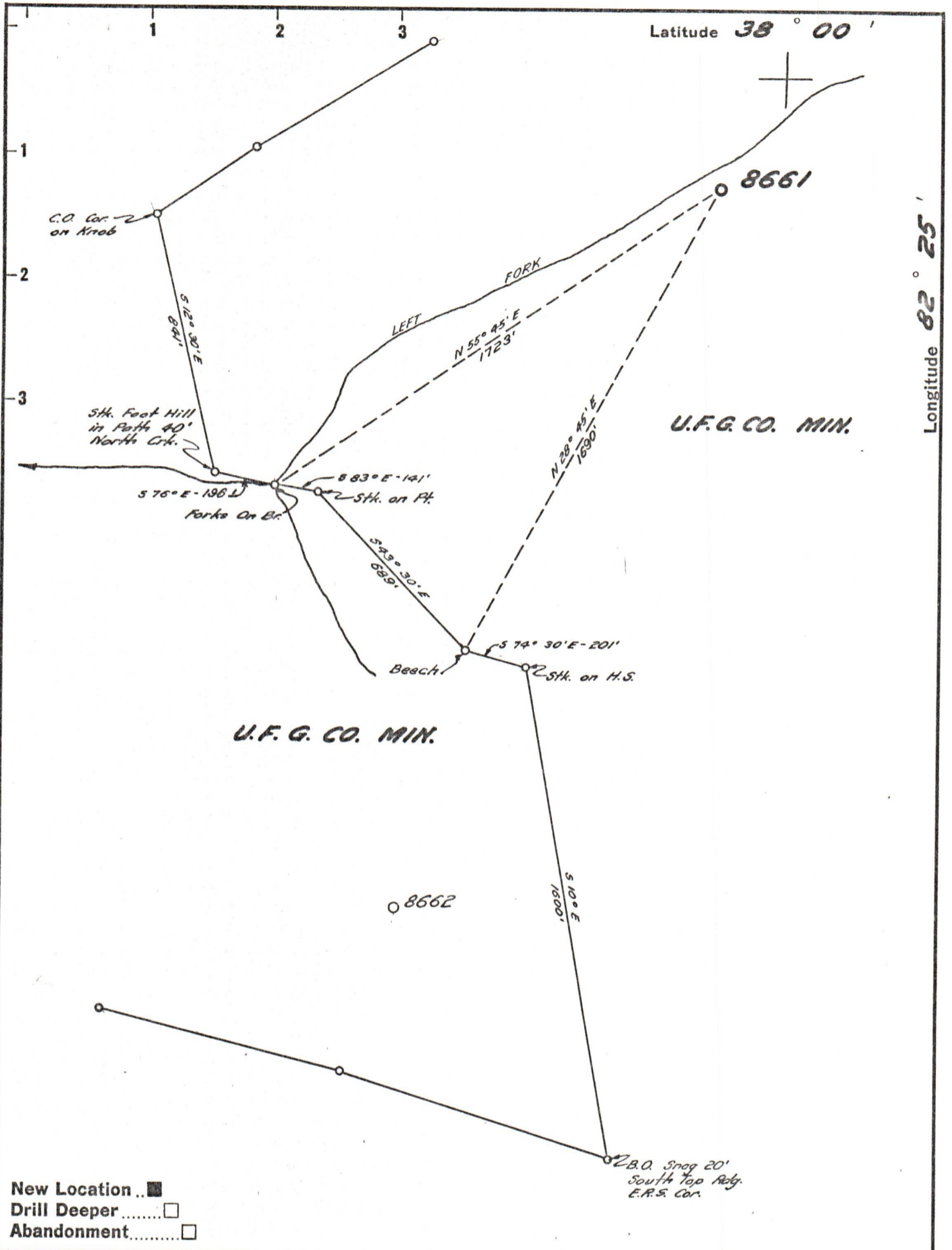

New Location
 Drill Deeper
 Abandonment

Company UNITED FUEL GAS CO.
 Address CHARLESTON, W. VA.
 Farm UNITED FUEL GAS CO. MIN.
 Tract 1 Acres 13,232.32 Lease No. NO. REF.
 Well (Farm) No. _____ Serial No. 8661
 Elevation (Spirit Level) 809.44'
 Quadrangle NAUGATUCK
 County WAYNE District LINCOLN
 Engineer Hubert R. Shnell
 Engineer's Registration No. 2529
 File No. 18-33 Drawing No. _____
 Date 4-23-58 Scale 1" = 400'

STATE OF WEST VIRGINIA
 DEPARTMENT OF MINES
 OIL AND GAS DIVISION
 CHARLESTON

WELL LOCATION MAP
 FILE NO. WAY-1075 08/18/2023

+ Denotes location of well on United States Topographic Maps, scale 1 to 62,500, latitude and longitude lines being represented by border lines as shown.
 - Denotes one inch spaces on border line of original tracing.