



STATE OF WEST VIRGINIA
DEPARTMENT OF MINES
OIL AND GAS DIVISION

NOTICE OF PROPOSED LOCATION OF OIL AND GAS WELL

To THE DEPARTMENT OF MINES,
Charleston, W. Va.

Charley & Lona Queen

~~COAL OPERATOR~~ COAL OWNER

R. F. D. #1, Wayne, West Virginia

ADDRESS

COAL OPERATOR OR COAL OWNER

ADDRESS

Same

OWNER OF MINERAL RIGHTS

ADDRESS

Owens, Libbey-Owens Gas Department

NAME OF WELL OPERATOR

P. O. Box 4158, Charleston 4, W. Va.

COMPLETE ADDRESS

May 23, 1958

PROPOSED LOCATION

Butler District

Wayne County

Well No. 1045-1 *Lat. 38° 15'*
Lon. 82° 15' Elev. 822.5

Charley Queen Farm

GENTLEMEN:

The undersigned well operator is entitled to drill upon the above named farm or tract of land for oil and gas, ~~having fee title thereto, (or as the case may be)~~ under grant or lease dated 7/30/1948, made by Charley & Lona Queen, to Owens-Illinois Glass Co. & Libbey-Owens-Ford Glass Co., and recorded on the 13th day of August, 1948, in the office of the County Clerk for said County in Book 37, page 433.

The enclosed plat was prepared by a competent engineer and shows the proposed location of a well to be drilled for oil and gas by the undersigned well operator on the farm and in the Magisterial District and County above named, determined by survey and courses and distances from two permanent points, or land marks.

The undersigned well operator is informed and believes there are no coal operators operating beds of coal beneath said farm or tract of land on which said well is located, or within 500 feet of the boundaries of the same, who have mapped their workings and filed their maps as required by law, excepting the coal operators or coal owners (if any) above named as addressees.

The above named coal operators or coal owners (if any) are notified that any objections they may desire to make to such proposed location, or which they are required to make by Section 3 of said Code, if the drilling of a well at said proposed location will cause a dangerous condition in or about their respective coal mines, must be received by, or filed with the Department of Mines within ten* days from the receipt of a copy of this notice and accompanying plat by said Department. Said coal operators are further notified that forms for use in making such objections will be furnished to them by the Department of Mines promptly on request and that all such objections must set forth as definitely as is reasonably possible the ground or grounds on which such objections are based and indicate the direction and distance the proposed location should be moved to overcome same.

(The next paragraph is to be completed only in Department's copy.)

Copies of this notice and the enclosed plat were mailed by registered mail, or delivered to the above named coal operators or coal owners at their above shown respective address same day ~~before~~, or on the same day with the mailing or delivery of this copy to the Department of Mines at Charleston, West Virginia.

Very truly yours,

OWENS, LIBBEY-OWENS GAS DEPARTMENT

WELL OPERATOR

P. O. BOX 4158

STREET

CHARLESTON 4, WEST VIRGINIA

CITY OR TOWN

08/18/2023

STATE

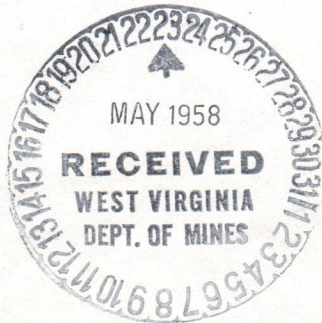

Address of Well Operator }

*Section 3 If no such objections be filed or be found by the department of mines, within said period of ten days from the receipt of said notice and plat by the department of mines, to said proposed location, the department shall forthwith issue to the well operator a drilling permit reciting the filing of such plat, that no objections have been made by the coal operators to the location, or found thereto by the department, and that the same is approved and the well operator authorized to proceed to drill at said location.

BLANKET BOND

1099

WAV-1099 PERMIT NUMBER



STATE OF WEST VIRGINIA
DEPARTMENT OF MINES
OIL AND GAS DIVISION

NOTICE OF PROPOSED LOCATION OF OIL AND GAS WELL

To The Department of Mines
Charleston, W. Va.

Charley & John Green

Owens, Libbey-Owens Gas Department

R. F. D. #1, Wayne, West Virginia

P. O. Box #158, Charleston, W. Va.

May 23, 1938

PROPOSED LOCATION

Butler

Wayne

Job No. 1055-1

Charley Green

The undersigned well operator is entitled to drill upon the above named farm or tract of land for oil and gas under grant or lease dated 7/30/35 to

Charley & John Green

Owens-Illinois Glass Co. & Libbey-Owens-Ford Glass Co. and recorded on the 13th day

of August, 1938 in the office of the County Clerk for said County in

Page 27

The enclosed plat was prepared by a competent engineer and shows the proposed location of a well to be drilled for oil and gas by the undersigned well operator on the farm and in the Magisterial District and County above named determined by survey and courses and distances from two permanent points or land marks.

The undersigned well operator is informed that before there are no coal operator operating beds of coal beneath said farm or tract of land on which said well is located or within 300 feet of the boundary of the same, the above named well operator and the other parties as required by law, excepting the coal operators or coal owners (if any) above named as addressees.

The above named coal operators or coal owners (if any) are notified that any objections they may desire to make to said proposed location or which they are required to make by Section 8 of said Code, if the drilling of a well at said proposed location will cause a dangerous condition in or about their respective coal mines, must be received by or filed with the Department of Mines within ten days from the receipt of a copy of this notice and accompanying plat by said Department. Said coal operators are further notified that copies of this notice and accompanying plat will be furnished to them by the Department of Mines promptly on request and that all such objections must set forth as definitely as is reasonably possible the ground or grounds on which such objections are based and indicate the direction and distance the proposed location should be moved to overcome same.

The next paragraph is to be completed only in Department's copy.

Copies of this notice and the enclosed plat were mailed by registered mail or delivered to the above named coal operators or coal owners at their above shown respective address _____ on the same day with the mailing or delivery of this copy to the Department of Mines at Charleston, West Virginia.

Very truly yours,

OWENS, LIBBEY-OWENS GAS DEPARTMENT

P. O. BOX #158

CHARLESTON 4, WEST VIRGINIA

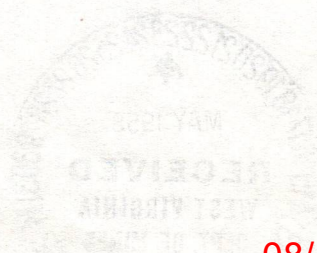

08/18/2023

Section 8. . . . If no such objections be filed or be found by the department of mines within said period of ten days from the receipt of this notice and plat by the department of mines, it is hereby declared that the proposed location of a well to be drilled for oil and gas by the undersigned well operator is a lawful location and that no objections have been made by the coal operators or coal owners to the location of said well and that the same is approved and the well operator is entitled to proceed to drill at said location.

Permit Number 1055-1

June 2, 1958

Owens, Libby-Owens Gas Department
P. O. Box 4158
Charleston 4, West Virginia

Att: Mr. T. S. Flourney

Gentlemen:

Please find enclosed permits for drilling the following wells:

<u>Permit No.</u>	<u>Well No.</u>	<u>Farm</u>	<u>District</u>
WAY-1098	1036 - 1	L. C. Knight	Union
WAY-1099	1045 - 1	Charley Queen	Butler

Please post one copy of the permit at the well site.

Very truly yours,

Assistant Director
OIL AND GAS DIVISION

MG/dm

encl:

cc Mr. G. H. Samples, Inspector at Large

Mr. R. C. Tucker, Assistant State Geologist

08/18/2023



State of West Virginia

Department of Mines
Oil and Gas Division
Charleston 5

MARIE GRIFFITH
EXECUTIVE SECRETARY

January 29, 1965

W. F. EIGENBROD
DIRECTOR

GURMER WAMOCK
DEPUTY DIRECTOR

Owens, Libbey Owens Gas Department
P. O. Box 4158
Charleston, West Virginia

Att: Mr. A. H. Smith

File

RE: PERMIT WAY-1099-P
WELL I-Sr-1045
FARM Charley Queen
DISTRICT Butler
COUNTY Wayne

Gentlemen:

Please send us the affidavit of filling and plugging for the above described well. If plugging has not been completed, please advise.

We will appreciate the information within the next ten days.

Very truly yours,

Marie E. Griffith
Executive Secretary
OIL AND GAS DIVISION



MEG/ap

AFFIDAVIT, FORM OG-8, MANNER WELL PLUGGED MUST BE SUBMITTED TO OBTAIN RELEASE OF WELL UNDER BOND.

This work has been postponed due to bad weather, and the well is scheduled to be plugged after March 1st of this year.

Tom Mollen copy
Tom Mollencop

08/18/2023

January 22, 1962

Owens, Lipsey Owens Gas Department
P. O. Box 1190
Charleston, West Virginia
Att: Mr. L. M. Smith

Mr. J. M. Smith
Mr. L. M. Smith
Mr. J. M. Smith
Mr. J. M. Smith
Mr. J. M. Smith

Enclosure

Please advise
the above and will
be glad to advise

mg/sp

ATTENTION: FORM OF A MANAGER WILL BE REQUIRED
SUBMITTED TO OBTAIN RELEASE OF WELL UNDER BOND

The work has been completed and the well is being
reworked and will be ready for production in
the near future.

08/18/2023



STATE OF WEST VIRGINIA
DEPARTMENT OF MINES
OIL AND GAS DIVISION 12

Quadrangle Wayne

Permit No. Way-1099

WELL RECORD

Oil or Gas Well Gas
(KIND)

Company OWENS, LIBBEY-OWENS GAS DEPARTMENT
Address P. O. Box 4168, Charleston 4, W. Va.
Farm Charley Queen Acres 116
Location (waters) _____
Well No. 1 (Serial No. 1045) Elev. 822.46
District Butler County Wayne
The surface of tract is owned in fee by _____
Address _____
Mineral rights are owned by Charley & Lona Queen
R.F.D. #1 Address Wayne, W. Va.
Drilling commenced 6-27-58
Drilling completed 8-13-58
Date Shot 8-14; 18; 20 From 2041 To 2051
With 100#; 383-1/2#; 1700# Gelatin
Open Flow /10ths Water in _____ Inch
/10ths Merc. in _____ Inch
Volume Berea 58 M Cu. Ft.
Rock Pressure 490 lbs. 48 hrs.
Oil _____ bbls., 1st 24 hrs.
WELL ACIDIZED _____
WELL FRACTURED _____

Casing and Tubing	Used in Drilling	Left in Well	Packers
Size			Kind of Packer
16			"Oilwell" W & A
13			Size of
10			6-5/8 x 3-1/2 x 16
8 1/4 5/8	383'2"	383'2"	Depth set
6 3/4 7	1581'8"	1581'8"	2057-2063
5 3/16			Perf. top
3 1/2	---	2078'3"	Perf. bottom 20'
2			(2056-2076)
Liners Used			Perf. top
			Perf. bottom

CASING CEMENTED _____ SIZE _____ No. Ft. _____ Date _____
COAL WAS ENCOUNTERED AT 150 FEET 24 INCHES
_____ FEET _____ INCHES _____ FEET _____ INCHES
_____ FEET _____ INCHES _____ FEET _____ INCHES

RESULT AFTER TREATMENT _____
ROCK PRESSURE AFTER TREATMENT _____
Fresh Water 235, 340, 365, 508 Feet Salt Water _____ Feet

Formation	Color	Hard or Soft	Top	Bottom	Oil, Gas or Water	Depth	Remarks
Clay	Yellow	Soft	0	15			
Sand	Yellow	Soft	15	35			
Sand	Light	Soft	35	50			
Slate	Light	Soft	50	63			
Slate	Red	Soft	63	79			
Slate	Light	Soft	79	95			
Slate	Grey	Soft	95	140'			
Slate	Dark	Soft	140	150			
Coal	Black	Soft	150	152			
Slate	Light	Soft	152	216			
Sand	White	Soft	216	275	Water at 235', 1 B.P.H.		
Slate	Dark	Soft	275	280			
Sand	Grey	Soft	280	310			
Slate	Dark	Soft	310	324			
Sand	Light	Soft	324	371	Water at 340', 2 B.P.H.		
Slate	Light	Soft	371	405	Water at 365', 3 B.P.H.		
Slate	Dark	Soft	405	430	7-3-58 Ran 8-5/8" casing on shoe at 383'2"		
Slate	Light	Soft	430	460	SIM 430 = Sand IM 430		
Sand	Light	Soft	460	514	Water at 460, 2-1/2 B.P.H.		
Slate	Grey	Soft	514	556	Water at 508, 4-1/2 B.P.H.		
Sand	Light	Soft	556	600			
Slate & Shls.	Light	Soft	600	663			
Slate	Light	Soft	663	681			
Sand	Light	Soft	681	701			
Slate	Grey	Soft	701	713			
S. & Shls.	Dark	Soft	713	732			
Salt Sand	White	Hard	732	754			
Sand	White	Hard	754	759			

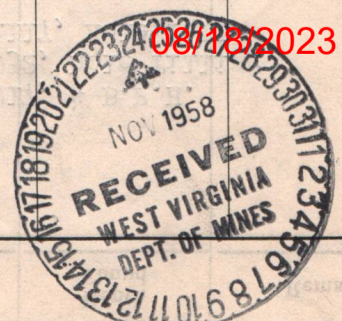

	Color	Hard or Soft	Top 12	Bottom	Oil, Gas or Water	Depth Found	Remarks
Shls.	Light	Soft	759	807			
	Light	Med.	807	817			
	Light	Soft	817	879			
Shls.	Light	Soft	879	899			
	White	Soft	899	963	Water at 917, 4 B.P.H.		
	White	Med.	963	1117	Water at 932, hole filling		
	Light	Med.	1117	1135	Water at 1117, hole full		
	Light	Med.	1135	1139			
	Light	Med.	1139	1150	Water level 270' at 1146'		
	Light	Soft	1150	1155			
	Light	Med.	1155	1232			
	White	Hard	1232	1244			
Little Lime	Grey	Hard	1244	1258			
late Br.			1258	1260			
Big Lime	Light	Hard	1260	1426	SIM 1391 = Sand IM 1391		
Grey Injun	Grey	Med.	1426	1506			
Slate Br.			1506	1508			
Grey Injun	Grey	Med.	1508	1537			
Sand	Light	Med.	1537	1547			
Grey Injun	Grey	Med.	1547	1563			
Gritty Shells	Grey	Med.	1563	1580	Water level 270' at 1580'		
Sl. & Shls.	Light	Med.	1580	1594	7-24-58 Running reamer.		
					7-28-58 7" casing cemented in at 1582'		
					by Halliburton Co.; used 6 sacks aqua		
					& 25 sacks cement. 15' cement in casing		
					Dried up hole at 1594'		
Sl. & Shls.	Light	Soft	1594	1748	Water at 1625', 113 gal.		
Shells	Grey	Med.	1748	1761			
Sl. & Shls.	White	Soft	1761	1791	Water at 1791', 6 gal. per hour		
Slate	Light	Soft	1791	1828			
Sl. & Shls.	Light	Soft	1828	1863			
Slate	Light	Soft	1863	1886			
Shells	Grey	Med.	1886	1894			
Sl. & Shls.	Light	Soft	1894	1957			
Shells	Grey	Hard	1957	1960			
Lime Shells	Grey	Med.	1960	1980			
Sl. & Shls.	Grey	Soft	1980	2010			
Slate	Dark	Soft	2010	2018			
Slate	Light	Soft	2018	2026			
Coffee Shale	Dark	Soft	2026	2041	SIM 2041 = Sand IM 2040		
Berea Sand	Grey	Hard	2041	2048	Gas 2043		33.2 MCF
					Gas 2046		38.3
Slate	Grey	Soft	2048	2050	Test 2050		36.7
Shells	Grey	Hard	2050	2061	Test 2056		35
Slate	Light	Soft	2061	2075	Test 2075		34.1
					SIM 2075 = Sand IM 2073		
					8-13; 14 Bailing water & getting ready		
					for shot.		
					Test 7:15 A.M.		(29 MCF)
					Shot well with 100# Gelatin from 2041 to		
					2051 ft. Tamped with 25' pea gravel.		
					Time bomb set for 2 hours.		
					8-15-58 Tests while cleaning out:		
					8 A.M.		106 MCF
					1 P.M.		71
					7 P.M.		66
					2 A.M.		63
					8 A.M.		61
					8 P.M.		60
					12 P.M.		57
					Cleaned out to 2059 ft.		
					8-18-58		
					Shot well with 383-1/2# Gelatin from		
					2041 to 2051 ft. Tamped with 25' pea		
					gravel. Time bomb set for 2 hours.		

Date November 20, 19 58

APPROVED OWENS, LIBBEY-OWENS GAS DEPARTMENT, Owner

By A. H. Smith (Title) Geologist

08/18/2023



STATE OF WEST VIRGINIA DEPARTMENT OF MINES OIL AND GAS DIVISION 12A

Quadrangle Wayne

Permit No. Way-1099

WELL RECORD

Oil or Gas Well Gas (KIND)

Company OWENS, LIBBEY-OWENS GAS DEPARTMENT
Address P. O. Box 4168, Charleston 4, W. Va.
Farm Charley Queen Acres 116
Location (waters) _____
Well No. 1 (Serial No. 1045) Elev. _____
District _____ County _____
The surface of tract is owned in fee by _____
Address _____
Mineral rights are owned by _____
Address _____
Drilling commenced 6-27-58
Drilling completed 8-13-58
Date Shot _____ From _____ To _____
With _____
Open Flow _____ /10ths Water in _____ Inch
_____ /10ths Merc. in _____ Inch
Volume 58,000 Cu. Ft.
Rock Pressure _____ lbs. _____ hrs.
Oil _____ bbls., 1st 24 hrs.
WELL ACIDIZED _____
WELL FRACTURED _____

Table with columns: Casing and Tubing, Used in Drilling, Left in Well, Packers. Rows include tubing sizes (16, 13, 10, 8 1/4, 6 5/8, 5 3/16, 3, 2) and packer types (Kind of Packer, Size of, Depth set, Perf. top, Perf. bottom).

CASING CEMENTED _____ SIZE _____ No. Ft. _____ Date _____

COAL WAS ENCOUNTERED AT _____ FEET _____ INCHES
_____ FEET _____ INCHES
_____ FEET _____ INCHES

RESULT AFTER TREATMENT _____
ROCK PRESSURE AFTER TREATMENT _____
Fresh Water _____ Feet Salt Water _____ Feet

Main data table with columns: Formation, Color, Hard or Soft, Top, Bottom, Oil, Gas or Water, Depth, Remarks. Contains detailed well logs including tests, cleaning operations, and final flow data.

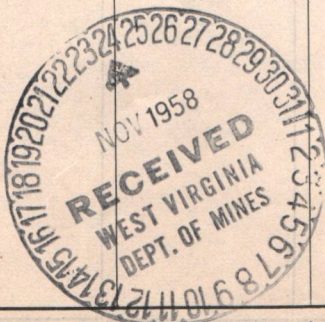

08/18/2023

Formation	Color	Hard or Soft	Top	Bottom	Oil, Gas or Water	Depth Found	Remarks
						3:30 P.M.	
							20 H.C.F.
							21 H.C.F.
							22 H.C.F.
							23 H.C.F.
							24 H.C.F.
							25 H.C.F.
							26 H.C.F.
							27 H.C.F.
							28 H.C.F.
							29 H.C.F.
							30 H.C.F.
							31 H.C.F.
							32 H.C.F.
							33 H.C.F.
							34 H.C.F.
							35 H.C.F.
							36 H.C.F.
							37 H.C.F.
							38 H.C.F.
							39 H.C.F.
							40 H.C.F.
							41 H.C.F.
							42 H.C.F.
							43 H.C.F.
							44 H.C.F.
							45 H.C.F.
							46 H.C.F.
							47 H.C.F.
							48 H.C.F.
							49 H.C.F.
							50 H.C.F.

08/18/2023

Date November 20, 1958

APPROVED OWENS, LIBBEY-OWENS GAS DEPARTMENT, Owner

By A. H. Smith (Title) Geologist



STATE OF WEST VIRGINIA
DEPARTMENT OF MINES
OIL AND GAS DIVISION

INSPECTOR'S PLUGGING REPORT

Permit No. Way-1099P Well No. 1
 COMPANY Quinn-Libby-Owens ADDRESS Charleston, W.Va.
 FARM Charley Green DISTRICT Butler COUNTY Wayne
 Filling Material Used Clay Stone Cement

Liner		Location	Amount	Packer	Location	
PLUGS USED AND DEPTH PLACED			BRIDGES		CASING AND TUBING	
CEMENT-THICKNESS	WOOD-SIZE	LEAD	CONSTRUCTION-LOCATION		RECOVERED	SIZE
<u>1940-1950</u>			<u>Stone</u>		<u>2078</u>	<u>3"</u>
<u>1590-1600</u>			<u>Bridge</u>			
		<u>1620-1650</u>	<u>Clay</u>			
			<u>1610-1620</u>			
			<u>Stone</u>			
			<u>1600-1610</u>			

Drillers' Names Marple Curry
Co. Tools

Remarks: 3" Tubing pulled on 5-10.

5-13-65 I hereby certify I visited the above well on this date.
DATE

K.E. Butcher
DISTRICT WELL INSPECTOR



08/18/2023

STATE OF WEST VIRGINIA
DEPARTMENT OF MINES
OIL AND GAS DIVISION

Rotary
Spudder
Cable Tools
Storage

INSPECTOR'S WELL REPORT

Permit No. _____

Oil or Gas Well _____
(KIND)

Company _____ Address _____ Farm _____ Well No. _____ District _____ County _____ Drilling commenced _____ Drilling completed _____ Total depth _____ Date shot _____ Depth of shot _____ Initial open flow _____/10ths Water in _____ Inch Open flow after tubing _____/10ths Merc. in _____ Inch Volume _____ Cu. Ft. Rock pressure _____ lbs. _____ hrs. Oil _____ bbls., 1st 24 hrs. Fresh water _____ feet _____ feet Salt water _____ feet _____ feet	CASING AND TUBING	USED IN DRILLING	LEFT IN WELL	PACKERS
	Size 16 13 10 8 1/4 6 5/8 5 3/16 3 2 Liners Used			
CASING CEMENTED _____ SIZE _____ No. FT. _____ Date _____ NAME OF SERVICE COMPANY _____ COAL WAS ENCOUNTERED AT _____ FEET _____ INCHES _____ FEET _____ INCHES _____ FEET _____ INCHES _____ FEET _____ INCHES _____ FEET _____ INCHES				

Drillers' Names _____

Remarks: _____

DATE

DISTRICT WELL INSPECTOR
08/18/2023

STATE OF WEST VIRGINIA
DEPARTMENT OF MINES
OIL AND GAS DIVISION

INSPECTOR'S PLUGGING REPORT

Permit No. Way-1099P Well No. 1
 COMPANY Owens-Libby Owens ADDRESS Charleston, W.Va.
 FARM Charley Queen DISTRICT Butler COUNTY Wayne
 Filling Material Used Clay stone cement

PLUGS USED AND DEPTH PLACED			BRIDGES	CASING AND TUBING		
CEMENT-THICKNESS	WOOD-SIZE	LEAD	CONSTRUCTION-LOCATION	RECOVERED	SIZE	LOST
703-713	3 1/2	sacks	Stone Bridge 761-811	811-	7"	770-
430-440			Clay 713-761	383-	8"	
			Stone 5740-580-			
			Clay 440-540-			

Drillers' Names Marple Curry
Co. Tools
 Remarks:

5-19-65 I hereby certify I visited the above well on this date.
DATE
5-21-65

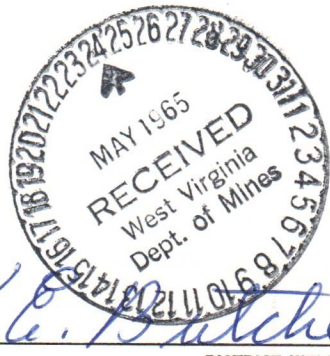

K. G. Butcher
 DISTRICT WELL INSPECTOR

08/18/2023

STATE OF WEST VIRGINIA
DEPARTMENT OF MINES
OIL AND GAS DIVISION

- Rotary
- Spudder
- Cable Tools
- Storage

INSPECTOR'S WELL REPORT

Permit No. _____

Oil or Gas Well _____
(KIND)

	CASING AND TUBING	USED IN DRILLING	LEFT IN WELL	PACKERS
Company _____	Size			
Address _____	16 _____			Kind of Packer _____
Farm _____	13 _____			
Well No. _____	10 _____			Size of _____
District _____ County _____	8 1/4 _____			
Drilling commenced _____	6 5/8 _____			Depth set _____
Drilling completed _____ Total depth _____	5 3/16 _____			
Date shot _____ Depth of shot _____	3 _____			Perf. top _____
Initial open flow _____ /10ths Water in _____ Inch	2 _____			Perf. bottom _____
Open flow after tubing _____ /10ths Merc. in _____ Inch	Liners Used _____			Perf. top _____
Volume _____ Cu. Ft.				Perf. bottom _____
Rock pressure _____ lbs. _____ hrs.	CASING CEMENTED _____ SIZE _____ No. FT. _____ Date _____			
Oil _____ bbls., 1st 24 hrs.	NAME OF SERVICE COMPANY _____			
Fresh water _____ feet _____ feet	COAL WAS ENCOUNTERED AT _____ FEET _____ INCHES			
Salt water _____ feet _____ feet	_____ FEET _____ INCHES _____ FEET _____ INCHES			
	_____ FEET _____ INCHES _____ FEET _____ INCHES			

Drillers' Names _____

Remarks:

DATE

DISTRICT WELL INSPECTOR

08/18/2023

STATE OF WEST VIRGINIA
DEPARTMENT OF MINES
OIL AND GAS DIVISION

INSPECTOR'S PLUGGING REPORT

Permit No. Way-1099P Well No. 1

COMPANY Owens-Libby-Owens ADDRESS Charleston, W. Va.

FARM Charley Queen DISTRICT Butler COUNTY Wayne

Filling Material Used Clay Stone Cement

Liner Location Amount Packer Location

PLUGS USED AND DEPTH PLACED			BRIDGES	CASING AND TUBING		
CEMENT-THICKNESS	WOOD-SIZE	LEAD	CONSTRUCTION-LOCATION	RECOVERED	SIZE	LOST
310' - 320'			Bridge Stone 395' - 405'			
0' - 10'			Clay 320' - 395'			
			Clay & Stone 10' - 310'			

Drillers' Names Marple Curry
E. O. Toals

Remarks:



5-25-65 I hereby certify I visited the above well on this date.
DATE

K. C. Butcher
DISTRICT WELL INSPECTOR

08/18/2023

STATE OF WEST VIRGINIA
DEPARTMENT OF MINES
OIL AND GAS DIVISION

Rotary
Spudder
Cable Tools
Storage

INSPECTOR'S WELL REPORT

Permit No. _____

Oil or Gas Well _____
(KIND)

		CASING AND TUBING	USED IN DRILLING	LEFT IN WELL	PACKERS
Company _____		Size			Kind of Packer _____
Address _____		16			
Farm _____		13			Size of _____
Well No. _____		10			
District _____ County _____		8 1/4			Depth set _____
Drilling commenced _____		6 5/8			
Drilling completed _____ Total depth _____		5 3/16			Perf. top _____
Date shot _____ Depth of shot _____		3			
Initial open flow _____ /10ths Water in _____ Inch		2			Perf. bottom _____
Open flow after tubing _____ /10ths Merc. in _____ Inch		Liners Used _____			Perf. top _____
Volume _____ Cu. Ft.					Perf. bottom _____
Rock pressure _____ lbs. _____ hrs.		CASING CEMENTED _____ SIZE _____ No. FT. _____ Date _____			
Oil _____ bbls., 1st 24 hrs.		NAME OF SERVICE COMPANY _____			
Fresh water _____ feet _____ feet		COAL WAS ENCOUNTERED AT _____ FEET _____ INCHES			
Salt water _____ feet _____ feet		_____ FEET _____ INCHES _____ FEET _____ INCHES			
		_____ FEET _____ INCHES _____ FEET _____ INCHES			

Drillers' Names _____

Remarks:

DATE

DISTRICT WELL INSPECTOR

08/18/2023

PROPOSED MANNER OF PLUGGING AND FILLING WELL

(REQUIRED BY RULES AND REGULATIONS)

WEST VIRGINIA DEPARTMENT OF MINES
OIL AND GAS DIVISION

WORK ORDER

Well to be plugged and filled as follows:

as completed 8-27-58 :

8-5/8" casing set at 383 ft.
7" casing set at 1582 ft. (cemented in)
3-1/2" tubing set at 2078 ft.
Shot hole 2051 - 2041
Total depth 2075

Pull 3-1/2" tubing

Rock bridge 2,000 - 1,950
Cement 1,950 - 1,940 2-1/2 sacks

Open hole to 1,650
Rock bridge 1,650 - 1,620
Clay 1,620 - 1,610
Rock 1,610 - 1,600
Cement 1,600 - 1,590 2-1/2 sacks

Continued

Rock 310 - 265
Clay 265 - 215
Rock 215 - 182
Cement 182 - 130 5-1/2 sacks
Clay 130 to surface.

7" casing is cemented in.
Rip 7" Casing between 1,540 and 1,510
Pull 7" casing.

Open hole to 1,010
Rock bridge 1,010 - 960
Clay 960 - 912
Cement 912 - 902 3-1/2 sacks

Rock bridge 580 - 540
Clay 540 - 440
Cement 440 - 430 3-1/2 sacks

Erect Concrete Monument 2' x 2' x 3'
Mark Monument "O.L.O. 1045"

Pull 8-5/8" casing at 383'2"

Rock bridge 405 - 395
Clay 395 - 320
Cement 320 - 310 5-1/2 sacks

To the Department of Mines
Coal Owner or Operator,
Lease or Property Owner.

Gentlemen:

This "work order" is submitted for your approval and concurrence and unless notified of your disapproval or non-concurrence, the undersigned will proceed with the plugging and filling of said well in the above described manner on the date inspector is notified after permit is issued.

Very truly yours,
OWENS, LIBBEY-OWENS GAS DEPARTMENT

A. H. Smith Well Operator

No objections have been filed by the coal owner or coal operator, or any available adjacent lease or property owners or interposed by the Department of Mines to the manner herein described for the plugging and filling of the well above mentioned. Therefore, the same is hereby approved this

6 day of Oct, 1964

08/18/2023

DEPARTMENT OF MINES
Oil and Gas Division

By: *Gurman Wamock*

NOTE: This "work order" shall be filed in triplicate, one copy for the files of the Department of Mines; one to be approved or corrected and returned to the well operator as his authority for plugging said well; and one for the well inspector.



STATE OF WEST VIRGINIA
DEPARTMENT OF MINES
OIL AND GAS DIVISION

NOTICE OF INTENTION TO PLUG AND ABANDON WELL

(REQUIRED BY SECTION 9, ARTICLE 4, CHAPTER 22 OF THE CODE)

To THE DEPARTMENT OF MINES,
Charleston, W. Va.

Coal Operator	OWENS, LIBBEY-OWENS GAS DEPARTMENT
Name of Well Operator	P. O. Box 4168, Charleston, W. Va. 25304
Address	Complete Address
Coal Owner	Date
Address	October 2, 1964
Mrs. Lona Queen	WELL TO BE ABANDONED
Lease or Property Owner	Butler District
R.F.D. 1	Wayne County
Wayne, W. Va.	Well No. 1 (Serial No. 1045)
Address	Charley Queen Farm

Inspector to be notified Kenneth Butcher Bunbaunville, W. Va. Telephone Number RE-61933

Gentlemen:—

The undersigned well operator is about to abandon the above described well and will commence

the work of plugging and abandoning said well on the date inspector is notified (which date shall not be less than five days after the day on which this notice so mailed is received, or in due course should be received by the Department of Mines).

This notice is given you in order that your respective representatives may be present at the plugging and filling of said well. You are further notified that whether you are represented or not represented the undersigned will proceed on that date, or shortly thereafter, to plug and fill said well in the manner required by Section 10, Article 4, Chapter 22 of the Code and given in detail on the reverse side of this notice, in "Work Order."

This notice is being mailed by registered mail to each of you at the above addresses on the above date.

Very truly yours,
OWENS, LIBBEY-OWENS GAS DEPARTMENT

A. H. Smith, Well Operator
Mgr. Land, Engrg. & Geology

NOTE: Upon the abandonment of any well drilled prior to June 1, 1929, a plat prepared by a registered engineer, shall be filed with THREE COPIES OF APPLICATION, (OG-9) AND "WORK ORDER" AND TWO COPIES OF THE WELL RECORD, (OG-10). The map must show the district and county in which the tract of land is located, the name and acreage of same, the name or names of the owners and names of adjacent tracts and the location of the well to be abandoned, determined by survey with the courses and distances of such well from two permanent points or landmarks on said tract.

08/18/2023

NOTE: In case plugging is not commenced within four months from the date of permit, same shall expire and be of no further force or effect.

NOTE: PERMIT IS NOT TRANSFERABLE.

BLANKET BOND

WAY-1099 - P

Permit Number

AFFIDAVIT OF PLUGGING AND FILLING WELL

AFFIDAVIT SHOULD BE MADE IN TRIPlicate AND ONLY MADE BY THE DEPARTMENT AND NOT BY THE WELL OPERATOR AND THE WELL OPERATOR MUST BE KEPT IN THE DEPARTMENT AT ALL TIMES

OWNER: *W. V. ...*

LOCAL OPERATOR: *...*

W. V. ...

Set Rock on top of 7" casing left in hole at 810 ft.

Rock 810 - 771
Clay 771 - 723
Cement 723 - 713 (3-1/2 bags)

Set Rock Bridge 580 - 540
Clay 540 - 440
Cement 440 - 430 (3-1/2 bags)

Pulled 382'1" of 8-5/8" casing.

Set Rock Bridge 405 - 395
Clay 395 - 320
Cement 320 - 310 (5-1/2 bags)
Rock 310 - 265
Clay 265 - 215
Rock 215 - 182
Cement 182 - 170 (5-1/2 bags)
Clay 170 - Surface.

DEPTH	DESCRIPTION	REMARKS
810 - 771	Rock	
771 - 723	Clay	
723 - 713	Cement	(3-1/2 bags)
580 - 540	Set Rock Bridge	
540 - 440	Clay	
440 - 430	Cement	(3-1/2 bags)
382'1" - 0	Pulled 8-5/8" casing	
405 - 395	Set Rock Bridge	
395 - 320	Clay	
320 - 310	Cement	(5-1/2 bags)
310 - 265	Rock	
265 - 215	Clay	
215 - 182	Rock	
182 - 170	Cement	(5-1/2 bags)
170 - Surface	Clay	

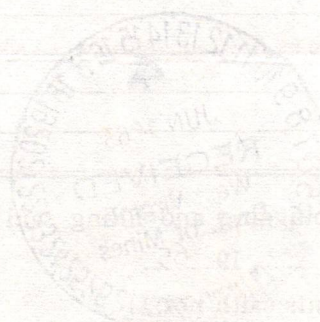

08/18/2023

[Handwritten signatures and notes]

STATE OF WEST VIRGINIA
DEPARTMENT OF MINES
OIL AND GAS DIVISION

AFFIDAVIT OF PLUGGING AND FILLING WELL

AFFIDAVIT SHOULD BE MADE IN TRIPLICATE, ONE COPY MAILED TO THE DEPARTMENT, ONE COPY TO BE RETAINED BY THE WELL OPERATOR AND THE THIRD COPY (AND EXTRA COPIES IF REQUIRED) SHOULD BE MAILED TO EACH COAL OPERATOR AT THEIR RESPECTIVE ADDRESSES.

COAL OPERATOR OR OWNER	OWENS, LIBBEY-OWENS GAS DEPARTMENT
ADDRESS	P. O. Box 4168, Charleston, W. Va. 25304
COAL OPERATOR OR OWNER	NAME OF WELL OPERATOR
ADDRESS	June 10, 1965
LEASE OR PROPERTY OWNER	WELL AND LOCATION
R.F.D. 1, Wayne, West Virginia	Butler District
ADDRESS	Wayne County
	Well No. 1 (Serial No. 1045)
	Charley Queen Farm

STATE INSPECTOR SUPERVISING PLUGGING.....

AFFIDAVIT

STATE OF WEST VIRGINIA, }
County of Kanawha } ss:

L. L. McClure and Marple Curry
being first duly sworn according to law depose and say that they are experienced in the work of plugging and filling oil and gas wells and were employed by Owens, Libbey-Owens Gas Dept., well operator, and participated in the work of plugging and filling the above well, that said work was commenced on the 10th day of May, 1965, and that the well was plugged and filled in the following manner:

SAND OR ZONE RECORD FORMATION	FILLING MATERIAL	PLUGS USED SIZE & KIND	CASING	
			CSG PULLED	CSG LEFT IN
Pulled 3-1/2" tubing at 2,079'2"		3-1/2"	2,079'2"	---
Set Rock Bridge	2000 - 1950			
Cement	1950 - 1940 (2-1/2 bags)	7"	810'3"	772'
Set Rock Bridge	1650 - 1620			
Clay	1620 - 1610	8-5/8"	382'1"	---
Rock	1610 - 1600			
Cement	1600 - 1590 (2-1/2 bags)			
Ripped 7" casing at 810'3" and pulled casing. Left 772 ft. of 7" casing in hole.				
(OVER)				
COAL SEAMS	DESCRIPTION OF MONUMENT			
(NAME)	Erected 2' x 2' x 3' Concrete Monument			
(NAME)				
(NAME)	Marked Monument "OLO 1045"			
(NAME)				

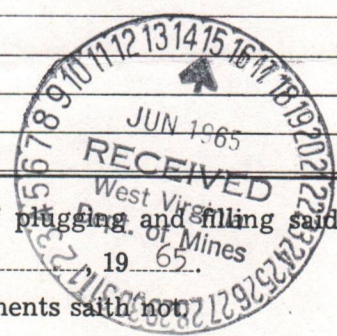

and that the work of plugging and filling said well was completed on the 25th day of May 1965.

And further deponents saith not L. L. McClure Marple Curry **08/18/2023**

Sworn to and subscribed before me this 14th day of June, 1965.

My commission expires: 2/7/67 Kathleen E. Hensch Notary Public.

Permit No. WAY-1099-P



State of West Virginia

Department of Mines
Oil and Gas Division

Charleston 5
June 29, 1965

W. F. EIGENBROD
DIRECTOR

GURMER WAMOCK
DEPUTY DIRECTOR

Owens, Libbey Owens Gas Department
P. O. Box 4168
Charleston, West Virginia 25304
ATT: Mr. A. H. Smith

In Re: Permit Way-1099-P
Farm Charley Queen
Well No. 1
District Butler
County Wayne

Gentlemen:

The final inspection report for your well which is described above has been received in our office.

Please be advised that the well, which is covered by the above permit number, has been released under your Blanket Bond.

Yours very truly,

Gurmer Wamock
Deputy Director
OIL AND GAS DIVISION

GW/jc

08/18/2023

STATE OF WEST VIRGINIA
DEPARTMENT OF MINES
OIL AND GAS DIVISION

Rotary
Spudder
Cable Tools
Storage

INSPECTOR'S WELL REPORT

Permit No. Way-1099P

Oil or Gas Well _____
(KIND)

Company	CASING AND TUBING	USED IN DRILLING	LEFT IN WELL	PACKERS
<u>Owens-Libby-Owens</u>	Size			
<u>Charleston, W. Va.</u>	16			Kind of Packer _____
<u>Charley Queen</u>	13			
<u>1</u>	10			Size of _____
<u>Butler</u> County <u>Wayne</u>	8 1/4			
Drilling commenced _____	6 5/8			Depth set _____
Drilling completed _____ Total depth _____	5 3/16			
Date shot _____ Depth of shot _____	3			Perf. top _____
Initial open flow _____ /10ths Water in _____ Inch	2			Perf. bottom _____
Open flow after tubing _____ /10ths Merc. in _____ Inch	Liners Used _____			Perf. top _____
Volume _____ Cu. Ft.				Perf. bottom _____
Rock pressure _____ lbs. _____ hrs.	CASING CEMENTED _____ SIZE _____ No. FT. _____ Date _____			
Oil _____ bbls., 1st 24 hrs.	NAME OF SERVICE COMPANY _____			
Fresh water _____ feet _____ feet	COAL WAS ENCOUNTERED AT _____ FEET _____ INCHES			
Salt water _____ feet _____ feet	_____ FEET _____ INCHES _____ FEET _____ INCHES			
	_____ FEET _____ INCHES _____ FEET _____ INCHES			

Drillers' Names _____

Remarks: Final inspection made by hand release

6-24-65
DATE

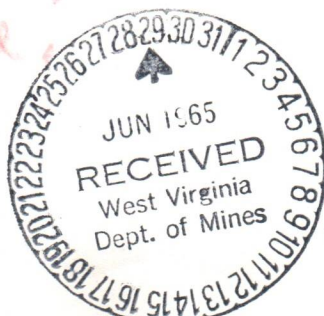

K. E. Butcher
DISTRICT WELL INSPECTOR

08/18/2023

STATE OF WEST VIRGINIA
DEPARTMENT OF MINES
OIL AND GAS DIVISION
INSPECTOR'S PLUGGING REPORT

Permit No. _____

Well No. _____

COMPANY _____ ADDRESS _____

FARM _____ DISTRICT _____ COUNTY _____

Filling Material Used _____

Liner	Location	Amount	Packer	Location		
PLUGS USED AND DEPTH PLACED			BRIDGES	CASING AND TUBING		
CEMENT-THICKNESS	WOOD-SIZE	LEAD	CONSTRUCTION-LOCATION	RECOVERED	SIZE	LOST

Drillers' Names _____

Remarks: _____

_____ I hereby certify I visited the above well on this date.
DATE

DISTRICT WELL INSPECTOR
08/18/2023

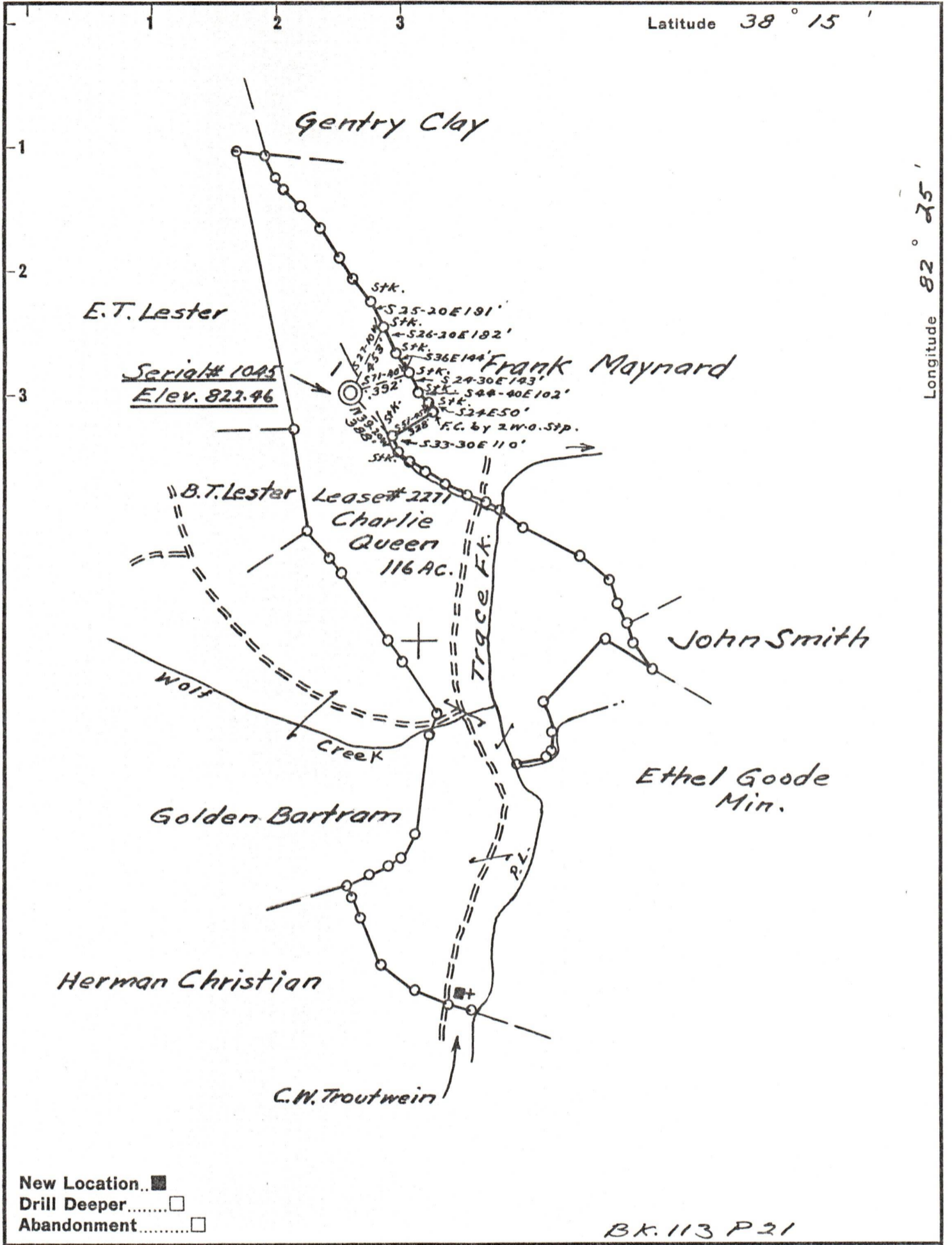

New Location..
 Drill Deeper.....
 Abandonment.....

BK. 113 P 21

Company Owens, Libbey-Owens Gas Dept.
 Address Box 4158
 Farm Charlie Queen
 Tract _____ Acres 116 Lease No. 2271
 Well (Farm) No. 1 Serial No. 1045
 Elevation (Spirit Level) 822.46
 Quadrangle Wayne 3-55.11"W 4.19"
 County Wayne District Butler
 Engineer T.S. Flourmoy
 Engineer's Registration No. 269
 File No. _____ Drawing No. _____
 Date May 23, 1958 Scale 1"=800 Ft.

STATE OF WEST VIRGINIA
 DEPARTMENT OF MINES
 OIL AND GAS DIVISION
 CHARLESTON

WELL LOCATION MAP

FILE NO. WAY-1099

08/18/2023

± Denotes location of well on United States Topographic Maps, scale 1 to 62,500, latitude and longitude lines being represented by border lines as shown.

— Denotes one inch spaces on border line of original tracing.