



STATE OF WEST VIRGINIA
DEPARTMENT OF MINES
OIL AND GAS DIVISION

*Mail permit
to Wayne Lycan
Fort Gay, W. Va.*

NOTICE OF PROPOSED LOCATION OF OIL AND GAS WELL

To THE DEPARTMENT OF MINES,
Charleston, W. Va.

John F. Spencer Jr.
COAL OPERATOR OR COAL OWNER

R.B. Eichholz & J.B. Hyman
NAME OF WELL OPERATOR

Fort Gay W. Va. - R.F.D.#1
ADDRESS

216-prince St. Alexandria, Va.
COMPLETE ADDRESS

Same
COAL OPERATOR OR COAL OWNER

Aug 26, 1958
PROPOSED LOCATION

ADDRESS

Butler District

John F. Spencer Jr.
OWNER OF MINERAL RIGHTS

Wayne County

Fort Gay W. Va. R.F.D.#1
ADDRESS

Well No. 1 Lat. 38° 15'
Lon. 82° 30' Elev. 800'

John F. Spencer Jr. Farm

GENTLEMEN:

The undersigned well operator is entitled to drill upon the above named farm or tract of land for oil and gas, having fee title thereto, (or as the case may be) under grant or lease dated Sept. 10th. 1956, made by John F. Spencer Jr., to Wayne Lycan + G.C. McClure, and recorded on the 27 day of April 1957, in the office of the County Clerk for said County in Book 47, page 62.

The enclosed plat was prepared by a competent engineer and shows the proposed location of a well to be drilled for oil and gas by the undersigned well operator on the farm and in the Magisterial District and County above named, determined by survey and courses and distances from two permanent points, or land marks.

The undersigned well operator is informed and believes there are no coal operators operating beds of coal beneath said farm or tract of land on which said well is located, or within 500 feet of the boundaries of the same, who have mapped their workings and filed their maps as required by law, excepting the coal operators or coal owners (if any) above named as addressees.

The above named coal operators or coal owners (if any) are notified that any objections they may desire to make to such proposed location, or which they are required to make by Section 3 of said Code, if the drilling of a well at said proposed location will cause a dangerous condition in or about their respective coal mines, must be received by, or filed with the Department of Mines within ten* days from the receipt of a copy of this notice and accompanying plat by said Department. Said coal operators are further notified that forms for use in making such objections will be furnished to them by the Department of Mines promptly on request and that all such objections must set forth as definitely as is reasonably possible the ground or grounds on which such objections are based and indicate the direction and distance the proposed location should be moved to overcome same.

(The next paragraph is to be completed only in Department's copy.)

Copies of this notice and the enclosed plat were mailed by registered mail, or delivered to the above named coal operators or coal owners at their above shown respective address _____ day _____ before, or on the same day with the mailing or delivery of this copy to the Department of Mines at Charleston, West Virginia.

Very truly yours,

R.B. Eichholz & J.B. Hyman
WELL OPERATOR

216-prince Street
STREET

Alexandria
CITY OR TOWN

Virginia
STATE

08/18/2023

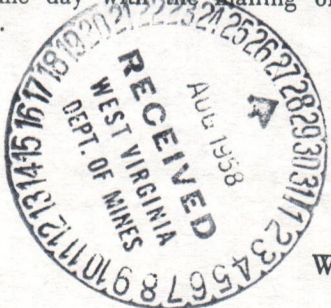

Address of Well Operator }

*Section 3 If no such objections be filed or be found by the department of mines, within said period of ten days from the receipt of said notice and plat by the department of mines, to said proposed location, the department shall forthwith issue to the well operator a drilling permit reciting the filing of such plat, that no objections have been made by the coal operators to the location, or found thereto by the department, and that the same is approved and the well operator authorized to proceed to drill at said location.

Fort Gay W, Va.
Dec. 3 1958.

Bureau Mines,
Oil & Gas Division
Charleston, West Virginia

Dear Sirs:

I am very sorry that I overlooked the
Rock pressure, on the completion form of the
John T. Spencer #1. I will try to get them
correct from now.

The Rock pressure was taken 18 hrs. after
shut in, and was 640 lbs.

Thanking you for calling my attention to
this error. I am,

Yours very Truly,

Hayne Lyeon.

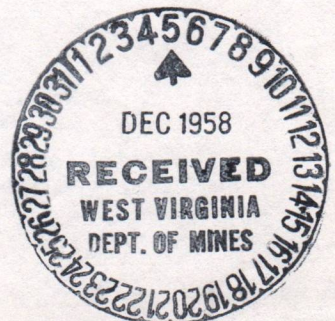

08/18/2023

Fort Boy W.V.
Dec 3 1888

Bureau of Mines
Oil & Gas Division
Charleston West Virginia
Dear Sir:

I am very sorry that I overlooked the
book for you, in the competition for the
John F. Sanger & I will try to get them
sent to you soon.

The book for you was taken 12 hrs after
that in, and was also the
standing in the calling my attention to
this case of the

Yours truly,
Stephen Lippincott

Stephen Lippincott



Formation	Color	Hard or Soft	Top	Bottom	Oil, Gas or Water	Depth Found	Remarks
Bottom hole			1022				
Shale sand			1022	1022	gas	1022-1023	
Shale sand			1022	1022			
Shale			1020	1020			
Shale & shelta			1020	1020	shale gas	1020-1021	
Big yellow sand			1020	1020	shale gas	1020-1021	
Shale			1020	1020			
Shale sand			100	100			
Shale			930	100			
sand			925	930			
shale			910	925			
sand			204	910			
shale			1702	204			
Hard shale			1702	1702			
shale			385	1702			
sand			330	385			
shale shelta			297	330			
shale			10	297			
surface			0	10			

08/18/2023

Date _____, 19____

APPROVED _____, Owner

By _____

(Title)



STATE OF WEST VIRGINIA
DEPARTMENT OF MINES
OIL AND GAS DIVISION

Permit No. **WV-1128**
80/18/2023
KENOVA

WELL RECORD

Oil or Gas Well **gas**
(KIND)

Company	R.B. Eichholz & J.B. Hyman		
Address	216 Prince St. Alexandria, Va.		
Farm	John T. Spencer		
Location (waters)	Left Fork Big Hurricane Creek		
Well No.	1		
Elev.	800'		
District	Butler		
County	Wayne		
The surface of tract is owned in fee by John T. Spencer			
R.F.D. No. 1			
Address Fort Gay, West Va.			
Mineral rights are owned by John T. Spencer			
Address above			
Drilling commenced	Sep. 19th, 1958		
Drilling completed	Nov. 18th, 1958		
Date Shot	Nov. 19th From 1955 To 1945'		
With	150 lbs. Gelatin		
Open Flow	77/10ths Water in		
Inch	2		
Inch	/10ths Merc. in		
Volume	370,000		
Cu. Ft.	640		
Rock Pressure	None		
hrs.	18		
Oil	None		
bbls., 1st 24 hrs.	None		
WELL ACIDIZED	no		
WELL FRACTURED	no		

CASING CEMENTED SIZE No. Ft. Date

None cemented

COAL WAS ENCOUNTERED AT None INCHES FEET

INCHES FEET INCHES FEET

RESULT AFTER TREATMENT
ROCK PRESSURE AFTER TREATMENT
Fresh Water

Formation	Color	Hard or Soft	Top	Bottom	Oil, Gas or Water	Depth	Remarks
Surface			0	19			
Slate			19	264			
Slate Shells			264	330			
Sand			330	382			
Slate			382	486			
Hard Slate			486	495			
Slate			495	507			
Sand			507	540			
Slate			540	612			
Sand			612	630			
Slate			630	700			
Salt Sand			700	1196			
Lime			1196	1327			
Big Injun Sand			1327	1430	Show gas	1427-1432	
Slate & Shells			1430	1570	Show gas	1468-1473	
Slate			1570	1926			
Sunbury Shale			1926	1945			
Burea Sand			1945	1955	Gas	1945-1953	
Bottom Hole			1955				



(over)

STATE OF WEST VIRGINIA
DEPARTMENT OF MINES
OIL AND GAS DIVISION

INSPECTOR'S WELL REPORT

Permit No. 1128 WAYne

Oil or Gas Well _____
(KIND)

Company <u>R. B. Eicholz & Wyman</u>	CASING AND TUBING	USED IN DRILLING	LEFT IN WELL	PACKERS
Address <u>216 Prince St. Alexandria, Va.</u>	Size			
Farm <u>John F. Spencer Jr.</u>	16			Kind of Packer _____
Well No. <u>1</u>	13			
District <u>Butler</u> County <u>Wayne</u>	10	20 7"		Size of _____
Drilling commenced <u>Sept 19, 1958</u>	8 1/4	244'		Depth set _____
Drilling completed _____ Total depth _____	6 5/8	1239'		
Date shot _____ Depth of shot _____	5 3/16			
Initial open flow _____ /10ths Water in _____ Inch	3			Perf. top _____
Open flow after tubing _____ /10ths Merc. in _____ Inch	2			Perf. bottom _____
Volume _____ Cu. Ft.	Liners Used			Perf. top _____
Rock pressure _____ lbs. _____ hrs.				Perf. bottom _____
Oil _____ bbls., 1st 24 hrs.	CASING CEMENTED _____ SIZE _____ No. FT. _____ Date _____			
Fresh water <u>190</u> feet _____ feet	COAL WAS ENCOUNTERED AT _____ FEET _____ INCHES			
Salt water <u>730</u> feet _____ feet	_____ FEET _____ INCHES _____ FEET _____ INCHES			
	_____ FEET _____ INCHES _____ FEET _____ INCHES			

Drillers' Names Ned Hampton
George Sloss

Remarks: fishing job at 1315

10-22-58
DATE

G. H. Samples
DISTRICT WELL INSPECTOR
08/18/2023

STATE OF WEST VIRGINIA
DEPARTMENT OF MINES
OIL AND GAS DIVISION
INSPECTOR'S PLUGGING REPORT

Permit No. _____

Well No. _____

COMPANY _____ ADDRESS _____

FARM _____ DISTRICT _____ COUNTY _____

Filling Material Used _____

Liner _____ Location _____ Amount _____ Packager _____ Location _____

PLUGS USED AND DEPTH PLACED			BRIDGES	CASING AND TUBING		
CEMENT-THICKNESS	WOOD-SIZE	LEAD	CONSTRUCTION-LOCATION	RECOVERED	SIZE	LOST

Drillers' Names _____

Remarks: _____

_____ DATE I hereby certify I visited the above well on this date.

DISTRICT WELL INSPECTOR
08/18/2023

STATE OF WEST VIRGINIA
DEPARTMENT OF MINES
OIL AND GAS DIVISION

INSPECTOR'S WELL REPORT

Permit No. WAY-1128

Oil or Gas Well Gas
(KIND)

Company <u>R.B.Eicholz & J.B.Hayman</u> Address <u>216 Prince Street</u> <u>Texandria, Va.</u> Farm <u>John F. Spencer, Jr.</u> Well No. <u>1</u> District <u>Bulter</u> County <u>Wayne</u> Drilling commenced <u>9-19-58</u> Drilling completed _____ Total depth _____ Date shot _____ Depth of shot _____ Initial open flow _____ /10ths Water in _____ Inch Open flow after tubing _____ /10ths Merc. in _____ Inch Volume _____ Cu. Ft. Rock pressure _____ lbs. _____ hrs. Oil _____ bbls., 1st 24 hrs. Fresh water <u>190'</u> feet _____ feet Salt water <u>740'</u> feet _____ feet	<table border="1" style="width: 100%; border-collapse: collapse;"> <thead> <tr> <th style="width: 15%;">CASING AND TUBING</th> <th style="width: 15%;">USED IN DRILLING</th> <th style="width: 15%;">LEFT IN WELL</th> <th style="width: 55%;">PACKERS</th> </tr> </thead> <tbody> <tr> <td>Size</td> <td></td> <td></td> <td>Kind of Packer</td> </tr> <tr> <td>16</td> <td></td> <td></td> <td></td> </tr> <tr> <td>18</td> <td></td> <td></td> <td></td> </tr> <tr> <td>10</td> <td style="text-align: center;">20'</td> <td></td> <td>Size of</td> </tr> <tr> <td>8 1/4</td> <td style="text-align: center;">244'</td> <td></td> <td></td> </tr> <tr> <td>6 5/8</td> <td style="text-align: center;">1239'</td> <td></td> <td>Depth set</td> </tr> <tr> <td>5 3/16</td> <td></td> <td></td> <td></td> </tr> <tr> <td>3</td> <td></td> <td></td> <td>Perf. top</td> </tr> <tr> <td>2</td> <td></td> <td></td> <td>Perf. bottom</td> </tr> <tr> <td>Liners Used</td> <td></td> <td></td> <td>Perf. top</td> </tr> <tr> <td></td> <td></td> <td></td> <td>Perf. bottom</td> </tr> </tbody> </table> <table style="width: 100%;"> <tr> <td style="width: 30%;">CASING CEMENTED</td> <td style="width: 20%;">SIZE</td> <td style="width: 20%;">No. FT.</td> <td style="width: 30%;">Date</td> </tr> <tr> <td> </td> <td> </td> <td> </td> <td> </td> </tr> </table> <table style="width: 100%;"> <tr> <td style="width: 60%;">COAL WAS ENCOUNTERED AT</td> <td style="width: 10%;">FEET</td> <td style="width: 10%;">INCHES</td> <td style="width: 20%;"> </td> </tr> <tr> <td> </td> <td> </td> <td> </td> <td> </td> </tr> <tr> <td> </td> <td> </td> <td> </td> <td> </td> </tr> <tr> <td> </td> <td> </td> <td> </td> <td> </td> </tr> </table>	CASING AND TUBING	USED IN DRILLING	LEFT IN WELL	PACKERS	Size			Kind of Packer	16				18				10	20'		Size of	8 1/4	244'			6 5/8	1239'		Depth set	5 3/16				3			Perf. top	2			Perf. bottom	Liners Used			Perf. top				Perf. bottom	CASING CEMENTED	SIZE	No. FT.	Date					COAL WAS ENCOUNTERED AT	FEET	INCHES													
CASING AND TUBING	USED IN DRILLING	LEFT IN WELL	PACKERS																																																																						
Size			Kind of Packer																																																																						
16																																																																									
18																																																																									
10	20'		Size of																																																																						
8 1/4	244'																																																																								
6 5/8	1239'		Depth set																																																																						
5 3/16																																																																									
3			Perf. top																																																																						
2			Perf. bottom																																																																						
Liners Used			Perf. top																																																																						
			Perf. bottom																																																																						
CASING CEMENTED	SIZE	No. FT.	Date																																																																						
COAL WAS ENCOUNTERED AT	FEET	INCHES																																																																							

Drillers' Names David Compton

Ned Compton

Remarks: Salt Sand 700'-1196'; Big Lime 1196'-1327'; Injun Sand 1327'-1470'; show gas @ 1427'-1432'; Gas 1468'-1473'; testing 3/10 Water 1" opening; drilling at 1684'.

11-13-58

DATE

J.W. pack

DISTRICT WELL INSPECTOR

08/18/2023

Latitude 38° 15'

Longitude 82° 30'

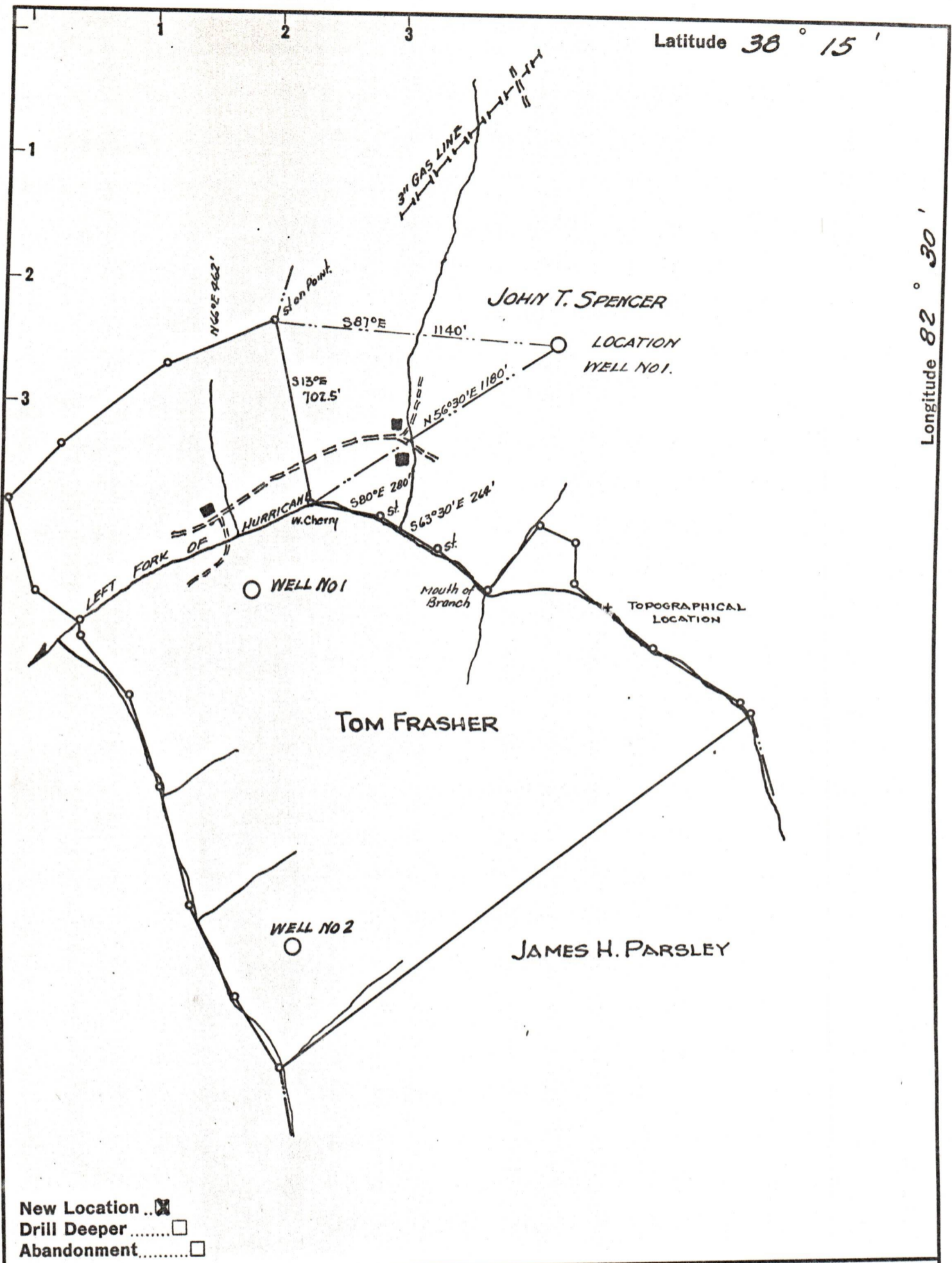

New Location
 Drill Deeper
 Abandonment

Company **R.B.EICHHOLZ & J.B.HYMAN**
 Address **ALEXANDRA, VA**
 Farm **JOHN T. SPENCER**
 Tract _____ Acres **85.** Lease No. _____
 Well (Farm) No. **1** Serial No. _____
 Elevation (Spirit Level) **800.**
 Quadrangle **LOUISA . W. VA**
 County **WAYNE** District **BUTLER**
 Engineer *Salmon Wallace*
 Engineer's Registration No. *Engr. Lawrence Co. Ky.*
 File No. _____ Drawing No. _____
 Date **AUG. 19. 1958** Scale **1" = 500'**

STATE OF WEST VIRGINIA
 DEPARTMENT OF MINES
 OIL AND GAS DIVISION
 CHARLESTON

WELL LOCATION MAP
 FILE NO. **WAY-1127** 08/18/2023

+ Denotes location of well on United States Topographic Maps, scale 1 to 62,500, latitude and longitude lines being represented by border lines as shown.
 - Denotes one inch spaces on border line of original tracing.