



STATE OF WEST VIRGINIA
DEPARTMENT OF MINES
OIL AND GAS DIVISION

NOTICE OF PROPOSED LOCATION OF OIL AND GAS WELL

To THE DEPARTMENT OF MINES,
Charleston, W. Va.

Coal Not Operated
COAL OPERATOR OR COAL OWNER

R. H. Adkins
NAME OF WELL OPERATOR

ADDRESS

Hamlin, W. Va.
COMPLETE ADDRESS

United Fuel Gas Co.
COAL OPERATOR OR COAL OWNER

November 26, 1958
PROPOSED LOCATION

Charleston, Box 1273, W. Va.
ADDRESS

Butler District

United Fuel Gas Co.
OWNER OF MINERAL RIGHTS

Wayne County

Box 1273, Charleston, W. Va.
ADDRESS

Well No. 1 Lat. 38° 45' 10"
Long. 82° 25' E. 760.00'
30 805.3'

United Fuel Gas Co. Farm

GENTLEMEN:

The undersigned well operator is entitled to drill upon the above named farm or tract of land for oil and gas, having fee title thereto, (or as the case may be) under grant or lease dated November 26 1958, made by United Fuel Gas Co, to R. H. Adkins, and recorded on the _____ day of _____, in the office of the County Clerk for said County in Book _____, page _____.

The enclosed plat was prepared by a competent engineer and shows the proposed location of a well to be drilled for oil and gas by the undersigned well operator on the farm and in the Magisterial District and County above named, determined by survey and courses and distances from two permanent points, or land marks.

The undersigned well operator is informed and believes there are no coal operators operating beds of coal beneath said farm or tract of land on which said well is located, or within 500 feet of the boundaries of the same, who have mapped their workings and filed their maps as required by law, excepting the coal operators or coal owners (if any) above named as addressees.

The above named coal operators or coal owners (if any) are notified that any objections they may desire to make to such proposed location, or which they are required to make by Section 3 of said Code, if the drilling of a well at said proposed location will cause a dangerous condition in or about their respective coal mines, must be received by, or filed with the Department of Mines within ten* days from the receipt of a copy of this notice and accompanying plat by said Department. Said coal operators are further notified that forms for use in making such objections will be furnished to them by the Department of Mines promptly on request and that all such objections must set forth as definitely as is reasonably possible the ground or grounds on which such objections are based and indicate the direction and distance the proposed location should be moved to overcome same.

(The next paragraph is to be completed only in Department's copy.)

Copies of this notice and the enclosed plat were mailed by registered mail, or delivered to the above named coal operators or coal owners at their above shown respective address _____ day _____ before, or on the same day with the mailing or delivery of this copy to the Department of Mines at Charleston, West Virginia.

Very truly yours,

R. H. Adkins
R. H. Adkins
WELL OPERATOR

By J. P. Engle
STREET

Address of Well Operator }

Hamlin
CITY OR TOWN

West Virginia
STATE

08/18/2023

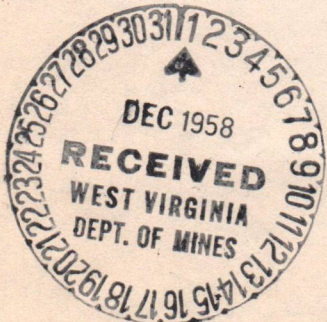

*Section 3 If no such objections be filed or be found by the department of mines, within said period of ten days from the receipt of said notice and plat by the department of mines, to said proposed location, the department shall forthwith issue to the well operator a drilling permit reciting the filing of such plat, that no objections have been made by the coal operators to the location, or found thereto by the department, and that the same is approved and the well operator authorized to proceed to drill at said location.

1157
WAY-1551 PERMIT NUMBER

1151

A-10



STATE OF WEST VIRGINIA
DEPARTMENT OF MINES
CHARLESTON

December 1, 1958

C
O
P
Y

Mr. James W. Pack, Inspector
Oil and Gas Wells
Hamlin, West Virginia

Dear Mr. Pack:

We are in receipt of the following applications
for permits to drill wells in your district:

Well No. 1 on C. W. Robinson Farm, Grant District,
Jackson County, from Foster Mays and Roy G. Hildreth. Permit
number will be JAC-989.

Wells No. 1 and 2 on United Fuel Gas Company Tract,
Butler District, Wayne County, from R. H. Adkins. Permit
number for Well No. 1 will be WAY-1151 and Well No. 2 - WAY-1152.

Well No. 4 on C. E. Huff Farm, Butler District, Wayne
County from R. H. Adkins. Permit number will be WAY-1153.

Very truly yours,

Crawford L. Wilson, Director
WEST VIRGINIA DEPARTMENT OF MINES

BY: _____
Assistant Director
OIL AND GAS DIVISION

HG/dm

08/18/2023



STATE OF WEST VIRGINIA
DEPARTMENT OF MINES
CHARLESTON

December 1, 1958

Mr. James W. Pack, Inspector
Oil and Gas Wells
Martinsburg, West Virginia

Dear Mr. Pack:

We are in receipt of the following applications
for permits to drill wells in your district:

Well No. 1 on C. W. Robinson Farm, Grant District,
Jackson County, from Foster Keys and Roy G. Hildreth. Permit
number will be JAC-989.

Wells No. 1 and 2 on United Fuel Gas Company Tract,
Butler District, Wayne County, from R. H. Adkins. Permit
number for Well No. 1 will be WAY-151 and Well No. 2 - WAY-152.

Well No. 1 on C. E. Hart Farm, Butler District, Wayne
County from R. H. Adkins. Permit number will be WAY-153.

Very truly yours,

Crawford L. Wilson, Director
WEST VIRGINIA DEPARTMENT OF MINES

BY: _____
Assistant Director
OIL AND GAS DIVISION

MS/cm

COPY

A-11

December 11, 1958

Mr. R. H. Adkins
Maalin, West Virginia

Dear Mr. Adkins:

Please find enclosed permits for drilling the following wells:

<u>Permit No.</u>	<u>Well No.</u>	<u>Farm</u>	<u>District</u>
WAY-1151	1	U. F. Gas Company	Butler
WAY-1152	2	U. F. Gas Company	Butler
WAY-1153	4	C. E. Huff	Butler

Please post one copy of each permit at the well site. When drilling is completed, please send us two copies of the well record for each location.

Very truly yours,

Crawford L. Wilson, Director
WEST VIRGINIA DEPARTMENT OF MINES

BY: _____
Assistant Director
OIL AND GAS DIVISION

MG/dm
encl:
cc Mr. James W. Pack, Inspector

Mr. R. C. Tucker, Assistant
State Geologist

A-12



STATE OF WEST VIRGINIA
DEPARTMENT OF MINES
CHARLESTON

May 11, 1959

C
O
P
Y

Mr. R. H. Adkins
Hamlin, West Virginia

Dear Mr. Adkins:

Please let us have two copies of drilling record for each of the following wells:

<u>Permit No.</u>	<u>Well No.</u>	<u>Farm</u>	<u>District</u>
WAY-1151	1	United Fuel Gas Company	Butler
WAY-1160	6	United Fuel Gas (T. L. Black)	Butler

Forms OG-10 are enclosed and we will appreciate the information without delay so that permits to drill Wells No. 1-SR-12 - 1-SR-13 on United Fuel Gas Company Mineral Tract, Butler District, Wayne County need not be delayed.

Very truly yours,

Assistant Director
OIL AND GAS DIVISION

ME/m

cc Mr. James W. Pack, Inspector



STATE OF WEST VIRGINIA
DEPARTMENT OF MINES
CHARLESTON

MAY 11, 1939

COPY

Mr. R. U. Admin
Harris, West Virginia

Dear Mr. Admin:

Please let us have two copies of drilling records for each of the following wells:

Well No.	Owner	Location
105-1197	1	United Fuel Gas Company, Jackson
105-1198	2	United Fuel Gas (L. Dick), Jackson

Form 02-10 are enclosed and we will appreciate the information without delay as that permits us to drill wells No. 1-25-12 - 1-25-13 on United Fuel Gas Company Mineral Tract, Jackson District. Yours faithfully need not be delayed.

Very truly yours,

Assistant Inspector
OIL AND GAS DIVISION

M/A

cc Mr. James W. Fitch, Inspector



STATE OF WEST VIRGINIA
DEPARTMENT OF MINES
OIL AND GAS DIVISION 8

Quadrangle Louisa

WELL RECORD

Permit No. WAY-1151

Oil or Gas Well Gas

(KIND)

Company Wolfe Gas Company
Address Hamlin, W. Va.
Farm James Lycans Acres 129.8
Location (waters) Wolf Branch
Well No. 1151 Elev. 805.03
District Butler County Wayne
The surface of tract is owned in fee by James Lycans
Address Fort Gay, W. Va.
Mineral rights are owned by U.F.G. Co.
Address Charleston, W. Va.

Casing and Tubing	Used in Drilling	Left in Well	Packers
Size			Kind of Packer
16			
13			
10		12	Size of
8 1/4		309' - 11"	
6 1/2		1592	Depth set
5 3/16			
3			Perf. top
2			Perf. bottom
Liners Used			Perf. top
			Perf. bottom

Drilling commenced November 26, 1958
Drilling completed February 11, 1959
Date Shot 2-4-59 From 2795 To 2015
With 6658 Gas Well B.
Open Flow /10ths Water in _____ Inch
/10ths Merc. in _____ Inch
Volume 35 M. Cu. Ft.
Rock Pressure 400 lbs. 72 hrs.
Oil 2075 Showing bbls., 1st 24 hrs.
Fresh water 225 feet feet
Salt water 855 feet feet

CASING CEMENTED _____ SIZE _____ No. Ft. _____ Date _____

COAL WAS ENCOUNTERED AT _____ FEET _____ INCHES
_____ FEET _____ INCHES FEET _____ INCHES
_____ FEET _____ INCHES FEET _____ INCHES

Formation	Color	Hard or Soft	Top	Bottom	Oil, Gas or Water	Depth Found	Remarks
Red Clay			0	10			
Sand Rock			10	14			
Slate			14	25			
Sand			25	48			
Slate			48	244			
Sand			244	283			
Slate			283	312			
Sand			312	327			
Slate&Shells			327	358			
Sand			358	400			
Slate			400	510			
Broken Sand			510	555			
Slate			555	575			
Sand			575	615			
Slate			615	660			
Sand			660	685			
Slate			685	727			
Sand			727	800			
Slate&Shells			800	855			
Salt Sand			855	1208			
Slate&Shells			1208	1293			
Maxton Sand			1293	1308			
Slate			1308	1310			
Big Lime			1310	1460			
Injun Sand			1460	1540			
Slate&Shells			1540	1565			
Squaw Sand			1565	1588			
Shell			1588	1600			
Slate&Shells			1600	1940			
Shell			1940	1975			
Slate			1975	2000			
Brown Shale			2000	2015			
Berea Sand			2015	2027			
Slate&Shells			2027	2118			

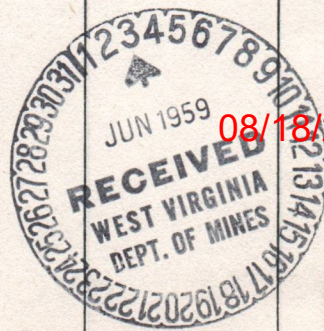

W. J. Hauldren, Well Supt.

(Title)

APPROVED Wolfe Gas Company, Owner

Date June 2, 19 59

Formation	Color	Hard or Soft	Top	Bottom	Oil, Gas or Water	Depth Found	Remarks
Shell			2118	2228			
State&shells			2228	2375			
Brown Shale			2375	2480			
Slate			2480	2650			
Brown Shale			2650	2795			
Slate			2795	2823			
Total Depth			1840	2823			
Red Clay			0	10			
Sand Rock			10	14			
Slate			14	25			
Sand			25	48			
Slate			48	244			
Sand			244	283			
Slate			283	312			
Sand			312	327			
Slate			327	388			
Sand			388	400			
Slate			400	510			
Broken Sand			510	553			
Slate			553	575			
Sand			575	615			
Slate			615	630			
Sand			630	688			
Slate			688	727			
Sand			727	800			
Slate			800	853			
Sand			853	1208			
Slate			1208	1303			
Sand			1303	1303			
Slate			1303	1310			
Slate			1310	1310			
Slate			1310	1400			

2020/8/18

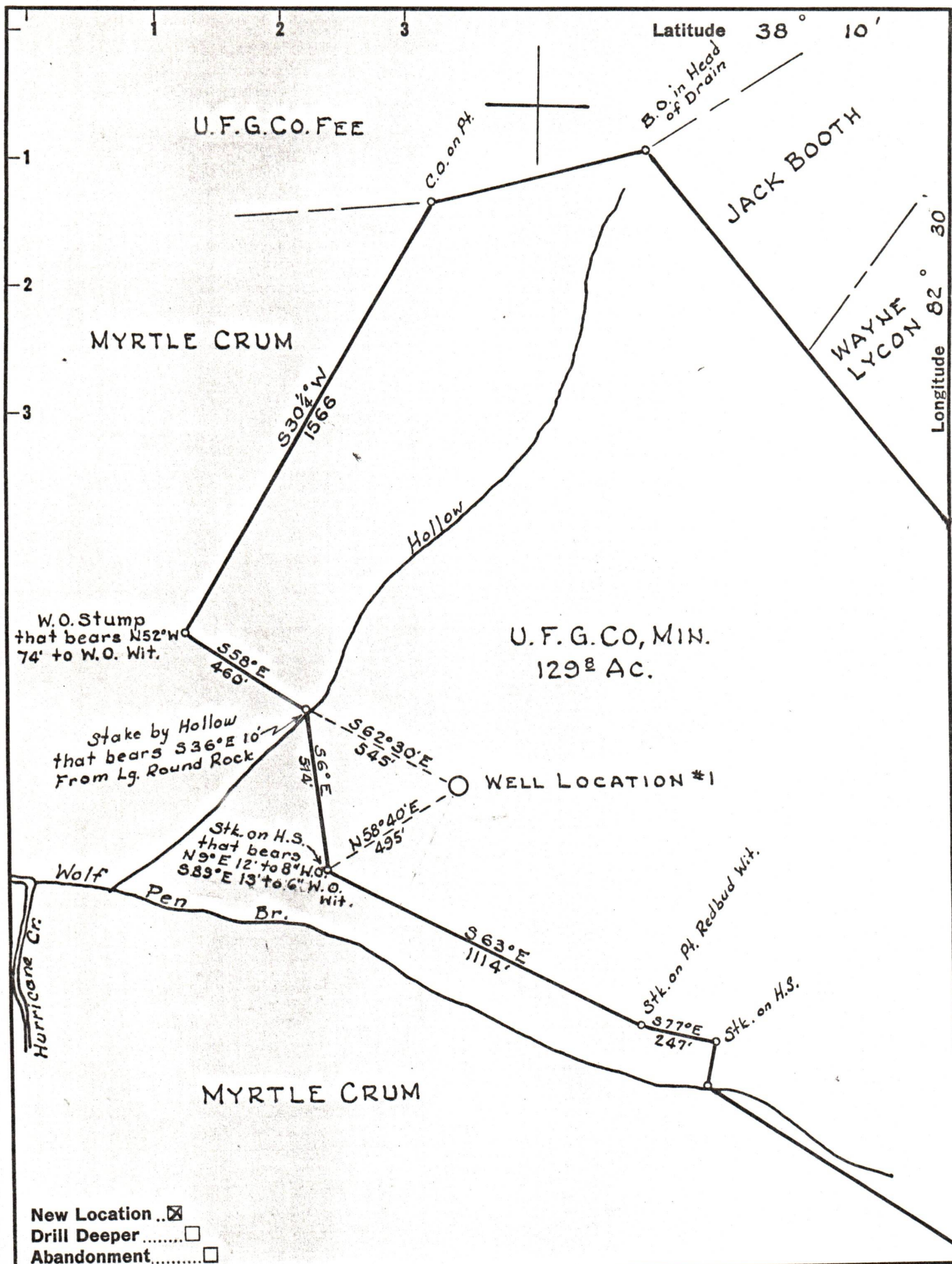

Company R. H. ADKINS
 Address HAMLIN, W. VA.
 Farm U.F.G.CO. MIN.
 Tract #50 Acres 129⁸ Lease No. _____
 Well (Farm) No. 1 Serial No. 1
 Elevation (Spirit Level) 805.03
 Quadrangle LOUISA
 County WAYNE District BUTLER
 Engineer PAUL E. JOACHIM
 Engineer's Registration No. 669
 File No. A-13 Drawing No. _____
 Date Nov. 15, 1958 Scale 1" = 400'

STATE OF WEST VIRGINIA
 DEPARTMENT OF MINES
 OIL AND GAS DIVISION
 CHARLESTON

WELL LOCATION MAP
 FILE NO. WAY-08/18/2023

+ Denotes location of well on United States Topographic Maps, scale 1 to 62,500, latitude and longitude lines being represented by border lines as shown.

- Denotes one inch spaces on border line of original tracing.