



STATE OF WEST VIRGINIA
DEPARTMENT OF MINES
OIL AND GAS DIVISION

*Will send letters
of lease as soon
as made.
Advised by Mr. Vickers*

NOTICE OF PROPOSED LOCATION OF OIL AND GAS WELL

To THE DEPARTMENT OF MINES,
Charleston, W. Va.

No Coal Operation
COAL OPERATOR OR COAL OWNER

ADDRESS

United Fuel Gas Co.
COAL OPERATOR OR COAL OWNER

Charleston, W. Va.
ADDRESS

United Fuel Gas Co.
OWNER OF MINERAL RIGHTS

Charleston, W. Va.
ADDRESS

R. H. Adkins
NAME OF WELL OPERATOR

Hamlin, West Virginia
COMPLETE ADDRESS

December 9, _____, 1958
PROPOSED LOCATION

Butler _____ District

Wayne _____ County

Well No. 6 38° 10' 82° 30' Elev. 899.30'
United Fuel Gas Co.
T. L. Black, Tr. #XXX 30-A Farm

GENTLEMEN:

The undersigned well operator is entitled to drill upon the above named farm or tract of land for oil and gas, having fee title thereto, (or as the case may be) under grant or lease dated November 29, 1958, made by United Fuel Gas Co., to R. H. Adkins, and recorded on the _____ day of _____, in the office of the County Clerk for said County in Book _____, page _____.

The enclosed plat was prepared by a competent engineer and shows the proposed location of a well to be drilled for oil and gas by the undersigned well operator on the farm and in the Magisterial District and County above named, determined by survey and courses and distances from two permanent points, or land marks.

The undersigned well operator is informed and believes there are no coal operators operating beds of coal beneath said farm or tract of land on which said well is located, or within 500 feet of the boundaries of the same, who have mapped their workings and filed their maps as required by law, excepting the coal operators or coal owners (if any) above named as addressees.

The above named coal operators or coal owners (if any) are notified that any objections they may desire to make to such proposed location, or which they are required to make by Section 3 of said Code, if the drilling of a well at said proposed location will cause a dangerous condition in or about their respective coal mines, must be received by, or filed with the Department of Mines within ten* days from the receipt of a copy of this notice and accompanying plat by said Department. Said coal operators are further notified that forms for use in making such objections will be furnished to them by the Department of Mines promptly on request and that all such objections must set forth as definitely as is reasonably possible the ground or grounds on which such objections are based and indicate the direction and distance the proposed location should be moved to overcome same.

(The next paragraph is to be completed only in Department's copy.)

Copies of this notice and the enclosed plat were mailed by registered mail, or delivered to the above named coal operators or coal owners at their above shown respective address _____ day _____ before, or on the same day with the mailing or delivery of this copy to the Department of Mines at Charleston, West Virginia.

Very truly yours,

R. H. Adkins
R. H. Adkins WELL OPERATOR
Main Street
STREET
Hamlin
CITY OR TOWN
West, Virginia
STATE

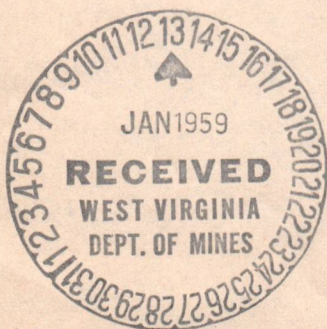

Address of Well Operator }

08/18/2023

*Section 3 If no such objections be filed or be found by the department of mines, within said period of ten days from the receipt of said notice and plat by the department of mines, to said proposed location, the department shall forthwith issue to the well operator a drilling permit reciting the filing of such plat, that no objections have been made by the coal operators to the location, or found thereto by the department, and that the same is approved and the well operator authorized to proceed to drill at said location.

1160



STATE OF WEST VIRGINIA
DEPARTMENT OF MINES
CHARLESTON

January 13, 1959

Mr. James W. Pack, Inspector
Oil and Gas Wells
Hamlin, West Virginia

Dear Mr. Pack:

We are in receipt of 6 applications from R. H. Adkins to drill Wells 5, 6, 7, 8, 9 and 10 on United Fuel Gas Company Mineral Tract (T. L. Black) Butler District, Wayne County.

Permit numbers will be

Well No. 5 - WAY-1159
Well No. 6 - WAY-1160
Well No. 7 - WAY-1161
Well No. 8 - WAY-1162
Well No. 9 - WAY-1163
Well No.10 - WAY-1164.

Very truly yours,

Crawford L. Wilson, Director
WEST VIRGINIA DEPARTMENT OF MINES

BY: _____

Assistant Director
OIL AND GAS DIVISION

MG/dm

08/18/2023

C
O
P
Y



STATE OF WEST VIRGINIA
DEPARTMENT OF MINES
CHARLESTON

January 13, 1959

Mr. James W. Peck, Inspector
Oil and Gas Wells
Harrison, West Virginia

Dear Mr. Peck:

We are in receipt of 6 applications from R. H. Adams to drill Wells 5, 6, 7, 8, 9 and 10 on United Fuel Gas Company Mineral Tract (T. 1. Black) Baker District, Wayne County.

Permit numbers will be

- Well No. 5 - WAY-1159
- Well No. 6 - WAY-1160
- Well No. 7 - WAY-1161
- Well No. 8 - WAY-1162
- Well No. 9 - WAY-1163
- Well No. 10 - WAY-1164

Very truly yours,

Crawford L. Wilson, Director
WEST VIRGINIA DEPARTMENT OF MINES

BY: _____
Assistant Director
OIL AND GAS DIVISION

WJW

COPY



STATE OF WEST VIRGINIA
 DEPARTMENT OF MINES
 CHARLESTON

May 11, 1959

C
O
P
Y

Mr. R. H. Adkins
 Hamlin, West Virginia

Dear Mr. Adkins:

Please let us have two copies of drilling record for each of the following wells:

<u>Permit No.</u>	<u>Well No.</u>	<u>Farm</u>	<u>District</u>
WAY-1151	1	United Fuel Gas Company	Butler
WAY-1160	6	United Fuel Gas (T. L. Black)	Butler

Forms OG-10 are enclosed and we will appreciate the information without delay so that permits to drill Wells No. 1-SR-12 - 1-SR-13 on United Fuel Gas Company Mineral Tract, Butler District, Wayne County need not be delayed.

Very truly yours,

Assistant Director
 OIL AND GAS DIVISION

NG/m

cc Mr. James W. Pack, Inspector



STATE OF WEST VIRGINIA
 DEPARTMENT OF MINES
 CHARLESTON

May 11, 1939

COPY

Mr. R. M. Adams
 Hinton, West Virginia

Dear Mr. Adams:

Please let us have two copies of drilling records for each of the following wells:

<u>District</u>	<u>Form</u>	<u>Well No.</u>	<u>Form No.</u>
Baker	United Fuel Gas Company	1	WAY-1152
Baker	United Fuel Gas (T. L. Black)	6	WAY-1153

Forms GC-10 are enclosed and we will appreciate the information without delay as that permits to drill wells in L-2B-12 - 1-2B-13 on United Fuel Gas Company Mineral Tract, Baker District, Wayne County need not be delayed.

Very truly yours,

Assistant Director
 OIL AND GAS DIVISION

WJA

cc Mr. James W. Koch, Inspector



STATE OF WEST VIRGINIA
 DEPARTMENT OF MINES
 CHARLESTON

May 26, 1959

Mr. Walter Hauldren
 c/o Mr. R. H. Adkins
 Hamlin, West Virginia

Dear Mr. Hauldren:

Please file two copies of the drilling completion record for the following wells:

<u>Permit No.</u>	<u>Well No.</u>	<u>Farm</u>	<u>District</u>
WAY-1152	2 SR-2	U. F. G. Mineral	Butler
WAY-1160	1 SR-6	U. F. G. (Black)	Butler

Forms are enclosed for a prompt reply.

Very truly yours,

Crawford L. Wilson, Director
 DEPARTMENT OF MINES

BY: _____
 Assistant Director
 OIL AND GAS DIVISION

MG/m

08/18/2023

COPY

B-5



STATE OF WEST VIRGINIA
 DEPARTMENT OF MINES
 CHARLESTON

May 26, 1932

Mr. Walter Hamilton
 c/o Mr. R. H. Adams
 Hamilton, West Virginia

Dear Mr. Hamilton:

Please find two copies of the drilling completion records for the following wells:

<u>Permit No.</u>	<u>Well No.</u>	<u>Form</u>	<u>Operator</u>
WAY-1152	2 SR-2	U. F. G. Mineral	Hamilton
WAY-1150	1 SR-6	U. F. G. (Block)	Hamilton

Forms are enclosed for a prompt reply.

Very truly yours,

Crawford L. Wilson, Director
 DEPARTMENT OF MINES

BY: _____
 Assistant Director
 OIL AND GAS DIVISION

COPY



STATE OF WEST VIRGINIA
DEPARTMENT OF MINES
OIL AND GAS DIVISION

Quadrangle Louisa

Permit No. 1160 - Wayne

WELL RECORD

Oil or Gas Well Gas
(KIND)

Company B Wolfe Gas Company
Address Hamlin, W. Va.
Farm Arland Cyrus Acres 100.7
Location (waters) Big Hurricane Creek
Well No. 1160 Elev. 899.30'
District Butler County Wayne
The surface of tract is owned in fee by Arland Cyrus
Address Fort Gay
Mineral rights are owned by United Fuel Gas Co.
Address Charleston, W. Va.

Drilling commenced February 23, 1959
Drilling completed April 14, 1959
Date Shot 4-10-59 From 2031 To 2043
With 2166 Gelatin
Open Flow 20 /10ths Water in 2 Inch
/10ths Merc. in _____ Inch
Volume 181,000 Cu. Ft.
Rock Pressure 400 lbs. _____ hrs.
Oil None bbls., 1st 24 hrs.
Fresh water 440 feet _____ feet
Salt water 970 feet _____ feet

Casing and Tubing	Used in Drilling	Left in Well	Packers
Size			Kind of Packer <u>Anchor</u>
16			
13			
10		<u>20'-6"</u>	Size of _____
8 1/4		<u>314'-10</u>	Depth set _____
6 5/8		<u>1612</u>	Perf. top _____
5 3/16			Perf. bottom _____
3			Perf. top _____
2			Perf. bottom _____
Liners Used			Perf. top _____
			Perf. bottom _____

CASING CEMENTED	SIZE	No. Ft.	Date
COAL WAS ENCOUNTERED AT _____ FEET _____ INCHES			

Formation	Color	Hard or Soft	Top	Bottom	Oil, Gas or Water	Depth Found	Remarks
Red Mud			0	25			
Sand			25	50			
Slate			50	90			
Sand			90	120			
Slate			120	310			
Shell			310	320			
Slate			320	360			
Sand			360	640			
Slate and Shells			640	665			
Sand			665	760			
Slate and Shells			760	795			
Black Slate			795	815			
Broken Sand			815	915			
Slate			915	925			
Salt Sand			925	1218			
Slate and Shells			1218	1270			
Big Lime			1270	1436			
Slate and Shells			1436	1495			
Injun Sand			1495	1545			
Slate and Shells			1545	1578			
Shell			1578	1600			
Slate and Shells			1600	1735			
Shell			1735	1765			
Slate and Shells			1765	1943			
Shell			1950	1995			
Slate			1995	2011			
Brown Shale			2011	2031			
Berea Sand			2031	2043			
Slate and Shells			2043	2066			
		Total Depth		2066			

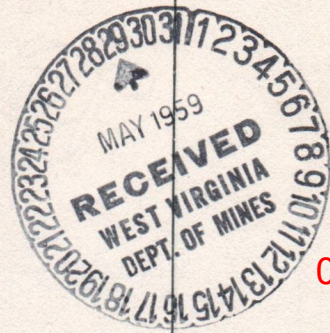

08/18/2023

W. J. Hauldren, (The) Supt.

By *W. J. Hauldren*

APPROVED Wolfe Gas Company, Owner

Date May 27, 1959

Formation	Color	Hard or Soft	Top	Bottom	Oil, Gas or Water	Depth Found	Remarks
			0	25			
			25	30			
			30	35			
			35	40			
			40	45			
			45	50			
			50	55			
			55	60			
			60	65			
			65	70			
			70	75			
			75	80			
			80	85			
			85	90			
			90	95			
			95	100			
			100	105			
			105	110			
			110	115			
			115	120			
			120	125			
			125	130			
			130	135			
			135	140			
			140	145			
			145	150			
			150	155			
			155	160			
			160	165			
			165	170			
			170	175			
			175	180			
			180	185			
			185	190			
			190	195			
			195	200			
			200	205			
			205	210			
			210	215			
			215	220			
			220	225			
			225	230			
			230	235			
			235	240			
			240	245			
			245	250			
			250	255			
			255	260			
			260	265			
			265	270			
			270	275			
			275	280			
			280	285			
			285	290			
			290	295			
			295	300			
			300	305			
			305	310			
			310	315			
			315	320			
			320	325			
			325	330			
			330	335			
			335	340			
			340	345			
			345	350			
			350	355			
			355	360			
			360	365			
			365	370			
			370	375			
			375	380			
			380	385			
			385	390			
			390	395			
			395	400			
			400	405			
			405	410			
			410	415			
			415	420			
			420	425			
			425	430			
			430	435			
			435	440			
			440	445			
			445	450			
			450	455			
			455	460			
			460	465			
			465	470			
			470	475			
			475	480			
			480	485			
			485	490			
			490	495			
			495	500			
			500	505			
			505	510			
			510	515			
			515	520			
			520	525			
			525	530			
			530	535			
			535	540			
			540	545			
			545	550			
			550	555			
			555	560			
			560	565			
			565	570			
			570	575			
			575	580			
			580	585			
			585	590			
			590	595			
			595	600			
			600	605			
			605	610			
			610	615			
			615	620			
			620	625			
			625	630			
			630	635			
			635	640			
			640	645			
			645	650			
			650	655			
			655	660			
			660	665			
			665	670			
			670	675			
			675	680			
			680	685			
			685	690			
			690	695			
			695	700			
			700	705			
			705	710			
			710	715			
			715	720			
			720	725			
			725	730			
			730	735			
			735	740			
			740	745			
			745	750			
			750	755			
			755	760			
			760	765			
			765	770			
			770	775			
			775	780			
			780	785			
			785	790			
			790	795			
			795	800			
			800	805			
			805	810			
			810	815			
			815	820			
			820	825			
			825	830			
			830	835			
			835	840			
			840	845			
			845	850			
			850	855			
			855	860			
			860	865			
			865	870			
			870	875			
			875	880			
			880	885			
			885	890			
			890	895			
			895	900			
			900	905			
			905	910			
			910	915			
			915	920			
			920	925			
			925	930			
			930	935			
			935	940			
			940	945			
			945	950			
			950	955			
			955	960			
			960	965			
			965	970			
			970	975			
			975	980			
			980	985			
			985	990			
			990	995			
			995	1000			

08/18/2023

STATE OF WEST VIRGINIA
DEPARTMENT OF MINES
OIL AND GAS DIVISION

INSPECTOR'S WELL REPORT

Permit No. WAY-1160

Oil or Gas Well 6
(KIND)

Company <u>R. H. Adkins</u>	CASING AND TUBING	USED IN DRILLING	LEFT IN WELL	PACKERS
Address <u>Hamlin, W. Va.</u>	Size			
Farm <u>(T. L. Black) U.F.G.Co. Min. Tr. 30-A</u>	16			Kind of Packer
Well No. <u>6</u>	13			
District <u>Butler</u> County <u>Wayne</u>	10	<u>20'6"</u>		Size of
Drilling commenced <u>2-23-59</u>	8 1/4	<u>314'</u>		Depth set
Drilling completed _____ Total depth _____	6 5/8			
Date shot _____ Depth of shot _____	5 3/16			Perf. top
Initial open flow _____ /10ths Water in _____ Inch	3			Perf. bottom
Open flow after tubing _____ /10ths Merc. in _____ Inch	2			Perf. top
Volume _____ Cu. Ft.	Liners Used			Perf. bottom
Rock pressure _____ lbs. _____ hrs.				
Oil _____ bbls., 1st 24 hrs.	CASING CEMENTED _____ SIZE _____ No. FT. _____ Date _____			
Fresh water <u>440</u> feet _____ feet	no coal			
Salt water _____ feet _____ feet	COAL WAS ENCOUNTERED AT _____ FEET _____ INCHES			
	_____ FEET _____ INCHES _____ FEET _____ INCHES			
	_____ FEET _____ INCHES _____ FEET _____ INCHES			

Drillers' Names Edd White

Marvin Egnor

Remarks: Drilling depth 842 ft.



3-4-59

DATE

J.W. pack
DISTRICT WELL INSPECTOR
08/18/2023

STATE OF WEST VIRGINIA
 DEPARTMENT OF MINES
 OIL AND GAS DIVISION
INSPECTOR'S PLUGGING REPORT

Permit No. _____ Well No. _____

COMPANY _____ ADDRESS _____

FARM _____ DISTRICT _____ COUNTY _____

Filling Material Used _____

Liner _____ Location _____ Amount _____ Packer _____ Location _____

PLUGS USED AND DEPTH PLACED			BRIDGES	CASING AND TUBING		
CEMENT-THICKNESS	WOOD-SIZE	LEAD	CONSTRUCTION-LOCATION	RECOVERED	SIZE	LOST

Drillers' Names _____

Remarks: _____

_____ I hereby certify I visited the above well on this date.

DATE

DISTRICT WELL INSPECTOR
 08/18/2023

Latitude 36° 10'

Longitude 82° 30'

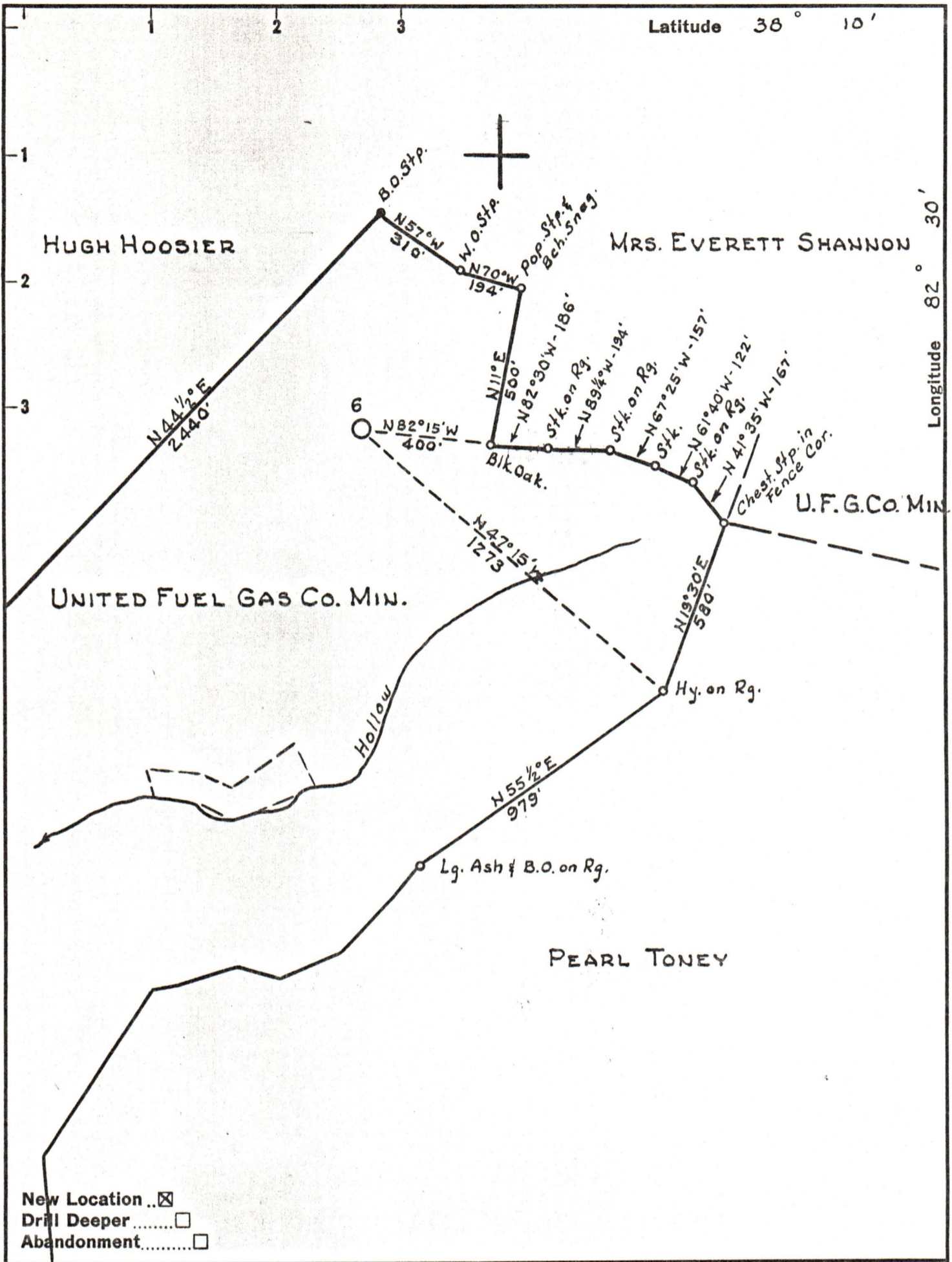

New Location
 Drill Deeper
 Abandonment

Company R. H. ADKINS
 Address HAMLIN, W. VA.
 Farm UNITED FUEL GAS CO. MIN.
 Tract 30-A Acres 100.7 Lease No. _____
 Well (Farm) No. 1 Serial No. 6
 Elevation (Spirit Level) 899.30
 Quadrangle LOUISA
 County WAYNE District BUTLER
 Engineer PAUL E. JOACHIM
 Engineer's Registration No. 669
 File No. A-13 Drawing No. _____
 Date DEC. 9, 1958 Scale 1" = 400'

STATE OF WEST VIRGINIA
 DEPARTMENT OF MINES
 OIL AND GAS DIVISION
 CHARLESTON

WELL LOCATION MAP
 FILE NO. WAY-1160 08/18/2023

+ Denotes location of well on United States Topographic Maps, scale 1 to 62,500, latitude and longitude lines being represented by border lines as shown.
 - Denotes one inch spaces on border line of original tracing.