



STATE OF WEST VIRGINIA
DEPARTMENT OF MINES
OIL AND GAS DIVISION

NOTICE OF PROPOSED LOCATION OF OIL AND GAS WELL

To THE DEPARTMENT OF MINES,
Charleston, W. Va.

COAL OPERATOR OR COAL OWNER

United Fuel Gas Co.
NAME OF WELL OPERATOR

ADDRESS

Charleston, W. Va.
COMPLETE ADDRESS

COAL OPERATOR OR COAL OWNER

September 1, 19 59
PROPOSED LOCATION

ADDRESS

Lincoln District

John B. Hollister & First Nat'l. Bank of
OWNER OF MINERAL RIGHTS/Cincinnati, Trustees, et al
90 Trust Dept. - 4th & Walnut Streets
Cincinnati, Ohio

Wayne County
Well No. 8746 80° 20' E. 1172.11'

ADDRESS

Mary L.S. Perkins, et al #10 Farm
2590.52 acres

GENTLEMEN:

The undersigned well operator is entitled to drill upon the above named farm or tract of land for oil and gas, having fee title thereto, (or as the case may be) under grant or lease dated April 4, 1930, made by Mary L. S. Perkins, et al, to John M. Lewis, et al, and recorded on the 23d day of April, 1930, in the office of the County Clerk for said County in Book 15, page 72.

The enclosed plat was prepared by a competent engineer and shows the proposed location of a well to be drilled for oil and gas by the undersigned well operator on the farm and in the Magisterial District and County above named, determined by survey and courses and distances from two permanent points, or land marks.

The undersigned well operator is informed and believes there are no coal operators operating beds of coal beneath said farm or tract of land on which said well is located, or within 500 feet of the boundaries of the same, who have mapped their workings and filed their maps as required by law, excepting the coal operators or coal owners (if any) above named as addressees.

The above named coal operators or coal owners (if any) are notified that any objections they may desire to make to such proposed location, or which they are required to make by Section 3 of said Code, if the drilling of a well at said proposed location will cause a dangerous condition in or about their respective coal mines, must be received by, or filed with the Department of Mines within ten* days from the receipt of a copy of this notice and accompanying plat by said Department. Said coal operators are further notified that forms for use in making such objections will be furnished to them by the Department of Mines promptly on request and that all such objections must set forth as definitely as is reasonably possible the ground or grounds on which such objections are based and indicate the direction and distance the proposed location should be moved to overcome same.

(The next paragraph is to be completed only in Department's copy.)

Copies of this notice and the enclosed plat were mailed by registered mail, or delivered to the above named coal operators or coal owners at their above shown respective address day before, or on the same day with the mailing or delivery of this copy to the Department of Mines at Charleston, West Virginia.

Very truly yours,

UNITED FUEL GAS COMPANY
WELL OPERATOR
P. O. Box 1273
STREET
Charleston 25
CITY OR TOWN
West Virginia
STATE

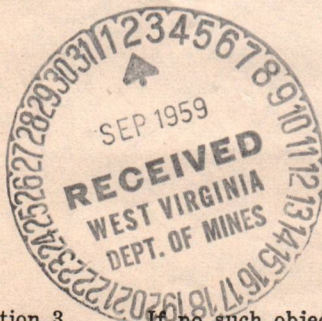

Address of Well Operator }

08/25/2023

*Section 3 . . . If no such objections be filed or be found by the department of mines, within said period of ten days from the receipt of said notice and plat by the department of mines, to said proposed location, the department shall forthwith issue to the well operator a drilling permit reciting the filing of such plat, that no objections have been made by the coal operators to the location, or found thereto by the department, and that the same is approved and the well operator authorized to proceed to drill at said location.

WAY-1221

PERMIT NUMBER

1221



STATE OF WEST VIRGINIA
DEPARTMENT OF MINES
OIL AND GAS DIVISION

NOTICE OF PROPOSED LOCATION OF OIL AND GAS WELL

To The Department of Mines
Charleston, W. Va.

United Fuel Gas Co.

NAME OF WELL OPERATOR

Charleston, W. Va.

COMPLETE ADDRESS

September 1, 1930

PROPOSED LOCATION

Lincoln

County

Wayne

County

Trustees, et al

John B. Hollister & First Nat'l Bank of

Charleston, W. Va.

30 Trust Dept. - Main & Walnut Streets

Charleston, Ohio

Mary J. S. Perkins, et al

County

The undersigned well operator is entitled to drill upon the above named tract of land for

oil and gas having the title thereto for as the case may be under grant or lease dated

Mary J. S. Perkins, et al

April 1, 1930

and recorded on the

33d

John M. Lewis, et al

of

April, 1930

Book 12 page 75

The enclosed plat was prepared by a competent engineer and shows the proposed location of a well to be drilled for oil and gas by the undersigned well operator on the tract and to the Marshall District and County above named, determined by survey and courses and distances from two permanent points on land owned

The undersigned well operator is informed and believes there are no coal operators operating both of coal bearing strata on tract of land on which said well is located or within 500 feet of the bounds of the same who have mapped their workings and filed their maps as required by law, excepting the coal operators or coal owners (if any) above named as addressees.

The above named coal operators or coal owners (if any) are notified that any objections they may desire to make to such proposed location, or which they are required to make by Section 3 of said Code, if the drilling of a well at such proposed location will cause a dangerous condition in or about their respective coal mines, must be received by or filed with the Department of Mines within ten days from the receipt of a copy of this notice and a accompanying plat by said Department. Said coal operators are further notified that failure to file such objections will be deemed to them by the Department of Mines as a consent to the proposed location and that all such objections must set forth as definitely as is reasonably possible the ground or grounds on which such objections are based and indicate the location and distance the proposed location should be moved to overcome same.

(The next paragraph is to be completed only in Department's copy.)

Copies of this notice and the enclosed plat were mailed by registered mail, or delivered to the above

named coal operators or coal owners at their above shown respective addresses

on the same day with the mailing or delivery of this copy to the Department of Mines at Charleston,

West Virginia.

UNITED FUEL GAS COMPANY

WELL OPERATOR

P. O. Box 1473

CITY

Charleston 25

WEST VIRGINIA

West Virginia

STATE

Section 3. All proposed locations of wells to be drilled on or in the State of West Virginia, within said period of ten days from the receipt of this notice and plat, shall be deemed to be approved by the Department of Mines, unless the Department of Mines shall have received a written objection to such location, or unless the Department of Mines shall have been notified by the coal operators or coal owners of the location of such proposed location, and that the same is approved and the well operator authorized to proceed to drill at said location.

Permit Number

12221



08/25/2023



STATE OF WEST VIRGINIA
DEPARTMENT OF MINES
OIL AND GAS DIVISION

NOTICE OF PROPOSED LOCATION OF OIL AND GAS WELL

To THE DEPARTMENT OF MINES,
Charleston, W. Va.

DRILL DEEPER

| | |
|-----------------------------------------------------|-----------------------------------|
| _____ | United Fuel Gas Company |
| COAL OPERATOR OR COAL OWNER | NAME OF WELL OPERATOR |
| _____ | Charleston, W. Va. |
| ADDRESS | COMPLETE ADDRESS |
| _____ | February 8, 19 60 |
| COAL OPERATOR OR COAL OWNER | PROPOSED LOCATION |
| _____ | Lincoln District |
| ADDRESS | _____ County |
| John B. Hollister & First Nat'l. Bank of Wayne | _____ County |
| OWNER OF MINERAL RIGHTS Cincinnati, Trustees, et al | Well No. 8746 |
| c/o Trust Dept. -4th & Walnut Sts. | |
| Cincinnati, Ohio | |
| ADDRESS | Mary L.S. Perkins, et al #10 Farm |

GENTLEMEN:

The undersigned well operator is entitled to drill upon the above named farm or tract of land for oil and gas, having fee title thereto, (or as the case may be) under grant or lease dated April 4, 1930, made by Mary L. S. Perkins, et al, to John M. Lewis, et al, and recorded on the 23d day of April, 1930, in the office of the County Clerk for said County in Book 15, page 72.

The enclosed plat was prepared by a competent engineer and shows the proposed location of a well to be drilled for oil and gas by the undersigned well operator on the farm and in the Magisterial District and County above named, determined by survey and courses and distances from two permanent points, or land marks.

The undersigned well operator is informed and believes there are no coal operators operating beds of coal beneath said farm or tract of land on which said well is located, or within 500 feet of the boundaries of the same, who have mapped their workings and filed their maps as required by law, excepting the coal operators or coal owners (if any) above named as addressees.

The above named coal operators or coal owners (if any) are notified that any objections they may desire to make to such proposed location, or which they are required to make by Section 3 of said Code, if the drilling of a well at said proposed location will cause a dangerous condition in or about their respective coal mines, must be received by, or filed with the Department of Mines within ten* days from the receipt of a copy of this notice and accompanying plat by said Department. Said coal operators are further notified that forms for use in making such objections will be furnished to them by the Department of Mines promptly on request and that all such objections must set forth as definitely as is reasonably possible the ground or grounds on which such objections are based and indicate the direction and distance the proposed location should be moved to overcome same.

(The next paragraph is to be completed only in Department's copy.)

Copies of this notice and the enclosed plat were mailed by registered mail, or delivered to the above named coal operators or coal owners at their above shown respective address _____ day before, or on the same day with the mailing or delivery of this copy to the Department of Mines at Charleston, West Virginia.

Very truly yours,

UNITED FUEL GAS COMPANY

WELL OPERATOR

P. O. Box 1273

STREET

Charleston 25

CITY OR TOWN

West Virginia

STATE

08/25/2023

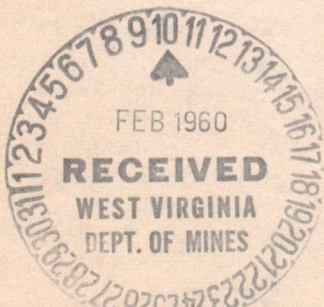

Address of Well Operator }

*Section 3 If no such objections be filed or be found by the department of mines, within said period of ten days from the receipt of said notice and plat by the department of mines, to said proposed location, the department shall forthwith issue to the well operator a drilling permit reciting the filing of such plat, that no objections have been made by the coal operators to the location, or found thereto by the department, and that the same is approved and the well operator authorized to proceed to drill at said location.



STATE OF WEST VIRGINIA
DEPARTMENT OF MINES
OIL AND GAS DIVISION

NOTICE OF PROPOSED LOCATION OF OIL AND GAS WELL

DILL DEEPER

To The Department of Mines
Charleston, W. Va.

United Fuel Gas Company

NAME OF WELL OPERATOR

COAL OPERATOR OR COAL OWNER

Charleston, W. Va.

February 8, 1930

PROPOSED LOCATION

COAL OPERATOR OR COAL OWNER

District

Lincoln

ADDRESS

County

Wayne

John B. Hollister & First Nat'l Bank of
Cincinnati, Trustees, of a

374

c/o Trust Dept. - John & Warren Bldg.
Cincinnati, Ohio

Mary J. Perkins, et al

ADDRESS

The undersigned well operator is authorized and desires to drill upon the above named farm or tract of land for

oil and gas, having for this purpose, for an (see map) and under grant or lease dated

April 4, 1930, made by Mary J. Perkins, et al

and recorded on the

of

in the office of the County Clerk for said County in

Book

The enclosed plat was prepared by a competent engineer and shows the proposed location of a well

to be drilled for oil and gas by the undersigned well operator on the farm and in the adjacent district

and County above named, determined by survey and corner and distance from two permanent points or

land marks.

The undersigned well operator is authorized and desires that the coal operators operating on the

land hereby named and farm or tract of land on which said well is located or within 500 feet of the boarder

of the same who have mapped their workings and filed their maps as required by law, excepting the

coal operators of coal owners (if any) above named, as follows:

The above named coal operators or coal owners, if any, are notified that any objections they may

desire to make to such proposed location or to such plat, are required to make by Section 7 of said Code, if

the drilling of a well at said proposed location will cause a dangerous condition or other like respective

coal mines, must be received by or filed with the Department of Mines within ten days from the receipt of

a copy of this notice and accompanying plat by said Department. Said coal operators are further notified

that failure to file such objections will be deemed a consent to the proposed location of the well and

on request and that all such objections must be forthwith withdrawn or removed from the ground or

grounds on which such objections are based and indicate the distance the proposed location should

be moved to overcome same.

(The next paragraph is to be completed only in Department's copy.)

Copies of this notice and the enclosed plat were mailed by registered mail, pre-delivered to the above

named coal operators or coal owners at their above shown respective offices

on the same day with the mailing or delivery of this notice to the Department of Mines at Charleston

West Virginia

Very truly yours,

UNITED FUEL GAS COMPANY

E. C. Box 1213

Ch. Weston 25

West Virginia

Address
of
Well Operator

08/25/2023

Section 7. If no such objections be filed or be filed by the department of mines within said period of ten days from the receipt of such notice and plat by the department of mines at said proposed location, the department shall forthwith issue to the well operator a permit to drill upon the land on which the well is to be drilled, and the coal operators of coal owners of the land on which the well is to be drilled shall be deemed to have consented to the proposed location of the well and the well operator shall be authorized to proceed to drill at said location.

W. J. [unclear] Permit Number
DILL DEEPER

| Formation | Color | Hard or Soft | Top | Bottom | Oil, Gas or Water | Depth Found | Remarks |
|-----------|-------|--------------|------|--------|-------------------|-------------|---------|
| 1541 | | | 1541 | | | | |
| 1542 | | | 1542 | | | | |
| 1543 | | | 1543 | | | | |
| 1544 | | | 1544 | | | | |
| 1545 | | | 1545 | | | | |
| 1546 | | | 1546 | | | | |
| 1547 | | | 1547 | | | | |
| 1548 | | | 1548 | | | | |
| 1549 | | | 1549 | | | | |
| 1550 | | | 1550 | | | | |
| 1551 | | | 1551 | | | | |
| 1552 | | | 1552 | | | | |
| 1553 | | | 1553 | | | | |
| 1554 | | | 1554 | | | | |
| 1555 | | | 1555 | | | | |
| 1556 | | | 1556 | | | | |
| 1557 | | | 1557 | | | | |
| 1558 | | | 1558 | | | | |
| 1559 | | | 1559 | | | | |
| 1560 | | | 1560 | | | | |
| 1561 | | | 1561 | | | | |
| 1562 | | | 1562 | | | | |
| 1563 | | | 1563 | | | | |
| 1564 | | | 1564 | | | | |
| 1565 | | | 1565 | | | | |
| 1566 | | | 1566 | | | | |
| 1567 | | | 1567 | | | | |
| 1568 | | | 1568 | | | | |
| 1569 | | | 1569 | | | | |
| 1570 | | | 1570 | | | | |
| 1571 | | | 1571 | | | | |
| 1572 | | | 1572 | | | | |
| 1573 | | | 1573 | | | | |
| 1574 | | | 1574 | | | | |
| 1575 | | | 1575 | | | | |
| 1576 | | | 1576 | | | | |
| 1577 | | | 1577 | | | | |
| 1578 | | | 1578 | | | | |
| 1579 | | | 1579 | | | | |
| 1580 | | | 1580 | | | | |
| 1581 | | | 1581 | | | | |
| 1582 | | | 1582 | | | | |
| 1583 | | | 1583 | | | | |
| 1584 | | | 1584 | | | | |
| 1585 | | | 1585 | | | | |
| 1586 | | | 1586 | | | | |
| 1587 | | | 1587 | | | | |
| 1588 | | | 1588 | | | | |
| 1589 | | | 1589 | | | | |
| 1590 | | | 1590 | | | | |
| 1591 | | | 1591 | | | | |
| 1592 | | | 1592 | | | | |
| 1593 | | | 1593 | | | | |
| 1594 | | | 1594 | | | | |
| 1595 | | | 1595 | | | | |
| 1596 | | | 1596 | | | | |
| 1597 | | | 1597 | | | | |
| 1598 | | | 1598 | | | | |
| 1599 | | | 1599 | | | | |
| 1600 | | | 1600 | | | | |

08/25/2023

Date February 5, 19 60

APPROVED UNITED FUEL GAS COMPANY, Owner

By SR Ferrell (Title)

Supt., Civil Engineering Dept.



STATE OF WEST VIRGINIA
DEPARTMENT OF MINES
OIL AND GAS DIVISION

STAFF ENGINEER
MAIL ROOM
18 20

Quadrangle Naugatuck

WELL RECORD

Permit No. WAY-1221

Oil or Gas Well Gas
(KIND)

Company United Fuel Gas Company
Address P.O. Box 1273; Charleston 25, W.Va.
Farm Mary L.S. Perkins, et al #10 Acres 2590.52

Location (waters) Moses Creek

Well No. 8746 Elev. 1172.11

District Lincoln County Wayne

The surface of tract is owned in fee by _____
Address _____

Mineral rights are owned by John B. Hollister & 1st Natl Trust Dept. - 4th & Walnut Sts. Cincinnati, Ohio
Address Cincinnati, Ohio

Drilling commenced 11-12-59

Drilling completed 12-22-59

Date Shot _____ From _____ To _____

With _____

Open Flow 20 /10ths Water in _____ Inch
4 /10ths Merc. in _____ Inch

Volume 2,768,000 - Salt Sand Cu. Ft.

Rock Pressure 245 lbs. 48 hrs.

Oil _____ bbls., 1st 24 hrs.

WELL ACIDIZED _____

WELL FRACTURED _____

| Casing and Tubing | Used in Drilling | Left in Well | Packers |
|------------------------------------|------------------|--------------|------------------------|
| Size | | | Anchor |
| 16 | | | Kind of Packer |
| 13 3/8 | | 15' | 8-5/8" x 10-3/4" x 16" |
| 10 3/4 | | 532 | Size of |
| 8 1/2 5/8 | | 1230 | Depth set 1230' |
| 6 3/8 Bank of Cincinnati, Trustees | | | |
| 5 3/16 | | | |
| 3 | | | Perf. top |
| 2 | | | Perf. bottom |
| Liners Used | | | Perf. top |
| | | | Perf. bottom |

CASING CEMENTED _____ SIZE _____ No. Ft. _____ Date _____

COAL WAS ENCOUNTERED AT 274 FEET 24 INCHES
335 FEET 36 INCHES 349 FEET 36 INCHES
477 FEET 36 INCHES FEET INCHES

RESULT AFTER TREATMENT

ROCK PRESSURE AFTER TREATMENT

Fresh Water _____ Feet Salt Water 1053' Feet

| Formation | Color | Hard or Soft | Top | Bottom | Oil, Gas or Water | Depth | Remarks |
|----------------|-------|--------------|-------|--------|------------------------------------------|-----------------|-----------------------|
| Surface | | | 0 | 4 | Gas 1023-1033' | 26/10 W 2" | 215 M |
| Blue Clay | | | 4 | 15 | Gas 1033-1038' | 72/10 W 2" | 358 M |
| Sand | | | 15 | 91 | | | |
| Slate | | | 91 | 101 | | | Hole full water 1053' |
| Sand | | | 101 | 248 | | | |
| Slate & Shells | | | 248 | 274 | Gas 1245-1247' | 40/10 W 10-3/4" | 6,924 M |
| Coal | | | 274 | 276 | | | |
| Sand | | | 276 | 335 | | | |
| Coal | | | 335 | 338 | Test after running 8-5/8" casing 20/10 M | | |
| Slate | | | 338 | 349 | 4" 2,768 M | | |
| Coal | | | 349 | 352 | | | |
| Slate & Shells | | | 352 | 390 | | | |
| Sand | | | 390 | 435 | Shut in 12-26-59 in 8-5/8" casing. | | |
| Slate & Shells | | | 435 | 477 | | | |
| Coal | | | 477 | 480 | | | |
| Hard Sand | | | 480 | 530 | | | |
| Slate | | | 530 | 538 | | | |
| Hard Sand | | | 538 | 576 | | | |
| Slate | | | 576 | 673 | | | |
| Sand | | | 673 | 715 | | | |
| Slate | | | 715 | 753 | | | |
| Sand | | | 753 | 801 | | | |
| Slate & Shells | | | 801 | 820 | | | |
| Hard Sand | | | 820 | 856 | | | |
| Slate & Shells | | | 856 | 994 | | | |
| Gas Sand | | | 994 | 1040 | | | |
| Salt Sand | | | 1040 | 1195 | | | |
| Lime Shells | | | 1195 | 1247 | | | |
| Total Depth | | | 1247' | | | | |

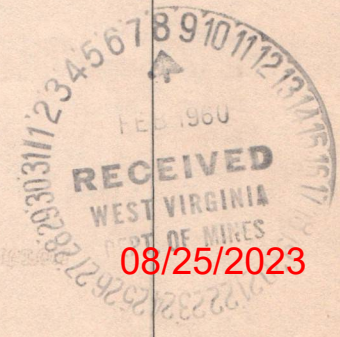

(over)

| Formation | Color | Hard or Soft | Top | Bottom | Oil, Gas or Water | Depth Found | Remarks |
|-----------|-------|--------------|------|--------|-------------------|-------------|---------|
| | | | 3581 | | | | |
| | | | 3580 | 3581 | | | |
| | | | 3085 | 3580 | | | |
| | | | 5052 | 3005 | | | |
| | | | 5112 | 5052 | | | |
| | | | 5211 | 5112 | | | |
| | | | 5201 | 5211 | | | |
| | | | 5101 | 5201 | | | |
| | | | 5301 | 5101 | | | |
| | | | 5300 | 5301 | | | |
| | | | 1812 | 5300 | | | |
| | | | 1832 | 1812 | | | |
| | | | 1852 | 1832 | | | |
| | | | 1158 | 1852 | | | |
| | | | 1000 | 1058 | | | |
| | | | 1211 | 1000 | | | |
| | | | 1205 | 1211 | | | |
| | | | 1250 | 1205 | | | |
| | | | 1180 | 1250 | | | |
| | | | 1121 | 1180 | | | |
| | | | 1115 | 1121 | | | |
| | | | 1111 | 1115 | | | |
| | | | 1381 | 1111 | | | |
| | | | 1381 | 1381 | | | |
| | | | 1511 | 1381 | | | |
| | | | 1511 | 1511 | | | |

08/25/2023

Date July 11, 19 60

APPROVED UNITED FUEL GAS COMPANY, Owner

By S.H. Ferrell
(Title) Supt., Civil Engineering Dept.





STATE OF WEST VIRGINIA
DEPARTMENT OF MINES

OIL AND GAS DIVISION

Quadrangle Naugatuck

DRILL DEEPER

WELL RECORD

Permit No. WAY-1221-D

Oil or Gas Well Gas
(KIND)

Company United Fuel Gas Co.
Address P.O. Box 1273; Charleston 25, W. Va.
Farm Mary L.S. Perkins, et al #10 Acres 2590.52
Location (waters) Moses Creek
Well No. 8746 Elev. 1172.11
District Lincoln County Wayne
The surface of tract is owned in fee by _____
Address _____

| Casing and Tubing | Used in Drilling | Left in Well | Packers |
|-------------------|------------------|--------------|----------------------|
| Size | | | Kind of Packer _____ |
| 16 | | | Hookwall |
| 13 | | | Size of _____ |
| 10 | | | 3 1/2" x 7" x 16" |
| 8 1/4 | 1648' | Pulled | Depth set _____ |
| 7 5/8 | | | 1907' |
| 5 3/16 | | | Perf. top _____ |
| 3 1/2 | Cemented | 2995' | Perf. bottom _____ |
| 2 | | | Perf. top _____ |
| Liners Used | | | Perf. bottom _____ |

Mineral rights are owned by John B. Hollister & First National Bank of Cincinnati, Trustees, et al
90 Trust Dept - 4th & Walnut Sts. Cincinnati, Ohio
Drilling commenced 12-10-60

Drilling completed 14-11-60
Date Shot _____ From _____ To _____

With _____
Open Flow 48 /10ths Water in 1 Inch
8 /10ths W in 2 Inch
Volume 192,000 - Injun & Shale Cu. Ft.
Rock Pressure 370 lbs. 48 hrs.
Oil _____ bbls., 1st 24 hrs.

| CASING CEMENTED | SIZE | No. Ft. | Date |
|-------------------------|------|---------|--------|
| COAL WAS ENCOUNTERED AT | | FEET | INCHES |
| | FEET | INCHES | FEET |
| | FEET | INCHES | FEET |

WELL FRACTURED 5-4-60 with 11,000 gallons water and 14,000# Sand in Injun

RESULT AFTER TREATMENT _____
ROCK PRESSURE AFTER TREATMENT _____
Fresh Water _____ Feet Salt Water _____ Feet

| Formation | Color | Hard or Soft | Top | Bottom | Oil, Gas or Water | Depth | Remarks |
|------------------|-------|--------------|-------|--------|-------------------|-------|------------------------------------------|
| Started Drilling | | | 1247 | | | | |
| Salt Sand | | | 1247 | 1384 | | | Perforated at 1844 and 1851' |
| Break | | | 1384 | 1387 | | | Show gas & oil 2384- 2390' |
| Maxon Sand | | | 1387 | 1414 | | | |
| Slate & Shells | | | 1414 | 1442 | | | Gas 3170-3175' 4/10 W 1" 21 M |
| Red Rock | | | 1442 | 1451 | | | |
| Slate & Shells | | | 1451 | 1480 | | | Test before shot 4/10 W 1" 21 M |
| Red Rock | | | 1480 | 1526 | | | Shot 4-13-60 with 8200# DuPont Gelatin |
| Slate & Shells | | | 1526 | 1562 | | | from 2510-3291' |
| Red Rock | | | 1562 | 1571 | | | Test 18 hours after shot 8/10 W 2" 119 M |
| Gritty Shell | | | 1571 | 1600 | | | |
| Little Lime | | | 1600 | 1628 | | | Test before Fractured - show |
| Big Lime | | | 1728 | 1825 | | | Fractured 5-4-60 with 11,000 gallons |
| Keener Sand | | | 1825 | 1835 | | | water and 14,000# Sand in Injun |
| Red Rock | | | 1835 | 1875 | | | Final open flow - 48/10 W 1" 73 M Injun |
| Slate & Shells | | | 1875 | 2360 | | | 8/10 W 2" 119 M Shale |
| Coffee Shale | | | 2360 | 2384 | | | |
| Berea Grit | | | 2384 | 2467 | | | |
| Slate | | | 2467 | 2504 | | | Shut in 5-16-60 in 3 1/2" tubing. |
| Brown Shale | | | 2504 | 2574 | | | |
| Gray Shale | | | 2574 | 2775 | | | LOGS RUN: |
| Brown Shale | | | 2775 | 2925 | | | Gamma Ray |
| Gray Shale | | | 2925 | 3002 | | | Neutron |
| Brown Shale | | | 3002 | 3280 | | | G. G. Density |
| White Slate | | | 3280 | 3291 | | | Temperature |
| Total Depth | | | 3291' | | | | Laterolog |
| | | | | | | | Microlaterolog |

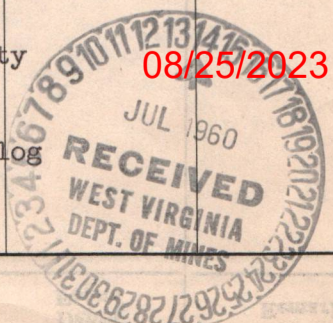

B-3
September 12, 1959

United Fuel Gas Company
P. O. Box 1273
Charleston, West Virginia

Dear Sirs:

Enclosed is Permit WAY-1221 for drilling Well
No. 8746 on Mary L. S. Perkins et al #10 Tract, Lincoln
District, Wayne County.

Please post one copy of permit at the well site.

Very truly yours,

Crawford L. Wilson, Director
DEPARTMENT OF MINES

BY

Assistant Director
OIL AND GAS DIVISION

NG/m
encl:
cc Mr. James W. Pack, Inspector

Mr. R. C. Tucker, Assistant
State Geologist

08/25/2023

B-4



STATE OF WEST VIRGINIA
DEPARTMENT OF MINES
CHARLESTON

February 4, 1960

C
O
P
Y

United Fuel Gas Company
P. O. Box 1275
Charleston, West Virginia

Att: Mr. Bernard Moon

Gentlemen:

Please send us two copies of the completion
drilling record for the following Wells:

| <u>Permit No.</u> | <u>Farm</u> | <u>Well No.</u> | <u>District</u> |
|-------------------|-------------------------------------------|-----------------|-----------------|
| WAY-501-D | Mary L. S. Perkins et al #3 | 5320 | Lincoln |
| WAY-1221 | Mary L. S. Perkins et al #10 | 8746 | Lincoln |
| WAY-1225 | United Fuel Gas Co. Min. Tr. #1, et al | 8896 | Grant |
| WAY-1226 | Mary L. S. Perkins et al #9 | 8748 | Lincoln |

Very truly yours,

CRAWFORD L. WILSON, DIRECTOR
Department of Mines

Assistant Director
OIL AND GAS DIVISION

HG/b

cc: Mr. James W. Pack, Inspector

08/25/2023



STATE OF WEST VIRGINIA
 DEPARTMENT OF MINES
 CHARLESTON

February 14, 1900

United Fuel Gas Company
 P. O. Box 1717
 Charleston, West Virginia
 Atty. W. Bennett Wood

Dear Sir:

I have gone in the office of the coalitions
 holding records for the following wells:

| Well No. | Location | Depth | Remarks |
|-----------|-----------|--------|-----------|
| 101-101-0 | Coalition | 101 ft | Coalition |
| 101-101-1 | Coalition | 101 ft | Coalition |
| 101-101-2 | Coalition | 101 ft | Coalition |
| 101-101-3 | Coalition | 101 ft | Coalition |

Very truly yours,

CHARLES L. WILSON, DIRECTOR
 Department of Mines

COPY

B-5

February 10, 1960

United Fuel Gas Company
P. O. Box 1273
Charleston, West Virginia

Att: Mr. Bernard Noon

Dear Sirs:

Enclosed are permits for deepening the following wells -

| <u>Permit No.</u> | <u>Well No.</u> | <u>Farm</u> | <u>District</u> |
|-------------------|-----------------|--------------------------------------|-----------------|
| LOG-156-D | 8138 | R. H. Adkins et al | Chapmansville |
| WAY-1221-D | 8746 | Mary L. S. Perkins et al #10 Lincoln | |

Very truly yours,

Crawford L. Wilson, Director
DEPARTMENT OF MINES

Assistant Director
OIL AND GAS DIVISION

MG/m
enclosures
cc Mr. Paul Hinchman, Inspector

Mr. James W. Pack, Inspector

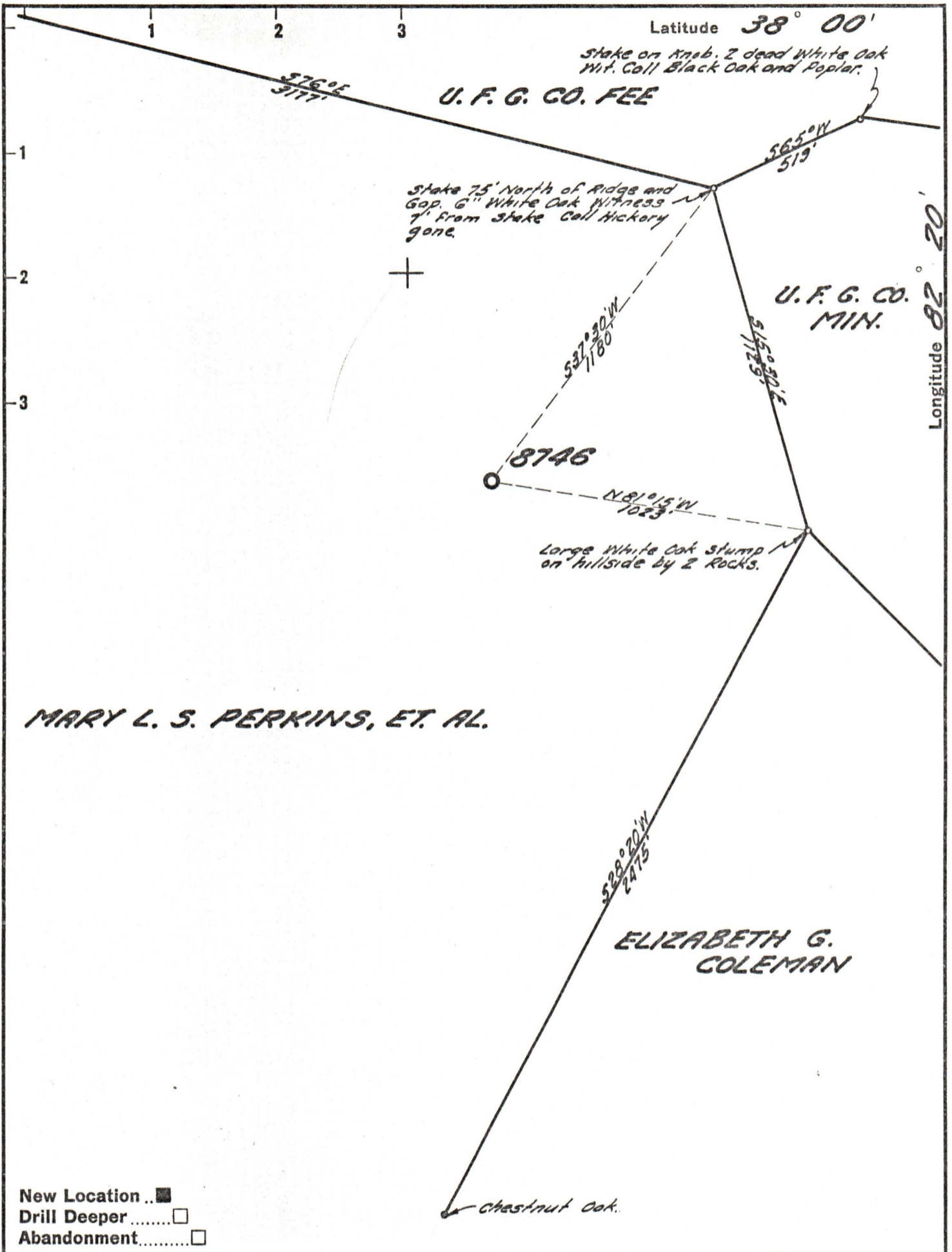

Company UNITED FUEL GAS CO.
 Address CHARLESTON, W.VA.
 Farm MARY L. S. PERKINS, ET AL.
 Tract _____ Acres 2590.52 Lease No. 38181
 Well (Farm) No. 10 Serial No. 8746
 Elevation (Spirit Level) 1172.11'
 Quadrangle NAUGATUCK
 County WAYNE District LINCOLN
 Engineer Super R. J. Jurell
 Engineer's Registration No. 2529
 File No. 18-33 Drawing No. _____
 Date 8-4-59 Scale 1" = 400'

STATE OF WEST VIRGINIA
 DEPARTMENT OF MINES
 OIL AND GAS DIVISION
 CHARLESTON

WELL LOCATION MAP
 FILE NO. WAY-1261 08/25/2023

+ Denotes location of well on United States
 Topographic Maps, scale 1 to 62,500, lat-
 itude and longitude lines being represented
 by border lines as shown.

- Denotes one inch spaces on border line
 of original tracing.