



STATE OF WEST VIRGINIA
DEPARTMENT OF MINES
OIL AND GAS DIVISION

NOTICE OF PROPOSED LOCATION OF OIL AND GAS WELL

To THE DEPARTMENT OF MINES,
Charleston, W. Va.

No Coal Operation

COAL OPERATOR OR COAL OWNER

ADDRESS

United Fuel Gas Company

COAL OPERATOR OR COAL OWNER

Charleston, West Virginia

ADDRESS

United Fuel Gas Company

OWNER OF MINERAL RIGHTS

Charleston, West Virginia

ADDRESS

R. H. Adkins

NAME OF WELL OPERATOR

Hamlin, West Virginia

COMPLETE ADDRESS

September 8, 1959

PROPOSED LOCATION

Butler District

Wayne County

Well No. 1 ^{38° 10'} 82° 30' E. 1045'

United Fuel Gas Co. Mineral Farm
436.5 Acres

GENTLEMEN:

The undersigned well operator is entitled to drill upon the above named farm or tract of land for oil and gas, having fee title thereto, (or as the case may be) under grant or lease dated Nov. 26, 1958, made by United Fuel Gas Company, to R. H. Adkins, and recorded on the _____ day of _____, in the office of the County Clerk for said County in Book _____, page _____.

The enclosed plat was prepared by a competent engineer and shows the proposed location of a well to be drilled for oil and gas by the undersigned well operator on the farm and in the Magisterial District and County above named, determined by survey and courses and distances from two permanent points, or land marks.

The undersigned well operator is informed and believes there are no coal operators operating beds of coal beneath said farm or tract of land on which said well is located, or within 500 feet of the boundaries of the same, who have mapped their workings and filed their maps as required by law, excepting the coal operators or coal owners (if any) above named as addressees.

The above named coal operators or coal owners (if any) are notified that any objections they may desire to make to such proposed location, or which they are required to make by Section 3 of said Code, if the drilling of a well at said proposed location will cause a dangerous condition in or about their respective coal mines, must be received by, or filed with the Department of Mines within ten* days from the receipt of a copy of this notice and accompanying plat by said Department. Said coal operators are further notified that forms for use in making such objections will be furnished to them by the Department of Mines promptly on request and that all such objections must set forth as definitely as is reasonably possible the ground or grounds on which such objections are based and indicate the direction and distance the proposed location should be moved to overcome same.

(The next paragraph is to be completed only in Department's copy.)

Copies of this notice and the enclosed plat were mailed by registered mail, or delivered to the above named coal operators or coal owners at their above shown respective address _____ day _____ before, or on the same day with the mailing or delivery of this copy to the Department of Mines at Charleston, West Virginia.

Very truly yours, R. H. Adkins

R. H. Adkins

WELL OPERATOR

Address of Well Operator

STREET

Hamlin

CITY OR TOWN

West Virginia

STATE

08/25/2023

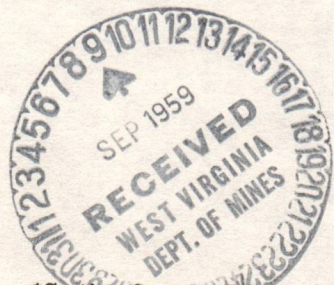

*Section 3. If no such objections be filed or be found by the department of mines, within said period of ten days from the receipt of said notice and plat by the department of mines, to said proposed location, the department shall forthwith issue to the well operator a drilling permit reciting the filing of such plat, that no objections have been made by the coal operators to the location, or found thereto by the department, and that the same is approved and the well operator authorized to proceed to drill at said location.

WAY-1224



STATE OF WEST VIRGINIA
DEPARTMENT OF MINES
OIL AND GAS DIVISION

NOTICE OF PROPOSED LOCATION OF OIL AND GAS WELL

To the Department of Mines
Charleston, W. Va.
No Coal Operation

NAME OF WELL OPERATOR
F. H. Adkins
COMPLETE ADDRESS
Hamlin, West Virginia

PROPOSED LOCATION
September 8, 1929

DISTRICT
Butler
COUNTY
Wayne

WELL NO. 1
United Fuel Gas Co. Mineral
430.5 Acres

The undersigned well operator is entitled to drill upon the above named farm or tract of land for oil and gas, having fee title thereto, (or as the case may be) under grant or lease dated Nov. 20, 1928, made by United Fuel Gas Company to

F. H. Adkins, and recorded on the _____ in the office of the County Clerk for said County in _____ page _____

The enclosed plat was prepared by a competent engineer and shows the proposed location of a well to be drilled for oil and gas by the undersigned well operator on the farm and in the Mineral District and County above named, determined by survey and courses and distances from two permanent points or land marks.

The undersigned well operator is informed and believes there are no coal operators operating beds of coal beneath said farm or tract of land on which said well is located, or within 500 feet of the bounds hereof, who have mapped their workings and filed their maps as required by law, excepting the coal operators or coal owners (if any) above named as addressees.

The above named coal operators or coal owners (if any) are notified that any objections they may desire to make to such proposed location, or which they are required to make by Section 3 of said Act, if the drilling of a well at said proposed location will cause a hazardous condition in or about their respective coal mines, must be received by or filed with the Department of Mines within ten days from the receipt of a copy of this notice and accompanying plat by said Department. Said coal operators are further notified that forms for use in making such objections will be furnished to them by the Department of Mines promptly on request and that all such objections must set forth as definitely as is reasonably possible the ground or grounds on which such objections are based and indicate the direction and distance the proposed location should be moved to overcome same.

(The next paragraph is to be completed only in Department's copy.)

Copies of this notice and the enclosed plat were mailed by registered mail, or delivered to the above named coal operators or coal owners at their above shown respective addresses _____ day _____ before or on the same day with the mailing or delivery of this copy to the Department of Mines at Charleston, West Virginia.

Very truly yours,
F. H. Adkins
WELL OPERATOR

Address of Well Operator
Hamlin
West Virginia

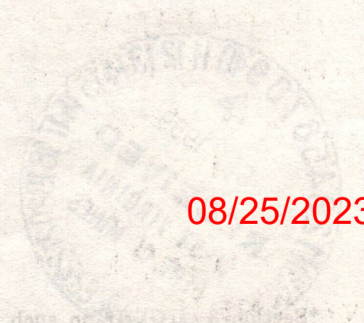

08/25/2023

STATE
CITY OR TOWN
West Virginia
Hamlin

APPROVED AND THE WELL OPERATOR AUTHORIZED TO PROCEED TO DRILL AT SAID LOCATION
DATE

PERMIT NUMBER

B-3

September 19, 1959

Mr. R. H. Adkins
Hamlin, West Virginia

Dear Mr. Adkins:

Enclosed are permits for drilling the following wells -

<u>Permit No.</u>	<u>Well No.</u>	<u>Farm</u>	<u>District</u>
WAY-1223	1	W. M. Peters	Butler
WAY-1224	1	U. F. G. Mineral	Butler

Please post one copy of each permit at the well site. When drilling is completed, please send us two copies of the well record for each location.

Very truly yours,

Crawford L. Wilson, Director
DEPARTMENT OF MINES

BY

Assistant Director
OIL AND GAS DIVISION

MG/m

encl:

cc Mr. James W. Pack, Inspector

Mr. R. C. Tucker, Assistant
State Geologist



STATE OF WEST VIRGINIA
DEPARTMENT OF MINES
OIL AND GAS DIVISION

Quadrangle Louisa

WELL RECORD

Permit No. Way-1224

Oil or Gas Well Gas
(KIND)

Company Wolf Gas Company
Address Hamlin, W.Va.
Farm Tucker Heirs Acres 436 1/2
Location (waters) Long Branch
Well No. 17 (1) Elev. 1045'
District Butler County Wayne
The surface of tract is owned in fee by Tucker Heirs
Address Ft. Gay, W.Va.
Mineral rights are owned by United Fuel Gas Co.
Address Charleston, W.Va.
Drilling commenced Sept 8, 1959
Drilling completed Oct 21, 1959
Date Shot 10-21-59 From 2155 To 2167
With Gas Well B
Open Flow 4 /10ths Water in 2 Inch
90 M. /10ths Merc. in 500 Inch
Volume 90 M. Cu. Ft.
Rock Pressure 500 lbs. 72 hrs.
Oil None bbls., 1st 24 hrs.
Fresh water 132 feet
Salt water 1060 feet 1410 feet

Casing and Tubing	Used in Drilling	Left in Well	Packers
Size			Kind of Packer
16			
13			
10	20' 9 1/2'	20' 9'	Size of
8 1/4	305' 6''	305' 6''	
6 3/4	1749	1749	Depth set
5 3/16			
3			Perf. top
2	Not	2176	Perf. bottom
Liners Used			Perf. top
			Perf. bottom

CASING CEMENTED _____ SIZE _____ No. Ft. _____ Date _____

COAL WAS ENCOUNTERED AT _____ FEET _____ INCHES
_____ FEET _____ INCHES _____ FEET _____ INCHES
_____ FEET _____ INCHES _____ FEET _____ INCHES

Formation	Color	Hard or Soft	Top	Bottom	Oil, Gas or Water	Depth Found	Remarks
Red Clay			0	10			
Blue Slate			10	85			
Red Rock			85	100			
Slate			100	130			
Sand			130	150			
Slate			150	285			
Red Rock			285	295			
Slate			295	500			
Sand			500	675			
Slate			675	750			
Broken sand			750	1060			
Salt Sand			1060	1410			
Big Lime			1410	1550			
Injun Sand			1550	1645			
Slate			1645	1665			
Sand			1665	1745			
Shell			1745	1757			
Slate			1757	1935			
Shell			1935	1960			
Slate			1960	2135			
Brown Shale			2135	2155			
Berea Grit			2155	2167			
Slate			2167	2176			
Total Depth			2176				

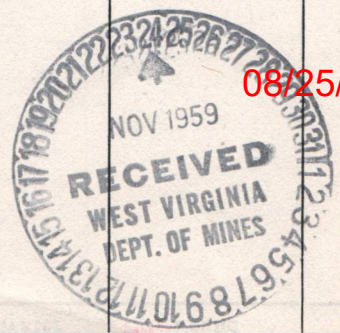

08/25/2023

B-12

STATE OF WEST VIRGINIA
DEPARTMENT OF MINES
OIL AND GAS DIVISION

INSPECTOR'S WELL REPORT

Permit No. WAY-1224

Oil or Gas Well 17
(KIND)

Company <u>R. H. Adkins</u>	CASING AND TUBING	USED IN DRILLING	LEFT IN WELL	PACKERS
Address <u>Hamlin, W. Va.</u>	Size			
Farm <u>U.F.G.Co. Min. Tr.</u>	16			Kind of Packer
Well No. <u>17</u>	13			
District <u>Butler</u> County <u>Wayne</u>	10	<u>20'9"</u>		Size of
Drilling commenced <u>9-8-59</u>	8 1/4	<u>303'</u>		Depth set
Drilling completed _____ Total depth _____	6 3/8			Perf. top
Date shot _____ Depth of shot _____	5 3/16			Perf. bottom
Initial open flow _____ /10ths Water in _____ Inch	3			Perf. top
Open flow after tubing _____ /10ths Merc. in _____ Inch	2			Perf. bottom
Volume _____ Cu. Ft.	Liners Used			Perf. top
Rock pressure _____ lbs. _____ hrs.				Perf. bottom
Oil _____ bbls., 1st 24 hrs.	CASING CEMENTED _____ SIZE _____ No. FT. _____ Date _____			
Fresh water <u>130</u> feet _____ feet	COAL WAS ENCOUNTERED AT _____ FEET _____ INCHES			
Salt water _____ feet _____ feet	_____ FEET _____ INCHES _____ FEET _____ INCHES			
	_____ FEET _____ INCHES _____ FEET _____ INCHES			

Drillers' Names Wilson Holton
Harry Sowards

Remarks: Drilling @ 377'

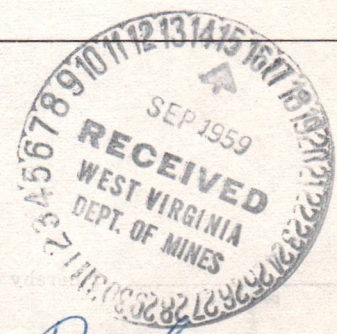

J.W. Pack
DISTRICT WELL INSPECTOR

9-11-59
DATE

08/25/2023

STATE OF WEST VIRGINIA
DEPARTMENT OF MINES
OIL AND GAS DIVISION
INSPECTOR'S PLUGGING REPORT

Permit No. _____

Well No. _____

COMPANY _____ ADDRESS _____

FARM _____ DISTRICT _____ COUNTY _____

Filling Material Used _____

Liner _____ Location _____ Amount _____ Packer _____ Location _____

PLUGS USED AND DEPTH PLACED			BRIDGES	CASING AND TUBING		
CEMENT-THICKNESS	WOOD-SIZE	LEAD	CONSTRUCTION-LOCATION	RECOVERED	SIZE	LOST

Drillers' Names _____

Remarks: _____

_____ I hereby certify I visited the above well on this date.

DATE

DISTRICT WELL INSPECTOR

08/25/2023

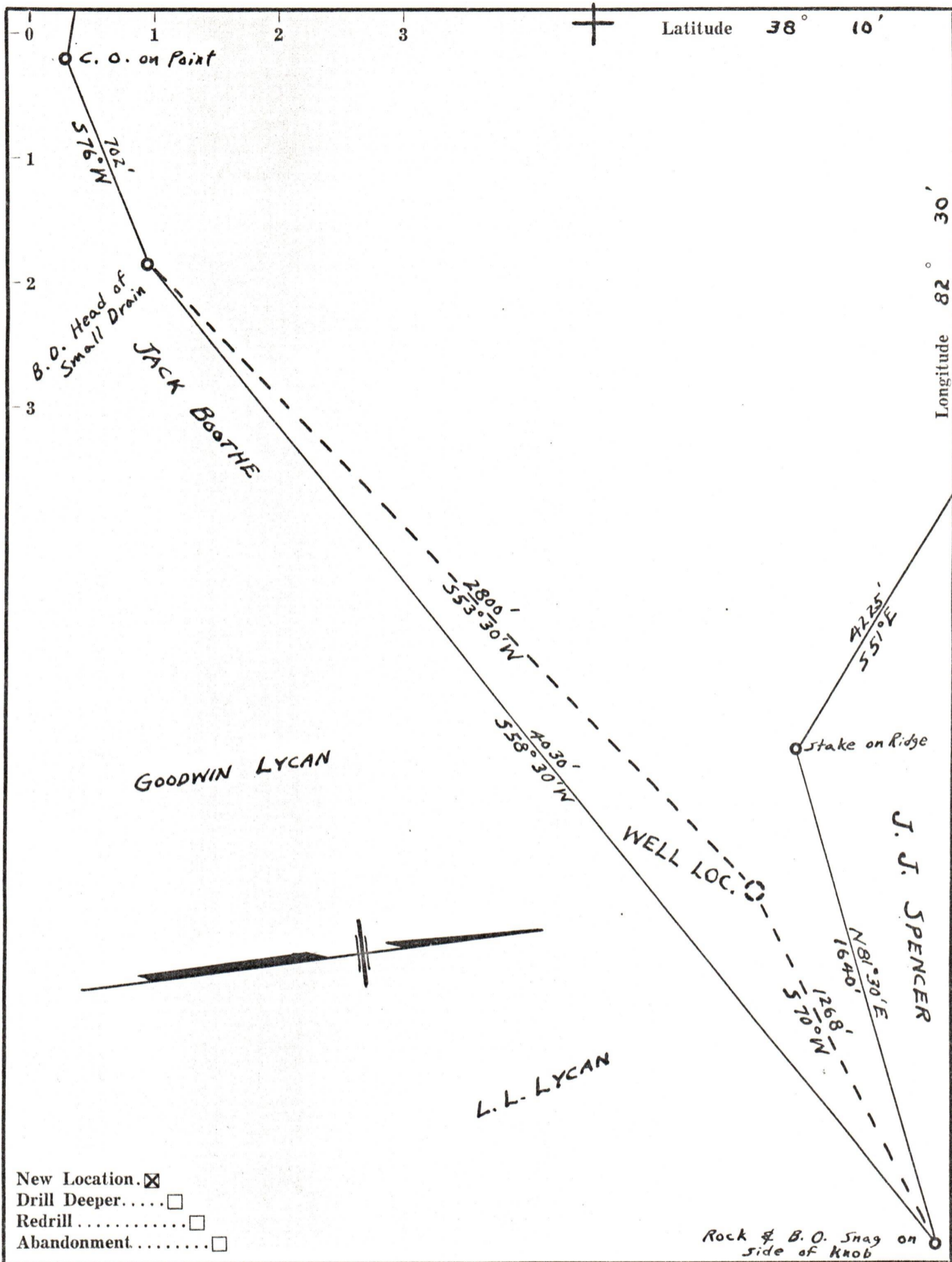

- New Location.
- Drill Deeper.....
- Redrill.....
- Abandonment.....

Company R. H. ADKINS
 Address HAMLIN, W. VA.
 Farm UNITED FUEL GAS CO. MIN.
 Tract _____ Acres 436 1/2 Lease No. _____
 Well (Farm) No. 1 Serial No. 17
 Elevation (Spirit Level) 1045'
 Quadrangle LOUISA, KY., - W. VA.
 County WAYNE District BUTLER
 Engineer W. J. Alloway
 Engineer's Registration No. 3148
 File No. 81 Drawing No. _____
 Date 8-28-59 Scale 1" = 400'

STATE OF WEST VIRGINIA
 DEPARTMENT OF MINES
 OIL AND GAS DIVISION
 CHARLESTON

WELL LOCATION MAP
 FILE NO. WAY-1224

+ Denotes location of well on United States Topographic Maps, scale 1 to 62,500, latitude and longitude lines being represented by border lines as shown.

— Denotes one inch spaces on border line of original tracing.