



STATE OF WEST VIRGINIA  
DEPARTMENT OF MINES  
OIL AND GAS DIVISION

NOTICE OF PROPOSED LOCATION OF OIL AND GAS WELL

To THE DEPARTMENT OF MINES,  
Charleston, W. Va.

<p style="text-align: center; font-size: small;">COAL OPERATOR OR COAL OWNER</p>	<p style="text-align: center;"><b>United Fuel Gas Company</b></p> <p style="text-align: center; font-size: x-small;">NAME OF WELL OPERATOR</p>
<p style="text-align: center; font-size: x-small;">ADDRESS</p>	<p style="text-align: center;"><b>Charleston, W. Va.</b></p> <p style="text-align: center; font-size: x-small;">COMPLETE ADDRESS</p>
<p style="text-align: center; font-size: small;">COAL OPERATOR OR COAL OWNER</p>	<p style="text-align: center;">September 25, 19 61</p> <p style="text-align: center; font-size: small;">PROPOSED LOCATION</p>
<p style="text-align: center; font-size: x-small;">ADDRESS</p>	<p style="text-align: center;"><b>Lincoln</b> District</p>
<p style="text-align: center;"><b>United Fuel Gas Co.</b></p> <p style="text-align: center; font-size: x-small;">OWNER OF MINERAL RIGHTS</p>	<p style="text-align: center;"><b>Wayne</b> County</p>
<p style="text-align: center;"><b>Charleston, W. Va.</b></p> <p style="text-align: center; font-size: x-small;">ADDRESS</p>	<p style="text-align: center;">Well No. <u>9106 38° 05' 82° 25' E. 858.24'</u></p> <p style="text-align: center;"><b>UNITED FUEL GAS CO. MIN. TR. #1</b> Farm</p> <p style="text-align: center; font-size: x-small;">13, 672.82 Acres</p>

GENTLEMEN:

The undersigned well operator is entitled to drill upon the above named farm or tract of land for oil and gas, having fee title thereto, (or as the case may be) under grant or lease dated December 26, 1946, made by Huntington Development & Gas Co., to United Fuel Gas Co., and recorded on the 27th day of December, 1946, in the office of the County Clerk for said County in Book 234, page 318.

The enclosed plat was prepared by a competent engineer and shows the proposed location of a well to be drilled for oil and gas by the undersigned well operator on the farm and in the Magisterial District and County above named, determined by survey and courses and distances from two permanent points, or land marks.

The undersigned well operator is informed and believes there are no coal operators operating beds of coal beneath said farm or tract of land on which said well is located, or within 500 feet of the boundaries of the same, who have mapped their workings and filed their maps as required by law, excepting the coal operators or coal owners (if any) above named as addressees.

The above named coal operators or coal owners (if any) are notified that any objections they may desire to make to such proposed location, or which they are required to make by Section 3 of said Code, if the drilling of a well at said proposed location will cause a dangerous condition in or about their respective coal mines, must be received by, or filed with the Department of Mines within ten\* days from the receipt of a copy of this notice and accompanying plat by said Department. Said coal operators are further notified that forms for use in making such objections will be furnished to them by the Department of Mines promptly on request and that all such objections must set forth as definitely as is reasonably possible the ground or grounds on which such objections are based and indicate the direction and distance the proposed location should be moved to overcome same.

(The next paragraph is to be completed only in Department's copy.)

Copies of this notice and the enclosed plat were mailed by registered mail, or delivered to the above named coal operators or coal owners at their above shown respective address \_\_\_\_\_ day \_\_\_\_\_ before, or on the same day with the mailing or delivery of this copy to the Department of Mines at Charleston, West Virginia.

Very truly yours,

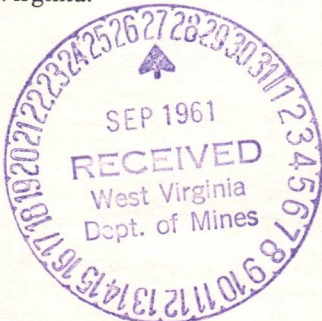

Address of Well Operator }

<p style="text-align: center;"><b>UNITED FUEL GAS COMPANY</b></p> <p style="text-align: center; font-size: x-small;">WELL OPERATOR</p>
<p style="text-align: center;"><b>P. O. Box 1273</b></p> <p style="text-align: center; font-size: x-small;">STREET</p>
<p style="text-align: center;"><b>Charleston 25</b></p> <p style="text-align: center; font-size: x-small;">CITY OR TOWN</p>
<p style="text-align: center;"><b>West Virginia</b></p> <p style="text-align: center; font-size: x-small;">STATE</p>

10/27/2023

\*Section 3 . . . . If no such objections be filed or be found by the department of mines, within said period of ten days from the receipt of said notice and plat by the department of mines, to said proposed location, the department shall forthwith issue to the well operator a drilling permit reciting the filing of such plat, that no objections have been made by the coal operators to the location, or found thereto by the department, and that the same is approved and the well operator authorized to proceed to drill at said location.

1371





STATE OF WEST VIRGINIA  
DEPARTMENT OF MINES  
CHARLESTON

October 7, 1961

C  
O  
P  
Y

United Fuel Gas Company  
P. O. Box 1273  
Charleston 25, West Virginia

Att: Mr. Bernard Moon

Gentlemen:

Enclosed are permits for drilling the following wells:

<u>PERMIT NO.</u>	<u>WELL NO.</u>	<u>FARM</u>	<u>DISTRICT</u>	<u>COUNTY</u>
WAY-1371✓	9106	United Fuel Gas Co. Min. Tr.#1	Lincoln	Wayne
WAY-1372	9107	United Fuel Gas Co. Min. Tr.#1	Lincoln	Wayne

Very truly yours,

Assistant Director  
OIL AND GAS DIVISION

MG/jb  
enclosure

cc: Mr. Kenneth E. Butcher, Inspector

Mr. R. C. Tucker, Assistant  
State Geologist





STATE OF WEST VIRGINIA  
 DEPARTMENT OF MINES  
 CHARLESTON

October 7, 1961

COPY

United Fuel Gas Company  
 P. O. Box 1573  
 Charleston 25, West Virginia

Attn: Mr. Bernard Moon

Gentlemen:

Enclosed are permits for drilling the following wells:

<u>DISTRICT COUNTY</u>	<u>FARM</u>	<u>WELL NO.</u>	<u>PERMIT NO.</u>
Wayne	United Fuel Gas Co. Min. Tr. #1 Lincoln	9108	WAY-1371
Wayne	United Fuel Gas Co. Min. Tr. #1 Lincoln	9107	WAY-1372

Very truly yours,

Assistant Director  
 OIL AND GAS DIVISION

MS:lp  
 enclosure

cc: Mr. Kenneth E. Estcher, Inspector

Mr. R. C. Tucker, Assistant  
 State Geologist



UNITED FUEL GAS COMPANY

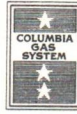

December 18, 1961

PERMIT - WAY-1371-P  
Approved December 18, 1961

Mrs. M. E. Griffith  
Department of Mines  
Charleston, West Virginia

*M. E. Griffith*  
Assistant Director

Dear Mrs. Griffith:

We propose to plug and abandon Well No. 9106, on the United Fuel Gas Company Mineral Tract No. 1 Farm, Lincoln District, Wayne County, West Virginia, Map Square 16-37, in the following manner:

Combination string of 4-1/2" Casing and 2-3/8" Tubing run and cemented in (981' of 4-1/2" Casing and 504' of 2-3/8" Tubing)

Aquagel	1514'	- 1368'	- 20'	above Injun Sand
Cement	1368'	- 1348'		
Aquagel	1348'	- 715'	- 20'	above Salt Sand
Cement	715'	- 695'		
Aquagel	695'	- 620'		
Cut & Pull 4-1/2" Casing			600'	
Cement	620'	- 600'		
Aquagel	600'	- 30'		
Pull 10" Casing			22'	
Aquagel			22'	- 5'
Cement			5'	- Surface

Erect monument 30" above the surface with inscription  
"United Fuel Gas Co. Well No. 9106 - Abandoned Date  
" .

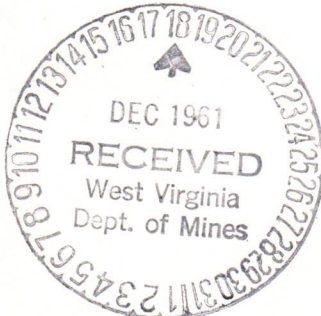

Yours very truly,

*W. B. Osbourn*  
W. B. Osbourn  
Division Superintendent

WBO:jcr













STATE OF WEST VIRGINIA  
DEPARTMENT OF MINES  
OIL AND GAS DIVISION

Quadrangle Wayne

Permit No. WAY-1371

WELL RECORD

Oil or Gas Well Dry

Dry  
Gas  
(KIND)

Company United Fuel Gas Company  
Address P.O. Box 1273; Charleston 25, W. Va.  
Farm United Fuel Gas Co. Min. Tr. #1 Acres 13,672.82  
Location (waters) Lost Creek  
Well No. 9106 Elev. 858.24  
District Lincoln County Wayne  
The surface of tract is owned in fee by \_\_\_\_\_  
Address \_\_\_\_\_  
Mineral rights are owned by United Fuel Gas Co.  
Address Charleston, W. Va.  
Drilling commenced 10-24-61  
Drilling completed 11-28-61  
Date Shot \_\_\_\_\_ From \_\_\_\_\_ To \_\_\_\_\_  
With \_\_\_\_\_  
Open Flow \_\_\_\_\_ /10ths Water in \_\_\_\_\_ Inch  
\_\_\_\_\_ /10ths Merc. in \_\_\_\_\_ Inch  
Volume \_\_\_\_\_ Cu. Ft.  
Rock Pressure \_\_\_\_\_ lbs. \_\_\_\_\_ hrs.  
Oil \_\_\_\_\_ bbls., 1st 24 hrs.  
WELL ACIDIZED \_\_\_\_\_  
WELL FRACTURED 12-5-61 22,000# Sand & 410 Bbl. Water

Casing and Tubing	Used in Drilling	Left in Well	Packers
Size			Kind of Packer
16			
13			
10 3/4		22'	Size of
8 5/8	254'	Pulled	
8 7"	1203'	Pulled	Depth set
5 x 6 1/2	1332'	Pulled	
4 1/2		981'	Perf. top
2 3/8		504'	Perf. bottom
Liners Used-			Perf. top
(Combination String of		2-3/8" &	Perf. bottom
		4-1/2")	

CASING CEMENTED \_\_\_\_\_ SIZE \_\_\_\_\_ No. Ft. \_\_\_\_\_ Date \_\_\_\_\_

COAL WAS ENCOUNTERED AT \_\_\_\_\_ FEET \_\_\_\_\_ INCHES  
\_\_\_\_\_ FEET \_\_\_\_\_ INCHES \_\_\_\_\_ FEET \_\_\_\_\_ INCHES  
\_\_\_\_\_ FEET \_\_\_\_\_ INCHES \_\_\_\_\_ FEET \_\_\_\_\_ INCHES

RESULT AFTER TREATMENT

ROCK PRESSURE AFTER TREATMENT

Fresh Water 125 Feet Salt Water 750; 891-978' Feet 1258-1268'

Formation	Color	Hard or Soft	Top	Bottom	Oil, Gas or Water	Depth	Remarks
Clay			0	23			
Sand			23	38			
Slate			38	60			
Sand			60	136	Water at 125' - Hole full		
Slate			136	220			
Sand			220	240			
Slate			240	260			
Sand			260	350			
Slate			350	400			
Sand			400	440			
Slate			440	464			
Sand			464	507			
Slate			507	530			
Sand			530	570			
Slate			570	607			
Sand			607	665			
Slate			665	685			
Sand			685	710			
Slate			710	735			
Salt Sand			735	825	Water at 750' - Hole Full		
Lime			825	891	Gas at 888'-891' - 10/10 M 2"		
Salt Sand			891	1055	Water at 891'-978'		
Slate			1055	1058			
Maxon Sand			1058	1110			
Slate			1110	1146			
Sand			1146	1175			
Big Lime			1175	1365	Water at 1258'-1268'		
Keener Sand			1365	1388	Show of Gas at 1340'		
Injun Sand			1388	1470			
Slate & Shells			1470	1514			
Total Depth			1514'				



10/27/2023



**UNITED FUEL GAS COMPANY**  
COMPANY

**SERIAL WELL NO.** 9106      **LEASE NO.** No Ref.      **MAP SQUARE** 16-37

RECORD OF WELL NO. <u>9106</u> on the		CASING AND TUBING				TEST BEFORE SHOT
UFG Co. Min. Tr. #1 farm of <u>13,672.82</u> Acres		SIZE	WEIGHT	USED IN DRILLING	LEFT IN WELL	/10 of Water in.....inch
in <u>Lincoln</u> District		<u>10-3/4"</u>	<u>32#</u>	<u>22'</u>		/10 of Merc. in.....inch
<u>Wayne</u> County		<u>8-5/8"</u>	<u>24#</u>	<u>254'</u>	<u>Pulled</u>	Volume.....Cu. ft.
State of: <u>West Virginia</u>		<u>7"</u>	<u>20#</u>	<u>1203'</u>	<u>Pulled</u>	<b>TEST AFTER SHOT</b>
Field: <u>Central Division</u>		<u>5-1/2"</u>	<u>15#</u>	<u>1332'</u>	<u>Pulled</u>	/10 of Water in.....inch
Rig Commenced <u>By Contractor</u> 19		<u>4-1/2"</u>	<u>11#</u>	<u>981'</u>		/10 of Merc. in.....inch
Rig Completed <u>By Contractor</u> 19		<u>2-3/8"</u>	<u>4#</u>	<u>504'</u>		Volume.....Cu. ft.
Drilling Commenced <u>October 24,</u> 19 <u>61</u>		<u>(Combination String of 2-3/8" &amp; 4 1/2")</u>				.....Hours After Shot
Drilling Completed <u>November 28,</u> 19 <u>61</u>						Rock Pressure.....
Drilling to cost per foot						Date <u>Shut Frac. 12/5/61</u>
Contractor is: <u>E. J. Elkins</u>						<u>22,000# Sand &amp; 410 Bbl. Water</u>
Address: <u>Hamlin, W. Va.</u>		<b>SHUT IN</b>				Oil Flowed.....bbls. 1st 24 hrs.
						Oil Pumped.....bbls. 1st 24 hrs.
Driller's Name <u>Lynett McComas</u>		.....in.			Tubing or Casing	
<u>Sax McComas</u>		Size of Packer.....				Well abandoned and
<u>Andrew Tabor</u>		Kind of Packer.....				Plugged.....19
Drilling Permit No. <u>WAY-1371</u>		1st. Perf. Set.....from.....				
Elevation: <u>858.24'</u>		2nd Perf. Set.....from.....				

**DRILLER'S RECORD**

FORMATION	TOP	BOTTOM	THICKNESS	REMARKS
Clay	0	23	23	
Sand	23	38	15	
Slate	38	60	22	
Sand	60	136	76	Water @ 125' - Hole Full
Slate	136	220	84	
Sand	220	240	20	
Slate	240	260	20	
Sand	260	350	90	
Slate	350	400	50	
Sand	400	440	40	
Slate	440	464	24	
Sand	464	507	43	
Slate	507	530	23	
Sand	530	570	40	
Slate	570	607	37	
Sand	607	665	58	
Slate	665	685	20	

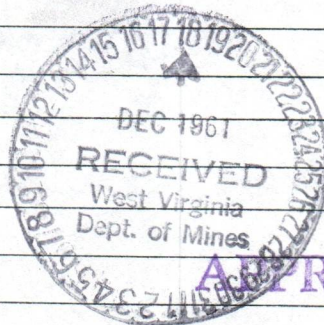

**APPROVED**  
*[Signature]*  
**DIVISION SUPERINTENDENT**

10/27/2023



UNITED FUEL GAS COMPANY

COMPANY

10-37 MAR SQUARE

LEASE NO. No. 101

SERIAL WELL NO. 2100

TEST BEFORE SHOT	CASING AND TUBING			RECORD OR WELL NO.	DATE
inch	LEFT IN WELL	BEER IN DRILLING	WEIGHT	1, 2, 3, 4, 5, 6, 7, 8, 9, 10, 11, 12, 13, 14, 15, 16, 17, 18, 19, 20, 21, 22, 23, 24, 25, 26, 27, 28, 29, 30, 31, 32, 33, 34, 35, 36, 37, 38, 39, 40, 41, 42, 43, 44, 45, 46, 47, 48, 49, 50, 51, 52, 53, 54, 55, 56, 57, 58, 59, 60, 61, 62, 63, 64, 65, 66, 67, 68, 69, 70, 71, 72, 73, 74, 75, 76, 77, 78, 79, 80, 81, 82, 83, 84, 85, 86, 87, 88, 89, 90, 91, 92, 93, 94, 95, 96, 97, 98, 99, 100	DATE
10 of Water in		22'	324	10-3/4"	1, 2, 3, 4, 5, 6, 7, 8, 9, 10, 11, 12, 13, 14, 15, 16, 17, 18, 19, 20, 21, 22, 23, 24, 25, 26, 27, 28, 29, 30, 31, 32, 33, 34, 35, 36, 37, 38, 39, 40, 41, 42, 43, 44, 45, 46, 47, 48, 49, 50, 51, 52, 53, 54, 55, 56, 57, 58, 59, 60, 61, 62, 63, 64, 65, 66, 67, 68, 69, 70, 71, 72, 73, 74, 75, 76, 77, 78, 79, 80, 81, 82, 83, 84, 85, 86, 87, 88, 89, 90, 91, 92, 93, 94, 95, 96, 97, 98, 99, 100
10 of Water in	Pulled	22'	324	6-5/8"	1, 2, 3, 4, 5, 6, 7, 8, 9, 10, 11, 12, 13, 14, 15, 16, 17, 18, 19, 20, 21, 22, 23, 24, 25, 26, 27, 28, 29, 30, 31, 32, 33, 34, 35, 36, 37, 38, 39, 40, 41, 42, 43, 44, 45, 46, 47, 48, 49, 50, 51, 52, 53, 54, 55, 56, 57, 58, 59, 60, 61, 62, 63, 64, 65, 66, 67, 68, 69, 70, 71, 72, 73, 74, 75, 76, 77, 78, 79, 80, 81, 82, 83, 84, 85, 86, 87, 88, 89, 90, 91, 92, 93, 94, 95, 96, 97, 98, 99, 100
TEST AFTER SHOT	Pulled	1203'	204	7"	1, 2, 3, 4, 5, 6, 7, 8, 9, 10, 11, 12, 13, 14, 15, 16, 17, 18, 19, 20, 21, 22, 23, 24, 25, 26, 27, 28, 29, 30, 31, 32, 33, 34, 35, 36, 37, 38, 39, 40, 41, 42, 43, 44, 45, 46, 47, 48, 49, 50, 51, 52, 53, 54, 55, 56, 57, 58, 59, 60, 61, 62, 63, 64, 65, 66, 67, 68, 69, 70, 71, 72, 73, 74, 75, 76, 77, 78, 79, 80, 81, 82, 83, 84, 85, 86, 87, 88, 89, 90, 91, 92, 93, 94, 95, 96, 97, 98, 99, 100
10 of Water in	Pulled	1332'	124	5-1/2"	1, 2, 3, 4, 5, 6, 7, 8, 9, 10, 11, 12, 13, 14, 15, 16, 17, 18, 19, 20, 21, 22, 23, 24, 25, 26, 27, 28, 29, 30, 31, 32, 33, 34, 35, 36, 37, 38, 39, 40, 41, 42, 43, 44, 45, 46, 47, 48, 49, 50, 51, 52, 53, 54, 55, 56, 57, 58, 59, 60, 61, 62, 63, 64, 65, 66, 67, 68, 69, 70, 71, 72, 73, 74, 75, 76, 77, 78, 79, 80, 81, 82, 83, 84, 85, 86, 87, 88, 89, 90, 91, 92, 93, 94, 95, 96, 97, 98, 99, 100
10 of Water in		981'	114	1-1/2"	1, 2, 3, 4, 5, 6, 7, 8, 9, 10, 11, 12, 13, 14, 15, 16, 17, 18, 19, 20, 21, 22, 23, 24, 25, 26, 27, 28, 29, 30, 31, 32, 33, 34, 35, 36, 37, 38, 39, 40, 41, 42, 43, 44, 45, 46, 47, 48, 49, 50, 51, 52, 53, 54, 55, 56, 57, 58, 59, 60, 61, 62, 63, 64, 65, 66, 67, 68, 69, 70, 71, 72, 73, 74, 75, 76, 77, 78, 79, 80, 81, 82, 83, 84, 85, 86, 87, 88, 89, 90, 91, 92, 93, 94, 95, 96, 97, 98, 99, 100
Volume		204'	114	2-3/8"	1, 2, 3, 4, 5, 6, 7, 8, 9, 10, 11, 12, 13, 14, 15, 16, 17, 18, 19, 20, 21, 22, 23, 24, 25, 26, 27, 28, 29, 30, 31, 32, 33, 34, 35, 36, 37, 38, 39, 40, 41, 42, 43, 44, 45, 46, 47, 48, 49, 50, 51, 52, 53, 54, 55, 56, 57, 58, 59, 60, 61, 62, 63, 64, 65, 66, 67, 68, 69, 70, 71, 72, 73, 74, 75, 76, 77, 78, 79, 80, 81, 82, 83, 84, 85, 86, 87, 88, 89, 90, 91, 92, 93, 94, 95, 96, 97, 98, 99, 100
Hours After Shot	(Compressor string of 2-3/8" x 12')				to 61
Rock 1 sample					to 61
Drilling to east					
Contractor	E. J. Adams				
Address	Hamilton, W. Va.				
Owner's Name	James McComas				
	Andrew Tabor				
Drilling Permit No.	WAY-1371				
Elevation	558' ±				

DRILLER'S RECORD

REMARKS	THICKNESS	SECTION	TOP	ELEVATION
	23	23	0	Clay
	15	38	23	Sand
	22	60	38	Slate
Water @ 125' - Hole Full	76	136	60	Sand
	81	220	136	Slate
	20	240	220	Sand
	20	260	240	Slate
	20	280	260	Sand
	20	300	280	Slate
	10	310	300	Sand
	21	331	310	Slate
	13	344	331	Sand
	23	367	344	Slate
	10	377	367	Sand
	37	414	377	Slate
	28	442	414	Sand
	20	462	442	Sand

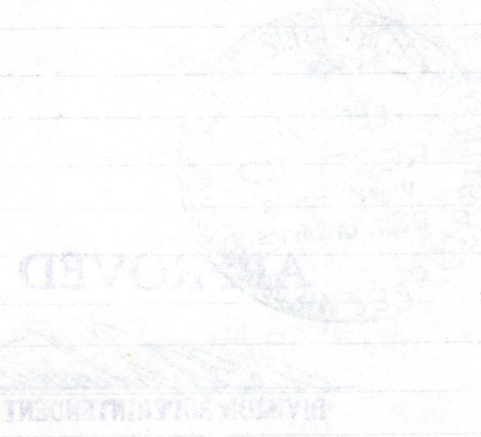

10/27/2023







SERIAL WELL NO. 2100

LEASE NO.

No. 1

MAP SQUARE

10-37

DRILLER'S RECORD

FORMATION	TOP	BOTTOM	THICKNESS	REMARKS
Sand	685	710	25	
Slate	710	735	25	
Self Sand	735	825	90	Water @ 750' - Hole Full
Same	825	891	66	Gas @ 888'-921' - 10/10 M-2"
Self Sand	891	1025	134	Water @ 891' to 978'
Slate	1025	1058	33	
Block Sand	1058	1110	52	
Slate	1110	1140	30	
Sand	1140	1175	35	
Big Lino	1175	1385	210	Water @ 1258'-1268'
Keener Sand	1385	1400	15	Show of Gas @ 1310'
Light Sand	1388	1470	82	
Slate & Shells	1470	1575	105	
TOTAL DEPTH	1575			

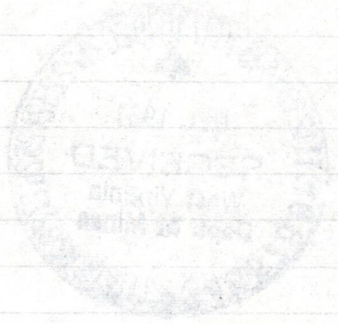







STATE OF WEST VIRGINIA  
DEPARTMENT OF MINES  
OIL AND GAS DIVISION

INSPECTOR'S WELL REPORT

Permit No. \_\_\_\_\_

Oil or Gas Well \_\_\_\_\_  
(KIND)

	CASING AND TUBING	USED IN DRILLING	LEFT IN WELL	PACKERS
Company _____				
Address _____	Size			
Farm _____	16			Kind of Packer _____
Well No. _____	13			
District _____ County _____	10			Size of _____
Drilling commenced _____	8 1/4			
Drilling completed _____ Total depth _____	6 5/8			Depth set _____
Date shot _____ Depth of shot _____	5 3/16			
Initial open flow _____ /10ths Water in _____ Inch	3			Perf. top _____
Open flow after tubing _____ /10ths Merc. in _____ Inch	2			Perf. bottom _____
Volume _____ Cu. Ft.	Liners Used			Perf. top _____
Rock pressure _____ lbs. _____ hrs.				Perf. bottom _____
Oil _____ bbls., 1st 24 hrs.	CASING CEMENTED _____ SIZE _____ No. FT. _____ Date _____			
Fresh water _____ feet _____ feet	COAL WAS ENCOUNTERED AT _____ FEET _____ INCHES			
Salt water _____ feet _____ feet	_____ FEET _____ INCHES _____ FEET _____ INCHES			

Drillers' Names \_\_\_\_\_

Remarks:

DATE

DISTRICT WELL INSPECTOR

10/27/2023







STATE OF WEST VIRGINIA  
DEPARTMENT OF MINES  
OIL AND GAS DIVISION

INSPECTOR'S WELL REPORT

Permit No. \_\_\_\_\_

Oil or Gas Well \_\_\_\_\_  
(KIND)

		CASING AND TUBING	USED IN DRILLING	LEFT IN WELL	PACKERS
Company _____		Size			
Address _____		16			Kind of Packer _____
Farm _____		13			
Well No. _____		10			Size of _____
District _____ County _____		8 1/4			
Drilling commenced _____		6 5/8			Depth set _____
Drilling completed _____ Total depth _____		5 3/16			
Date shot _____ Depth of shot _____		3			Perf. top _____
Initial open flow _____ /10ths Water in _____ Inch		2			Perf. bottom _____
Open flow after tubing _____ /10ths Merc. in _____ Inch		Liners Used			Perf. top _____
Volume _____ Cu. Ft.					Perf. bottom _____
Rock pressure _____ lbs. _____ hrs.		CASING CEMENTED _____ SIZE _____ No. FT. _____ Date _____			
Oil _____ bbls., 1st 24 hrs.		COAL WAS ENCOUNTERED AT _____ FEET _____ INCHES			
Fresh water _____ feet _____ feet		_____ FEET _____ INCHES _____ FEET _____ INCHES			
Salt water _____ feet _____ feet		_____ FEET _____ INCHES _____ FEET _____ INCHES			

Drillers' Names \_\_\_\_\_

Remarks:

DATE

DISTRICT WELL INSPECTOR

10/27/2023







STATE OF WEST VIRGINIA  
DEPARTMENT OF MINES  
OIL AND GAS DIVISION

INSPECTOR'S WELL REPORT

Permit No. \_\_\_\_\_

Oil or Gas Well \_\_\_\_\_  
(KIND)

	CASING AND TUBING	USED IN DRILLING	LEFT IN WELL	PACKERS
Company _____	Size			
Address _____	16			Kind of Packer _____
Farm _____	13			
Well No. _____	10			Size of _____
District _____ County _____	8 1/4			
Drilling commenced _____	6 5/8			Depth set _____
Drilling completed _____ Total depth _____	5 3/16			
Date shot _____ Depth of shot _____	3			Perf. top _____
Initial open flow _____ /10ths Water in _____ Inch	2			Perf. bottom _____
Open flow after tubing _____ /10ths Merc. in _____ Inch	Liners Used _____			Perf. top _____
				Perf. bottom _____

Volume \_\_\_\_\_ Cu. Ft. CASING CEMENTED \_\_\_\_\_ SIZE \_\_\_\_\_ No. FT. \_\_\_\_\_ Date \_\_\_\_\_

Rock pressure \_\_\_\_\_ lbs. \_\_\_\_\_ hrs.

Oil \_\_\_\_\_ bbls., 1st 24 hrs. COAL WAS ENCOUNTERED AT \_\_\_\_\_ FEET \_\_\_\_\_ INCHES

Fresh water \_\_\_\_\_ feet \_\_\_\_\_ feet \_\_\_\_\_ FEET \_\_\_\_\_ INCHES \_\_\_\_\_ FEET \_\_\_\_\_ INCHES

Salt water \_\_\_\_\_ feet \_\_\_\_\_ feet \_\_\_\_\_ FEET \_\_\_\_\_ INCHES \_\_\_\_\_ FEET \_\_\_\_\_ INCHES

Drillers' Names \_\_\_\_\_

Remarks: \_\_\_\_\_

DATE \_\_\_\_\_

DISTRICT WELL INSPECTOR \_\_\_\_\_

10/27/2023



PROPOSED MANNER OF PLUGGING AND FILLING WELL

(REQUIRED BY RULES AND REGULATIONS)

WEST VIRGINIA DEPARTMENT OF MINES

OIL AND GAS DIVISION

WORK ORDER

Well to be plugged and filled as follows:

Combination string of 4-1/2" Casing and 2-3/8" Tubing run and cemented in (981' of 4 1/2" Casing and 504' of 2-3/8" Tubing)

Aquagel 1514' - 1368' - 20' above Injun Sand

Cement 1368' - 1348'

Aquagel 1348' - 715' - 20' above Salt Sand

Cement 715' - 695'

Aquagel 695' - 620'

Cut & Pull 4 1/2" Casing 600'

Cement 620' - 600'

Aquagel 600' - 30'

Pull 10" Casing 22'

Aquagel 22' - 5'

Cement 5' - Surface

Erect monument 30" above the surface with inscription "United Fuel Gas Co. Well No. 9106 - Abandoned Date \_\_\_\_\_."

To the Department of Mines
Coal Owner or Operator,
Lease or Property Owner.

Gentlemen:

This "work order" is submitted for your approval and concurrence and unless notified of your disapproval or non-concurrence, the undersigned will proceed with the plugging and filling of said well in the above described manner on the date inspector is notified after permit is issued.

Very truly yours,

UNITED FUEL GAS COMPANY

Well Operator

No objections have been filed by the coal owner or coal operator, or any available adjacent lease or property owners or interposed by the Department of Mines to the manner herein described for the plugging and filling of the well above mentioned. Therefore, the same is hereby approved 10/27/2023

day of \_\_\_\_\_, 19\_\_\_\_.

DEPARTMENT OF MINES
Oil and Gas Division

By: \_\_\_\_\_

NOTE: This "work order" shall be filed in triplicate, one copy for the files of the Department of Mines; one to be approved or corrected and returned to the well operator as his authority for plugging said well; and one for the well inspector.





STATE OF WEST VIRGINIA  
DEPARTMENT OF MINES  
OIL AND GAS DIVISION

NOTICE OF INTENTION TO PLUG AND ABANDON WELL

(REQUIRED BY SECTION 9, ARTICLE 4, CHAPTER 22 OF THE CODE)

TO THE DEPARTMENT OF MINES,  
Charleston, W. Va.

Coal Operator	United Fuel Gas Company;
Address	Name of Well Operator P. O. Box 1273 Charleston 25, W. Va.
Coal Owner	Complete Address December 19, 1961 Date
Address	WELL TO BE ABANDONED Lincoln District
United Fuel Gas Company Lease or Property Owner	Wayne County
Charleston, W. Va. Address	Well No. 9106
Inspector to be notified <b>DANA LAWSON HAMLIN, W. VA.</b>	Telephone Number <b>Hamlin 824-3672</b>

Gentlemen:— **24 HOURS IN ADVANCE OF PLUGGING**

The undersigned well operator is about to abandon the above described well and will commence the work of plugging and abandoning said well on the date inspector is notified (which date shall not be less than five days after the day on which this notice so mailed is received, or in due course should be received by the Department of Mines).

This notice is given you in order that your respective representatives may be present at the plugging and filling of said well. You are further notified that whether you are represented or not represented the undersigned will proceed on that date, or shortly thereafter, to plug and fill said well in the manner required by Section 10, Article 4, Chapter 22 of the Code and given in detail on the reverse side of this notice, in "Work Order."

This notice is being mailed by registered mail to each of you at the above addresses on the above date.

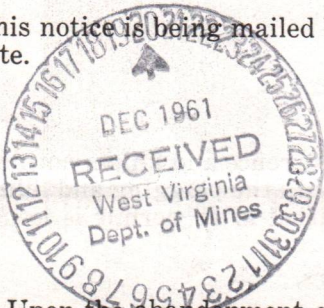

Very truly yours,  
**UNITED FUEL GAS COMPANY**  
Well Operator

NOTE: Upon the abandonment of any well drilled prior to June 1, 1929, a plat prepared by a registered engineer, shall be filed with THREE COPIES OF APPLICATION, (OG-9) AND "WORK ORDER" AND TWO COPIES OF THE WELL RECORD, (OG-10). The map must show the district and county in which the tract of land is located, the name and acreage of same, the name or names of the owners and names of adjacent tracts and the location of the well to be abandoned, determined by survey with the courses and distances of such well from two permanent points or landmarks on said tract.

10/27/2023

NOTE: In case plugging is not commenced within four months from the date of permit, same shall expire and be of no further force or effect.

NOTE: PERMIT IS NOT TRANSFERABLE.

WAY-1371-P  
Permit Number



STATE OF WEST VIRGINIA  
DEPARTMENT OF MINES  
OIL AND GAS DIVISION

AFFIDAVIT OF PLUGGING AND FILLING WELL

AFFIDAVIT SHOULD BE MADE IN TRIPLICATE, ONE COPY MAILED TO THE DEPARTMENT, ONE COPY TO BE RETAINED BY THE WELL OPERATOR AND THE THIRD COPY (AND EXTRA COPIES IF REQUIRED) SHOULD BE MAILED TO EACH COAL OPERATOR AT THEIR RESPECTIVE ADDRESSES.

COAL OPERATOR OR OWNER	United Fuel Gas Company
ADDRESS	P.O. Box 1273, Charleston 25, W. Va.
COAL OPERATOR OR OWNER	NAME OF WELL OPERATOR
ADDRESS	COMPLETE ADDRESS
LEASE OR PROPERTY OWNER	Well No. 9106
ADDRESS	United Fuel Gas Co. Min. Tr. #1 Farm
	January 4, 19 62
	WELL AND LOCATION
	Lincoln District
	Wayne County
	Dana Lawson
	STATE INSPECTOR SUPERVISING PLUGGING

AFFIDAVIT

STATE OF WEST VIRGINIA,

County of Wayne

SS:

CLARENCE PINKERTON

and EMMETT LOVEJOY

being first duly sworn according to law depose and say that they are experienced in the work of plugging and filling oil and gas wells and were employed by E. J. ELKINS, well operator, and participated in the work of plugging and filling the above well, that said work was commenced on the 19th day of December, 19 61, and that the well was plugged and filled in the following manner:

SAND OR ZONE RECORD	FILLING MATERIAL	PLUGS USED	CASING	
			CSG PULLED	CSG LEFT IN
FORMATION	Combination string of 981' of	SIZE & KIND		
	1 1/2" Casing and 504' of 2-3/8" tubing run & cemented in	10-3/4"	-	23'
	Cement 1514' - 1485'	4-1/2"	355'	626'
	Aquagel 1485' - 1031'	2-3/8"	-	503'
	Cement 1031' - 981'			
	Set Rubber Cement Plug @ 981'			
	Cal Seal 981' - 971'			
	Mud & Clay 971' - 890'			
	Aquagel 890' - 715'			
	Cement 715' - 695'			
	Cut & Pulled 1 1/2" Casing 395'			
	Aquagel 695' - 395'			
	Cement 395' - 375'			
	Aquagel 375' - 5'			
	Cement 5' - Surface			
COAL SEAMS			DESCRIPTION OF MONUMENT	
(NAME)			Erected monument 30" above the surface	
(NAME)			with inscription "United Fuel Gas Co.	
(NAME)			Well No. 9106 - Abandoned 12/29/61:	
(NAME)				

and that the work of plugging and filling said well was completed on the 29th day of December, 19 61.

And further deponents saith not.

Sworn to and subscribed before me this 5 day of September, 19 62

My commission expires:

Sept 6, 1966

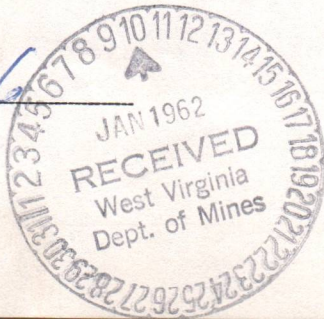

*Clarence Pinkerton*  
*Emmett Lovejoy*  
10/27/2023  
Notary Public.  
Permit No. WAY-1371-P



AFFIDAVIT OF PLUGGING AND FILLING WELL

THE AFFIDAVIT SHOULD BE FILED IN THE OFFICE OF THE REGISTRAR OF DEEDS AND RECORDS IN THE COUNTY WHERE THE WELL IS LOCATED. THIS AFFIDAVIT IS VALID FOR A PERIOD OF 30 DAYS FROM THE DATE OF FILING. IF THE WELL IS NOT PLUGGED AND FILLED WITHIN THIS PERIOD, THE REGISTRAR OF DEEDS AND RECORDS SHALL REVOKE THIS AFFIDAVIT.

United Fuel Gas Company

100 Box 1272, Charleston 25, W. Va.

January 1, 1931

Lincoln

Wayne

Well No. 2105

United Fuel Gas Co. Inc., P. O. Box 1272

Dana Lawson

AFFIDAVIT

STATE OF WEST VIRGINIA

County of Wayne

CHARLES TIMMONS

EMMETT LOVELLY

I, CHARLES TIMMONS, being first duly sworn according to law in and to the State of West Virginia, depose and say that I am a resident of the County of Wayne, State of West Virginia, and that I am the owner of the well herein described. I have caused the well herein described to be plugged and filled with cement and sand, and the same has been done in accordance with the provisions of the laws of the State of West Virginia relating to the plugging and filling of wells. The well herein described is located in the County of Wayne, State of West Virginia, and is known as Well No. 2105. The well was plugged and filled on the 1st day of December, 1931.

DATE	DESCRIPTION	AMOUNT	REMARKS
12-31-30	1 1/2" casing and 20 ft of 2-3/8" casing run & cemented in	250.00	
12-31-30	Cement	150.00	
12-31-30	Agar	100.00	
12-31-30	Cement	200.00	
12-31-30	Set Rubber Cement Plug	20.00	
12-31-30	Gal Seal	20.00	
12-31-30	Lead & Clay	20.00	
12-31-30	Agar	20.00	
12-31-30	Cement	20.00	
12-31-30	Gal & Filled 1/2" casing	30.00	
12-31-30	Agar	20.00	
12-31-30	Cement	20.00	
12-31-30	Agar	20.00	
12-31-30	Cement	20.00	
12-31-30	Agar	20.00	
12-31-30	Cement	20.00	

Witness my hand and the seal of the State of West Virginia this 1st day of December, 1931.

29th

December 1931

10/27/2023

*[Handwritten signatures and notes, including "Dana Lawson" and "Charles Timmons"]*







STATE OF WEST VIRGINIA  
DEPARTMENT OF MINES  
OIL AND GAS DIVISION

INSPECTOR'S WELL REPORT

Permit No. \_\_\_\_\_

Oil or Gas Well \_\_\_\_\_  
(KIND)

	CASING AND TUBING	USED IN DRILLING	LEFT IN WELL	PACKERS
Company _____				
Address _____	Size			
Farm _____	16			Kind of Packer _____
Well No. _____	13			
District _____ County _____	10			Size of _____
Drilling commenced _____	8 1/4			
Drilling completed _____ Total depth _____	6 5/8			Depth set _____
Date shot _____ Depth of shot _____	5 3/16			
Initial open flow _____ /10ths Water in _____ Inch	3			Perf. top _____
Open flow after tubing _____ /10ths Merc. in _____ Inch	2			Perf. bottom _____
Volume _____ Cu. Ft.	Liners Used			Perf. top _____
Rock pressure _____ lbs. _____ hrs.				Perf. bottom _____
Oil _____ bbls., 1st 24 hrs.	CASING CEMENTED _____ SIZE _____ No. FT. _____ Date _____			
Fresh water _____ feet _____ feet	COAL WAS ENCOUNTERED AT _____ FEET _____ INCHES			
Salt water _____ feet _____ feet	_____ FEET _____ INCHES _____ FEET _____ INCHES			
	_____ FEET _____ INCHES _____ FEET _____ INCHES			

Drillers' Names \_\_\_\_\_

Remarks:

DATE

DISTRICT WELL INSPECTOR

10/27/2023







STATE OF WEST VIRGINIA  
DEPARTMENT OF MINES  
OIL AND GAS DIVISION

INSPECTOR'S WELL REPORT

Permit No. \_\_\_\_\_

Oil or Gas Well \_\_\_\_\_  
(KIND)

Company _____ Address _____ Farm _____ Well No. _____ District _____ County _____ Drilling commenced _____ Drilling completed _____ Total depth _____ Date shot _____ Depth of shot _____ Initial open flow _____ /10ths Water in _____ Inch Open flow after tubing _____ /10ths Merc. in _____ Inch Volume _____ Cu. Ft. Rock pressure _____ lbs. _____ hrs. Oil _____ bbls., 1st 24 hrs. Fresh water _____ feet _____ feet Salt water _____ feet _____ feet	CASING AND TUBING	USED IN DRILLING	LEFT IN WELL	PACKERS
	Size 16 _____ 13 _____ 10 _____ 8 1/4 _____ 6 5/8 _____ 5 3/16 _____ 3 _____ 2 _____ Liners Used _____			
CASING CEMENTED _____ SIZE _____ No. FT. _____ Date _____				
COAL WAS ENCOUNTERED AT _____ FEET _____ INCHES _____ FEET _____ INCHES _____ FEET _____ INCHES _____ FEET _____ INCHES _____ FEET _____ INCHES				

Drillers' Names \_\_\_\_\_

Remarks:

DATE

DISTRICT WELL INSPECTOR

10/27/2023







STATE OF WEST VIRGINIA  
DEPARTMENT OF MINES  
OIL AND GAS DIVISION

INSPECTOR'S WELL REPORT

Permit No. \_\_\_\_\_

Oil or Gas Well \_\_\_\_\_  
(KIND)

	CASING AND TUBING	USED IN DRILLING	LEFT IN WELL	PACKERS
Company _____				
Address _____	Size			
Farm _____	16			Kind of Packer _____
Well No. _____	13			
District _____ County _____	10			Size of _____
Drilling commenced _____	8 1/4			
Drilling completed _____ Total depth _____	6 5/8			Depth set _____
Date shot _____ Depth of shot _____	5 3/16			
Initial open flow _____ /10ths Water in _____ Inch	3			Perf. top _____
Open flow after tubing _____ /10ths Merc. in _____ Inch	2			Perf. bottom _____
Volume _____ Cu. Ft.	Liners Used			Perf. top _____
Rock pressure _____ lbs. _____ hrs.				Perf. bottom _____
Oil _____ bbls., 1st 24 hrs.	CASING CEMENTED _____ SIZE _____ No. FT. _____ Date _____			
Fresh water _____ feet _____ feet	COAL WAS ENCOUNTERED AT _____ FEET _____ INCHES			
Salt water _____ feet _____ feet	_____ FEET _____ INCHES _____ FEET _____ INCHES			
	_____ FEET _____ INCHES _____ FEET _____ INCHES			

Drillers' Names \_\_\_\_\_

Remarks:

DATE

DISTRICT WELL INSPECTOR

10/27/2023



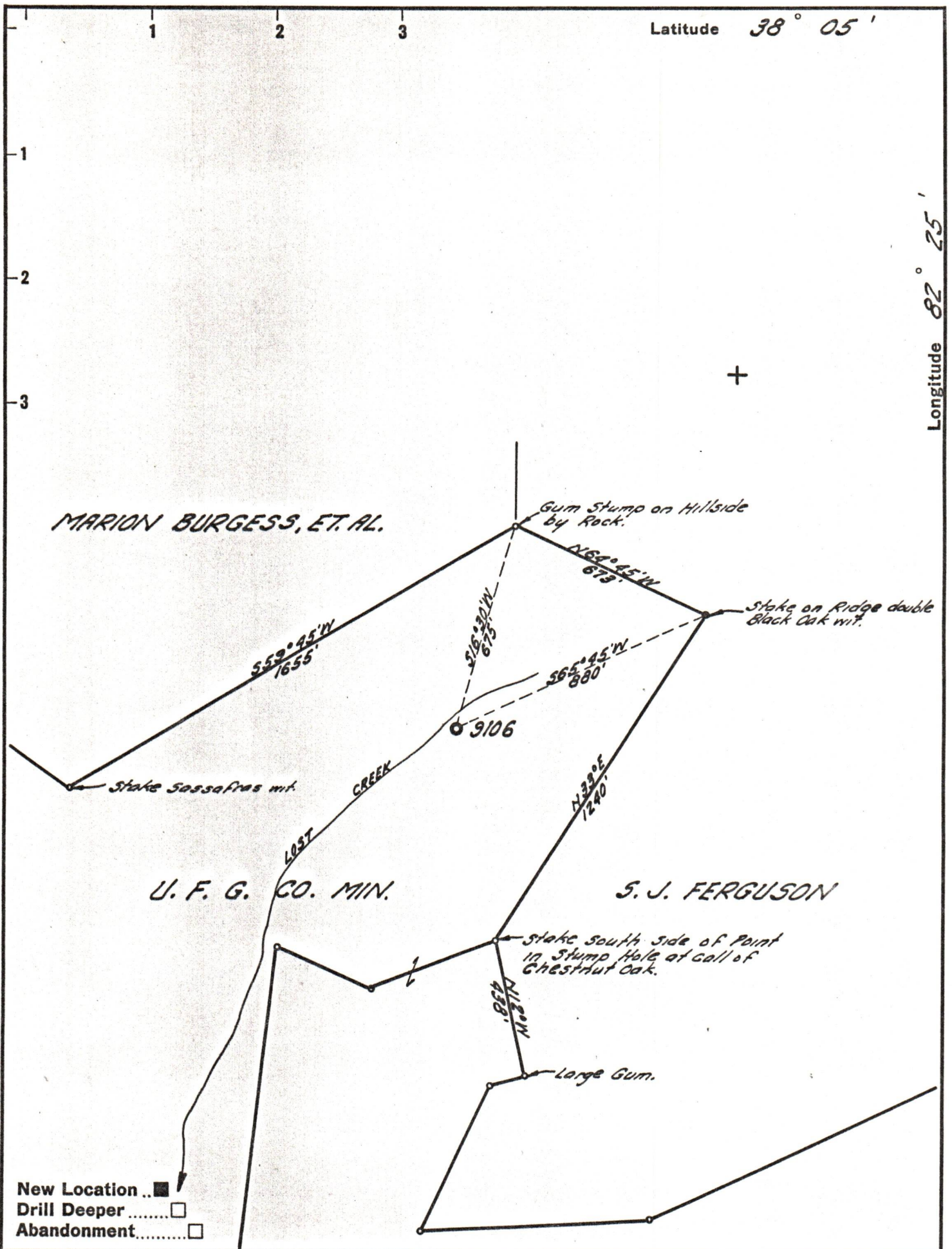

Latitude  $38^{\circ} 05'$

Longitude  $82^{\circ} 25'$

Company UNITED FUEL GAS CO.  
 Address CHARLESTON, W.VA.  
 Farm UNITED FUEL GAS CO. MIN  
 Tract 1 Acres 13677.82 Lease No. NO REF.  
 Well (Farm) No. \_\_\_\_\_ Serial No. 9106  
 Elevation (Spirit Level) 858.24'  
 Quadrangle WAYNE  
 County WAYNE District LINCOLN  
 Engineer Paul E. Joachims  
 Engineer's Registration No. 669  
 File No. 16-37 Drawing No. \_\_\_\_\_  
 Date 8-15-61 Scale 1" = 400'

STATE OF WEST VIRGINIA  
 DEPARTMENT OF MINES  
 OIL AND GAS DIVISION  
 CHARLESTON

**WELL LOCATION MAP**  
 FILE NO. WAY-1371 10/27/2023

+ Denotes location of well on United States Topographic Maps, scale 1 to 62,500, latitude and longitude lines being represented by border lines as shown.

- Denotes one inch spaces on border line of original tracing.