



STATE OF WEST VIRGINIA
DEPARTMENT OF MINES
OIL AND GAS DIVISION

NOTICE OF PROPOSED LOCATION OF OIL AND GAS WELL

To THE DEPARTMENT OF MINES,
Charleston, W. Va.

COAL OPERATOR OR COAL OWNER

United Fuel Gas Company
NAME OF WELL OPERATOR

ADDRESS

Charleston, W. Va.
COMPLETE ADDRESS

COAL OPERATOR OR COAL OWNER

May 24, 1962
PROPOSED LOCATION

ADDRESS

Lincoln District

United Fuel Gas Company
OWNER OF MINERAL RIGHTS

Wayne County

Charleston, W. Va.
ADDRESS

Well No. 9199 ^{38° 05'} ^{82° 25'} ^{6.789.23'}

United Fuel Gas Co. Min. Tr. #1 Farm
13,672.82 acres

GENTLEMEN:

The undersigned well operator is entitled to drill upon the above named farm or tract of land for oil and gas, having fee title thereto, (or as the case may be) under grant or lease dated December 26, 1946, made by Huntington Development & Gas Co., to United Fuel Gas Co., and recorded on the 27th day of December 1946, in the office of the County Clerk for said County in Book 234, page 318.

The enclosed plat was prepared by a competent engineer and shows the proposed location of a well to be drilled for oil and gas by the undersigned well operator on the farm and in the Magisterial District and County above named, determined by survey and courses and distances from two permanent points, or land marks.

The undersigned well operator is informed and believes there are no coal operators operating beds of coal beneath said farm or tract of land on which said well is located, or within 500 feet of the boundaries of the same, who have mapped their workings and filed their maps as required by law, excepting the coal operators or coal owners (if any) above named as addressees.

The above named coal operators or coal owners (if any) are notified that any objections they may desire to make to such proposed location, or which they are required to make by Section 3 of said Code, if the drilling of a well at said proposed location will cause a dangerous condition in or about their respective coal mines, must be received by, or filed with the Department of Mines within ten* days from the receipt of a copy of this notice and accompanying plat by said Department. Said coal operators are further notified that forms for use in making such objections will be furnished to them by the Department of Mines promptly on request and that all such objections must set forth as definitely as is reasonably possible the ground or grounds on which such objections are based and indicate the direction and distance the proposed location should be moved to overcome same.

(The next paragraph is to be completed only in Department's copy.)

Copies of this notice and the enclosed plat were mailed by registered mail, or delivered to the above named coal operators or coal owners at their above shown respective address _____ day before, or on the same day with the mailing or delivery of this copy to the Department of Mines at Charleston, West Virginia.

Very truly yours,

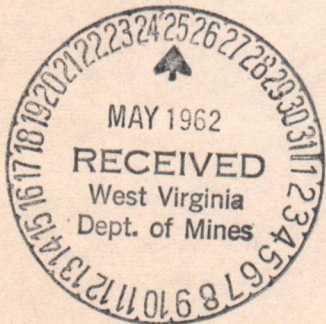

Address of Well Operator }

UNITED FUEL GAS COMPANY
WELL OPERATOR
P. O. Box 1273
STREET
Charleston 25,
CITY OR TOWN
West Virginia
STATE

10/27/2023

*Section 3 If no such objections be filed or be found by the department of mines, within said period of ten days from the receipt of said notice and plat by the department of mines, to said proposed location, the department shall forthwith issue to the well operator a drilling permit reciting the filing of such plat, that no objections have been made by the coal operators to the location, or found thereto by the department, and that the same is approved and the well operator authorized to proceed to drill at said location.

1431

B-4

June 4, 1962
"Centennial '63"

United Fuel Gas Company
P. O. Box 1273
Charleston 25, West Virginia

Att: Mr. Bernard Moon

Gentlemen:

Enclosed are permits for drilling the following wells:

<u>PERMIT NO.</u>	<u>WELL NO.</u>	<u>FARM</u>	<u>DISTRICT</u>	<u>COUNTY</u>
KAN-1870	9195	United Fuel Gas Co. Fee	Malden	Kanawha
KAN-1871	9205	United Fuel Gas Co. Fee	Malden	Kanawha
WAY-1430	9192	U. F. Gas Co. Min. Tr. #1	Lincoln	Wayne
WAY-1431	9199	U. F. Gas Co. Min. Tr. #1	Lincoln	Wayne

Very truly yours,

Assistant Director
OIL AND GAS DIVISION

MG/jb
enclosure

cc: Mr. Dana Lawson, Inspector
Mr. Kenneth E. Butcher, Inspector

Mr. R. C. Tucker, Assistant State
Geologist

10/27/2023



STATE OF WEST VIRGINIA
DEPARTMENT OF MINES
OIL AND GAS DIVISION

Quadrangle Wayne

Permit No. WAY-1431

WELL RECORD

Oil or Gas Well Gas
(KIND)

Company United Fuel Gas Company
Address P.O. Box 1273 Charleston 25, W. Va.
Farm United Fuel Gas Company Min. Tr. #1 13,672.82
Location (waters) Left Fork of Lost Creek
Well No. 9199 Elev. 789.23'
District Lincoln County Wayne
The surface of tract is owned in fee by United Fuel Gas Co.
Address _____

Mineral rights are owned by _____
Address _____

Drilling commenced 8-11-62

Drilling completed 9-2-62

Date Shot _____ From _____ To _____

With _____

Open Flow _____ /10ths Water in _____ Inch

54 /10ths Merc. in 2 Inch

Volume 1,143,000 - Injun Cu. Ft.

Rock Pressure 480 lbs. 48 hrs.

Oil _____ bbls., 1st 24 hrs.

WELL ACIDIZED _____

WELL FRACTURED _____

RESULT AFTER TREATMENT _____

ROCK PRESSURE AFTER TREATMENT _____

Fresh Water 120 Feet 723 Salt Water _____ Feet

Casing and Tubing	Used in Drilling	Left in Well	Packers
Size			Kind of Packer
16			
13			
10 3/4		18'	Size of
8 5/8		384	
7"	1274'	Pulled	Depth set
5 3/16			
3 1/2	Cemented	1416'	Perf. top
2			Perf. bottom
Liners Used			Perf. top
			Perf. bottom

CASING CEMENTED _____ SIZE _____ No. Ft. _____ Date _____

COAL WAS ENCOUNTERED AT 68 FEET 24 INCHES

_____ FEET _____ INCHES _____ FEET _____ INCHES

_____ FEET _____ INCHES _____ FEET _____ INCHES

Formation	Color	Hard or Soft	Top	Bottom	Oil, Gas or Water	Depth	Remarks
Surface			0	19	Water 120'	1	bailer per hour
Sand			19	68			
Coal			68	70	Hole full water 723'		
Slate			70	110			
Sand			110	187	Show oil 1270'		
Slate			187	245			
Sand			245	255	Gas 1363-1380'	22/10 W 1" 49 M	
Slate			255	420			
Sand			420	462	Perforated at 1367-1368'		with 6 shots.
Slate			462	490			
Sand			490	525	Fractured Injun 9-7-62		with 570 bbls. sand laden fluid and 50,000# 20-40 sand.
Slate			525	628			
Sand			628	723	Final open flow after fracture		54/10 Merc. 2" 1,143 M
Settling Sand			723	755			
Sand			755	767			
Slate			767	795			
Sand			795	945			
Slate			945	967			
Sand			967	979	Shut in 9-10-62 in 3 1/2" tubing.		
Slate			979	1010			
Lime Shells			1010	1020			
Sand			1020	1145	LOGS RUN:		
Little Lime			1145	1155	Gamma Ray		
Big Lime			1155	1237	Density		
Sandy Lime			1237	1245	Induction		
Big Lime			1245	1310			
Injun Sand			1310	1385			
Slate & Shells			1385	1428			
Total Depth			1428'				

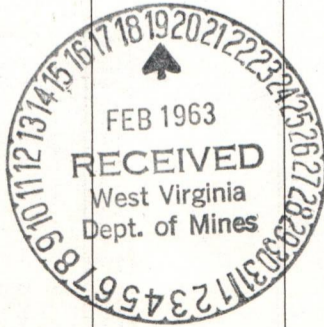

10/27/2023

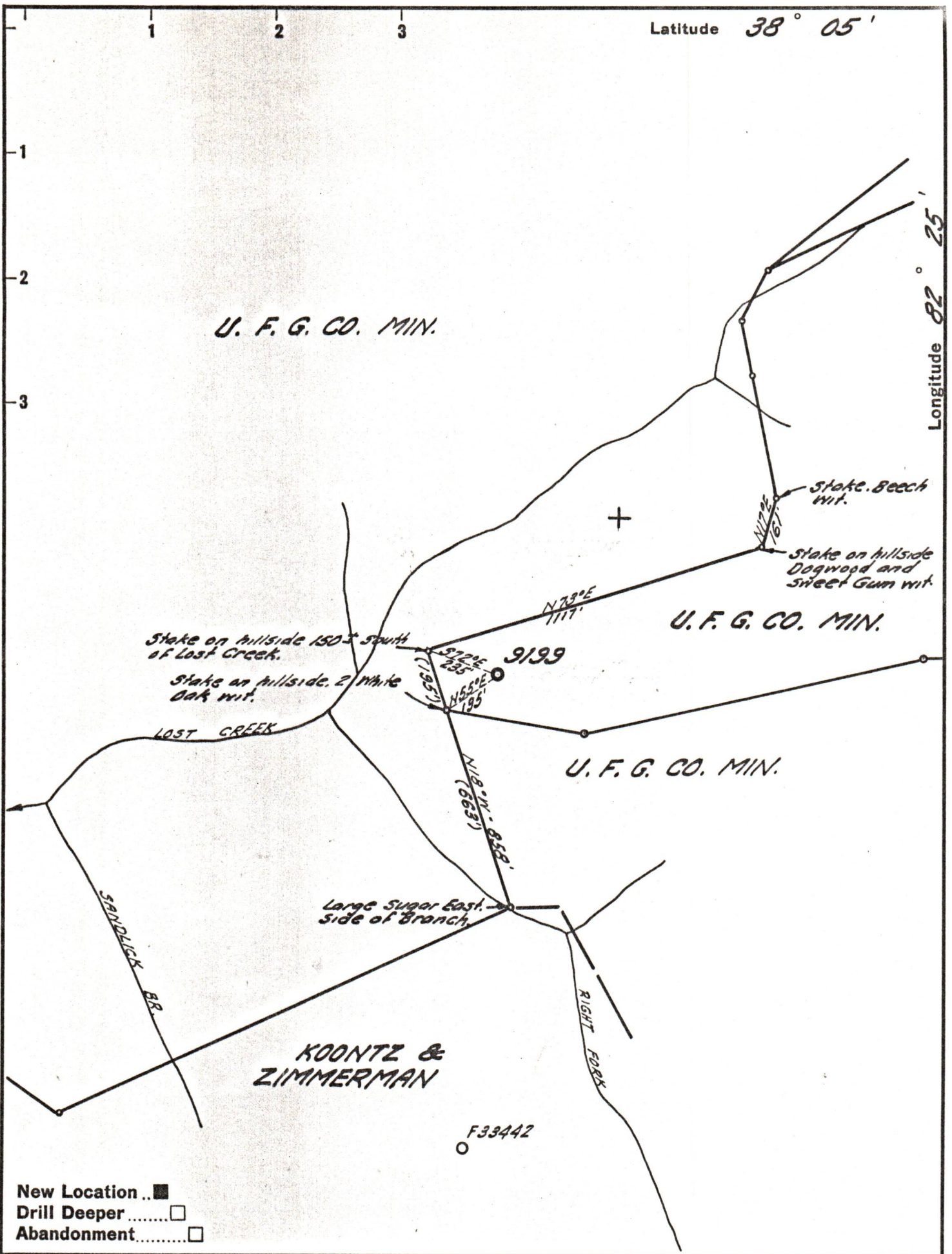

New Location ..
 Drill Deeper
 Abandonment.....

Company UNITED FUEL GAS CO.
 Address CHARLESTON, W. VA.
 Farm UNITED FUEL GAS CO. MIN.
 Tract 1 Acres 13,672.82 Lease No. NO REF
 Well (Farm) No. _____ Serial No. 9199
 Elevation (Spirit Level) 789.23
 Quadrangle WAYNE
 County WAYNE District LINCOLN
 Engineer Seibert R. Jewell
 Engineer's Registration No. 2529
 File No. 16-37 Drawing No. _____
 Date 5-17-62 Scale 1" = 400'

STATE OF WEST VIRGINIA
 DEPARTMENT OF MINES
 OIL AND GAS DIVISION
 CHARLESTON

WELL LOCATION MAP
 FILE NO. WAY-1731 10/27/2023

+ Denotes location of well on United States Topographic Maps, scale 1 to 62,500, latitude and longitude lines being represented by border lines as shown.
 - Denotes one inch spaces on border line of original tracing.