

A-10

November 13, 1962
"Centennial '63"

United Fuel Gas Company
P. O. Box 1273
Charleston 25, West Virginia

ATT: Mr. Bernard Moon

Dear Mr. Moon:

Enclosed is a copy of Permit to partially plug your Well No. 2380 on the Jesse Spry Farm, Grant District, Wayne County.

The Spry well is not on our records for a drilling permit since it was drilled in 1923. We will now need a map of the well location; and as it will be produced from a depth 1450 feet, we will assign Permit Number WAY-1449 in our records of wells drilled.

Yours very truly,

Assistant Director
OIL AND GAS DIVISION

MG/sm

Enclosure

cc: Mr. Kenneth Butcher, Inspector

10/27/2023

A-11

March 25, 1963
"Centennial Year"

*Partial Plugging
now active gas well*

Mr. Bernard Moon
United Fuel Gas Company
P. O. Box 1273
Charleston, West Virginia

Dear Mr. Moon:

On November 13, 1962, we issued Permit WAY-1449 for the partial plugging of Well No. 2380 on the Jesse Spry Farm, Grant District, Wayne County to be produced from a total depth of 1450 feet.

Will you please give us the casing record for the well after it was partially plugged and the initial open flow? We will transfer all records to our file of active wells.

Yours very truly,

Assistant Director
OIL AND GAS DIVISION

MG/sm

10/27/2023



STATE OF WEST VIRGINIA
DEPARTMENT OF MINES
OIL AND GAS DIVISION

Quadrangle Wayne

Permit No. WAY-1449

WELL RECORD

Oil or Gas Well Gas
(KIND)

Company United Fuel Gas Company
Address P.O. Box 1273; Charleston 25, W. Va.
Farm Jesse Spry Acres 50
Location (waters) Left Fork of 12-Pole
Well No. 2380 Elev. 678'
District Grant County Wayne
The surface of tract is owned in fee by _____
Address _____
Mineral rights are owned by George F. A. Fletcher
33 Sagamore Road Address Bronxville, New York
Drilling commenced January 4, 1923
Drilling completed February 22, 1923
Date Shot _____ From _____ To _____
With _____
Open Flow 18 /10ths Water in 2 Inch
_____ /10ths Merc. in _____ Inch
Volume _____ Cu. Ft.
Rock Pressure 395 lbs. _____ hrs.
Oil _____ bbls., 1st 24 hrs.
WELL ACIDIZED _____
WELL FRACTURED _____

Casing and Tubing	Used in Drilling	Left in Well	Packers
Size			Kind of Packer
16			
13			
10 <u>3/4</u>		<u>40'</u>	Size of
8 <u>1/4</u>		<u>60'</u>	
6 <u>5/8</u>		<u>1148</u>	Depth set
5 <u>3/16</u>			
3			Perf. top
2 <u>3/8</u>		<u>1951</u>	Perf. bottom
Liners Used			Perf. top
			Perf. bottom

CASING CEMENTED _____ SIZE _____ No. Ft. _____ Date _____
COAL WAS ENCOUNTERED AT 325 FEET 60 INCHES
_____ FEET _____ INCHES _____ FEET _____ INCHES
_____ FEET _____ INCHES _____ FEET _____ INCHES

RESULT AFTER TREATMENT _____
ROCK PRESSURE AFTER TREATMENT _____
Fresh Water _____ Feet _____ Salt Water _____ Feet _____

Formation	Color	Hard or Soft	Top	Bottom	Oil, Gas or Water	Depth	Remarks
Quick Sand			0	52			
Slate			52	140			
Sand			140	170			
Black Slate			170	260			
Sand			260	280			
Slate			280	325			
Coal			325	330			
Black Slate			330	335			
Sand			335	340			
Black Slate			340	490			
Sand			490	595			
Slate			595	640			
Salt Sand			640	775			
Slate			775	780			
Hard Sand			780	830			
Slate			830	840			
Broken Sand			840	920			
Hard Sand			920	960			
Black Slate			960	965			
Hard Sand			965	1055			
Slate & Shell			1055	1070			
Maxon Sand			1070	1122			
Little Lime			1122	1127			
Pencil Cave			1127	1132			
Big Lime			1132	1333			
Red Rock			1333	1342			
Injun Sand			1342	1392			
Slate & Shell			1392				
Berea			1914	1930			
Total Depth			1931'				

Well plugged back to 1450' to be produced.
See record attached

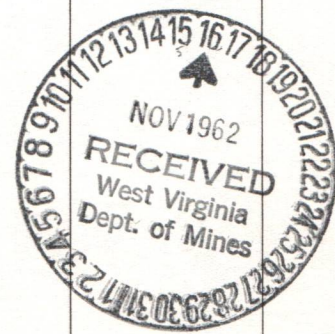

Show of oil in Big Lime
Small show of gas at 1250' to 1290'
Gas pay 1367' to 1382'

10/27/2023



STATE OF WEST VIRGINIA
DEPARTMENT OF MINES
OIL AND GAS DIVISION

Quadrangle Wayne

Permit No. WAY-1449

WELL RECORD

Oil or Gas Well Gas
(KIND)

Company United Fuel Gas Company
Address P.O. Box 1273; Charleston 25, W. Va.
Farm Jesse Spry Acres 50
Location (waters) Left Fork of 12-Pole
Well No. 2380 Elev. 678'
District Grant County Wayne
The surface of tract is owned in fee by _____
Address _____
Mineral rights are owned by George F. A. Fletcher
33 Sagamore Road Address Bronxville, New York
Drilling commenced January 4, 1923
Drilling completed February 22, 1923
Date Shot _____ From _____ To _____
With _____
Open Flow 18 /10ths Water in 2 Inch
_____ /10ths Merc. in _____ Inch
Volume _____ Cu. Ft.
Rock Pressure 395 lbs. _____ hrs.
Oil _____ bbls., 1st 24 hrs.
WELL ACIDIZED _____
WELL FRACTURED _____

Casing and Tubing	Used in Drilling	Left in Well	Packers
Size			Kind of Packer
16			
13			
10 <u>3/4</u>		<u>40'</u>	Size of
8 1/4		<u>60'</u>	
6 5/8		<u>1148</u>	Depth set
5 3/16			
3			Perf. top
2 <u>3/8</u>		<u>1951</u>	Perf. bottom
Liners Used			Perf. top
			Perf. bottom

CASING CEMENTED _____ SIZE _____ No. Ft. _____ Date _____

COAL WAS ENCOUNTERED AT 325 FEET 60 INCHES
_____ FEET _____ INCHES _____ FEET _____ INCHES
_____ FEET _____ INCHES _____ FEET _____ INCHES

RESULT AFTER TREATMENT _____

ROCK PRESSURE AFTER TREATMENT _____

Fresh Water _____ Feet _____ Salt Water _____ Feet _____

Formation	Color	Hard or Soft	Top	Bottom	Oil, Gas or Water	Depth	Remarks
Quick Sand			0	52	Well reconditioned 12-3-1962 Present Total Depth 1401' Pay Zones 1320'-1328'-1330'-1338' Result after Treatment 995,000 cu.ft.		
Slate			52	140			
Sand			140	170			
Black Slate			170	260			
Sand			260	280			
Slate			280	325			
Coal			325	330			
Black Slate			330	335			
Sand			335	340			
Black Slate			340	490			
Sand			490	595			
Slate			595	640			
Salt Sand			640	775			
Slate			775	780			
Hard Sand			780	830			
Slate			830	840			
Broken Sand			840	920			
Hard Sand			920	960			
Black Slate			960	965			
Hard Sand			965	1055			
Slate & Shell			1055	1070			
Maxon Sand			1070	1122			
Little Lime			1122	1127			
Pencil Cave			1127	1132			
Big Lime			1132	1333			
Red Rock			1333	1342			
Injun Sand			1342	1392			
Slate & Shell			1392				
Berea			1914	1930			
Total Depth			1931'				

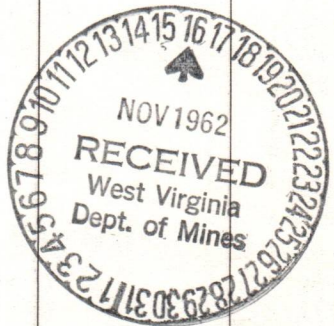

Show of oil in Big Line
Small show of gas at 1280' to 1290'
Gas pay 1367' to 1382'

Permit- WAY-1449

UNITED FUEL GAS COMPANY

MRC-65-62

REPORT OF STIMULATION - SUMMARY

WELL NO. 2380 MAP SQUARES 24-37 ELEV. N/A
 DISTRICT Grant COUNTY Wayne STATE W. Va.
 FARM Jessee Spry LOCATION 12 PoleCreek
 FORMATION Injun Sand TOP 1364 BOTTOM 1394
 PAY ZONES 1320-1328; 1330-1338' PREVIOUS TREATMENTS None
 ORIGINAL T.D. Approx. 1931' DATE DRILLED IN 1-4-23
 LOGGED BY Schlumberger DATE LOGGED 12-3-62
 LOGS USED Gamma Gamma, Gamma Ray, and Caliper
 O. F. ORIGINAL - MCF - HOURS - R. P. - PSI - HOURS
 PRODUCTION STRING 3-1/2" Grade J-55, 7.7#/ft. tubing to 1428'
 TYPE OF COMPLETION Set through, cement pipe in, and fracture.

PRESENT T.D. 1401' PERFORATIONS 1370-1378'; 1380-1388'
 SERVICE CO. Dowell DATE 1 shot per ft. 12-6-62
 O. F. BEFORE TREATMENT - R. P. - PSI - HOURS
 O. F. AFTER TREATMENT 995 Mcf R. P. 310 PSI 18 HOURS
 FLUID USED (TYPE) FILL Acid 300 gals.
Water 8 bbls.
 TREATING Sand and Water AMOUNT 383 bbls.
 FLUSH Water AMOUNT 13 bbls.
 SAND (MESH) 20-40 AMOUNT 30,000 RECOVERED -
 BREAKDOWN 2600 PSI TREATING (AVE) 1700 PSI
 SHUT-IN 1100 PSI INJECTION RATE 13.3 bbl/min.
 SAND CONCENTRATION - MINIMUM 1/2 MAXIMUM 2-1/2 AVERAGE 2
 TOTAL FLUID USED 404 bbls. FLUID RECOVERED -



STATE OF WEST VIRGINIA
DEPARTMENT OF MINES
OIL AND GAS DIVISION

INSPECTOR'S WELL REPORT

B-4

Permit No. Way-1449

Oil or Gas Well _____
(KIND)

Company	CASING AND TUBING	USED IN DRILLING	LEFT IN WELL	PACKERS
<u>U.F.M. CO.</u>	Size			
<u>Charleston, W.Va.</u>	16			Kind of Packer _____
<u>Jesse Spry</u>	13			
<u>2380</u>	10			Size of _____
District <u>Grant</u> County <u>Wayne</u>	8 1/4			
Drilling commenced _____	6 5/8			Depth set _____
Drilling completed <u>old well</u> Total depth _____	5 3/16			
Date shot <u>working over</u> Depth of shot _____	3			Perf. top _____
	2			Perf. bottom _____
Initial open flow _____ /10ths Water in _____ Inch	Liners Used _____			Perf. top _____
Open flow after tubing _____ /10ths Merc. in _____ Inch				Perf. bottom _____
Volume _____ Cu. Ft.	CASING CEMENTED _____ SIZE _____			Perf. top _____
Rock pressure _____ lbs. _____ hrs.				Perf. bottom _____
Oil _____ bbls., 1st 24 hrs.	COAL WAS ENCOUNTERED AT _____ FEET _____ INCHES			
Fresh water _____ feet _____ feet	_____ FEET _____ INCHES _____ FEET _____ INCHES			
Salt water _____ feet _____ feet	_____ FEET _____ INCHES _____ FEET _____ INCHES			

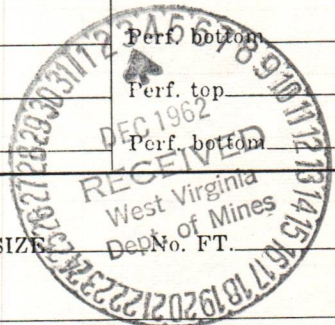

Drillers' Names Wiley Price
U.F.M. CO. Cable Tools

Remarks: Fishing for 2" tubing at 1229'

11-26-62
DATE

H.E. Butcher
DISTRICT WELL INSPECTOR

10/27/2023

STATE OF WEST VIRGINIA
 DEPARTMENT OF MINES
 OIL AND GAS DIVISION

INSPECTOR'S PLUGGING REPORT

Permit No. _____ Well No. _____

COMPANY _____ ADDRESS _____

FARM _____ DISTRICT _____ COUNTY _____

Filling Material Used _____

Liner	Location	Amount	Packer	Location	
PLUGS USED AND DEPTH PLACED			BRIDGES	CASING AND TUBING	
CEMENT-THICKNESS	WOOD-SIZE	LEAD	CONSTRUCTION-LOCATION	RECOVERED	SIZE LOST

Drillers' Names _____

Remarks: _____

_____ I hereby certify I visited the above well on this date.
DATE

DISTRICT WELL INSPECTOR
10/27/2023

STATE OF WEST VIRGINIA
DEPARTMENT OF MINES
OIL AND GAS DIVISION

B-3

May-14-49

INSPECTOR'S WELL REPORT

Permit No. Work-over well

Oil or Gas Well _____
(KIND)

Company <u>U.F.S. CO.</u>	CASING AND TUBING	USED IN DRILLING	LEFT IN WELL	PACKERS
Address <u>Charleston, W.Va.</u>	Size			
Farm _____	16			Kind of Packer _____
Well No. <u>2380</u>	13			
District <u>Lincoln</u> County <u>Wayne</u>	10			Size of _____
Drilling commenced _____	8 1/4			Depth set _____
Drilling completed _____ Total depth _____	6 5/8			
Date shot _____ Depth of shot _____	5 3/16			Perf. top _____
Initial open flow _____ /10ths Water in _____ Inch	3			Perf. bottom _____
Open flow after tubing _____ /10ths Merc. in _____ Inch	2			Perf. top _____
Volume _____ Cu. Ft.	Liners Used			Perf. bottom _____
Rock pressure _____ lbs. _____ hrs.	CASING CEMENTED _____ SIZE _____ No. FT. _____ Date _____			
Oil _____ bbls., 1st 24 hrs.	COAL WAS ENCOUNTERED AT _____ FEET _____ INCHES			
Fresh water _____ feet _____ feet	_____ FEET _____ INCHES FEET _____ INCHES			
Salt water _____ feet _____ feet	_____ FEET _____ INCHES FEET _____ INCHES			

Drillers' Names Wiley Price

Remarks: U.F.S. Co.

Cleaning out after sand frac. No test on gas.

12-13-62

DATE



K. C. Butcher

DISTRICT WELL INSPECTOR

10/27/2023

STATE OF WEST VIRGINIA
DEPARTMENT OF MINES
OIL AND GAS DIVISION
INSPECTOR'S PLUGGING REPORT

Permit No. _____ Well No. _____

COMPANY _____ ADDRESS _____

FARM _____ DISTRICT _____ COUNTY _____

Filling Material Used _____

Liner	Location	Amount	Packer	Location		
				PLUGS USED AND DEPTH PLACED	BRIDGES	CASING AND TUBING
CEMENT-THICKNESS	WOOD-SIZE	LEAD	CONSTRUCTION-LOCATION	RECOVERED	SIZE	LOST

Drillers' Names _____

Remarks: _____

_____ I hereby certify I visited the above well on this date.
DATE

DISTRICT WELL INSPECTOR
10/27/2023

B-9

PROPOSED MANNER OF PLUGGING AND FILLING WELL

(REQUIRED BY RULES AND REGULATIONS)

WEST VIRGINIA DEPARTMENT OF MINES

OIL AND GAS DIVISION

WORK ORDER

Well to be ^{partially} plugged and filled as follows:

Original Total Depth	1931'	
Set Bridge at	1896'	- 20' above Berea
Cement	1896' - 1876'	
Aquegel	1876' - 1450'	
(3 1/2" Tubing to be run to 1896' when bridge is set)		
Pull 3 1/2" Tubing to	1450'	
Circulate hole with aquegel and cement 3 1/2" Tubing to fracture the Injun Sand Formation.		
New Total Depth	1450'	

To the Department of Mines
Coal Owner or Operator,
Lease or Property Owner.

Gentlemen:

This "work order" is submitted for your approval and concurrence and unless notified of your disapproval or non-concurrence, the undersigned will proceed with the plugging and filling of said well in the above described manner on the date inspector is notified after permit is issued.

Very truly yours,

UNITED FUEL GAS COMPANY

Well Operator

No objections have been filed by the coal owner or coal operator, or any available adjacent lease or property owners or interposed by the Department of Mines to the manner herein described for the plugging and filling of the well above mentioned. Therefore, the same is hereby approved.

13th day of NOVEMBER, 1962.

DEPARTMENT OF MINES
Oil and Gas Division

By: W. E. Gypile

NOTE: This "work order" shall be filed in triplicate, one copy for the files of the Department of Mines; one to be approved or corrected and returned to the well operator as his authority for plugging said well; and one for the well inspector.



STATE OF WEST VIRGINIA
DEPARTMENT OF MINES
OIL AND GAS DIVISION
PARTIALLY
NOTICE OF INTENTION TO/PLUG AND ABANDON WELL

(REQUIRED BY SECTION 9, ARTICLE 4, CHAPTER 22 OF THE CODE)

TO THE DEPARTMENT OF MINES,
Charleston, W. Va.

Coal Operator	<u>United Fuel Gas Company</u>
	Name of Well Operator
	<u>P. O. Box 1273</u>
Address	<u>Charleston 25, W. Va.</u>
	Complete Address
Coal Owner	<u>November 15, 1962</u>
	Date
Address	<u>WELL TO BE ABANDONED</u>
	Grant District
<u>Gordon F. A. Fletcher</u>	<u>Wayne</u> County
Lease or Property Owner	
<u>33 Sagamore Road</u>	Well No. <u>2380</u> <u>38° 05'</u> <u>82° 15'</u>
<u>Bronxville, New York</u>	
Address	<u>JESSE SPRY</u> Farm

Inspector to be notified KENNETH BUTCHER Telephone Number RE-61933
Barboursville, W. Va.

Gentlemen:— 24 HOURS IN ADVANCE OF PLUGGING

The undersigned well operator is about to abandon the above described well and will commence the work of plugging and abandoning said well on the date inspector is notified (which date shall not be less than five days after the day on which this notice so mailed is received, or in due course should be received by the Department of Mines).

This notice is given you in order that your respective representatives may be present at the plugging and filling of said well. You are further notified that whether you are represented or not represented the undersigned will proceed on that date, or shortly thereafter, to plug and fill said well in the manner required by Section 10, Article 4, Chapter 22 of the Code and given in detail on the reverse side of this notice, in "Work Order."

This notice is being mailed by registered mail to each of you at the above addresses on the above date.

Very truly yours,

UNITED FUEL GAS COMPANY
Well Operator

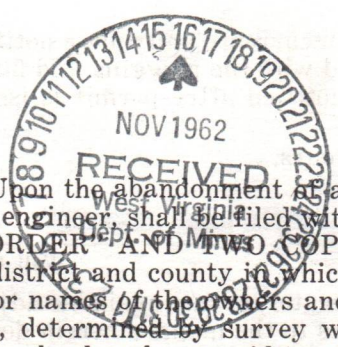

NOTE: Upon the abandonment of any well drilled prior to June 1, 1929, a plat prepared by a registered engineer shall be filed with THREE COPIES OF APPLICATION, (OG-9) AND "WORK ORDER" AND TWO COPIES OF THE WELL RECORD, (OG-10). The map must show the district and county in which the tract of land is located, the name and acreage of same, the name or names of the owners and names of adjacent tracts and the location of the well to be abandoned, determined by survey with the courses and distances of such well from two permanent points or landmarks on said tract.

10/27/2023

NOTE: In case plugging is not commenced within four months from the date of permit, same shall expire and be of no further force or effect.

NOTE: PERMIT IS NOT TRANSFERABLE.

WAY-1449
Permit Number

Partial Plugging

B-10

STATE OF WEST VIRGINIA
DEPARTMENT OF MINES
OIL AND GAS DIVISION

PARTIAL
AFFIDAVIT OF PLUGGING AND FILLING WELL

AFFIDAVIT SHOULD BE MADE IN TRIPLICATE, ONE COPY MAILED TO THE DEPARTMENT, ONE COPY TO BE RETAINED BY THE WELL OPERATOR AND THE THIRD COPY (AND EXTRA COPIES IF REQUIRED) SHOULD BE MAILED TO EACH COAL OPERATOR AT THEIR RESPECTIVE ADDRESSES.

COAL OPERATOR OR OWNER	United Fuel Gas Company
ADDRESS	NAME OF WELL OPERATOR Charleston, West Virginia
COAL OPERATOR OR OWNER	COMPLETE ADDRESS February 1, 19 63
ADDRESS	WELL AND LOCATION Grant District
LEASE OR PROPERTY OWNER	Wayne County
ADDRESS	Well No. 2380
	Jesse Spry Farm

STATE INSPECTOR SUPERVISING PLUGGING Kenneth Butcher

AFFIDAVIT

STATE OF WEST VIRGINIA, }
County of Wayne } ss:

WILEY V. PRICE and HALLIE STOWERS

being first duly sworn according to law depose and say that they are experienced in the work of plugging and filling oil and gas wells and were employed by UNITED FUEL GAS COMPANY, well operator, and participated in the work of plugging and filling the above well, that said work was commenced on the 3rd day of December, 19 62, and that the well was plugged and filled in the following manner:

SAND OR ZONE RECORD	FILLING MATERIAL	PLUGS USED	CASING	
			CSG PULLED	CSG LEFT IN
FORMATION	527' of 2-3/8" Tubing abandoned in hole. Hole filled up with cavings to 1404' Hole filled with Cal Seal from 1404' to 1394' New Total Depth 1394'	SIZE & KIND		
COAL SEAMS			DESCRIPTION OF MONUMENT	
(NAME)				
(NAME)				
(NAME)				
(NAME)				

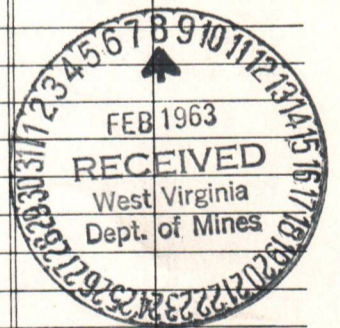

and that the work of plugging and filling said well was completed on the 3rd day of December, 19 62.

And further deponents saith not.

Sworn to and subscribed before me this 6th day of February, 19 63.

My commission expires:

April 9, 1963

Wiley V. Price
Hallie Stowers
Stanford H. Barrett

10/27/2023
Notary Public.

Permit No. WAY-1449-1

AFFIDAVIT OF PLUGGING AND FILLING WELL

AFFIDAVIT SHOULD BE MADE IN TRIPLICATE, ONE COPY TO BE FILED IN THE OFFICE OF THE DEPARTMENT OF MINES AND ONE COPY TO BE FILED IN THE OFFICE OF THE LOCAL OPERATOR AND THE LOCAL OPERATOR IS RESPONSIBLE FOR THE PROPER FILING OF THIS AFFIDAVIT.

LOCAL OPERATOR OR OWNER: United Fuel Gas Company
COUNTY: Grant
WELL LOCATION: Grant
WELL NO.: 2380
LOCAL OPERATOR'S OFFICE: [Address]
DATE OF AFFIDAVIT: [Date]

AFFIDAVIT

STATE OF WEST VIRGINIA

County of Wayne

WILLY V. PRICE

WILLY STOWERS

I, WILLY V. PRICE, being first duly sworn according to law depose that I am a resident of the County of Wayne, State of West Virginia, and was employed by UNITED FUEL GAS COMPANY in the work of plugging and filling of oil and gas wells and participated in the work of plugging and filling of well No. 2380, located in the County of Grant, State of West Virginia, and that the well was plugged and filled on the 3rd day of December, 1934, and that the well was plugged and filled in the following manner:

Low total depth 1394'
1401' to 1391'
hole filled with Cal Seal from 1401'
hole filled up with cavings to 1401'
in hole.
527' of 2-3/4" tubing abandoned



And that the work of plugging and filling said well was completed on the 3rd day of December, 1934.

10/27/2023

My commission expires [Date]
[Signature]
[Signature]

E-6

*old well reconditioned
and being produced*

November 8, 1962

Approved-November 13, 1962

Mrs. M. E. Griffith
State Department of Mines
Charleston, West Virginia

M. E. Griffith
Assistant Director-Oil and Gas Div.

Dear Mrs. Griffith:

Notify: Inspector Kenneth Butcher,
RFD No. 1-Barboursville
RE 6-1933

We propose to partially plug and abandon Well No. 2380,
on the Jesse Sprys Farm, Grant District, Wayne County, West Virginia,
Map Square 24-37, in the following manner:

Original Total Depth	1931'	
Set Bridge at	1896'	- 20' above Berea
Cement	1896' - 1876'	
Aquagel	1876' - 1450'	
(3 1/2" Tubing to be run to 1896' when bridge is set)		
Pull 3 1/2" Tubing to	1450'	
Circulate Lole with aquagel and cement 3 1/2" Tubing to fracture the Injun Sand Formation.		
New Total Depth	1450'	

Yours very truly,

R. N. Tullis
R. N. Tullis
Division Superintendent

RNT:jcr

10

Old well reworked
and being produced

November 8, 1962

Approved-November 13, 1962

M. E. Griffith

Assistant Director-Oil and Gas Div.

Mrs. M. E. Griffith
State Department of Mines
Charleston, West Virginia

Dear Mrs. Griffith:

We propose to partially plug and abandon Well No. 2380 on the lease Spivey Farm, Grant District, Wayne County, West Virginia, Map Square 24-37, in the following manner:

Original Total Depth	1931'
Set bridge at	1896'
Cement	1896' - 1876'
Agassel	1876' - 1850'
(3/4" tubing to be run to 1896' when bridge is set)	1850'
Fill 3/4" tubing to	
Circulate hole with agassel and cement 3/4" tubing	
to fracture the horizon sand formation.	
New Total Depth	1850'

- 20' above base

Yours very truly,

R. W. Willis

R. W. Willis
Division Superintendent

RWT:jar

Latitude $38^{\circ} 05'$

Longitude $82^{\circ} 15'$

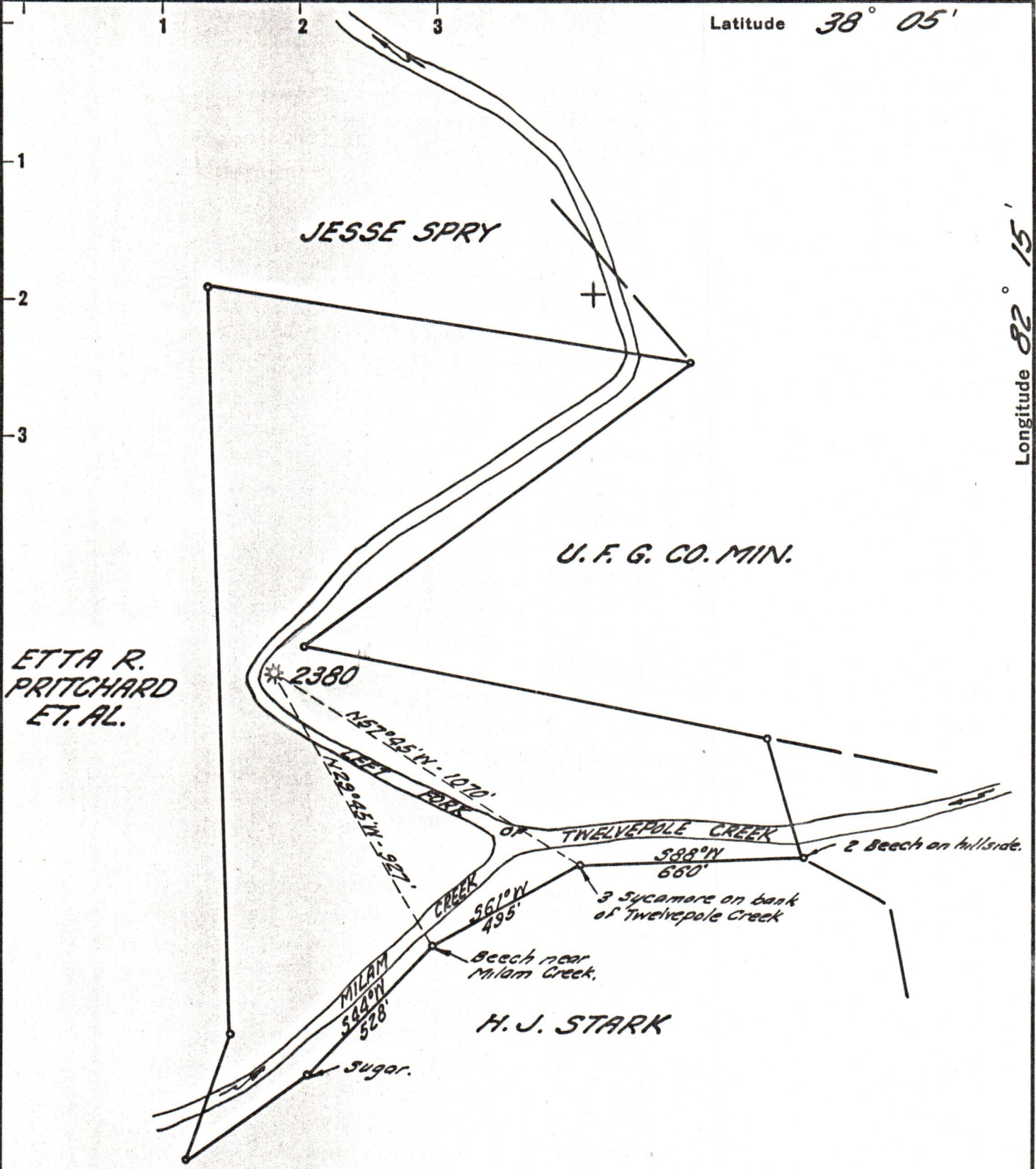

PARTICALLY PLUGGED & RECONDITIONED

- New Location...
- Drill Deeper.....
- Abandonment.....

Company UNITED FUEL GAS CO.
 Address CHARLESTON, W. VA.
 Farm JESSE SPRY
 Tract _____ Acres 50 Lease No. 24697
 Well (Farm) No. _____ Serial No. 2380
 Elevation (Spirit Level) 678.00'
 Quadrangle WAYNE
 County WAYNE District GRANT
 Engineer Seybert R. Howell
 Engineer's Registration No. 2529
 File No. 24-37 Drawing No. _____
 Date 11-14-62 Scale 1" = 400'

STATE OF WEST VIRGINIA
 DEPARTMENT OF MINES
 OIL AND GAS DIVISION
 CHARLESTON

WELL LOCATION MAP
 FILE NO. WAY - 1449 10/27/2023

- + Denotes location of well on United States Topographic Maps, scale 1 to 62,500, latitude and longitude lines being represented by border lines as shown.
- Denotes one inch spaces on border line of original tracing.