

Latitude 37° 55'

Longitude 82° 20'

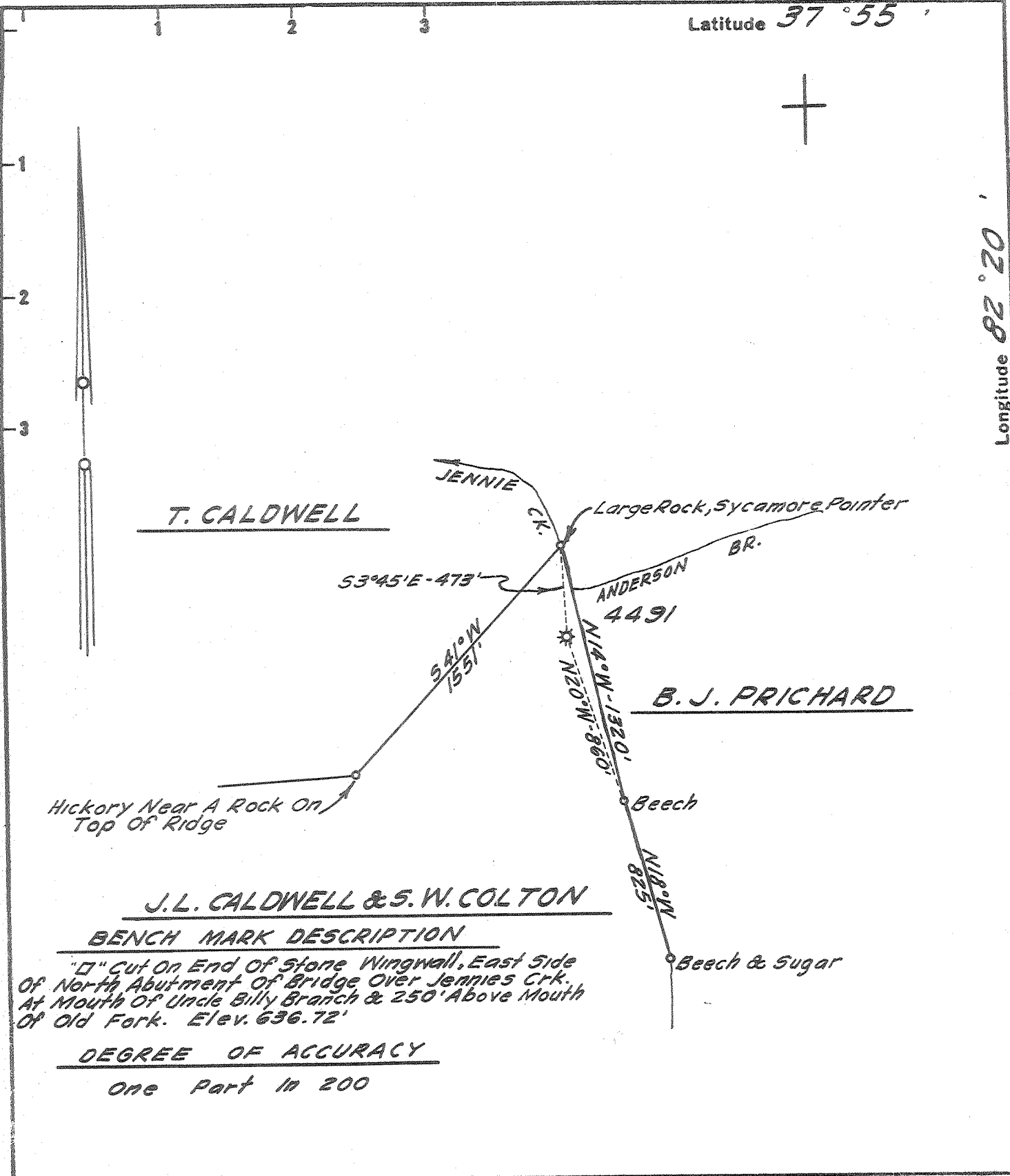

T. CALDWELL

B. J. PRICHARD

J. L. CALDWELL & S. W. COLTON

BENCH MARK DESCRIPTION

"D" Cut On End Of Stone Wingwall, East Side Of North Abutment Of Bridge Over Jennies Crk. At Mouth Of Uncle Billy Branch & 250' Above Mouth Of Old Fork. Elev. 636.72'

DEGREE OF ACCURACY

One Part In 200

- Fracture Before 6/5/27
- New Location
- Drill Deeper
- Redrill
- Abandonment

I, the undersigned, hereby certify that this map is correct to the best of my knowledge and belief and shows all the information required by Paragraph 5 of the Rules and Regulations of the Oil and Gas Section of the Mining Laws of West Virginia.

The accuracy of this survey is within the limits and as prescribed in paragraph 5 by the Oil and Gas Division of the Department of Mines Regulations. **PROVEN ELEVATION 636.72'**

Company UNITED FUEL GAS CO.  
 Address CHARLESTON, W. VA.  
 Farm J. L. CALDWELL & S. W. COLTON  
 Tract \_\_\_\_\_ Acres 13,500 Lease No. 38002  
 Well (Farm) No. 9 Serial No. 4491  
 Elevation (Spirit Level) 660.89'  
 Quadrangle NAUGATUCK - C  
 County WAYNE District LINCOLN  
 Engineer O. L. Spinks  
 Engineer's Registration No. 2712  
 File No. 22-27 Drawing No. \_\_\_\_\_  
 Date APRIL 29, '66 Scale 1" = 660'

STATE OF WEST VIRGINIA  
DEPARTMENT OF MINES  
OIL AND GAS DIVISION  
CHARLESTON

WELL LOCATION MAP  
FILE NO. WAY-32-A

+ Denotes location of well on United States Topographic Maps, scale 1 to 62,500 latitude and longitude lines being represented by border lines as shown.

- Denotes one inch spaces on border line of original tracing.