

NOTICE OF PROPOSED LOCATION OF OIL AND GAS WELL

(REQUIRED BY SECTION 2, CHAPTER 86, ACTS 1929)

WEST VIRGINIA DEPARTMENT OF MINES

OIL AND GAS SECTION

To THE DEPARTMENT OF MINES,
Charleston, W. Va.

Roosevelt Coal & Coke Co.,

COAL OPERATOR OR COAL OWNER

Wilmerding, Pa.

ADDRESS

COAL OPERATOR OR COAL OWNER

ADDRESS

OWNER OF MINERAL RIGHTS

ADDRESS

THE MANUFACTURERS LIGHT & HEAT COMPANY

NAME OF WELL OPERATOR

800 Union Trust Bldg., Pittsburgh, Pa.

COMPLETE ADDRESS

September 29th, 1936

PROPOSED LOCATION

Proctor District

Wetzel County

Well No. 1 - 3532 39° 45' 8.0° 40' 100acres

August Blatt Farm

GENTLEMEN:

The undersigned well operator is entitled to drill upon the above named farm or tract of land for oil and gas, having fee title thereto, (or as the case may be) under grant or lease dated.....

October 18th, 1934

made by August Blatt and Mary C. Blatt, to

The Manufacturers Light & Heat Company

and recorded on the 20th day

of November, 1934

in the office of the County Clerk for said County in

Book 29-A, page 407

The enclosed plat was prepared by a competent engineer and shows the proposed location of a well to be drilled for oil and gas by the undersigned well operator on the farm and in the Magisterial District and County above named, determined by survey and courses and distances from two permanent points, or land marks.

The undersigned well operator is informed and believes there are no coal operators operating beds of coal beneath said farm or tract of land on which said well is located, or within 500 feet of the boundaries of the same, who have mapped their workings and filed their maps as required by law, excepting the coal operators or coal owners (if any) above named as addressees.

The above named coal operators or coal owners (if any) are notified that any objections they may desire to make to such proposed location, or which they are required to make by Section 3 of said Act, if the drilling of a well at said proposed location will cause a dangerous condition in or about their respective coal mines, must be received by, or filed with the Department of Mines within ten* days from the receipt of a copy of this notice and accompanying plat by said Department. Said coal operators are further notified that forms for use in making such objections will be furnished to them by the Department of Mines promptly on request and that all such objections must set forth as definitely as is reasonably possible the ground or grounds on which such objections are based and indicate the direction and distance the proposed location should be moved to overcome same.

(The next paragraph is to be completed only in Department's copy.)

Copies of this notice and the enclosed plat were mailed by registered mail, or delivered to the above

named coal operators or coal owners at their above shown respective address.....this.....day.... before, or on the same day with the mailing or delivery of this copy to the Department of Mines at Charleston, West Virginia.

Very truly yours, THE MANUFACTURERS LIGHT & HEAT COMPANY,
Land Dept.

WELL OPERATOR

800 Union Trust Bldg.,

STREET

Pittsburgh

CITY OR TOWN

Pennsylvania

STATE

09/29/2023

Address of Well Operator }

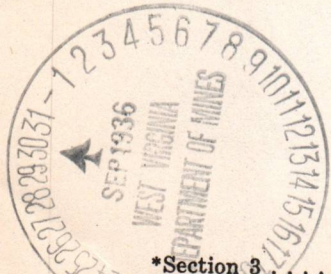

*Section 3. If no such objections be filed, or be found by the department of mines, within said period of ten days from the receipt of said notice and plat by the department of mines, to said proposed location, the department shall forthwith issue to the well operator a drilling permit reciting the filing of such plat, that no objections have been made by the coal operators to the location, or found thereto by the department, and that the same is approved and the well operator authorized to proceed to drill at said location.

133

STATE OF PENNSYLVANIA
DEPARTMENT OF REVENUE
DIVISION OF TAXES

THE MANUFACTURERS LIGHT & HEAT COMPANY

Roosevelt Coal & Coke Co.

300 Union Trust Bldg., Pittsburgh, Pa.

Washington, Pa.

Inspector
PROPOSED LOCATION

Address

City

State

County

Zip

Telephone

Proposed Location

Proposed Location

Proposed Location

Proposed Location

Proposed Location

Proposed Location

Proposed Location

Proposed Location

Proposed Location

Proposed Location

Proposed Location

Proposed Location

Proposed Location

Proposed Location

Proposed Location

Proposed Location

Proposed Location

Proposed Location

Proposed Location

09/29/2023

A-10

October 10, 1936

The Manufacturers Light & Heat Company
800 Union Trust Building
Pittsburgh, Pennsylvania

Gentlemen:

Permit Wet-133 to drill Well No. 1 - 3532
on the August Blatt Farm, Proctor District, Wetzel County,
is enclosed.

Please send us a complete record of the
well as soon as it is completed. Blanks are enclosed.

Very truly yours,

OIL AND GAS DIVISION.

MG:g
encl

copy to Inspector Courtney.
lat 39d-45'
long 80d-40'

G-1c
B-1

WEST VIRGINIA DEPARTMENT OF MINES

OIL AND GAS DIVISION

PRELIMINARY DATA SHEET NO. 1

File No. _____

Well No. 3532

The Manufacturers Light & Heat Co. Company of 800 Union Trust Building, Pittsburgh Pa.

_____ on the August Blatt Farm

containing 100 acres. Location _____

Proctor District, in Wetzel County, West Virginia

The surface of the above tract is owned in fee by August Blatt

of R. D. 1, Proctor, W. Va. address, and the mineral rights are owned by

The Manufacturers Light & Heat Co., of Pittsburgh, Penn'a.

The oil and gas privileges are held under lease by the above named company, and this well is drilled under permit

No. Wet-133 issued by the West Virginia Department of Mines, Oil and Gas Division

October 10th, 193 6.

Elevation of surface at top of well, 1200.9 feet Spirit Barometric.

The number of feet of the different sized casings used in the well.

16 feet 13 size. Wood conductor.

1077'-3" feet 10 size, csg. 1594'-10" feet 8 1/4 sized csg.

2049'-6" feet 6 5/8" size, csg. _____ feet _____ sized csg.

_____ feet _____ size, csg. _____ feet _____ sized csg.

No packer packer of _____ size, set at _____

_____ packer of _____ size, set at _____

_____, in casing perforated at _____ feet to _____ feet.

_____, in casing perforated at _____ feet to _____ feet.

Coal was encountered at 600' feet, thick ness 60 inches, and at 905

feet; thickness 36 inches; and at 1035 feet; thickness 60 inches.

Liners were used as follows: (Give details) None.

December 14th, 1936.

Date.

Approved THE MANUFACTURERS LIGHT & HEAT CO. Owner. 09/29/2023

By [Signature] (TITLE) Land Department.

7.



WEST VIRGINIA DEPARTMENT OF MINES

ON ANNUAL REPORT

PRIME MINERY DATA SHEET NO. 1

WEST VIRGINIA DEPARTMENT OF MINES

The Manufacturers Light & Heat Co., 300 Union Trust Building, Pittsburgh, Pa.

Against District

100

Proctor

Proctor

Proctor

Proctor, W. W.

The Manufacturers Light & Heat Co.,

Pittsburgh, Pa.

100-100

October 1933

100

1000.0 feet

10

10

10

1000-10

10

1000-10

1000

1000

No packer

100

100

100

100

1000

100

Home

October 1933

09/29/2023

The Manufacturers Light & Heat Company

COMPLETION DATA SHEET

800 Union Trust Building, Address
Pittsburgh, Pa.

No. 2

WELL NO. 3532

FARM August Blatt

FORMATION RECORD

Name	Color	Character	Oil, Gas or Water	Top	Bottom	Thickness	Total Depth	Remarks
Clay	Gray	Soft		0	16	16		
Lime	White	Hard		16	46	30		
Slate				46	100	54		
Sand				100	125	25		
Lime				125	140	15		
Red rock	Red	Soft		140	170	30		
Lime				170	210	40		
Slate			Water @ 210'	210	250	40		
Red rock	Red	Soft		250	280	30		
Slate				280	310	30		
Lime				310	325	15		
Sand				325	375	50		
Slate				375	425	50		
Red rock	Red	Soft		425	455	30		
Slate				455	470	15		
Lime				470	500	30		
Slate				500	560	60		
Sand				560	600	40		
Coal	Black	Soft		600	605	5		
Lime				605	640	35		
Slate				640	670	30		
Lime				670	700	30		
Slate				700	720	20		
Lime	White	Hard		720	745	25		
Red rock	Red	Soft		745	750	5		
Lime	White	Hard		750	905	155		
Mapletown Coal	Black	Soft		905	908	3		
Lime	White	Hard		908	950	42		
Slate	Black	Soft		950	970	20		
Lime & sand	White	Hard		970	990	20		
Slate	Gray	Hard & soft		990	1035	45		
Pitts. Coal	Black	Soft		1035	1040	5		
Slate	Black	Soft		1040	1045	5		
Sand	Gray	Hard		1045	1075	30		
Lime	White	Hard		1075	1125	50		
Sand	Gray	Hard		1125	1200	75		
Slate & shells	Gray	Soft		1200	1280	80		
Red rock	Red	Soft		1280	1350	70		
Lime	White	Hard		1350	1380	30		
Slate	Black	Soft		1380	1428	48		
Little Dunkard		Hard		1428	1443	15		
Slate	Black	Soft		1443	1495	52		
Big Dunkard				1495	1530	35		
Slate	Black	Soft		1530	1540	10		
Lime	White	Hard		1540	1580	40		
Slate	Black	Soft		1580	1600	20		
Gas sand	White	Hard & soft		1600	1697	97		
Slate	Black	Soft		1697	1725	28		
Sand			Water @ 1770'	1725	1808	83		
Slate	Black	Soft	Water @ 1805'	1808	1900	92		
Sand				1900	1950	50		
Slate shells				1950	2035	85		
Maxon sand		Hard	Gas 2035 to 2042.	2035	2042	7	2042	

Well was not shot at No. feet; well was shot at No. feet.

Salt salt
Fresh water at 210' feet; fresh water at 1770 and 1805 feet.

producing
Well was hole.

THE MANUFACTURERS LIGHT & HEAT COMPANY,

December 14th, 1936.
Date

Approved *[Signature]*
Owner

Land 09/29/2023

NOTE: All bottom formations must be noted as indicated above and all key-rocks and oil and gas sands must be recorded under their proper geological names in the district as well as any local names commonly used in the district for such strata.

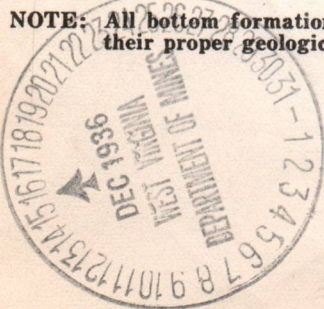

09/29/2023

NOTE: All bottom locations and depths indicated above and all depths and oil and gas lands shall be recorded under their proper geological names in the district as well as any local names commonly used in the district for such strata.

and Logarithm

December, 1930

THE MANUFACTURERS LIGHT & HEAT CO. BIRMINGHAM

1930 and 1931

No. 1-7 well log sheet of

No. 1-7 well log sheet of

Depth	Formation	Color	Texture	Notes
0	Clay	Gray	Soft	
10	Lime	White	Hard	
15	Slates			
20	Slates			
25	Slates			
30	Red rock	Red	Soft	
35	Lime			
40	Slates			
45	Red rock	Red	Soft	
50	Slates			
55	Lime			
60	Slates			
65	Red rock	Red	Soft	
70	Slates			
75	Red rock	Red	Soft	
80	Slates			
85	Slates			
90	Slates			
95	Slates			
100	Slates			
105	Slates			
110	Slates			
115	Slates			
120	Slates			
125	Slates			
130	Slates			
135	Slates			
140	Slates			
145	Slates			
150	Slates			
155	Slates			
160	Slates			
165	Slates			
170	Slates			
175	Slates			
180	Slates			
185	Slates			
190	Slates			
195	Slates			
200	Slates			
205	Slates			
210	Slates			
215	Slates			
220	Slates			
225	Slates			
230	Slates			
235	Slates			
240	Slates			
245	Slates			
250	Slates			
255	Slates			
260	Slates			
265	Slates			
270	Slates			
275	Slates			
280	Slates			
285	Slates			
290	Slates			
295	Slates			
300	Slates			
305	Slates			
310	Slates			
315	Slates			
320	Slates			
325	Slates			
330	Slates			
335	Slates			
340	Slates			
345	Slates			
350	Slates			
355	Slates			
360	Slates			
365	Slates			
370	Slates			
375	Slates			
380	Slates			
385	Slates			
390	Slates			
395	Slates			
400	Slates			
405	Slates			
410	Slates			
415	Slates			
420	Slates			
425	Slates			
430	Slates			
435	Slates			
440	Slates			
445	Slates			
450	Slates			
455	Slates			
460	Slates			
465	Slates			
470	Slates			
475	Slates			
480	Slates			
485	Slates			
490	Slates			
495	Slates			
500	Slates			
505	Slates			
510	Slates			
515	Slates			
520	Slates			
525	Slates			
530	Slates			
535	Slates			
540	Slates			
545	Slates			
550	Slates			
555	Slates			
560	Slates			
565	Slates			
570	Slates			
575	Slates			
580	Slates			
585	Slates			
590	Slates			
595	Slates			
600	Slates			
605	Slates			
610	Slates			
615	Slates			
620	Slates			
625	Slates			
630	Slates			
635	Slates			
640	Slates			
645	Slates			
650	Slates			
655	Slates			
660	Slates			
665	Slates			
670	Slates			
675	Slates			
680	Slates			
685	Slates			
690	Slates			
695	Slates			
700	Slates			
705	Slates			
710	Slates			
715	Slates			
720	Slates			
725	Slates			
730	Slates			
735	Slates			
740	Slates			
745	Slates			
750	Slates			
755	Slates			
760	Slates			
765	Slates			
770	Slates			
775	Slates			
780	Slates			
785	Slates			
790	Slates			
795	Slates			
800	Slates			
805	Slates			
810	Slates			
815	Slates			
820	Slates			
825	Slates			
830	Slates			
835	Slates			
840	Slates			
845	Slates			
850	Slates			
855	Slates			
860	Slates			
865	Slates			
870	Slates			
875	Slates			
880	Slates			
885	Slates			
890	Slates			
895	Slates			
900	Slates			
905	Slates			
910	Slates			
915	Slates			
920	Slates			
925	Slates			
930	Slates			
935	Slates			
940	Slates			
945	Slates			
950	Slates			
955	Slates			
960	Slates			
965	Slates			
970	Slates			
975	Slates			
980	Slates			
985	Slates			
990	Slates			
995	Slates			
1000	Slates			

300 Union Trust Building
 Pittsburgh, Pa.
 August 1930
 The Manufacturers Light & Heat
 COMPLETION DATA SHEET
 FORMATION RECORD

B-3



STATE OF WEST VIRGINIA
DEPARTMENT OF MINES
OIL AND GAS DIVISION

Littleton

WELL RECORD

Storage

Permit No. WET- 133

Oil or Gas Well Gas
(KIND)

Company THE MANUFACTURERS LIGHT & HEAT COMPANY
 Address 800 Union Trust Bldg., Pgh., Penna.
 Farm August Blatt Acres 100
 Location (waters) _____
 Well No. 3532 Elev. 1200.9
 District Proctor County Wetzel
 The surface of tract is owned in fee by August Blatt
 Address _____
 Mineral rights are owned by The Mfrs. Light & Heat Co.
800 Union Trust Bldg., Address Pgh., Penna.
 Drilling commenced August 21, 1952
 Drilling completed November 19, 1952
 Date Shot _____ From _____ To _____
 With _____
 Open Flow _____ /10ths Water in _____ Inch
 _____ /10ths Merc. in _____ Inch
 Volume _____ Cu. Ft.
 Rock Pressure _____ lbs. _____ hrs.
 Oil _____ bbls., 1st 24 hrs.
 Fresh water _____ feet _____ feet
 Salt water _____ feet _____ feet

Casing and Tubing	Used in Drilling	Left in Well	Packers
Size			Kind of Packer
16			
13			Size of
10			Depth set
8 1/4			
6 5/8			
5 3/16			Perf. top
4 1/2	<u>2050'2"</u>	<u>2050'2"</u>	Perf. bottom
2			Perf. top
Liners Used			Perf. bottom

CASING CEMENTED _____ SIZE _____ No. Ft. _____ Date _____
 COAL WAS ENCOUNTERED AT _____ FEET _____ INCHES
 _____ FEET _____ INCHES FEET _____ INCHES
 _____ FEET _____ INCHES FEET _____ INCHES

Formation	Color	Hard or Soft	Top	Bottom	Oil, Gas or Water	Depth Found	Remarks
Total Depth				2076			Schlumberger Measurement
Filled with stone				2065			
Lead Plug				2062'4"			
Total Depth				2062'4"			Tubing Centralizers installed at
Maxon Sand			2032	2062			depth beginning at top of hole
Gas			2034	2054			
						1 -	68'8"
						2 -	567'10"
						3 -	1080'
						4 -	1712'
						5 -	1841'11"
						6 -	1946'1"
						7 -	2040'2"
The Manufacturers Light and Heat Company Active Well - - Reconditioned							

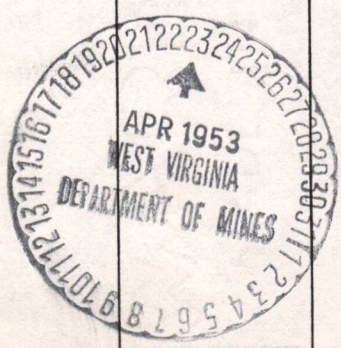

09/29/2023

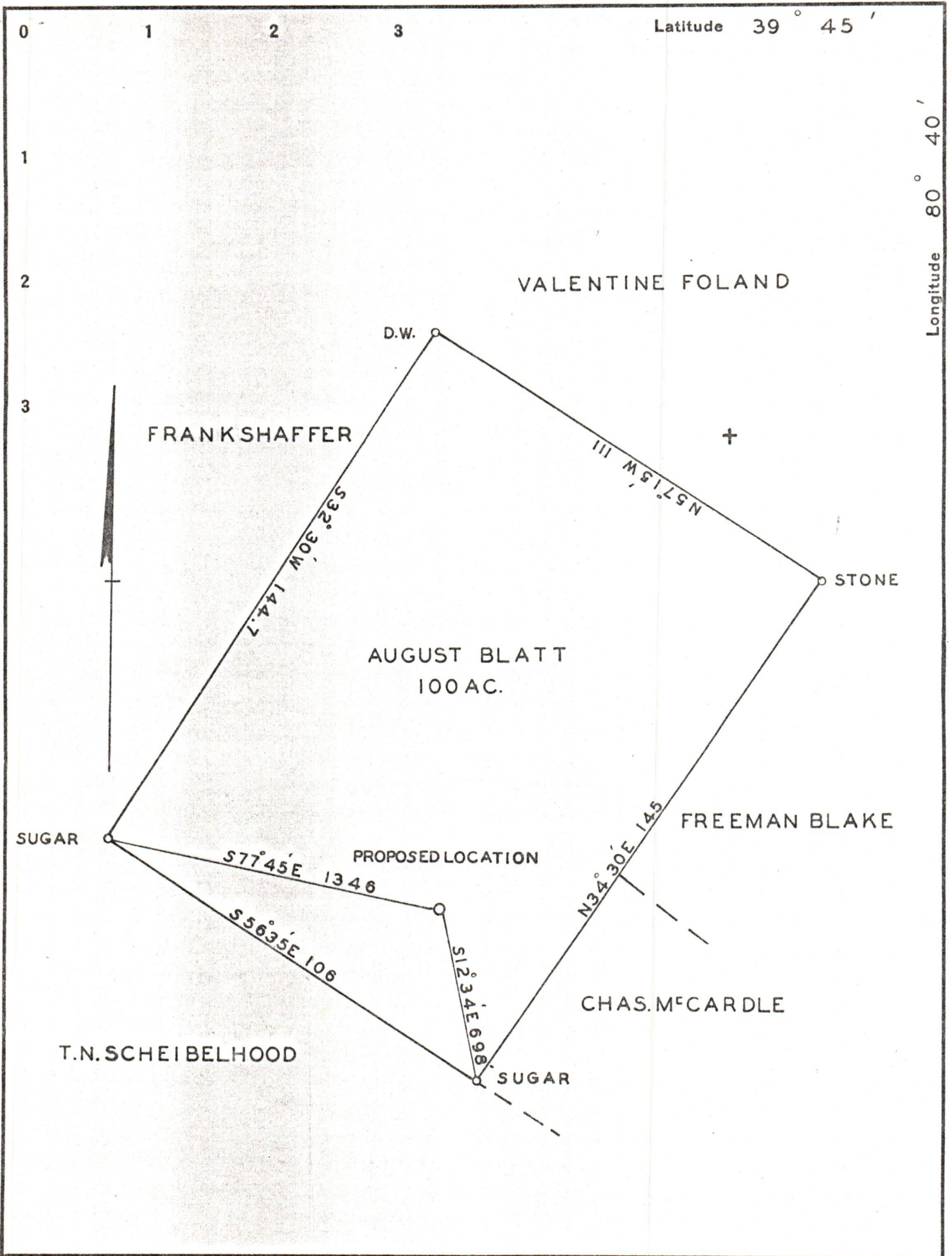

Company THE MANUFACTURERS LIGHT & HEAT

Address 800 UNION TRUST BUILDING

Farm AUGUST BLATT

Tract Acres 100 Lease No. 17174

Well (Farm) No. 1 Serial No. 3532

Elevation (Spirit Level) 1200.9

Quadrangle LITTLETON N.W.

County WETZEL District PROCTOR

Engineer F. H. SOCHOR

Engineer's Registration No.

File No. Drawing No. Y-7 486

Date SEPT. 22 1936 Scale 1" = 500'

STATE OF WEST VIRGINIA
 DEPARTMENT OF MINES
 OIL AND GAS DIVISION
 CHARLESTON

WELL LOCATION MAP

FILE NO. WET-133

09/29/2023

+ Denotes location of well on United States Topographic Maps, scale 1 to 62,500, latitude and longitude lines being represented by border lines as shown.

- Denotes one inch spaces on border line of original tracing.