

A1 FORM G-1

NOTICE OF PROPOSED LOCATION OF OIL AND GAS WELL

(REQUIRED BY SECTION 2, CHAPTER 86, ACTS 1929)

WEST VIRGINIA DEPARTMENT OF MINES

OIL AND GAS SECTION

To THE DEPARTMENT OF MINES,
Charleston, W. Va.

No Coal Operations in Vicinity.
COAL OPERATOR OR COAL OWNER

ADDRESS

Coal Owner Unknown.
COAL OPERATOR OR COAL OWNER

ADDRESS

O. W. Yeater
OWNER OF MINERAL RIGHTS

Silverhill, W. Va.,
ADDRESS

Hope Natural Gas Company
NAME OF WELL OPERATOR

445 West Main St.
Clarksburg, W. Va.,
COMPLETE ADDRESS

April 28, 1937

PROPOSED LOCATION

Center District

Wetzel County

Well No. 7783 39° 45' 80° 40' 56ac

O. W. Yeater Farm

GENTLEMEN:

The undersigned well operator is entitled to drill upon the above named farm or tract of land for oil and gas, having fee title thereto, (or as the case may be) under grant or lease dated 2-17-1925

made by O. W. & Ora Yeater

Hope Natural Gas Company, and recorded on the 1st day

of June 1925, in the office of the County Clerk for said County in

Book 18-A, page 306

The enclosed plat was prepared by a competent engineer and shows the proposed location of a well to be drilled for oil and gas by the undersigned well operator on the farm and in the Magisterial District and County above named, determined by survey and courses and distances from two permanent points, or land marks.

The undersigned well operator is informed and believes there are no coal operators operating beds of coal beneath said farm or tract of land on which said well is located, or within 500 feet of the boundaries of the same, who have mapped their workings and filed their maps as required by law, excepting the coal operators or coal owners (if any) above named as addressees.

The above named coal operators or coal owners (if any) are notified that any objections they may desire to make to such proposed location, or which they are required to make by Section 3 of said Act, if the drilling of a well at said proposed location will cause a dangerous condition in or about their respective coal mines, must be received by, or filed with the Department of Mines within ten* days from the receipt of a copy of this notice and accompanying plat by said Department. Said coal operators are further notified that forms for use in making such objections will be furnished to them by the Department of Mines promptly on request and that all such objections must set forth as definitely as is reasonably possible the ground or grounds on which such objections are based and indicate the direction and distance the proposed location should be moved to overcome same.

(The next paragraph is to be completed only in Department's copy.)

Copies of this notice and the enclosed plat were mailed by registered mail, or delivered to the above named coal operators or coal owners at their above shown respective address day before, on the same day with the mailing or delivery of this copy to the Department of Mines at Charleston, West Virginia.

Very truly yours, Hope Natural Gas Company

Asst. General Supt.
WELL OPERATOR

445 West Main St.

STREET

Clarksburg,

CITY OR TOWN

West Virginia.,

STATE

Address of Well Operator }

09/22/2023

*Section 3 If no such objections be filed, or be found by the department of mines, within said period of ten days from the receipt of said notice and plat by the department of mines, to said proposed location, the department shall forthwith issue to the well operator a drilling permit reciting the filing of such plat, that no objections have been made by the coal operators to the location, or found thereto by the department, and that the same is approved and the well operator authorized to proceed to drill at said location.

156

NOTICE OF PROPOSED LOCATION OF OIL AND GAS WELL
 (REGULATED BY SECTION 2, CHAPTER 88, ACTS 1929)
 WEST VIRGINIA DEPARTMENT OF MINES
 OIL AND GAS SECTION

Form G-1

To The Department of Mines
 Charleston, W. Va.

Hope Natural Gas Company
 NAME OF WELL OPERATOR
 425 West Main St.
 Charleston, W. Va.
 COMPLETE ADDRESS

No Coal Operations in Virginia
 COAL OPERATOR OR COAL OWNER

Proposed Location
 198 7
 33
 7

Coal Owner Unknown
 COAL OPERATOR OR COAL OWNER

Center
 District

ADDRESS

Weston
 County

O. W. Yeator
 OWNER OF MINERAL RIGHTS

Well No. 82
 Farm

Eliverhill, W. Va.
 ADDRESS

The undersigned well operator is entitled to drill upon the above named farm or tract of land for oil and gas having fee title thereto, (or as the case may be) under grant or lease dated 2-17-1923

made by O. W. & Ora Yeator

and recorded on the 1st day

of June 1923

in the office of the County Clerk for said County in

Book 18-A page 308

The enclosed plat was prepared by a competent engineer and shows the proposed location of a well to be drilled for oil and gas by the undersigned well operator on the farm and in the Magisterial District and County above named, determined by survey and courses and distances from two permanent points on land marked.

The undersigned well operator is informed and believes there are no coal operators operating beds of coal beneath said farm or tract of land on which said well is located, or within 500 feet of the boundary of the same, who have mapped their workings and filed their maps as required by law, excepting the coal operators or coal owners (if any) above named as addressees.

The above named coal operators or coal owners (if any) are notified that any objections they may desire to make to such proposed location, or which they are required to make by Section 3 of said Act, if the drilling of a well at said proposed location will cause a dangerous condition in or about their respective coal mines, must be received by or filed with the Department of Mines within ten days from the receipt of a copy of this notice and accompanying plat by said Department. Said coal operators are further notified that forms for use in making such objections will be furnished to them by the Department of Mines promptly on request and that all such objections must set forth substantially as is reasonably possible the ground or grounds on which such objections are based and indicate the direction and distance the proposed location should be moved to overcome same.

(The next paragraph is to be completed only in Department's copy.)

Copies of this notice and the enclosed plat were mailed by registered mail, or delivered to the above named coal operators or coal owners at their above shown respective addresses, on the same day with the mailing or delivery of this copy to the Department of Mines at Charleston, West Virginia.

Very truly yours, Hope Natural Gas Company

Asst. General Supt.

WELL OPERATOR

425 West Main St.

Street

Charleston

CITY OR TOWN

West Virginia

STATE

Address
 of
 Well Operator

09/22/2023

*Section 8. . . . If no such objections be filed or be found by the department of mines within said period of ten days from the receipt of said notice and plat by the department of mines to said proposed location, the department shall forthwith issue to the well operator a drilling permit reciting the date of such plat, that no objections have been made by the coal operators to the location, or found there by the department, and that the same is approved and the well operator authorized to proceed to drill at said location.

As 10

April 29, 1937

Mr. O. W. Yeater
Silverhill, W. Va.

Dear Sir:

A notice of a proposed location of oil or gas Well No. 7783 on the O. W. Yeater Farm, Center District, Wetzel County, has been received from the Hope Natural Gas Company, Clarksburg, West Virginia. A copy of the notice and location plat should have been mailed you by the well operator.

If you have any objections to the proposed location, please file same not later than May 9, 1937.

Very truly yours,

Secretary
OIL AND GAS DIVISION.

MG:g

09/22/2023

A-11

May 10, 1937

Hope Natural Gas Company
445 West Main Street
Clarksburg, West Virginia

Gentlemen:

Permit Wet-156 to drill Well No. 7783 on
the O. W. Yeater Farm, Center District, Wetzel County,
is enclosed.

Duplicate permits are enclosed.

Very truly yours,

Secretary
OIL AND GAS DIVISION.

MG:g
encl

copy to Inspector Courtney.
lat 39d-45'
long 80d-40'

09/22/2023

Formation	Color	Hard or Soft	Top	Bottom	Oil, Gas or Water	Depth Found	Remarks
Coal			700	704			
Lime	Dark	Hard	704	740			
Lime & Shells		Soft	740	760			
Slate		Soft	760	770			
Lime		Soft	770	780			
Coal		Soft	780	784			
Lime	Dark	Hard	784	800			
Bluff Sand			800	845			
Coal		Soft	845	849			
Lime		Hard	849	860			
Red Rock			860	870			
Lime		Broken	870	900			
Slate			900	920			
Lime		Hard	920	960			
Red Rock			960	970			
Lime		Hard	970	1000			
Lime		Broken	1000	1070			
Slate			1070	1076			
Mapletown Coal			1076	1079			
Lime	Dark	Hard	1079	1115			
Slate			1115	1118			
Lime & Slate			1118	1174			
Pittsburgh Coal			1174	1179			
Lime & Slate			1179	1250			
Sand	White	Hard	1250	1258			
Pink Rock			1258	1270			
Pink Rock & Lime			1270	1275			
Red Rock			1275	1300			
Lime		Hard	1300	1315			
Shell		Soft	1315	1325			
Murphy Sand			1325	1352	Water	1335	
Red Rock			1352	1365			
Slate			1365	1443			
Red Rock			1443	1504			
Slate			1504	1512			
Sand			1512	1555			
Red Rock			1555	1562			
Slate			1562	1570			
Little Dunkard Sand			1570	1590			
Lime & Slate			1590	1680			
Big Dunkard Sand			1680	1712			
Slate			1712	1796			
Gas Sand			1796	1825			
White Muck			1825	1835			
Sand			1835	1860			
Slate			1860	1910			
Sand (First Salt Sand)			1910	1940	Water	1933	
Slate			1940	1974			
Sand (Second Salt Sand)			1974	2010			
Slate			2010	2060			
Sand (Salt Sand)		Hard	2060	2124	Water	2086-2100	
Slate			2124	2195			
Lime			2195	2205			
Slate			2205	2228			
Maxon Sand			2228	2300	Water	2240	
Big Lime		Hard	2300	2359			
Big Injun Sand			2359	2595	Gas	2406	
Shells & Slate			2595	2630			
Lime	Gray	Hard	2630	2680			
Lime & Shells		Broken	2680	2955			
Slate			2955	2965			
Fifty Foot Sand			2965	3000			
Slate & Pink Rock			3000	3090			
Thirty Foot Sand			3090	3116			
Slate & Shells			3116	3187			
Gordon Stray Sand			3187	3193			
Slate			3193	3203			
Gordon Sand			3203	3215	Oil	3205-3215	
Total Depth			-----	3215			

Date August 17, 1937

APPROVED Hope Natural Gas Company, Owner

By *[Signature]*
(Title) Asst. General Supt.

09/22/2023

WEST VIRGINIA DEPARTMENT OF MINES
OIL AND GAS DIVISION

WELL RECORD

Permit No. Wet-156Oil or Gas Well Oil
(Kind)

Company Hope Natural Gas Company
 Address Clarksburg, W. Va.,
 Farm O. W. Yeater Acres 56
 Location (waters) Lower Run
 Well No. 7783 Elev. 1239
 District Center County Wetzel
 The surface of tract is owned in fee by
 Address
 Mineral rights are owned by
 Address
 Drilling commenced May 6, 1937
 Drilling completed July 22, 1937
 Date shot Depth of shot
 Open Flow /10ths Water in Inch
 /10ths Merc. in Inch
 Volume Cu. Ft.
 Rock Pressure lbs. hrs.
 Oil 8 bbls., 1st 24 hrs.
 Fresh water 82 feet 1335 feet
 Salt water 1933-2086-2100 feet 2240 feet

Casing and Tubing	Used in Drilling	Left in Well	Packers
Size			
16			Kind of Packer
13	<u>127</u>	<u>60</u>	
10	<u>1305</u>	<u>1305</u>	Size of
8 1/4	<u>1510</u>	<u>1510</u>	
6 5/8	<u>2108</u>	<u>2108</u>	Depth set
5 3/16	<u>2315</u>	<u>2315</u>	
3			Perf. top
2			Perf. bottom
Liners Used			Perf. top
			Perf. bottom

CASING CEMENTED SIZE No. FT. Date
Not cemented
 COAL WAS ENCOUNTERED AT 700 FEET 48 INCHES
780 FEET 48 INCHES 845 FEET 48 INCHES
1076 FEET 36 INCHES 1174 FEET 60 INCHES

Formation	Color	Hard or Soft	Top	Bottom	Oil Gas or Water	Depth Found	Remarks
Brown Shale				<u>10</u>			
Sand Stone		Hard	<u>10</u>	<u>25</u>			
Slate	Black	Soft	<u>25</u>	<u>30</u>			
Blue Stone		Hard	<u>30</u>	<u>40</u>			
Gray Stone		Soft	<u>40</u>	<u>45</u>			
Lime Stone		Hard	<u>45</u>	<u>60</u>			
Gritty Lime			<u>60</u>	<u>80</u>			
Blue Mud			<u>80</u>	<u>85</u>	Water	<u>82</u>	
Lime Stone		Hard	<u>85</u>	<u>110</u>			
Blue Rock		Hard	<u>110</u>	<u>130</u>			
Red Rock			<u>130</u>	<u>140</u>			
Lime			<u>140</u>	<u>160</u>			
Slate			<u>160</u>	<u>180</u>			
Lime			<u>180</u>	<u>195</u>			
Red Rock			<u>195</u>	<u>210</u>			
Lime			<u>210</u>	<u>240</u>			
Slate			<u>240</u>	<u>250</u>			
Lime			<u>250</u>	<u>260</u>			
Red Rock			<u>260</u>	<u>275</u>			
Lime			<u>275</u>	<u>280</u>			
Red Rock			<u>280</u>	<u>290</u>			
Lime		Hard	<u>290</u>	<u>295</u>			
Red Rock			<u>295</u>	<u>305</u>			
Lime		Hard	<u>305</u>	<u>310</u>			
Red Rock			<u>310</u>	<u>320</u>			
Lime			<u>320</u>	<u>350</u>			
Red Rock			<u>350</u>	<u>400</u>			
Lime		Hard	<u>400</u>	<u>420</u>			
Red Rock			<u>430</u>	<u>445</u>			
Lime		Hard	<u>445</u>	<u>450</u>			
Slate			<u>450</u>	<u>460</u>			
Lime		Hard	<u>460</u>	<u>500</u>			
Lime	Dark	Hard	<u>500</u>	<u>515</u>			
Sand		Hard	<u>515</u>	<u>540</u>			
Lime		Hard	<u>540</u>	<u>570</u>			
Red Rock			<u>570</u>	<u>575</u>			
Lime	Light	Hard	<u>575</u>	<u>590</u>			
Sand			<u>590</u>	<u>600</u>			
Slate			<u>600</u>	<u>660</u>			
Lime			<u>660</u>	<u>670</u>			
Red Rock			<u>670</u>	<u>675</u>			
Sand			<u>665</u>	<u>700</u>			



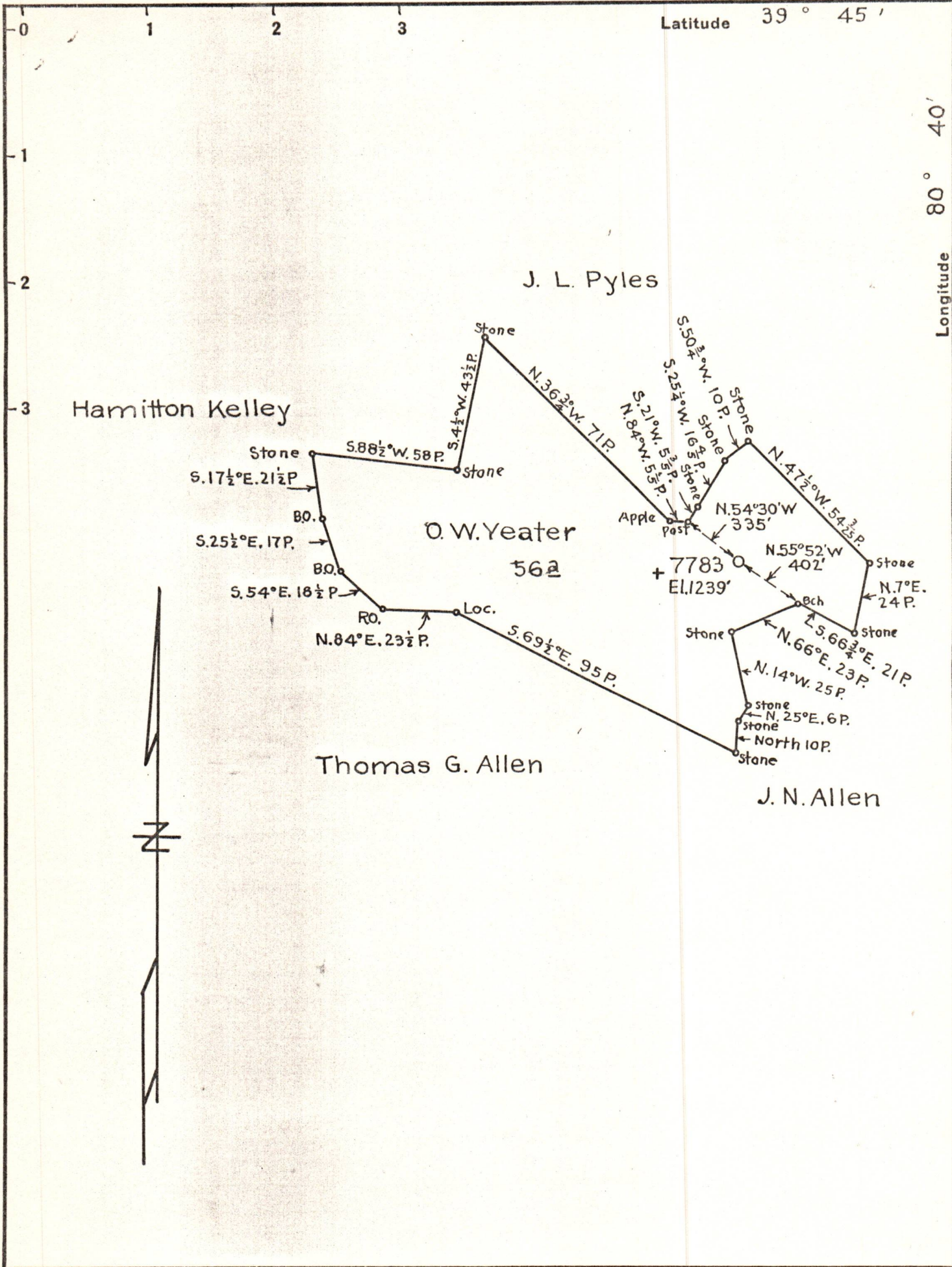

Company Hope Natural Gas Co.
 Address Clarksburg, W.Va.
 Farm O. W. Yeater
 Tract _____ Acres 56 Lease No. _____
 Well (Farm) No. 1 Serial No. 7783
 Elevation (Spirit Level) 1239'
 Quadrangle Littleton
 County Wetzel District Center
 Engineer B. H. Bradley
 Engineer's Registration No. 135
 File No. _____ Drawing No. _____
 Date 4-27-1937 Scale 1"=40 Poles

STATE OF WEST VIRGINIA
 DEPARTMENT OF MINES
 OIL AND GAS DIVISION
 CHARLESTON

WELL LOCATION MAP 09/22/2023
 FILE NO. WET-156

+ Denotes location of well on United States Topographic Maps, scale 1 to 62,500, latitude and longitude lines being represented by border lines as shown.

— Denotes one inch spaces on border line of original tracing.

BK-647 P-9.