

NOTICE OF PROPOSED LOCATION OF OIL AND GAS WELL

(REQUIRED BY SECTION 2, CHAPTER 86, ACTS 1929)

WEST VIRGINIA DEPARTMENT OF MINES

OIL AND GAS SECTION

To THE DEPARTMENT OF MINES, Charleston, W. Va.

Miss Beatrice Yeater

COAL OPERATOR OR COAL OWNER

Virginia St., New Martinsville, WVa

ADDRESS

COAL OPERATOR OR COAL OWNER

ADDRESS

OWNER OF MINERAL RIGHTS

ADDRESS

THE MANUFACTURERS LIGHT & HEAT COMPANY

NAME OF WELL OPERATOR

800 Union Trust Bldg., Pittsburgh, Pa.

COMPLETE ADDRESS

May 26th, 1937

PROPOSED LOCATION

Proctor District

Wetzel County

Well No. 2 - 3547 39° 45' 80° 42'

George and Mary Poland Farm

GENTLEMEN:

The undersigned well operator is entitled to drill upon the above named farm or tract of land for oil and gas, having fee title thereto, (or as the case may be) under grant or lease dated.....

April 10th, 1914

, made by George and Mary Poland, to

The Wheeling Natural Gas Company

, and recorded on the 12th day

of May, 1914, in the office of the County Clerk for said County in

Book 4-A, page 304

The enclosed plat was prepared by a competent engineer and shows the proposed location of a well to be drilled for oil and gas by the undersigned well operator on the farm and in the Magisterial District and County above named, determined by survey and courses and distances from two permanent points, or land marks.

The undersigned well operator is informed and believes there are no coal operators operating beds of coal beneath said farm or tract of land on which said well is located, or within 500 feet of the boundaries of the same, who have mapped their workings and filed their maps as required by law, excepting the coal operators or coal owners (if any) above named as addressees.

The above named coal operators or coal owners (if any) are notified that any objections they may desire to make to such proposed location, or which they are required to make by Section 3 of said Act, if the drilling of a well at said proposed location will cause a dangerous condition in or about their respective coal mines, must be received by, or filed with the Department of Mines within ten\* days from the receipt of a copy of this notice and accompanying plat by said Department. Said coal operators are further notified that forms for use in making such objections will be furnished to them by the Department of Mines promptly on request and that all such objections must set forth as definitely as is reasonably possible the ground or grounds on which such objections are based and indicate the direction and distance the proposed location should be moved to overcome same.

(The next paragraph is to be completed only in Department's copy.)

Copies of this notice and the enclosed plat were mailed by registered mail, or delivered to the above

named coal operators or coal owners at their above shown respective address.....this.....day.... before, or on the same day with the mailing or delivery of this copy to the Department of Mines at Charleston, West Virginia.

Very truly yours, THE MANUFACTURERS LIGHT & HEAT CO.,

Harry H. Fowler

Land Dept. WELL OPERATOR Office Manager

800 Union Trust Building

STREET

Pittsburgh

CITY OR TOWN

Pennsylvania

STATE

09/22/2023

Address of Well Operator }

\*Section 3 . . . . . If no such objections be filed, or be found by the department of mines, within said period of ten days from the receipt of said notice and plat by the department of mines, to said proposed location, the department shall forthwith issue to the well operator a drilling permit reciting the filing of such plat, that no objections have been made by the coal operators to the location, or found thereto by the department, and that the same is approved and the well operator authorized to proceed to drill at said location.

158



NOTICE OF PROPOSED LOCATION OF OIL AND GAS WELL  
WEST VIRGINIA DEPARTMENT OF MINES  
THE STATE DEPARTMENT

THE MANUFACTURERS LIGHT & HEAT COMPANY

Miss Beatrice Foster

300 Union Trust Bldg., Pittsburgh, Pa.

Virginia St., New Martinsville, W. Va.

May 20th 1911

PROPOSED LOCATION

Section

County

Well No. 2 - 3347

George and Mary Polans

The undersigned well owners are desirous to lease the above named land or part of land for  
oil and gas purposes to the State of West Virginia for the use of the State or for the use of

George and Mary Polans

The West Virginia Natural Gas Company

and recorded on the 12th day

of May, 1911

The proposed well was proposed by a competent person and shows the proposed location of a well  
to be drilled for oil and gas by the proposed well owners on the land and in the Mineral District  
of the State of West Virginia and shows the proposed location of a well to be drilled for oil and gas

The proposed well operator is desirous to lease the above named land or part of land for  
oil and gas purposes to the State of West Virginia for the use of the State or for the use of

The State of West Virginia and shows the proposed location of a well to be drilled for oil and gas  
by the proposed well owners on the land and in the Mineral District of the State of West Virginia

The proposed well operator is desirous to lease the above named land or part of land for  
oil and gas purposes to the State of West Virginia for the use of the State or for the use of

The State of West Virginia and shows the proposed location of a well to be drilled for oil and gas  
by the proposed well owners on the land and in the Mineral District of the State of West Virginia

The proposed well operator is desirous to lease the above named land or part of land for  
oil and gas purposes to the State of West Virginia for the use of the State or for the use of

The State of West Virginia and shows the proposed location of a well to be drilled for oil and gas  
by the proposed well owners on the land and in the Mineral District of the State of West Virginia

The proposed well operator is desirous to lease the above named land or part of land for  
oil and gas purposes to the State of West Virginia for the use of the State or for the use of

The State of West Virginia and shows the proposed location of a well to be drilled for oil and gas  
by the proposed well owners on the land and in the Mineral District of the State of West Virginia

The proposed well operator is desirous to lease the above named land or part of land for  
oil and gas purposes to the State of West Virginia for the use of the State or for the use of

The State of West Virginia and shows the proposed location of a well to be drilled for oil and gas  
by the proposed well owners on the land and in the Mineral District of the State of West Virginia

The proposed well operator is desirous to lease the above named land or part of land for  
oil and gas purposes to the State of West Virginia for the use of the State or for the use of

The State of West Virginia and shows the proposed location of a well to be drilled for oil and gas  
by the proposed well owners on the land and in the Mineral District of the State of West Virginia

The proposed well operator is desirous to lease the above named land or part of land for  
oil and gas purposes to the State of West Virginia for the use of the State or for the use of

The State of West Virginia and shows the proposed location of a well to be drilled for oil and gas  
by the proposed well owners on the land and in the Mineral District of the State of West Virginia

09/22/2023





STATE OF WEST VIRGINIA  
DEPARTMENT OF MINES  
OIL AND GAS DIVISION

NOTICE OF PROPOSED LOCATION OF OIL AND GAS WELL

To THE DEPARTMENT OF MINES,  
Charleston, W. Va.

\_\_\_\_\_  
COAL OPERATOR OR COAL OWNER

\_\_\_\_\_  
ADDRESS

\_\_\_\_\_  
COAL OPERATOR OR COAL OWNER

\_\_\_\_\_  
ADDRESS

\_\_\_\_\_  
OWNER OF MINERAL RIGHTS

\_\_\_\_\_  
ADDRESS

THE MANUFACTURERS LIGHT AND HEAT COMPANY

\_\_\_\_\_  
NAME OF WELL OPERATOR  
800 Union Trust Building  
Pittsburgh, Pennsylvania

\_\_\_\_\_  
COMPLETE ADDRESS

August 24, 1953, 19\_\_\_\_

PROPOSED LOCATION

Proctor \_\_\_\_\_ District

Wetzel \_\_\_\_\_ County

Well No. 2-3547 <sup>39° 40'</sup><sub>80° 40'</sub>

George & Mary Foland \_\_\_\_\_ Farm

GENTLEMEN:

The undersigned well operator is entitled to drill upon the above named farm or tract of land for oil and gas, having fee title thereto, (or as the case may be) under grant or lease dated \_\_\_\_\_  
March 10, 1952, made by Valentine & Anna Foland, to  
THE MANUFACTURERS LIGHT AND HEAT COMPANY, and recorded on the 17th day  
of April, 1952, in the office of the County Clerk for said County in  
Book 40A, page 43.

The enclosed plat was prepared by a competent engineer and shows the proposed location of a well to be drilled for oil and gas by the undersigned well operator on the farm and in the Magisterial District and County above named, determined by survey and courses and distances from two permanent points, or land marks.

The undersigned well operator is informed and believes there are no coal operators operating beds of coal beneath said farm or tract of land on which said well is located, or within 500 feet of the boundaries of the same, who have mapped their workings and filed their maps as required by law, excepting the coal operators or coal owners (if any) above named as addressees.

The above named coal operators or coal owners (if any) are notified that any objections they may desire to make to such proposed location, or which they are required to make by Section 3 of said Code, if the drilling of a well at said proposed location will cause a dangerous condition in or about their respective coal mines, must be received by, or filed with the Department of Mines within ten\* days from the receipt of a copy of this notice and accompanying plat by said Department. Said coal operators are further notified that forms for use in making such objections will be furnished to them by the Department of Mines promptly on request and that all such objections must set forth as definitely as is reasonably possible the ground or grounds on which such objections are based and indicate the direction and distance the proposed location should be moved to overcome same.

(The next paragraph is to be completed only in Department's copy.)

Copies of this notice and the enclosed plat were mailed by registered mail, or delivered to the above named coal operators or coal owners at their above shown respective address \_\_\_\_\_ day \_\_\_\_\_ before, or on the same day with the mailing or delivery of this copy to the Department of Mines at Charleston, West Virginia.

Very truly yours,

  
 \_\_\_\_\_ ASST. LAND AGENT

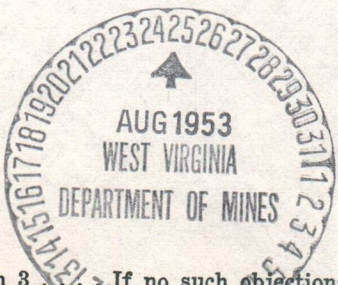

Address of Well Operator }

THE MANUFACTURERS LIGHT AND HEAT COMPANY

\_\_\_\_\_  
STREET

800 Union Trust Building

\_\_\_\_\_  
CITY OR TOWN

Pittsburgh, Pennsylvania

\_\_\_\_\_  
STATE

09/22/2023

\*Section 3. If no such objections be filed or be found by the department of mines, within said period of ten days from the receipt of said notice and plat by the department of mines, to said proposed location, the department shall forthwith issue to the well operator a drilling permit reciting the filing of such plat, that no objections have been made by the coal operators to the location, or found thereto by the department, and that the same is approved and the well operator authorized to proceed to drill at said location.

158 Redrill





STATE OF WEST VIRGINIA  
DEPARTMENT OF MINES  
OIL AND GAS DIVISION

NOTICE OF PROPOSED LOCATION OF OIL AND GAS WELL

To THE DEPARTMENT OF MINES  
Charleston, W. Va.

THE MANUFACTURERS LIGHT AND HEAT COMPANY

NAME OF WELL OPERATOR  
800 Union Trust Building  
Pittsburgh, Pennsylvania

COAL OPERATOR OR COAL OWNER

ADDRESS

August 24, 1923

PROPOSED LOCATION

COAL OPERATOR OR COAL OWNER

ADDRESS

District Proctor

County Netzel

OWNER OF MINERAL RIGHTS

Well No. 2-3547

ADDRESS

Farm George & Mary Roland

GENTLEMEN:

The undersigned well operator is entitled to drill upon the above named farm or tract of land for oil and gas, having fee title thereto, (or as the case may be) under grant or lease dated

March 10, 1922 made by Valentine & Anna Roland to THE MANUFACTURERS LIGHT AND HEAT COMPANY and recorded on the 17th day

of April, 1922 in the office of the County Clerk for said County in

Book NO. 43 page 43

The enclosed plat was prepared by a competent engineer and shows the proposed location of a well to be drilled for oil and gas by the undersigned well operator on the farm and in the Marshall District and County above named, determined by survey and courses and distances from two permanent points or land marks.

The undersigned well operator is informed and believes there are no coal operators operating beds of coal beneath said farm or tract of land on which said well is located, or within 500 feet of the board-aces of the same, who have mapped their workings and filed their maps as required by law, excepting the coal operators or coal owners (if any) above named as addressees.

The above named coal operators or coal owners (if any) are notified that any objections they may desire to make to such proposed location or which they are required to make by Section 3 of said Code, if the drilling of a well at said proposed location will cause a dangerous condition in or about their respective coal mines, must be received by or filed with the Department of Mines within ten days from the receipt of a copy of this notice and accompanying plat by said Department. Said coal operators are further notified that forms for use in making such objections will be furnished to them by the Department of Mines promptly on request and that all such objections must set forth in detail as is reasonably possible the grounds or grounds on which such objections are based and indicate the direction and distance the proposed location should be moved to overcome same.

(The next paragraph is to be completed only in Department's copy.) Copies of this notice and the enclosed plat were mailed by registered mail, or delivered to the above

named coal operators or coal owners at their above shown respective addresses day before, on the same day with the mailing or delivery of this copy to the Department of Mines at Charleston, West Virginia.

Very truly yours,

*[Signature]*

THE MANUFACTURERS LIGHT AND HEAT COMPANY  
ATTENTION ASST. LAND AGENT

800 Union Trust Building  
Pittsburgh, Pennsylvania

Address of Well Operator



09/22/2023

\*Section 3 of the Code provides that if no such objections be filed or be found by the department of mines within said period of ten days from the receipt of this notice and plat by the department of mines, the proposed location of the well shall forthwith be deemed to be approved and the well operator a drilling permit vesting the right of such well, and no objections have been made by the coal operators on the location or found thereby by the department and that the same is approved and the well operator authorized to proceed to drill at said location.



A-10

June 6, 1937

The Manufacturers Light & Heat Co.,  
800 Union Trust Bldg.,  
Pittsburgh, Pa.

Gentlemen:

Permit Wet-158 to drill Well No. 2-3547  
on the George and Mary Poland Farm, Proctor District,  
Wetzel County, is enclosed.

Duplicate permits are issued. One shall  
be posted on the rig in a conspicuous place.

Very truly yours,

Secretary  
OIL AND GAS DIVISION.

MG:g  
encl

copy to Inspector Courtney.  
lat 39d-45'  
long 80d-40'

09/22/2023



Formation	Color	Hard or Soft	Top	Bottom	Oil, Gas or Water	Depth Found	Remarks
Red rock	Red		1515	1550			
Shale			1550	1565			
Red rock	Red		1565	1572			
1st cow run			1572	1584			
Red rock	Red		1584	1604			
Slate	Black		1604	1610			
Lime			1610	1645			
Shale			1645	1655			
Red rock			1655	1665			
Slate	Dark	Soft	1665	1685			
Red rock	Red		1685	1698			
2nd cow run			1698	1718			
Slate	Red		1718	1730			
Gas sand			1730	1755			
Slate			1755	1775			
Shale			1775	1785			
1st salt sand			1785	1825			
Shale			1825	1935			
Lime			1935	1960			
Slate			1960	2037			
2nd salt sand	Red		2035	2110			
Slate			2110	2143			
Lime			2143	2207			
3rd salt sand	Red		2207	2218	Gas	2207-2215	
Slate			2218	2223			
Total depth			2223				

09/22/2023

Date... September 21st, 19...37

APPROVED THE MANUFACTURERS LIGHT & HEAT CO Owner

By Harry H. Fowler  
Land Dept. (Title) Office Mgr.



WEST VIRGINIA DEPARTMENT OF MINES  
OIL AND GAS DIVISION

WELL RECORD

Permit No. *Wet-158*

Oil or Gas Well *Gas*  
(Kind)

Company *The Manufacturers Light & Heat*  
 Address *800 Union Trust Bldg., Pittsburgh Pa.*  
 Farm *George Foland* Acres *83*  
 Location (waters) \_\_\_\_\_  
 Well No. *3547* Elev. *1387'*  
 District *Procter* County *Wetzel*  
 The surface of tract is owned in fee by *George Foland*  
 Address \_\_\_\_\_  
 Mineral rights are owned by \_\_\_\_\_  
 Address \_\_\_\_\_  
 Drilling commenced *7/21/37*  
 Drilling completed *8/16/37*  
 Date shot *Not shot* Depth of shot \_\_\_\_\_  
 Open Flow *3.4* /10ths Water in \_\_\_\_\_ Inch  
*2.4* /10ths Merc. in *2"* Inch  
 Volume *568.360* Cu. Ft.  
 Rock Pressure *28.5* lbs. *48* hrs.  
 Oil \_\_\_\_\_ bbls., 1st 24 hrs.  
 Fresh water *None* feet \_\_\_\_\_ feet  
 Salt water \_\_\_\_\_ feet \_\_\_\_\_ feet

Casing and Tubing	Used in Drilling	Left in Well	Packers
Size			
#6 Conductors	<i>16'</i>	<i>16'</i>	Kind of Packer <i>None</i>
13			
10	<i>622'-10"</i>	<i>622'-10"</i>	Size of _____
8 1/4	<i>1738'-0"</i>	<i>1738'-0"</i>	
6 5/8	<i>2207'-7"</i>	<i>2207'-7"</i>	Depth set _____
5 3/16			
3			Perf. top _____
2			Perf. bottom _____
Liners Used			Perf. top _____
			Perf. bottom _____

CASING CEMENTED \_\_\_\_\_ SIZE \_\_\_\_\_ No. FT. \_\_\_\_\_ Date \_\_\_\_\_  
 COAL WAS ENCOUNTERED AT *1111* FEET *24* INCHES  
*1212* FEET *24* INCHES FEET INCHES  
 FEET INCHES FEET INCHES

Formation	Color	Hard or Soft	Top	Bottom	Oil Gas or Water	Depth Found	Remarks
Red rock	Red		0	14			
Sand			14	50			
Slate			50	125			
Lime	Red		125	135			
Slate			135	235			
Red rock	Red		235	250			
Slate			250	260			
Red rock	Red		260	270			
Slate			270	310			
Lime			310	314			
Red rock	Red		314	384			
Slate			384	397			
Red rock	Red		397	456			
Slate			456	466			
Red rock	Red		466	483			
Slate			483	565			
Red rock	Red		565	575			
Lime			575	585			
Slate			585	625			
Lime			625	635			
Slate			635	640			
Red rock	Red		640	662			
Slate			662	710			
Lime			710	727			
Slate			727	730			
Red rock	Red		730	745			
Slate			745	815			Show of coal 825'
Sand			815	878			
Lime			878	890			
Slate			890	918			
Lime			918	940			
Red rock	Red		940	950			
Slate			950	985			
Lime			985	1015			
Red rock	Red		1015	1050			
Lime			1050	1106			
Slate			1106	1111			
Maple town coal	Black	Soft	1111	1113			
Slate			1113	1117			
Lime			1117	1152			
Slate			1152	1160			
Lime			1160	1170			
Slate			1170	1212			
Pitts. Coal	Black	Soft	1212	1214			
Slate			1214	1245			
Sand			1245	1260			
Red rock	Red		1260	1267			
Slate			1267	1285			
Sand			1285	1300			
Slate			1300	1350			
Red rock	Red		1350	1415			
Lime			1415	1420			
Red rock	Red		1420	1450			
Slate			1450	1493			
Red rock	Red		1493	1515			









B-3



STATE OF WEST VIRGINIA  
DEPARTMENT OF MINES  
OIL AND GAS DIVISION

*Littleton*

WELL RECORD

Permit No. WET 158-Redrill

Oil or Gas Well Gas  
(KIND)

Company THE MANUFACTURERS LIGHT AND HEAT CO.  
 Address 800 Union Trust Bldg., Pgh., Penna.  
 Farm Geo. Foland Acres 83  
 Location (waters) \_\_\_\_\_  
 Well No. 3547 Elev. 1387'  
 District Proctor County Wetzel  
 The surface of tract is owned in fee by \_\_\_\_\_  
 Address \_\_\_\_\_  
 Mineral rights are owned by \_\_\_\_\_  
 Address \_\_\_\_\_  
 Drilling commenced November 1, 1952  
 Drilling completed February 15, 1954  
 Date Shot \_\_\_\_\_ From \_\_\_\_\_ To \_\_\_\_\_  
 With \_\_\_\_\_  
 Open Flow 5.6/10ths Water in 1 1/2 Inch  
 \_\_\_\_\_ /10ths Merc. in \_\_\_\_\_ Inch  
 Volume 131,968 Cu. Ft.  
 Rock Pressure 168 lbs. 56 hrs.  
 Oil \_\_\_\_\_ bbls., 1st 24 hrs.  
 Fresh water \_\_\_\_\_ feet \_\_\_\_\_ feet  
 Salt water \_\_\_\_\_ feet \_\_\_\_\_ feet

Casing and Tubing	Used in Drilling	Left in Well	Packers
Size			
16			Kind of Packer _____
13			
10		607'2"	Size of _____
8 1/4		1702'4"	
6 5/8			Depth set _____
5 3/16		2215'9"	
3			Perf. top _____
2			Perf. bottom _____
Liners Used _____			Perf. top _____
			Perf. bottom _____

CASING CEMENTED \_\_\_\_\_ SIZE \_\_\_\_\_ No. Ft. \_\_\_\_\_ Date \_\_\_\_\_

COAL WAS ENCOUNTERED AT \_\_\_\_\_ FEET \_\_\_\_\_ INCHES  
 \_\_\_\_\_ FEET \_\_\_\_\_ INCHES \_\_\_\_\_ FEET \_\_\_\_\_ INCHES  
 \_\_\_\_\_ FEET \_\_\_\_\_ INCHES \_\_\_\_\_ FEET \_\_\_\_\_ INCHES

Formation	Color	Hard or Soft	Top	Bottom	Oil, Gas or Water	Depth Found	Remarks
Top of Maxon Sand			2200	Schlumberger Measurement			
Bottom of Maxon Sand			2212				
Lead Plug			2208				
Total Depth			2208	Casing Centralizers set at following depths from bottom			
				1 - 61'2"			
				2 - 157'3"			
				3 - 411'9"			
				4 - 623'10"			
				5 - 872'4"			
				6 - 1506'5"			
				7 - 2105'9"			

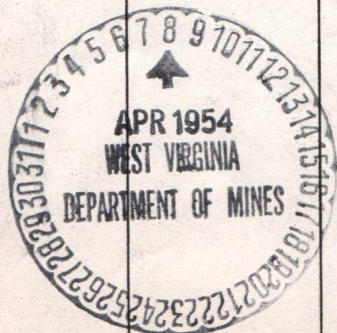

09/22/2023



B-8

FORM OG 9

STATE OF WEST VIRGINIA  
DEPARTMENT OF MINES  
OIL AND GAS DIVISION

NOTICE OF INTENTION TO PLUG AND ABANDON WELL

(REQUIRED BY SECTION 9, ARTICLE 4, CHAPTER 22 OF THE CODE)

To THE DEPARTMENT OF MINES,  
Charleston, W. Va.

Miss Beatrice Yeater  
COAL OPERATOR OR COAL OWNER  
Virginia Street  
New Martinsville, W. Va.

ADDRESS

COAL OPERATOR OR COAL OWNER

ADDRESS

LEASE OR PROPERTY OWNER

ADDRESS

The Manufacturers Light & Heat Co

NAME OF WELL OPERATOR  
800 Union-Trust Building  
Pittsburgh, Pennsylvania

COMPLETE ADDRESS

October 22, 1943 194

WELL TO BE ABANDONED

Procter District

Wetzel County

Well No. 3547 (2)

George Foland Farm

NOTE: If plugging cannot begin on the date specified below, please notify Herbert A. Sumney, Inspector Oil & Gas Wells, C/O Gore Hotel, Clarksburg, or notify Department of Mines, Oil & Gas Division, telephone 346741.

Gentlemen:—

The undersigned well operator is about to abandon the above described well and will commence

the work of plugging and abandoning said well on the 1st. day of November, 194 3,  
(which date shall not be less than five days after the day on which this notice so mailed is received,  
or in due course should be received by the Department of Mines.)

This notice is given you in order that your respective representatives may be present at the plugging and filling of said well. You are further notified that whether you are represented or not represented the undersigned will proceed on that date, or shortly thereafter, to plug and fill said well in the manner required by Section 10, Article 4, Chapter 22 of the Code and given in detail on the reverse side of this notice, in "Work Order."

This notice is being mailed by registered mail to each of you at the above addresses on the above date.

Very truly yours,

THE MANUFACTURERS LIGHT & HEAT COMPANY,

*Harry H. Fowler*  
Land Dept. Office Mgr. Well Operator.



09/22/2023

NOTE: Upon the abandonment of all wells drilled prior to June 1, 1929, a plat prepared by a competent engineer, showing the district and county in which the tract of land is located, the name and acreage of same, the names of the owners and adjacent tracts, and the location of the about to be abandoned well, determined by survey, and the courses and distances of such well from two permanent points or landmarks on said tract, shall be submitted with this notice.

(Over)

WET - 158-P PERMIT NUMBER



B-9

PROPOSED MANNER OF PLUGGING AND FILLING WELL

(REQUIRED BY RULES AND REGULATIONS)

WEST VIRGINIA DEPARTMENT OF MINES

OIL AND GAS DIVISION

WORK ORDER

Well to be plugged and filled as follows:

Total Depth.	2223	
Clay	2223 - 2207	
Wood Plug	2207 - 2204	Lift 6 5/8" Casing
Clay	2204 - 1960	
Wood Plug	1960 - 1957	
Clay	1957 - 1740	
Wood Plug	1740 - 1737	Lift 8 1/4" Casing
Bridge at	1250	
Clay	1250 - 1244	
Cement	1244 - 1192	Sealing Pgh. Coal. 30' below to 20' above
Clay	1192 - 1133	
Cement	1133 - 1086	Sealing Mapletown Coal 30' below to 20' above
Bridge	1086 630	<i>bridges not permitted above coal seams,</i>
Clay	630 - 622	Lift 10" Casing
Clay	622	To Surface

Ercet Monument as per Rule #13

To the Department of Mines  
Coal Owner or Operator,  
Lease or Property Owner.

Gentlemen:

This "work order" is submitted for your approval and concurrence and unless notified of your disapproval or non-concurrence, the undersigned will proceed with the plugging and filling of said well in the above described manner on the date stated in the notice of intention to plug and abandon the said well on opposite side of this sheet.

Very truly yours,

THE MANUFACTURERS LIGHT & HEAT COMPANY,  
*Sam H. Fowler*  
Land Dept. Office Mgr. Well Operator.

No objections have been filed by the coal owner or coal operator, or any available adjacent lease or property owners or interposed by the Department of Mines to the manner herein described for the plugging and filling of the well above mentioned. Therefore, the same is hereby approved this

3d day of November, 1943

09/22/2023

DEPARTMENT OF MINES  
Oil and Gas Division

By: \_\_\_\_\_

NOTE: This "work order" shall be filed in triplicate, one copy for the files of the Department of Mines; one to be approved or corrected and returned to the well operator as his authority for plugging said well; and one for the well inspector.



B-10

FORM OG-8



STATE OF WEST VIRGINIA  
DEPARTMENT OF MINES  
OIL AND GAS DIVISION

AFFIDAVIT OF PLUGGING AND FILLING WELL

AFFIDAVIT SHOULD BE MADE IN TRIPPLICATE, ONE COPY MAILED TO THE DEPARTMENT, ONE COPY TO BE RETAINED BY THE WELL OPERATOR AND THE THIRD COPY (AND EXTRA COPIES IF REQUIRED) SHOULD BE MAILED TO EACH COAL OPERATOR AT THEIR RESPECTIVE ADDRESSES.

Miss Beatrice Yeater  
COAL OPERATOR OR OWNER  
Virginia St., New Martinsville, WVa.  
ADDRESS  
COAL OPERATOR OR OWNER  
ADDRESS  
LEASE OR PROPERTY OWNER  
ADDRESS

The Manufacturers Light & Heat Co.,  
NAME OF WELL OPERATOR  
800 Union Trust Building,  
Pittsburgh Pa.  
COMPLETE ADDRESS  
Feb. 29th. 1944 194  
WELL AND LOCATION  
Proctor District  
Wetzel County  
Well No. 3547 (2)  
George Foland Farm

STATE INSPECTOR SUPERVISING PLUGGING

AFFIDAVIT

STATE OF WEST VIRGINIA,  
County of Wetzel } SS:

William C. Moffitt and Ralph Montgomery  
being first duly sworn according to law depose and say that they are experienced in the work of plugging and filling oil and gas wells and were employed by The Manufacturers Light & Heat Co., well operator, and participated in the work of plugging and filling the above well, that said work was commenced on the 17th day of November, 1945, and that the well was plugged and filled in the following manner:

SAND OR ZONE RECORD FORMATION	FILLING MATERIAL			PLUGS USED SIZE & KIND	CASING	
	CONTENT	FROM	TO		CSG PULLED	CSG LEFT IN
	Clay	2223	2207		6 5/8"	
	Wood plug	2207	2204	6 5/8" Wood	<del>627'-4"</del>	<del>351'-3"</del>
	Clay	2204	1960		2189'-2"	38'-5"
	Wood plug	1960	1957	8 1/2" Wood	8 1/2"	
	Clay	1957	1740		1292'-4"	471'-2"
	Wood plug	1740	1737	8 1/2" Wood		
	Bridged	1250			10"	
	Clay	1250	1244		627'-4"	15'-3"
	Cement	1244	1192			
	Clay	1192	1133			
	Cement	1133	1088			
	Clay	1088	to Surface			
COAL SEAMS	DESCRIPTION OF MONUMENT					
(NAME) Pitts Coal	Cement	1244	1192	Monument erected as per rule # 18.		
(NAME) Mapletown Coal	Cement	1133	1088			
(NAME)						
(NAME)						

and that the work of plugging and filling said well was completed on the 14th day of January, 1944.

And further deponents saith not.

Sworn to and subscribed before me this 2nd day of March, 1944.

My commission expires:

Feb 4<sup>th</sup> 1946

JARRETT PRINTING COMPANY, CHARLESTON, W. VA.

*William C. Moffitt*  
*Ralph Montgomery*  
*[Signature]*

Notary Public.

Permit No. WET - 158 - P

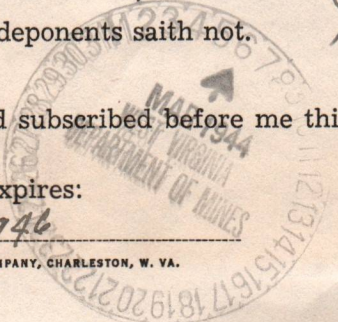





STATE OF WEST VIRGINIA  
DEPARTMENT OF MINES  
OIL AND GAS DIVISION

AFFIDAVIT OF PLUGGING AND FILLING WELL

AFFIDAVIT SHOULD BE MADE IN TRIPLICATE. ONE COPY MAILED TO THE DEPARTMENT ONE COPY TO BE KEPT BY THE AFFIDAVIT MAKER AND THE THIRD COPY (AND EXTRA COPIES IF REQUIRED) SHOULD BE KEPT BY EACH LOCAL OFFICE AT THEIR RESPECTIVE OFFICES.

MISS BEATRICE YACOP  
LOCAL OPERATOR OR OWNER  
Virginia St., New Martinsville, W. Va.  
ADDRESS

The Manufacturers Light & Heat Co.,  
300 Union Trust Building,  
Martinsburg, W. Va.  
LOCAL OPERATOR OR OWNER

Geo. Poland  
Wm No. 557 (s)  
Wetzel  
Wetzel  
Wetzel

AFFIDAVIT

STATE OF WEST VIRGINIA

County of Wetzel

William C. Morris

Edwin Montgomery

I, the undersigned, do hereby swear according to law and say that they are conversant with the work of plugging and filling oil and gas wells and were employed by The Manufacturers Light & Heat Co., W. Va. and participated in the work of plugging and filling the above well and that the well was plugged and filled on the 17th day of November, 1933.

DATE OF RECORD	CONTENTS	FILLING MATERIAL		PLUG DATE	WELL NO.
		TO	FROM		
	Clay	2225	2207		6 5/8"
	Wood plug	2207	2201		6 5/8" wood
	Clay	2201	1900		6 5/8"
	Wood plug	1900	1871		6 5/8" wood
	Clay	1871	1710		6 5/8"
	Wood plug	1710	1707		6 5/8" wood
	Etched	1250			10"
	Clay	1250	1241		6 5/8"
	Cement	1241	1192		
	Clay	1192	1133		
	Cement	1133	1088		
	Clay	1088	1000 to surface		
	Cement	1241	1192		
	Cement	1133	1088		

09/22/2023



E-4

February 23, 1944

Mr. Harry H. Fowler, Office Manager  
The Manufacturers Light & Heat Company  
800 Union Trust Building  
Pittsburgh, Pennsylvania

Dear Mr. Fowler:

Inspector Sumney of the Northern District reports that he is unable to obtain the cooperation of your Hundred, West Virginia office in notifying him when plugging operations will begin.

A specific instance that occurred recently was the George and Mary Poland Well No. 2, serial 3547, Proctor District, Wetzel County. In December, Mr. Sumney reports he was at the well but at that time it was doubtful that the well would be plugged and the foreman at Reader, West Virginia promised to have Mr. Harry Moore advise him later if the well would be plugged if cleaning out operations determined it would be necessary. Mr. Sumney reports that he heard nothing further about the well and again called at the Hundred office on January 17 and learned that filling and plugging was completed to 400 feet.

This may have been an oversight in this particular case but the Inspector reports that the Hundred office consistently fails to notify him of the beginning date on plugging operations and we believe this matter should be brought to your attention.

The Department is willing to cooperate to the fullest extent with all the operators in the State and we would appreciate having the same courtesy extended to us by your field men. The Inspector is obligated to the Department to inspect all plugging operations since this is a provision of the Law and he is merely doing his duty when he requests that the proper date be given him when operations do not begin at the time set forth on the work order.

Thank you kindly for your attention to this matter.

Very truly yours,

Secretary  
OIL AND GAS DIVISION

MG/jh

09/22/2023







E-6



Mumms  
Sat - evening

Dear Annie -

Will you please advise  
the Manufacturers L. & H. Co  
in Pittsburgh by letter  
of my complaint on their  
permit - Net. 158-P - Geo. Toland  
# 2 (354/7).

Some time (please get  
date from my report on file)  
prior to 12-28-43 - I was advised  
by their foreman at Reader-Wra  
that after cleaning out - they  
would run a test. He promised  
to advise me through Mr.  
Harry Moore - Field Supt. or  
direct as to whether it would  
be produced or plugged. Hearing  
nothing one way or another  
I called at the Standard office  
on Jan. 17-'44 and they reported  
plugging operations going on at  
400'.

also the Standard office  
has consistently failed to notify  
me of starting dates. Please  
advise <sup>them</sup> of this complaint.

Thanks  
Hess

09/22/2023



09/22/2023



E-1

February 29, 1944

Mr. Herbert A. Sumney  
c/o Gore Hotel  
Clarksburg, West Virginia

Dear Mr. Sumney:

Enclosed is a copy of The Manufacturers  
Light and Heat Company's letter of February 25 in reply  
to ours of the 23d regarding your complaint.

Very truly yours,

Secretary  
OIL AND GAS DIVISION

MG:K  
Encl.

09/22/2023



E-9

September 4, 1953

The Manufacturers Light & Heat Company  
800 Union Trust Building  
Pittsburgh, Pennsylvania

Gentlemen:

Enclosed is permit WET-158-Redrill for  
reopening Well No. 2-3547 on the George & Mary Poland Farm,  
Proctor District, Wetzel County.

Very truly yours,

Administrative Assistant  
OIL AND GAS DIVISION

MG:g  
encl

cc: Mr. D. F. Desist, Inspector  
Mr. R. C. Tucker, Assistant State  
Geologist

09/22/2023



E-8

April 12, 1954

The Manufacturers Light & Heat Company  
800 Union Trust Building  
Pittsburgh 19, Pennsylvania

RE: Lease 26468, Well 2-3547  
Proctor District  
Wetzel County, West Virginia

Gentlemen:

The correct permit number for drilling the above well, is WET-158. Your letter of April 7 enclosing well record for the well, gave the permit number, WET-148. Please correct your files accordingly.

Very truly yours,

Administrative Assistant  
OIL AND GAS DIVISION

MG:g

Company THE MANUFACTURERS LIGHT AND HEAT CO.

Address 800 UNION TRUST BLDG., PITTSBURGH, PA.

Farm GEORGE AND MARY FOLAND

Tract \_\_\_\_\_ Acres 83 Lease No. 4918

Well (Farm) No. 2 Serial No. 3547

Elevation (Spirit Level) 1387'

Quadrangle LITTLETON

County WETZEL District PROCTOR

Engineer John A. Laudon

Engineer's Registration No. \_\_\_\_\_

File No. \_\_\_\_\_ Drawing No. Y-7-674

Date MAY 20 1937 Scale 1"=500'

STATE OF WEST VIRGINIA  
DEPARTMENT OF MINES  
OIL AND GAS DIVISION  
CHARLESTON

WELL LOCATION MAP  
FILE NO. WET-158 09/22/2023

+ Denotes location of well on United States Topographic Maps, scale 1 to 62,500, latitude and longitude lines being represented by border lines as shown.

- Denotes one inch spaces on border line of original tracing.



09/22/2023







09/22/2023