



STATE OF WEST VIRGINIA
DEPARTMENT OF MINES
OIL AND GAS DIVISION

NOTICE OF PROPOSED LOCATION OF OIL AND GAS WELL

To The Department of Mines,
Charleston, W. Va.

NAME OF WELL OPERATOR <u>Hope Natural Gas Company</u>	COAL OPERATOR OR COAL OWNER <u>No coal operations in vicinity</u>
COMPLETE ADDRESS <u>448 West Main St., Charleston, W. Va.</u>	ADDRESS _____
PROPOSED LOCATION <u>December 2, 1942</u>	COAL OPERATOR OR COAL OWNER _____
District <u>Grant</u>	ADDRESS <u>_____</u>
County <u>Putnam</u>	OWNER OF MINERAL RIGHTS <u>E. J. Milroye</u>
Well No. <u>8847</u>	ADDRESS <u>Smithfield, W. Va.</u>
Farm <u>E. J. Milroye</u>	_____

BOOK 34 A PAGE 155
OF 6 ENTERED 1940 IN THE OFFICE OF THE COUNTY CLERK FOR SAID COUNTY IN
_____ DAY _____ AND RECORDED ON THE 2 DAY
_____ MADE BY E. J. Milroye (single) TO
OIL AND GAS HAVING THE TITLE HERETO, (OR AS THE CASE MAY BE) UNDER GRANT OR LEASE DATED
_____ THE UNDERSIGNED WELL OPERATOR IS ENTITLED TO DRILL UPON THE ABOVE NAMED FARM OR TRACT OF LAND FOR

COAL OPERATIONS. THE UNDERSIGNED WELL OPERATOR IS INFORMED AND BELIEVES THERE ARE NO COAL OPERATIONS OPERATING BEHIND OF COAL BENEATH SAID FARM OR TRACT OF LAND ON WHICH SAID WELL IS LOCATED, OR WITHIN 500 FEET OF THE BOUNDARIES OF THE SAME, WHO HAVE MAPPED THEIR WORKINGS AND FILED THEIR MAPS AS REQUIRED BY LAW, EXCEPTING THE COAL OPERATORS OR COAL OWNERS (IF ANY) ABOVE NAMED AS ADDRESSEES.

THE ABOVE NAMED COAL OPERATORS OR COAL OWNERS (IF ANY) ARE NOTIFIED THAT ANY OBJECTIONS THEY MAY DESIRE TO MAKE TO SAID PROPOSED LOCATION, OR WHICH THEY ARE REQUIRED TO MAKE BY SECTION 3 OF SAID CODE, IF COAL MINES MUST BE RECEIVED BY OR FILED WITH THE DEPARTMENT OF MINES WITHIN TEN DAYS FROM THE RECEIPT OF A COPY OF THIS NOTICE AND ACCOMPANYING PLAN BY SAID DEPARTMENT. SAID COAL OPERATORS ARE FURTHER NOTIFIED THAT FORMS FOR USE IN MAKING SUCH OBJECTIONS WILL BE FURNISHED TO THEM BY THE DEPARTMENT OF MINES PROMPTLY ON REQUEST AND THAT ALL SUCH OBJECTIONS MUST SET FORTH AS DEFINITELY AS IS REASONABLY POSSIBLE THE GROUNDS OR GROUNDS ON WHICH SUCH OBJECTIONS ARE BASED AND INDICATE THE DIRECTION AND DISTANCE THE PROPOSED LOCATION SHOULD BE MOVED TO OVERCOME SAME.

(THE NEXT PARAGRAPH IS TO BE COMPLETED ONLY IN DEPARTMENT'S COPY.)
COPIES OF THIS NOTICE AND THE ENCLOSED PLAN WERE MAILED BY REGISTERED MAIL, OR DELIVERED TO THE ABOVE NAMED COAL OPERATORS OR COAL OWNERS AT THEIR ABOVE SHOWN RESPECTIVE ADDRESSES _____ DAY BEFORE _____ OR ON THE SAME DAY WITH THE MAILING OR DELIVERY OF THIS COPY TO THE DEPARTMENT OF MINES AT CHARLESTON, WEST VIRGINIA.

Very truly yours,
Hope Natural Gas Company
WELL OPERATOR

448 West Main St.
STREET
Charleston
CITY OR TOWN
West Virginia
STATE

Address of Well Operator

10/06/2023

SECTION 3 If no such objections be filed or be found by the department of mines within said period of ten days from the receipt of said notice and plan by the department of mines, to said proposed location, the department shall forthwith issue to the well operator a drilling permit, reserving the thing of such plan that no objections have been made by the coal operators to the location, or found made by the department, and that the same is approved and the well operator authorized to proceed to drill at said location.

A-10

December 13, 1943

Hope Natural Gas Company
445 West Main Street
Clarksburg, West Virginia

Gentlemen:

The following permits are enclosed:

WET-300 to drill well No. 8845 on the James M.
Allen Farm, Grant District, Wetzel County, is enclosed.

WET-301 to drill well No. 8847 on the S. J.
Kilcoyne Farm, Grant District, Wetzel County.

Very truly yours,

Secretary
OIL AND GAS DIVISION

MG/jh
enc-4

CC: Inspector Herbert A. Sumney

10/06/2023

B-1
Littleton



STATE OF WEST VIRGINIA
DEPARTMENT OF MINES
OIL AND GAS DIVISION

WELL RECORD

Permit No. WET- 301

Oil or Gas Well
(KIND)

Company Hope Natural Gas Company
 Address 445 West Main St. Clarksburg, W. Va.
 Farm S. J. Kilcoyne Acres 180
 Location (waters) _____
 Well No. 8847 Elev. 935
 District Grant County Wetzel
 The surface of tract is owned in fee by _____
 Address _____
 Mineral rights are owned by _____
 Address _____
 Drilling commenced December 28, 1943
 Drilling completed January 11, 1944
 Date Shot _____ From _____ To _____
 With _____
 Open Flow 10/10ths Water in 1"EM Inch
 _____ /10ths Merc. in _____ Inch
 Volume _____ Cu. Ft.
 Rock Pressure _____ lbs _____ hrs.
 Oil _____ bbls., 1st 24 hrs.
 Fresh water 5 feet 50 feet
 Salt water _____ feet _____ feet

Casing and Tubing	Used in Drilling	Left in Well	Packers
Size			Kind of Packer
16			
13			
10			Size of
8 3/4	30	30	
6 3/4	192	43	Depth set
5 3/16	612	612	
3			Perf. top
2			Perf. bottom
Liners Used			Perf. top
			Perf. bottom

CASING CEMENTED 5 3/16" Cemented show No. Ft. _____ Date _____
 COAL WAS ENCOUNTERED AT 647 FEET _____ INCHES
550 FEET 48 INCHES FEET _____ INCHES
 _____ FEET _____ INCHES FEET _____ INCHES

Formation	Color	Hard or Soft	Top	Bottom	Oil, Gas or Water	Depth Found	Remarks
Gravel			0	10	water	5	
Slate			10	40	water		
Lime			40	75	water	50	
Slate			75	100			
Red rock			100	110			
Lime			110	125			
Slate			125	150			
Lime			150	200			
Slate			200	225			
Lime			225	240			
Sand			240	300			
Slate			300	325			
Lime			325	345			
Sand			345	375			
Slate			375	435			
Lime			435	550			
Coal			550	554			
Slate			554	580			
Lime			580	620			
Slate			620	624			
Lime			624	642			
Slate			642	648			
PITTSBURGH COAL			647		gas	648- 651	
Total depth				651			

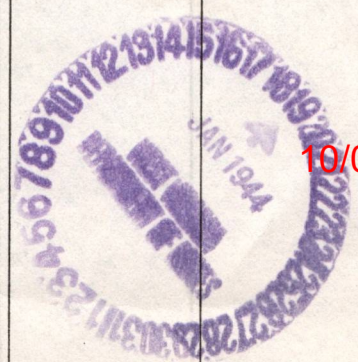

10/06/2023

Record of Hope Natural Gas Company

Acres 180

Well No. 8347 Lease No. 53633 Name S. J. Kilcoyne District Littleton
 District Grant Elev. 933 County Squares Wetzel State West Virginia
 Location Made November 26, 1943 First Work Done November 26, 1943
 Rig Commenced Used spudding Machine Rig Completed _____
 Drilling Commenced December 28, 1943 Drilling Completed January 11, 1944
 Rig Contractor Used spudding machine (Drilling Contractor Hope Natural Gas Company)
 (If H. N. G. Co. Tools, String No.) _____
 Drillers Wm. A. Swiger, Setha Bane, S. H. Showalter Tool Dressers John Adams, H. P. Stroanider, George H. Williams

FORMATION	Open or Close Hard or Soft	TOP	BOTTOM	Steel Line Measurement	Water Found Depth	Oil Found Depth	Gas Found Depth	REMARKS
Gravel		0	10		5			
Slate		10	40		50			
Lime		40	75					
Slate		75	100					
Red Rock		100	110					
Lime		110	125					
Slate		125	150					
Lime		150	200					
Slate		200	225					
Lime		225	240					
Sand		240	300					
Slate		300	325					
Lime		325	345					
Sand		345	375					
Slate		375	435					
Lime		435	550					
Coal		550	554					
Slate		554	580					
Lime		580	620					
Slate		620	624					
Lime		624	642					
Slate		642	648					
Pittsburgh Coal		647	651				648-651	
Total Depth			651					

SIZE	Charged to Well		Put in Well		Pulled Out		Left in Well		Transferred Before Completing		Left at Well Not in Use		Steel Line Measurement		If more than two strings of c are left in hole, give reasons for ing additional strings.
	Feet	In.	Feet	In.	Feet	In.	Feet	In.	Feet	In.	Feet	In.	Feet	In.	
13" Csg.															
10" "															
8 1/4" "	30	0	30		None		30	0	-		-		-		
6 5/8" "	259	0	192		149	0	43	0	216	0	None		Unable to pull 43 feet		
5 1/8" "	717	0	614		None		614		103	0	None		612 0		
Tbg.															

PACKER RECORD

SIZE	KIND	Amount Anchor	Amount Above Anchor	REMARKS
5-3/16	Run with steel shoe on bottom and set in 200 lbs. cement			

SHOOTING RECORD (IF SHOT BEFORE OR UPON COMPLETION OF WELL)

DATE	Quarts	Top of Shell	Bottom of Shell	Diameter	Sand	TEST BEFORE SHOT			TEST AFTER SHOT			Test Taken After Shot No. Hours	By Whom Shot
						Reading	Liquid	Opening	Reading	Liquid	Opening		

CEMENTING RECORD

10/06/2023

Date Cemented..... Size Hole Cemented..... Size Casing Cemented.....
 Top Pittsburgh Coal..... Top Cementing..... Amount Cement Used.....
 Bottom Pittsburgh Coal..... Bottom Cementing..... Amount Sand Used.....
 Mr. _____ of _____ Coal Company on ground when coal was cemented
 Remarks New gas well producing from Pittsburgh Coal Signature of persons who cemented well

1.0 API well number: (If not available, leave blank. 14 digits.)	47-103-00301		
2.0 Type of determination being sought: (Use the codes found on the front of this form.)	108 Section of NGPA	Category Code	
3.0 Depth of the deepest completion location: (Only needed if sections 103 or 107 in 2.0 above.)	_____ feet		
4.0 Name, address and code number of applicant: (35 letters per line maximum. If code number not available, leave blank.)	Consolidated Gas Supply Corporation Name 445 West Main Street Street Clarksburg WV 26301 City State Zip Code		004228 Seller Code
5.0 Location of this well: [Complete (a) or (b).] (a) For onshore wells (35 letters maximum for field name.)	Grant Field Name Wetzel WV County State		
(b) For OCS wells:	Area Name _____ Block Number _____ Date of Lease: _____ Mo. Day Yr. OCS Lease Number _____		
(c) Name and identification number of this well: (35 letters and digits maximum.)	S. J. Kilcoyne WN-8847		
(d) If code 4 or 5 in 2.0 above, name of the reservoir: (35 letters maximum.)	_____		
6.0 (a) Name and code number of the purchaser: (35 letters and digits maximum. If code number not available, leave blank.)	General System Purchasers Name		Buyer Code
(b) Date of the contract:	_____ Mo. Day Yr.		
(c) Estimated annual production:	6 MMcf		
7.0 Contract price: (As of filing date. Complete to 3 decimal places.)	(a) Base Price (\$/MMBTU)	(b) Tax	(c) All Other Prices (Indicate (+) or (-).)
8.0 Maximum lawful rate: (As of filing date. Complete to 3 decimal places.)	3.217	_____	_____
9.0 Person responsible for this application:	T. A. Kuhn Name <i>T A Kuhn</i> Signature		V. P. Gas Supply Title
Agency Use Only	3-18-1982 Date Application is Completed		304 623-8000 Phone Number
Date Received by Juris. Agency	MAR 24 1982		
Date Received by FERC			

PARTICIPANTS:

DATE: JUL 29 1982

BUYER-SELLER CODE

WELL OPERATOR: Consolidated Gas Supply Corp.

004228

FIRST PURCHASER: General System Purchasers

OTHER:

W. Va. Department of Mines, Oil & Gas Division
WELL DETERMINATION FILE NUMBER
820324-108-103-0301
Use Above File Number on all Communications
Relating to Determination of this Well

QUALIFIED

CHECK EACH ITEM AS COMPLETE OR NOTE WHAT IS MISSING

ITEM NO.

- 1. FERC -121 [check] Items not completed - Line No. All 7.0 b, c, d 8.0
2. IV-1 Agent T. A. Kuhn
3. IV-2 Well Permit
4. IV-6 Well Plat [check]
5. IV-35 Well Record [check] Drilling [check] Deepening
6. IV-36 Gas-Oil Test: Gas Only Was Oil Produced? Ratio
7. IV-39 Annual Production 1 year
8. IV-40 90 day Production 90 Days off line:
9. IV-48 Application for certification. Complete? [check]
10-17. IV Form 51 - 52 - 53 - 54 - 55 - (56) - 57 - 58 Complete? [check] Affidavit Signed [check]
18-28. Other: Survey Logs Geological Charts
Structure Map 1: 4000 Map Well Tabulations
Gas Analyses
(5) Date commenced: 12-28-43 Date completed 1-11-44 Deepened
(5) Production Depth: 648-51
(5) Production Formation: Pittsburgh Coal
(5) Final Open Flow: NA
(5) After Frac. R. P. NA
(6) Other Gas Test:
(7) Avg. Daily Gas from Annual Production: 5579 / 360 = 15.5 MCF
(8) Avg. Daily Gas from 90-day ending w/1-120 days 1328 / 90 = 14.8 MCF
(8) Line Pressure: NA PSIG from Daily Report
(5) Oil Production: From Completion Report
0-17. Does lease inventory indicate enhanced recovery being done Yes
0-17. Is affidavit signed? [check] Notarized? [check]
Does official well record with the Department confirm the submitted information? No Yes
Additional information Does computer program confirm?
As Determination Objected to By Whom?

Describe the search made of any records listed above:

As indicated, Applicant's primary oil and gas production records have been largely computerized. In preparing this application, Applicant, by use of its computers, generated a listing of those of its wells which produced non-associated natural gas at a rate not exceeding an average of 60 MCF per production day (at maximum efficient rates of flow) during the 90 day production period indicated on the attachment. These listings were checked and verified manually by two or more Applicant's employees. The results of this diligent search and examination indicated that the well which is the subject of this application qualifies as a stripper well; see attached data submitted in compliance with applicable regulations of this agency and the Federal Energy Regulatory Commission.

Are you aware of other information which would tend to be inconsistent with the information specified above? Yes ___ No X. If yes, indicate the type and source of the information.

AFFIDAVIT

I, T. A. Kuhn, having been first sworn according to law, state that I have caused to be made a diligent search of those records hereinbefore indicated in the manner herein described, that the information contained in this document is true and accurate and that on the basis of the records and examinations hereinbefore described, and to the best of my information, knowledge and belief, the well for which this certification is sought qualifies as a stripper well.

T. A. Kuhn
Vice President, Appalachian Gas Supply

STATE OF WEST VIRGINIA,

COUNTY OF HARRISON, TO WIT:

I, J. P. Greene, a Notary Public in and for the state and county aforesaid, do certify that T. A. KUHN, whose name is signed to the writing above, bearing date the 18 date of March, 1982 has acknowledged the same before me, in my county aforesaid.

Given under my hand and official seal this 18 day of March, 1982.

My term of office expires on the 20 day of May, 1988.

J. P. Greene
Notary Public
In and for the State of West Virginia

(NOTARIAL SEAL)

10/06/2023

STATE OF WEST VIRGINIA
DEPARTMENT OF MINES, OIL AND GAS DIVISION

Date March 18, 1982

Operator's
Well No. 8847

WELL CLASSIFICATION FORM

API Well
No. 47 103 00301
State County Permit

STRIPPER GAS WELL

NGPA Section 108

DESIGNATED AGENT T. A. Kuhn

ADDRESS 445 West Main Street
Clarksburg, WV 26301

WELL OPERATOR Consolidated Gas Supply Corp.

ADDRESS 445 West Main Street
Clarksburg, W. Va. 26301

GAS PURCHASER None - gas is delivered

ADDRESS into Applicant's interstate
pipeline system

LOCATION: Elevation 933'

Watershed Quad

Dist. Grant County Wetzel

Gas Purchase Contract NO. N/A

Meter Chart Code N/A

Date of Contract N/A

* * * * *

Provide a complete inventory of the lease and production equipment used for the well for the previous 24 months or, if less than 24 months, the period the well has been in production. Include a complete list of equipment or processes used in connection with recognized enhanced recovery techniques during completion or production. (Attach separate sheets, if necessary)

See attachment; compression, dehydration, or related equipment indicated on the attached inventory, and hydraulic fracturing, shooting, or similar completion processes indicated on the attached well records, are used in connection with recognized enhanced recovery techniques during production or completion.

List all records reasonably available to you which contain information relevant to a determination of eligibility (including production records, B&O Tax Records and royalty payment records) and indicate the location of such records:

Applicant's oil and gas production records (which are largely computerized) constitute its primary and most reliable source of information relevant to a determination of eligibility. From these records, Applicant derives information used by it in connection with royalty payments, tax payments, and general statistical uses, and records of these matters are also maintained. All of the above records are located at Applicant's offices at 445 West Main Street, Clarksburg, West Virginia.

10/06/2023

STATE OF WEST VIRGINIA
DEPARTMENT OF MINES, OIL AND GAS DIVISION

Date March 18, 1982
Operator's
Well No. 8847

API Well
No. 47 103 00301
State County Permit

STATE APPLICATION FOR WELL CLASSIFICATION

Previous File No. _____
(If Applicable)

WELL OPERATOR Consolidated Gas Supply Corp.
ADDRESS 445 West Main Street
Clarksburg, West Virginia 26301

DESIGNATED AGENT T. A. Kuhn
ADDRESS 445 West Main Street
Clarksburg, West Virginia 26301

Gas Purchase Contract No. N A and Date _____
(Month, day and year)

Meter Chart Code N A

Name of First Purchaser None; gas is delivered into applicant's
interstate pipeline system
(Street or P. O. Box)

FERC Seller Code 004228 (City) (State) (Zip Code)
FERC Buyer Code _____

TYPE OF DETERMINATION BEING SOUGHT:

- (1) Initial determination (See FERC Form 121.) 108
Section of NPGA Category Code
- (2) Determination that increased production is the result of enhanced recovery technology.
- (3) Determination of a seasonally affected well.

T. A. Kuhn V.P. Gas Supply
Name (Print) Title
T. A. Kuhn
Signature
445 West Main Street
Street or P. O. Box
Clarksburg, WV 26301
City State (Zip Code)
(304) 622-8000
Area Code Phone Number

(Certificate of Proof of Service to Purchaser)

CERTIFICATE OF SERVICE

This will certify that Applicant has served a complete copy of this document and attachments thereto, if any, including FERC Form 121, properly addressed and with postage prepaid upon the identified purchaser, if any, of the natural gas which is the subject of this application.

(All of the above to be completed by the Operator/Applicant)

(To be completed by Jurisdictional Agency. Executed copy to be returned to Operator/Applicant and purchaser, if known).

The Department of Mines has received a request, [] for certification of the above described well as meeting the requirements of Section _____ under the Natural Gas Policy Act of 1978. (NGPA); [] or for determination that increased production is the result of enhanced recovery technology under Section 108 of (NGPA); [] or for determination of a seasonally affected well under Section 108 of (NGPA).

All interested parties are hereby notified that on the _____ day of _____, 19____, at the office of the Oil and Gas Division in Charleston, West Virginia, or as soon thereafter as it may be heard, there will be a public hearing, if requested, or if objection is filed.

This Application is assigned File No. _____.

Initial review of information submitted indicates the well [] is, [] is not entitled to certification as claimed under the Natural Gas Policy Act (NGPA). A review of this evidence and any additional evidence will be made at the time appointed for a public hearing or as soon thereafter as the matter may be heard.

Unless objections are timely filed or a request for a hearing is made within fifteen (15) days, a hearing will not be held except on ex parte motion of the department and the matter will go to determination.

WEST VIRGINIA DEPARTMENT OF MINES **10/06/2023**

MAR 24 1982

Date Received By
Jurisdictional Agency

By T. A. Kuhn
Title _____

WPI NUMBER 47-103-0301
 WELL NUMBER 8847

WELL NAME S. J. Kilcoyne

COUNTY & STATE Wetzel Co. WV

OPERATOR CGSC

3 MONTH AVERAGE 15

12 MONTH AVERAGE 16

YEAR 19	JAN.	FEB.	MAR.	APR.	MAY	JUN.	JUL.	AUG.	SEP.	OCT.	NOV.	DEC.	TOTALS
GAS-PCP	484	636	484	470	338	630	490	242	477	428	426	474	5579
OIL-BBL DAYS ON LINE	30	30	30	30	30	30	30	30	30	30	30	30	360
DAYS OFF LINE													

YEAR 19	JAN.	FEB.	MAR.	APR.	MAY	JUN.	JUL.	AUG.	SEP.	OCT.	NOV.	DEC.	TOTALS
GAS-PCP													
OIL-BBL DAYS ON LINE													
DAYS OFF LINE													

10/06/2023

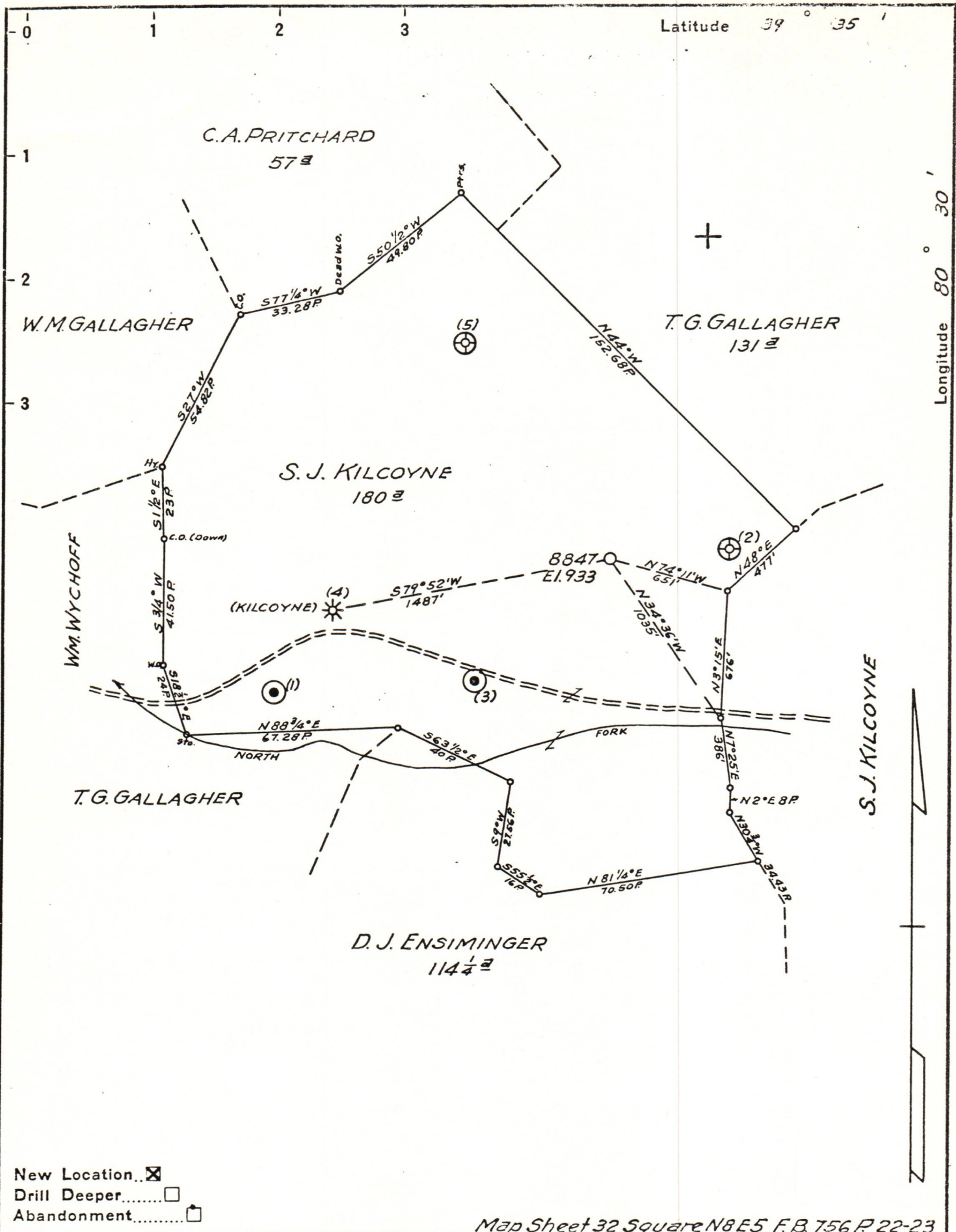

- New Location..
- Drill Deeper.....
- Abandonment.....

Map Sheet 32 Square N8E5 F.B. 756 P. 22-23

Company	HOPE NATURAL GAS CO
Address	CLARKSBURG, W. VA.
Farm	S. J. KILCOYNE
Tract	Acres 180 Lease No. 53638
Well (Farm) No.	6 Serial No. 8847
Elevation (Spirit Level)	933
Quadrangle	LITTLETON
County	WETZEL District GRANT
Engineer	Wm Bowers
Engineer's Registration No.	900
File No.	Drawing No.
Date	Nov. 30, 1943 Scale 1" = 40 P.

STATE OF WEST VIRGINIA
DEPARTMENT OF MINES
OIL AND GAS DIVISION
CHARLESTON

WELL LOCATION MAP
FILE NO. WET-301

10/06/2023

+ Denotes location of well on United States Topographic Maps, scale 1 to 62,500, latitude and longitude lines being represented by border lines as shown.

- Denotes one inch space on border line of original tracing.

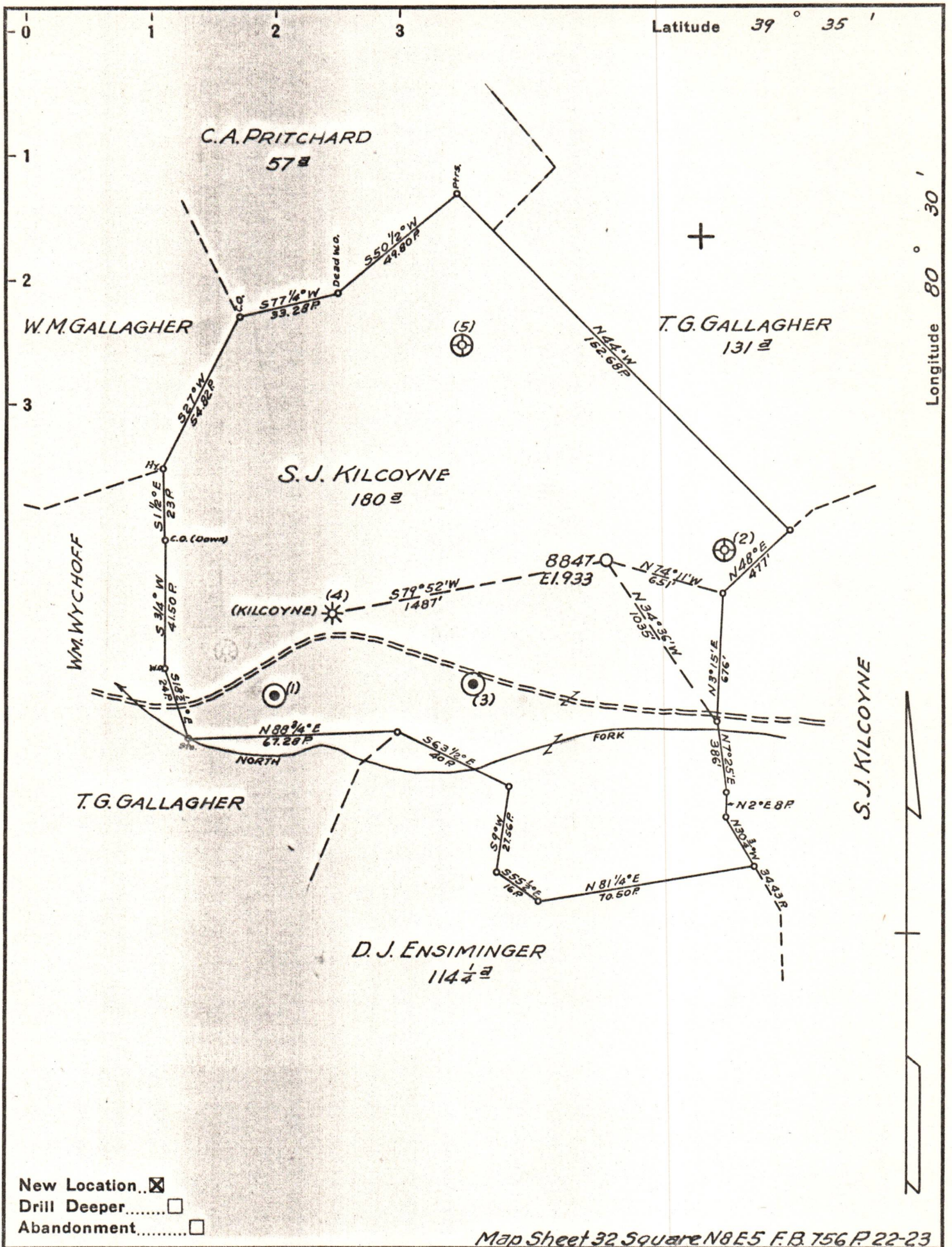

New Location..
 Drill Deeper.....
 Abandonment.....

Map Sheet 32 Square N8E5 F.B. 756 P. 22-23

Company HOPE NATURAL GAS CO.
 Address CLARKSBURG, W.VA.
 Farm S.J. KILCOYNE
 Tract _____ Acres 180 Lease No. 53638
 Well (Farm) No. 6 Serial No. 8847
 Elevation (Spirit Level) 933
 Quadrangle LITTLETON
 County WETZEL District GRANT
 Engineer Wm Bowers
 Engineer's Registration No. 900
 File No. _____ Drawing No. _____
 Date Nov. 30, 1943 Scale 1" = 40 P.

STATE OF WEST VIRGINIA
 DEPARTMENT OF MINES
 OIL AND GAS DIVISION
 CHARLESTON

WELL LOCATION MAP
 FILE NO. WET-301 10/06/2023

+ Denotes location of well on United States Topographic Maps, scale 1 to 62,500, latitude and longitude lines being represented by border lines as shown.

- Denotes one inch spaces on border line of original tracing.