

2.93 S  
2.74 W

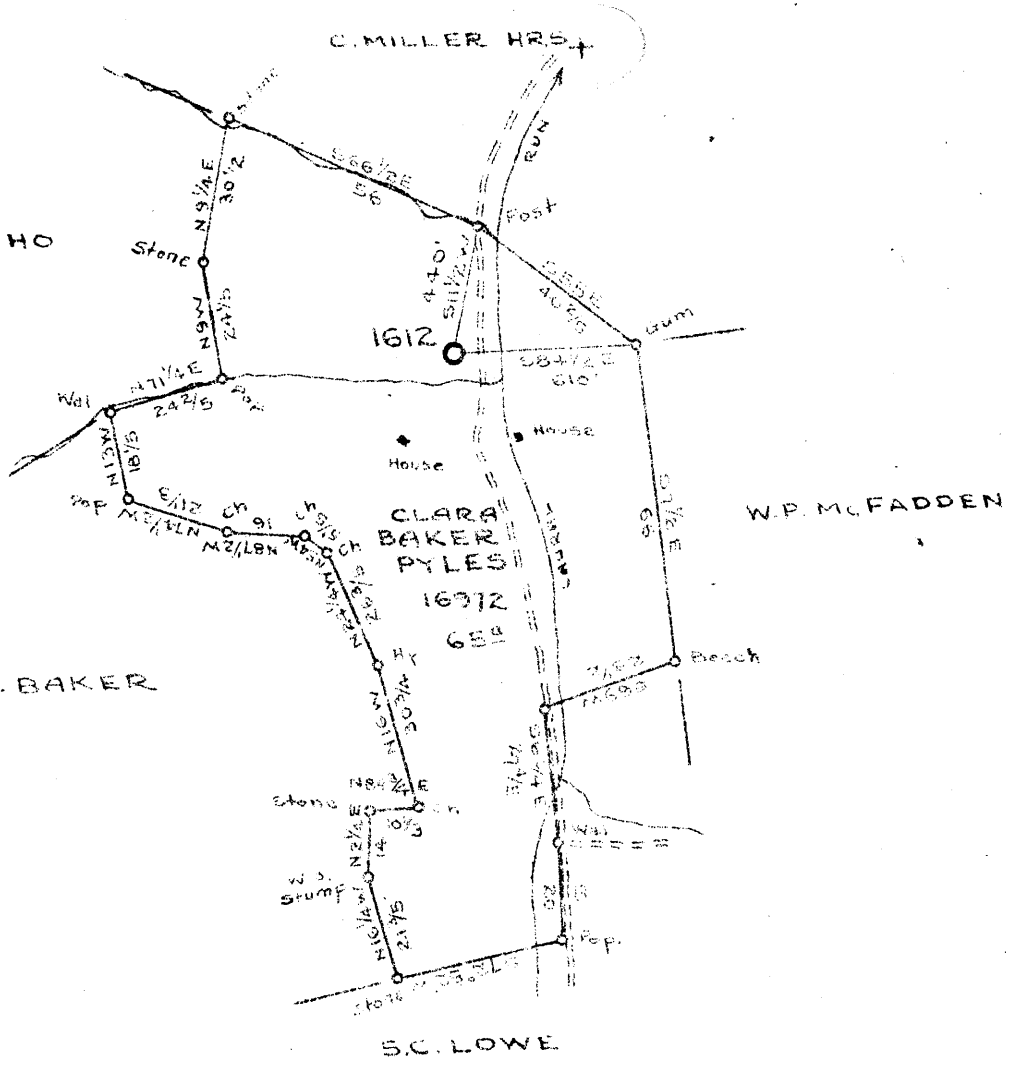

New Location X  
 Drill Deeper  
 Abandonment

Company CARNEGIE NATURAL GAS  
 Address PITTSBURGH, PENNA.  
 Farm CLARA BAKER PYLES  
 Tract \_\_\_\_\_ Acres 65 Lease No. E-16912-71  
 Well (Farm No. 1 Serial No. 1612)  
 Elevation (Spirit Level) 1155 ?  
 Quadrangle LITTLETON NW  
 County WETZEL District CENTER  
 Engineer: D.T. BRITTON  
 Engineer's Registration No. \_\_\_\_\_  
 File No. \_\_\_\_\_ Drawing No. \_\_\_\_\_  
 Date 10-30-44 Scale 1" = 40 rods

STATE OF WEST VIRGINIA  
 DEPARTMENT OF MINES  
 OIL AND GAS DIVISION  
 CHARLESTON

WELL LOCATION MAP  
 FILE NO. WET-323

+ Denotes location of well on United States Topographic Maps, scale 1 to 62,500, latitude and longitude lines being represented by border lines as shown.  
 - Denotes one inch spaces on border line of original tracing

Latitude

1.13s  
.53w

Longitude

Topo Location

7.5' Loc. \_\_\_\_\_ 15' Loc. \_\_\_\_\_  
(calc.) \_\_\_\_\_

Company Carnegie Nat Gas

Farm Clara Baker Pyles

15' Quad \_\_\_\_\_  
(sec.)

7.5' Quad Wilkesville

District Center

WELL LOCATION PLAT

County 103 Permit 323



STATE OF WEST VIRGINIA  
DEPARTMENT OF MINES  
OIL AND GAS DIVISION

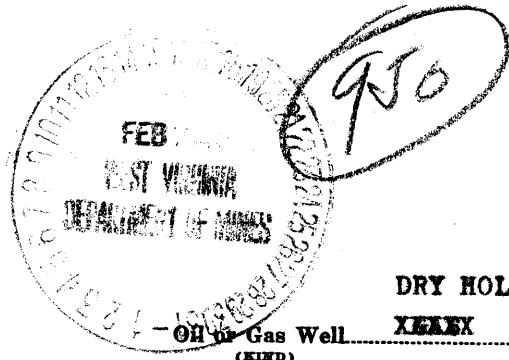

WELL RECORD

DRY HOLE

Permit No. WET-323

- Oil or Gas Well XGAX  
(Kind)

Company Carnegie Natural Gas Company  
Address 1015 Frick Bldg., Pittsburgh, Pa.  
Farm Clara Baker Pyles Acres 65  
Location (waters) Laurel Run  
Well No. E-1612 Elev. 1155?  
District Center County Netzel  
The surface of tract is owned in fee by SEE REVERSE SIDE

Mineral rights are owned by SEE REVERSE SIDE  
Address SEE REVERSE SIDE  
Drilling commenced December 4, 1944  
Drilling completed February 5, 1945

Date Shot Feb. 8, 1945 From 2907'16" To 2915'  
With 30 quarts' nitroglycerine  
Open Flow 70 /10ths Water in 3 Inch  
/10ths Merc. in 3 Inch

Volume 794,000 cu.ft. blew down to 8,000 Cu. Ft.  
Rock Pressure 24 1/2 lbs 24 hrs.  
Oil --- bbls., 1st 24 hrs.  
Fresh water 40 feet 845 feet  
Salt water --- feet --- feet

Casing and Tubing	Used in Drilling	Left in Well	Packers
Size			
16.			Kind of Packer
13.			
10.	<u>231'</u>		Size of
8 1/4.	<u>1352'</u>		
6 1/2.	<u>1794'</u>		Depth set
5 3/16.			
3.			Perf. top
2.			Perf. bottom
Liners Used			Perf. top
			Perf. bottom

CASING CEMENTED --- SIZE --- No. Ft. --- Date ---  
COAL WAS ENCOUNTERED AT 735 FEET --- INCHES  
840 FEET --- INCHES FEET --- INCHES  
--- FEET --- INCHES FEET --- INCHES

Formation	Color	Hard or Soft	Top	Bottom	Oil, Gas or Water	Depth Found	Remarks
Clay	Yellow	Soft	0	10			
Lime	Light	Medium	10	20			
Slate	Light	Soft	20	30			
Rock	Red	Soft	30	35			
Lime	Light	Hard	35	60	Fresh Water	40'	Hole full
Slate	Light	Soft	60	75			
Sand	Light	Medium	75	83			
Slate	Light	Soft	83	150			
Rock	Red	Soft	150	160			
Slate	Light	Soft	160	200			
Rock	Red	Soft	200	210			
Slate	Dark	Soft	210	225			
Lime	Light	Medium Hard	225	240			
Slate	Light	Soft	240	250			
Lime	Light	Hard	250	280			
Slate	Dark	Soft	280	310			
Sand	Light	Hard	310	330			
Slate	Light	Soft	330	345			
Lime	Light	Hard	345	360			
Slate	Light	Soft	360	375			
Coal	Black	Soft	375	377			
Slate	Dark	Soft	377	470			
Sand	Light	Soft	470	505			
Slate	Dark	Soft	505	575			
Lime	Light	Hard	575	620			
Slate	Dark	Soft	620	735			
Coal	Black	Hard	735	740			
Lime	Light	Soft	740	840			Mapletown
Coal	Black	Soft	840	845			Pittsburgh
Lime	Light	Hard	845	855			
Slate	Light	Soft	855	875			
Lime	Light	Hard	875	890			
Slate	Light	Soft	890	920			
Lime	Light	Hard	920	952			
Rock	Red	Soft	952	960			
Sand	Light	Hard	960	970			
Slate	Light	Hard	970	975	Water	845'	1/8 bailer per hr.
Rock	Red	Soft	975	995			

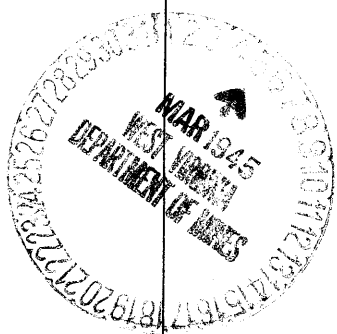

Formation	Color	Hard or Soft	Top	Bottom	Oil, Gas or Water	Depth Found	Remarks
Slate	Light	Soft	995	1015			
Rock	Red	Soft	1015	1063			
Slate	Light	Soft	1063	1075			
Lime	Light	Hard	1075	1110			
Slate	Light	Soft	1110	1180			
Slate	Dark	Soft	1180	1220			
Lime	Light	Soft	1220	1250			
Sand	Light	Med. Hard	1250	1275			
Slate	Dark	Soft	1275	1315			
Slate	Light	Soft	1315	1330			
Rock	Pink	Soft	1330	1340			
Sand	Light	Hard	1340	1415			Big Dunkard
Slate	Dark	Soft	1415	1470			
Sand	Light	Hard	1470	1500			Gas Sand
Slate	Dark	Soft	1500	1525			
Lime	Light	Hard	1525	1532			
Slate	Light	Soft	1532	1548			
Sand	Light	Hard	1548	1557			
Slate	Dark	Soft	1557	1595			
Sand	Light	Hard	1595	1610			1st Salt
Slate	Light	Soft	1610	1645			
Sand	Light	Hard	1645	1685	Water	1650	2nd Salt
Slate	Dark	Soft	1685	1742			
Sand	Light	Hard	1742	1775	Water-hole	Full - 1760'	3rd Salt
Slate	Light	Soft	1775	1790			
Sand	Light	Hard	1790	1825			Maxton
Slate	Dark	Soft	1825	1904			
Sand	Light	Hard	1904	1915			Little Lime
Slate	Dark	Soft	1915	1955			
Sand	Light	Hard	1955	2012		1955	Big Lime
Sand	Light	Hard	2012	2248	2350 1155 1195	1155	Big Injun
Slate	Dark	Soft	2248	2350			
Lime	Light	Hard	2350	2450			
Slate and Lime Shells	Dark	Soft and Hard	2450	2495			1775 1155 835
Shale	Dark	Soft	2495	2550			
Slate & Shells	Dark	Soft	2550	2585			
Lime	Light	Hard	2585	2605			
Slate	Dark	Soft	2605	2612			
Slate and Lime Shells	Dark	Med. Hard	2612	2684			
Rock	Red	Soft	2684	2728			
Slate & Shells	Light	Soft	2728	2830	Oil - show	2834'	
Sand	Light	Hard	2830	2844			Gordon Stray
Slate	Light	Soft	2844	2870			
Sand	Light	Soft	2870	2890			
Slate	Light	Soft	2890	2908			
Sand	Light	Hard	2908	2916	Gas	2912'	Gordon
Slate	Light	Soft	2916	2985	40/10 Water	in 1"	
Lime	Light	Medium	2985	2990	Gas	2986'	
Slate	Light	Soft	2990	3081	70/10 Water	in 3"	
TOTAL DEPTH				3081	Blew down to 9/10 Water	in 2"	
<b>OWNERS of SURFACE and MINERAL RIGHTS:</b>							
Clara Baker Pydes, John Baker, Lillian Nesly, Warren A. Baker, Gretta A. Baker, Cameron, W. Va.							

Date FEBRUARY 14, 1945

APPROVED CARNEGIE NATURAL GAS COMPANY, Owner

By B. N. Archer  
(Title) Land Agent.