

0.743
0.770

To be re-drilled under
Permit WET-562

ACCURACY 1" IN 200'

Frederic E.
New Location SOURCE ELEV. FORMS ROAD ON MILLER RUN 1072.00
Drill Deeper
Redrill "I, the undersigned, hereby certify that this map is correct to the best of my knowledge and belief and shows all the information required by paragraph 6 of the rules and regulations of the oil and gas section of the mining laws of West Virginia."
~~Abandonment~~

Company	WILLIAM CASSADY
Address	4303 WHITED DRIVE VIENNA, W. VA.
Farm	G. W. CLARK
Tract	Acres 175 Lease No.
Well (Farm) No.	4 Serial No.
Elevation (Spirit Level)	1132.55
Quadrangle	LITTLETON - C
County	WITZEL District CENTER
Engineer	G. J. Dye
Engineer's Registration No.	804
File No.	Drawing No.
Date	2-15-64 Scale 1" = 40 FEET

STATE OF WEST VIRGINIA
DEPARTMENT OF MINES
OIL AND GAS DIVISION
CHARLESTON

WELL LOCATION MAP

FILE NO. ~~W-51-1121~~
WET-562

+ Denotes location of well on United States Topographic Maps, scale 1 to 62,500, latitude and longitude lines being represented by border lines as shown.

- Denotes one inch spaces on border line of original tracing.

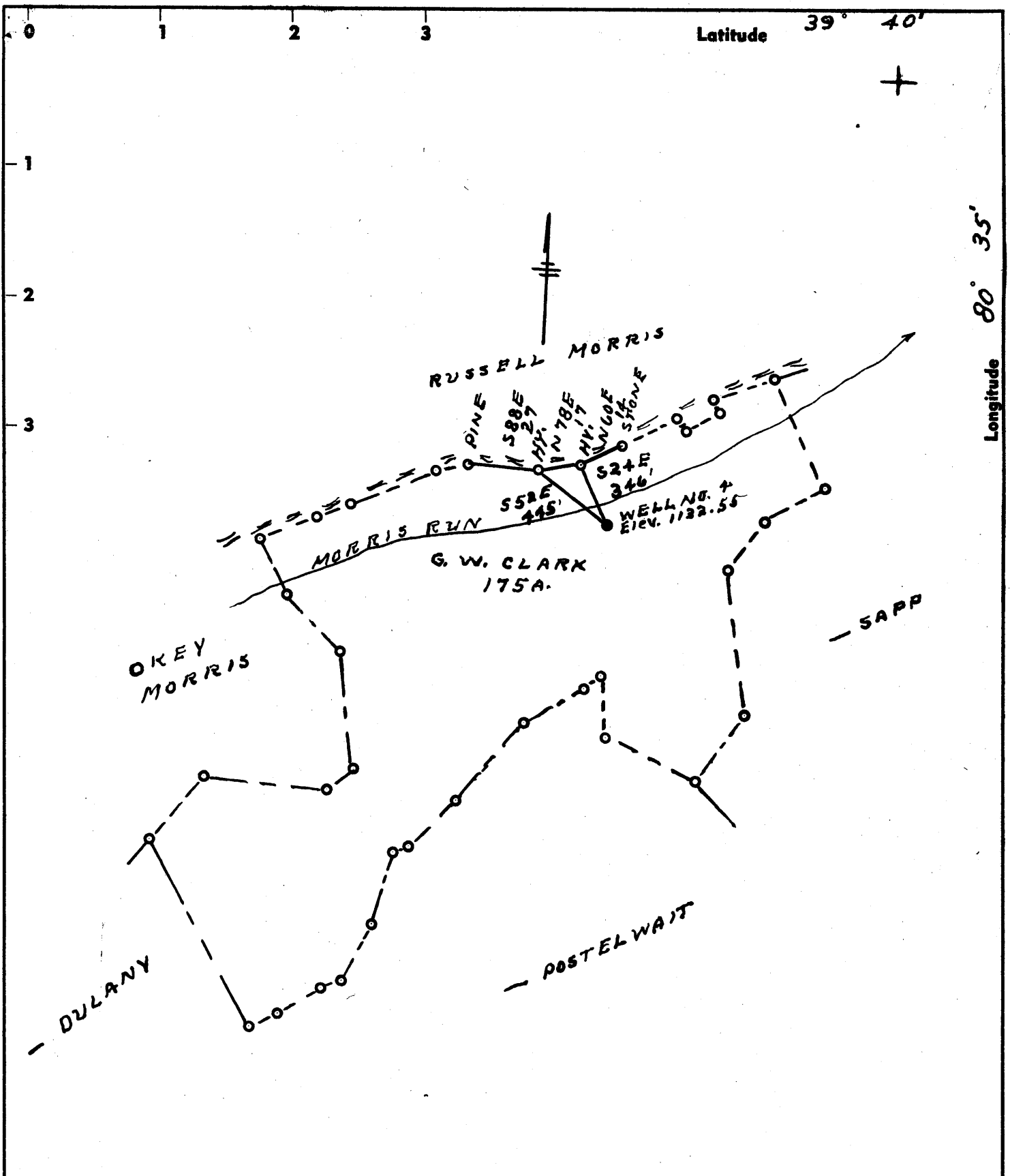

ACCURACY 1" IN 200'

New Location . SOURCE ELEV. FORMS ROAD ON MILLER RUN 1072.00
 Drill Deeper
 Redrill
 Abandonment "I, the undersigned, hereby certify that this map is correct to the best of my knowledge and belief and shows all the information required by paragraph 6 of the rules and regulations of the oil and gas section of the mining laws of West Virginia."

Company	WILLIAM CASSADY	
Address	4303 WHITED DRIVE VIENNA, W. VA.	
Farm	G. W. CLARK	
Tract	Acres 175	Lease No.
Well (Farm) No.	4	Serial No.
Elevation (Spirit Level)	1132.55	
Quadrangle	LITTLETON	
County	WITZEL	District CENTER
Engineer	L. J. Dye	
Engineer's Registration No.	801	
File No.	Drawing No.	
Date	2-15-64	Scale 1" = 40 FEET

STATE OF WEST VIRGINIA
 DEPARTMENT OF MINES
 OIL AND GAS DIVISION
 CHARLESTON

WELL LOCATION MAP
 FILE NO. WET-1176-A

+ Denotes location of well on United States Topographic Maps, scale 1 to 62,500, latitude and longitude lines being represented by border lines as shown.

- Denotes one inch spaces on border line of original tracing.



STATE OF WEST VIRGINIA
DEPARTMENT OF MINES
OIL AND GAS DIVISION

Quadrangle Littleton
Permit No. WET 562 ^W ~~562~~

WELL RECORD

Oil or Gas Well Gas

(KIND)

Company Adena Petroleum, Inc.
Address 1814 7th Street Parkersburg, W. Va.
Farm G.W. Clark Acres 175
Location (waters) Morris Run
Well No. Four Elev. 1132
District Center County Wetzel
The surface of tract is owned in fee by G.W. Clark,
Address Wileyville, W. Va.
Mineral rights are owned by Tasa Coal Co.
Address Morgantown, W. Va.
Drilling commenced Old hole no record
Drilling completed 1921
Date Shot From To
With
Open Flow /10ths Water in Inch
/10ths Merc. in Inch
Volume Cu. Ft.
Rock Pressure lbs. hrs.
Oil bbls., 1st 24 hrs.
WELL ACIDIZED

Casing and Tubing	Used in Drilling	Left in Well	Packers
Size			Kind of Packer
16			
13			Size of
10			
8 1/2	2195	2195	Depth set
5 3/16	2423	2423	Perf. top <u>2 343</u>
# 4 1/2			Perf. bottom <u>2349</u>
2			Perf. top
Liners Used			Perf. bottom

CASING CEMENTED 4 1/2 SIZE 2423 No. Ft. 9/19/64 Date
50 ex reg cement (Dowell)

~~NO RECORD~~
COAL WAS ENCOUNTERED AT FEET INCHES
FEET INCHES FEET INCHES
FEET INCHES FEET INCHES

WELL FRACTURED 10/16/64 559 bbl water 14,000 lb sand Dowell

RESULT AFTER TREATMENT 85,000 cubic feet
ROCK PRESSURE AFTER TREATMENT 120 lb 48 hours
Fresh Water Feet Salt Water Feet

Formation	Color	Hard or Soft	Top	Bottom	Oil, Gas or Water	Depth	Remarks
No record on old well - Formation picks from Gamma Ray Log							
Sand			1620	1710			
Shale			1710	1750			
Sand			1750	1814			
Shale			1814	1868			
Sand			1868	1900			
Shale			1900	1920			
Sand			1920	1960			
Sandy Shale			1960	2150			
Time B.L.			2150	2290			
Sand B.I.			2290	2450			

2150
1133
1017

