

Janice
1/25/96

BLACKSHERE WELLS & CO.
3800Ac.

Pat Dallison, Surf.

Coastal Lumber Co.,
Surf.

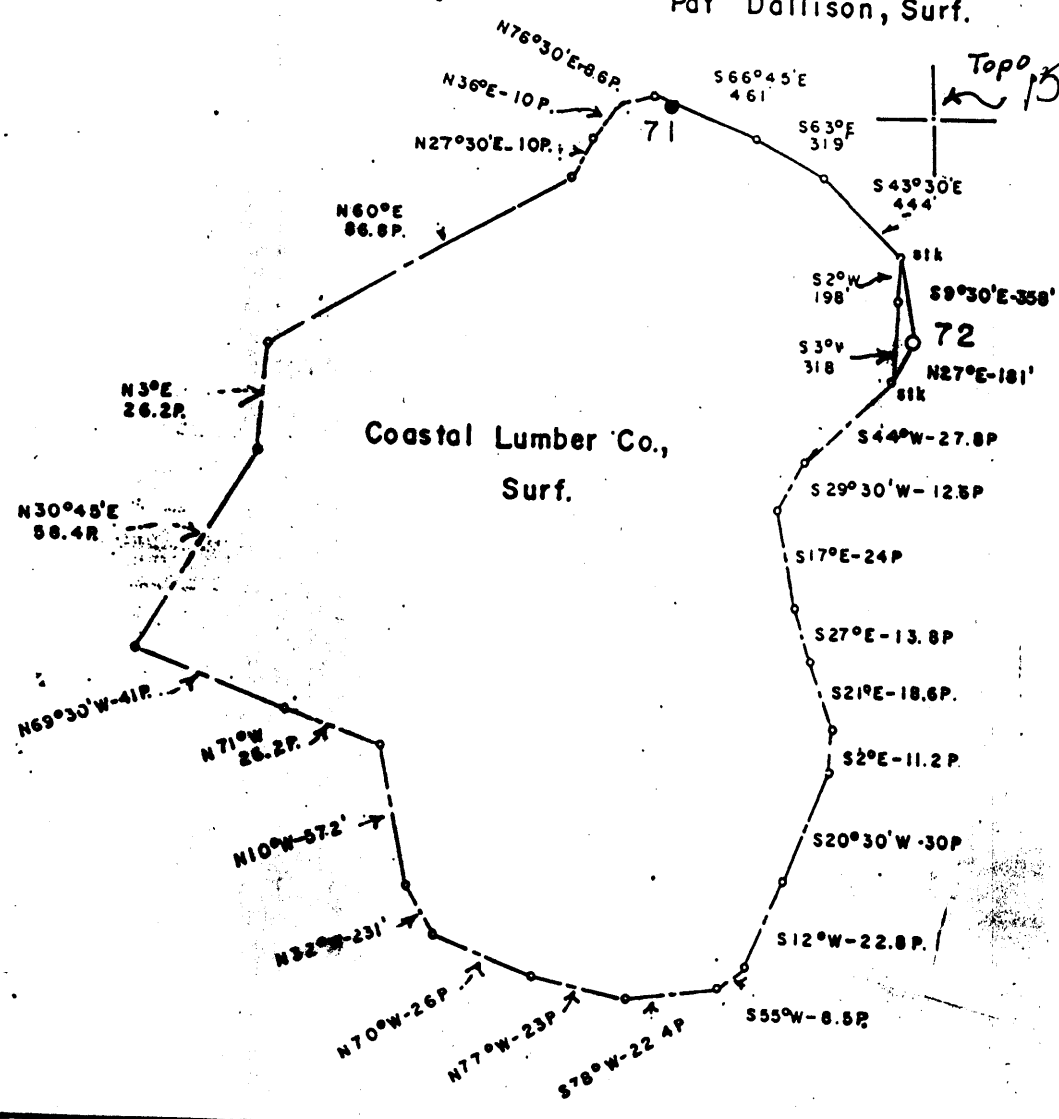

FILE NO. _____
 MAP NO. N59 sqs. N2E5
 SCALE 1" = 800'
 MINIMUM DEGREE OF ACCURACY 1 in 200
 PROVEN SOURCE OF ELEVATION Pennzoil Co Records

I THE UNDERSIGNED, HEREBY CERTIFY THAT THIS PLAT IS CORRECT TO THE BEST OF MY KNOWLEDGE AND BELIEF AND SHOWS ALL THE INFORMATION REQUIRED BY LAW AND THE REGULATIONS ISSUED AND PRESCRIBED BY THE DEPARTMENT OF MINES.
 (SIGNED) *Curtis A Lucas*
 Curtis A Lucas PS 275

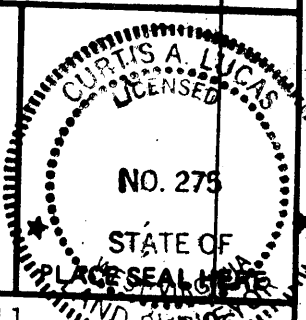

STATE OF WEST VIRGINIA
 DEPARTMENT OF MINES
 OIL AND GAS DIVISION



DATE July 11
 FARM B Wells NO. 72
 API WELL NO. _____
47 - 103 - 0607-P
 STATE COUNTY PERMIT

(+) DENOTES LOCATION OF WELL ON UNITED STATES TOPOGRAPHIC MAPS
 WELL TYPE: OIL GAS _____ LIQUID INJECTION _____ WASTE DISPOSAL _____
 (IF "GAS,") PRODUCTION _____ STORAGE _____ DEEP _____ SHALLOW _____
 LOCATION: ELEVATION 1604.84 WATER SHED Trader Fork of So Fork of Fishing Creek
 DISTRICT Grant COUNTY Wetzel
 QUADRANGLE Folsom

SURFACE OWNER Coastal Lumber Co ACREAGE _____
 OIL & GAS ROYALTY OWNER Carl E Beaty, Agt LEASE ACREAGE 3800
 LEASE NO. _____

PROPOSED WORK: DRILL _____ CONVERT _____ DRILL DEEPER _____ REDRILL _____ FRACTURE OR
 STIMULATE _____ PLUG OFF OLD FORMATION _____ PERFORATE NEW
 FORMATION _____ OTHER PHYSICAL CHANGE IN WELL (SPECIFY) _____

JUL 26 1995

PLUG AND ABANDON CLEAN OUT AND REPLUG _____
 TARGET FORMATION Big Injun ESTIMATED DEPTH 2868
 WELL OPERATOR G B HEFNER & ASSOC DESIGNATED AGENT G B HEFNER
 ADDRESS P O BOX 249 BRIDGEPORT WV 26330 ADDRESS P O BOX 249 BRIDGEPORT WV 26330

BLACKSHERE WELLS & CO.
3800Ac.

Pat Dallison, Surf.

2.875
2.30W

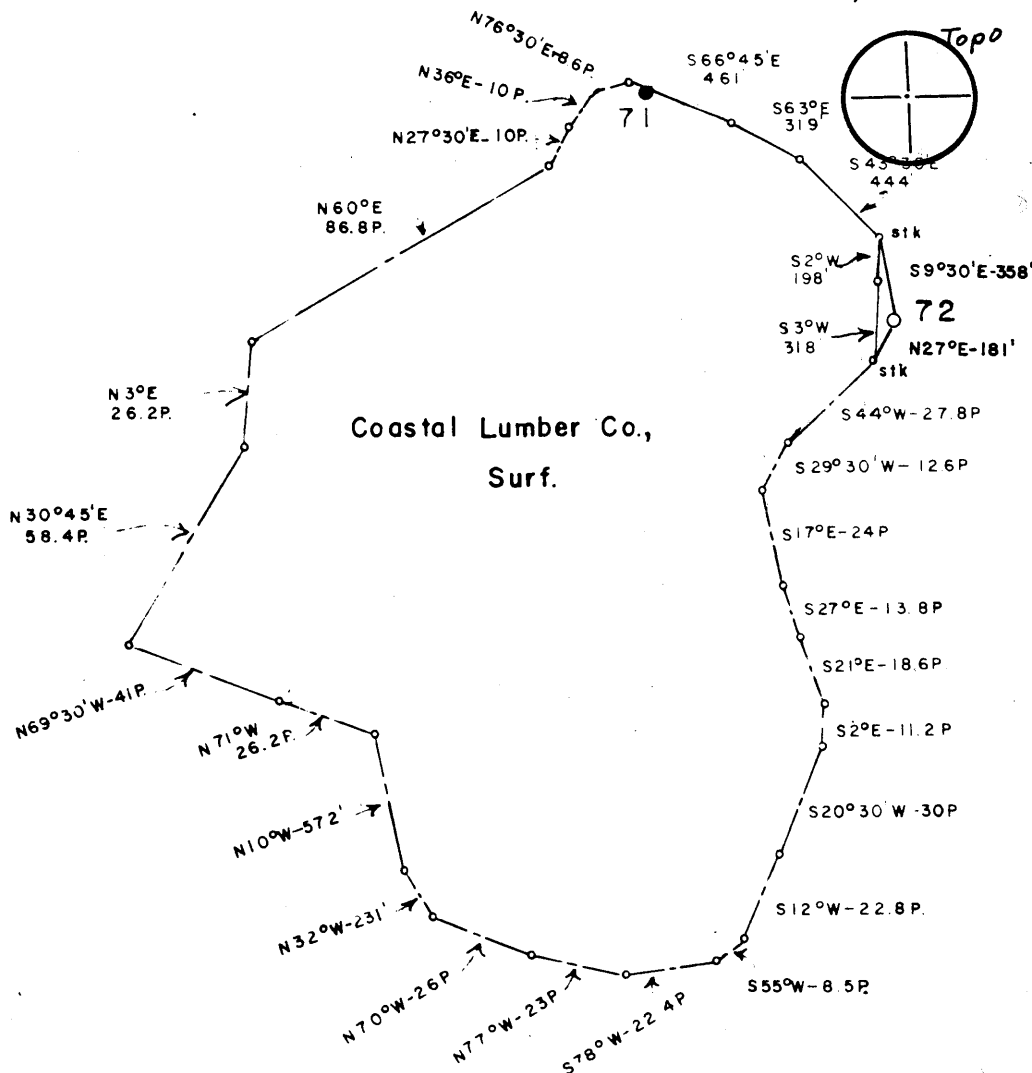

Minimum Error of Closure 1 in 200

Source of Elevation BLACKSHERE WELLS & CO. 70, Rev.
Elev. 1589.08

Fracture
New Location
Drill Deeper
Abandonment

I, the undersigned, hereby certify that this map is correct to the best of my knowledge and belief and shows all the information required by paragraph 6 of the rules and regulations of the oil and gas section of the mining laws of West Virginia.

Signed: *Curtis A. Lucas*

Map No. N 49 Squares: N 2 S E 5 W

Company PENNZOIL COMPANY
Address P.O. Box 1588, Parkersburg, W. Va. 26101
Farm BLACKSHERE WELLS & CO.
Tract Acres 3800 Lease No. 10037-50
Well (Farm) No. 72 Serial No.
Elevation (Spirit Level) 1604.84
Quadrangle Centerpoint 15' NE
County Wetzel District Grant
Surveyor CURTIS A. LUCAS
Surveyor's Registration No. 275
File No. 81 Drawing No.
Date 9-9-76 Scale 1" = 800'

STATE OF WEST VIRGINIA
DEPARTMENT OF MINES
OIL AND GAS DIVISION
CHARLESTON

WELL LOCATION MAP
FILE NO. WET-607

+ Denotes location of well on United States Topographic Maps, scale 1 to 62,500, latitude and longitude lines being represented by border lines as shown.

- Denotes one inch spaces on border line of original tracing.

47-103

BRUNING 44131 27198

2850' B Sign - 6-6 SMITHFIELD

SEP 29 1976



STATE OF WEST VIRGINIA
DEPARTMENT OF MINES

Oil and Gas Division

WELL RECORD ¹⁴

Quadrangle Centerpoint

Permit No. Wet-607

Rotary X Oil _____
Cable _____ Gas _____
Recycling _____ Comb. (X)
Water Flood _____ Storage _____
Disposal _____ (Kind) _____

Company Pennzoil Company
Address P. O. Box 1588, Parkersburg, W. Va. 26101
Farm Blackshere Wells & Co. Acres 3800
Location (waters) South Fork of Fishing Creek
Well No. 72 Elev. 1604.84'
District Grant County Wetzel
The surface of tract is owned in fee by Coastal Lumber Company, Pioneer Division
Address P.O. Box 8, Daley, W. Va. 26259
Mineral rights are owned by Carl E. Beaty, Jr.
Address 110 Water Street, Huntington W. Va.
Drilling Commenced October 29, 1976
Drilling Completed November 4, 1976
Initial open flow 60 M cu. ft. 2 bbls.
Final production 60 M cu. ft. per day (1) bbls.
Well open _____ hrs. before test _____ RP.

Casing and Tubing	Used in Drilling	Left in Well	Cement fill up Cu. ft. (Sks.)
Size 20-16			
Cond. 13-10" 10-3/4	18	18	5 sks.
9 5/8			
8 5/8			
7	1800	1800	335 sks.
1/2			
4 1/2	2851	2851	50 sks.
3			
2			
Liners Used			

Well treatment details:

Attach copy of cementing record.

Fractured: 12/15/76 w/28,000# Frac. Sd. 20/40, 500 Gal. HCL 15%, 800 BW

Coal was encountered at _____ Feet _____ Inches
Fresh water _____ Feet _____ Salt Water _____ Feet
Producing Sand Big Injun Depth 2135

Formation	Color	Hard or Soft	Top Feet	Bottom Feet	Oil, Gas or Water	* Remarks
Sand & Silt			0	85		
Silt & Shale			85	945		
Sand			945	1002		
Silt & Shale			1002	1054		
Sand			1054	1088		
Shale & Silt			1088	1145		
Sand			1145	1163		
Silt & Shale			1163	1178		
Sand			1178	1262		
Shale & Silt			1262	1385		
Pittsburgh Coal			1385	1397		
Shale & Silt			1397	1754		
Sand & Silt			1754	1810		
Silt & Shale			1810	1865		
Big Dunkard			1865	1908		
Shale & Silt			1908	2010		
Sand			2010	2020		
Shale			2020	2120		
1st Salt Sand			2120	2220		
Silt & Shale			2220	2310		
2nd Salt Sand			2310	2354		
Silt & Shale			2354	2381		
3rd Salt Sand			2381	2422		
Shale & Silt			2422	2583		

(over)

* Indicates Electric Log tops in the remarks section.

Formation	Color	Hard or Soft	Top Feet ¹⁴	Bottom Feet	Oil, Gas or Water	* Remarks
Little Lime			2583	2598		
Pencil Cave			2598	2632		
Big Lime			2632	2696		
Loyalhanna Big Injun			2696	2752		
<u>Pocono Big Injun</u>			2752	2835		
Shale			2835	2868		
Total Depth				2868		

2632
1605
2752

Date June 20 19 77

APPROVED PENNZOIL COMPANY Owner

By Arthur A. Bacon
(Title) Eng. Dept



RECEIVED
SEP 13 1976

STATE OF WEST VIRGINIA
DEPARTMENT OF MINES

Oil and Gas Division

OIL AND GAS WELL PERMIT APPLICATION

TO THE DEPARTMENT OF MINES,
Charleston, W. Va.

DATE September 10, 1976

Surface Owner Coastal Lumber Company
Address Pioneer Division
P. O. Box 8, Daley, W. Va. 26259
Mineral Owner Carl E. Baaty, Jr., Agt.
Address 110 Water Street
Coal Owner Mannington, W. Va. 26582
Address _____
Coal Operator Mountaineer Coal Company
Address P. O. Box 1632,
Mannington, W. Va. 26554

Company PENNZOIL COMPANY
Address P. O. Box 1588, Parkersburg, W. Va. 2610
Farm Blackshere Wells & Co. Acres 3800
Location (waters) South Fork of Fishing Creek
Well No. 72 Elevation 1604.84'
District Grant County Wetzel
Quadrangle Centerpoint 15'

THIS PERMIT MUST BE POSTED AT THE WELL SITE

All provisions being in accordance with Chapter 22, of the W. Va. Code, the location is hereby approved for drilling. This permit shall expire if operations have not commenced by 1-13-77

INSPECTOR
TO BE NOTIFIED William Blosser
ADDRESS Colfax, W.Va.
PHONE 363-9105

[Signature]
Deputy Director - Oil & Gas Division

GENTLEMEN:

The undersigned well operator is entitled to drill upon the above named farm or tract of land for oil and gas, having fee title thereto, (or as the case may be) under grant or lease dated February 20, 1892 by John Blackshere, et al made to South Penn Oil Company and recorded on the _____ day of _____ 19____, in _____ County, Book 35 Page 547

NEW WELL _____ DRILL DEEPER _____ REDRILL _____ FRACTURE OR STIMULATE
_____ OIL AND GAS WELL ORIGINALLY DRILLED BEFORE JUNE 5, 1969.

The enclosed plat was prepared by a registered engineer or licensed land surveyor and all coal owners and/or operators have been notified as of the above date.

The above named coal owners and/or operator are hereby notified that any objection they wish to make, or are required to make by Section 3 of the Code, must be received by, or filed with the Department of Mines within ten (10) days. *

Copies of this notice and the enclosed plat were mailed by registered mail, or delivered to the above named coal operators or coal owners at their above shown respective address _____ day _____ before, or on the same day with the mailing or delivery of this copy to the Department of Mines at Charleston, West Virginia.

PLEASE SUBMIT COPIES OF ALL
GEOPHYSICAL LOGS DIRECTLY TO:

WEST VIRGINIA GEOLOGICAL AND
ECONOMIC SURVEY
P. O. BOX 879
MORGANTOWN, WEST VIRGINIA 26505
AC-304 - 292-6331

Address
of
Well Operator

Very truly yours, PENNZOIL COMPANY
(Sign Name) Curtis A. Lucas
Well Operator Curtis A. Lucas,
Civil Eng. Dept.
P. O. Box 1588,
Street
Parkersburg,
City or Town
West Virginia 26101
State

*SECTION 3 If no objections are filed or found by the Department of mines, within said period of ten days from the receipt of notice and plat by the department of mines, to said proposed location, the department shall forthwith issue to the well operator a permit reciting the filing of such plat, that no objections have been made by the coal operators or found thereto by the department and that the same is approved and the well operator authorized to proceed.

WET-607 PERMIT NUMBER

"I have read and understand the reclamation requirements as set forth in Chapter 22, Article 4, Section 12-b and will carry out the specified requirements."

Signed by Curtis A. Lucas

BLANKET BOND

47-103

THIS IS AN ESTIMATE ONLY
ACTUAL INFORMATION WILL BE SUBMITTED ON OG-10 UPON COMPLETION

PROPOSED WORK ORDER TO X DRILL _____ DEEPEN _____ FRACTURE-STIMULATE _____
 DRILLING CONTRACTOR: (If Known) RESPONSIBLE AGENT:
 NAME F. W. A. NAME Pennzoil Company
 ADDRESS _____ ADDRESS Parkersburg, West Virginia 26101
 TELEPHONE _____ TELEPHONE 422-6565
 ESTIMATED DEPTH OF COMPLETED WELL: 2850' ROTARY X CABLE TOOLS _____
 PROPOSED GEOLOGICAL FORMATION: Big Injun
 TYPE OF WELL: OIL X GAS _____ COMB. _____ STORAGE _____ DISPOSAL _____
 RECYCLING _____ WATER FLOOD _____ OTHER _____

TENTATIVE CASING PROGRAM:

CASING AND TUBING SIZE	USED FOR DRILLING	LEFT IN WELL	CEMENT FILL UP OR SACKS - CUBIC FT.
20 - 16			
13 - 10			
9 - 5/8			
8 - 5/8			
7	1400'	1400'	Cement to surface
5 1/2			
4 1/2	2850'	2850'	50 sks.
3			Perf. Top
2			Perf. Bottom
Liners			Perf. Top
			Perf. Bottom

APPROXIMATE FRESH WATER DEPTHS _____ FEET SALT WATER _____ FEET
 APPROXIMATE COAL DEPTHS 1360', Pittsburgh Coal
 IS COAL BEING MINED IN THE AREA? None BY WHOM? _____

TO DRILL:

SUBMIT FIVE (5) COPIES OF OG - 1, \$100.00 PERMIT FEE, PERFORMANCE BOND AND PERMANENT COPY OF PLAT.

TO DRILL DEEPER OR REDRILL:

SUBMIT FIVE (5) COPIES OF OG - 1, SHOWING ORIGINAL PERMIT NUMBER AND PERFORMANCE BOND. ON WELLS DRILLED PRIOR TO 1929, A PERMANENT COPY OF THE PLAT AND THE ORIGINAL WELL RECORD MUST ALSO BE SUBMITTED.

TO FRACTURE - STIMULATE:

OIL AND/OR GAS WELL ORIGINALLY DRILLED BEFORE JUNE 5, 1929, FIVE (5) COPIES OG - 1, PERFORMANCE BOND, PERMANENT PLAT AND ORIGINAL WELL RECORD.

OIL AND/OR GAS WELL ORIGINALLY DRILLED ON AND/OR AFTER JUNE 5, 1929, FIVE COPIES OG - 1, SHOWING ORIGINAL PERMIT NUMBER, AND PERFORMANCE BOND.

Required forms must be filed within ninety (90) days of completion for bond release. Inspector to be notified twenty-four (24) hours in advance.

The following waiver must be completed by the coal operator if the permit is to be issued within ten days of receipt thereof.

WAIVER: I the undersigned, Agent for _____ Coal Company, Owner or Operator of the coal under this lease have examined and place on our mine maps this proposed well location.

We the _____ Coal Company have no objections to said well being drilled at this location, providing operator has complied with all rules and regulations in Articles 4, 5, and 7, Chapter 22 of the West Virginia Code.

 For Coal Company

 Official Title

STATE OF WEST VIRGINIA
DIVISION OF ENVIRONMENTAL PROTECTION
SECTION OF OIL AND GAS

AFFIDAVIT OF PLUGGING AND FILLING WELL

AFFIDAVIT SHOULD BE IN TRIPLICATE, one copy mailed to the Division, one copy to be retained by the Well Operator and the third copy (and extra copies if required) should be mailed to each coal operator at their respective addresses.

Farm name: COASTAL LUMBER CO. Operator Well No.: B. WELLS #72

LOCATION: Elevation: 1,604.84 Quadrangle: FOLSOM
District: GRANT County: WETZEL
Latitude: 14425 Feet South of 39 Deg. 30 Min. 0 Sec.
Longitude 800 Feet West of 80 Deg. 32 Min. 30 Sec.

Well Type: OIL X GAS _____

Company: G B HEFNER & ASSOC
P O BOX 249
BRIDGEPORT WV 26330

Coal Operator CONSOLIDATION COAL CO
or Owner P O BOX 1314
MORGANTOWN WV 26507

Agent: G B HEFNER

Coal Operator _____
or Owner _____

Permit Issued: 07/26/96



AFFIDAVIT

STATE OF WEST VIRGINIA,
County of WETZEL

ss:

KYLE D PERKINS and TONY PERKINS being first duly sworn according to law depose and say that they are experienced in the work of plugging and filling oil and gas wells and were employed by the above named well operator, and participated in the work of plugging and filling the above well, and RANDAL MICK Oil and Gas Inspector representing the Director, say that said work was commenced on the 3rd day of September, 1996, and that the well was plugged and filled in the following manner:

TYPE	FROM	TO	PIPE REMOVED	LEFT
Cement	2830	2640 (tagged)	4 1/2" 1880	971
Gel	2640	1880	7" 0	1804CTS
Cement	1880	1780	10 3/4" 0	26CTS
Gel	1780	1425		
Cement	1425	1325		
Gel	1325	110		
Cement	110	surface		

Description of monument: 7" csg extending 30" above surface
and that the work of plugging and filling said well was completed on the 5th day of September, 1996.

And further deponents saith not.

Kyle D Perkins

Tony Perkins

Sworn and subscribe before me this 5th day of September, 1996
My commission expires: June 7, 2000

Curtis A. Lucas
Notary Public

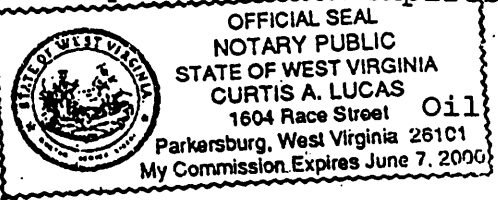

Oil and Gas Inspector: _____