



west virginia department of environmental protection

Office of Oil and Gas
601 57th Street, S.E.
Charleston, WV 25304
(304) 926-0450
fax: (304) 926-0452

Harold D. Ward, Cabinet Secretary
www.dep.wv.gov

Monday, September 25, 2023
PERMIT MODIFICATION APPROVAL
Horizontal 6A / New Drill

EQT PRODUCTION COMPANY
625 LIBERTY AVE., SUITE 1700
PITTSBURGH, PA 15222

Re: Permit Modification Approval for Haggard 2H
47-103-03526-00-00

Lateral Extension

EQT PRODUCTION COMPANY

The Office of Oil and Gas has reviewed the attached permit modification for the above referenced permit. The attached modification has been approved and well work may begin. Please be reminded that the oil and gas inspector is to be notified twenty-four (24) hours before permitted well work is commenced.

If there are any questions, please feel free to contact me at (304) 926- 0450.

A handwritten signature in blue ink, appearing to read 'James A. Martin', is written over a faint circular stamp.

James A. Martin
Chief

Operator's Well Number: Haggard 2H
Farm Name: Amie Lee Henderson
U.S. WELL NUMBER: 47-103-03526-00-00
Horizontal 6A New Drill
Date Modification Issued: 09/25/2023

Promoting a healthy environment.

09/29/2023

STATE OF WEST VIRGINIA
DEPARTMENT OF ENVIRONMENTAL PROTECTION, OFFICE OF OIL AND GAS
WELL WORK PERMIT APPLICATION

1) Well Operator: EQT Production Company 306686 Wetzel Center Littleton
Operator ID County District Quadrangle

2) Operator's Well Number: 2H Well Pad Name: Haggard

3) Farm Name/Surface Owner: Amie Lee Henderson Public Road Access: CR 8/2

4) Elevation, current ground: 1,519' (built) Elevation, proposed post-construction: 1,519' (built)

5) Well Type (a) Gas Oil Underground Storage
Other

(b) If Gas Shallow Deep
Horizontal

6) Existing Pad: Yes or No Yes

7) Proposed Target Formation(s), Depth(s), Anticipated Thickness and Expected Pressure(s):
Marcellus, 7,600', 47', 2,620 psi

8) Proposed Total Vertical Depth: 7,600'

9) Formation at Total Vertical Depth: Marcellus

10) Proposed Total Measured Depth: 19,347'

11) Proposed Horizontal Leg Length: 9,928'

12) Approximate Fresh Water Strata Depths: 465'

13) Method to Determine Fresh Water Depths: Offset Wells: 47-103-02236, 47-103-02647

14) Approximate Saltwater Depths: No salt water shows listed in offsets

15) Approximate Coal Seam Depths: 1,339'-1,342'; 1,437'-1,442'

16) Approximate Depth to Possible Void (coal mine, karst, other): N/A

17) Does Proposed well location contain coal seams directly overlying or adjacent to an active mine? Yes No

(a) If Yes, provide Mine Info: Name: _____
Depth: _____
Seam: _____
Owner: _____

RECEIVED
Office of Oil and Gas
SEP 18 2023
WV Department of
Environmental Protection

Ch# 598232
250000
Ch# 599136
500000

Page 1 of 3
Stephen Mccoy
Digitally signed by Stephen Mccoy
Date: 2023.09.08 09:40:56 -0400

09/29/2023

18)

CASING AND TUBING PROGRAM

TYPE	Size (in)	New or Used	Grade	Weight per ft. (lb/ft)	FOOTAGE: For Drilling (ft)	INTERVALS: Left in Well (ft)	CEMENT: Fill-up (Cu. Ft.)/CTS
Conductor	26	New	A252 GR3	85.6	68	68 ✓	50 ft^3 / CTS ✓
Fresh Water	13 3/8	New	J-55	54.5	1492	1492 ✓	1325 ft^3 / CTS
Coal							
Intermediate	9 5/8	New	J-55	36	2909	2909 ✓	1100 ft^3 / CTS
Production	6	New	P-110	24	19347	19347 ✓	500' above intermediate casing
Tubing							
Liners							

TYPE	Size (in)	Wellbore Diameter (in)	Wall Thickness (in)	Burst Pressure (psi)	Anticipated Max. Internal Pressure (psi)	Cement Type	Cement Yield (cu. ft./k)
Conductor	26	30	0.312	1000	18	Class A/L	1.04 - 1.20
Fresh Water	13 3/8	17 1/2	0.380	2730	2184	Class A/L	1.04 - 1.20
Coal							
Intermediate	9 5/8	12 3/8	0.352	3520	2816	Class A/L	1.04 - 1.20
Production	6	8 1/2	0.400	14580 ✓	11664	Class A/H/L	1.04 - 2.10
Tubing							
Liners							

PACKERS

Kind:			
Sizes:			
Depths Set:			

RECEIVED
Office of Oil and Gas
SEP 18 2023
WV Department of Environmental Protection

19) Describe proposed well work, including the drilling and plugging back of any pilot hole:

This well has been drilled to an MD of 6,334' EQT will continue drilling and complete a new horizontal well in the Marcellus Formation. We will resume drilling the curve from the tie in, drill the lateral in the Marcellus. Cement casing.

20) Describe fracturing/stimulating methods in detail, including anticipated max pressure and max rate:

Hydraulic fracturing is completed in accordance with state regulations using water recycled from previously fractured wells and obtained from freshwater sources. This water is mixed with sand and a small percentage (less than 0.1%) of chemicals (including 15% Hydrochloric acid, friction reducer, biocide, and scale inhibitor), referred to in the industry as a "slickwater" completion. Maximum anticipated internal casing pressure is expected to be approximately 10,000 psi, maximum anticipated treating rates are expected to average approximately 100 bpm. Stage lengths vary from 150 to 300 feet. Average approximately 350,000 gallons of water per stage. Sand sizes vary from 100 mesh to 20/40 mesh. Average approximately 200,000-600,000 pounds of proppant per stage.

21) Total Area to be disturbed, including roads, stockpile area, pits, etc., (acres): 15.24 acres (built)

22) Area to be disturbed for well pad only, less access road (acres): 8.84 acres (built)

23) Describe centralizer placement for each casing string:

- Surface: Bow spring centralizers – One centralizer at the shoe and one spaced every 500'.
- Intermediate: Bow spring centralizers– One centralizer at the shoe and one spaced every 500'.
- Production: One solid body centralizer spaced every other joint from production casing shoe to landing point. One solid body centralizer spaced every joint from landing point to planned top of cement.

RECEIVED
Office of Oil and Gas

SEP 18 2023

24) Describe all cement additives associated with each cement type:

Conductor: No additives
 Surface: Calcium Chloride. Used to speed the setting of cement slurries
 Intermediate: Calcium Chloride. Used to speed the setting of cement slurries.
 Production: Calcium Carbonate, Fluid Loss, Extender, Dispersent, Viscosifier, Defoamer, POZ, Bonding Agent, Retarder, Anti-Settling/Suspension Agent

WV Department of
Environmental Protection

25) Proposed borehole conditioning procedures:

Surface: Circulate hole clean while rotating & reciprocating the drill string until cuttings diminish at surface.
 Intermediate: Circulate hole clean while rotating & reciprocating the drill string until cuttings diminish at surface.
 Production: Perform a cleanup cycle by pumping 3-8 bottoms up or until the shakers are clean. Check volume of cuttings coming across the shakers every 15 minutes.

*Note: Attach additional sheets as needed.

09/29/2023

EQT Production

Wellbore Diagram

Well: Haggard 2H
Pad: Haggard
Elevation: 1519' GL 1547' KB

County: Wetzel
State: West Virginia

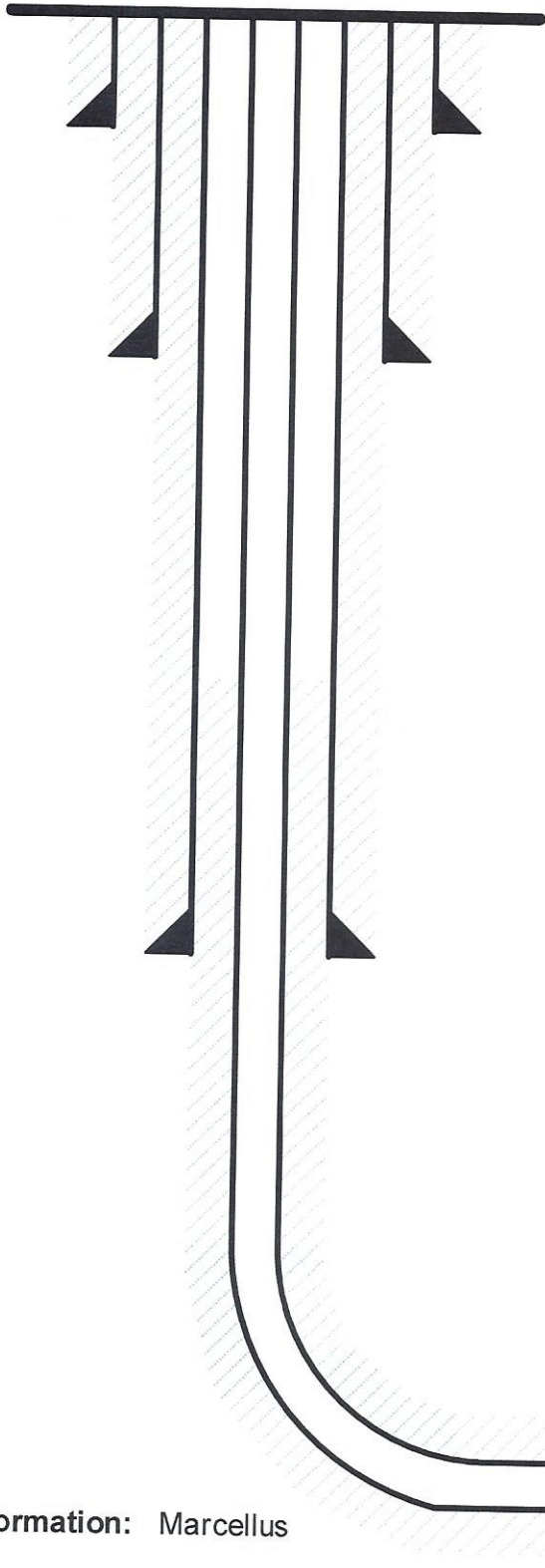

Conductor @ 68'

26", 85.6#, A252 GR3, cement to surface w/ Class A/L

Surface @ 1,492'

13-3/8", 54.5#, J-55, cement to surface w/ Class A/L

Intermediate @ 2,909'

9-5/8", 36#, J-55, cement to surface w/ Class A/L

Production @ 19,347' MD / 7,600' TVD

6", 24#, P-110, cement to 500' inside 9-5/8" w/ Class A/H/L

Formation: Marcellus

RECEIVED
Office of Oil and Gas

SEP 18 2023

WV Department of
Environmental Protection

Stephen Mccoy

Digitally signed by Stephen
Mccoy
Date: 2023.09.08 10:03:17
-04'00'

NOT TO SCALE

09/29/2023

EQT Production
Hydraulic Fracturing Monitoring Plan
Pad ID: Haggard
County: Wetzel

September 13, 2023

RECEIVED
Office of Oil and Gas
SEP 18 2023
WV Department of
Environmental Protection

Page 1 of 2

09/29/2023

Purpose

The purpose of this pad-specific Hydraulic Fracturing Monitoring Plan is to identify and notify conventional well operators near EQT hydraulic fracturing in Wetzel County, WV prior to hydraulic fracturing at the following EQT wells on the Haggard pad: 2H, 4H, 6H, 8H, 10H, 12H, 14H and 16H.

Due to the requirements under 35CSR8 5.11, the permittee is required to review the area surrounding the proposed well pad so as to identify and evaluate potential conduits for unintended fracture propagation.

A report is required to be submitted along with a well work permit application.

The plan is being implemented as an additional safety measure to be utilized in conjunction with existing best management practices and emergency action plans for the site. These additional measures include coordination with well operators of the timing and location of the hydraulic fracturing, establishment of measures well operators should implement, and assurance that the OOG is notified of the timeline, as well as any issues that may arise during fracturing.

1. Communications with Well Operators

EQT, using available data (WV Geological Survey, WVDEP website, and IHS data service), has identified all known wells and well operators within 500 feet of this pad and the lateral sections that are known or could reasonably be expected to be within range of the fracture propagation. A map showing these wells along with a list of the wells and operators is included in **Attachment A**.

EQT will notify these operators of the hydraulic fracturing schedule for these wells, and coordinate with them throughout the fracturing process.

EQT will recommend to these operators at a minimum to:

1. Inspect their surface equipment prior to fracturing to establish integrity and establish pre-frac well conditions
2. Observe wells closely during and after fracturing and monitor for abnormal increases in water, gas or pressure
3. Inspect or install master valves or other necessary equipment for wellhead integrity capable of a pressure recommended by EQT
4. Notify the OOG and EQT if any changes in water, gas production, pressure, or other anomalies are identified

2. Reporting

EQT will provide information relating to the hydraulic fracturing schedule, communication with other operators, and ongoing monitoring of the work upon request of OOG or immediately in the event of any noted abnormalities.

RECEIVED
Office of Oil and Gas

SEP 18 2023

WV State Office
Environment & Energy

Page 2 of 2

09/29/2023



RECEIVED
Office of Oil and Gas
SEP 18 2023
WV Department of
Environmental Protection

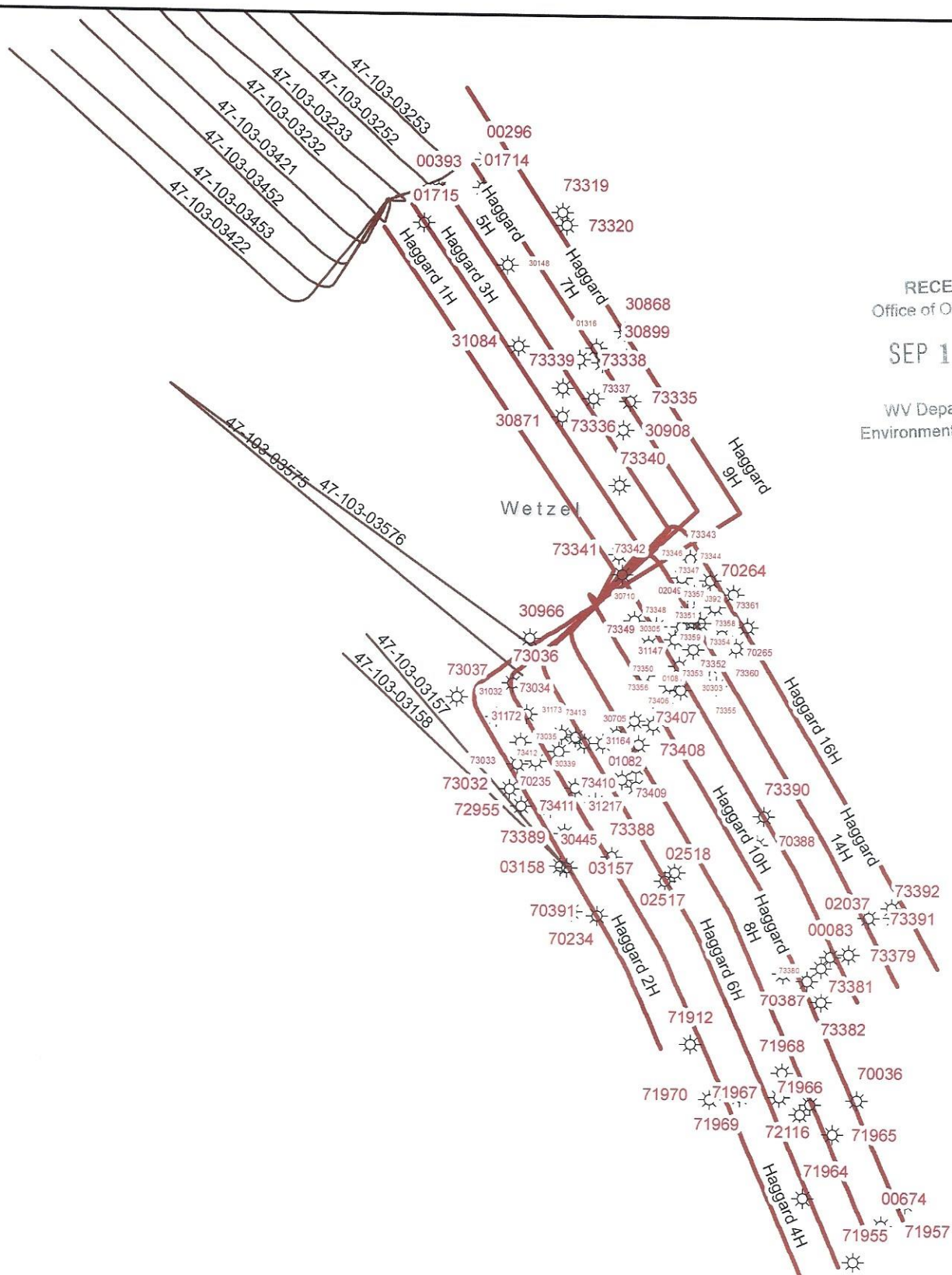

EQT
EQT Corporation
625 Liberty Avenue
Pittsburgh, PA 15222

Legend

- ☀ Foreign_Offset_Wells
- Foreign_Laterals
- Well Lateral_FM
- Formation**
- Genesee
- Marcellus
- Utica

Disclaimer:

This map is confidential and is to be used only for the express informational purposes for which it was created. Unauthorized use, copying, or dissemination is strictly prohibited. EQT does not warrant the accuracy of the location of any items shown on this map, including, but not limited to, any structures, well or pipeline facilities, property boundaries, topography, roadways, or waterways. The items shown on the map may not have been placed on the map using survey lines or GPS coordinates. The specific location of any of the map items should be determined by a field survey performed by a licensed surveyor upon consultation with EQT.

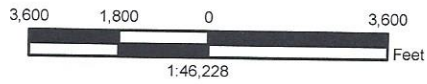

Haggard

Vertical Offsets and
Foreign Laterals
within 500'



Created By: Kellen Waitman Printed By: McClayO on 8/22/2023

Path: \\fsd1p.file.core.windows.net\gis\users\olivia.hudgins\VerticalOffset\Foreign Well Working Map_update_v3.mxd

09/29/2023

00674	73341	03157	73413	31084	71957	73036	02037	71955	03158	71967	31217	73388	73094	73349	73320	02517	71968	73336	73406	30303	73037	73411	73340	00393	31032	30705	73032	73085	
47-103-00574-00	47-103-73341-00	47-103-03157-00	47-103-73413-00	47-103-31084-00	47-103-71957-00	47-103-73036-00	47-103-02037-00	47-103-71955-00	47-103-03158-00	47-103-71967-00	47-103-31217-00	47-103-73388-00	47-103-73094-00	47-103-73349-00	47-103-73320-00	47-103-02517-00	47-103-71968-00	47-103-73336-00	47-103-73406-00	47-103-30303-00	47-103-73037-00	47-103-73411-00	47-103-73340-00	47-103-00393-00	47-103-31032-00	47-103-30705-00	47-103-73032-00	47-103-73085-00	
DIVERSIFIED ENERGY	DIVERSIFIED ENERGY	ANTERO RESOURCES	ANTERO RESOURCES	REEVANS & GEORGE HIX	REEVANS & GEORGE HIX	DIVERSIFIED ENERGY	DIVERSIFIED ENERGY	ANTERO RESOURCES	ANTERO RESOURCES	CASSADY, WILLIAM	CASSADY, WILLIAM	ANTERO RESOURCES	ANTERO RESOURCES	ANTERO RESOURCES	BP	CNK	ANTERO RESOURCES	ANTERO RESOURCES	CD CROUCH GAS	CD CROUCH GAS	CD CROUCH GAS	CD CROUCH GAS	MANUFACTURERS LIGHT & HEAT CO	MANUFACTURERS LIGHT & HEAT CO	MOSES, WILLIAM	MOSES, WILLIAM	RANDALL-ZOGG SUPPLY CO.	RANDALL-ZOGG SUPPLY CO.	
(N/A)	(N/A)	(N/A)	(N/A)	(N/A)	(N/A)	(N/A)	(N/A)	(N/A)	(N/A)	(N/A)	(N/A)	(N/A)	(N/A)	(N/A)	(N/A)	(N/A)	(N/A)	(N/A)	(N/A)	(N/A)	(N/A)	(N/A)	(N/A)	(N/A)	(N/A)	(N/A)	(N/A)	(N/A)	
P & A	UNREPORTED	DRILLED	INACTIVE COMPLETED	UNREPORTED	UNREPORTED	P & A	DRILLED	INACTIVE COMPLETED	UNREPORTED	UNREPORTED	UNREPORTED	UNREPORTED	UNREPORTED	UNREPORTED	UNREPORTED	PERMIT CANCELLED	UNREPORTED	UNREPORTED	UNREPORTED	UNREPORTED	UNREPORTED	UNREPORTED	P & A	UNREPORTED	COMPLETED	INACTIVE COMPLETED	UNREPORTED	UNREPORTED	
GAS	UNREPORTED	GAS	OIL	UNREPORTED	UNREPORTED	GAS	GAS	GAS	UNREPORTED	UNREPORTED	UNREPORTED	UNREPORTED	UNREPORTED	UNREPORTED	UNREPORTED	UNREPORTED	UNREPORTED	UNREPORTED	UNREPORTED	UNREPORTED	UNREPORTED	UNREPORTED	GAS	UNREPORTED	UNREPORTED	UNREPORTED	UNREPORTED	UNREPORTED	
DIVERSIFIED PRODUCTION	(N/A)	DAC ENERGY	REEVANS & GEORGE HIX	(N/A)	(N/A)	DIVERSIFIED PRODUCTION	DAC ENERGY	DAC ENERGY	CASSADY, WILLIAM	CASSADY, WILLIAM	(N/A)	(N/A)	(N/A)	(N/A)	(N/A)	HOPE NATURAL GAS COMPANY	CIX GAS COMPANY	(N/A)	(N/A)	(N/A)	(N/A)	(N/A)	OPERATOR UNKNOWN	(N/A)	(N/A)	MOSES, WILLIAM	RANDALL-ZOGG SUPPLY CO.	(N/A)	(N/A)
(N/A)	(N/A)	(N/A)	(N/A)	(N/A)	(N/A)	(N/A)	(N/A)	(N/A)	(N/A)	(N/A)	(N/A)	(N/A)	(N/A)	(N/A)	(N/A)	(N/A)	(N/A)	(N/A)	(N/A)	(N/A)	(N/A)	(N/A)	(N/A)	(N/A)	(N/A)	(N/A)	(N/A)	(N/A)	(N/A)
1169.00	1467.00	1442.00	1498.00	1369.00	1059.00	1167.00	1241.00	1028.00	1148.00	1371.00	1240.00	1045.00	1219.00	1337.00	1551.00	1301.00	1232.00	1473.00	1295.00	1091.00	1507.00	1300.00	1289.00	1356.00	1139.00	1127.00	1439.00		
2989.00	0.00	15928.00	0.00	3125.00	0.00	0.00	0.00	0.00	0.00	0.00	0.00	0.00	0.00	0.00	0.00	0.00	0.00	0.00	0.00	0.00	0.00	0.00	0.00	0.00	0.00	0.00	0.00	0.00	
INGRAM, J. 646	S MILLER	POSTLETHWAIT IM	T & S POSTLETHWAIT	SMITH HEIRS	OLLIE SIX	ELLEN DELANEY	BRIGGS 1	JOHN INGRAMM	ROCK CAMP IM	JACOB YOHO	C W POSTLETHWAIT	ELLEN DELANEY	ELIZABETH SOLE	F MILLER	LEE, WILLIAM E. WZ106	F BLAKE	J LEMASTERS	B POSTLETHWAIT	JENNIE MORRIS	ELLEN DELANEY	T & S POSTLETHWAIT	SOLOMON MILLER	JACKSON, ALONZO 1-4235	J LEMASTERS	A G SIDELL 1	SUSAN POSTLETHWAIT 2	MARY RICHTER	A C YOHO	
2989.00	0.00	15928.00	0.00	3125.00	0.00	0.00	0.00	0.00	0.00	0.00	0.00	0.00	0.00	0.00	0.00	0.00	0.00	0.00	0.00	0.00	0.00	3260.00	0.00	2975.00	3350.00	0.00	0.00	0.00	

ENWWellSt	ENWOperato	ENWWellSt	ENWWellSt	ENWWellSt	ENWWellSt	ENWWellSt	ENWWellSt	ENWWellSt	ENWWellSt	ENWWellSt	ENWWellSt	ENWWellSt	ENWWellSt	ENWWellSt	ENWWellSt	ENWWellSt	ENWWellSt	ENWWellSt	ENWWellSt	ENWWellSt	ENWWellSt	ENWWellSt	ENWWellSt	ENWWellSt	ENWWellSt	ENWWellSt	ENWWellSt	ENWWellSt	ENWWellSt
47-103-03421-C	47-103-03158-C	47-103-03157-C	47-103-03158-C	47-103-03157-C	47-103-03158-C	47-103-03157-C	47-103-03158-C	47-103-03157-C	47-103-03158-C	47-103-03157-C	47-103-03158-C	47-103-03157-C	47-103-03158-C	47-103-03157-C	47-103-03158-C	47-103-03157-C	47-103-03158-C	47-103-03157-C	47-103-03158-C	47-103-03157-C	47-103-03158-C	47-103-03157-C	47-103-03158-C	47-103-03157-C	47-103-03158-C	47-103-03157-C	47-103-03158-C	47-103-03157-C	47-103-03158-C
SOUTHWESTERN ENER PRODUCING	ANTERO RESOURCES	ANTERO RESOURCES	ANTERO RESOURCES	ANTERO RESOURCES	ANTERO RESOURCES	ANTERO RESOURCES	ANTERO RESOURCES	ANTERO RESOURCES	ANTERO RESOURCES	ANTERO RESOURCES	ANTERO RESOURCES	ANTERO RESOURCES	ANTERO RESOURCES	ANTERO RESOURCES	ANTERO RESOURCES	ANTERO RESOURCES	ANTERO RESOURCES	ANTERO RESOURCES	ANTERO RESOURCES	ANTERO RESOURCES	ANTERO RESOURCES	ANTERO RESOURCES	ANTERO RESOURCES	ANTERO RESOURCES	ANTERO RESOURCES	ANTERO RESOURCES	ANTERO RESOURCES	ANTERO RESOURCES	ANTERO RESOURCES
(N/A)	(N/A)	(N/A)	(N/A)	(N/A)	(N/A)	(N/A)	(N/A)	(N/A)	(N/A)	(N/A)	(N/A)	(N/A)	(N/A)	(N/A)	(N/A)	(N/A)	(N/A)	(N/A)	(N/A)	(N/A)	(N/A)	(N/A)	(N/A)	(N/A)	(N/A)	(N/A)	(N/A)	(N/A)	(N/A)
17325.00	15142.00	1604.00	1604.00	1604.00	1604.00	1604.00	1604.00	1604.00	1604.00	1604.00	1604.00	1604.00	1604.00	1604.00	1604.00	1604.00	1604.00	1604.00	1604.00	1604.00	1604.00	1604.00	1604.00	1604.00	1604.00	1604.00	1604.00	1604.00	1604.00
7372.040	7372.040	7372.040	7372.040	7372.040	7372.040	7372.040	7372.040	7372.040	7372.040	7372.040	7372.040	7372.040	7372.040	7372.040	7372.040	7372.040	7372.040	7372.040	7372.040	7372.040	7372.040	7372.040	7372.040	7372.040	7372.040	7372.040	7372.040	7372.040	7372.040
SWN A WZ17 H	ROCK CAMP IM	WILLIAM RITCHEA WZ1 410H	WILLIAM RITCHEA WZ1 410H	WILLIAM RITCHEA WZ1 410H	WILLIAM RITCHEA WZ1 410H	WILLIAM RITCHEA WZ1 410H	WILLIAM RITCHEA WZ1 410H	WILLIAM RITCHEA WZ1 410H	WILLIAM RITCHEA WZ1 410H	WILLIAM RITCHEA WZ1 410H	WILLIAM RITCHEA WZ1 410H	WILLIAM RITCHEA WZ1 410H	WILLIAM RITCHEA WZ1 410H	WILLIAM RITCHEA WZ1 410H	WILLIAM RITCHEA WZ1 410H	WILLIAM RITCHEA WZ1 410H	WILLIAM RITCHEA WZ1 410H	WILLIAM RITCHEA WZ1 410H	WILLIAM RITCHEA WZ1 410H	WILLIAM RITCHEA WZ1 410H	WILLIAM RITCHEA WZ1 410H	WILLIAM RITCHEA WZ1 410H	WILLIAM RITCHEA WZ1 410H	WILLIAM RITCHEA WZ1 410H	WILLIAM RITCHEA WZ1 410H	WILLIAM RITCHEA WZ1 410H	WILLIAM RITCHEA WZ1 410H	WILLIAM RITCHEA WZ1 410H	WILLIAM RITCHEA WZ1 410H
UNREPORTED-UNREPORTED	UNREPORTED-UNREPORTED	UNREPORTED-UNREPORTED	UNREPORTED-UNREPORTED	UNREPORTED-UNREPORTED	UNREPORTED-UNREPORTED	UNREPORTED-UNREPORTED	UNREPORTED-UNREPORTED	UNREPORTED-UNREPORTED	UNREPORTED-UNREPORTED	UNREPORTED-UNREPORTED	UNREPORTED-UNREPORTED	UNREPORTED-UNREPORTED	UNREPORTED-UNREPORTED	UNREPORTED-UNREPORTED	UNREPORTED-UNREPORTED	UNREPORTED-UNREPORTED	UNREPORTED-UNREPORTED	UNREPORTED-UNREPORTED	UNREPORTED-UNREPORTED	UNREPORTED-UNREPORTED	UNREPORTED-UNREPORTED	UNREPORTED-UNREPORTED	UNREPORTED-UNREPORTED	UNREPORTED-UNREPORTED	UNREPORTED-UNREPORTED	UNREPORTED-UNREPORTED	UNREPORTED-UNREPORTED	UNREPORTED-UNREPORTED	UNREPORTED-UNREPORTED
GAS-PRODUCING	GAS-PRODUCING	OTHER-DUC	GAS-PRODUCING	GAS-PRODUCING	GAS-PRODUCING	GAS-PRODUCING	GAS-PRODUCING	GAS-PRODUCING	GAS-PRODUCING	GAS-PRODUCING	GAS-PRODUCING	GAS-PRODUCING	GAS-PRODUCING	GAS-PRODUCING	GAS-PRODUCING	GAS-PRODUCING	GAS-PRODUCING	GAS-PRODUCING	GAS-PRODUCING	GAS-PRODUCING	GAS-PRODUCING	GAS-PRODUCING	GAS-PRODUCING	GAS-PRODUCING	GAS-PRODUCING	GAS-PRODUCING	GAS-PRODUCING	GAS-PRODUCING	GAS-PRODUCING

RECEIVED
Office of Oil and Gas
SEP 18 2023
WV Department of
Environmental Protection

09/29/2023

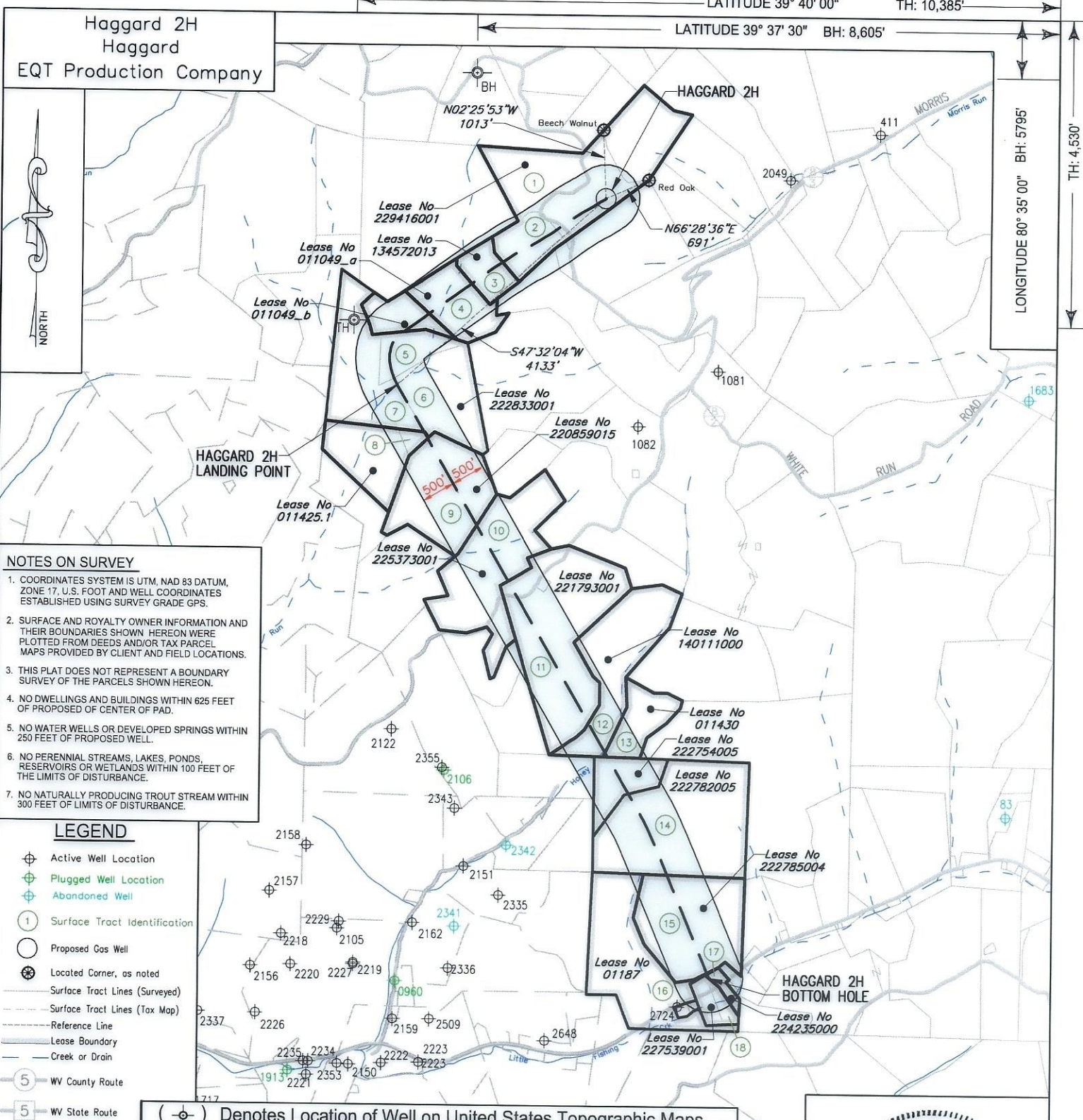

NOTES ON SURVEY

- COORDINATES SYSTEM IS UTM, NAD 83 DATUM, ZONE 17, U.S. FOOT AND WELL COORDINATES ESTABLISHED USING SURVEY GRADE GPS.
- SURFACE AND ROYALTY OWNER INFORMATION AND THEIR BOUNDARIES SHOWN HEREON WERE PLOTTED FROM DEEDS AND/OR TAX PARCEL MAPS PROVIDED BY CLIENT AND FIELD LOCATIONS.
- THIS PLAT DOES NOT REPRESENT A BOUNDARY SURVEY OF THE PARCELS SHOWN HEREON.
- NO DWELLINGS AND BUILDINGS WITHIN 625 FEET OF PROPOSED OF CENTER OF PAD.
- NO WATER WELLS OR DEVELOPED SPRINGS WITHIN 250 FEET OF PROPOSED WELL.
- NO PERENNIAL STREAMS, LAKES, PONDS, RESERVOIRS OR WETLANDS WITHIN 100 FEET OF THE LIMITS OF DISTURBANCE.
- NO NATURALLY PRODUCING TROUT STREAM WITHIN 300 FEET OF LIMITS OF DISTURBANCE.

- LEGEND**
- Active Well Location
 - Plugged Well Location
 - Abandoned Well
 - Surface Tract Identification
 - Proposed Gas Well
 - Located Corner, as noted
 - Surface Tract Lines (Surveyed)
 - Surface Tract Lines (Tax Map)
 - Reference Line
 - Lease Boundary
 - Creek or Drain
 - WV County Route
 - WV State Route

(⊕) Denotes Location of Well on United States Topographic Maps



I, the undersigned, hereby certify that this plat is correct to the best of my knowledge and belief and shows all the information required by law and the regulations issued and prescribed by the Department of Environmental Protection.

Thomas C. Smit
L. L. S. 687



FILE NO: _____
 DRAWING NO: _____
 SCALE: 1" = 2000'
 MINIMUM DEGREE OF ACCURACY: 1:2500
 PROVEN SOURCE OF ELEVATION: NGS CORS Station



DATE: AUGUST 30 20 23
 OPERATORS WELL NO: Haggard 2H
 API WELL NO: 47 - 103 - 03526
 STATE COUNTY PERMIT

WELL TYPE: OIL GAS LIQUID INJECTION WASTE DISPOSAL
 (IF GAS) PRODUCTION: STORAGE DEEP SHALLOW
 LOCATION ELEVATION: 1519' WATERSHED: LOWER WEST VIRGINIA FORK FISH CREEK QUADRANGLE: LITTLETON
 DISTRICT: Center COUNTY: Wetzel
 SURFACE OWNER: Amie Lee Henderson ACREAGE: 84.94 ±
 ROYALTY OWNER: Blackrock Enterprises LLC, et al. LEASE NO: 229416001 ACREAGE: 84.94 ±
 PROPOSED WORK: DRILL CONVERT DRILL DEEPER FRACTURE OR STIMULATE PLUG OFF OLD FORMATION
 PERFORATE NEW FORMATION OTHER PHYSICAL CHANGE IN WELL (SPECIFY)
 PLUG AND ABANDON CLEAN OUT AND REPLUG TARGET FORMATION: Marcellus ESTIMATED DEPTH: 7,600'
 WELL OPERATOR: EQT Production Company DESIGNATED AGENT: Joseph C Mallow
 ADDRESS: 400 Woodcliff Drive ADDRESS: 427 Midstate Drive
 Canonsburg, PA 15317 Clarksburg, WV 26301

Haggard 2H
Haggard
EQT Production Company

Tract ID.	Tax Map No.	Parcel No.	County	District	Surface Tract Owner	Acres
1	10	36.0	Wetzel	Center	Amie Lee Henderson	45.50
2	10	37.0	Wetzel	Center	Amie Lee Henderson	14.50
3	10	51.0	Wetzel	Center	Sharon J. McMillen	10.00
4	10	49.0	Wetzel	Center	Sharon J. McMillen	33.00
5	10	50.0	Wetzel	Center	Coastal Forest Resources Co.	16.50
6	14	4.0	Wetzel	Center	Coastal Forest Resources Co.	31.25
7	14	3.0	Wetzel	Center	Coastal Forest Resources Co.	44.00
8	14	25.1	Wetzel	Center	Coastal Forest Resources Co.	3.25
9	14	17.0	Wetzel	Center	Coastal Forest Resources Co.	36.00
10	14	26.0	Wetzel	Center	James H. Holt	78.00
11	14	28.0	Wetzel	Center	Kenneth R. & Jennifer L. Mason	80.00
12	14	29.0	Wetzel	Center	Kenneth R. & Jennifer L. Mason	43.36
13	14	30.0	Wetzel	Center	Kenneth R. & Jennifer L. Mason	16.25
14	14	41.0	Wetzel	Center	James E. Ashcraft	92.43
15	18	8.0	Wetzel	Center	James E. Ashcraft	50.00
16	18	7.0	Wetzel	Center	Billy Ray Dent	62.55
17	18	7.8	Wetzel	Center	Pelma Morris	2.57
18	18	7.3	Wetzel	Center	Anthony D. & Shirley D. Morris	3.88

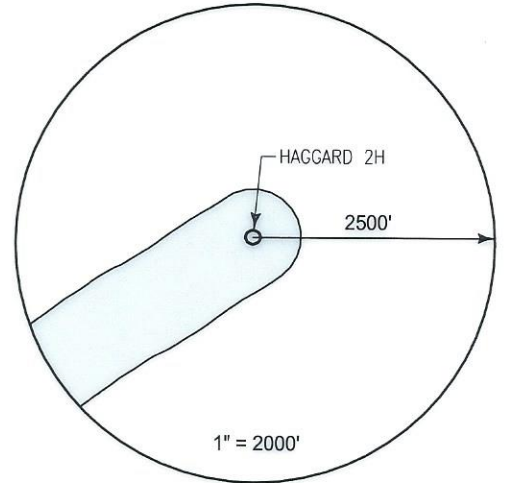

Lease	Owner	Acres
229416001	Blackrock Enterprises LLC, et al.	84.94 ac of 198.1275 ac
134572013	Ohio Valley University, Inc., et al.	105.7625 ac
011049_a	KKS Minerals, LLC, et al.	22.753 ac
011049_b	KKS Minerals, LLC, et al.	10.247 ac of 1,147.39 ac
222833001	Jane Lee Pfalzgraf Wilson, et al.	91.75 ac
011425.1	Earnest H. Cadle, et al.	30.161 ac of 64 ac
220859015	Paul Irvin Reis, et al.	36 ac
225373001	Barbara Postlethwait Norris, et al.	78.1 ac
221793001	Thomas E. Garner, et al.	79.42 ac
140111000	TH Exploration II LLC	43.3 ac of 1,962.7875 ac
011430	SW2 Minerals, LLC, et al.	16.25 ac
222754005	Lisa A. Glover, et al.	21.5 ac
222782005	Lisa A. Glover, et al.	67 ac
222785004	Lisa A. Glover, et al.	50.5 ac
011187	Tribune Resources Minerals, LLC, et al.	47.50 ac & 25 ac
224235000	Pelma B. Swiger, et al.	4.261 ac
227539001	Anthony D. Morris, et ux., et al.	8.128 ac

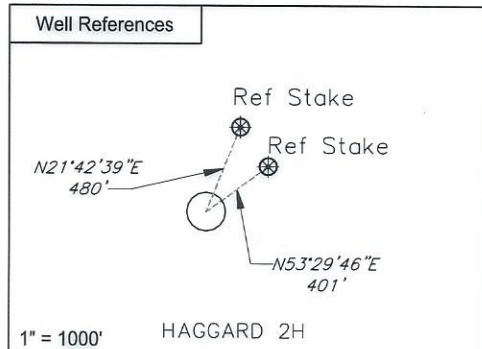

Notes:
HAGGARD 2H coordinates are
 NAD 27 N: 422,331.750 E: 1,684,545.631
 NAD 27 Lat: 39.654144 Long: -80.620402
 NAD 83 UTM N: 4,389,449.612 E: 532,581.539

HAGGARD 2H Landing Point coordinates are
 NAD 27 N: 419,541.436 E: 1,681,496.942
 NAD 27 Lat: 39.646379 Long: -80.631104
 NAD 83 UTM N: 4,388,583.977 E: 531,666.872

HAGGARD 2H Bottom Hole coordinates are
 NAD 27 N: 410,807.220 E: 1,686,187.210
 NAD 27 Lat: 39.622562 Long: -80.614064
 NAD 83 UTM N: 4,385,946.903 E: 533,140.158

West Virginia Coordinates system of 1927 (North Zone)
 based upon Differential GPS Measurements
 Plat orientation, Corner and well ties are based upon
 the grid north meridian
 Well location references are based upon the grid north
 meridian.
 UTM coordinates are NAD83, Zone 17, Meters.

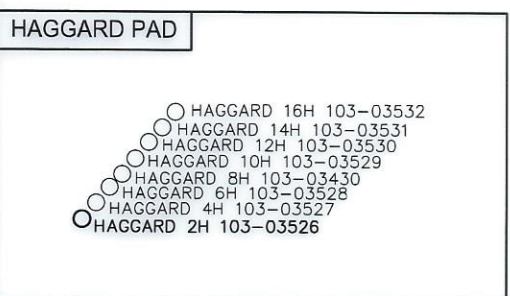

I, the undersigned, hereby certify that this plat is correct to the best of my knowledge and belief and shows all the information required by law and the regulations issued and prescribed by the Department of Environmental Protection.

Thomas C. Smit
 L. L. S. 687



FILE NO: _____
 DRAWING NO: _____
 SCALE: 1" = 1000'
 MINIMUM DEGREE OF ACCURACY:
 1:2500
 PROVEN SOURCE OF ELEVATION:
 NGS CORS Station



DATE: AUGUST 30 20 23
 OPERATORS WELL NO: Haggard 2H
 API WELL NO
 47 - 103 - 03526
 STATE COUNTY PERMIT

WELL TYPE: OIL GAS LIQUID INJECTION WASTE DISPOSAL
 (IF GAS) PRODUCTION: STORAGE DEEP SHALLOW
 LOCATION ELEVATION: 1519' WATERSHED: LOWER WEST VIRGINIA FORK FISH CREEK QUADRANGLE: LITTLETON
 DISTRICT: Center COUNTY: Wetzel
 SURFACE OWNER: Amie Lee Henderson ACREAGE: 45.5 ±
 ROYALTY OWNER: Blackrock Enterprises LLC, et al. LEASE NO: 229416001 ACREAGE: 84.94 ±
 PROPOSED WORK: DRILL CONVERT DRILL DEEPER FRACTURE OR STIMULATE PLUG OFF OLD FORMATION
 PERFORATE NEW FORMATION OTHER PHYSICAL CHANGE IN WELL (SPECIFY)
 PLUG AND ABANDON CLEAN OUT AND REPLUG TARGET FORMATION: Marcellus ESTIMATED DEPTH: 7,600'

WELL OPERATOR: EQT Production Company DESIGNATED AGENT: Joseph C Mallow
 ADDRESS: 400 Woodcliff Drive ADDRESS: 427 Midstate Drive
 Canonsburg, PA 15317 Clarksburg, WV 26301

09/29/2023

**INFORMATION SUPPLIED UNDER WEST VIRGINIA CODE
Chapter 22, Article 6A, Section 5(a)(5)
IN LIEU OF FILING LEASE(S) AND OTHER CONTINUING CONTRACT(S)**

Under the oath required to make the verification on page 1 of this Notice and Application, I depose and say that I am the person who signed the Notice and Application for the Applicant, and that –

- (1) the tract of land is the same tract described in this Application, partly or wholly depicted in the accompanying plat, and described in the Construction and Reclamation Plan;
- (2) the parties and recordation data (if recorded) for lease(s) or other continuing contract(s) by which the Applicant claims the right to extract, produce or market the oil or gas are as follows:

Lease Name or Number	Grantor, Lessor, etc.	Grantee, Lessee, etc.	Royalty	Book/Page
----------------------	-----------------------	-----------------------	---------	-----------

See attached

RECEIVED
Office of Oil and Gas

SEP 18 2023

WV Department of
Environmental Protection

**Acknowledgement of Possible Permitting/Approval
In Addition to the Office of Oil and Gas**

The permit applicant for the proposed well work addressed in this application hereby acknowledges the possibility of the need for permits and/or approvals from local, state, or federal entities in addition to the DEP, Office of Oil and Gas, including but not limited to the following:

- WV Division of Water and Waste Management
- WV Division of Natural Resources WV Division of Highways
- U.S. Army Corps of Engineers
- U.S. Fish and Wildlife Service
- County Floodplain Coordinator

The applicant further acknowledges that any Office of Oil and Gas permit in no way overrides, replaces, or nullifies the need for other permits/approvals that may be necessary and further affirms that all needed permits/approvals should be acquired from the appropriate authority before the affected activity is initiated.

Well Operator: EQT Production Company
 By: John Zavatchan
 Its: Project Specialist - Permitting

Lease No.	Grantor, Lessor, etc.	Acres	Grantee, Lessee, etc.	Royalty	Book/Page
/ 229416001	<u>Blackrock Enterprises LLC, et al.</u> Blackrock Enterprises LLC Antero Resources Corporation	84.94 ac of 198.1275 ac	Antero Resources Corporation EQT Production Company	"at least 1/8th per WV Code 22-6-8"	OG 273A/383 OG 324A/748
/ 134572013	<u>Ohio Valley University, Inc., et al.</u> Thomas H. Fluharty, Chapter 7 Trustee for Ohio Valley University, Inc., f/k/a Ohio Valley College, Inc.	105.7625 ac	EQT Production Company	"at least 1/8th per WV Code 22-6-8"	OG 314A/531
/ 011049 a	<u>KKS Minerals, LLC, et al.</u> Three Rivers Royalty II, LLC SWN Production Company, LLC	22.753 ac	SWN Production Company, LLC EQT Production Company	"at least 1/8th per WV Code 22-6-8"	OG 287A/910 Drill Letter dated August 9, 2023
/ 011049 b	<u>KKS Minerals, LLC, et al.</u> Rock Camp Oil Co. and Telluric Company Drilling Appalachian Corporation Antero Resources Corporation	10.247 ac of 1,147.39 ac	Drilling Appalachian Corporation Antero Resources Corporation EQT Production Company	"at least 1/8th per WV Code 22-6-8"	OG 126A/155 OG 179A/300 OG 338A/844
/ 222833001	<u>Jane Lee Pfalzgraf Wilson, et al.</u> Jane Lee Pfalzgraf Wilson, a widow	91.75 ac	EQT Production Company	"at least 1/8th per WV Code 22-6-8"	OG 302A/581
/ 011425.1	<u>Earnest H. Cadle, et al.</u> Earnest H. Cadle Drilling Appalachian Corporation Antero Resources Corporation	30.161 ac of 64 ac	Drilling Appalachian Corporation Antero Resources Corporation EQT Production Company	"at least 1/8th per WV Code 22-6-8"	OG 138A/486 OG 179A/300 OG 338A/844

RECEIVED
Office of Oil and Gas
SEP 18 2023
WV Department of
Environmental Protection

09/29/2023

<u>220859015</u>	<u>Paul Irvin Reis, et al.</u> Paul Irvin Reis, married dealing in his sole and separate property	36 ac	EQT Production Company	"at least 1/8th per WV Code 22-6-8"	OG 321A/169
<u>225373001</u>	<u>Barbara Postlethwait Norris, et al.</u> Barbara Postlethwait Norris and Carlton G. Norris, wife and husband	78.1 ac	EQT Production Company	"at least 1/8th per WV Code 22-6-8"	OG 311A/82
<u>221793001</u>	<u>Thomas E. Garner, et al.</u> Thomas E. Garner, a married man dealing in his sole and separate property	79.42 ac	EQT Production Company	"at least 1/8th per WV Code 22-6-8"	OG 299A/374
<u>140111000</u>	<u>TH Exploration II LLC</u> TH Exploration II LLC TH Exploration LLC	43.3 ac of 1,962.7875 ac	TH Exploration LLC EQT Production Company	"at least 1/8th per WV Code 22-6-8"	OG 252A/110 OG 258/333
<u>011430</u>	<u>SW2 Minerals, LLC, et al.</u> SW2 Minerals, LLC Antero Resources Corporation	16.25 ac	Antero Resources Corporation EQT Production Company	"at least 1/8th per WV Code 22-6-8"	OG 288A/476 Drill Letter dated August 9, 2023
<u>222754005</u>	<u>Lisa A. Glover, et al.</u> Lisa A. Glover, divorced and not remarried	21.5 ac	EQT Production Company	"at least 1/8th per WV Code 22-6-8"	OG 315A/426
<u>222782005</u>	<u>Lisa A. Glover, et al.</u> Lisa A. Glover, divorced and not remarried	67 ac	EQT Production Company	"at least 1/8th per WV Code 22-6-8"	OG 315A/429
<u>222785004</u>	<u>Lisa A. Glover, et al.</u> Lisa A. Glover, widowed and not remarried	50.5 ac	EQT Production Company	"at least 1/8th per WV Code 22-6-8"	OG 315A/423

RECEIVED
Office of Oil and Gas
SEP 18 2023
WV Department of
Environmental Protection

09/29/2023

/	<u>01187</u>	<u>Tribune Resources Minerals, LLC, et al.</u> Ascent Resources - Marcellus, LLC, f/k/a American Energy - Marcellus, LLC Ascent Resources Marcellus Minerals, LLC Tribune Resources Minerals, LLC	47.50 ac & 25 ac	Ascent Resources Marcellus Minerals, LLC Tribune Resources Minerals, LLC EQT Production Company	"at least 1/8th per WV Code 22-6-8"	DB 448/247 Corp Book 13/427 Drill Letter dated July 27, 2023
/	<u>224235000</u>	<u>Pelma B. Swiger, et al.</u> Pelma Blanchetta Morris, a/k/a Pelma B. Swiger, single	4.261 ac	EQT Production Company	"at least 1/8th per WV Code 22-6-8"	OG 305A/462
/	<u>227539001</u>	<u>Anthony D. Morris, et ux., et al.</u> Anthony D. Morris and Shirley D. Morris, husband and wife	8.128 ac	EQT Production Company	"at least 1/8th per WV Code 22-6-8"	OG 325A/370

RECEIVED
Office of Oil and Gas
SEP 18 2023
WV Department of
Environmental Protection

09/29/2023



July 27, 2023

VIA ELECTRONIC MAIL

SWN Production Company, LLC
10000 Energy Drive
Spring, Texas 77389

RECEIVED
Office of Oil and Gas
SEP 18 2023
WV Department of
Environmental Protection

Re: Leasehold Commitment Agreement
EQT Production Company Proposed Haggard North Unit Area 1H, 3H, 5H, 7H, 9H Wells
EQT Production Company Proposed Haggard South Unit Area 2H, 4H, 6H, 8H, 10H, 12H, 14 H,
16H Wells
Center and Proctor District, Wetzel County, West Virginia

Dear Ian:

This letter (this "**Leasehold Commitment Agreement**") shall serve as a formal agreement between EQT Production Company, LLC, a Pennsylvania company with an address of 400 Woodcliff Drive, Canonsburg, PA 15317 ("EQT") and SWN Production Company, a Texas limited liability company with an address of 10000 Energy Drive, Spring, Texas 77389 ("Southwestern") regarding certain tracts of land and leases in Center and Proctor Districts, Wetzel County, West Virginia, as described in the attached Exhibit "A", wherein SWN may own a leasehold interest in the oil and gas rights (the "**Subject Tracts**"). Intending to be legally bound hereby, the parties agree as follows:

EQT and Southwestern executed an Acreage Trade Agreement on May 12, 2023 ("Trade Agreement") with respect to certain tracts in Wetzel County, West Virginia, covering the leasehold owned by each company, and it has come to EQT's attention that the Subject Tracts, which SWN and EQT included in said Trade Agreement, are located within EQT's Haggard North Unit Area and Haggard South Unit Area (the "**Units**"). EQT plans to drill wells (the "**Wells**") in these Units and the wellbore laterals for such Wells may reach the Subject Tracts prior to EQT and Southwestern closing the aforementioned Trade Agreement. EQT intends to drill the Wells to the Marcellus Formation. As used herein, "**Marcellus Formation**" means all depths and formations from 500' above the top of the Tully formation as seen at 6943' MD in the log for the BIG57H1 well located in Wetzel County, WV (API# 4710302414) down to 200' below the top of the Onondaga formation as seen in the aforementioned well log at a depth of 7117' MD.

Subject to the terms and conditions of this Leasehold Commitment Agreement, SWN consents to and grants EQT all of Southwestern's rights to make regulatory permit applications and, upon receipt of all necessary permits and governmental approvals, to proceed to develop such Oil and Gas Leases and extract, produce and market the Hydrocarbons therefrom.

As noted above, EQT and Southwestern executed a Trade Agreement, and the parties included the Subject Tracts among those interests to be assigned by Southwestern to EQT. Within ten days following the earliest to occur (on a Subject Tract-by-Subject Tract basis) of the following (as applicable, the "**Conveyance Date**"): (a) the date that a Subject Tract is fully and finally excluded from the assignment to occur pursuant to the Trade Agreement; or (b) the date that the Trade Agreement is terminated in accordance with its

09/29/2023

express terms, the following items in clauses (1) and (2) below shall occur (each being deemed to occur simultaneously and each being a condition to the other). For clarity, those Subject Tracts that have not been assigned to EQT pursuant to a Trade Agreement on or before the applicable Conveyance Date are, collectively, the “*Southwestern Remaining Tracts*”.

- (1) Southwestern and EQT shall execute, acknowledge, and deliver to one another an assignment, bill of sale, and conveyance pursuant to which Southwestern will assign to EQT all of Southwestern’s right, title, and interest in and to the Southwestern Remaining Tracts limited to the Marcellus Formation.
- (2) EQT shall pay to Southwestern, by wire transfer of immediately available funds to an account designated in writing by Southwestern, an amount equal to (y) the sum of the net acres for the Southwestern Remaining Tracts (which shall be equal to the number set forth in Exhibit “A” under the column heading “Lease Net Acres” for each such Southwestern Remaining Tract), *multiplied by* (z) \$10,000.00.

EQT shall be fully responsible for and shall release, defend, indemnify and hold Southwestern harmless from and against any and all losses, expenses, damages, injuries, claims or obligations and liabilities (including attorneys’ fees) arising from or relating to EQT’s activities and operations under this Leasehold Commitment Agreement.

This Leasehold Commitment Agreement is governed by the laws of West Virginia. This Leasehold Commitment Agreement may be executed in counterparts, which when taken together, will form one instrument. **Neither Party shall be liable to the other Party for any special, incidental, consequential, punitive or exemplary damages related to, arising out of, or connected with this Leasehold Commitment Agreement.** This Leasehold Commitment Agreement, together with the Trade Agreement, represent the entire agreement of the Parties with respect to the subject matter hereof and supersedes all prior verbal and/or written agreements with respect to the subject matter hereof.

If the above terms and conditions of this Leasehold Commitment Agreement are acceptable to you, please indicate your approval in the space provided below and return an executed copy of this Leasehold Commitment Agreement to the attention of the undersigned.

Should you have any questions, please contact the undersigned at (724)802-2353 or by email at greg.godbey@eqt.com.

Respectfully,

EQT Production Company

DocuSigned by:

 Greg Godbey, CPL

RECEIVED
 Office of Oil and Gas
 SEP 18 2023
 WV Department of
 Environmental Protection

[SIGNATURE PAGE TO FOLLOW]

09/29/2023

SWN Production Company, LLC

DocuSigned by:
Derek Cutright
By: _____
Name: Derek Cutright
Title: Senior Vice President

^{DS} IN ^{DS} IN ^{DS} PMB

EQT Production Company

DocuSigned by:
CA
By: _____
Name: Corey C. Peck
Title: Vice President of Land

^{DS} LMS ^{DS} ME

RECEIVED
Office of Oil and Gas
SEP 18 2023
WV Department of
Environmental Protection

09/29/2023

EXHIBIT "A"

Attached to and made a part of that certain Leasehold Commitment Agreement, dated July 27, 2023, by and between,
and EQT Production Company and SWN Production Company, LLC.

SEP 18 2023

WV Department of
Environmental Protection

Original Lessor	Original Lessee	Lease Date	County	BK/PG	Gross Acres	Net Acres	Tax Parcel
Shane A. Steele	SWN Production Company, LLC	10/13/2022	Wetzel	304A/357	29.0854999	0.0168319	01-0010-0017-0001
Shane A. Steele	SWN Production Company, LLC	10/13/2022	Wetzel	304A/357	38.5000000	0.0222801	01-0010-0017-0002
Shane A. Steele	SWN Production Company, LLC	10/13/2022	Wetzel	304A/357	5.1736871	0.0029940	01-0010-0017-0004
Shane A. Steele	SWN Production Company, LLC	10/13/2022	Wetzel	304A/357	10.0094179	0.0057925	01-0010-0026-0000
George Robinson, a married man dealing in his sole and separate property	SWN Production Company, LLC	09/27/2022	Wetzel	302A/253	0.4925670	0.0001425	01-0010-0017-0000
George Robinson, a married man dealing in his sole and separate property	SWN Production Company, LLC	09/27/2022	Wetzel	302A/253	29.0854999	0.0084159	01-0010-0017-0001
George Robinson, a married man dealing in his sole and separate property	SWN Production Company, LLC	09/27/2022	Wetzel	302A/253	38.5000000	0.0111400	01-0010-0017-0002
George Robinson, a married man dealing in his sole and separate property	SWN Production Company, LLC	09/27/2022	Wetzel	302A/253	5.1736871	0.0014970	01-0010-0017-0004
George Robinson, a married man dealing in his sole and separate property	SWN Production Company, LLC	09/27/2022	Wetzel	302A/253	13.8994179	0.0040218	01-0010-0026-0000
Darla Shaw	SWN Production Company, LLC	10/18/2022	Wetzel	304A/340	0.4925670	0.0001425	01-0010-0017-0000
Darla Shaw	SWN Production Company, LLC	10/18/2022	Wetzel	304A/340	29.0854999	0.0084159	01-0010-0017-0001
Darla Shaw	SWN Production Company, LLC	10/18/2022	Wetzel	304A/340	38.5000000	0.0111400	01-0010-0017-0002
Darla Shaw	SWN Production Company, LLC	10/18/2022	Wetzel	304A/340	5.1736871	0.0014970	01-0010-0017-0004

09/29/2023

EXHIBIT "A"

Attached to and made a part of that certain Leasehold Commitment Agreement, dated July 27, 2023, by and between,
and EQT Production Company and SWN Production Company, LLC.

WV Department of
Environmental Protection

Darla Shaw	SWN Production Company, LLC	10/18/2022	Wetzel	304A/340	10.0094179	0.0028962	01-0010-0026-0000
Raymond J. Glover	SWN Production Company, LLC	11/05/2022	Wetzel	306A/418	0.4925670	0.0002851	01-0010-0017-0000
Raymond J. Glover	SWN Production Company, LLC	11/05/2022	Wetzel	306A/418	29.0854999	0.0168319	01-0010-0017-0001
Raymond J. Glover	SWN Production Company, LLC	11/05/2022	Wetzel	306A/418	38.5000000	0.0222801	01-0010-0017-0002
Raymond J. Glover	SWN Production Company, LLC	11/05/2022	Wetzel	306A/418	5.1736871	0.0029940	01-0010-0017-0004
Raymond J. Glover	SWN Production Company, LLC	11/05/2022	Wetzel	306A/418	10.0094179	0.0057925	01-0010-0026-0000
Linda M. Leas, a single woman	SWN Production Company, LLC	11/14/2022	Wetzel	308A/53	0.4925670	0.0003421	01-0010-0017-0000
Linda M. Leas, a single woman	SWN Production Company, LLC	11/14/2022	Wetzel	308A/53	29.0854999	0.0201983	01-0010-0017-0001
Linda M. Leas, a single woman	SWN Production Company, LLC	11/14/2022	Wetzel	308A/53	38.5000000	0.0267361	01-0010-0017-0002
Linda M. Leas, a single woman	SWN Production Company, LLC	11/14/2022	Wetzel	308A/53	16.6925326	0.0115920	01-0010-0017-0003
Linda M. Leas, a single woman	SWN Production Company, LLC	11/14/2022	Wetzel	308A/53	5.1736871	0.0035928	01-0010-0017-0004
Linda M. Leas, a single woman	SWN Production Company, LLC	11/14/2022	Wetzel	308A/53	13.8994179	0.0096524	01-0010-0026-0000
LaVonne Appel, a married woman dealing in her sole and separate property	SWN Production Company, LLC	11/16/2022	Wetzel	308A/568	0.4925670	0.0005701	01-0010-0017-0000
LaVonne Appel, a married woman dealing in her sole and separate property	SWN Production Company, LLC	11/16/2022	Wetzel	308A/568	29.0854999	0.0336638	01-0010-0017-0001
LaVonne Appel, a married woman dealing in her sole and separate property	SWN Production Company, LLC	11/16/2022	Wetzel	308A/568	5.1736871	0.0059881	01-0010-0017-0004

09/29/2023

SEP 18 2023

EXHIBIT "A"

Attached to and made a part of that certain Leasehold Commitment Agreement, dated July 27, 2023, by and between,
and EQT Production Company and SWN Production Company, LLC.

WV Department of
Environmental Protection

LaVonne Appel, a married woman dealing in her sole and separate property	SWN Production Company, LLC	11/16/2022	Wetzel	308A/568	10.0094179	0.0115850	01-0010-0026-0000
Randal Ralph Steele, Sr. a/k/a Randy Steele Sr., a married man dealing in his sole and separate property	SWN Production Company, LLC	11/23/2022	Wetzel	308A/586	0.4925670	0.0005701	01-0010-0017-0000
Randal Ralph Steele, Sr. a/k/a Randy Steele Sr., a married man dealing in his sole and separate property	SWN Production Company, LLC	11/23/2022	Wetzel	308A/586	29.0854999	0.0336638	01-0010-0017-0001
Randal Ralph Steele, Sr. a/k/a Randy Steele Sr., a married man dealing in his sole and separate property	SWN Production Company, LLC	11/23/2022	Wetzel	308A/586	5.1736871	0.0059881	01-0010-0017-0004
Randal Ralph Steele, Sr. a/k/a Randy Steele Sr., a married man dealing in his sole and separate property	SWN Production Company, LLC	11/23/2022	Wetzel	308A/586	10.0094179	0.0115850	01-0010-0026-0000
Joshua T. Elifritz	SWN Production Company, LLC	11/15/2022	Wetzel	308A/580	0.4925670	0.0000285	01-0010-0017-0000
Joshua T. Elifritz	SWN Production Company, LLC	11/15/2022	Wetzel	308A/580	29.0854999	0.0016832	01-0010-0017-0001
Joshua T. Elifritz	SWN Production Company, LLC	11/15/2022	Wetzel	308A/580	38.5000000	0.0022280	01-0010-0017-0002
Joshua T. Elifritz	SWN Production Company, LLC	11/15/2022	Wetzel	308A/580	5.1736871	0.0002994	01-0010-0017-0004
Joshua T. Elifritz	SWN Production Company, LLC	11/15/2022	Wetzel	308A/580	10.0094179	0.0005792	01-0010-0026-0000
Jordan T. Elifritz, a single man	SWN Production Company, LLC	11/15/2022	Wetzel	308A/574	0.4925670	0.0000285	01-0010-0017-0000
Jordan T. Elifritz, a single man	SWN Production Company, LLC	11/15/2022	Wetzel	308A/574	29.0854999	0.0016832	01-0010-0017-0001

09/29/2023

SEP 18 2023

WV Department of
Environmental Protection**EXHIBIT "A"**

Attached to and made a part of that certain Leasehold Commitment Agreement, dated July 27, 2023, by and
between,
and EQT Production Company and SWN Production Company, LLC.

Jordan T. Elifritz, a single man	SWN Production Company, LLC	11/15/2022	Wetzel	308A/574	38.5000000	0.0022280	01-0010-0017-0002
Jordan T. Elifritz, a single man	SWN Production Company, LLC	11/15/2022	Wetzel	308A/574	5.1736871	0.0002994	01-0010-0017-0004
Jordan T. Elifritz, a single man	SWN Production Company, LLC	11/15/2022	Wetzel	308A/574	10.0094179	0.0005792	01-0010-0026-0000
Sherald L. Hill, a married man dealing in his sole and separate property	SWN Production Company, LLC	11/14/2022	Wetzel	308A/539	0.4925670	0.0015203	01-0010-0017-0000
Sherald L. Hill, a married man dealing in his sole and separate property	SWN Production Company, LLC	11/14/2022	Wetzel	308A/539	29.0854999	0.0897701	01-0010-0017-0001
Sherald L. Hill, a married man dealing in his sole and separate property	SWN Production Company, LLC	11/14/2022	Wetzel	308A/539	38.5000000	0.1188272	01-0010-0017-0002
Sherald L. Hill, a married man dealing in his sole and separate property	SWN Production Company, LLC	11/14/2022	Wetzel	308A/539	5.1736871	0.0159682	01-0010-0017-0004
Sherald L. Hill, a married man dealing in his sole and separate property	SWN Production Company, LLC	11/14/2022	Wetzel	308A/539	10.0094179	0.0308933	01-0010-0026-0000
David L. Hill, a married man dealing in his sole and separate property	SWN Production Company, LLC	11/14/2022	Wetzel	308A/561	0.4925670	0.0007601	01-0010-0017-0000
David L. Hill, a married man dealing in his sole and separate property	SWN Production Company, LLC	11/14/2022	Wetzel	308A/561	29.0854999	0.0448850	01-0010-0017-0001
David L. Hill, a married man dealing in his sole and separate property	SWN Production Company, LLC	11/14/2022	Wetzel	308A/561	38.5000000	0.0594136	01-0010-0017-0002
David L. Hill, a married man dealing in his sole and separate property	SWN Production Company, LLC	11/14/2022	Wetzel	308A/561	5.1736871	0.0079841	01-0010-0017-0004

09/29/2023

EXHIBIT "A"

Attached to and made a part of that certain Leasehold Commitment Agreement, dated July 27, 2023, by and between,
and EQT Production Company and SWN Production Company, LLC.

SEP 18 2023

WV Department of
Environmental Protection

David L. Hill, a married man dealing in his sole and separate property	SWN Production Company, LLC	11/14/2022	Wetzel	308A/561	10.0094179	0.0154466	01-0010-0026-0000
Jena L. Richards, a married woman dealing in her sole and separate property	SWN Production Company, LLC	12/05/2022	Wetzel	309A/749	0.4925670	0.0007601	01-0010-0017-0000
Jena L. Richards, a married woman dealing in her sole and separate property	SWN Production Company, LLC	12/05/2022	Wetzel	309A/749	29.0854999	0.0448850	01-0010-0017-0001
Jena L. Richards, a married woman dealing in her sole and separate property	SWN Production Company, LLC	12/05/2022	Wetzel	309A/749	38.5000000	0.0594136	01-0010-0017-0002
Jena L. Richards, a married woman dealing in her sole and separate property	SWN Production Company, LLC	12/05/2022	Wetzel	309A/749	5.1736871	0.0079841	01-0010-0017-0004
Jena L. Richards, a married woman dealing in her sole and separate property	SWN Production Company, LLC	12/05/2022	Wetzel	309A/749	10.0094179	0.0154466	01-0010-0026-0000
Shelva L. Gorby, a widow	SWN Production Company, LLC	12/14/2022	Wetzel	312A/391	0.4925670	0.0006841	01-0010-0017-0000
Shelva L. Gorby, a widow	SWN Production Company, LLC	12/14/2022	Wetzel	312A/391	29.0854999	0.0403965	01-0010-0017-0001
Shelva L. Gorby, a widow	SWN Production Company, LLC	12/14/2022	Wetzel	312A/391	38.5000000	0.0534722	01-0010-0017-0002
Shelva L. Gorby, a widow	SWN Production Company, LLC	12/14/2022	Wetzel	312A/391	16.6925326	0.0231841	01-0010-0017-0003
Shelva L. Gorby, a widow	SWN Production Company, LLC	12/14/2022	Wetzel	312A/391	5.1736871	0.0071857	01-0010-0017-0004
Shelva L. Gorby, a widow	SWN Production Company, LLC	12/14/2022	Wetzel	312A/391	13.8994179	0.0193047	01-0010-0026-0000
Jeffrey A. Gorby, a married man dealing in his sole and separate property	SWN Production Company, LLC	01/05/2023	Wetzel	312A/397	0.4925670	0.0008552	01-0010-0017-0000

09/29/2023

EXHIBIT "A"

Attached to and made a part of that certain Leasehold Commitment Agreement, dated July 27, 2023, by and between,
and EQT Production Company and SWN Production Company, LLC.

Jeffrey A. Gorby, a married man dealing in his sole and separate property	SWN Production Company, LLC	01/05/2023	Wetzel	312A/397	29.0854999	0.0504957	01-0010-0017-0001
Jeffrey A. Gorby, a married man dealing in his sole and separate property	SWN Production Company, LLC	01/05/2023	Wetzel	312A/397	38.5000000	0.0668403	01-0010-0017-0002
Jeffrey A. Gorby, a married man dealing in his sole and separate property	SWN Production Company, LLC	01/05/2023	Wetzel	312A/397	16.6925326	0.0289801	01-0010-0017-0003
Jeffrey A. Gorby, a married man dealing in his sole and separate property	SWN Production Company, LLC	01/05/2023	Wetzel	312A/397	5.1736871	0.0089821	01-0010-0017-0004
Jeffrey A. Gorby, a married man dealing in his sole and separate property	SWN Production Company, LLC	01/05/2023	Wetzel	312A/397	13.8994179	0.0241309	01-0010-0026-0000
Sandra Himelrigh, a married woman dealing in her sole and separate property	SWN Production Company, LLC	01/06/2023	Wetzel	313A/42	0.4925670	0.0008552	01-0010-0017-0000
Sandra Himelrigh, a married woman dealing in her sole and separate property	SWN Production Company, LLC	01/06/2023	Wetzel	313A/42	29.0854999	0.0504957	01-0010-0017-0001
Sandra Himelrigh, a married woman dealing in her sole and separate property	SWN Production Company, LLC	01/06/2023	Wetzel	313A/42	38.5000000	0.0668403	01-0010-0017-0002
Sandra Himelrigh, a married woman dealing in her sole and separate property	SWN Production Company, LLC	01/06/2023	Wetzel	313A/42	16.6925326	0.0289801	01-0010-0017-0003
Sandra Himelrigh, a married woman dealing in her sole and separate property	SWN Production Company, LLC	01/06/2023	Wetzel	313A/42	5.1736871	0.0089821	01-0010-0017-0004
David Gorby, a single man	SWN Production Company, LLC	01/09/2023	Wetzel	313A/48	13.8994179	0.0241309	01-0010-0026-0000

09/29/2023

SEP 18 2023

EXHIBIT "A"Attached to and made a part of that certain Leasehold Commitment Agreement, dated July 27, 2023, by and
between,

and EQT Production Company and SWN Production Company, LLC.

WV Department of
Environmental Protection

Devin J. Elifritz, a single man	SWN Production Company, LLC	01/13/2023	Wetzel	314A/858	0.4925670	0.0000285	01-0010-0017-0000
Devin J. Elifritz, a single man	SWN Production Company, LLC	01/13/2023	Wetzel	314A/858	29.0854999	0.0016832	01-0010-0017-0001
Devin J. Elifritz, a single man	SWN Production Company, LLC	01/13/2023	Wetzel	314A/858	38.5000000	0.0022280	01-0010-0017-0002
Devin J. Elifritz, a single man	SWN Production Company, LLC	01/13/2023	Wetzel	314A/858	5.1736871	0.0002994	01-0010-0017-0004
Devin J. Elifritz, a single man	SWN Production Company, LLC	01/13/2023	Wetzel	314A/858	10.0094179	0.0005792	01-0010-0026-0000
Darrin Russell McLean a/k/a D. Rusty McLean, a married man dealing in his sole and separate property	SWN Production Company, LLC	03/11/2023	Wetzel	320A/643	0.4925670	0.0001425	01-0010-0017-0000
Darrin Russell McLean a/k/a D. Rusty McLean, a married man dealing in his sole and separate property	SWN Production Company, LLC	03/11/2023	Wetzel	320A/643	29.0854999	0.0084159	01-0010-0017-0001
Darrin Russell McLean a/k/a D. Rusty McLean, a married man dealing in his sole and separate property	SWN Production Company, LLC	03/11/2023	Wetzel	320A/643	38.5000000	0.0111400	01-0010-0017-0002
Darrin Russell McLean a/k/a D. Rusty McLean, a married man dealing in his sole and separate property	SWN Production Company, LLC	03/11/2023	Wetzel	320A/643	5.1736871	0.0014970	01-0010-0017-0004
Darrin Russell McLean a/k/a D. Rusty McLean, a married man dealing in his sole and separate property	SWN Production Company, LLC	03/11/2023	Wetzel	320A/643	10.0094179	0.0028962	01-0010-0026-0000
Dustin Rory McLean, a married man dealing in his	SWN Production Company, LLC	03/11/2023	Wetzel	320A/637	0.4925670	0.0001425	01-0010-0017-0000

09/29/2023

EXHIBIT "A"

Attached to and made a part of that certain Leasehold Commitment Agreement, dated July 27, 2023, by and between,
and EQT Production Company and SWN Production Company, LLC.

RECEIVED

Office of Oil and Gas

SEP 18 2023

sole and separate property							WV Department of Environmental Protection
Dustin Rory McLean, a married man dealing in his sole and separate property	SWN Production Company, LLC	03/11/2023	Wetzel	320A/637	29.0854999	0.0084159	01-0010-0017-0001
Dustin Rory McLean, a married man dealing in his sole and separate property	SWN Production Company, LLC	03/11/2023	Wetzel	320A/637	38.5000000	0.0111400	01-0010-0017-0002
Dustin Rory McLean, a married man dealing in his sole and separate property	SWN Production Company, LLC	03/11/2023	Wetzel	320A/637	5.1736871	0.0014970	01-0010-0017-0004
Dustin Rory McLean, a married man dealing in his sole and separate property	SWN Production Company, LLC	03/11/2023	Wetzel	320A/637	10.0094179	0.0028962	01-0010-0026-0000
Kermit W. Mason and Reva L. Mason, his wife	Columbia Natural Resources, L.L.C.	03/25/2005	Wetzel	84A/498	2.2510350	1.1255175	01-0004-0038-0000
John Joseph Mensore, a married man dealing in his sole and separate property	Chesapeake Appalachia, L.L.C.	04/27/2009	Wetzel	102A/96 100A/199	2.2010350	0.5500000	01-0004-0038-0000
Esta Marie Bean McCall, f/k/a Esta Marie Bean, a married woman dealing in her sole and separate property	Chesapeake Appalachia, L.L.C.	04/23/2009	Wetzel	102A/101 100A/200	2.2010350	0.5500000	01-0004-0038-0000
Kermit W. Mason and Reva L. Mason, his wife, Paul J. Shiben and Eleanor L. Shiben, his wife	Manufacturers Light & Heat Co	02/28/1962	Wetzel	46A/407	6.7501050	6.7501050	01-0004-0039-0000
Ernie J. Ramsey, single, Elmer Ramsey and Ethel L. Ramsey, his wife	Manufacturers Light & Heat Co	02/28/1962	Wetzel	45A/359	5.0830230	5.0830230	01-0004-0040-0000
O.W. Yeater and Ethel Yeater, husband and wife	Manufacturers Light and Heat Company	01/18/1962	Wetzel	45A/343	18.3516345	18.3516345	01-0007-0003-0000

09/29/2023

SEP 18 2023

EXHIBIT "A"

Attached to and made a part of that certain Leasehold Commitment Agreement, dated July 27, 2023, by and between
 between,
 and EQT Production Company and SWN Production Company, LLC.

O.W. Yeater and Ethel Yeater, husband and wife	Manufacturers Light & Heat Co	01/18/1962	Wetzel	45A/343	1.4147903	1.4147903	01-0007-0003-0001
O.W. Yeater and Ethel Yeater, husband and wife	Manufacturers Light and Heat Company	01/18/1962	Wetzel	45A/343	2.8750000	2.8750000	01-0007-0009-0002
Blake Realty, LLC	SWN Production Company, LLC	04/27/2017	Wetzel	191A/883	27.3141660	27.3141660	01-0007-0021-0000
Richard G. Postlethwait and Stella L. Postlethwait, husband and wife	SWN Production Company, LLC	07/17/2017	Wetzel	190A/590	14.7655930	7.3827965	01-0007-0022-0000
Christine A Ballard A Married Woman Dealing In Her Sole And Separate Property	SWN Production Company, LLC	04/04/2017	Wetzel	186A/235	0.5000000	0.5000000	01-0007-0032-0000
Raymond J Glover	SWN Production Company, LLC	11/05/2022	Wetzel	306A/418	29.0854999	0.0168319	01-0010-0017-0001
Linda M Leas	SWN Production Company, LLC	11/14/2022	Wetzel	308A/53	29.0854999	0.0201983	01-0010-0017-0001
Charles E Hill	SWN Production Company, LLC	03/21/2022	Wetzel	301A/269	38.5000000	0.1188272	01-0010-0017-0002
Raymond J Glover	SWN Production Company, LLC	11/05/2022	Wetzel	306A/418	38.5000000	0.0222801	01-0010-0017-0002
Linda M Leas	SWN Production Company, LLC	11/14/2022	Wetzel	308A/53	38.5000000	0.0267361	01-0010-0017-0002
Linda M Leas	SWN Production Company, LLC	11/14/2022	Wetzel	308A/53	16.6925326	0.0115920	01-0010-0017-0003
Charles E Hill	SWN Production Company, LLC	03/21/2022	Wetzel	301A/269	10.0094179	0.0308933	01-0010-0026-0000
Raymond J Glover	SWN Production Company, LLC	11/05/2022	Wetzel	306A/418	10.0094179	0.0057925	01-0010-0026-0000
Linda M Leas	SWN Production Company, LLC	11/14/2022	Wetzel	308A/53	13.8994179	0.0096524	01-0010-0026-0000
Shiben Estates, Inc.	SWN Production Company, LLC	07/16/2021	Wetzel	266A/259 271A/844	48.7500000	4.8750000	01-0010-0029-0000
Karen M. Nichols-Skoff & Michael	SWN Production Company, LLC	08/03/2021	Wetzel	267A/888	29.8700000	1.2445833	01-0010-0041-0000

09/29/2023

EXHIBIT "A"

Attached to and made a part of that certain Leasehold Commitment Agreement, dated July 27, 2023, by and between,
and EQT Production Company and SWN Production Company, LLC.

SEP 18 2023

WV Department of
Environmental Protection

Skoff, wife and husband							
Terry A. Nichols, Sr. & Susan Nichols, husband and wife	SWN Production Company, LLC	08/03/2021	Wetzel	267A/899	29.8700000	1.2445833	01-0010-0041-0000
Karen M. Nichols-Skoff & Michael Skoff, wife and husband	SWN Production Company, LLC	08/03/2021	Wetzel	267A/888	2.1400000	0.0891667	01-0010-0041-0001
Terry A. Nichols, Sr. & Susan Nichols, husband and wife	SWN Production Company, LLC	08/03/2021	Wetzel	267A/899	2.1400000	0.0891667	01-0010-0041-0001
Karen M. Nichols-Skoff & Michael Skoff, wife and husband	SWN Production Company, LLC	08/03/2021	Wetzel	267A/888	0.2400000	0.0100000	01-0010-0042-0000
Terry A. Nichols, Sr. & Susan Nichols, husband and wife	SWN Production Company, LLC	08/03/2021	Wetzel	267A/899	0.2400000	0.0100000	01-0010-0042-0000
Three Rivers Royalty II, LLC	SWN Production Company, LLC	04/22/2022	Wetzel	287A/910	10.7604470	1.3450559	01-0010-0049-0000B
Shiben Estates, Inc.	SWN Production Company, LLC	07/23/2021	Wetzel	271A/832 266A/265	16.5000000	8.2500000	01-0010-0050-0000
Clarence E. Miller, a single man	SWN Production Company, LLC	05/21/2021	Wetzel	267A/894	1.4380000	0.0080246	12-0010-0034-0000
Nancy C. Lucido, divorced	SWN Production Company, LLC	05/26/2021	Wetzel	262A/652	3.4800000	0.3480000	01-0010-0052-0001
Karen M. Nichols-Skoff & Michael Skoff, wife and husband	SWN Production Company, LLC	08/03/2021	Wetzel	267A/888	15.0000000	0.6250000	01-0010-0055-0000
Terry A. Nichols, Sr. & Susan Nichols, husband and wife	SWN Production Company, LLC	08/03/2021	Wetzel	267A/899	15.0000000	0.6250000	01-0010-0055-0000
Shiben Estates, Inc.	SWN Production Company, LLC	07/23/2021	Wetzel	271A/832 266A/265	44.0000000	22.0000000	01-0014-0003-0000
Shiben Estates, Inc.	SWN Production Company, LLC	07/23/2021	Wetzel	271A/832 266A/265	31.7500000	15.8750000	01-0014-0004-0000
Kimberly Dawn Haynes, a married woman dealing in her sole and separate property	SWN Production Company, LLC	02/25/2022	Wetzel	285A/316	20.0000000	0.4761905	01-0014-0006-0004

09/29/2023

EXHIBIT "A"

Attached to and made a part of that certain Leasehold Commitment Agreement, dated July 27, 2023, by and between,
and EQT Production Company and SWN Production Company, LLC.

Joel S. Steele	Antero Resources Corporation	12/12/2017	Wetzel	203A/565	0.1600000	0.0001111	01-0014-0018-0000
Joel S. Steele	Antero Resources Corporation	12/12/2017	Wetzel	203A/565	61.2500000	0.0425347	01-0014-0019-0000
Piney Holdings, Inc.	Antero Resources Corporation	06/07/2017	Wetzel	189A/40	43.0320000	5.3790000	01-0014-0019-0000
Shiben Estates, Inc.	SWN Production Company, LLC	07/16/2021	Wetzel	266A/257	80.0000000	40.0000000	01-0014-0028-0000
Brent Eugene Cain	SWN Production Company, LLC	09/26/2017	Wetzel	196A/251	1.7950210	0.0000194	01-0007-0030-0000
Sally L Carter	SWN Production Company, LLC	09/26/2017	Wetzel	196A/257	1.7950210	0.0000582	01-0007-0030-0000
Thomas Dean Cain	SWN Production Company, LLC	09/27/2017	Wetzel	194A/912	1.7950210	0.0000194	01-0007-0030-0000
Carroll Lee Persinger	SWN Production Company, LLC	09/12/2017	Wetzel	194A/906	1.7950210	0.0001745	01-0007-0030-0000
David Scott Cain	SWN Production Company, LLC	09/27/2017	Wetzel	194A/918	1.7950210	0.0000194	01-0007-0030-0000
William F. Miller and Gloria L. Miller, husband and wife	SWN Production Company, LLC	03/18/2022	Wetzel	285A/331	66.1500000	0.0215332	01-0014-0005-0000
Charles Pyles et al.	Earl M. Hennen	12/18/1912	Wetzel	3A/479	54.0000000	54.0000000	01-0007-0005-0000
Brc Minerals Lp And Brc Appalachian Minerals Llc	BRC Working Interest Company LLC	08/27/2009	Wetzel	102A/505 103A/320	18.0000000	12.1500000	01-0008-0030-0000
New Martinsville United Methodist Church	Antero Resources Corporation	04/08/2016	Wetzel	177A/138	61.2500000	7.6562500	01-0014-0019-0000

RECEIVED
Office of Oil and Gas
SEP 18 2023
WV Department of
Environmental Protection

09/29/2023

Execution Version



August 9, 2023

Jared Hurst
Antero Resources Corp
1615 Wynkoop St
Denver CO 80202

RECEIVED
Office of Oil and Gas

SEP 18 2023

WV Department of
Environmental Protection

RE: Drill Letter – Wetzel Co., WV

Dear Mr. Hurst:

1. Per our discussions, EQT Production Company, a Pennsylvania corporation (“**EQT Production**”), ET Blue Grass, LLC (“**ET Blue Grass**”), and together with EQT Production, “**EQT**”, and Antero Resources Corporation (“**ARC**”) (ARC and EQT may be referred to individually as a “**Party**” and collectively as the “**Parties**”), are currently negotiating a potential transaction for the exchange, assignment and/or granting of certain oil and gas leases in Wetzel and Tyler Counties, West Virginia (the “**Potential Transaction**”), to facilitate each of their respective drilling and development needs.

2. The Parties anticipate that in the Potential Transaction, ARC would assign and/or grant to EQT certain oil and gas leases in exchange for EQT (i) assigning and/or granting to ARC certain oil and gas leases and (ii) leasing to ARC certain fee interest oil and gas properties. The specific properties and amounts of properties to be exchanged will be specified in a definitive written agreement (if any) containing terms and conditions mutually acceptable to the Parties in their respective sole and absolute discretion (a “**Definitive Agreement**”).

3. The Parties anticipate that among the ARC oil and gas leases and fee interest oil and gas properties that may be included in the Potential Transaction are the oil and gas leases or portions thereof described on **Exhibit A** attached hereto, comprising approximately 75.21617 NRI Acres (the “**Drilling Leases**”). As used in this letter agreement, “**NRI Acres**” shall have the definition set forth on **Schedule 1**.

4. The Parties desire to accommodate EQT’s drilling and development of certain EQT units during the pendency of discussions and negotiations on, and in advance of the execution of, a Definitive Agreement and the closing of the Potential Transaction. Therefore, ARC hereby grants to EQT and/or its designated affiliates the right to drill, complete, produce, and obtain all necessary permits and governmental approvals, in order to drill, complete and produce one (1) or more wellbore laterals (“**Wells**”) through and in the Marcellus Formation of the lands covered by the Drilling Leases; **provided, however**, that ARC hereby expressly withholds to itself and its successors and assigns and does not grant to EQT (a) the right to complete in any formation covered by the Drilling Leases other than the Marcellus Formation (**provided** that EQT may drill through such formations) or (b) the right to access the surface of or to conduct surface operations on the lands covered by the Drilling Leases unless EQT enters into a separate agreement with the surface owner(s). As used in this letter agreement, “**Marcellus Formation**” shall have the definition set forth on **Schedule 1**.

09/29/2023

SEP 18 2023

WV Department of
Environmental Protection

5. EQT hereby agrees to indemnify, defend and hold harmless ARC and its affiliates, equityholders, subsidiaries or related companies (the "**Indemnified Parties**") for, from and against any and all Claims (as defined below) sustained by the Indemnified Parties resulting from or in connection with EQT's and/or its designated affiliates' activities with respect to the Drilling Leases, including, without limitation, the drilling of the Wells and EQT's development and operation of the Drilling Leases, that arise on or after the date of this letter agreement. "**Claims**" shall mean any and all losses, suits, proceedings, actions, causes of action, in law or at equity, demands, penalties, fines, fees, charges, assessments, liabilities (including environmental liabilities), damages (including environmental and natural resources damages), claims, judgments, executions, costs and expenses of any kind (including, without limitation, attorney's fees, expert's fees, court costs and other out-of-pocket fees and disbursements), fines, taxes, and interest, whether existing or incurred or asserted in the future, in connection with (a) any such claim or the defense thereof, (b) amounts paid in settlement, orders, liens, or decrees, or (c) any injury or damage of any kind and nature to persons (including sickness, illness and death), mines, wells, or property claims or to the Drilling Lease, or natural resources, and with respect to any of the foregoing, whether sustained or brought by or against EQT or any third party. Notwithstanding any of the foregoing, EQT shall have no obligation to indemnify the Indemnified Parties for any Claim to the extent arising out of an Indemnified Party's gross negligence or willful misconduct. The indemnity obligation set forth in this section shall survive (a) any execution of a Definitive Agreement or assignment of the Drilling Leases or other mutually agreed transaction pursuant to which EQT acquired any of the Drilling Leases, or (b) any termination of all or any part of this letter agreement; **provided**, that if the parties hereto enter into a JOA pursuant to this letter agreement, then this paragraph shall terminate and be of no further force and effect (with the terms and conditions of the JOA to govern the respective liability of the parties thereunder).

6. In the event that the Parties execute a Definitive Agreement on or before October 13, 2023 (the "**Execution Deadline**"), subject to Section 7 below, the Drilling Leases, limited to the Marcellus Formation, shall be included in and assigned at the closing of the Potential Transaction in accordance with the terms and conditions set forth in the Definitive Agreement; **provided, however**, that even if a Definitive Agreement is executed, the Drilling Leases shall be conveyed on an "as is, where is" basis and without representations or warranties of any kind whatsoever other than those expressly set forth in the applicable Definitive Agreement, and ARC hereby expressly disclaims any and all other representations and warranties with respect to the Drilling Leases. Further, EQT may not assert any title defects associated with net acres or Net Revenue Interest under the terms of the Definitive Agreement for the Drilling Leases. The foregoing provisions shall survive the execution of a Definitive Agreement or assignment of the Drilling Leases. The Parties may extend the Execution Deadline by mutual written agreement in order to continue to pursue the Potential Transaction discussions while reasonably accommodating each Party's ongoing development needs.

7. Prior to spudding any initial Well, EQT shall send to ARC an AFE (as defined in the JOA) for the initial Wells that EQT desires to drill. In the event that the Parties do not execute a Definitive Agreement on or before the Execution Deadline or in the event that a Definitive Agreement is executed but the Potential Transaction does not close on or before the Execution Deadline, then the Parties shall promptly (and in any event within five (5) business days after the Execution Deadline) enter into a mutually agreeable Joint Operating Agreement (the "**JOA**") based upon and in the form of the 2015 AAPL Model Form Operating Agreement, with the contract area(s) in EQT's sole discretion, effective as of the spud date and non-consent percentages being 400% for drilling costs and 200% for equipment costs. Contemporaneously with the execution of the mutually agreeable JOA, ARC shall elect either (a) to participate in the drilling of any and all Wells governed by the JOA and subject to and in accordance with the terms of the JOA, shall be responsible for its proportionate share of costs from and after the date hereof through the date the JOA is executed by ARC (and thereafter governed by the terms of the JOA), which may be offset against ARC's proportionate share of production from such Wells, or (b) to be a non-consenting party under the JOA (which shall be a non-consent election with respect to any and all wells governed by the JOA, whether or

09/29/2023

not covered by the AFE for the initial Well(s)). If ARC makes the election pursuant to the foregoing clause (b), then, contemporaneously with the execution of the JOA(s), ARC and EQT shall enter into an imbalance agreement covering those Drilling Leases subject to the JOA, the form of which attached hereto as **Exhibit B**.

8. If any assignment of the acreage is made, such properties shall be assigned and/or granted, as the case may be, free and clear of (a) all gathering or midstream dedications or commitments, and (b) all other senior mortgages, liens and encumbrances for which pre-closing waivers, releases or subordinations are customarily sought in transactions similar to the Potential Transaction.

9. If any assignment of the acreage is made, the assigning or leasing Party shall make available to the other Party, electronically on a digital file-sharing service, electronic copies of its lease and payment files pertaining to such acreage (the "**Records**").

10. Nothing in this letter agreement shall require the Parties to consummate a Potential Transaction, it being understood that any such Potential Transaction is subject to negotiation of a Definitive Agreement and approval by the Parties' respective senior management and boards of directors, as applicable, each in their sole and absolute discretion; **provided, however**, that in the absence of a Definitive Agreement, the Parties' respective obligations under Sections 4 through 11 hereof shall be fully enforceable.

11. Except as otherwise provided herein, this letter agreement and the rights and obligations of the Parties hereunder shall terminate if and when the Parties execute and deliver a Definitive Agreement and close the Potential Transaction thereunder. This letter agreement shall be governed by Pennsylvania law excluding any choice-of-law rules which would refer the matter to the laws of another jurisdiction. This letter agreement may be executed in any number of counterparts, each of which shall be considered an original for all purposes, and all of which, when taken together, shall constitute one and the same instrument, provided that this letter agreement but shall not be binding on any Party until fully executed by all Parties.

[Signature page follows]

RECEIVED
Office of Oil and Gas



SEP 18 2023

WV Department of
Environmental Protection



If the above meets your approval, please execute in the space provided below and return one signed copy to my attention. Should you have any questions, please contact Jarred Detweiler at (412) 660-6276.

Sincerely,

EQT PRODUCTION COMPANY

DocuSigned by:

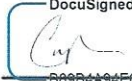
B89B4A94E0C846A... 
Name: Corey C. Peck
Title: Vice President - Land

ET BLUE GRASS, LLC

DocuSigned by:

B89B4A94E0C846A... 
Name: Corey C. Peck
Title: Vice President - Land

Acknowledged, accepted and agreed to on August 10, 2023.

ANTERO RESOURCES CORPORATION

Name: Aaron Merrick
Title: Chief Administrative Officer

RECEIVED
Office of Oil and Gas
SEP 18 2023
WV Department of
Environmental Protection

Signature Page to Drill Letter

09/29/2023

Schedule 1

Definitions

“**Marcellus Formation**” means the stratigraphic equivalent of those depths and formations underlying such leases (or portions of leases) from 500’ above the top of the Tully formation, as seen at 6943’ MD in the log for the BIG57H1 well located in Wetzel County, West Virginia (API No. 4710302414) down to 200’ below the top of the Onondaga formation, as seen in the log of such well at a depth of 7117’ MD.

“**Net Revenue Interest**” means, with respect to the Marcellus Formation of each Drilling Lease, the interest in and to all hydrocarbons produced and sold from the Marcellus Formation of such Drilling Lease, after giving effect to all royalties, overriding royalties, production payments, carried interests, net profits interests, reversionary interests and other similar burdens upon, measured by or payable out of production therefrom.

“**Net Working Interest Acreage**” means, computed separately with respect to each Drilling Lease and with respect to the Marcellus Formation, (i) the number of gross mineral acres in the lands included in or encumbered by such Drilling Lease, multiplied by (ii) the percent interest of oil, gas and associated hydrocarbons in such Drilling Lease owned by the lessor upon its execution, multiplied by (iii) the assigning Party’s Working Interest in the Drilling Lease as to the Marcellus Formation; **provided**, that if the Working Interest varies as to different areas within any tracts or parcels burdened by such Drilling Lease, a separate calculation shall be done for each area.

“**NRI Acres**” means, as computed separately with respect to each Drilling Lease, the (i) Net Working Interest Acreage, multiplied by (ii) the Party’s Net Revenue Interest.

“**Working Interest**” means with respect to any Drilling Lease, the percentage of costs and expenses associated with the operating rights and the exclusive right to exploit hydrocarbons from the Drilling Lease required to be borne with respect thereto, but, for clarity, without regard to the effect of any royalties, overriding royalties, production payments, carried interests, net profits interests, reversionary interests and other similar burdens upon, measured by or payable out of production therefrom

RECEIVED
Office of Oil and Gas

SEP 18 2023

WV Department of
Environmental Protection

09/29/2023

EXHIBIT A
Drilling Leases

Lease ID	Lease Fee	Lease Type	Lease Date	Lease Gross Acres	Conveyed Gross Acres	Retained Gross Acres	Royalty Interest	WI	NE	SE	SW	Conveyed	Retained	State	County	District	Block	Page	Conveyed Interest	Retained Interest	Split	Lease	Conveyed Instrument	Split Instrument
192831	Lease	HP	11/08/2018	52.125	52.125	0.00000	0.15	1.00	0.85	0.85	0.85	14.79000	22.80000	WV	Wayne	Center	2304	48B	1-14-31	None	None	X	X	X
192832	Lease	HP	07/24/2013	16.25	16.25	0.00000	0.15	1.00	0.85	0.85	14.79000	6.90250	6.90250	WV	Wayne	Center	2754	579	1-14-30	None	None	X	X	X
192833	Lease	HP	4/29/2012	16.25	16.25	0.00000	0.15	1.00	0.85	0.85	14.79000	6.62500	6.62500	WV	Wayne	Center	2804	476	1-14-30	None	None	X	X	X
192834	Lease	HP	11/7/2012	52.125	52.125	0.00000	0.2	1.00	0.85	0.85	14.79000	16.50000	16.50000	WV	Wayne	Center	3074	684	1-14-31	None	None	X	X	X
192835	Lease	HP	11/7/2012	52.125	52.125	0.00000	0.2	1.00	0.85	0.85	14.79000	16.50000	16.50000	WV	Wayne	Center	3074	684	1-14-31	None	None	X	X	X
192836	Lease	HP	7/20/2008	26.83	22.797	3.53300	0.125	1.00	0.875	0.875	5.69925	4.92884	4.92884	WV	Wayne	Center	914	717	1-18-10(aka 1-18-10, p/o 1-18-26, 1-18-25.1	All parcels not specifically listed in the "Conveyed Interest" Column are retained	None	X	X	X
192837	Lease	HP	2/20/2008	26.83	22.797	3.53300	0.125	1.00	0.875	0.875	5.69925	4.92884	4.92884	WV	Wayne	Center	914	721	1-18-10(aka 1-18-10, p/o 1-18-26, 1-18-25.1	All parcels not specifically listed in the "Conveyed Interest" Column are retained	None	X	X	X
192838	Lease	HP	2/20/2008	3.171	3.171	0.00000	0.125	1.00	0.875	0.875	1.58550	1.39731	1.39731	WV	Wayne	Center	994	46	1-18-25.1	None	None	X	X	X
192839	Lease	HP	6/28/2009	19.63	19.63	0.00000	0.125	1.00	0.875	0.875	2.4525	2.14659	2.14659	WV	Wayne	Center	1014	70	1-18-10(aka 1-18-10, p/o 1-18-26)	None	None	X	X	X
192840	Lease	HP	6/18/2000	19.63	19.63	0.00000	0.125	1.00	0.875	0.875	2.4525	2.14659	2.14659	WV	Wayne	Center	1014	17	1-18-10(aka 1-18-10, p/o 1-18-26)	None	None	X	X	X
192841	Lease	HP	6/21/2009	19.63	19.63	0.00000	0.125	1.00	0.875	0.875	4.90850	4.29349	4.29349	WV	Wayne	Center	1014	353	1-18-10(aka 1-18-10, p/o 1-18-26)	None	None	X	X	X

END OF EXHIBIT A

RECEIVED
Office of Oil and Gas
SEP 18 2023
WV Department of
Environmental Protection

09/29/2023

SEP 18 2023

WV Department of
Environmental Protection**EXHIBIT B****Form of Imbalance Agreement**

This Imbalance Agreement (this "Imbalance Agreement"), dated _____, 2023 (the "Execution Date"), is by and between Antero Resources Corporation, a Delaware corporation ("Antero"), and EQT Production Company, a Pennsylvania corporation ("EQT"). Each of Antero and EQT is a "Party" and together are the "Parties". For good and valuable consideration, the receipt and sufficiency of which are hereby acknowledged, the Parties agree as follows:

1. Permission Letter. Antero and EQT are parties to the letter agreement, dated June [], 2023 (as amended from time to time, the "Permission Letter"). Capitalized terms used but not defined in this Imbalance Agreement have the meanings given to them in the Permission Letter. This Imbalance Agreement is being delivered pursuant to Antero's election to non-consent to the drilling of a Well governed by a JOA.

2. JOA Imbalance. Pursuant to that certain JOA and at the execution of this Imbalance Agreement, (a) Antero assigned or leased, as applicable, [] NRI Acres of O&G Interests to Antero, resulting in an acreage imbalance as of the date hereof of [] NRI Acres owed by EQT to Antero (the "JOA Imbalance").

3. Reconciliation.

(a) The Parties agree that the JOA Imbalance shall be carried forward to be reconciled and satisfied in a future trade or other transaction between the Parties or their respective Affiliates wherein the Parties shall endeavor to mutually agree on oil and gas leases (or portions thereof) or fee mineral interests (or portions thereof) to be assigned or leased, as applicable, between the Parties.

(b) To the extent the JOA Imbalance is not reconciled and satisfied in full within thirty (30) days from the Execution Date, EQT shall deliver to Antero a reconciliation statement (the "Reconciliation Statement") setting forth (x) the JOA Imbalance (also reflective of any adjustments under this Section 3), and (y) setting forth a reasonably detailed calculation of the Final Payment in accordance with this Section 3(b).

- (i) If the adjusted JOA Imbalance is owed to EQT, then Antero shall owe to EQT \$5,000 per NRI Acre of such JOA Imbalance;
- (ii) If the adjusted JOA Imbalance is owed to Antero, then EQT shall owe to Antero \$5,000 per NRI Acre of such JOA Imbalance;

Based upon the amounts set forth in clauses (i) and (ii) above, EQT shall calculate and set forth on the Reconciliation Statement the net amount owed and the Party to whom such amount is owed. Such amount shall be the "Final Payment". The Party obligated to pay such amount is the "Shortfall Party", and the Party entitled to receive such amount is the "Overage Party". Within five (5) Business Days following Antero's receipt of the Reconciliation Statement, the Shortfall Party shall pay the Final Payment to the Overage Party to the account designated in writing by such Overage Party by wire transfer of immediately available funds.

09/29/2023

RECEIVED
Office of Oil and Gas

SEP 18 2023

WV Department of
Environmental Protection

4. Assignment. This Imbalance Agreement shall be binding upon and shall inure to the benefit of the Parties and their respective permitted successors and assigns. Notwithstanding the preceding sentence, neither of the Parties shall assign this Imbalance Agreement or be released from their rights or obligations hereunder without the other Party's prior written consent, with any assignment or delegation without such consent being void *ab initio*.

5. Entire Agreement. This Imbalance Agreement, together with the Permission Letter and JOA, constitutes the entire understanding of the Parties with respect to the subject matter hereof and thereof, superseding all related negotiations, prior discussions and prior agreements and understandings with respect to the subject matter hereof.

6. Severability. If a court of competent jurisdiction determines that any clause or provision of this Imbalance Agreement is void, illegal, or unenforceable, the other clauses and provisions of this Imbalance Agreement shall remain in full force and effect to the extent permitted by law and if commercially reasonable and consistent with the original intent of the Parties.

7. Advice of Counsel. The Parties acknowledge and represent that they have carefully read and know the contents of this Imbalance Agreement, fully understand its terms, have had the opportunity to consult legal counsel prior to signing this Imbalance Agreement, have been given a reasonable amount of time to enter this Imbalance Agreement, and enter into it voluntarily.

8. Governing Law.

(a) This Imbalance Agreement shall be governed by, construed, interpreted and applied in accordance with the laws of the State of Texas, excluding any choice of law rules which would refer the matter to the laws of another jurisdiction.

(b) The Parties agree that the appropriate, exclusive and convenient forum for any disputes between the Parties arising out of this Imbalance Agreement, the agreements and certificates delivered pursuant hereto and the transactions contemplated hereby or thereby shall be in any state or federal court in Houston, Texas and each of the Parties irrevocably submits to the jurisdiction of such courts solely in respect of any proceeding arising out of or related to this Imbalance Agreement. The Parties further agree that the Parties shall not bring suit with respect to any disputes arising out of this Imbalance Agreement, any agreement or certificate delivered pursuant hereto or the transactions contemplated hereby or thereby in any court or jurisdiction other than the above specified courts. The Parties further agree, to the extent permitted by law, that a final and nonappealable judgment against a Party in any action or proceeding contemplated above shall be conclusive and may be enforced in any other jurisdiction within or outside the United States by suit on the judgment, a certified or exemplified copy of which shall be conclusive evidence of the fact and amount of such judgment.

(c) THE PARTIES HERETO AGREE THAT THEY HEREBY KNOWINGLY, VOLUNTARILY AND INTENTIONALLY IRREVOCABLY WAIVE THE RIGHT TO TRIAL BY JURY IN ANY ACTION BASED HEREON, OR ARISING OUT OF, UNDER OR IN CONNECTION WITH THIS IMBALANCE AGREEMENT, ANY AGREEMENT OR CERTIFICATE DELIVERED

PURSUANT HERETO OR THE TRANSACTIONS CONTEMPLATED
HEREBY OR THEREBY.

9. Notices.

- (a) Any notice given hereunder shall be deemed to have been duly made and the receiving Party charged with notice (i) if personally delivered, when delivered, (ii) if mailed (which shall be certified mail, return receipt requested), when received or (iii) if sent by overnight courier, one day after sending. All notices shall be addressed as follows:

ANTERO:

Antero Resources Corporation
Attn: Aaron Merrick
1615 Wynkoop Street
Denver, Colorado 80202

With copies to:

Antero Resources Corporation
Attn: Yvette K. Schultz
1615 Wynkoop Street
Denver, Colorado 80202

and

Antero Resources Corporation
Attn: Jared Hurst
1615 Wynkoop Street
Denver, Colorado 80202

EQT:

EQT Production Company
Attn: Director – Business Development
EQT Plaza
625 Liberty Avenue, Suite 1700
Pittsburgh, PA 15222

With a copy to:

EQT Production Company
Attn: General Counsel
EQT Plaza
625 Liberty Avenue, Suite 1700
Pittsburgh, PA 15222

- (b) Each Party may change its address at any time and from time to time by giving written notice to the other Party.

10. Further Assurances. From and after the Execution Date, at the request of a Party, the other Party shall without additional consideration execute and deliver or use reasonable efforts to cause to be

RECEIVED
Office of Oil and Gas

SEP 18 2023

WV Department of
Environmental Protection

executed and delivered such other instruments of conveyance and take such other actions as the requesting Party reasonably may request to otherwise accomplish the transactions contemplated by this Imbalance Agreement.

11. Counterpart Execution. This Imbalance Agreement may be executed in a number of counterparts, each of which shall be considered an original for all purposes, but shall not be binding until fully executed by all Parties. Execution of this Imbalance Agreement by an electronic form of signature (including .PDFs) that is an exact copy of the original signature shall be deemed to be, and shall have the same effect as, execution by original signature.

[Signature pages follow.]

RECEIVED
Office of Oil and Gas
SEP 18 2023
WV Department of
Environmental Protection

Certificate Of Completion

Envelope Id: FBF2B60202DA4D6CA6706241E356014D Status: Completed
 Subject: Complete with DocuSign: Standalone ARC Drill letter with EQT (Haggard) (Execution Version 8.9.2...
 Source Envelope:
 Document Pages: 10 Signatures: 2 Envelope Originator:
 Certificate Pages: 2 Initials: 4 Jarred Detweiler
 AutoNav: Enabled 625 Liberty Ave Ste 1700
 Envelopeld Stamping: Enabled Pittsburgh, PA 15222
 Time Zone: (UTC-05:00) Eastern Time (US & Canada) jdetweiler@eqt.com
IP Address: 100.6.90.208

Record Tracking

Status: Original Holder: Jarred Detweiler Location: DocuSign
 8/10/2023 11:20:08 AM jdetweiler@eqt.com

Signer Events

Jarred Detweiler
 jdetweiler@eqt.com
 Landman IV
 EQT Corporation
 Security Level: Email, Account Authentication (None)

Signature

 Signature Adoption: Pre-selected Style
 Using IP Address: 136.226.49.7

Timestamp

Sent: 8/10/2023 11:21:36 AM
 Viewed: 8/10/2023 11:21:50 AM
 Signed: 8/10/2023 11:22:01 AM

RECEIVED
 Office of Oil and Gas
 SEP 18 2023

Electronic Record and Signature Disclosure:
 Not Offered via DocuSign

Matt Eller
 meller@eqt.com
 Land BD Director
 EQT Corporation
 Security Level: Email, Account Authentication (None)

 Signature Adoption: Pre-selected Style
 Using IP Address: 136.226.53.18

Sent: 8/10/2023 11:22:04 AM WV Department of
 Viewed: 8/10/2023 11:57:15 AM Environmental Protection
 Signed: 8/10/2023 11:57:42 AM

Electronic Record and Signature Disclosure:
 Not Offered via DocuSign

Corey C Peck
 cpeck@eqt.com
 Authorized Agent
 EQT Corporation
 Security Level: Email, Account Authentication (None)

DocuSigned by:
 B89B4A94E0C646A...
 Signature Adoption: Uploaded Signature Image
 Using IP Address: 71.60.184.26
 Signed using mobile

Sent: 8/10/2023 11:57:45 AM
 Viewed: 8/10/2023 5:18:22 PM
 Signed: 8/10/2023 5:18:26 PM

Electronic Record and Signature Disclosure:
 Not Offered via DocuSign

In Person Signer Events	Signature	Timestamp
Editor Delivery Events	Status	Timestamp
Agent Delivery Events	Status	Timestamp
Intermediary Delivery Events	Status	Timestamp
Certified Delivery Events	Status	Timestamp
Carbon Copy Events	Status	Timestamp

09/29/2023

Witness Events	Signature	Timestamp
Notary Events	Signature	Timestamp
Envelope Summary Events	Status	Timestamps
Envelope Sent	Hashed/Encrypted	8/10/2023 11:21:36 AM
Certified Delivered	Security Checked	8/10/2023 5:18:22 PM
Signing Complete	Security Checked	8/10/2023 5:18:26 PM
Completed	Security Checked	8/10/2023 5:18:26 PM
Payment Events	Status	Timestamps

RECEIVED
Office of Oil and Gas

SEP 18 2023

WV Department of
Environmental Protection

09/29/2023



July 27, 2023

VIA ELECTRONIC MAIL

Mike Lipari
Tribune Resources, LLC
3861 Ambassador Caffery Parkway, Suite 600
Lafayette, Louisiana 70503

RECEIVED
Office of Oil and Gas

SEP 18 2023

WV Department of
Environmental Protection

RE: Acreage Trade Agreement – Drill Letter – Wetzel County, WV

Dear Mr. Lipari:

1. EQT Production Company, a Pennsylvania corporation ("**EQT**"), and Tribune Resources, LLC, an Oklahoma limited liability company, and Tribune Resources Minerals, LLC, an Oklahoma limited liability company (together, "**Tribune**") (Tribune and EQT may be referred to individually as a "**Party**" and collectively as the "**Parties**"), have entered into an Acreage Trade Agreement dated May 3, 2023 (the "**Definitive Agreement**") for the exchange, assignment and/or granting of certain oil and gas leases in Wetzel, Doddridge, and Harrison Counties, West Virginia (the "**Transaction**") to facilitate each of their respective drilling and development needs.

2. Subject to the terms of the Definitive Agreement, the Parties have agreed that upon the closing of the Transaction, Tribune will assign and/or grant to EQT certain oil and gas leases in exchange for EQT assigning and/or granting to Tribune certain oil and gas leases. The specific properties and amounts of properties to be exchanged are specified in the Definitive Agreement, which contains terms and conditions mutually acceptable to the Parties in their respective sole and absolute discretion.

3. The Parties anticipate that among the Tribune oil and gas leases that are included in the Transaction are the oil and gas leases or portions thereof described on **Exhibit A** attached hereto, comprising approximately 214.22625 NRI Acres (the "**Drilling Leases**") (further subject to title due diligence being performed in accordance with the Definitive Agreement). As used in this letter agreement, "**NRI Acres**" shall have the definition set forth on **Schedule 1**.

4. The Parties desire to accommodate EQT's drilling and development of certain EQT units during the completion of title due diligence on the Drilling Leases, and in advance of the closing of the Transaction. Therefore, Tribune hereby grants to EQT and/or its designated affiliates the limited right to permit and, upon receipt of all necessary permits and government approvals, to horizontally drill, complete and produce one (1) or more wellbore laterals ("**Wells**") through and in the Marcellus Formation of the lands covered by the Drilling Leases; **provided, however**, that Tribune hereby expressly withholds to itself and its successors and assigns and does not grant to EQT (a) all rights regarding any formation covered by the Drilling Leases other than the Marcellus Formation, (b) the right to access the surface of or to conduct surface operations on the lands covered by the Drilling Leases unless EQT enters into a separate agreement with the applicable surface owner(s), and (c) any other rights or interests withheld, reserved or retained by

09/29/2023

SEP 18 2023

WV Department of
Environmental Protection

Tribune pursuant to the terms of the Definitive Agreement. As used in this letter agreement, "**Marcellus Formation**" shall have the definition set forth on **Schedule 1**.

5. EQT hereby agrees to indemnify, release, defend and hold harmless Tribune and its affiliates, and any officer, director, employee, agent, consultant, representative or advisor of Tribune or its affiliates (the "**Indemnified Parties**") for, from and against any and all Claims (as defined below) that may be sustained by the Indemnified Parties or otherwise brought by any third party against the Indemnified Parties, in each case, resulting from or in connection with EQT's and/or its designated affiliates' activities with respect to the Drilling Leases, including, without limitation, the drilling of the Wells, the development and operation of the Drilling Leases and any other operations performed pursuant to this letter agreement, that arise on or after the date of this letter agreement. FOR THE AVOIDANCE OF DOUBT, THIS **SECTION 5 DOES NOT IN ANY WAY AMEND OR OTHERWISE MODIFY ANY ASSUMED LIABILITY, INDEMNITY OBLIGATION OR OTHER PROVISION OF THE DEFINITIVE AGREEMENT REGARDING THE DRILLING LEASES OR THE WELLS, WHICH SHALL REMAIN SUBJECT TO THE TERMS OF THE TRADE AGREEMENT FOR ALL PURPOSES THEREUNDER.** "**Claims**" shall mean any and all losses, suits, proceedings, actions, causes of action, in law or at equity, demands, penalties, fines, fees, charges, assessments, liabilities (including environmental liabilities), damages (including environmental and natural resources damages), claims, judgments, executions, costs and expenses of any kind (including, without limitation, attorney's fees, expert's fees, court costs and other out-of-pocket fees and disbursements), fines, taxes, and interest, whether existing or incurred or asserted in the future, in connection with (a) any such claim or the defense thereof, (b) amounts paid in settlement, orders, liens, or decrees, or (c) any injury or damage of any kind and nature to persons (including sickness, illness and death), mines, wells, or property claims or to the Drilling Lease, or natural resources, and with respect to any of the foregoing, whether sustained or brought by or against Tribune or any third party. Notwithstanding any of the foregoing, EQT shall have no obligation to indemnify Tribune Indemnified Parties for any Claim to the extent such Claim is judicially determined to arise solely out of a Tribune Indemnified Party's gross negligence or willful misconduct. The indemnity obligation set forth in this section shall survive any termination of all or any part of this letter agreement.

6. In the event that the Parties close the Transaction on or before September 30, 2023 or such later date as mutually agreed by the Parties in accordance with the Definitive Agreement (the "**Closing Deadline**"), subject to **Section 7** below, the Drilling Leases, limited to the Marcellus Formation, shall be included in and assigned at the closing of the Transaction in accordance with the terms and conditions set forth in the Definitive Agreement.

7. In the event that the Parties do not close on or before the Closing Deadline, then Tribune shall promptly transfer (and in any event within 5 business days after the Closing Deadline) to EQT the Drilling Leases via an assignment in substantially the same form as the assignment attached to the Definitive Agreement as Exhibit C (subject to such modifications as are reasonable and necessary to reflect the assignment of the Drilling Leases) and EQT shall contemporaneously remit to Tribune an amount equal to \$7,500.00 per NRI Acre of the Drilling Leases (such transaction, a "Drilling Lease Transaction"). In the event the Parties proceed with a Drilling Lease Transaction, the closing of such Drilling Lease Transaction shall be subject to the same terms and conditions as the closing transaction contemplated in the Definitive Agreement, limited only to the extent reasonable and necessary to reflect the agreements set forth in this **Section 7**.

8. If any assignment of acreage is made pursuant to this agreement or the imbalance agreement, such properties shall be assigned and/or granted, as the case may be, free and clear of (a) all gathering or midstream dedications or commitments, and (b) all other senior mortgages, liens and encumbrances for which pre-closing waivers, releases or subordinations are customarily sought in transactions similar to the Potential Transaction.

09/29/2023

9. Except as otherwise provided herein (including Section 5 hereof), this letter agreement and the rights and obligations of the Parties hereunder shall terminate upon the earlier of the closing of the transaction contemplated under the terms of the Definitive Agreement, the closing of a Drilling Lease Transaction or the mutual written agreement of the Parties. This letter agreement shall be governed by Pennsylvania law excluding any choice-of-law rules which would refer the matter to the laws of another jurisdiction and except to the extent that the laws of the State of West Virginia are mandatorily applicable in connection with the assignment or leasing of real property located in the State of West Virginia. This letter agreement may be executed in any number of counterparts, each of which shall be considered an original for all purposes, and all of which, when taken together, shall constitute one and the same instrument, provided that this letter agreement but shall not be binding on any Party until fully executed by all Parties.

If the above meets your approval, please execute in the space provided below and return one signed copy to my attention. Should you have any questions, please contact Greg Godbey at (724) 802-2353.

Sincerely,

EQT Production Company

DocuSigned by:

AB96C2046F2D4D6...
Greg Godbey, CPL

[SIGNATURE PAGE TO FOLLOW]

09/29/2023

Tribune Resources, LLC

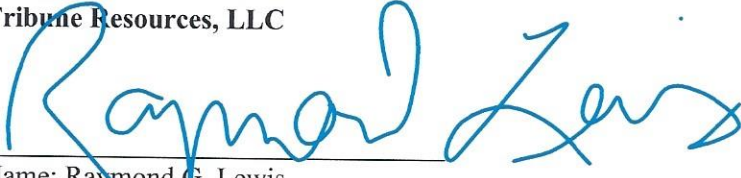

Name: Raymond G. Lewis
Title: CFO

Tribune Resources Minerals, LLC

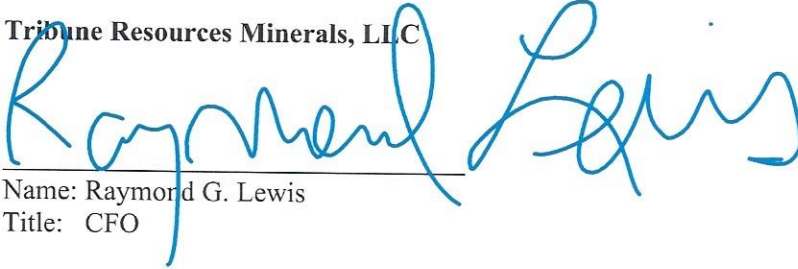

Name: Raymond G. Lewis
Title: CFO

EQT Production Company

DocuSigned by:

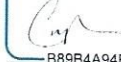

By:

889B4A94E0C646A

Name: Corey C. Peck
Title: Vice President of Land

DS
GG

DS
ME

RECEIVED
Office of Oil and Gas
SEP 18 2023
WV Department of
Environmental Protection

09/29/2023

Schedule 1

Definitions

“Marcellus Formation” means the stratigraphic equivalent of those depths and formations below the top of the Marcellus formation, at a depth of 7,066 feet MD, to the base of the Onondaga formation, at a depth of 7,347 feet MD, as seen by the J M Allen, et al, #511391, API 4710302414, Wetzel County, West Virginia.

“Net Revenue Interest” means, with respect to each Marcellus Leasehold Right and Marcellus Leased Fee Mineral Interest, the interest in and to all Hydrocarbons produced from or attributable to such Marcellus Leasehold Right or such Marcellus Leased Fee Mineral Interest, as applicable, after giving effect to all Burdens.

“NRI Acreage” or **“NRI Acres”** means, with respect to each Marcellus Leasehold Right or Marcellus Leased Fee Mineral Interest, as applicable, the Net Acreage covered by such Marcellus Leasehold Right or Marcellus Leased Fee Mineral Interest, as applicable, multiplied by the Assigning Party’s Net Revenue Interest in such Marcellus Leasehold Right or Marcellus Leased Fee Mineral Interest, as applicable.

RECEIVED
Office of Oil and Gas

SEP 18 2023

WV Department of
Environmental Protection

09/29/2023

EXHIBIT A
Drilling Leases

[See attached.]

RECEIVED
Office of Oil and Gas

SEP 18 2023

WV Department of
Environmental Protection

09/29/2023

Exhibit A - Part I
Tribune Leases (other than Tribune Partial Leases)

LEASE_TRACT	Lessor	Lessee	Lease Date	Expiration Date	Township Name	Tract - Tax Parcel	Gross	Company Net	Marcellus Co Net	Royalty	ORRI	Lease NRI	Company NRI	NRI Acres	Book	Page
MARC00035-001_001	CANDICE LOU BOOKHART	AMERICAN ENERGY - MARCELLUS, LLC	9/26/2014	9/26/2024	CENTER - WETZEL, WV	01-14-50, 01-18-24, 01-18-26	60.309891	0.153845	0.153845	0.125	0	0.875	0.875	0.134614375	157A	306
MARC00035-001_003	CANDICE LOU BOOKHART	AMERICAN ENERGY - MARCELLUS, LLC	9/26/2014	9/26/2024	CENTER - WETZEL, WV	01-18-26	18.020109	0.045967	0.045967	0.125	0	0.875	0.875	0.040221125	157A	306
MARC00041-001_001	JOHN DOUGLAS CHILDERS	HG ENERGY, LLC	9/15/2014	9/15/2024	CENTER - WETZEL, WV	01-18-24, 01-18-26	44.229891	0.902644	0.902644	0.125	0	0.875	0.875	0.7898135	169A	322
MARC00041-001_003	JOHN DOUGLAS CHILDERS	HG ENERGY, LLC	9/15/2014	9/15/2024	CENTER - WETZEL, WV	01-18-26	18.020109	0.367754	0.367754	0.125	0	0.875	0.875	0.32178475	169A	322
MARC00042-001_001	JULIENNE ANNA BUSCHO	HG ENERGY, LLC	9/26/2014	9/26/2024	CENTER - WETZEL, WV	01-14-50, 01-18-24, 01-18-26	60.309891	0.233526	0.233526	0.125	0	0.875	0.875	0.20433525	169A	325
MARC00042-001_003	JULIENNE ANNA BUSCHO	HG ENERGY, LLC	9/26/2014	9/26/2024	CENTER - WETZEL, WV	01-18-26	18.020109	0.069776	0.069776	0.125	0	0.875	0.875	0.061054	169A	325
MARC00043-001_001	NELSON V. & PAULIA S. ROGERS	HG ENERGY, LLC	8/26/2014	8/26/2024	CENTER - WETZEL, WV	01-18-24, 01-18-26	44.229891	3.610592	3.610592	0.125	0	0.875	0.875	3.159268	169A	328
MARC00043-001_003	NELSON V. & PAULIA S. ROGERS	HG ENERGY, LLC	8/26/2014	8/26/2024	CENTER - WETZEL, WV	01-18-26	18.020109	1.471025	1.471025	0.125	0	0.875	0.875	1.287146875	169A	328
MARC00049-001_001	MELANIE LOHMAN, A MARRIED WOMAN	AMERICAN ENERGY - MARCELLUS, LLC	10/6/2014	10/6/2024	CENTER - WETZEL, WV	01-14-50, 01-18-24, 01-18-26	60.309891	0.153835	0.153835	0.125	0	0.875	0.875	0.134605625	157A	300
MARC00049-001_003	MELANIE LOHMAN, A MARRIED WOMAN	AMERICAN ENERGY - MARCELLUS, LLC	10/6/2014	10/6/2024	CENTER - WETZEL, WV	01-18-26	18.020109	0.045965	0.045965	0.125	0	0.875	0.875	0.040219375	157A	300
MARC00050-001_001	RYAN LEE REINECKER, A SINGLE MAN	AMERICAN ENERGY - MARCELLUS, LLC	10/13/2014	10/13/2024	CENTER - WETZEL, WV	01-14-50, 01-18-24, 01-18-26	60.309891	0.153835	0.153835	0.125	0	0.875	0.875	0.134605625	157A	303
MARC00050-001_003	RYAN LEE REINECKER, A SINGLE MAN	AMERICAN ENERGY - MARCELLUS, LLC	10/13/2014	10/13/2024	CENTER - WETZEL, WV	01-18-26	18.020109	0.045965	0.045965	0.125	0	0.875	0.875	0.040219375	157A	303
MARC00071-001_001	B. B. POSTLETHWAIT AND RHODA POSTLETHWAIT	SOUTH PENN OIL COMPANY	10/15/1900	10/15/1906	CENTER - WETZEL, WV	01-14-8, 01-14-19.1	41.25	41.25	41.25	0.125	0	0.875	0.875	36.09375	49	598
MARC01175-000_001	MARGARET J. WELCH AND JOHN WELCH, HER HU	W. P. VINCENT	2/16/1910	3/1/1911	GRANT - WETZEL, WV	04-28-46, 04-28-46.1	50	50	50	0.125	0	0.875	0.875	43.75	107	412
MARC03004-001_001	BOBBI LYNN TYLER	AMERICAN ENERGY - MARCELLUS, LLC	12/11/2014	12/11/2019	CENTER - WETZEL, WV	01-14-50, 01-18-24, 01-18-26	60.309891	0.276099	0.276099	0.125	0	0.875	0.875	0.241586625	160A	807
MARC03004-001_003	BOBBI LYNN TYLER	AMERICAN ENERGY - MARCELLUS, LLC	12/11/2014	12/11/2019	CENTER - WETZEL, WV	01-18-26	18.020109	0.082496	0.082496	0.125	0	0.875	0.875	0.072184	160A	807
MARC03005-001_001	DANIEL & ELIZABETH SHACKLETON	AMERICAN ENERGY - MARCELLUS, LLC	11/26/2014	11/26/2019	CENTER - WETZEL, WV	01-18-24, 01-18-27	62.25	1.0163	1.0163	0.125	0	0.875	0.875	0.8892625	161A	424
MARC03008-001_001	DAVID RYAN CRISWELL	AMERICAN ENERGY - MARCELLUS, LLC	11/21/2014	11/20/2019	CENTER - WETZEL, WV	01-14-50, 01-18-24, 01-18-26	60.309891	0.153832	0.153832	0.125	0	0.875	0.875	0.134603	161A	472
MARC03008-001_003	DAVID RYAN CRISWELL	AMERICAN ENERGY - MARCELLUS, LLC	11/21/2014	11/20/2019	CENTER - WETZEL, WV	01-18-26	18.020109	0.045964	0.045964	0.125	0	0.875	0.875	0.0402185	161A	472
MARC03008-002_001	JOHN E. & TAMMY STEENERSON	HG ENERGY, LLC	9/12/2014	9/12/2024	CENTER - WETZEL, WV	01-14-50, 01-18-24, 01-18-26	60.309891	0.053664	0.053664	0.125	0	0.875	0.875	0.046956	169A	315
MARC03008-002_003	JOHN E. & TAMMY STEENERSON	HG ENERGY, LLC	9/12/2014	9/12/2024	CENTER - WETZEL, WV	01-18-26	18.020109	0.016034	0.016034	0.125	0	0.875	0.875	0.01402975	169A	315
MARC03017-001_001	JUNE A. TUCKER 2012 REVOCABLE TRUST	AMERICAN ENERGY - MARCELLUS, LLC	12/4/2014	12/4/2019	CENTER - WETZEL, WV	01-18-26	34.979891	2.001807	2.001807	0.17	0	0.83	0.83	1.66149981	164A	930
MARC03017-001_002	JUNE A. TUCKER 2012 REVOCABLE TRUST	AMERICAN ENERGY - MARCELLUS, LLC	12/4/2014	12/4/2019	CENTER - WETZEL, WV	01-18-24	9.25	3.03305	3.03305	0.17	0	0.83	0.83	2.5174315	164A	930
MARC03017-001_003	JUNE A. TUCKER 2012 REVOCABLE TRUST	AMERICAN ENERGY - MARCELLUS, LLC	12/4/2014	12/4/2019	CENTER - WETZEL, WV	01-14-50	16.08	5.272589	5.272589	0.17	0	0.83	0.83	4.37624887	164A	930
MARC03017-001_005	JUNE A. TUCKER 2012 REVOCABLE TRUST	AMERICAN ENERGY - MARCELLUS, LLC	12/4/2014	12/4/2019	CENTER - WETZEL, WV	01-18-26	18.020109	1.031243	1.031243	0.17	0	0.83	0.83	0.85593169	164A	930

MARCO3216-000_001	NEWELL FAMILY TRUST	AMERICAN ENERGY - MARCELLUS, LLC	9/22/2014	9/22/2017	CENTER - WETZEL, WV	01-18-26	34.979891	1.943324	1.943324	1.943324	0.15	0	0.85	0.85	1.6518254	156A	445
MARCO3216-000_003	NEWELL FAMILY TRUST	AMERICAN ENERGY - MARCELLUS, LLC	9/22/2014	9/22/2017	CENTER - WETZEL, WV	01-18-26	18.020109	1.001116	1.001116	1.001116	0.15	0	0.85	0.85	0.8509486	156A	445
MARCO3536-000_001	VIRGINIA G. CROW	ASCENT RESOURCES - MARCELLUS, LLC	5/31/2016	5/31/2026	CLAY - WETZEL, WV	03-4-46	77.75	4.319444	4.319444	4.319444	0.14	0	0.86	0.86	3.71472184	176A	753
MARCO3537-000_001	ROY LEE & EVA V RICE	ASCENT RESOURCES - MARCELLUS, LLC	6/2/2016	6/2/2026	CLAY - WETZEL, WV	03-4-46	77.75	1.851191	1.851191	1.851191	0.14	0	0.86	0.86	1.59202426	176A	756
MARCO3538-000_001	GEORGE DWAYNE RICE	ASCENT RESOURCES - MARCELLUS, LLC	6/2/2016	6/2/2026	CLAY - WETZEL, WV	03-4-46	77.75	1.851191	1.851191	1.851191	0.14	0	0.86	0.86	1.59202426	176A	759
MARCO3541-000_001	NORMA M. WOOD, A WIDOW	ASCENT RESOURCES - MARCELLUS, LLC	5/13/2016	5/13/2026	CLAY - WETZEL, WV	03-4-46	77.75	11.10714	11.10714	11.10714	0.14	0	0.86	0.86	9.5521404	175A	944
MARCO3548-000_001	RONALD LYN AND MARY L. JOHNS	ASCENT RESOURCES - MARCELLUS, LLC	6/20/2016	5/31/2026	CLAY - WETZEL, WV	03-4-46	77.75	0.205688	0.205688	0.205688	0.14	0	0.86	0.86	0.17689168	177A	948
MARCO3549-000_001	LINDA I. & MARK A. SMITH	ASCENT RESOURCES - MARCELLUS, LLC	6/23/2016	6/23/2026	CLAY - WETZEL, WV	03-4-46	77.75	1.85119	1.85119	1.85119	0.14	0	0.86	0.86	1.5920234	177A	945
MARCO3676-001_001	REBECCA OLSON, A SINGLE WOMAN	HG ENERGY, LLC	8/1/2014	8/1/2024	CENTER - WETZEL, WV	01-18-24, 01-18-26	44.229891	0.902361	0.902361	0.902361	0.125	0	0.875	0.875	0.789565875	154A	149
MARCO3676-001_003	REBECCA OLSON, A SINGLE WOMAN	HG ENERGY, LLC	8/1/2014	8/1/2024	CENTER - WETZEL, WV	01-18-26	18.020109	0.367639	0.367639	0.367639	0.125	0	0.875	0.875	0.321684125	154A	149
MARCO3676-002_001	NEWT AND KATHERINE WAKEMAN	HG ENERGY, LLC	8/1/2014	8/1/2024	CENTER - WETZEL, WV	01-18-24, 01-18-26	44.229891	0.902645	0.902645	0.902645	0.125	0	0.875	0.875	0.789814375	154A	214
MARCO3676-002_003	NEWT AND KATHERINE WAKEMAN	HG ENERGY, LLC	8/1/2014	8/1/2024	CENTER - WETZEL, WV	01-18-26	18.020109	0.367755	0.367755	0.367755	0.125	0	0.875	0.875	0.321785625	154A	214
MARCO3676-003_001	MACK MAURICE AND DONDEENA J. CALDWELL	HG ENERGY, LLC	8/5/2014	8/5/2024	CENTER - WETZEL, WV	01-18-24, 01-18-26	44.229891	0.294198	0.294198	0.294198	0.125	0	0.875	0.875	0.63183925	154A	937
MARCO3676-003_003	MACK MAURICE AND DONDEENA J. CALDWELL	HG ENERGY, LLC	8/5/2014	8/5/2024	CENTER - WETZEL, WV	01-18-26	18.020109	0.294198	0.294198	0.294198	0.125	0	0.875	0.875	0.25742325	154A	932
MARCO3676-004_001	JANET LAWRENCE, A SINGLE WOMAN	HG ENERGY, LLC	8/4/2014	8/4/2024	CENTER - WETZEL, WV	01-18-24, 01-18-26	44.229891	0.722102	0.722102	0.722102	0.125	0	0.875	0.875	0.789565875	154A	489
MARCO3676-004_003	JANET LAWRENCE, A SINGLE WOMAN	HG ENERGY, LLC	8/4/2014	8/4/2024	CENTER - WETZEL, WV	01-18-26	18.020109	0.367639	0.367639	0.367639	0.125	0	0.875	0.875	0.321684125	154A	489
MARCO3676-005_001	COLLEEN OLSON, A SINGLE WOMAN	HG ENERGY, LLC	8/1/2014	8/1/2024	CENTER - WETZEL, WV	01-18-24, 01-18-26	44.229891	0.180543	0.180543	0.180543	0.125	0	0.875	0.875	0.157975125	155A	280
MARCO3676-005_003	COLLEEN OLSON, A SINGLE WOMAN	HG ENERGY, LLC	8/1/2014	8/1/2024	CENTER - WETZEL, WV	01-18-26	18.020109	0.073557	0.073557	0.073557	0.125	0	0.875	0.875	0.064362375	155A	280
MARCO3676-006_001	BRUCE LESTER CALDWELL, A DIVORCED MAN	HG ENERGY, LLC	9/15/2014	9/15/2024	CENTER - WETZEL, WV	01-18-24, 01-18-26	44.229891	0.180543	0.180543	0.180543	0.125	0	0.875	0.875	0.157975125	155A	286
MARCO3676-006_003	BRUCE LESTER CALDWELL, A DIVORCED MAN	HG ENERGY, LLC	9/15/2014	9/15/2024	CENTER - WETZEL, WV	01-18-26	18.020109	0.073557	0.073557	0.073557	0.125	0	0.875	0.875	0.064362375	155A	286
MARCO3676-007_001	BRENT AND TERRY LYNN CALDWELL	HG ENERGY, LLC	9/15/2014	9/15/2024	CENTER - WETZEL, WV	01-18-24, 01-18-26	44.229891	0.180543	0.180543	0.180543	0.125	0	0.875	0.875	0.157975125	155A	286
MARCO3676-007_003	BRENT AND TERRY LYNN CALDWELL	HG ENERGY, LLC	9/15/2014	9/15/2024	CENTER - WETZEL, WV	01-18-26	18.020109	0.073557	0.073557	0.073557	0.125	0	0.875	0.875	0.064362375	155A	286
MARCO3682-001_001	JUNE HARVEY	HG ENERGY, LLC	9/2/2014	9/2/2024	CENTER - WETZEL, WV	01-18-26	18.020109	0.697755	0.697755	0.697755	0.125	0	0.875	0.875	2.043348125	154A	905
MARCO3682-001_003	JUNE HARVEY	HG ENERGY, LLC	9/2/2014	9/2/2024	CENTER - WETZEL, WV	01-18-26	18.020109	0.697755	0.697755	0.697755	0.125	0	0.875	0.875	0.610535625	154A	905
MARCO3682-002_001	CLAIRE ANNE & MAJOR JOE HOLMES	HG ENERGY, LLC	8/26/2014	8/26/2024	CENTER - WETZEL, WV	01-14-50, 01-18-24, 01-18-26	60.309891	0.389208	0.389208	0.389208	0.15	0	0.85	0.85	0.3308268	154A	908
MARCO3682-002_003	CLAIRE ANNE & MAJOR JOE HOLMES	HG ENERGY, LLC	8/26/2014	8/26/2024	CENTER - WETZEL, WV	01-18-26	18.020109	0.116292	0.116292	0.116292	0.15	0	0.85	0.85	0.0988482	154A	908
MARCO3682-003_001	CAROL & CARL CARPENTER	HG ENERGY, LLC	9/19/2014	9/19/2024	CENTER - WETZEL, WV	01-14-50, 01-18-24, 01-18-26	60.309891	0.233525	0.233525	0.233525	0.125	0	0.875	0.875	0.204334375	155A	283
MARCO3682-003_003	CAROL & CARL CARPENTER	HG ENERGY, LLC	9/19/2014	9/19/2024	CENTER - WETZEL, WV	01-18-26	18.020109	0.069775	0.069775	0.069775	0.125	0	0.875	0.875	0.061053125	155A	283

MARCO0358-001_001	DELORES J. SAPP, A WIDOW, LIFE ESTATE	EAST RESOURCES, INC.	6/18/2009	6/18/2014	CENTER - WETZEL, WV	01-18-10	19.63	9.815	9.815	0.125	0	0.875	0.875	8.588125	101A 23
MARCO0554-001_001	LINDA JOYCE RYAN ORLANDO, SINGLE	CHESAPEAKE APPALACHIA, L.L.C.	8/25/2009	8/25/2016	CENTER - WETZEL, WV	01-18-9	12.813894	0.088998	0.088998	0.125	0.175	0.7	0.7	0.0622986	103A 495
MARCO0554-001_002	LINDA JOYCE RYAN ORLANDO, SINGLE	CHESAPEAKE APPALACHIA, L.L.C.	8/25/2009	8/25/2016	CENTER - WETZEL, WV	01-18-9	63.25	0.2196	0.2196	0.125	0.175	0.7	0.7	0.15372	103A 495
MARCO0554-001_004	LINDA JOYCE RYAN ORLANDO, SINGLE	CHESAPEAKE APPALACHIA, L.L.C.	8/25/2009	8/25/2016	CENTER - WETZEL, WV	01-18-9	11.936106	0.082902	0.082902	0.125	0.175	0.7	0.7	0.0580314	103A 495
MARCO0555-001_001	MARY ALICE BLACKBURN, A MARRIED WOMAN D	CHESAPEAKE APPALACHIA, LLC	9/2/2009	9/2/2016	CENTER - WETZEL, WV	01-18-9	12.813894	0.088998	0.088998	0.125	0.175	0.7	0.7	0.0622986	104A 669
MARCO0555-001_002	MARY ALICE BLACKBURN, A MARRIED WOMAN D	CHESAPEAKE APPALACHIA, LLC	9/2/2009	9/2/2016	CENTER - WETZEL, WV	01-18-9	63.25	0.2196	0.2196	0.125	0.175	0.7	0.7	0.15372	104A 669
MARCO0555-001_004	MARY ALICE BLACKBURN, A MARRIED WOMAN D	CHESAPEAKE APPALACHIA, LLC	9/2/2009	9/2/2016	CENTER - WETZEL, WV	01-18-9	11.936106	0.082902	0.082902	0.125	0.175	0.7	0.7	0.0580314	104A 669
MARCO0556-001_001	TEENA BETH EMCH F/K/A TEENA BETH MCINTYR	CHESAPEAKE APPALACHIA, L.L.C.	6/25/2009	6/25/2016	CENTER - WETZEL, WV	01-18-9	12.813894	0.059539	0.059539	0.125	0.175	0.7	0.7	0.0416773	102A 468
MARCO0556-001_002	TEENA BETH EMCH F/K/A TEENA BETH MCINTYR	CHESAPEAKE APPALACHIA, L.L.C.	6/25/2009	6/25/2016	CENTER - WETZEL, WV	01-18-9	63.25	0.146	0.146	0.125	0.175	0.7	0.7	0.1022	102A 468
MARCO0556-001_004	TEENA BETH EMCH F/K/A TEENA BETH MCINTYR	CHESAPEAKE APPALACHIA, L.L.C.	6/25/2009	6/25/2016	CENTER - WETZEL, WV	01-18-9	11.936106	0.055461	0.055461	0.125	0.175	0.7	0.7	0.0388227	102A 468
MARCO0558-001_001	THEODORE A. BROOKOVER AND LINDA M. BROOK	CHESAPEAKE APPALACHIA, L.L.C.	8/12/2009	8/12/2016	CENTER - WETZEL, WV	01-18-9	12.813894	0.1781	0.1781	0.125	0.175	0.7	0.7	0.12467	103A 480
MARCO0558-001_002	THEODORE A. BROOKOVER AND LINDA M. BROOK	CHESAPEAKE APPALACHIA, L.L.C.	8/12/2009	8/12/2016	CENTER - WETZEL, WV	01-18-9	63.25	0.439	0.439	0.125	0.175	0.7	0.7	0.3073	103A 480
MARCO0558-001_004	THEODORE A. BROOKOVER AND LINDA M. BROOK	CHESAPEAKE APPALACHIA, L.L.C.	8/12/2009	8/12/2016	CENTER - WETZEL, WV	01-18-9	11.936106	0.1659	0.1659	0.125	0.175	0.7	0.7	0.11613	103A 480
MARCO3090-001_001	NANCY GRUBBS BURFORD	CHESAPEAKE APPALACHIA, LLC	11/11/2009	11/11/2014	CENTER - WETZEL, WV	01-18-9	12.813894	0.118647	0.118647	0.125	0.175	0.7	0.7	0.0830529	107A 905
MARCO3090-001_002	NANCY GRUBBS BURFORD	CHESAPEAKE APPALACHIA, LLC	11/11/2009	11/11/2014	CENTER - WETZEL, WV	01-18-9	63.25	0.292824	0.292824	0.125	0.175	0.7	0.7	0.2049768	107A 905
MARCO3090-001_004	NANCY GRUBBS BURFORD	CHESAPEAKE APPALACHIA, LLC	11/11/2009	11/11/2014	CENTER - WETZEL, WV	01-18-9	11.936106	0.11052	0.11052	0.125	0.175	0.7	0.7	0.077364	107A 905
MARCO3090-003_001	DANNY J & FLORIE NE DULANEY	CHESAPEAKE APPALACHIA, LLC	6/25/2009	6/25/2016	CENTER - WETZEL, WV	01-18-9	12.813894	0.118647	0.118647	0.125	0.175	0.7	0.7	0.0830529	102A 474
MARCO3090-003_002	DANNY J & FLORIE NE DULANEY	CHESAPEAKE APPALACHIA, LLC	6/25/2009	6/25/2016	CENTER - WETZEL, WV	01-18-9	63.25	0.292824	0.292824	0.125	0.175	0.7	0.7	0.2049768	102A 474
MARCO3090-003_004	DANNY J & FLORIE NE DULANEY	CHESAPEAKE APPALACHIA, LLC	6/25/2009	6/25/2016	CENTER - WETZEL, WV	01-18-9	11.936106	0.11052	0.11052	0.125	0.175	0.7	0.7	0.077364	102A 474
MARCO3090-004_001	SANDRA JOAN & TERRY ABEREGG	CHESAPEAKE APPALACHIA, LLC	6/25/2009	6/25/2016	CENTER - WETZEL, WV	01-18-9	12.813894	0.118647	0.118647	0.125	0.175	0.7	0.7	0.0830529	102A 477
MARCO3090-004_002	SANDRA JOAN & TERRY ABEREGG	CHESAPEAKE APPALACHIA, LLC	6/25/2009	6/25/2016	CENTER - WETZEL, WV	01-18-9	63.25	0.292824	0.292824	0.125	0.175	0.7	0.7	0.2049768	102A 477
MARCO3090-004_004	SANDRA JOAN & TERRY ABEREGG	CHESAPEAKE APPALACHIA, LLC	6/25/2009	6/25/2016	CENTER - WETZEL, WV	01-18-9	11.936106	0.11052	0.11052	0.125	0.175	0.7	0.7	0.077364	102A 477
MARCO3090-005_001	SANDRA L. RICHIE	CHESAPEAKE APPALACHIA, LLC	7/10/2009	7/10/2016	CENTER - WETZEL, WV	01-18-9	12.813894	0.118647	0.118647	0.125	0.175	0.7	0.7	0.0830529	102A 639
MARCO3090-005_002	SANDRA L. RICHIE	CHESAPEAKE APPALACHIA, LLC	7/10/2009	7/10/2016	CENTER - WETZEL, WV	01-18-9	63.25	0.292824	0.292824	0.125	0.175	0.7	0.7	0.2049768	102A 639
MARCO3090-005_004	SANDRA L. RICHIE	CHESAPEAKE APPALACHIA, LLC	7/10/2009	7/10/2016	CENTER - WETZEL, WV	01-18-9	11.936106	0.11052	0.11052	0.125	0.175	0.7	0.7	0.077364	102A 639
MARCO3090-006_001	VELMA RUTH WORTH	CHESAPEAKE APPALACHIA, LLC	7/14/2009	7/14/2016	CENTER - WETZEL, WV	01-18-9	12.813894	0.118647	0.118647	0.125	0.175	0.7	0.7	0.0830529	102A 665
MARCO3090-006_002	VELMA RUTH WORTH	CHESAPEAKE APPALACHIA, LLC	7/14/2009	7/14/2016	CENTER - WETZEL, WV	01-18-9	63.25	0.292824	0.292824	0.125	0.175	0.7	0.7	0.2049768	102A 665
MARCO3090-006_004	VELMA RUTH WORTH	CHESAPEAKE APPALACHIA, LLC	7/14/2009	7/14/2016	CENTER - WETZEL, WV	01-18-9	11.936106	0.11052	0.11052	0.125	0.175	0.7	0.7	0.077364	102A 665

MARCO3090-007_001	JAMES H. RUSH AND JANE A. RUSH, HIS WIFE	CHESAPEAKE APPALACHIA, LLC	7/15/2009	7/15/2016	CENTER - WETZEL, WV	01-18-9	12.813894	0.118647	0.118647	0.125	0.175	0.7	0.7	0.7	0.0830529	102A	859
MARCO3090-007_002	JAMES H. RUSH AND JANE A. RUSH, HIS WIFE	CHESAPEAKE APPALACHIA, LLC	7/15/2009	7/15/2016	CENTER - WETZEL, WV	01-18-9	63.25	0.292824	0.292824	0.125	0.175	0.7	0.7	0.7	0.2049768	102A	859
MARCO3090-007_004	JAMES H. RUSH AND JANE A. RUSH, HIS WIFE	CHESAPEAKE APPALACHIA, LLC	7/15/2009	7/15/2016	CENTER - WETZEL, WV	01-18-9	11.936106	0.11052	0.11052	0.125	0.175	0.7	0.7	0.7	0.077364	102A	859
MARCO3090-008_001	HELEN LOUISE EARLEY	CHESAPEAKE APPALACHIA, LLC	6/24/2009	6/24/2016	CENTER - WETZEL, WV	01-18-9	12.813894	0.118647	0.118647	0.125	0.175	0.7	0.7	0.7	0.0830529	102A	480
MARCO3090-008_002	HELEN LOUISE EARLEY	CHESAPEAKE APPALACHIA, LLC	6/24/2009	6/24/2016	CENTER - WETZEL, WV	01-18-9	63.25	0.292824	0.292824	0.125	0.175	0.7	0.7	0.7	0.2049768	102A	480
MARCO3090-008_004	HELEN LOUISE EARLEY	CHESAPEAKE APPALACHIA, LLC	6/24/2009	6/24/2016	CENTER - WETZEL, WV	01-18-9	11.936106	0.11052	0.11052	0.125	0.175	0.7	0.7	0.7	0.077364	102A	480
MARCO3090-009_001	WILLARD L. MINGES AND WILLA JOYCE MINGES	CHESAPEAKE APPALACHIA, LLC	7/23/2009	7/23/2016	CENTER - WETZEL, WV	01-18-9	12.813894	0.711883	0.711883	0.125	0.175	0.7	0.7	0.7	0.4983181	102A	687
MARCO3090-009_002	WILLARD L. MINGES AND WILLA JOYCE MINGES	CHESAPEAKE APPALACHIA, LLC	7/23/2009	7/23/2016	CENTER - WETZEL, WV	01-18-9	63.25	1.757	1.757	0.125	0.175	0.7	0.7	0.7	1.2299	102A	687
MARCO3090-009_004	WILLARD L. MINGES AND WILLA JOYCE MINGES	CHESAPEAKE APPALACHIA, LLC	7/23/2009	7/23/2016	CENTER - WETZEL, WV	01-18-9	11.936106	0.663117	0.663117	0.125	0.175	0.7	0.7	0.7	0.4641819	102A	687
MARCO3090-010_001	BILLY JAMES HIGGINS AND FRANCIS J.	CHESAPEAKE APPALACHIA, LLC	8/4/2009	8/4/2016	CENTER - WETZEL, WV	01-18-9	12.813894	0.237122	0.237122	0.125	0.175	0.7	0.7	0.7	0.1659854	103A	532
MARCO3090-010_002	BILLY JAMES HIGGINS AND FRANCIS J.	CHESAPEAKE APPALACHIA, LLC	8/4/2009	8/4/2016	CENTER - WETZEL, WV	01-18-9	63.25	0.586	0.586	0.125	0.175	0.7	0.7	0.7	0.4102	103A	532
MARCO3090-010_004	BILLY JAMES HIGGINS AND FRANCIS J.	CHESAPEAKE APPALACHIA, LLC	8/4/2009	8/4/2016	CENTER - WETZEL, WV	01-18-9	11.936106	0.220878	0.220878	0.125	0.175	0.7	0.7	0.7	0.1546146	103A	532
MARCO3090-011_001	MARLENE LOUISE GARDNER, A WIDOW	CHESAPEAKE APPALACHIA, LLC	8/13/2009	8/13/2016	CENTER - WETZEL, WV	01-18-9	12.813894	0.047631	0.047631	0.125	0.175	0.7	0.7	0.7	0.0333417	103A	638
MARCO3090-011_002	MARLENE LOUISE GARDNER, A WIDOW	CHESAPEAKE APPALACHIA, LLC	8/13/2009	8/13/2016	CENTER - WETZEL, WV	01-18-9	63.25	0.117	0.117	0.125	0.175	0.7	0.7	0.7	0.0819	103A	638
MARCO3090-011_004	MARLENE LOUISE GARDNER, A WIDOW	CHESAPEAKE APPALACHIA, LLC	8/13/2009	8/13/2016	CENTER - WETZEL, WV	01-18-9	11.936106	0.044369	0.044369	0.125	0.175	0.7	0.7	0.7	0.0310583	103A	638
MARCO3090-012_001	LESTER LEE RUSH AND SARA JEAN RUSH	CHESAPEAKE APPALACHIA, LLC	8/13/2009	8/13/2016	CENTER - WETZEL, WV	01-18-9	12.813894	0.047631	0.047631	0.125	0.175	0.7	0.7	0.7	0.0333417	103A	489
MARCO3090-012_002	LESTER LEE RUSH AND SARA JEAN RUSH	CHESAPEAKE APPALACHIA, LLC	8/13/2009	8/13/2016	CENTER - WETZEL, WV	01-18-9	63.25	0.117	0.117	0.125	0.175	0.7	0.7	0.7	0.0819	103A	489
MARCO3090-012_004	LESTER LEE RUSH AND SARA JEAN RUSH	CHESAPEAKE APPALACHIA, LLC	8/13/2009	8/13/2016	CENTER - WETZEL, WV	01-18-9	11.936106	0.044369	0.044369	0.125	0.175	0.7	0.7	0.7	0.0310583	103A	489
MARCO3090-013_001	MARY JANE POLESKI, A WIDOW	CHESAPEAKE APPALACHIA, LLC	8/13/2009	8/13/2016	CENTER - WETZEL, WV	01-18-9	12.813894	0.047631	0.047631	0.125	0.175	0.7	0.7	0.7	0.0333417	103A	486
MARCO3090-013_002	MARY JANE POLESKI, A WIDOW	CHESAPEAKE APPALACHIA, LLC	8/13/2009	8/13/2016	CENTER - WETZEL, WV	01-18-9	63.25	0.116082	0.116082	0.125	0.175	0.7	0.7	0.7	0.0812574	103A	486
MARCO3090-013_004	MARY JANE POLESKI, A WIDOW	CHESAPEAKE APPALACHIA, LLC	8/13/2009	8/13/2016	CENTER - WETZEL, WV	01-18-9	11.936106	0.044369	0.044369	0.125	0.175	0.7	0.7	0.7	0.0310583	103A	486
MARCO3090-014_001	PATRICIA JACQUELINE SILVIS AND MELVIN	CHESAPEAKE APPALACHIA, LLC	8/13/2009	8/13/2016	CENTER - WETZEL, WV	01-18-9	12.813894	0.047631	0.047631	0.125	0.175	0.7	0.7	0.7	0.0333417	103A	483
MARCO3090-014_002	PATRICIA JACQUELINE SILVIS AND MELVIN	CHESAPEAKE APPALACHIA, LLC	8/13/2009	8/13/2016	CENTER - WETZEL, WV	01-18-9	63.25	0.117	0.117	0.125	0.175	0.7	0.7	0.7	0.0819	103A	483
MARCO3090-014_004	PATRICIA JACQUELINE SILVIS AND MELVIN	CHESAPEAKE APPALACHIA, LLC	8/13/2009	8/13/2016	CENTER - WETZEL, WV	01-18-9	11.936106	0.044369	0.044369	0.125	0.175	0.7	0.7	0.7	0.0310583	103A	483
MARCO3090-015_001	DENA LOUISE HAYES BROWN	CHESAPEAKE APPALACHIA, LLC	7/21/2009	7/21/2016	CENTER - WETZEL, WV	01-18-9	12.813894	0.1781	0.1781	0.125	0.175	0.7	0.7	0.7	0.12467	102A	690
MARCO3090-015_002	DENA LOUISE HAYES BROWN	CHESAPEAKE APPALACHIA, LLC	7/21/2009	7/21/2016	CENTER - WETZEL, WV	01-18-9	63.25	0.439	0.439	0.125	0.175	0.7	0.7	0.7	0.3073	102A	690
MARCO3090-015_004	DENA LOUISE HAYES BROWN	CHESAPEAKE APPALACHIA, LLC	7/21/2009	7/21/2016	CENTER - WETZEL, WV	01-18-9	11.936106	0.1659	0.1659	0.125	0.175	0.7	0.7	0.7	0.11613	102A	690
MARCO3090-016_001	STEPHEN DOUGLAS HAYES	CHESAPEAKE APPALACHIA, LLC	7/21/2009	7/21/2016	CENTER - WETZEL, WV	01-18-9	12.813894	0.1781	0.1781	0.125	0.175	0.7	0.7	0.7	0.12467	102A	693

09/29/2023

09/29/2023

MARCO3090-016_002	STEPHEN DOUGLAS HAYES	CHESAPEAKE APPALACHIA, LLC	7/21/2009	7/21/2016	CENTER - WETZEL, WV	01-18-9	63.25	0.439	0.439	0.439	0.125	0.175	0.7	0.7	0.3073	102A	693
MARCO3090-016_004	STEPHEN DOUGLAS HAYES	CHESAPEAKE APPALACHIA, LLC	7/21/2009	7/21/2016	CENTER - WETZEL, WV	01-18-9	11.996106	0.1659	0.1659	0.1659	0.125	0.175	0.7	0.7	0.11613	102A	693
MARCO3090-017_001	VICKI SUE HAYES MIRACLE	CHESAPEAKE APPALACHIA, LLC	7/21/2009	7/21/2016	CENTER - WETZEL, WV	01-18-9	12.813894	0.1781	0.1781	0.1781	0.125	0.175	0.7	0.7	0.12467	102	668
MARCO3090-017_002	VICKI SUE HAYES MIRACLE	CHESAPEAKE APPALACHIA, LLC	7/21/2009	7/21/2016	CENTER - WETZEL, WV	01-18-9	63.25	0.439	0.439	0.439	0.125	0.175	0.7	0.7	0.3073	102	668
MARCO3090-017_004	VICKI SUE HAYES MIRACLE	CHESAPEAKE APPALACHIA, LLC	7/21/2009	7/21/2016	CENTER - WETZEL, WV	01-18-9	11.996106	0.1659	0.1659	0.1659	0.125	0.175	0.7	0.7	0.11613	102	668
MARCO3017-001_001	JUNE A. TUCKER 2012 REVOCABLE TRUST	AMERICAN ENERGY - MARCELLUS, LLC	12/4/2014	12/4/2019	CENTER - WETZEL, WV	01-18-26	34.979891	2.001807	2.001807	2.001807	0.17	0	0.83	0.83	1.66149981	164A	930
MARCO3017-001_002	JUNE A. TUCKER 2012 REVOCABLE TRUST	AMERICAN ENERGY - MARCELLUS, LLC	12/4/2014	12/4/2019	CENTER - WETZEL, WV	01-18-24	9.25	3.03305	3.03305	3.03305	0.17	0	0.83	0.83	2.5174315	164A	930
MARCO3017-001_003	JUNE A. TUCKER 2012 REVOCABLE TRUST	AMERICAN ENERGY - MARCELLUS, LLC	12/4/2014	12/4/2019	CENTER - WETZEL, WV	01-14-50	16.08	5.272589	5.272589	5.272589	0.17	0	0.83	0.83	4.37624887	164A	930
MARCO3017-001_005	JUNE A. TUCKER 2012 REVOCABLE TRUST	AMERICAN ENERGY - MARCELLUS, LLC	12/4/2014	12/4/2019	CENTER - WETZEL, WV	01-18-26	18.020109	1.031243	1.031243	1.031243	0.17	0	0.83	0.83	0.85593169	164A	930
MARCO3216-000_001	NEWELL FAMILY TRUST	AMERICAN ENERGY - MARCELLUS, LLC	9/22/2014	9/22/2017	CENTER - WETZEL, WV	01-18-26	34.979891	1.943324	1.943324	1.943324	0.15	0	0.85	0.85	1.6518254	156A	445
MARCO3216-000_003	NEWELL FAMILY TRUST	AMERICAN ENERGY - MARCELLUS, LLC	9/22/2014	9/22/2017	CENTER - WETZEL, WV	01-18-26	18.020109	1.001116	1.001116	1.001116	0.15	0	0.85	0.85	0.8509486	156A	445
MARCO0035-001_001	CANDICE LOU BOOKHART	AMERICAN ENERGY - MARCELLUS, LLC	9/26/2014	9/26/2024	CENTER - WETZEL, WV	01-14-50, 01-18-24, 01-18-26	60.309891	0.153845	0.153845	0.153845	0.125	0	0.875	0.875	0.134614375	157A	306
MARCO0035-001_003	CANDICE LOU BOOKHART	AMERICAN ENERGY - MARCELLUS, LLC	9/26/2014	9/26/2024	CENTER - WETZEL, WV	01-18-26	18.020109	0.045967	0.045967	0.045967	0.125	0	0.875	0.875	0.040221125	157A	306
MARCO0042-001_001	JULIENNE ANNA BUSCHO	HG ENERGY, LLC	9/26/2014	9/26/2024	CENTER - WETZEL, WV	01-18-26	60.309891	0.233526	0.233526	0.233526	0.125	0	0.875	0.875	0.20433525	169A	325
MARCO0042-001_003	JULIENNE ANNA BUSCHO	HG ENERGY, LLC	9/26/2014	9/26/2024	CENTER - WETZEL, WV	01-18-26	18.020109	0.069776	0.069776	0.069776	0.125	0	0.875	0.875	0.061054	169A	325
MARCO0050-001_001	RYAN LEE REINECKER, A SINGLE MAN	AMERICAN ENERGY - MARCELLUS, LLC	10/13/2014	10/13/2024	CENTER - WETZEL, WV	01-14-50, 01-18-24, 01-18-26	60.309891	0.153835	0.153835	0.153835	0.125	0	0.875	0.875	0.134605625	157A	303
MARCO0050-001_003	RYAN LEE REINECKER, A SINGLE MAN	AMERICAN ENERGY - MARCELLUS, LLC	10/13/2014	10/13/2024	CENTER - WETZEL, WV	01-18-26	18.020109	0.045965	0.045965	0.045965	0.125	0	0.875	0.875	0.040219375	157A	303
MARCO0049-001_001	MELANIE LOHMAN, A MARRIED WOMAN	AMERICAN ENERGY - MARCELLUS, LLC	10/6/2014	10/6/2024	CENTER - WETZEL, WV	01-14-50, 01-18-24, 01-18-26	60.309891	0.153835	0.153835	0.153835	0.125	0	0.875	0.875	0.134605625	157A	300
MARCO0049-001_003	MELANIE LOHMAN, A MARRIED WOMAN	AMERICAN ENERGY - MARCELLUS, LLC	10/6/2014	10/6/2024	CENTER - WETZEL, WV	01-18-26	18.020109	0.045965	0.045965	0.045965	0.125	0	0.875	0.875	0.040219375	157A	300
MARCO3004-001_001	BOBBI LYNN TYLER	AMERICAN ENERGY - MARCELLUS, LLC	12/11/2014	12/11/2019	CENTER - WETZEL, WV	01-18-26	60.309891	0.276099	0.276099	0.276099	0.125	0	0.875	0.875	0.241586625	160A	807
MARCO3004-001_003	BOBBI LYNN TYLER	AMERICAN ENERGY - MARCELLUS, LLC	12/11/2014	12/11/2019	CENTER - WETZEL, WV	01-18-26	18.020109	0.082496	0.082496	0.082496	0.125	0	0.875	0.875	0.072184	160A	807
MARCO3008-001_001	DAVID RYAN CRISWELL	AMERICAN ENERGY - MARCELLUS, LLC	11/21/2014	11/21/2019	CENTER - WETZEL, WV	01-14-50, 01-18-24, 01-18-26	60.309891	0.153832	0.153832	0.153832	0.125	0	0.875	0.875	0.134603	161A	472
MARCO3008-001_003	DAVID RYAN CRISWELL	AMERICAN ENERGY - MARCELLUS, LLC	11/21/2014	11/21/2019	CENTER - WETZEL, WV	01-18-26	18.020109	0.045964	0.045964	0.045964	0.125	0	0.875	0.875	0.0402185	161A	472
MARCO3008-002_001	JOHN E. & TAMMY STEENERSON	HG ENERGY, LLC	9/12/2014	9/12/2024	CENTER - WETZEL, WV	01-14-50, 01-18-24, 01-18-26	60.309891	0.053664	0.053664	0.053664	0.125	0	0.875	0.875	0.046956	169A	315
MARCO3008-002_003	JOHN E. & TAMMY STEENERSON	HG ENERGY, LLC	9/12/2014	9/12/2024	CENTER - WETZEL, WV	01-18-26	18.020109	0.016034	0.016034	0.016034	0.125	0	0.875	0.875	0.01402975	169A	315
MARCO3682-001_001	JUNE HARVEY	HG ENERGY, LLC	9/2/2014	9/2/2024	CENTER - WETZEL, WV	01-14-50, 01-18-24, 01-18-26	60.309891	2.335255	2.335255	2.335255	0.125	0	0.875	0.875	2.043348125	154A	905
MARCO3682-001_003	JUNE HARVEY	HG ENERGY, LLC	9/2/2014	9/2/2024	CENTER - WETZEL, WV	01-18-26	18.020109	0.697755	0.697755	0.697755	0.125	0	0.875	0.875	0.610635625	154A	905
MARCO3682-002_001	CLAIRE ANNE & MAJOR JOE HOLMES	HG ENERGY, LLC	8/26/2014	8/26/2024	CENTER - WETZEL, WV	01-18-26	60.309891	0.389208	0.389208	0.389208	0.15	0	0.85	0.85	0.3308268	154A	908

09/29/2023

MARCO3682-002_003	CLAIRE ANNE & MADR JOE HOLMES	HG ENERGY, LLC	8/26/2014	8/26/2024	CENTER - WETZEL, WV	01-18-26	18.020109	0.116292	0.116292	0.15	0	0.85	0.85	0.0988482	154A	908
MARCO3682-003_001	CAROL & CARL CARPENTER	HG ENERGY, LLC	9/19/2014	9/19/2024	CENTER - WETZEL, WV	01-14-50, 01-18-24, 01-18-26	60.309891	0.233525	0.233525	0.125	0	0.875	0.875	0.204334375	155A	283
MARCO3682-003_003	CAROL & CARL CARPENTER	HG ENERGY, LLC	9/19/2014	9/19/2024	CENTER - WETZEL, WV	01-18-26	18.020109	0.069775	0.069775	0.125	0	0.875	0.875	0.061053125	155A	283
MARCO1796-001_001	GEORGE R. HUFF AND MARGARET J. HUFF, HIS	PENNZOIL PRODUCTS COMPANY	5/15/1996	5/15/2006	CENTER - WETZEL, WV	01-14-50	2.079946	0.129997	0.129997	0.125	0	0.875	0.875	0.113747375	76A	373
MARCO1796-001_003	GEORGE R. HUFF AND MARGARET J. HUFF, HIS	PENNZOIL PRODUCTS COMPANY	5/15/1996	5/15/2006	CENTER - WETZEL, WV	01-14-50	14.000054	0.875003	0.875003	0.125	0	0.875	0.875	0.765627625	76A	373
MARCO1797-001_001	JESSIE M. HUFF, ALSO KNOWN AS, MAXINE HU	PENNZOIL PRODUCTS COMPANY	5/15/1996	5/15/2006	CENTER - WETZEL, WV	01-14-50	2.079946	0.129997	0.129997	0.125	0	0.875	0.875	0.113747375	76A	361
MARCO1797-001_003	JESSIE M. HUFF, ALSO KNOWN AS, MAXINE HU	PENNZOIL PRODUCTS COMPANY	5/15/1996	5/15/2006	CENTER - WETZEL, WV	01-14-50	14.000054	0.875003	0.875003	0.125	0	0.875	0.875	0.765627625	76A	361
MARCO1798-001_001	MARY LUCILLE BALL, A WIDOW	PENNZOIL PRODUCTS COMPANY	5/16/1996	5/16/2006	CENTER - WETZEL, WV	01-14-50	2.079946	0.129997	0.129997	0.125	0	0.875	0.875	0.113747375	76A	399
MARCO1798-001_003	MARY LUCILLE BALL, A WIDOW	PENNZOIL PRODUCTS COMPANY	5/16/1996	5/16/2006	CENTER - WETZEL, WV	01-14-50	14.000054	0.875003	0.875003	0.125	0	0.875	0.875	0.765627625	76A	399
MARCO1799-001_001	SUE L. HEINTZMAN AND PAUL C. HEINTZMAN,	PENNZOIL PRODUCTS COMPANY	5/16/1996	5/16/2006	CENTER - WETZEL, WV	01-14-50	2.079946	0.129997	0.129997	0.125	0	0.875	0.875	0.113747375	76A	433
MARCO1799-001_003	SUE L. HEINTZMAN AND PAUL C. HEINTZMAN,	PENNZOIL PRODUCTS COMPANY	5/16/1996	5/16/2006	CENTER - WETZEL, WV	01-14-50	14.000054	0.875003	0.875003	0.125	0	0.875	0.875	0.765627625	76A	433
MARCO1800-001_001	RAY W. CALDWELL, A SINGLE PERSON	PENNZOIL PRODUCTS COMPANY	6/18/1996	6/18/2006	CENTER - WETZEL, WV	01-14-50	2.079946	0.014875	0.014875	0.125	0	0.875	0.875	0.013015625	76A	457
MARCO1800-001_003	RAY W. CALDWELL, A SINGLE PERSON	PENNZOIL PRODUCTS COMPANY	6/18/1996	6/18/2006	CENTER - WETZEL, WV	01-14-50	14.000054	0.100125	0.100125	0.125	0	0.875	0.875	0.087609375	76A	457
MARCO1801-001_001	JOHN R. CALDWELL, A SINGLE PERSON	PENNZOIL PRODUCTS COMPANY	6/21/1996	6/21/2006	CENTER - WETZEL, WV	01-14-50	2.079946	0.014875	0.014875	0.125	0	0.875	0.875	0.013015625	76A	461
MARCO1801-001_003	JOHN R. CALDWELL, A SINGLE PERSON	PENNZOIL PRODUCTS COMPANY	6/21/1996	6/21/2006	CENTER - WETZEL, WV	01-14-50	14.000054	0.100125	0.100125	0.125	0	0.875	0.875	0.087609375	76A	461
MARCO1802-001_001	JANET M. LAWRENCE, A SINGLE PERSON	PENNZOIL PRODUCTS COMPANY	6/21/1996	6/21/2006	CENTER - WETZEL, WV	01-14-50	2.079946	0.014875	0.014875	0.125	0	0.875	0.875	0.013015625	76A	465
MARCO1802-001_003	JANET M. LAWRENCE, A SINGLE PERSON	PENNZOIL PRODUCTS COMPANY	6/21/1996	6/21/2006	CENTER - WETZEL, WV	01-14-50	14.000054	0.100125	0.100125	0.125	0	0.875	0.875	0.087609375	76A	465
MARCO1803-001_001	MACK M. CALDWELL AND DON DEENA J. CALDW	PENNZOIL PRODUCTS COMPANY	6/18/1996	6/18/2006	CENTER - WETZEL, WV	01-14-50	2.079946	0.014875	0.014875	0.125	0	0.875	0.875	0.013015625	76A	473
MARCO1803-001_003	MACK M. CALDWELL AND DON DEENA J. CALDW	PENNZOIL PRODUCTS COMPANY	6/18/1996	6/18/2006	CENTER - WETZEL, WV	01-14-50	14.000054	0.100125	0.100125	0.125	0	0.875	0.875	0.087609375	76A	473
MARCO1804-001_001	MARY A. CRISWELL, A WIDOW	PENNZOIL PRODUCTS COMPANY	6/18/1996	6/18/2006	CENTER - WETZEL, WV	01-14-50	2.079946	0.103997	0.103997	0.125	0	0.875	0.875	0.090997375	76A	626
MARCO1804-001_003	MARY A. CRISWELL, A WIDOW	PENNZOIL PRODUCTS COMPANY	6/18/1996	6/18/2006	CENTER - WETZEL, WV	01-14-50	14.000054	0.700003	0.700003	0.125	0	0.875	0.875	0.612502625	76A	626
MARCO1805-001_001	JOANNE M. SHACKLETON AND ALVIN W. SHACKL	PENNZOIL PRODUCTS COMPANY	6/18/1996	6/18/2006	CENTER - WETZEL, WV	01-14-50	2.079946	0.014875	0.014875	0.125	0	0.875	0.875	0.013015625	76A	630
MARCO1805-001_003	JOANNE M. SHACKLETON AND ALVIN W. SHACKL	PENNZOIL PRODUCTS COMPANY	6/18/1996	6/18/2006	CENTER - WETZEL, WV	01-14-50	14.000054	0.100125	0.100125	0.125	0	0.875	0.875	0.087609375	76A	630
MARCO1806-001_001	JUNE L. TUCKER AND THOMAS G. TUCKER, HER	PENNZOIL PRODUCTS COMPANY	7/10/1996	7/10/2006	CENTER - WETZEL, WV	01-14-50	2.079946	0.103997	0.103997	0.125	0	0.875	0.875	0.090997375	76A	644
MARCO1806-001_003	JUNE L. TUCKER AND THOMAS G. TUCKER, HER	PENNZOIL PRODUCTS COMPANY	7/10/1996	7/10/2006	CENTER - WETZEL, WV	01-14-50	14.000054	0.700003	0.700003	0.125	0	0.875	0.875	0.612502625	76A	644
MARCO1807-001_001	NELSON V. ROGERS AND PAULA S. ROGERS, HI	PENNZOIL PRODUCTS COMPANY	7/9/1996	7/9/2006	CENTER - WETZEL, WV	01-14-50	2.079946	0.103997	0.103997	0.125	0	0.875	0.875	0.090997375	76A	644
MARCO1807-001_003	NELSON V. ROGERS AND PAULA S. ROGERS, HI	PENNZOIL PRODUCTS COMPANY	7/9/1996	7/9/2006	CENTER - WETZEL, WV	01-14-50	14.000054	0.700003	0.700003	0.125	0	0.875	0.875	0.612502625	76A	644
	American Energy Marcellus	East Resources Inc	8/1/2014	1/1/2078	WETZEL, WV	01-18-25		1.000000	1.000000	0.200	0	0.800	0.800	0.800000	153A	238

American Energy Marcellus	East Resources Inc	8/1/2014	1/1/2078	WETZEL, WV	01-18-25-2					2.851000	2.851000	0.200	0	0.800	0.800	2.280800	153A	238
HG Energy	Paula Suzanne Rogers	8/26/2014	8/24/2024	WETZEL, WV	01-18-26					32.609000	32.609000	0.200	0	0.800	0.800	26.087200	168A	328
East Resources, Inc.	Thomas Iacaboni	6/13/2006	6/13/2011	WETZEL, WV	01-18-24					2.289063	2.289063	0.200	0	0.800	0.800	0.457813	86A	214
East Resources, Inc	William Francik and Pamela Francik	6/13/2006	6/13/2011	WETZEL, WV	01-18-24					2.289063	2.289063	0.200	0	0.800	0.800	0.457813	86A	210
East Resources	David B. Moore	10/8/2008	12/1/2078	WETZEL, WV	01-18-7.5					2.575564	2.575564	0.200	0	0.800	0.800	1.287782	95A	636
Tribune Resources	Ascent Resources	8/31/2018	12/31/2078	WETZEL, WV	01-18-7.8					0.756250	0.756250	0.200	0	0.800	0.800	0.151250	13	427
East Resources	David B. Moore	10/8/2008	12/1/2078	WETZEL, WV	01-18-7.8					1.921875	1.921875	0.200	0	0.800	0.800	0.960938	95A	636
Tribune Resources	Ascent Resources	8/31/2018	12/31/2078	WETZEL, WV	01-18-7.1					0.756250	0.756250	0.200	0	0.800	0.800	0.151250	13	427
American Energy - Marcellus, LLC	East Resources, Inc. & HG Energy, LLC	8/1/2014	12/31/2099	WETZEL, WV	01-15-46					0.180764	0.180764	0.200	0	0.800	0.800	0.144611	440	540
Tribune Resources	Ascent Resources Marcellus	1/29/2016	12/31/2078	WETZEL, WV	01-18-7					15.637500	15.637500	0.200	0	0.800	0.800	3.127500	448	247
East Resources	David B. Moore	10/8/2008	12/1/2078	WETZEL, WV	01-18-7.3					2.423750	2.423750	0.200	0	0.800	0.800	1.211875	95A	636
American Energy - Marcellus, LLC	East Resources, Inc. & HG Energy, LLC	8/1/2014	12/31/2099	WETZEL, WV	01-15-22					0.005344	0.005344	0.200	0	0.800	0.800	0.004275	440	540
American Energy - Marcellus, LLC	East Resources, Inc. & HG Energy, LLC	8/1/2014	12/31/2099	WETZEL, WV	01-15-33					0.007816	0.007816	0.200	0	0.800	0.800	0.006253	440	540
American Energy - Marcellus, LLC	East Resources, Inc. & HG Energy, LLC	8/1/2014	12/31/2099	WETZEL, WV	01-15-34					0.396341	0.396341	0.200	0	0.800	0.800	0.317073	440	540
American Energy - Marcellus, LLC	East Resources, Inc. & HG Energy, LLC	8/1/2014	12/31/2099	WETZEL, WV	01-15-34.1					0.001844	0.001844	0.200	0	0.800	0.800	0.001475	440	540
American Energy - Marcellus, LLC	East Resources, Inc. & HG Energy, LLC	8/1/2014	12/31/2099	WETZEL, WV	01-15-35					0.048405	0.048405	0.200	0	0.800	0.800	0.038724	440	540
American Energy - Marcellus, LLC	East Resources, Inc. & HG Energy, LLC	8/1/2014	12/31/2099	WETZEL, WV	01-15-36					0.025045	0.025045	0.200	0	0.800	0.800	0.020036	440	540

RECEIVED
 Office of Oil and Gas
 SEP 18 2023
 WV Department of
 Environmental Protection

09/29/2023

Exhibit A - Part III
Tribune Free Mineral Interests

LEASE_TRACT	Lessor	Lessee	Lease Date	Township Name	Tract - Tax Parcel	Gross	Company Net	Marcellus Co Net	TOTAL MINERALS	Royalty	ORRI	Lease NRI	Company NRI	NRI Acres	Book	Page
MARCO2997-000_196	EAST RESOURCES, INC. & HG ENERGY, LLC	AMERICAN ENERGY - MARCELLUS, LLC	8/1/2014	CENTER - WETZEL, WV	01-15-22, 01-15-33, 01-15-34, 01-15-34.1, 01-15-35, 01-15-36, 01-15-46	84	0.67	0.67	0.67000000	0	0	0.83	0.83	0.5561	440	540
MARCO2997-000_003	EAST RESOURCES, INC. & HG ENERGY, LLC	AMERICAN ENERGY - MARCELLUS, LLC	8/1/2014	CENTER - WETZEL, WV	01-14-50	16.08	0.0766	0.0766	0.0766	0	0	0.83	0.83	0.063578	440	540
MARCO2997-000_009	EAST RESOURCES, INC. & HG ENERGY, LLC	AMERICAN ENERGY - MARCELLUS, LLC	8/1/2014	CENTER - WETZEL, WV	01-14-42, 01-18-11, 01-18-11.1	24.75	0.29167	0.29167	0.29167	0	0	0.83	0.83	0.19020861	440	540
MARCO2997-000_178	EAST RESOURCES, INC. & HG ENERGY, LLC	AMERICAN ENERGY - MARCELLUS, LLC	8/1/2014	CENTER - WETZEL, WV	01-14-42, 01-18-11, 01-18-11.1	63.75	0.292824	0.292824	0.292824	0	0	0.83	0.83	0.24304392	440	540
MARCO2997-000_115	EAST RESOURCES, INC. & HG ENERGY, LLC	AMERICAN ENERGY - MARCELLUS, LLC	8/1/2014	GRANT - WETZEL, WV	01-14-51	26	0.81	0.81	0.81	0	0	0.83	0.83	0.6723	440	540

RECEIVED
Office of Oil and Gas
SEP 18 2023
WV Department of
Environmental Protection



September 13, 2023

Via FedEx Overnight Delivery

West Virginia Department of Environmental Protection
Office of Oil and Gas
601 57th Street, S.E.
Charleston, WV 25304

RE: Horizontal Well Work Permit Application Modification – EXPEDITED REVIEW REQUESTED
Haggard 2H
Permit Number 47-103-03526
Center District, Wetzel County, WV

WVDEP Recipient,

Attached please find the Well Work Permit Application for the well referenced above. You will find the following included with this submittal:

- Check in the amount \$2,500.00 for the permit fee and an additional \$5,000.00 for the expedited permit modification fee
- Completed WW-6B and supporting documents, approved by the O&G Inspector
- Well Location Plat
- Completed Form WW-6A1 and supporting documentation
- Hydraulic Fracturing Monitoring Plan
- Offset Well Map and Table
- Disk containing the revised Water Management Plan to add two additional sources

EQT is proposing to extend the lateral from the previously permitted length.

EQT Production trusts that if any portion of the submitted documentation is found to be inadequate for processing the permit, notification will be made to our Permitting department at your earliest convenience. It is EQT Production's intent to cooperate fully to provide any additional requested documentation and clarification in a timely manner such that permitting proceeds in a predictable and logical manner.

Best Regards,

John Zavatchan
Project Specialist – Permitting
jzavatchan@eqt.com
724-746-9073

RECEIVED
Office of Oil and Gas
SEP 18 2023
WV Department of
Environmental Protection

09/29/2023