

HOPE NATURAL GAS COMPANY

LOCATION FOR WELL No. 5

Pine Grove DISTRICT

Anthony A. Cunningham Farm, on waters of Piney Fork
Greene District, Wetzel County, West Virginia

Lease No. 491 1/2 Acres N. 7 S. E. W. 4

Scale, one inch equals 80 Poles. Sent to 1

Location to be

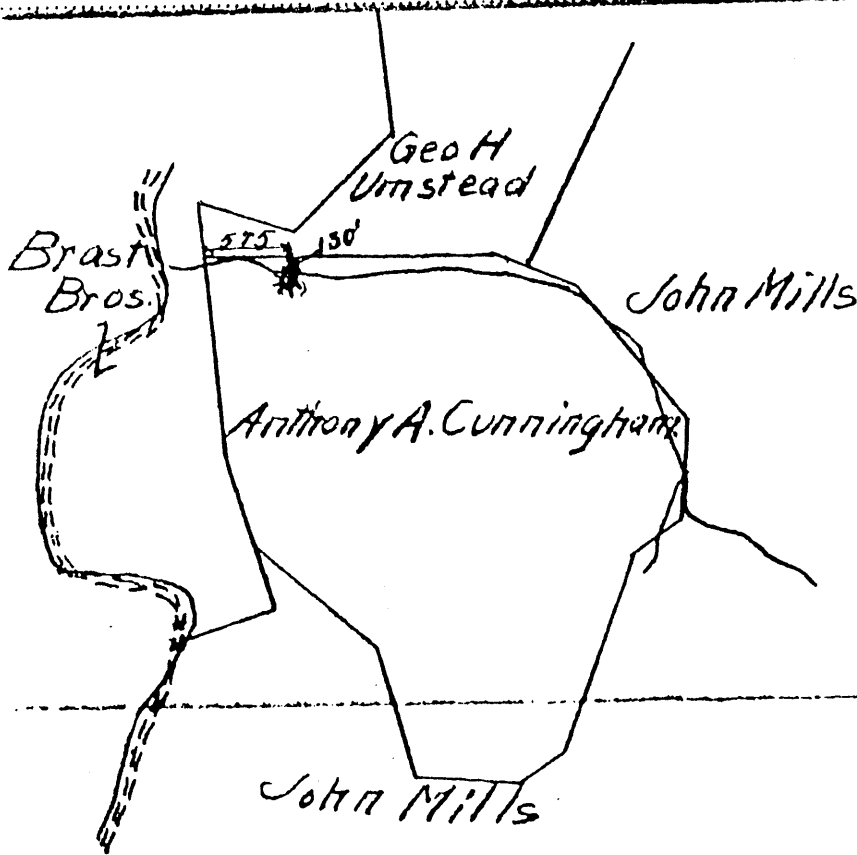

#103-0647

RESERVE

SPECIAL INSTRUCTIONS

Location ^{Notes} _{made} 4/11 11 by C.N. Jones As per plat, except as noted. On field n

1 Returned to Pittsburgh. 1

Location changed on account of

Authorized by Date 1 Signed

LATITUDE 39° 32' 30"

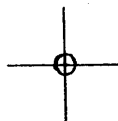

88° 40' 00"

LONGITUDE

7'5 OGIS topo location

7.5' loc 0.62 S 15' loc _____
' 1.22 W (calc.) _____

Company _____

Farm _____

Quad PINE GROVE 7 1/2'

County WETZEL

District GREEN

WELL LOCATION MAP

File No. 103-0647

Well No. 5

REPAIR RECORD

Pine Grove Duff

Farm Name Thomas Cunningham

N 7 S E W 6

Repairs Commenced Dec. 21st, 1936

Repairs Completed May 4th, 1937

CASING AND TUBING RECORD

Size	Before Repairs	Pulled	Put in Well	After Repairs	Disposition of Amount Pulled
8-1/4"	691-0	none	none	691-0	
6-5/8"	1772-0	none	none	1772-0	
5-3/16"	none	--	2276-4	2276-4	2614-11
4-7/8"	none	--	338-7	338-7	
4" Tubg.	2614-0	2614-0	none	none	

SHOOTING RECORD

Date	Quarts	Top of Shell	Bottom of Shell	Diameter	Sand	TEST BEFORE SHOT			TEST AFTER SHOT			Test Taken After Shot No. Hours	By Whom Shot	
						Reading	Liquid	Opening	Reading	Liquid	Opening			
			Not shot.											

RECORD OF ANY DEEPER DRILLING

Formation	Top	Bottom	Name of Driller	Time (Days)
			William H. Martin	68
			John H. Calvert	35
Commenced drilling at depth of			Names of Tool Dressers	
No drilling deeper.			Harrison E. Ketzal	66
			Frank V. Henderson	35

PACKER RECORD

(ALSO NOTE BELOW IF ANY PACKERS ARE PULLED)

Size	Kind	Anchor	As Above
6-5/8x5-3/16	Comb Wall & Anchor	147'7"	3567
<i>Change per record - Nov 4/1938</i>			

OIL AND GAS DISCOVERIES IN DEEPER DRILLING

Oil at	----	Ft. in	-----
Gas at	----	Ft. in	---

Total Depth **2593.**

VOLUME AND PRESSURE REPORT

BEFORE REPAIRS

Reading	Liquid	Opening	Rock or Minute Pressure	Sands Gas From
40/10	Water	1-1/4"	R	Gordon Stray & Gordon

AFTER REPAIRS

VOLUME TEST

Date of Test	Opening	PITOT TUBE		OPEN FLOW	Sands Gas From
		Reading	Liquid Used	Lbs.	
5-3-37	1 1/2" Casing flow meter	18/10	Mercury	7/1000	Gordon Stray & Gordon
5-3-37	1/4" Tubing flow meter	No/10	Water		Injun

PRESSURE TEST

Date of Test	Opening	1 Min.	2 Min.	3 Min.	4 Min.	5 Min.	6 Min.	7 Min.	8 Min.	9 Min.	10 Min.	30 Min.	60 Min.
5-3-37	5-3/16" Casing	3	6	9	11	13	14	15	16	18	19	28	30
	" Tubing												

OIL: From Sand 1-5-3/16" Bull Plug on bottom. 1st & 2nd perforation set
 Estimated Production Bbl. per Day 2613-10- 3rd, perforation set at 2488-2.
 Remarks: _____

Wet-647