

Hope Natural Gas Co.

LOCATION FOR WELL No. 22

Pine Grove DISTRICT.

On Belle Newman Farm, on waters of Piney Fork.
Greene District, Wetzel County, West Virginia.

Lease No. 529 Acres Range: N. 7 S. — E. — W. 4

Scale 1" = 800' Made 10-30-1908

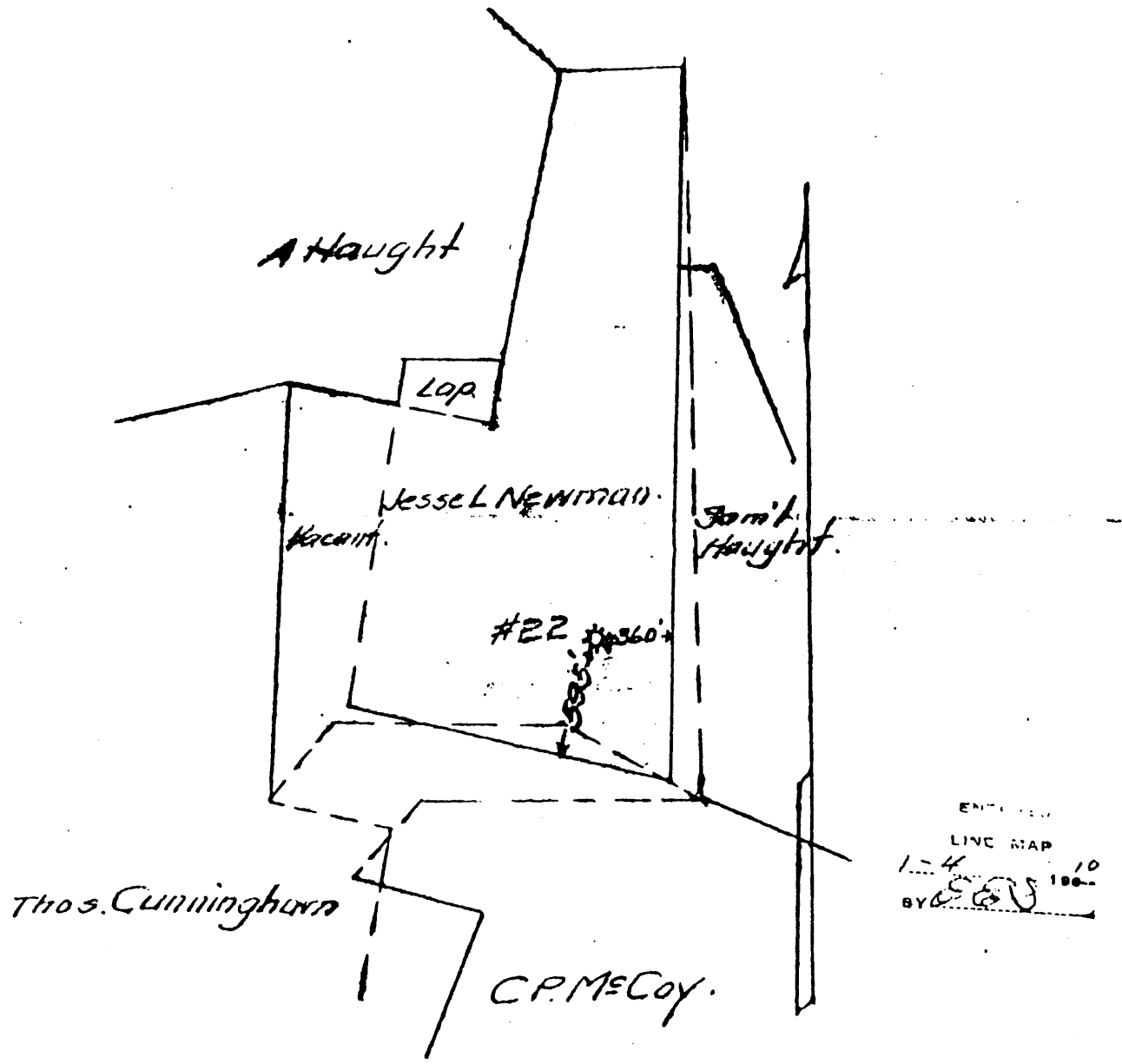

ENTERED
LINE MAP
1-4-10
BY *SEU*

ENTERED
WELL BOOK
LEASE RECORD
LEASE DOCKET
WALL MAP 67PR-12-31-01
WORKING MAP
LOCATION BOOK

LOCATION MADE *11/20/08* 10-30-1908
 BY *J.P. McClintock*
 as per plat. Except as noted
 On Field Map _____ 19____
 Returned to Pittsburg _____ 19____

RESERVE:

SPECIAL INSTRUCTIONS:

LATITUDE 39° 35' 00"

LONGITUDE 80° 40' 00"

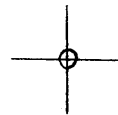

7'5 OGIS topo location

7.5' 10C	<u>2.645</u>	15' 10C	_____
	<u>0.97w</u>	(calc.)	_____

Company _____

Farm _____

Quad PINE GROVE 7 1/2'

County WETZEL

District GREEN

WELL LOCATION MAP

File No. 103-0652

(035)

Della Newman
 Grant District Metzger

Farm, Acres
 County M. J. State

HPI-0652

Well No. # 22

Rig Commenced 189 }
 Rig Completed 189 } Contractor.
 Drilling Commenced Apr 15- 1899 }
 Drilling Completed June 24 1899 } O.O. Allen Contractor.

FORMATION.	TOP.	REMARKS.	BOTTOM
bond	17 fr.		
10" casing	464		
8 1/4 "	1411	No 10" casing pulled	
6 5/8 "	7187	No 8 1/4 "	"
5 1/16 "	7455	No 6 7/8 "	"
Phylloaly	855		
Top Injun Sand	7168		
Day of Gas	7170		
Bottom Injun Sand	7373		
Top of Stray Sand	7937		
Gas " "	7934		
Bottom " "	7960		
Top Gordon Sand	7966		
Day of Gas	7970		
Bottom Gordon Sand	7975		
Total depth	7975		
hoft at well			
10"	99 fr		
8 1/4 "	77 "		
6 5/8 "	46 "		
5 1/16 "	159 "		

7/17/1900

O. K. Allen

NOTE:

A good record must show the formation from top to bottom of well.

103-652