

# HOPE NATURAL GAS COMPANY.

LOCATION FOR WELL No. 30

Pine Grove DISTRICT

On Geo. H. Unstead Farm, on waters of Piney Fork

Greene District, Wetzel County, West Virginia.

Lease No. 1617 Acres 22 N 7 S E W A

Scale, one inch equals 80 Poles Sent to 1

Location to be

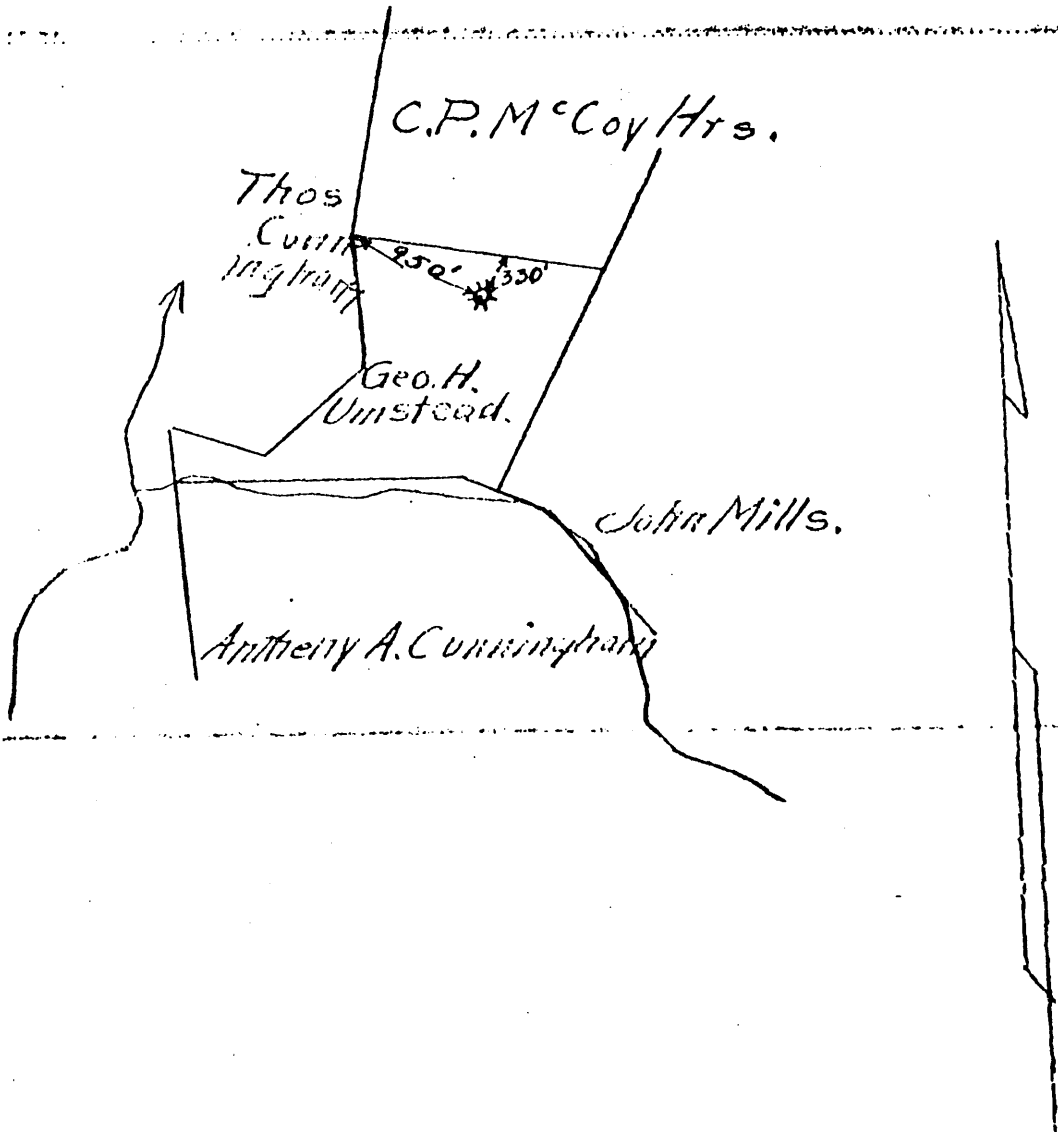

Wet - 654

RESERVE

SPECIAL INSTRUCTIONS

Location made <sup>Mess.</sup> 4/11 11 by C.N. Jones As per plat, except as noted. On field ma

Returned to Pittsburgh 1

Location changed on account of

Authorized by Date 1 Signed



Well No. 30

G. H. UMSTEAD

PINE GROVE

District

N. 7 S. E. W.

REPAIRS

Commenced NOVEMBER 10-1910

Completed JANUARY 17-1911

CASING AND TUBING RECORD

Size	Amount in Well		Amount Pulled	Amount Put in Well	Amount Left in Well	Disposition of Amount Pulled
	Before Repair	After Repair				
10"	*840	none	826-3	none	none	Stock at well
8 1/2"	*1395	none	1367	none	none	Stock at well
6 3/8"	1875	1875	none	none	1875	
5-3/16"	2294	2294	none	none	2294	
3"	3112	none	3112	none	none	Stock at well
2" F.E.	None	3137-5	None	None	3137-5	None

Size Opening	Before Repair			Pressure		After Repair			Pressure
	Liquid Used	Reading	Rock or Minute	Pounds	Size Opening	Liquid Used	Reading	Rock or Minute	
2"	Water	4/10	ROCK	75	2"	Mercury	8/10	Rock	120

Names of Drillers	Time (Days)	Names of Tool Dressers	Time (Days)
M. J. THOMPSON DAVID WHITE		DAVID MYERS S. H. CARPENTER	

If well is drilled deeper, insert below the record of deeper drilling

Formation	Top	Bottom	Formation	Top	Bottom
Original total depth		3093			
Slate & Shells	3093	3123			
TOTAL DEPTH		3123			
* Original record shows 640 ft of 10" casing in well, we found but 626-8					
* " " " " 1395 ft of 8 1/2" casing " " " " 1367 ft.					
3123 3093 --- 30 new ft.			39		

SHOOTING RECORD

Date	Quarts	Top of Shell	Bottom of Shell	Diameter	Sand	Test Before Shot			Test After Shot			Test taken after shot No. Hours	By Whom Shot
						Reading	Liquid	Opening	Reading	Liquid	Opening		
12-29-10	80	3040	3070	3 3 1/2 x 10	Sbray & Grd	4/10	Wat	2"	8/10	MER	2"	48	MAR. T. COO Ph. Moore

PACKER RECORD

Size	Kind	Amount Anchor	Amount Above Anchor
5-3/16 1 1/2"	HEETER ANCHOR	187	2947

Packer set at 2947

Tubing Record if Well Never Previously Tubed

Date Tubed	Size	Amount Put in Well
1-1-11	2" Ex. Invy	3137-5

Remarks: First perforation on bottom- Second perforation at 3040  
2" Screw Plug and 2" collar on bottom of tubing

ENTERED  
 JAN 30 1910 G.A.K.  
 WELL BOOK  
 LEASE RECORD  
 LEASE DOCUMENT  
 WALL MAP  
 LINE MAP  
 LOCATION BOOK  
 CONTRACTOR'S PLAT  
 TITLE

MAR 10 1911 H.H.S.

Wd-654  
2947  
G.P. 1/10 1/15

NOTE - Whenever a well is shot, tubed, drilled deeper or in any way repaired, fill out this report and mail promptly.

FOREMAN

1379

30

# WELL RECORD.

7: 988

*George H. Unstead*  
 District *Metzger*

Farm, \_\_\_\_\_ Acres  
 County *W Va* State

Well No. *1*

Rig Commenced \_\_\_\_\_ 189 \_\_\_\_\_ } *E Myers* Contractor.  
 Rig Completed \_\_\_\_\_ 189 \_\_\_\_\_ }  
 Drilling Commenced *July 19* 189*9* } *H. J. Potts* Contractor.  
 Drilling Completed *June 8* 189*9* }

FORMATION.	TOP.	REMARKS.	BOTTOM
<i>Condr.</i>	<i>16 ft.</i>		
<i>10" Casq</i>	<i>640</i>		
<i>8 1/4 "</i>	<i>1395</i>		
<i>6 1/8 "</i>	<i>1975</i>		
<i>5 3/16 "</i>	<i>2294</i>		
<i>Fgh. Coal</i>	<i>965</i>		
<i>Shun Sand</i>	<i>2245</i>		<i>2530</i>
<i>Pay of Gas</i>	<i>2252</i>		
<i>Stray Sand</i>	<i>3033</i>		<i>3050</i>
<i>Gas.</i>	<i>3040</i>		
<i>London Sand</i>	<i>3052</i>		<i>3075</i>
<i>Gas.</i>	<i>3067</i>		
<i>Total Depth</i>			<i>3093</i>

NOTE:

A good record must show the formation from top to bottom of well.

*Well- 654*