



A-3

Hope Natural Gas Co.

# LOCATION FOR WELL No. 101

## Wetzel DISTRICT.

On Blackshere Wells & Co Farm, on waters of Archers fork

Grant District, Wetzel County, West Virginia.

Lease No. 729 Acres 3800 Range: N. 1 S. E. 3 W.

Scale 1" = 80 poles Made \_\_\_\_\_ 19\_\_

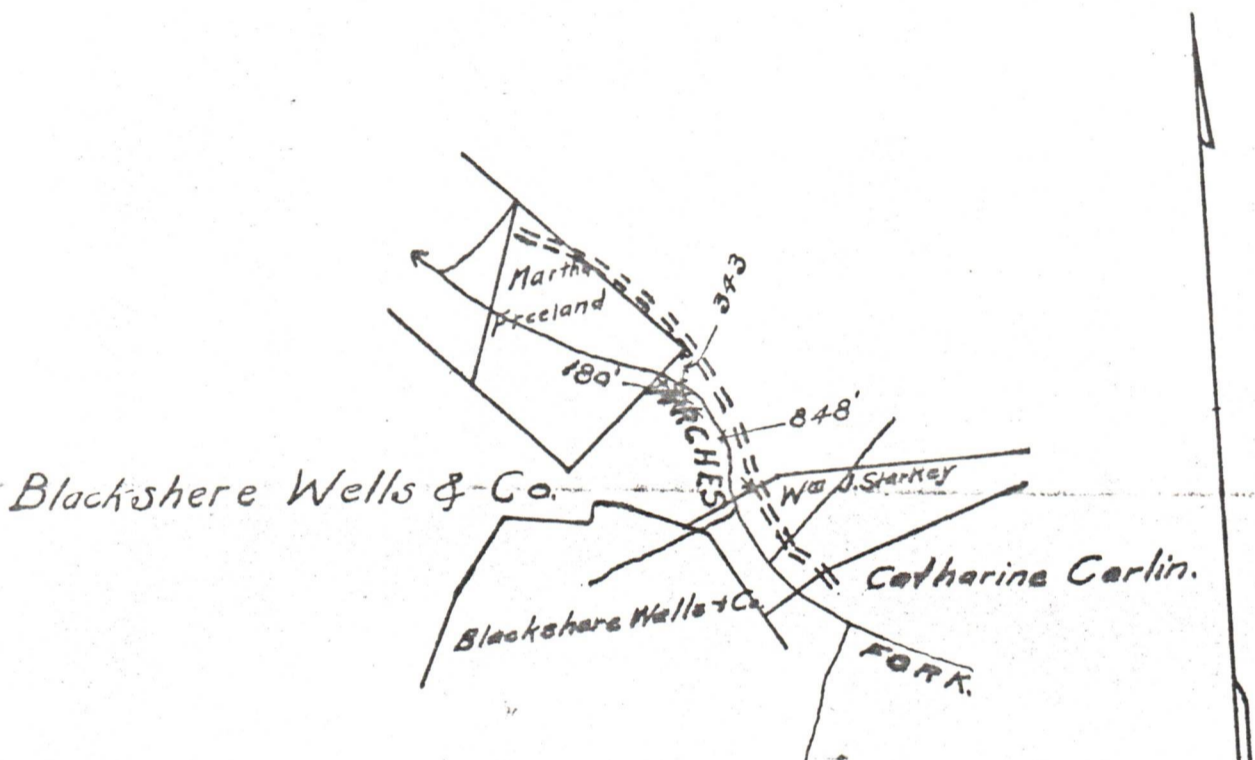

*new*  
 LOCATION ~~MADE~~ Oct 7 1908  
 BY Richard Scott  
 As per plat. Except as noted  
 On Field Map \_\_\_\_\_ 19\_\_\_\_  
 Returned to Pittsburg \_\_\_\_\_ 19\_\_\_\_

103-0657

RESERVE:.....  
 .....  
 .....  
 SPECIAL INSTRUCTIONS:.....  
 .....  
 .....

09/15/2023

# WELL RECORD.

B-1

H

*AWH*

*B. Mills* Farm ..... Acres  
*Grant* District *Nagle* County *N Va* State

Well No. *101*  
 Rig Commenced ..... 190  
 Rig Completed ..... 190  
 Drilling Commenced ..... 190  
 Drilling Completed ..... 190

Contractor.  
 Contractor.

ROCK FORMATION.	TOP.	BOTTOM.	REMARKS.
<i>Conductor</i>		<i>12</i>	<i>5 7/8 casing was put in after well was struck at Gordon by H. D. S. Co</i>
<i>Pittsburg Coal</i>	<i>656</i>	<i>646</i>	
<i>Big Chyun</i>	<i>1772</i>		
<i>Gas</i>	<i>2050</i>		
<i>Total Depth</i>		<i>2084</i>	
<i>Gordon Record</i>			
<i>Commenced May 26 - 1905</i>			
<i>Big Chyun</i>	<i>1972</i>	<i>2117</i>	
<i>Gray Sand</i>	<i>2723</i>	<i>2743</i>	
<i>Gas (First)</i>	<i>2723</i>		
<i>Gordon Sand</i>	<i>2743</i>	<i>2750</i>	
<i>Gas</i>	<i>2743</i>		
<i>Total Depth</i>		<i>2750</i>	
	<i>Completed Aug 2 - 1905</i>		

### CASING RECORD.

Size	Charged to Well.		Put in Well.		Pulled Out.		Left in Well.		Transferred Before Completion.		Left at Well, Not in Use.	
	Feet	In	Feet	In	Feet	In	Feet	In	Feet	In	Feet	In
<i>10</i>							<i>240</i>					
<i>8 1/4</i>							<i>1138</i>					
<i>6 5/8</i>							<i>1972</i>					
<i>5 7/8</i>							<i>2260</i>	<i>8</i>				

Approved by \_\_\_\_\_  
 Production First 24 hours ..... Bbls. \_\_\_\_\_ Supt. \_\_\_\_\_

09/15/2023

PROOF.—Sum of Three right hand columns equals First or "Charged to Well."  
 Use as many sheets as necessary to make a complete record.  
 In making out this record please use copying ink or an indelible pencil.

103-657

X

1.0 API well number (If not available, leave blank 14 digits.)	47-103-657			
2.0 Type of determination being sought. (Use the codes found on the front of this form.)	108 Section of NGPA	- Category Code		
3.0 Depth of the deepest completion location. (Only needed if sections 103 or 107 in 2.0 above.)	- feet			
4.0 Name, address and code number of applicant. (35 letters per line maximum. If code number not available, leave blank.)	Consolidated Gas Supply Corporation Name 445 West Main Street Street Clarksburg City		004228 Seller Code	W. Va. 26301 State Zip Code
5.0 Location of this well. (Complete (a) or (b).) (a) For onshore wells (35 letters maximum for field name.)	West Virginia Other Field Name		A-85772	
(b) For DCS wells	WETZEL County		W. Va. State	
	Area Name		Block Number	
	Date of Lease Mo Day Yr		OCS Lease Number	
(c) Name and identification number of this well (35 letters and digits maximum.)	BLACKSHERE WELLS		101	
(d) If code 4 or 5 in 2.0 above, name of the reservoir (35 letters maximum.)				
6.0 (a) Name and code number of the purchaser (35 letters and digits maximum. If code number not available, leave blank.)	General System Purchasers Name		Buyer Code	
(b) Date of the contract	Mo Day Yr			
(c) Estimated annual production	5 MMcf.			
	(a) Base Price (\$/MMBTU)	(b) Tax	(c) All Other Prices (Indicate (+) or (-).)	(d) Total of (a), (b) and (c)
7.0 Contract price (As of filing date. Complete to 3 decimal places.)	---	---	---	---
8.0 Maximum lawful rate (As of filing date. Complete to 3 decimal places.)	2.224	---	---	---
9.0 Person responsible for this application:	J. W. Hendrickson Name V.P. Gas Supply Title			
Agency Use Only	Signature <i>J.W. Hendrickson</i>			
Date Received by Juris. Agency	DEC. 31, 1978 Date Application is Completed			
Date Received by FERC	304-623-3611 Phone Number			

**U.S. DEPARTMENT OF ENERGY  
Federal Energy Regulatory Commission  
Washington, D.C. 20426**

**APPLICATION FOR DETERMINATION OF THE MAXIMUM LAWFUL  
PRICE UNDER THE NATURAL GAS POLICY ACT (NGPA)  
(Sections 102, 103, 107 and 108)**

**PLEASE READ BEFORE COMPLETING THIS FORM:**

General Instructions

Complete this form if you are applying for price classification under sections 102, 103, 107 or 108 of the NGPA. A separate application is required for each well. If any reservoir qualifies for a category which differs from the category applicable to the producing well, separate applications must be made for the producing well and the reservoir. Complete each appropriate item on the reverse side of this page. The code numbers used in items 4.0 and 6.0 can be obtained from the Buyer/Seller Code Book. If there is more than one purchaser or contract, identify the additional information in the space below. Enter any additional remarks in the space below.

Submit the completed application to the appropriate Jurisdictional Agency as listed in title 18 of the CFR, part 270.103. If there are any questions, call (202) 275-4539.

Specific Instructions for Item 2.0, Type of Determination

<u>Section of NGPA</u>	<u>Category Code</u>	<u>Description</u>
102	1	New OCS Lease
102	2	New onshore well (2.5 mile test)
102	3	New onshore well (1,000 feet deeper test)
102	4	New onshore reservoir
102	5	New reservoir on old OCS Lease
103	-	New onshore production well
107	-	High cost natural gas
108	-	Stripper well

Other Purchasers/Contracts:

<u>Contract Date</u> (Mo Day Yr.)	<u>Purchaser</u>	<u>Buyer Code</u>
_____	_____	_____
_____	_____	_____
_____	_____	_____

**Remarks:**

Applicant is an interstate pipeline company. Its production from the subject well is delivered into its pipeline system and is therefore not subject to a field sales contract.

FEB 22 1980

WELL OPERATOR: Consolidated Gas Supply Corp. 004228  
 FIRST PURCHASER: General System Purchasers N/A  
 OTHER: \_\_\_\_\_

*Revised Letter 108, stopped well  
 Patrick*

W. Va. Department of Mines, Oil & Gas Division  
 WELL DETERMINATION FILE NUMBER  
790227-108-103-0657  
 Use Above File Number on all Communications  
 Relating to Determination of this Well

CHECK EACH ITEM AS COMPLETE OR NOTE WHAT IS MISSING

- ITEM NO. \_\_\_\_\_
- 1 FERC-121  Items not completed - Line No. \_\_\_\_\_
  - 2 IV-1 - Agent J. W. Hendrickson
  - 3 IV-2 - Well Permit \_\_\_\_\_
  - 4 IV-6 - Well Plat
  - 5 IV-35- Well Record  Drilling  Deepening \_\_\_\_\_
  - 6 IV-36- Gas-Oil Test: Gas Only  Was Oil Produced? \_\_\_\_\_ Ratio \_\_\_\_\_
  - 7 IV-39- Annual Production 2 years - 1 mo.
  - 8 IV-40- 90 day Production 90-annual Days off Line: \_\_\_\_\_
  - 9 IV-48- Application for Certification. Complete?
  - 10 - 17 IV Form #51 - 52 - 53 - 54 - 55 - (56) - 57 - 58. Complete  Affidavit Signed
  - 18 - 28 Other: Survey \_\_\_\_\_ Logs \_\_\_\_\_ Geological Charts \_\_\_\_\_ Structure Map \_\_\_\_\_  
 1:4000 Map \_\_\_\_\_ Well Tabulations \_\_\_\_\_ Gas Analyses \_\_\_\_\_
  - (5) Date commenced: 5-26-05  
 Date Completed: 8-2-05 Deepened \_\_\_\_\_
  - (5) Production Depth: 1772-2084; 2723-2743
  - (5) Production Formation: B. Injun; Stray Sand
  - (5) Final open Flow N/A
  - (5) ~~Initial Flow~~ N/A
  - (5) Static R.P. ~~\_\_\_\_\_~~ N/A
  - (6) Other Gas Test: ~~\_\_\_\_\_~~
  - (7) Avg. Daily Gas from Annual Production: 4323/365 = 12 MCF
  - (8) Avg. Daily Gas from 90-day endit. w/1-120 days 1203/90 = 13 MCF
  - (8) Line Pressure: N/A PSIG from Daily Report \_\_\_\_\_
  - (5) Oil Production: No From Completion Report \_\_\_\_\_
  - (10-17) Does lease inventory indicate enhanced recovery being done: No
  - (10-17) Is affidavit signed?  Notarized?
- Does official well record with the Department confirm the submitted information? No
- Additional Information \_\_\_\_\_ Does computer program confirm? \_\_\_\_\_
- Was Determination Objected to? \_\_\_\_\_ By Whom? \_\_\_\_\_

09/15/2023

Date 12-31 1978

STATE OF WEST VIRGINIA  
DEPARTMENT OF MINES, OIL AND GAS DIVISION

Operator's  
Well No. 101

API Well  
No. 47 - 10.3 - 657  
State County Permit

WELL CLASSIFICATION FORM

STRIPPER GAS WELL

NGPA Section 108

DESIGNATED AGENT J. W. Hendrickson

ADDRESS 445 West Main Street  
Clarksburg, West Virginia 26301

WELL OPERATOR Cons. Gas Supply Corp. LOCATION: Elevation 926

ADDRESS 445 West Main Street Watershed ARCHERS FORK  
Clarksburg, W. Va. Dist. GRANT County WETZEL Quad. \_\_\_\_\_

GAS PURCHASER None; gas is de- Gas Purchase Contract No. N/A

ADDRESS livered into applicant's Meter Chart Code N/A

interstate pipeline system Date of Contract N/A

\* \* \* \* \*

Provide a complete inventory of the lease and production equipment used for the well for the previous 24 months or, if less than 24 months, the period the well has been in production. Include a complete list of equipment or processes used in connection with recognized enhanced recovery techniques during completion or production. (Attach separate sheets, if necessary.)

See attachment; compression, dehydration, or related equipment indicated on the attached inventory, and hydraulic fracturing, shooting, or similar completion processes indicated on the attached well records, are used in connection with recognized enhanced recovery techniques during production or completion.

List all records reasonably available to you which contain information relevant to a determination of eligibility (including production records, B&O Tax Records and royalty payment records) and indicate the location of such records:

Applicant's oil and gas production records (which are largely computerized) constitute its primary and most reliable source of information relevant to a determination of eligibility. From these records Applicant derives information used by it in connection with royalty payments, tax payments, and general statistical uses, and records of these matters are also maintained. All of the above records are located at Applicant's offices at 445 West Main Street, Clarksburg, West Virginia.

09/15/2023

Describe the search made of any records listed above.

As indicated, Applicant's primary oil and gas production records have been largely computerized. In preparing this application, Applicant, by use of its computers, generated a listing of those of its wells which produced non-associated natural gas at a rate not exceeding an average of 60 Mcf per production day (at maximum efficient rates of flow) during the 90 day production period indicated on the attachment. These listings were checked and verified manually by two or more Applicant's employees. The results of this diligent search and examination indicated that the well which is the subject of this application qualifies as a stripper well; see attached data submitted in compliance with applicable regulations of this agency and the Federal Energy Regulatory Commission.

Are you aware of any other information which would tend to be inconsistent with the information specified above? Yes \_\_\_ No X. If yes, indicate the type and source of the information.

AFFIDAVIT

I, J. W. Hendrickson, having been first sworn according to law, state that I have caused to be made a diligent search of those records hereinbefore indicated in the manner herein described, that the information contained in this document is true and accurate and that on the basis of the records and examinations hereinbefore described, and to the best of my information, knowledge and belief, the well for which this certification is sought qualifies as a stripper well.

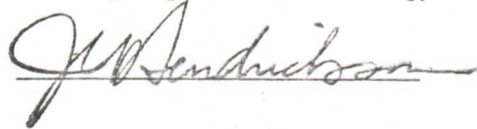

STATE OF WEST VIRGINIA,

COUNTY OF HARRISON, TO WIT:

I, Ralph D. Bradley, a Notary Public in and for the state and county aforesaid, do certify that J.W. Hendrickson, whose name is signed to the writing above, bearing date the \_\_\_ day of DEC 31 1978, has acknowledged the same before me, in my county aforesaid.

Given under my hand and official seal this 7 day of Feb, 19 79.

My term of office expires on the 13th day of September, 19 86.

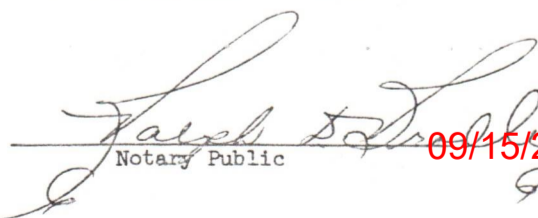
  
Notary Public

09/15/2023

(NOTORIAL SEAL)



09/15/2023

CONSOLIDATED GAS SUPPLY CORPORATION--SOUTHERN REGION

WELL NUMBER 101  
COMPANY FORMATION CODE 0  
DISTRICT MANINGTN  
COUNTY 103  
ETER NUMBER-999999999  
DCK PRESSURE 32 IN 0/71  
ERMIT NUMBER 0

DATE COMPLETED 10/11/1893  
DATE INTO LINE 10/18/93  
SPUD DATE 0/0/0

ORIG OPEN FLOW 3131 M  
ORIG ROCK PRES 325 P  
PCT INTEREST 100.0000  
TOWNSHIP 4  
PRE 10/07/69 LEASE  
LAST LINE PRESSURE

GROSS MONTHLY PRODUCTION IN MCF

	JAN	FEB	MAR	APR	MAY	JUN	JUL	AUG	SEP	OCT	NOV	DEC	TOTAL
176 PROD	0	0	0	0	0	0	0	0	0	0	396	409	805
ILY AVG	0	0	0	0	0	0	0	0	0	0	13	13	13
EC. GRAV.	0.0	0.0	0.0	0.0	0.0	0.0	0.0	0.0	0.0	0.0	85.731	85.731	85.731
77 PROD	462	375	428	402	403	396	365	388	480	481	447	372	499
ILY AVG	14	13	13	13	13	13	11	12	16	15	14	12	13
EC. GRAV.	85.731	85.728	85.731	85.730	85.731	85.730	85.729	85.731	85.730	85.731	85.730	85.731	85.731
78 PROD	381	330	369	363	425	408	431	413	396	419	390	0	432
ILY AVG	12	11	11	12	13	13	13	13	13	13	13	0	13
EC. GRAV.	85.731	85.728	85.731	85.730	85.731	85.730	85.731	85.731	85.730	85.731	85.730	85.731	85.731