



HOPE NATURAL GAS COMPANY  
YALCOB OR M

# HOPE NATURAL GAS COMPANY

LOCATION FOR WELL No. 1630

C. 7  
Instructions N

Wetzel DISTRICT

G. Robinson Farm, on waters of Shreve's Creek

Wetzel District, Wetzel County, West Virg

Lease No. 132 Acres 12 1/4 N. 3 S. 6 E. 3 W.

Scale one inch equals 80 feet Location made in Pittsburgh, Aug 1-1919 Sent to Clarksburg

Location to be Ownership Well -

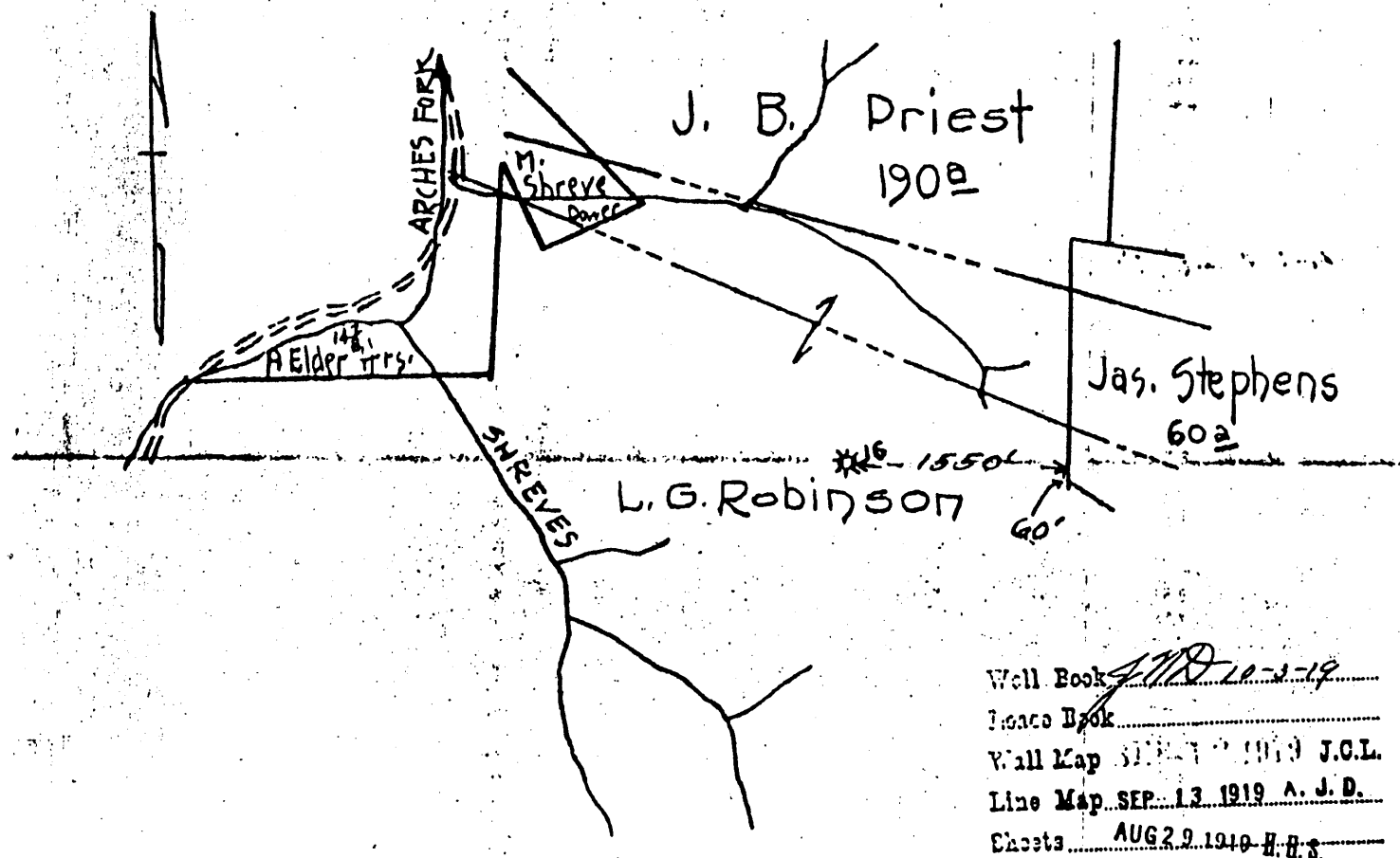

Well Book 110-10-1-19  
Lease Book  
Well Map SEP 13 1919 J.C.L.  
Line Map SEP 13 1919 A. J. D.  
Sheets AUG 29 1919 H.H.S.

API  
103-0718

39  
40

TITLE RESERVE Ownership Lease, South Penn Oil Co.  
Aug 20 1919 Leasing Lease, South Penn Oil Co. to be on this farm.

SPECIAL INSTRUCTIONS: COMPLETE WELL ON OR BEFORE

Same Lease on which 118 Located Well No. 11-12-14-08-12-19-2382-4721

Measurements obtained from Location Made Aug 12, 1919 by South Penn Oil Co. As per plat, except as noted. On field

Returned to Pittsburgh Aug. 12, 1919

Location changed on account of

Authorized by \_\_\_\_\_ Date \_\_\_\_\_ Signed S.H. Bradley,  
Ry - Talley,

Well No. **5630** **Wetsel**  
 Located on **L. G. Robinson**  
 District **Grant** County **Wetsel** State **V. A.**

Location Made **?** First Work Done **?**  
 Rig Commenced **?** Rig Completed **?**  
 Drilling Commenced **May 29th, 1919** Drilling Completed **July 23rd, 1919**  
 Rig Contractor **?** Drilling Contractor **S. P. O. Drilling Dept**  
 Drillers **J. G. Templeton & A. W. Day**  
 Tool Dressers **Back Wyatt & Bert Beverlin**

FORMATION	TOP	BOTTOM	Steel Line Measurements	Water Found Depth	Oil Found Depth	Gas Found Depth	REMARKS
Native Coal	1125	1133					Record furnished by S. P. Oil Co.
Pittsburg Coal	1125	1133					
Little Dunkard							
Big Dunkard	1600	1650					
Gas Sand							
First Salt	1925	2015					S. P. O. Co. #16
Second Salt							
Maxon							
Little Line							
Pencil Cove	2325	2330					
Big Line	2330	2430					
Big Injun	2430	2600			2521		about, 30 bbls
Squaw							
Berea							
Gantz							
Fifty Foot	2950	2965					
Thirty Foot							
Gordon Stray	3154	3182					
Gordon	3225					3229	25/10. Mercury on 2"
Fourth							
Total Depth	3236						

SIZE	Charged to Well		Put in Well		Pulled Out		Left in Well		Transferred Before Completing		Left at Well Not in Use		If more than two strings of casing are left hole, give reasons for leaving additional strings.
	Foot	In.	Foot	In.	Foot	In.	Foot	In.	Foot	In.	Foot	In.	
19" Csg													
10" "			298				298						
8 1/2" "			1641				1641						
6 5/8" "			2485				2485						
5 3/16" "	16	3	2811		16	3	2811				16	3	
2" Tbg.	3343	4	3257				3257				65	10	25' for Storage

SIZE	KIND	Amount Anchor	Amount Above Anchor	REMARKS
5 3/16" x 2	Anchor	58'	3241' 4"	Packer 2' 8" Perforation set at 31'

SHOOTING RECORD (If shot before or upon completion of well)														
DATE	Gauge	Top of Shell	Bottom of Shell	Diameter	Sand	Test Before Shot			Test After Shot			Test Taken After Shot No. Hours	By Whom Shot	
						Reading	Liquid	Opening	Reading	Liquid	Opening			
		Not Shot												

**CEMENTING RECORD**

Date Cemented **Not Cemented** Size Hole Cemented ..... Size Casing Cemented .....  
 Top Pittsburg Coal ..... Top Cementing ..... Amount Cement Used .....  
 Bottom Pittsburg Coal ..... Bottom Cementing ..... Amount Cement Used .....  
 Mr. .... of ..... Coal Company on ground when coal was cemented  
 Remarks: ..... Signatures of persons who cemented well  
 Old Oil well drilled deeper, 1-5 1/2" Csg, Shoe on Bottom of 5 3/16" Casing,  
 no Record as to what was on other casing.

Approved by *M. J. ...* Foreman  
 OCT 18 1919  
 OCT 21 1919 E.E.S.  
 APR - 103-0719

# Hope Natural Gas Company

Well No. **5630**

## REPAIR RECORD

Pina Grove Dis

Farm Name **L. G. Robinson**

N 3 S - E 3 W

Repairs Commenced **11-29-45**

Repairs Completed **3/13/46**

### CASING AND TUBING RECORD

Size	Before Repairs	Pulled	Put In Well	After Repairs	Disposition of Amount Pulled
10	298-0	none	none	298-0	
8-1/4	1641	none	none	1641-0	
6-5/8	2485-0	none	none	2485-0	
5-3/16	2811-0	none	none	2811-0	
2" Tubg	3257-0	3257-0	3321	3321-0	

### SHOOTING RECORD

Date	Quarts	Top of Shell	Bottom of Shell	Diameter	Sand	TEST BEFORE SHOT			TEST AFTER SHOT			Test Taken After Shot No.	By Whom Shot
						Reading	Liquid	Opening	Reading	Liquid	Opening		
3-30-46	20	3226	3234	4"	Gord	18/10	W	1"	30/10	W	1"	83	M.T.Co.
	Open Shot					31	950	cuft	41,822	cuft			

### RECORD OF ANY DEEPER DRILLING

Formation	Top	Bottom	Names of Drillers	Time (Days)
Drilled Pocket Commenced drilling at depth of	3236		Charley E. Wise	81
Gordon	3225	3245		
			Names of Tool Dressers	Time (Days)
			Delbert E. Canary	81

PACKER RECORD (ALSO NOTE BELOW IF ANY PACKERS ARE PULLED)			
Size	Kind	Anchor	Am Above
5-3/16x2	Comb W-A Packer	108	318
(5-3/16x2 Anchor Packer Pulled)			

OIL AND GAS DISCOVERIES IN DEEPER DRILLING			
Oil at		Ft. In	
Gas at		Ft. In	

### VOLUME AND PRESSURE REPORT

#### BEFORE REPAIRS

Reading	Liquid	Opening	Rock or Minute Pressure	Sands Gas From
(APR 5-1944 - Test) 32/10	water	1"	78	Gordon
		42600 cuft.	206.7-1945	When Start - C.O.
			Test - 13/10-W-1" FM - 26.087	

#### AFTER REPAIRS

#### VOLUME TEST

Date of Test	Flow Meter or Open Flow	Size of Opening	PITOT TUBE	OPEN FLOW	Sands Gas From
3/7/46	FM	1/4	Reading: 80/10 Liquid Used: Water	41,822 cuft.	Leak Gordon
3/7/1946	FM	1			
Time Blown					

#### PRESSURE TEST

Date of Test	Opening	1 Min.	2 Min.	3 Min.	4 Min.	5 Min.	6 Min.	7 Min.	8 Min.	9 Min.	10 Min.	20 Min.	60 Min.
3/7/46	5-3/16	0	0	0	0	0	0	0	0	0	0	0	0
3/7/46	2" Tubing	6	10	18	16	18	20	22	24	26	27	38	44

OIL: From None Sand.

Estimated Production \_\_\_\_\_ Bbl. per Day

Remarks: \_\_\_\_\_

*[Signature]*  
District Supervisor

103-718