

The Wheeling Natural Gas Company.

LOCATION FOR WELL No. 1621

Lease No. 4377 for 121 Acres, Hundred District.

DESCRIPTION

Well No. 1621 on farm of J. Lindsay Heimrich
Wirtz Dist., Wirtz Twp. Wirtz County W.V.
750 feet from North line of Eliz. Hummel Farm.
37 feet from West line of St. J. Minor (250) Farm.
 feet from line of Farm.
 feet of well on Farm.

As shown on sketch below. Scale of sketch: 1" equals 125 feet.
 Location made April 11 1912 Signed W. S. W.
 Reservation around Buildings. 300 Feet.

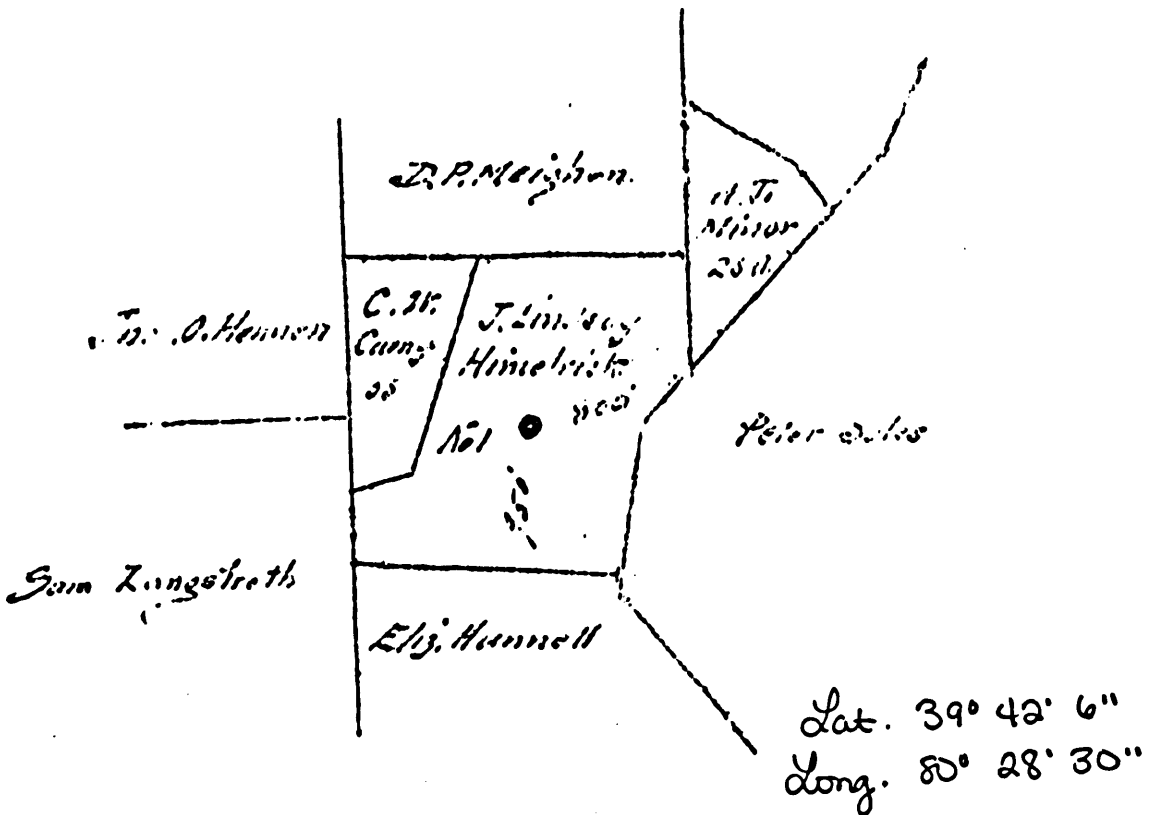

WET-727

W. S. W. Dist. Supt. Pittsburgh, Pa., April 11 1912

You are hereby authorized to commence work on above well at once, as well must be commenced by at once 1912, and must be completed by 1912

All charges for labor and material incident to above well must be charged to this Well No. 1621

APPROVED
[Signature]

The Manufacturers Light & Heat Co.

Farmers Bank Building, Pittsburg, Penna.

Record of Well No. 1601 of Lindsay Hughes Farm 101 Acres
 Numbered 1601 Field Couch Hopel County W. Va. State
 Rig commenced Apr. 29 1913 Completed May 6 1913
 Drilling commenced May 28 1913 Completed Oct 2 1913
 Cost per foot 1.50 Contractor Frank Alexander & Son Address Beetles, Pa.
 Drillers' names Nancy Williams & Mike O'Neil

BOILER			ENGINE			RIG		
H. P.	No.	Name of Maker	H. P.	No.	Name of Maker	New	Old	Height
						<u>New</u>		<u>82'</u>
								<u>May 8 1913</u>

CONDUCTOR AND CASING USED IN DRILLING									
Conductor	18 inch	16 inch	14 inch	12 inch	10 inch	8 inch	6 inch	4 inch	3 inch
<u>1</u>	<u>16</u>	<u>318' 10"</u>	<u>1550</u>	<u>2352' 0"</u>					

CONDUCTOR AND CASING LEFT IN WELL									
Conductor	18 inch	16 inch	14 inch	12 inch	10 inch	8 inch	6 inch	4 inch	3 inch
		<u>318' 10"</u>	<u>1550</u>	<u>2352' 0"</u>					

OIL WELL					GAS WELL					
When Shut	Size of Torpedo	1st Day's Production	Tubing	Reds	Tanks	Size of Packer	Depth Set	Packed With	1st Month's Pressure	Back Pressure

FORMATION	Top	Bottom	Thickness	REMARKS
<u>Mapleton Coal</u>	<u>993</u>	<u>927</u>	<u>4</u>	
<u>Pittsburg</u>	<u>1090</u>	<u>1091</u>	<u>8</u>	
<u>Little Dunkard Sand</u>	<u>1485</u>	<u>1520</u>	<u>35</u>	
<u>Big " "</u>	<u>1630</u>	<u>1662</u>	<u>12</u>	
<u>1 1/2" Plat. Sand</u>	<u>1700</u>	<u>1720</u>	<u>20</u>	
<u>2 1/2" "</u>	<u>1745</u>	<u>1775</u>	<u>30</u>	
<u>Salt " "</u>	<u>1875</u>	<u>1968</u>	<u>93</u>	
<u>Gas at</u>	<u>1882</u>			
<u>Major Sand</u>	<u>2100</u>	<u>2134</u>	<u>34</u>	<u>Little Gas</u>
<u>Little Lime</u>	<u>2253</u>	<u>2273</u>	<u>20</u>	
<u>Pencil Cove</u>	<u>2273</u>	<u>2288</u>	<u>15</u>	
<u>Big Lime</u>	<u>2281</u>	<u>2365</u>	<u>77</u>	
<u>" Argon</u>	<u>2365</u>	<u>2515</u>	<u>220</u>	
<u>Thirty Foot</u>	<u>2930</u>	<u>2952</u>	<u>22</u>	
<u>Fifty " "</u>	<u>3080</u>	<u>3122</u>	<u>42</u>	
<u>London Street</u>	<u>3142</u>	<u>3160</u>	<u>18</u>	
<u>" Sand</u>	<u>3200</u>	<u>3220</u>	<u>20</u>	<u>Gas at 3215</u>
<u>Fourth Sand</u>	<u>3226</u>	<u>3292</u>	<u>72</u>	
<u>Gas & Oil</u>	<u>3281</u>			
<u>Total depth</u>	<u>3420</u>			

WET-727

Examined above information and measurements and found to be correct by
Frank Alexander & Son Contractor
 Examined and approved by
A. Snyder Superintendent of Co.
 NOTE - The above blank must be filled out carefully by the Contractor, with a complete and accurate record of the Well, and accompany, when presented for payment, the bill for drilling.
 Measurements and known names used for given by their proper name, with steel line measurements, and under the head of "Remarks" must be recorded in what sand and depth depth (ft., line or Water was found, the quantity of water, the quality of the sand, and thickness of pay.
 measurements of boiler and engine if owned by Contractor.

0002 0517