



West Virginia Department of Environmental Protection
Office of Oil and Gas
WELL LOCATION FORM: GPS

API: 47-103-00832 P WELL NO.: WV 601629 (Robinson #1629)

FARM NAME: Robinson

RESPONSIBLE PARTY NAME: EQT Production Company

COUNTY: Wetzel DISTRICT: Grant

QUADRANGLE: Pine Grove 7.5'

SURFACE OWNER: Wheeling Jesuit University, Inc

ROYALTY OWNER: Sarah M. Robinson et. al.

UTM GPS NORTHING: 4,376,320

UTM GPS EASTING: 529,732 GPS ELEVATION: 281 m (923 ft)

The Responsible Party named above has chosen to submit GPS coordinates in lieu of preparing a new well location plat for a plugging permit or assigned API number on the above well. The Office of Oil and Gas will not accept GPS coordinates that do not meet the following requirements:

- Datum: NAD 1983, Zone: 17 North, Coordinate Units: meters, Altitude: height above mean sea level (MSL) – meters.
- Accuracy to Datum – 3.05 meters
- Data Collection Method:
Survey grade GPS : Post Processed Differential
Real-Time Differential
Mapping Grade GPS : Post Processed Differential
Real-Time Differential
- Letter size copy of the topography map showing the well location.**

I the undersigned, hereby certify this data is correct to the best of my knowledge and belief and shows all the information required by law and the regulations issued and prescribed by the Office of Oil and Gas.

Ben Saylor
Signature

P.S. 2092
Title

9-30-11
Date

Topo Quad: Pine Grove

Scale: 1" = 2000' 103-00832P

County: Wetzel

Date: Aug. 4, 2011

District: Grant

Project No: 40-34-00-09

47-103-00832 (WV 601629)

Topo

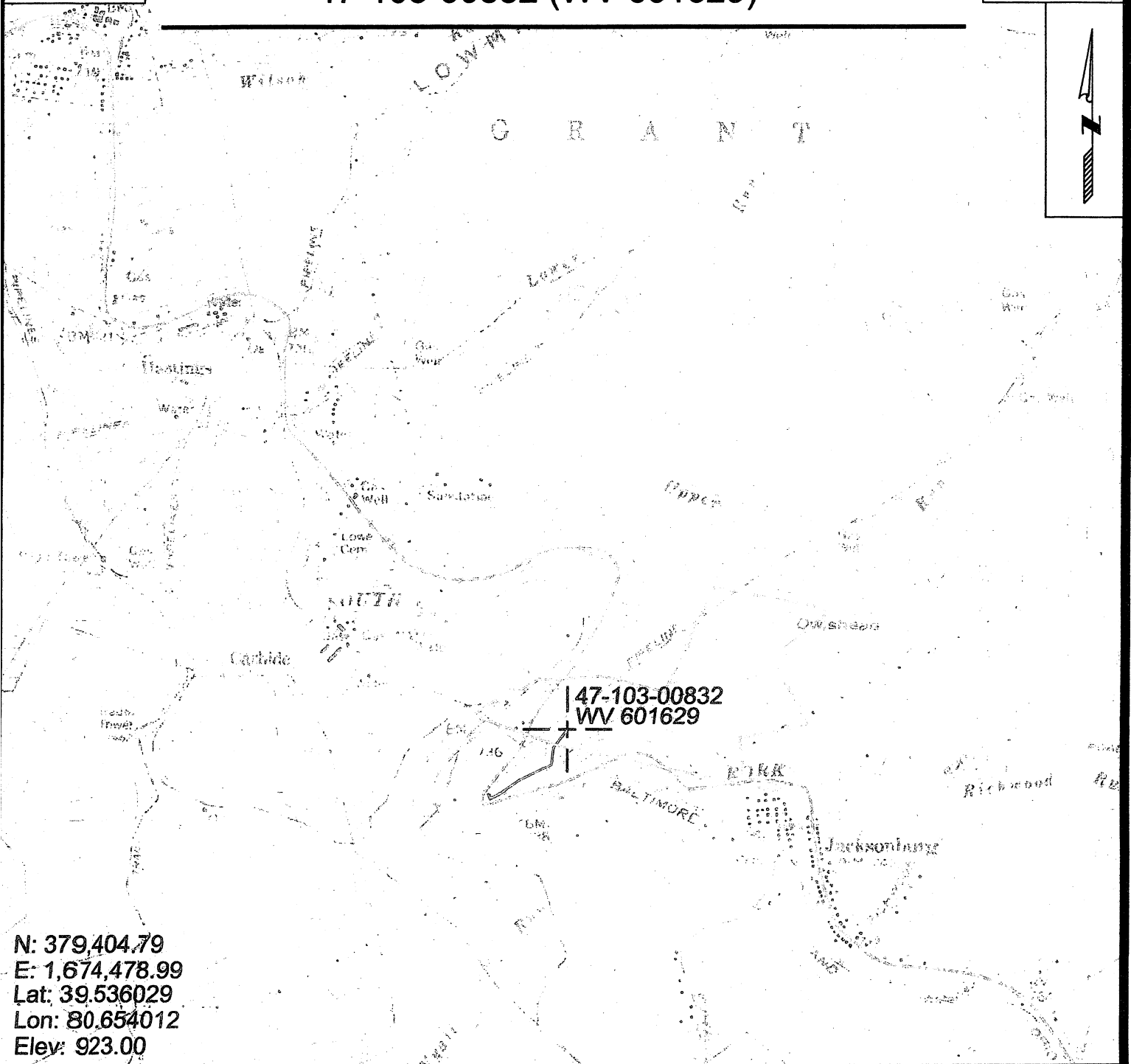

N: 379,404.79
E: 1,674,478.99
Lat: 39.536029
Lon: 80.654012
Elev: 923.00



SURVEYING AND MAPPING SERVICES PERFORMED BY:
ALLEGHENY SURVEYS, INC.
1-800-482-8606
P.O. BOX 438
BIRCH RIVER, WV 26610
PH: (304) 649-8606
FAX: (304) 649-8608

PREPARED FOR:
EQT Production Company
1710 Pennsylvania Ave.
Charleston, WV 25302