

LATITUDE 39° 40' 00"

80° 40' 00"

LONGITUDE

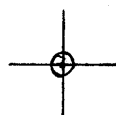

7'5 OGIS topo location

7.5' 10C	<u>2.265</u>	15' 10C	_____
	<u>1.10w</u>	(calc.)	_____

Company _____

Farm _____

Quad WILEYVILLE 7 1/2'

County WETZEL

District PROCTOR

WELL LOCATION MAP

File No. 103-0902

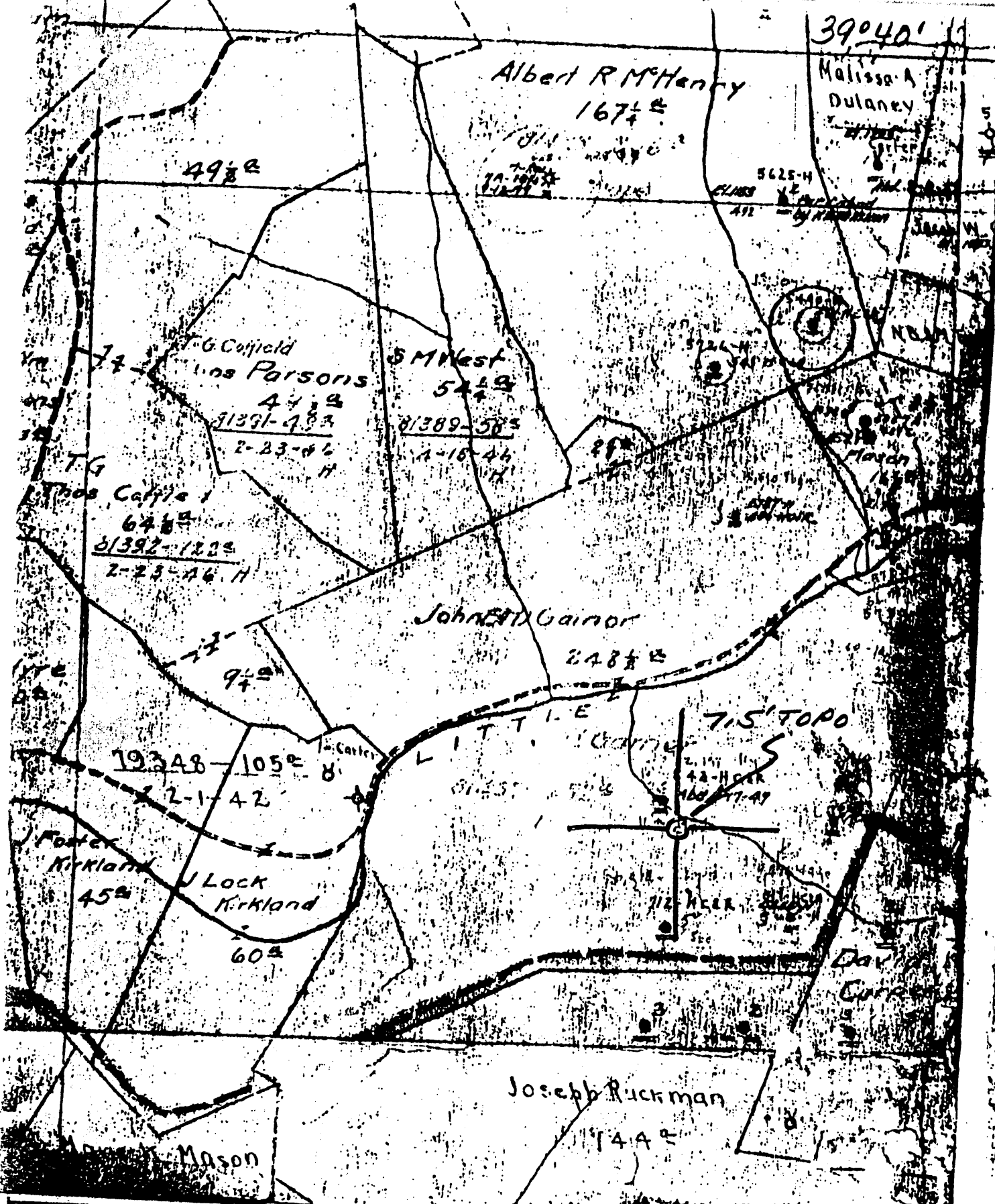

(+) DENOTES LOCATION OF WELL ON UNITED STATES TOPOGRAPHIC MAPS
 FORM IV-6 (8-78)
N77N13E9

 STATE OF WEST VIRGINIA
 DEPARTMENT OF MINES
 OIL AND GAS DIVISION

DATE 1-5-1979
 OPERATOR'S WELL NO. _____
 API WELL NO. 47-103-0902
 STATE COUNTY PERMIT

WELL TYPE: OIL GAS _____ LIQUID INJECTION _____ WASTE DISPOSAL _____
 (IF "GAS", PRODUCTION _____ STORAGE _____ DEEP _____ SHALLOW _____)
 LOCATION: ELEVATION _____ WATER SHED LITTLE FISHING CK
 DISTRICT PROCTOR COUNTY WETZEL
 QUADRANGLE WILLEVILLE 7.5'

SURFACE OWNER _____ ACREAGE _____
 OIL & GAS ROYALTY OWNER _____ LEASE NO. _____ LEASE ACREAGE _____

PROPOSED WORK: DRILL _____ CONVERT _____ DRILL DEEPER _____ REDRILL _____ FRACTURE OR
 STIMULATE _____ PLUS OFF OLD FORMATION _____ PERFORATE NEW
 FORMATION _____ OTHER PHYSICAL CHANGE IN WELL (SPECIFY) _____

PLUG AND ABANDON _____ CLEAN OUT AND REPLUG _____
 TARGET FORMATION _____ ESTIMATED DEPTH _____
 WELL OPERATOR Pennzoil Company ADDRESS James A. Crews
 ADDRESS P. O. Box 1585 ADDRESS P. O. Box 1588
Parkersburg, WV 26101 Parkersburg, WV 26101

A. R. McHENRY-1

DISTRICT *Walla Walla*
 RECORD
 CASINO AND TUBING
 DATE TAKEN *1919*
 LOCATION *Walla Walla*
 SURVEYED BY *W. H. ...*
 COMPLETED *1919*
 CONTRACTOR *W. H. ...*
 PURCHASED FROM *W. H. ...*
 DATE PURCHASED *1919*
 DATE SHUT IN
 DATE CONNECTED
 DATE TURNED ON
 DATE TURNED OFF
 DATE DISCONNECTED
 SOLD TO
 DATE SOLD
 DATE RE-PLUMBED
 DATE RE-CASINO
 DATE RE-ARRANGED
 ELEVATION ABOVE SEA LEVEL

DATE TAKEN	TIME	DEPTH	OPENING	INCHES PRESSURE	1 MIN	5 MIN	10 MIN	30 MIN	60 MIN	1 HOUR	1 DAY	PACKERS	INITIAL OIL PRODUCTION	
												SIZE	MAKE	DATE
<i>1919</i>														
<i>1919</i>														
<i>1920</i>														
<i>1920</i>														

power caped
