

(+) DENOTES LOCATION OF WELL ON UNITED STATES TOPOGRAPHIC MAPS

FILE NO. 84-380
 DRAWING NO. _____
 SCALE 1" = 1000'
 MINIMUM DEGREE OF ACCURACY 1/200'
 PROVEN SOURCE OF ELEVATION 103-1147
(1334.9')

I THE UNDERSIGNED, HEREBY CERTIFY THAT THIS PLAT IS CORRECT TO THE BEST OF MY KNOWLEDGE AND BELIEF AND SHOWS ALL THE INFORMATION REQUIRED BY LAW AND THE REGULATIONS ISSUED AND PRESCRIBED BY THE DEPARTMENT OF MINES.
 (SIGNED) Ed Waterman
 R.P.E. 3788 L.L.S. _____

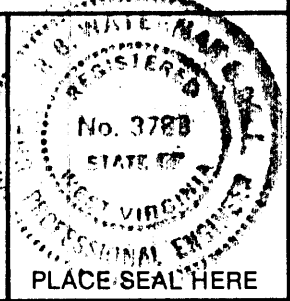

STATE OF WEST VIRGINIA
 DEPARTMENT OF MINES
OIL AND GAS DIVISION

DATE 7/6, 1984
 OPERATOR'S WELL NO. RHODA #1
 API WELL NO. BALLOUZ #2

WELL TYPE: OIL ___ GAS X LIQUID INJECTION ___ WASTE DISPOSAL ___
 (IF "GAS,") PRODUCTION X STORAGE ___ DEEP ___ SHALLOW ___

LOCATION: ELEVATION 1220 WATER SHED HAYNES RUN **CANCELLED**
 DISTRICT MAGNOLIA COUNTY WETZEL
 QUADRANGLE NEW MARTINSVILLE 7.5'

SURFACE OWNER J. M. BALLOUZ ACREAGE 283.50
 OIL & GAS ROYALTY OWNER J. M. BALLOUZ LEASE ACREAGE 283.50
 LEASE NO. _____

PROPOSED WORK: DRILL X CONVERT ___ DRILL DEEPER ___ REDRILL ___ FRACTURE OR
 STIMULATE ___ PLUG OFF OLD FORMATION ___ PERFORATE NEW
 FORMATION ___ OTHER PHYSICAL CHANGE IN WELL (SPECIFY) _____

PLUG AND ABANDON ___ CLEAN OUT AND REPLUG ___

TARGET FORMATION MARCELLUS SHALE ESTIMATED DEPTH 5990'
 WELL OPERATOR CLAY RESOURCES, INC. DESIGNATED AGENT STEVE KUHLE
 ADDRESS 204 UNION SQUARE ADDRESS 1004 41st St.
MARIETTA, OHIO 45750 Vienna, WV

APR 27 1987

FORM IV-6 (8-78)
 H.T. HALL

COUNTY NAME WETZEL
 PERMIT 1312

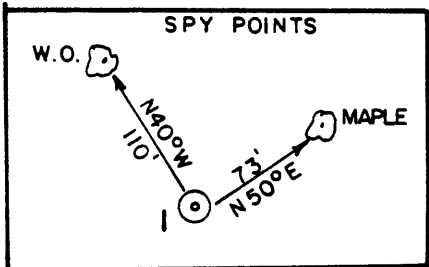
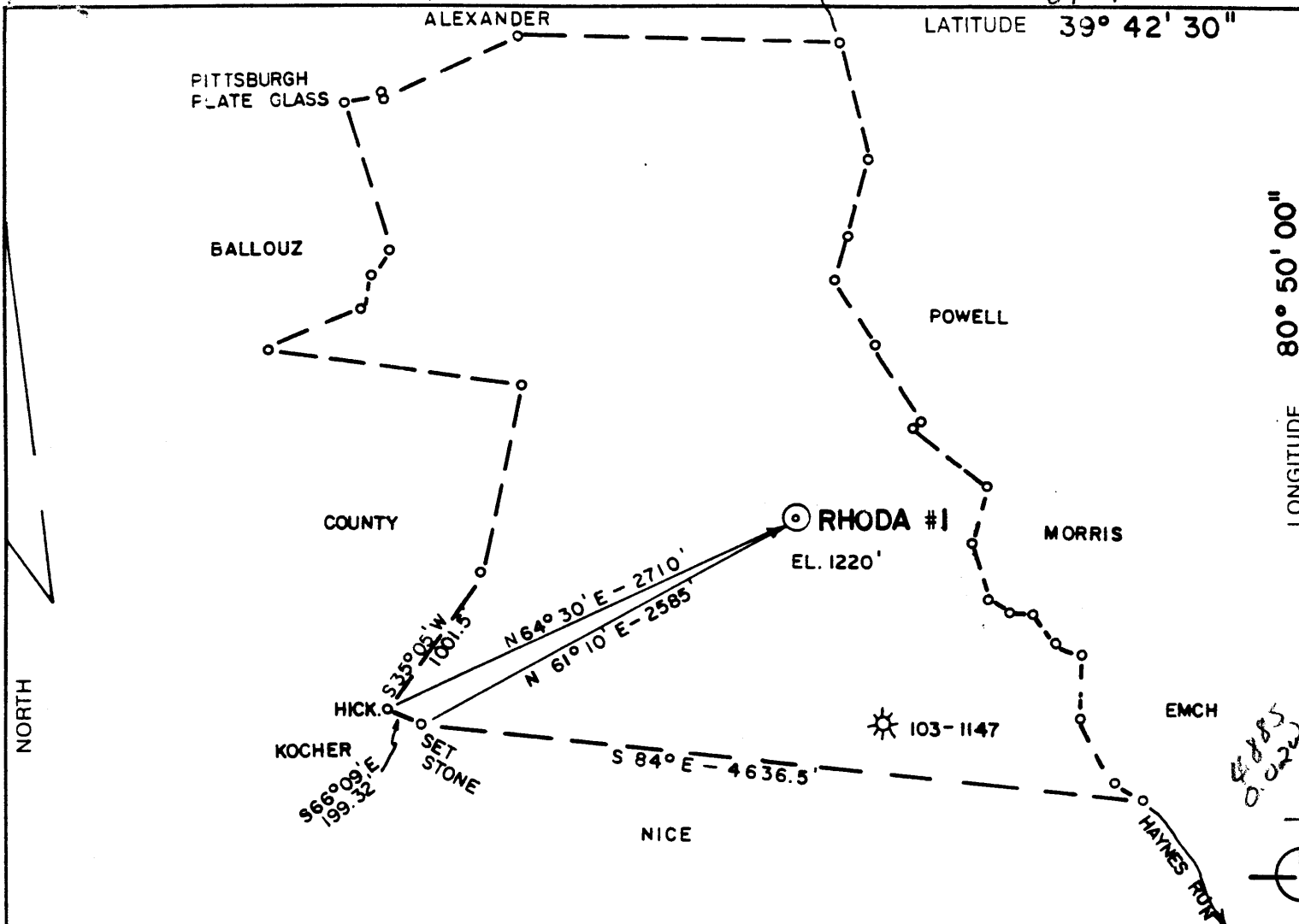

(+) DENOTES LOCATION OF WELL ON UNITED STATES TOPOGRAPHIC MAPS

FILE NO. 84-380
 DRAWING NO. _____
 SCALE 1" = 1000'
 MINIMUM DEGREE OF ACCURACY 1/200'
 PROVEN SOURCE OF ELEVATION 103-1147
(1334.9')

I THE UNDERSIGNED, HEREBY CERTIFY THAT THIS PLAT IS CORRECT TO THE BEST OF MY KNOWLEDGE AND BELIEF AND SHOWS ALL THE INFORMATION REQUIRED BY LAW AND THE REGULATIONS ISSUED AND PRESCRIBED BY THE DEPARTMENT OF MINES.
 (SIGNED) Bob Waterman
 R.P.E. 3788 L.L.S. _____

PLACE SEAL HERE

STATE OF WEST VIRGINIA
 DEPARTMENT OF MINES
 OIL AND GAS DIVISION



DATE 7/6, 19 84
 OPERATOR'S WELL NO. RHODA #1
 API WELL NO. _____

WELL TYPE: OIL ___ GAS X LIQUID INJECTION ___ WASTE DISPOSAL ___
 (IF "GAS,") PRODUCTION X STORAGE ___ DEEP ___ SHALLOW ___
 STATE 47 COUNTY 103 PERMIT 1312

LOCATION: ELEVATION 1220 WATER SHED HAYNES RUN
 DISTRICT MAGNOLIA COUNTY WETZEL

QUADRANGLE NEW MARTINSBURG 7.5' 509 New Martinsville 091

SURFACE OWNER J. M. BALLOUZ ACREAGE 283.50
 OIL & GAS ROYALTY OWNER J. M. BALLOUZ LEASE ACREAGE 283.50

PROPOSED WORK: DRILL X CONVERT ___ DRILL DEEPER ___ REDRILL ___ FRACTURE OR STIMULATE ___ PLUG OFF OLD FORMATION ___ PERFORATE NEW FORMATION ___ OTHER PHYSICAL CHANGE IN WELL (SPECIFY) _____

PLUG AND ABANDON ___ CLEAN OUT AND REPLUG ___
 TARGET FORMATION MARCELLUS SHALE ESTIMATED DEPTH 5990'
 WELL OPERATOR CLAY RESOURCES, INC. DESIGNATED AGENT STEVE KUHLE
 ADDRESS 204 UNION SQUARE ADDRESS 1004 41st St. Vienna, WV
 MARIETTA, OHIO 45750

SEP 17 1984

FORM IV-6 (8-78)
 H.T. HALL

COUNTY NAME
 PERMIT

