

NORTH

520'

LATITUDE 39° 42' 30"

39-45

LONGITUDE 80° 08' 50" 00"

11, 440

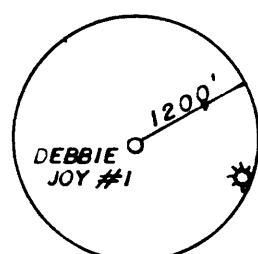

NEW MARTINSVILLE 7.5'

(+) DENOTES LOCATION OF WELL ON UNITED STATES TOPOGRAPHIC MAPS

REFERENCE POINTS

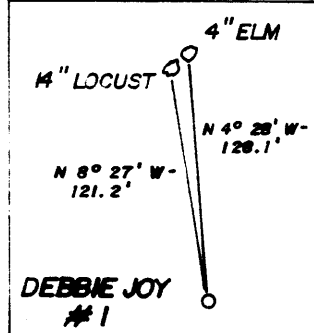

2.185  
0.10

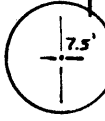

FILE NO. \_\_\_\_\_  
DRAWING NO. \_\_\_\_\_  
SCALE 1" = 1000'  
MINIMUM DEGREE OF ACCURACY 1:200  
PROVEN SOURCE OF ELEVATION TOP OF RIDGE  
1372'

I THE UNDERSIGNED, HEREBY CERTIFY THAT THIS PLAT IS CORRECT TO THE BEST OF MY KNOWLEDGE AND BELIEF AND SHOWS ALL THE INFORMATION REQUIRED BY LAW AND THE REGULATIONS ISSUED AND PRESCRIBED BY THE DEPARTMENT OF MINES.  
(SIGNED) Paul K Marshall  
R.P.E. \_\_\_\_\_ L.L.S. 580

PLACE SEAL HERE

STATE OF WEST VIRGINIA  
DEPARTMENT OF MINES  
OIL AND GAS DIVISION



DATE APRIL 30, 19 85  
OPERATOR'S WELL NO. Debbie Joy #1  
API WELL NO. \_\_\_\_\_

WELL TYPE: OIL  GAS  LIQUID INJECTION \_\_\_\_\_ WASTE DISPOSAL \_\_\_\_\_  
(IF "GAS,") PRODUCTION  STORAGE \_\_\_\_\_ DEEP \_\_\_\_\_ SHALLOW   
LOCATION: ELEVATION 1339' WATERSHED HAYNES RUN  
DISTRICT MAGNOLIA 6 COUNTY WETZEL  
QUADRANGLE NEW MARTINSVILLE 7.5' 309 091 NC 2  
SURFACE OWNER JOSEPH M. BOLLOUZ ACREAGE 273.9 AC.  
OIL & GAS ROYALTY OWNER JOSEPH M. BOLLOUZ LEASE ACREAGE 273.9 ACRES

LEASE NO. \_\_\_\_\_  
PROPOSED WORK: DRILL  CONVERT \_\_\_\_\_ DRILL DEEPER \_\_\_\_\_ REDRILL \_\_\_\_\_ FRACTURE OR STIMULATE  PLUG OFF OLD FORMATION \_\_\_\_\_ PERFORATE NEW FORMATION \_\_\_\_\_ OTHER PHYSICAL CHANGE IN WELL (SPECIFY) \_\_\_\_\_

PLUG AND ABANDON \_\_\_\_\_ CLEAN OUT AND REPLUG \_\_\_\_\_  
TARGET FORMATION GORDON ESTIMATED DEPTH 3500  
WELL OPERATOR CLAY RESOURCES INC. DESIGNATED AGENT ANDY BROWN  
ADDRESS 204 UNION SQUARE 172 ADDRESS BOX 32  
MARIETTA, OHIO 45730 READER, WV 26167

COUNTY NAME  
PERMIT

JUN 21 1985

WR-35



Date February 18, 1986  
Operator's Well No. Debbie Joy #1  
Farm Joseph Ballouz  
API No. 47 - 103 - 1349

State of West Virginia

DEPARTMENT OF ENERGY  
Oil and Gas Division

FEB 21 1986

WELL OPERATOR'S REPORT  
OF  
DRILLING, FRACTURING AND/OR STIMULATING, OR PHYSICAL CHANGE

WELL TYPE: Oil X / Gas X / Liquid Injection    / Waste Disposal    /  
(If "Gas," Production X / Underground Storage    / Deep    / Shallow    /)

LOCATION: Elevation: 1339 Watershed Haynes Run  
District: Magnolia County Wetzel Quadrangle New Martinsville 7.5'

COMPANY Clay Resources, Inc.  
ADDRESS 204 Union Square, Marietta, OH 45750  
DESIGNATED AGENT Andy Brown  
ADDRESS Box 32, Reader, WV 26167  
SURFACE OWNER Joseph Ballouz  
ADDRESS 216 Paducah Dr. New Martinsville, WV  
MINERAL RIGHTS OWNER SAME  
ADDRESS     
OIL AND GAS INSPECTOR FOR THIS WORK Robert  
Lother General Delivery ADDRESS Middlebourne, WV  
PERMIT ISSUED June 11, 1985  
DRILLING COMMENCED July 22, 1985  
DRILLING COMPLETED October 23, 1985  
IF APPLICABLE: PLUGGING OF DRY HOLE ON  
CONTINUOUS PROGRESSION FROM DRILLING OR  
REWORKING. VERBAL PERMISSION OBTAINED  
ON   

Casing & Tubing	Used in Drilling	Left in Well	Cement fill up Cu. ft.
Size 20-16 Cord.			
13-10"			
9 5/8			
8 5/8		1645	350 sx
7			
5 1/2			
4 1/2		2977	sx
3			
2			
Liners used			

GEOLOGICAL TARGET FORMATION Gordon Depth 3000 feet  
Depth of completed well 2957 feet Rotary    / Cable Tools X  
Water strata depth: Fresh    feet; Salt 2318 feet  
Coal seam depths: 1129 Is coal being mined in the area? No

OPEN FLOW DATA

Producing formation Gordon Pay zone depth 2938-2950 feet  
Gas: Initial open flow 20 Mcf/d Oil: Initial open flow 0 Bbl/d  
Final open flow (15) Mcf/d Final open flow 0 Bbl/d  
Time of open flow between initial and final tests 72 hours  
Static rock pressure 320 psig (surface measurement) after 72 hours shut in  
(If applicable due to multiple completion--)  
Second producing formation    Pay zone depth    feet  
Gas: Initial open flow    Mcf/d Oil: Initial open flow    Bbl/d  
Final open flow    Mcf/d Oil: Final open flow    Bbl/d  
Time of open flow between initial and final tests    hours  
Static rock pressure    psig (surface measurement) after    hours shut in

MAR 3 1986  
(Continue on reverse side)

DETAILS OF PERFORATED INTERVALS, FRACTURING OR STIMULATING, PHYSICAL CHANGE, ETC.

PERFORATIONS: 20 shots: 2936 to 2952

FRAC: Foam

WELL LOG

FORMATION	COLOR	HARD OR SOFT	TOP FEET	BOTTOM FEET	REMARKS
					Including indication of all fresh and salt water, coal, oil and gas
sand & shale			0	618	
shale & lime			618	1384	
shale, lime, redrock			1384	1464	
shale 7 lime			1464	2208	
shale			2208	2600	Weir: 2454-2464
sand & shale			2600	2650	
sand			2650	2700	Berea: 2678-2686
sand & shale			2700	2850	
shale			2850	<u>2957</u>	Gordon 2938-2950

(Attach separate sheets as necessary)

CLAY RESOURCES, INC  
 Well Operator  
 By: Sandra L. Schaefer V. Pres. Operations  
 Date: February 18, 1986

Note: Regulation 2.02(i) provides as follows:  
 "The term 'log' or 'well log' shall mean a systematic detailed geological record of all formations, including coal, encountered in the drilling of a well."

**RECEIVED**

JUN 05 1985



1) Date: May 28, 1985  
 2) Operator's Well No. Debbie Joy #1  
 3) API Well No. 47 103 - 1349  
 State County Permit

STATE OF WEST VIRGINIA  
 DEPARTMENT OF MINES, OIL AND GAS DIVISION  
 APPLICATION FOR A WELL WORK PERMIT

OIL & GAS DIVISION  
 DEPT. OF MINES

- 4) WELL TYPE: A Oil  Gas   
 B (If "Gas", Production  / Underground storage  / Deep  / Shallow  )  
 5) LOCATION: Elevation: 1339' Watershed: Haynes Run  
 District: Magnolia County: Wetzel Quadrangle: New Martinsville 7.5  
 6) WELL OPERATOR Clay Resources, Inc. 7) DESIGNATED AGENT Andrew C. Brown  
 Address 204 Union Square Address Box 32  
Marietta, OH 45750 10025 Reader, WV 26167  
 8) OIL & GAS INSPECTOR TO BE NOTIFIED 9) DRILLING CONTRACTOR:  
 Name Robert Lowther Name Unknown  
 Address General Delivery Address \_\_\_\_\_  
Middlebourne, WV 26149  
 10) PROPOSED WELL WORK: Drill  / Drill deeper  / Redrill  / Stimulate   
 Plug off old formation  / Perforate new formation   
 Other physical change in well (specify) \_\_\_\_\_  
 11) GEOLOGICAL TARGET FORMATION, Gordon  
 12) Estimated depth of completed well, 3500 feet  
 13) Approximate trata depths: Fresh, 550 feet; salt, 500 feet.  
 14) Approximate coal seam depths: 900 - 1000' Is coal being mined in the area? Yes  / No

15) CASING AND TUBING PROGRAM

CASING OR TUBING TYPE	SPECIFICATIONS					FOOTAGE INTERVALS		CEMENT FILL-UP OR SACKS (Cubic feet)	PACKERS
	Size	Grade	Weight per ft.	New	Used	For drilling	Left in well		
Conductor									Kinds
Fresh water	8 5/8					1030'	1030'	CTS	Per rule 15.05
Coal									Sizes
Intermediate									
Production	4 1/2					3500'	3500'	500 + SKS	Depths set Per rule 15.01
Tubing									
Liners									Perforations: Top Bottom

OFFICE USE ONLY  
 DRILLING PERMIT

Permit number 47-103-1349

June 11 19 85  
 Date

This permit covering the well operator and well location shown below is evidence of permission granted to drill in accordance with the pertinent legal requirements subject to the conditions contained herein and on the reverse hereof. Notification must be given to the District Oil and Gas Inspector, (Refer to No. 8) Prior to the construction of roads, locations and pits for any permitted work. In addition, the well operator or his contractor shall notify the proper district oil and gas inspector 24 hours before actual permitted work has commenced.)

The permitted work is as described in the Notice and Application, plat, and reclamation plan, subject to any modifications and conditions specified on the reverse hereof.

Permit expires June 11, 1987 unless well work is commenced prior to that date and prosecuted with due diligence.

Bond:	Agent:	Plat:	Casing	Fee
38	ALB	MU	MU	528

Margaret J. Kisse  
 Administrator, Office of Oil and Gas

NOTE: Keep one copy of this permit posted at the drilling location.

File

See the reverse side of the APPLICANT'S COPY for instructions to the well operator.