

FILE NO. \_\_\_\_\_  
 MAP NO. N68 sqs. N12, W1  
 SCALE 1" = 800'  
 MINIMUM DEGREE OF ACCURACY \_\_\_\_\_  
 PROVEN SOURCE OF ELEVATION \_\_\_\_\_

I THE UNDERSIGNED, HEREBY CERTIFY THAT THIS PLAT IS CORRECT TO THE BEST OF MY KNOWLEDGE AND BELIEF AND SHOWS ALL THE INFORMATION REQUIRED BY LAW AND THE REGULATIONS ISSUED AND PRESCRIBED BY THE DEPARTMENT OF MINES.  
 (SIGNED) Timothy P. Roush  
 TIMOTHY P. ROUSH P.S. 793

PLACE SEAL HERE

STATE OF WEST VIRGINIA  
 DEPARTMENT OF MINES  
 OIL AND GAS DIVISION



DATE December 31, 1992  
 FARM L. S. Hoyt NO. 79  
 API WELL NO. 47 - 103 - 1532 - N  
 STATE COUNTY PERMIT

(+) DENOTES LOCATION OF WELL ON UNITED STATES TOPOGRAPHIC MAPS  
 WELL TYPE: OIL  GAS \_\_\_\_\_ LIQUID INJECTION \_\_\_\_\_ WASTE DISPOSAL \_\_\_\_\_  
 (IF "GAS,") PRODUCTION \_\_\_\_\_ STORAGE \_\_\_\_\_ DEEP \_\_\_\_\_ SHALLOW \_\_\_\_\_  
 LOCATION: ELEVATION 1103.42 WATER SHED LITTLE FISHING CREEK  
 DISTRICT CENTER 1 COUNTY Wetzel  
 QUADRANGLE PINE GROVE 549 Wetzel C  
 SURFACE OWNER \_\_\_\_\_ ACREAGE \_\_\_\_\_  
 OIL & GAS ROYALTY OWNER Hoyt Foundation LEASE ACREAGE 825  
 LEASE NO. 52265-50  
 PROPOSED WORK: DRILL \_\_\_\_\_ CONVERT \_\_\_\_\_ DRILL DEEPER \_\_\_\_\_ REDRILL \_\_\_\_\_ FRACTURE OR STIMULATE \_\_\_\_\_ PLUG OFF OLD FORMATION \_\_\_\_\_ PERFORATE NEW FORMATION \_\_\_\_\_ OTHER PHYSICAL CHANGE IN WELL (SPECIFY) \_\_\_\_\_  
Application for assignment of API number.

PLUG AND ABANDON \_\_\_\_\_ CLEAN OUT AND REPLUG \_\_\_\_\_  
 TARGET FORMATION Gordon ESTIMATED DEPTH 2975'  
 WELL OPERATOR PENNZOIL PRODUCTS CO. DESIGNATED AGENT JAMES A. CREWS  
 ADDRESS P.O. BOX 5519 ADDRESS P.O. BOX 5519  
VIENNA, WV 26105 VIENNA, WV 26105

STATE OF WEST VIRGINIA  
DIVISION OF ENVIRONMENTAL PROTECTION  
SECTION OF OIL AND GAS

WELL REGISTER ASSIGNMENT

This API Number 47-103-01532, issued to PENNZOIL PRODUCTS COMPANY is evidence of permission to operate the well that is referenced at the location described on the attached plat, subject to the provisions of Chapters 22 and 22B of the West Virginia Code of 1931, as amended, and all rules and regulations promulgated thereunder. The name and telephone number of the Oil and Gas Inspector for this well is RANDAL MICK -  
304-986-3324.

Spills or emergency discharges must be reported to 1-800-654-3312.

Failure to abide by all statutory and regulatory provisions governing all duties and operations hereunder may result in suspension or revocation of your permits and in addition may result in civil and/or criminal penalties.

The enclosed WR-35 must be completed by you and returned to this office. In addition annual production reports must be submitted on this well and failure to do so may require you to plug the well.

Theodore M. Streit  
Chief

By: 

Title: \_\_\_\_\_

Operator's Well No: L.S. HOYT # 79

Farm Name: HOYT FOUNDATION

API Well Number : 47-103-01532 N

Date Issued : 04/15/93

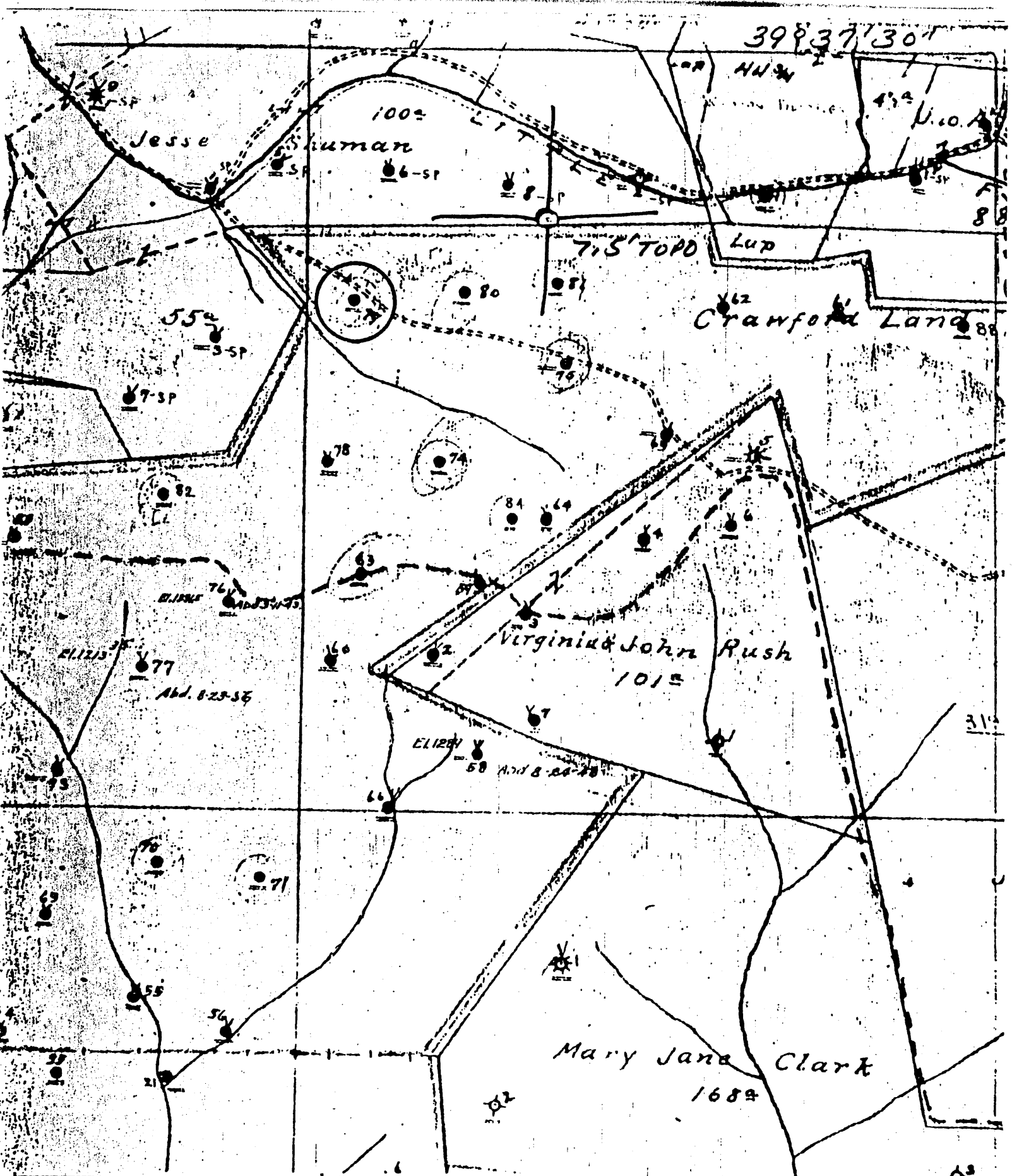

(+) DENOTES LOCATION OF WELL ON UNITED STATES TOPOGRAPHIC MAPS

FORM IV-6  
(8-78)  
NGB N12W1



STATE OF WEST VIRGINIA  
DEPARTMENT OF MINES  
OIL AND GAS DIVISION

DATE 1-5-1979  
OPERATOR'S WELL NO. 79  
API WELL NO. 47-103-1000  
STATE COUNTY PERMIT

now  
103 1582

WELL TYPE: OIL  GAS  LIQUID INJECTION  WASTE DISPOSAL   
( IF "GAS", PRODUCTION  STORAGE  DEEP  SHALLOW   
LOCATION: ELEVATION 1108.98 WATER SHED LITTLE FISHING CR  
DISTRICT CENTER COUNTY WETZEL  
QUADRANGLE PINE GROVE 715

SURFACE OWNER \_\_\_\_\_ ACREAGE \_\_\_\_\_  
OIL & GAS ROYALTY OWNER \_\_\_\_\_ LEASE NO. \_\_\_\_\_ LEASE ACREAGE \_\_\_\_\_

PROPOSED WORK: DRILL  CONVERT  DRILL DEEPER  REDRILL  FRACTURE OR STIMULATE  PLUS OFF OLD FORMATION  PERFORATE NEW FORMATION  OTHER PHYSICAL CHANGE IN WELL (SPECIFY) \_\_\_\_\_

PLUG AND ABANDON  CLEAN OUT AND REPLUG   
TARGET FORMATION \_\_\_\_\_ ESTIMATED DEPTH \_\_\_\_\_  
WELL OPERATOR Conocoil Company DESIGNATED AGENT James A. Cravs  
ADDRESS P. O. Box 1582 ADDRESS P. O. Box 1582  
Parkersburg, WV 26101 Parkersburg, WV 26101

LATITUDE 39° 37' 30"

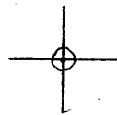

80° 37' 30"

LONGITUDE

T5 OGIS topo location

7.5' loc 0.615  
                  1.09 w

15' loc 3.485  
(calc.) 3.30 w

Company \_\_\_\_\_

Farm \_\_\_\_\_

Quad Littleton C  
PINE GROVE 7 1/2'

County WETZEL

District CENTER

WELL LOCATION MAP

File No. 103-1000

now 103:1532

Pine Grove Camp Run (040)

Well No. 9-5582 L. Hoyt tract Farm.  
 Lease No. Grant Township Stetzel County WV  
 Rig built by Geo. W. Crawford  
 Well drilled by William George Contractor.  
 Began drilling Sept 3 - 1903 Completed Apr. 7 - 1907

Formation	No.	Bottom	Remarks
Conductor		16	
Water Seal	545	548	
Shale	920	927	Light gas in upper
Green sand	2127	2362	
Iron	2927	2947	Light gas in string
Shale	2465	2975	
Shale		2461	
Water Seal		2975	

105 lbs. 12 2 1/2 hrs.

Casing Record

Ent in	Reel	Depth
105	548	548
105	1005	1005
105	2309	2309

W. S. Taylor Super

Shot 3-11-41 - 40 lbs. @ 2959 - Well Bridged 400 ft. from bottom when shot

**RECEIVED**  
 WV Division of  
 Environmental Protection  
 APR 14 1983  
 Permitting  
 Office of Oil & Gas

103-1532

APR 19 1983