

SHIBEN LEASE 65.5 AC.

11,430' W

LATITUDE 39°37'30"

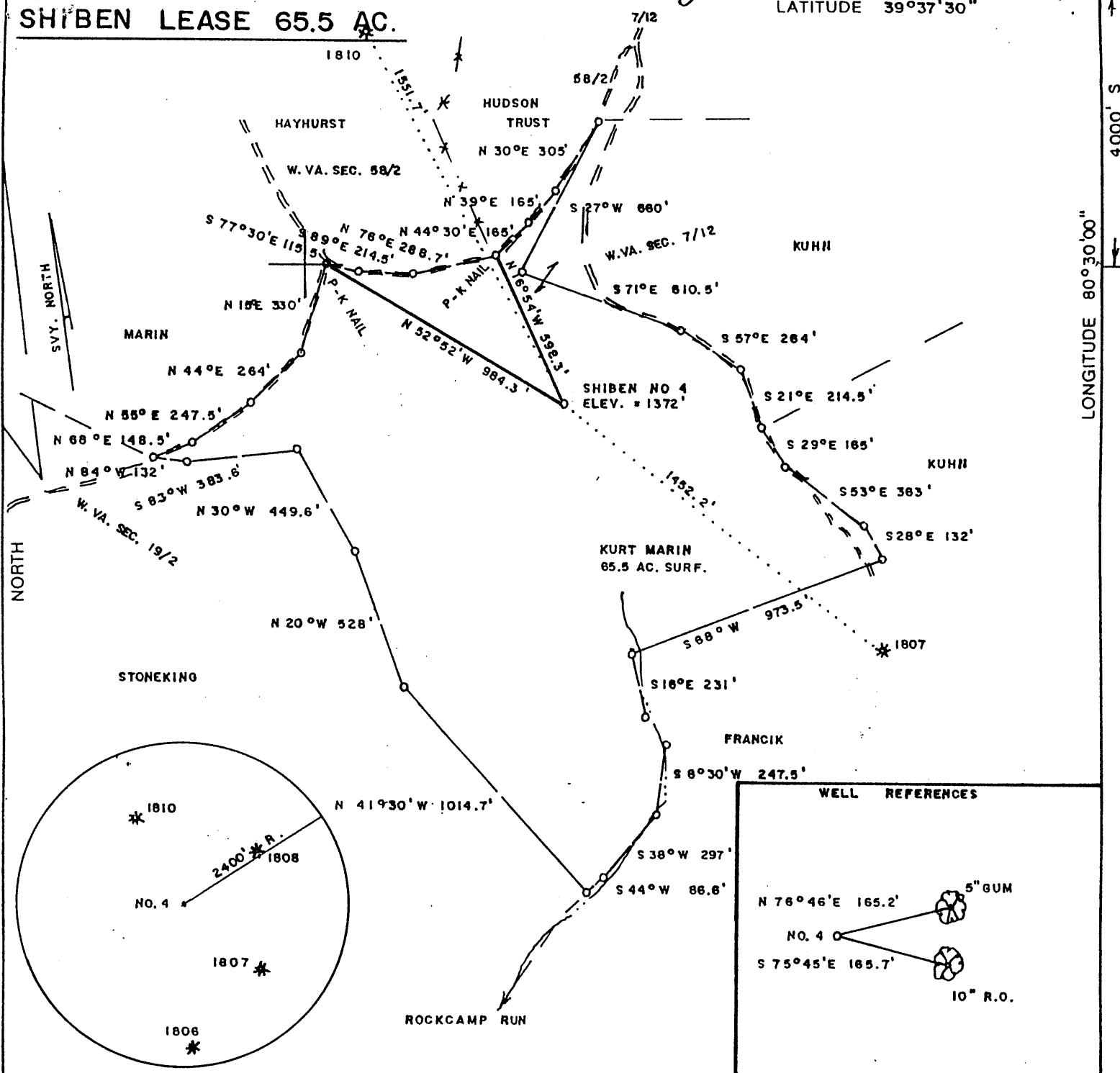

(+) DENOTES LOCATION OF WELL ON UNITED STATES TOPOGRAPHIC MAPS

FILE NO. _____
 DRAWING NO. _____
 SCALE 1" = 500'
 MINIMUM DEGREE OF ACCURACY 1/200
 PROVEN SOURCE OF ELEVATION TOP OF KNOB - W. SIDE OF LEASE ELEV. = 1638'

I THE UNDERSIGNED, HEREBY CERTIFY THAT THIS PLAT IS CORRECT TO THE BEST OF MY KNOWLEDGE AND BELIEF AND SHOWS ALL THE INFORMATION REQUIRED BY LAW AND THE REGULATIONS ISSUED AND PRESCRIBED BY THE DEPARTMENT OF ENERGY.
 (SIGNED) Mark C. Echard
 R.P.E. _____ L.L.S. 490

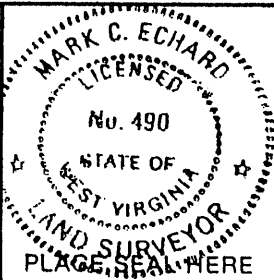

STATE OF WEST VIRGINIA
 Division of Environmental Protection
 OFFICE OF OIL AND GAS

DATE JULY 10, 2001
 OPERATOR'S WELL NO. SHIBEN NO. 4
 API WELL NO. _____

WELL TYPE: OIL GAS LIQUID INJECTION WASTE DISPOSAL
 (IF "GAS,") PRODUCTION STORAGE DEEP SHALLOW
 LOCATION: ELEVATION 1372 WATERSHED ROCK CAMP RUN OF WILLEY FORK
 DISTRICT GRANT COUNTY WETZEL
 QUADRANGLE BIG RUN 7.5'

SURFACE OWNER KURT MARIN ACREAGE 65.5
 OIL & GAS ROYALTY OWNER SHIBEN ESTATES, INC. et al LEASE ACREAGE 65.5
 LEASE NO. _____

PROPOSED WORK: DRILL CONVERT DRILL DEEPER REDRILL FRACTURE OR STIMULATE PLUG OFF OLD FORMATION PERFORATE NEW FORMATION OTHER PHYSICAL CHANGE IN WELL (SPECIFY) _____

PLUG AND ABANDON CLEAN OUT AND REPLUG
 TARGET FORMATION SPEECHLEY ESTIMATED DEPTH 3900'
 WELL OPERATOR D.A.C. DESIGNATED AGENT KENNETH MASON
 ADDRESS P.O. BOX 99 ADDRESS PO. BOX 99
ALMA, WV 26320 ALMA, WV 26320

S. 0004
 00,0E,08 EDUJIGNOT
 COUNTY NAME WET
 PERMIT 18516

AUG 24 2001

State of West Virginia
Department of Environmental Protection
Office of Oil and Gas

Row: _____

Ar-J

Well Operator's Report of Well Work

Farm name: Kurt Martin

Operator Well No. Shiben #4

LOCATION: Elevation: 1372'

Quadrangle: Big Run 7.5'

District: Grant County: Wetzel
Latitude: 4000' Feet South of 39 Deg. 37 Min. 30 Sec.
Longitude 11,430' Feet West of 80 Deg. 30 Min. 00 Sec.

Company: D.A.C.

	Casing & Tubing	Used in drilling	Left in well	Cement fill up Cu. Ft.
Address: P.O. Box 99	9-5/8"	200'	200'	55 sks
Alma, WV 26320	7"	1675'	1675'	100 sks
Agent: Kenneth Mason	4-1/2"	3800'	3800'	160 sks
Inspector: Randal Mick				
Date Permit Issued: 08/23/01				
Date Well Work Commenced: 10/11/01				
Date Well Work Completed: 10/17/01				
Verbal Plugging:				
Date Permission granted on:				
Rotary X Cable Rig				
Total Depth (feet): 3612'				
Fresh Water Depth (ft.): 1900'				
Salt Water Depth (ft.):				
Is coal being mined in area (N/Y)? N				
Coal Depths (ft.): 1147'				

OPEN FLOW DATA

Producing formatio 4th Sd Pay zone depth (ft) 3270-3380
Gas: Initial open flow 298 MCF/d Oil: Initial open flow _____ Bbl/d
Final open flow 298 MCF/d Final open flow _____ Bbl/d
Time of open flow between initial and final tests _____ Hours
Static rock Pressure 675 psig (surface pressure) after _____ Hours

Second producing formation _____ Pay zone depth (ft) _____
Gas: Initial open flow _____ MCF/d Oil: Initial open flow _____ Bbl/d
Final open flow _____ MCF/d Final open flow _____ Bbl/d
Time of open flow between initial and final tests _____ Hours
Static rock Pressure _____ psig (surface pressure) after _____ Hours

NOTE: ON BACK OF THIS FORM PUT THE FOLLOWING: 1). DETAILS OF PERFORATED INTERVALS, FRACTURING OR STIMULATING, PHYSICAL CHANGE, ETC. 2). THE WELL LOG WHICH IS A SYSTEMATIC DETAILED GEOLOGICAL RECORD OF ALL FORMATIONS, INCLUDING COAL ENCOUNTERED BY THE WELLBORE.

Signed: D.A.C. *Kenny Mason*
By: Kenny Mason

MAR 08 2002

WET 1856

API # 47-103-01856
Shiben #4

Stage #1	perfs	sand sks
4 th /Gordon	3270-3300 16 holes	250

ISIP 2838

Drillers Log

Fill	0-7'
Shale	7'-15'
Sd/Stone	15'-60'
Shale	60'-248'
RR	248'-258'
Shale	258'-262'
Sand	262'-268'
Sd/Sh	268'-1147'
Coal	1147'-1150'
Sd/Sh	1150'-1197'
RR	1197'-1235'
Sd/Sh	1235'-1288'
RR/Sh	1288'-1545'
Sd/Sh	1545'-1667'
Sd	1667'-1738'
Shale	1738'-1900'
Sand	1900-2323'
B. Lime	2323'-2387'
Injun	2387'-2602'
Sd/Sh	3602'-3200'
Gordon	3200'-3248'
Sd/Sh	3248'-3280'
4 th Sand	3280'-3304'
Sd/sh	3304'-3430'
Bayard	3430'-3440'
Sd/Sh	3440'-3612'
TD	3612'

1 1/4" strm @ 1900'
2" strm @ 2030'

gas ck @ Td = 298 mcfs

Electric Log Tops

Big Lime	2368'
Gordon	3185'