

SURFACE HOLE DEC. LONG: 80.612651  
SURVEYED LONG: 80° 36' 45.5"

8,260'

Latitude: 39° 37' 30" (NAD27)

PROPERTY OWNER	ACRES	LEASE NUMBER	PARCEL ID
A. DELORIS JEAN SAPP	0.880	LEASE NUMBER 4	1-18-18.5
B. DURWIN W. & MORGAN TEAUNNA MILLER	1.000	LEASE NUMBER 5	1-18-21
C. HG ENERGY LLC.	2.000	LEASE NUMBER 7	1-18-19

DAVID D. MOORE  
TAX MAP & PARCEL  
1-14-45.1  
LEASE NUMBER  
99445-00 thru 99445-50  
& 108053-00 & 99519-00  
5.29 ACRES

JACK W. THOMAS  
TAX MAP & PARCEL  
1-14-36  
LEASE NUMBER  
99444-00 & 99519-00 &  
99553-00 & 99445-00 thru  
99445-50 & 99446-00 thru  
99446-21  
50.00 ACRES

GARY BAKER  
TAX MAP & PARCEL  
1-18-33  
LEASE NUMBER  
107734-00 & 99447-01 &  
99516-00 & 99517-00 &  
99518-00 & 99563-00 &  
99446-00 thru 99446-20 &  
99445-00 thru 99445-50  
84.75 ACRES



103-02149  
30687 L. BAKER  
TAX MAP & PARCEL  
1-14-46  
LEASE NUMBER  
107734-00 & 99447-01 &  
99516-00 & 99517-00 &  
99518-00 & 99563-00 &  
99446-00 thru 99446-20 &  
99445-00 thru 99445-50  
84.75 ACRES

HG ENERGY LLC  
TAX MAP & PARCEL  
1-18-5  
LEASE NUMBER  
99357-00 & 107940-00 &  
108025-00 & 107605-00 &  
107605-01 & 107672-00 thru  
107672-34  
40.00 ACRES

RANDY W. LEMASTERS  
TAX MAP & PARCEL  
1-14-45  
LEASE NUMBER  
99445-00 thru 99445-50  
& 108053-00 & 99519-00 &  
107734-00  
64.11 ACRES

DURWIN MILLER  
TAX MAP & PARCEL  
1-18-20  
LEASE NUMBER  
108022-00 & 107605-00 &  
107605-01  
5.00 ACRES

JOYCE M. LONG & DONNA STRAIGHT  
TAX MAP & PARCEL  
1-18-02  
LEASE NUMBER  
107734-00  
105.78 ACRES

TOP HOLE (UTM NAD 83)	N) 4385110.9
	E) 533285.0
BOTTOM HOLE (UTM NAD 83)	N) 4386669.1
	E) 530990.6

W#1	N 80°50'33" W	1,537'
W#2	S 82°13'43" W	2,010'
W#3	N 46°37'51" E	1,729'
W#4	N 41°22'38" E	1,869'
W#5	N 32°16'58" E	1,777'
S#1	N 40°25'17" E	1,902'

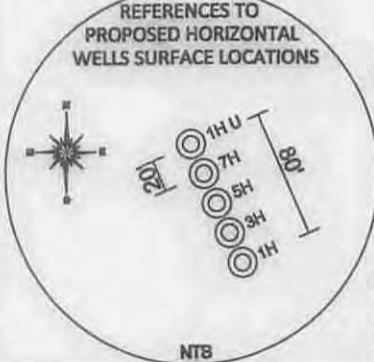

**REFERENCE NOTES**  
Boundaries as shown taken from deeds, tax maps and field locations. A full boundary survey is not expressed nor implied. All bearings are based on true north. Ownership taken from public records Wetzel County, West Virginia NOVEMBER 2014  
State Plane Coordinates & NAD 83 Lat/Long by differential submeter mapping grade GPS  
Drafted by EAJ

NO DWELLINGS FOUND WITHIN 650' OF THE CENTER OF THE WELL PAD  
NO WATER WELLS FOUND WITHIN 250' OF THE CENTER OF WELL PAD

FILE #: AE001  
DRAWING #: 2455  
SCALE: PLAT - 1" = 1400'  
TICK MARK - 1" = 2000'  
MINIMUM DEGREE OF ACCURACY: 1/200  
PROVEN SOURCE OF ELEVATION: SUBMETER MAPPING GRADE GPS

I, THE UNDERSIGNED, HEREBY CERTIFY THAT THIS PLAT IS CORRECT TO THE BEST OF MY KNOWLEDGE AND BELIEF AND SHOWS ALL THE INFORMATION REQUIRED BY LAW AND THE REGULATIONS ISSUED AND PRESCRIBED BY THE DEPARTMENT OF ENVIRONMENTAL PROTECTION.  
Signed: *[Signature]*  
L.L.S. #2124 : Ernest J. Benchek III



(+) DENOTES LOCATION OF WELL ON UNITED STATES TOPOGRAPHIC MAPS WVDEP  
**OFFICE OF OIL & GAS**  
601 57TH STREET  
CHARLESTON, WV 25304  
Well Type:  Oil  Waste Diposal  Production  Deep  
 Gas  Liquid Injection  Storage  Shallow  
WATERSHED: FISHING CREEK  
COUNTY/DISTRICT: WETZEL / CENTER  
SURFACE OWNER: DALE K. DULANEY  
OIL & GAS ROYALTY OWNER: PATSY C. FISH, ARTHUR R. & JOAN E. MILLER, CONNIE S. WHITE, KEITH R. MOORE  
LEASE NUMBERS: \_\_\_\_\_  
TARGET FORMATION: MARCELLUS  
WELL OPERATOR: American Energy-Marcellus LLC.  
ADDRESS: 3501 NW 63rd Street  
CITY: Oklahoma City STATE: OK ZIP CODE: 73116

DATE: FEBRUARY 23, 2015  
OPERATOR'S WELL #: MARY MILLER GRT WZ 3H  
API WELL #: 47 103 03071H6A  
STATE COUNTY PERMIT  
ASBUILT ELEVATION: 1,364'  
QUADRANGLE: BIG RUN, WV  
ACREAGE: 156.90 +/-  
ACREAGE: 623.92 +/-  
DRILL  CONVERT  DRILL DEEPER  REDRILL  FRACTURE OR STIMULATE   
PLUG OFF FORMATION  PERFORATE NEW FORMATION  PLUG & ABANDON   
CLEAN OUT & REPLUG  OTHER CHANGE  (SPECIFY): \_\_\_\_\_  
ESTIMATED DEPTH: TVD: 7,439' TMD: 16,800'  
DESIGNATED AGENT: Eric B. Gillespie  
ADDRESS: 103 Taryn Lane  
CITY: Cross Lanes STATE: WV ZIP CODE: 25515

03/06/2015

