

39° 30' 00"

80° 30' 00"

Latitude

Longitude

⊕
148s
35w

Topo Location

7.5' Loc. _____ 15' Loc. _____
_____ (calc.) _____

Company South Penn Oil Co

Farm Sam Talkington #2

15' Quad _____
(sec.)

7.5' Quad Folsom

District GRANT

WELL LOCATION PLAT

County 103 **Permit** 30072

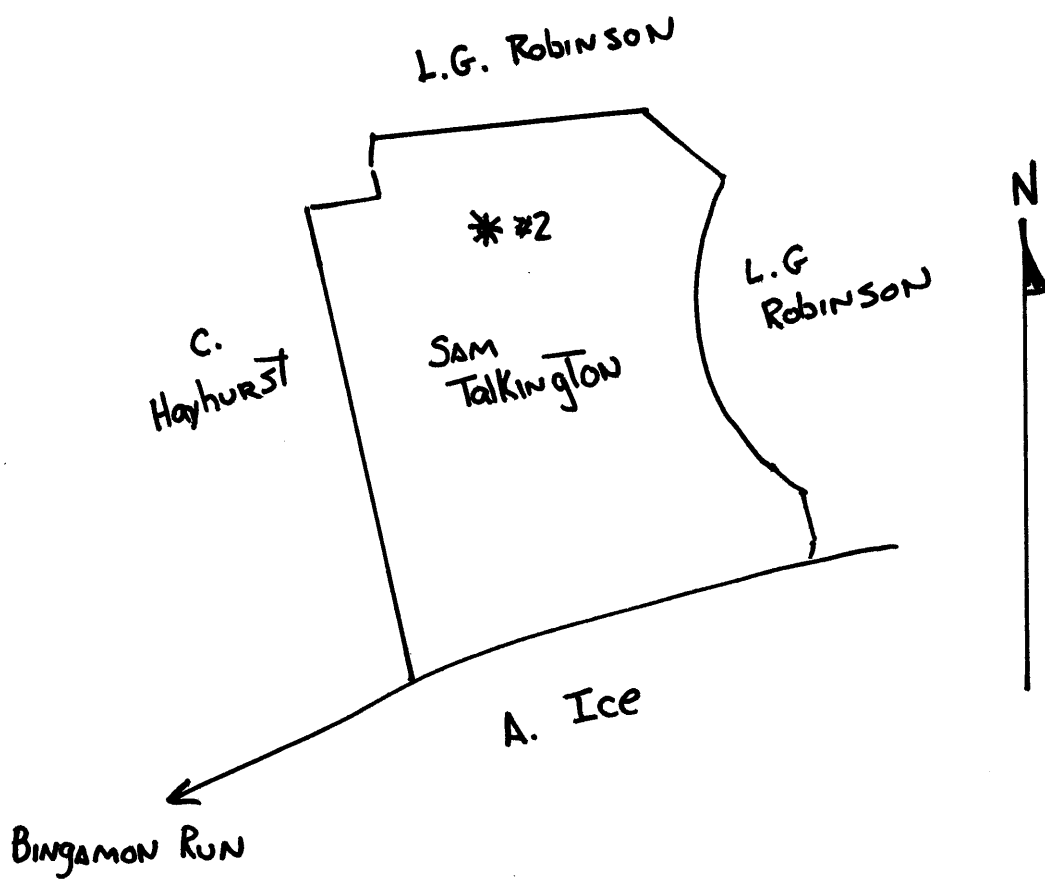

(p-A)

Grant District, Wetzel County, W. Va.
 By South Penn Oil Co., Drawer 1255, Pittsburgh, Pa.
 On 25 acres, surface owned by Robinson Improvement Co., W. A. Lewis,
 The Plains, Va., and mineral rights by Louise S. Fox, 1012
 Locust St., Fairmont, W. Va., and Cecil B. Highland, New
 Martinsville, W. Va.

Elevation, 1316' L.

16' conductor; 10" casing, 347' (pulled); 8 $\frac{1}{2}$ " 1669'; 6-5/8" 2569'.

Coal was encountered at 1173-1180'.

538' of 5 $\frac{1}{2}$ x 5" liner.

Abandonment reported to Dept. of Mines Dec. 15, 1931.

Well was shot twice (depth unknown).

Oil well.

	Top.	Bottom.
Wood Conductor	0	16
Pittsburgh Coal	1175	1180
Dunkard Sand	1580	1615
Salt Sand	2040	2170
Pencil Cave	2375	2390
Big Lime	2390	2480
Big Injun Sand	2480	2550
50-Ft. Sand	3052	3067
30-Ft. Sand	3149	3175
Stray Sand	3202	3262
Gordon Sand (oil)	3275	3295
Total depth		3300